

TEC Professional Services Questionnaire**A. Project Name and Advertisement Resolution Number:**

SOQ - 22-026: Professional Architectural and Engineering Services for
Architectural Type Projects - Resolution: 139630

B. Firm Name & Address:

VergesRome Architects, APAC
320 N Carrollton Ave, Suite 100 - New Orleans, Louisiana 70119

VergesRome

C. Name, title and contact information of Principal, as defined in Section 2-926 of the Jefferson Parish Code of Ordinances, who is a registered, licensed architect, professional engineer, or surveyor in the State of Louisiana:

Ernest E. Verges, II, AIA - President
Email: Chip@vergesrome.com
Telephone: (504) 488-7739
Fax: (504) 488-7743

D. Name and contact information of employee who is a registered and licensed architect, professional engineer, or surveyor in the State of Louisiana in the applicable discipline. A subcontractor may be substituted here only if the advertised Project requires more than one discipline.

Steven H. Rome - Vice President
Email: Steve@vergesrome.com
Telephone: (504) 488-7739
Fax: (504) 488-7743

E. Please provide the number of employees whose primary function corresponds with each category:

<u>5</u> Administrative	<u> </u> Estimators	<u> </u> Specification Writers
<u>9</u> Architects (Licensed)	<u> </u> Geologists	<u> </u> Structural Engineers
<u> </u> Chemical Engineers	<u> </u> Geotechnical Engineers	<u> </u> Graduate Engineers
<u> </u> Civil Engineers	<u>1</u> Interior Designers	<u> </u> Project Managers
<u>1</u> Construction Inspectors	<u> </u> Landscape Architects	<u>4</u> Clerical
<u> </u> Ecologists	<u> </u> Land Surveyor	<u> </u> Grant/Funding Specialist
<u> </u> Electrical Engineers	<u> </u> Mechanical Engineers	<u> </u> Sanitary Engineers
<u>4</u> Engineer Intern Architect Intern	<u> </u> Environmental Engineers	
<u> </u> Professional Land Surveyors		<u>24</u> TOTAL

F. Is this submittal by a JOINT-VENTURE? Please check: YES ☐ NO ☒

If marked "No" skip to Section I. If marked "yes" complete Sections G-H.

TEC Professional Services Questionnaire

G. If submittal is by JOINT-VENTURE, list the firms participating and outline specific areas of responsibility (including administrative, technical, and financial) for each firm. Please attach additional pages if necessary.

1.

N/A

2.

N/A

H. Has this JOINT-VENTURE previously worked together? Please check:

YES ☐ NO ☐

N/A

I. List all subcontractors anticipated for this Project. Please note that all subcontractors must submit a fully completed copy of this questionnaire, applicable licenses, and any other information required by the advertisement. See Jefferson Parish Code of Ordinances, Sec. 2-928(a)(3). Please attach additional pages if necessary.

Name & Address:	Specialty:	Worked with Firm Before (Yes or No):
1. Morphy Makofsky, Inc. 336 N. Norman C. Francis Pkwy, New Orleans, LA 70119	Structural Engineering	Yes
2.  Lucien T. Vivien Jr. & Associates 3001 22nd Street Metairie, LA 70002	Mechanical Engineering	Yes
3. Drake Engineering 2783 Lapalco Boulevard Havary, LA 70058	Electrical Engineering	Yes

J. Please specify the total number of support personnel that may assist in the completion of this Project:

The number of support personnel assigned to a project would be determined by the project scope. With a staff of 24, we have adequate staff for both small- and large-scale projects.

TEC Professional Services Questionnaire

K. List the professional in charge, key persons, specialists, and individual consultants anticipated for this Project and provide their relevant information below. If necessary, please attach additional documentation (i.e. resume) that demonstrates the employment history and experience of the Firm's key persons that may assist in the completion of this Project. Please attach additional pages if necessary.

PROFESSIONAL IN CHARGE OF PROJECT:

Ernest E. (Chip) Verges, II, AIA NCARB **Principal-in-Charge**



Professional Experience

A pro-active and hands-on leader, Principal Chip Verges directs the planning and design of a wide array of projects for VergesRome Architects. With nearly 40 years of experience, his business skills and technical expertise generate projects that are not only innovative, but respect the clients' budgetary and programmatic requirements. Joining the firm in 1983, Chip became an Associate in 1988, Principal and Vice President in 2000, and President in 2006, carrying on a legacy of architectural excellence and service to the communities of southeast Louisiana.

Experience:

St. Tammany Parish School Board
Little Oak Classroom Wing Addition
Slidell, Louisiana

Orleans Parish School Board
New Orleans Charter Science & Mathematics High School
New Orleans, Louisiana

LSU Dental School & Health Sciences Center

Campus Restoration & New Annex Building
New Orleans, Louisiana

Plaquemines Parish School Board
North and South Transportation Facilities
Buras, Louisiana

Recovery School District

- Morris Jeff Community School at Fisk Howard
- John McDonogh High School Renovation - Orleans Parish School Board
- Lake Area High School
- **John McDonogh Gymnasium Demolition & New Gymnasium**
- Live Oak Elementary Refurbishment

- Andrew J. Bell Junior High School Main Building Shoring
- Andrew J. Bell Junior High School Main Building Historic Roof Structure Replacement & Reroofing
- Israel M. Augustine Middle School Re-Roofing
- Oretha Castle Haley Elementary School Accessory Building Abatement & Demolition
- Safe & Secure Mothballing of 9 Campuses

New Orleans, Louisiana

Southern University at New Orleans
Education and Human Development Building
New Orleans, Louisiana

City of New Orleans
Oliver Bush Playground Restoration
New Orleans, Louisiana

Education

Bachelor of Architecture, 1983,
Louisiana State University

Registrations

Licensed Architect
Alabama 5829

Arkansas 8654

Colorado ARC.00401439

Florida AR0017845

Louisiana 3906

Mississippi 3477

Tennessee 104770

Texas 20026

National Council of Architectural
Registration Board (NCARB)
Certified

Years of Experience

41 years in industry/
40 years with VRA

Contact Information

Chip@vergesrome.com

TEC Professional Services Questionnaire**KEY PERSON, SPECIALIST, OR INDIVIDUAL CONSULTANT:****Steven H. Rome, AIA, NCARB
Principal; Director of Design****Professional Experience**

Leading with tremendous energy, a comprehensive outlook, and over 35 years of solid experience, Steve Rome draws on the diverse opportunities of his past to influence his architecture and design, showcasing quality design in tandem with the best product for the price. **An architect, designer and Houma native** who has earned respect for his leadership, Steve keeps large groups focused, endures and overcomes obstacles, and always finds a solution. Through early project work in exhibit design, hospitality, and retail planning/ design, such as Riverwalk Marketplace, the Ogden Museum of Southern Art, and the 1984 Louisiana World Exposition, Steve learned invaluable skills as an interpreter. Such assignments taught Steve Rome how to set design direction early in the process, and that *the design must support the operation*.

Education

Master of Business Administration,
1992, Tulane University
Bachelor of Architecture, 1981,
Louisiana State University

Registrations

Licensed Architect
Colorado ARC.00403539
Mississippi 3788
Florida AR92527
Georgia RA013597
Louisiana 4773
North Carolina 13954
Pennsylvania RA403205
Texas 27537
NCARB Certified

Years of Experience

41 years in industry/
24 years with VRA

Contact Information

Steve@vergesrome.com

Experience:

Christian Brothers School

- City Park Campus Expansion & Renovation (Historic)
- Padua Campus Renovation

New Orleans, Louisiana

Orleans Parish School Board

New Orleans Charter Science & Mathematics High School
New Orleans, Louisiana

Recovery School District of New Orleans

- Morris Jeff Community School at Fisk Howard School
- John McDonogh High School Renovation (Historic)
- **John McDonogh Gymnasium Replacement**

New Orleans, Louisiana

LSU Dental School & Health Sciences Center

Campus Restoration & New Annex Building
New Orleans, Louisiana

Saint Joseph Abbey & Seminary College

- **Benet Hall Auditorium Renovation (Historic)**
- **Savio Residence Hall Renovation**

- Master Planning
- Pere Rouquette Library
- **Vianney Residence Hall Renovation (Historic)**

St. Benedict, Louisiana

City of New Orleans

- Allie Mae Williams Community Center
- Dept. of Public Works New Maintenance Building/ Site Construction
- Oliver Bush Playground Renovations
- Parks & Parkways Gentilly Campus Repairs & Greenhouse Repairs (Historic)
- Union Passenger Terminal Central Plant Upgrades
- Municipal & Traffic Court New Orleans (Historic) Renovation and Temporary Court Facility

City Putt Miniature Golf Clubhouse, City Park
New Orleans, Louisiana

TEC Professional Services Questionnaire**KEY PERSON, SPECIALIST, OR INDIVIDUAL CONSULTANT:****Corey Brizzolara, ASSOCIATE AIA, LEED BD+C
Design and Architectural Production****Professional Experience**

Since joining VergesRome Architects in 2009, Corey Brizzolara has worked on numerous and diverse projects, in all project phases from programming and design through contract documents and construction closeout. His calm demeanor, and diligence make him a valued project team member.

Corey worked on technically demanding HVAC/Electrical upgrades and window replacements across five residential campuses for the East Baton Rouge Parish Housing Authority. He was a project team member for the Warren Easton High School window replacement project, a restoration project at the historic school building. Corey's experience with Tulane Medical Center projects include a \$2 Million Helistop atop the Aron Pavilion that was completed ahead of schedule and within budget. Recent project work includes the new \$27.5 Million facility for the New Orleans Charter Science and Mathematics School now in its Warranty Phase, the recently closed out \$32 Million renovation of the historic John McDonogh High School and its new Gymnasium, and a new, \$25.6 Million, three-section facility for Morris Jeff Community School at Fisk-Howard.

Experience

Recovery School District of New Orleans/ LA Department of Education

- Morris Jeff Community School at Fisk Howard School
- **John McDonogh High School Renovation (Historic)**
- **John McDonogh Gymnasium Replacement**
- Live Oak Elementary School Refurbishment
- Frederick Douglass High School Renovation & Roof Replacement (Historic)
- Andrew J. Bell Junior High School Main Building Shoring; Roof Structure Repair; Roof Replacement (Historic)
- Safe & Secure/ Mothballing of Nine School Campuses
- Samuel Green Elementary School Refurbishment (Historic)
- Martin Luther King Jr. School Refurbishment

New Orleans, Louisiana

Orleans Parish School Board

- New Orleans Charter Science and Mathematics High School
- **Warren Easton High School Window Replacement; Weatherproofing; Roofing; Interior Renovations; Remote Offices; Parking; Elevator Studies; ADA Modifications; Classroom Repairs (Historic)**

New Orleans, Louisiana

City of New Orleans

Oliver Bush Playground Restoration

New Orleans, Louisiana

**East Baton Rouge Parish Housing Authority
Abatement, Demolition, & Renovations**

- **Monte Sano Office Building**
- **Turner Plaza Fire-Damaged Apartments**
- **Multiple Campus HVAC, Electrical, and Window Replacements**

Baton Rouge, Louisiana

Saint Joseph Abbey & Seminary College

- Pere Rouquette Library

St. Benedict, Louisiana

Lakeside Shopping Center

- New Outparcel Retail Development (Starbucks, Whitney, & Flemings)
- 2nd Floor Addition & Tenant Shell Building for Charles Schwab

Metairie Louisiana

Education

Bachelor of Architecture, 2009,
Louisiana State University

Years of Experience

18 years in industry/
13 years with VRA

Contact Information

Corey@vergesrome.com

TEC Professional Services Questionnaire

KEY PERSON, SPECIALIST, OR INDIVIDUAL CONSULTANT:

Russ M. Hogan, ASSOCIATE AIA Architectural Production



Education

Bachelor of Architecture, 2002,
University of Louisiana, Lafayette

Years of Experience

20 years in industry/
14 years with VRA

Contact Information

Russ@vergesrome.com

Professional Experience

Russ Hogan joined VergesRome in 2008, quickly gaining extensive experience working on various renovation and new construction projects for local and State governmental clients, and several public school systems. Mr. Hogan has developed projects from programming and design concepts through completion of construction. He worked on several Hurricane Katrina damage assessments and was Project Manager on various renovation and new construction projects for local governmental bodies and public school districts.

Experience

Recovery School District of New Orleans/ LA Department of Education

- Morris Jeff Community School at Fisk Howard School
- **John McDonogh High School Renovation (Historic)**
John McDonogh Gymnasium Replacement
- Martin Luther King Jr. School Refurbishment

New Orleans, Louisiana

Orleans Parish School Board

- New Orleans Charter Science and Mathematics High School

New Orleans, Louisiana

Plaquemines Parish School Board

- Belle Chasse Middle School Renovation and Addition
 - Plaquemines Parish School Board North Transportation Facility
- Belle Chasse, Louisiana
- Food Service/Maintenance Building
- Port Sulphur, Louisiana
- South Plaquemines High School
 - South Plaquemines High School Field House and Athletic Fields
 - Vehicle Maintenance Facility

Buras, Louisiana

Saint Joseph Abbey & Seminary College

- **Benet Hall Auditorium Renovation (Historic)**
- Borromeo Residence Hall Renovation
- Library Planning
- **Vianney Residence Hall Renovation (Historic)**

St. Benedict, Louisiana

St. Charles Catholic High School
Renovation and Addition
LaPlace, Louisiana

TEC Professional Services Questionnaire**KEY PERSON, SPECIALIST, OR INDIVIDUAL CONSULTANT:****Richard W. Fenner, AIA****Quality Control and Specifications Manager****Education**

Bachelor of Architecture, 1981,
Ball State University

Professional Registrations

Licensed Architect
Louisiana 3468

Years of Experience

40 years in industry/
40 years with VRA

Contact Information

Rick@vergesrome.com

Professional Experience

Rick Fenner joined the firm in 1981 and in 2003 became a Partner. Mr. Fenner has worked as designer, project architect, specifications writer and programmer, and he now leads Specifications production and QA Review. Rick facilitated multiple (40+) sub-projects, from FEMA Scope Alignment, emergency damage assessments and repairs, to hurricane mitigation plans, renovations, and replacement facilities, including a new Clinic/ Administration Building, and Warehouse/ Maintenance Buildings.

Experience

Plaquemines Parish School Board

- Belle Chasse Middle School Addition
 - Belle Chasse Primary Pre-K Early Learning Center
 - Plaquemines Parish School Board North Transportation Facility Belle Chasse, Louisiana
 - Food Service/Maintenance Building
- Port Sulphur, Louisiana

- South Plaquemines High School
 - Maintenance/Athletic Building Repairs
- Buras, Louisiana

Recovery School District of New Orleans/ LA Department of Education

- Morris Jeff Community School at Fisk Howard School
- **John McDonogh High School Renovation (Historic)**
- **John McDonogh Gymnasium Replacement**
- Live Oak Elementary School Refurbishment
- Samuel Green Elementary School Refurbishment (Historic)
- Martin Luther King Jr. School Refurbishment

New Orleans, Louisiana

Orleans Parish School Board

- **Warren Easton High School Window Replacement; Weatherproofing; Roofing; Interior Renovations; Remote Offices; Parking; Elevator Studies; ADA Modifications; Classroom Repairs (Historic)**

New Orleans, Louisiana

LSU Dental School and Health Sciences Center (JV)

Hurricane Recovery Campus Restoration/ New Annex Bldg.
New Orleans, Louisiana

Offices at Mid-City Market Renovation

New Orleans, Louisiana

Saint Joseph Abbey & Seminary College

- Strategic Planning
- Vianney Hall Renovations (Historic)
- Benet Hall Flood Recovery (Historic)

St. Benedict, Louisiana

TEC Professional Services Questionnaire

KEY PERSON, SPECIALIST, OR INDIVIDUAL CONSULTANT:



Harold L. Montreuil, Jr., CSI, AIC
Construction Administration

Professional Experience

Harold Montreuil was a Project Manager for 28 years that worked closely with VergesRome on several projects. In 2008, he joined the team as Construction Administrator to work with the architect throughout the construction, which he still. His expertise is reviewing submittals and shop drawings, conducting job site construction observation and meetings, preparing and submitting field reports, supplying the information requested by Contractors, and developing a punch list when the project is substantially complete. The experience that he carries made Mr. Montreuil a vital and dependable team member.

Experience

- Belle Chase High School Renovation

Belle Chasse, Louisiana

- Winn Dixie at Mid-City Market, New Orleans, Louisiana
- Tulane University Hurricane Mitigation Projects, New Orleans, Louisiana
- Pan American Life Center Water Riser Replacement, New Orleans, Louisiana
- Lake Area High School, New Orleans, Louisiana
- Gold Seal Creamery Apartment Conversion, New Orleans, Louisiana
- Crescent Bank & Trust New Offices, New Orleans, Louisiana

- Southern University New Orleans Faculty and Student Housing
New Orleans, Louisiana

- Burns & Wilcox Center, Metairie, Louisiana
- Ray Brandt Porsche Dealership, Metairie, Louisiana
Metairie, Louisiana

- Abita Springs Elementary School Additions and Renovations
Abita Springs, Louisiana

- Folsom Junior High School Additions and Renovations; New Cafetorium
Folsom, Louisiana

- Plaquemines Parish School Board Faculty Housing
- South Plaquemines High School
Buras, Louisiana

- South Plaquemines Elementary School
- Plaquemines Parish School Board Faculty Housing
Port Sulphur, Louisiana

- Madisonville Junior High School
Madsonville, Louisiana

- Northshore High School Renovations
Slidell, Louisiana

- St. Charles Catholic High School Renovations
Laplace, Louisiana

- Little Pearl Elementary School Renovations
Pearl River, Louisiana

Education

Bachelor of Industrial Technology, Louisiana State University

Years of Experience

28 years in industry/
14 years wil VRA

Contact Information

Harold@vergesrome.com

TEC Professional Services Questionnaire

KEY PERSON, SPECIALIST, OR INDIVIDUAL CONSULTANT:

Michael J. Roussel, AIA, Partner
Project Manager



Education

Bachelor of Architecture, Louisiana State University, 1988

Years of Experience

35 years in industry/
20 years with VRA

Registration

Licensed Architect
Louisiana 4636

Memberships

American Institute of Architects

Contact Information

Michael@vergesrome.com

Professional Experience

Michael Roussel project experience entails both private and public projects including banking, retail and commercial, schools and universities, disaster recovery, automotive dealerships, religious structures, speculative office development, and low-income housing. Mr. Roussel's experience with VergesRome Architects has provided him with ample know-how for working with civic, state, and municipal jurisdictional authorities. Recent projects have included the Hurricane Laura Recovery of the 108,000 SF Health and Human Performance Building at McNeese State University in Lake Charles, LA, the new 47,000 SF College of Education and Human Development building at Southern University at New Orleans, a major renovation of his high school alma mater at St. Charles Catholic High School in LaPlace, LA, and a new 50,000 SF building for the Little Oak Middle School which added 33 new classrooms and a new library to Slidell, LA campus.

He also has successfully worked with large, diverse stakeholder groups, for example, during the early planning for the Mid City Market retail development, as Project Manager for the \$38 Million project located along the Lafitte Greenway. The scope of the Mid City Market project included four buildings, one of them a new 53,000 SF Winn-Dixie Marketplace, with 55,000 additional SF distributed among the other buildings, one of which had been a blighted property since Katrina. The site planning and conceptual design process took place with the full participation and input of neighborhood groups such as the Mid-City Neighborhood Organization, and the Friends of the Lafitte Greenway.

Experience

- Mid City Market
- Southern University at New Orleans Education & Human Development Building
- Cabrini High School Gymnasium Renovations
- McNeese State University, Hurricane Laura Repairs, Health and Human Performance Building
New Orleans, Louisiana
- St. Tammany Parish school Board Little Oak Middle School Additions
- Northshore High School Renovations
- Calcasieu Parish Schools Hurricane Laura Repairs at Vinton High, Middle and Elementary Schools and Cypress Cove Elementary School
Slidell, Louisiana
- Ray Brandt Infiniti of South Mississippi
- Ray Brandt Nissan of South Mississippi
D'Iberville, Mississippi
- St. Charles Catholic High School Renovations
LaPlace, Louisiana
- Patrick F. Taylor Science & Technology Academy
Avondale, Louisiana
- Bureau of Ocean Energy Management, Regulation and Enforcement Renovations (Elmwood Office Building)
Jefferson, Louisiana
- Ray Brandt Nissan and Ray Brandt Chrysler/Jeep
Harvey, Louisiana
- Judge Lionel Collins Elementary School Renovation and Addition
Marrero, Louisiana
- Eagan Insurance Agency Office Building
Mandeville, Louisiana

Lanette Flores Savoy Interior Design



Professional Experience

Ms. Savoy has enjoyed working in the architecture and design industry for 15 years. Prior to joining VergesRome in 2005 she was a principal and partner in a small architecture firm. As a partner, she was involved in all aspects of the business including development, office management, project management, and construction administration. In addition, she was solely responsible for all interior design services for the firm which included renovation as well as new construction projects such as hotels, corporate headquarters, hospital, condo conversions, restaurant, nightclubs, country clubs, and casino gaming facilities.

Since joining VergesRome, Ms. Savoy has completed numerous projects for Tulane University Hospital and Clinic, including Tulane Institute of Sports Medicine, and Tulane Cancer Center. She is currently working on various renovation projects within Tulane University Hospital and Clinic, including 1st and 2nd floor lobbies, dining facilities, and various medical departments. Additional projects include renovation work on hotels, bank branches, and corporate offices. She believes in providing the client with a total design package which not only includes finishes and furniture but also plantscaping, and art selection and procurement. By remaining active in the local art community, she believes it is beneficial to her and to VergesRome's clients.

Education

Bachelor of Fine Arts in Interior Architecture, College of Art and Architecture, University of Louisiana at Lafayette, 1988.

Years of Experience

23 years in industry/
16 years with VRA

Contact Information

Lanette@vergesrome.com

Experience

- Allie Mae Williams Multi-Service Center
- AOS Offices Renovation and Expansion
- Astor Hotel Renovations
- Hotel Intercontinental Renovations
- John McDonogh High School Renovations
- New Orleans Charter School for Science and Mathematics
- Southern University at New Orleans Faculty and Student Housing
- Southern University at New Orleans Education and Human Development Building
- Offices at Mid-City Market
- Penthouses at Mid-City Center
New Orleans, Louisiana
- Aucoin Heart Jewelers Renovation
- Burns & Wilcox Insurance New Offices
- Crescent Bank & Trust New Offices
Metairie, Louisiana
- Eagan Insurance New Office Building
Covington, Louisiana
- First NBC Bank
Numerous branch locations
- Ray Brandt Infiniti of South Mississippi
D'Iberville, Mississippi
- Saint Joseph Seminary College Vianney Hall Renovation
St. Benedict, Louisiana
- St. Charles Catholic High School Renovations
LaPlace, Louisiana

TEC Professional Services Questionnaire

L. Work by Firm or Joint-Venture members which best illustrates current qualifications relevant to this Project. Please include any and all work performed for Jefferson Parish. Please attach additional pages if necessary.

PROJECT NO. 1

Project Name, Location and Owner's contact information:	Nature of Firm's Responsibility:	
Judge Lionel R. Collins Elementary School MAJOR REPLACEMENT AND RENOVATION Marrero, Louisiana Jefferson Parish Public School System Steve Faust on behalf of David Taylor 4600 River Road Marrero, LA 70072 (504) 349-8595 Stephen.faust@jpschools.org	Full A/E Services	
Completion Date (Actual or estimated):	Estimated Cost:	
	Entire Project:	Work for which Firm was Responsible:
2012 (A)	\$13,000,000 11,700 SF Renovation 48,660 SF Addition	\$13,000,000



The \$13 Million Judge Lionel R. Collins Elementary School Major Replacement and Renovation project included both renovations and additions to a historic West-bank school. The renovation of the late 1920's, original one-story 11,700 SF existing brick school building, formerly Ames Elementary School, yielded four multipurpose classrooms, two special education classrooms, one computer lab, and one Physical Education classroom. The renovation also provided a **new Media center, a new kitchen and new Cafeteria/Auditorium** that can accommodate **300 people** in an auditorium setting. To enhance student safety, the school bus delivery and departure area functions are separated from pedestrian and automobile traffic. A new bus canopy was constructed in front of the original building.



Also included was the **48,660 SF** addition of a new Administration building and three classroom pods designed to respect the scale of the surrounding Marrero residential neighborhood. The design provides **14 classrooms** designed to support principles of Montessori teaching. Each classroom is provided with a Smart Board and an adjacent yard to supplement Montessori teaching methods.



The school's main entrance was relocated to Ames Boulevard, with site improvements providing common lawn and physical education spaces. VergesRome Architects delivered the project in Joint Venture with Imre Hegedus & Associated Architects.

TEC Professional Services Questionnaire**PROJECT NO. 2**

Project Name, Location and Owner's contact information:	Nature of Firm's Responsibility:	
4848 Veterans Memorial Boulevard Metairie, Louisiana 4848 Veterans Memorial Blvd. Retail-Dining Destination Louis J. Roussel, III Post Office Box 5902 Metairie, Louisiana 70009 504-837-2230 Assistant: Colette Cisco (colettecisco@hotmail.com)	Full A/E Services	
Completion Date (Actual or estimated):	Estimated Cost:	
	Entire Project:	Work for which Firm was Responsible:
2012 (A)	\$5,100,000	\$5,100,000



VergesRome Architects designed a **two-building retail** and dining destination in Metairie, a New Orleans suburb, on the former site of a large sprawling automobile dealership. Completed in Summer, 2012, eateries in the new development originally consisted of four **national tenants**: Bonefish Grill, Panera Bread, Red Mango, and Pei Wei. **VRA's** design created distinctive identities for each establishment that complied with the national brand identity and design criteria for each entity.



The site along a heavily traveled highway is bounded on the east by a popular bar/grill and a bank on the west. At the south side is a residential neighborhood, screened from the new development with a 7' fence. Only minimal rear signage was allowed. These constraints led **VRA** to situate the two new buildings as close to the front of the parcel as possible, yielding high visibility while not disturbing existing buried utilities. Minimal parking spaces are located along the front of the buildings. The project, with a cost of **\$5.1 Million**, was achieved through an intense process of planning and approvals, communications, accommodation of changes in local zoning, and coordination of multiple contractors on site during construction and buildout.



The **9,000 SF** building housing **Bonefish Grill and Panera Bread** pops visually with a combination of brick and stucco and distinctive entries. Overhangs serve as light shelves to project light through the spaces to the greatest extent possible, allowing use of tall windows. The **second building**, originally housing Pei Wei, Red Mango, and a retail store, is a **8,400 SF** predominantly brick structure that complements the other building while maintaining a **unique style** through careful architectural detailing. Kitchen design criteria were furnished by each restaurant, and VergesRome coordinated those criteria into its designs.

The successfully completed development's visual appeal contrasts with its suburban surroundings and has attracted a steady stream of patrons since its opening. **VRA** also coordinated permitting and design criteria for a third building on the site.

TEC Professional Services Questionnaire

PROJECT NO. 3		
Project Name, Location and Owner's contact information:	Nature of Firm's Responsibility	
PATRICK F. TAYLOR SCIENCE & TECHNOLOGY ACADEMY Westwego, Louisiana Jefferson Parish School Board Steve Faust on behalf of David Taylor 4600 River Road Marrero, LA 70072 (504) 349-8595 Stephen.faust@jpschools.org	Full A/E Services	
Completion Date (Actual or estimated)	Estimated Cost:	
	Entire Project:	Work for which Firm was Responsible:
2013 (A)	\$27,000,000	\$27,000,000



2018 Award of Merit, AIA Louisiana
2018 Excellence In Sustainability Honor Award, USGBC Louisiana
2014 New Orleans Magazine, New Orleans Architecture: 6 Buildings Among the Best
2014 Award of Excellence, Outstanding Project, Learning by Design
2014 People's Choice Award, AIA New Orleans



A dramatic new educational facility for **Jefferson Parish Schools, the Patrick F. Taylor Regional Science and Technology Academy** was designed by the Joint Venture of Perez, APC, and VergesRome Architects, APAC. Completed in time for classes in August 2013, the **\$27 Million, two-story, 99,762 SF facility serving grades 6 - 12**, is located in JEDCO's Churchill Technology Park in Avondale, Louisiana. Conceived as an incubator benefiting students, Patrick Taylor Academy also includes a 6,843 SF Conference Center managed by JEDCO.

Twenty-Eight classrooms are distributed in three two-story classroom wings; each has its own spacious, flexible area that enhances students' collaborative learning and social experiences. Storefront glass walls between classrooms, flexible spaces and clerestory windows bring daylight far into the interior. All classrooms, Chemistry, Biology, Robotics and Multimedia Labs, and Drama Classroom have state-of-the-art Smart Boards, and hardwired and wireless internet access. Collaborative learning and team building are further encouraged in the Video Conference Room and Green Roof Deck.



TEC Professional Services Questionnaire

PROJECT NO. 4		
Project Name, Location and Owner's contact information:	Nature of Firm's Responsibility:	
JEDCO Incubator Interior Renovation Avondale, Louisiana Jefferson Economic Development Commission (JEDCO) Scott Rojas, Director of Facilities and IT 700 Churchill Parkway Avondale, LA 70094 504-875-3916 SROjas@jedco.org	Full A/E Services	
Completion Date (Actual or estimated):	Estimated Cost:	
	Entire Project:	Work for which Firm was Responsible:
2021 (A)	\$126,500	\$126,500

Before

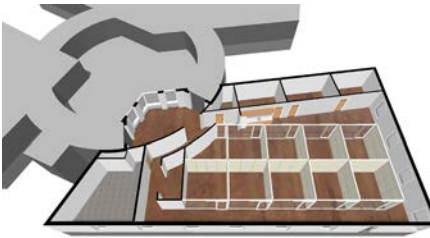

After

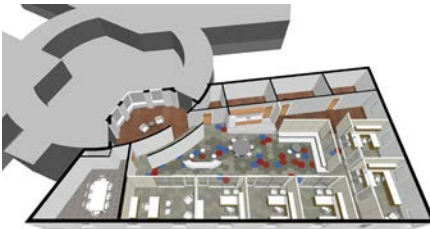

In 2021 **VRA** worked with **Associated Office Systems of Louisiana (AOS)** on an interior renovation of the Executive Offices and Collaborative communal space at the headquarters of the **Jefferson Economic Development Commission (JEDCO)** in Avondale, Louisiana.

AOS previously outfitted the JEDCO offices, for actual companies to lease, with **DIRTT** modular self-contained interior partition systems that are purported to provide complete flexibility for changing operational programs.

VRA assisted AOS in revising the floor plan of the executive and collaborative core offices away from the existing floor plan that included ten small cubicles and a conference room, to a large collaborative space, six more spacious private offices, and a conference room. The reception area retained its configuration with curved demising walls separating it from the working spaces beyond. The **new space** plan leads from Reception into a collaboration/ break area with access to the six offices.

Changes to the floor plan required relocation of power and data including relocation of junction boxes to accommodate the new layout; relocation of lighting fixtures; and extension and relocation of existing mechanical supply diffusers and return air grills. **New carpet, luxury vinyl tile and base** were installed to create an exciting environment for work and collaboration.

The finished project is a testament to the adaptability and flexibility of DIRTT interior modular systems, as no additional DIRTT components were required to change the office layout, resulting in **no additional cost** for partitions. The newly refreshed and reconfigured JEDCO executive offices and collaboration space has been praised by visitors and staff alike.



TEC Professional Services Questionnaire

PROJECT NO. 5		
Project Name, Location and Owner's contact information:	Nature of Firm's Responsibility:	
Christian Brothers School at City Park Renovation & Expansion New Orleans, Louisiana Christian Brothers School Mr. Joey Scaffidi, Principal 8 Friederichs Drive New Orleans, LA 70124 504-486-6770 jscaffidi@yahoo.com	Full A/E Services	
Completion Date (Actual or estimated):	Estimated Cost:	
	Entire Project:	Work for which Firm was Responsible:
2011 (A)	\$5,200,000	\$5,200,000



Design intent for the **15,000 square foot** expansion of Christian Brothers School, located in the **heart of New Orleans' famous City Park**, was not only to address appropriate scale, but to establish the perception of its having been there all along. **VRA's** design capitalized on and respected the **original historic mansion's** architectural character through careful attention to circulation, transition, and scale.

VRA was able to provide a **full regulation Gymnasium/ Multi-Purpose Cultural Center** within a limited construction site; City Park mandated protection and preservation of all trees on site including historic live oaks. Positioning the Cultural Center apart from the mansion, **VRA** designed a Classroom- Courtyard Addition as a transitional separation between new Cultural Center and existing mansion, visually diminishing the scale of the new construction while echoing the roof eave lines of the original structure.

The Cultural Center's interior is **simple and light**, with the stage oriented on the long side of the gym to maximize visual lines to the stage. A large curtain wall window behind the stage presents a striking **view of the Park** behind a silhouetted cruciform. Glazing in the Cultural Center was **minimized** to reduce cooling demands, and in the space, variable-controlled lighting with occupancy sensors conserve energy both during use and when unoccupied.

The new Cultural Center multi-purpose hall accommodates **physical education and sports activities** as well as assemblies, masses, theater and music presentations, the school's annual Speech Night, and graduations. Construction of the new Cultural Center and Addition, and renovation of the existing school were completed in 2011, with a final construction cost of **\$5.2 Million**.

TEC Professional Services Questionnaire

PROJECT NO. 6		
Project Name, Location and Owner's contact information: Allie Mae Williams Multi-Service Center New Orleans, Louisiana City of New Orleans Capital Projects Administration 1300 Perdido Street Suite 6E15 New Orleans, LA 70112 Mr. J. Miguel Viteri, Project Manager 504-658-8629 jmviteri@nola.gov	Nature of Firm's Responsibility: <div style="text-align: center; padding: 20px;">Full A/E Services</div>	
Completion Date (Actual or estimated):	Estimated Cost:	
2019 (A)	Entire Project: \$6,073,184 (Main Building Renovation, and HVAC Replacement and Roof Repairs at Senior Citizen Center and Edna Pilsbury Clinic)	Work for which Firm was Responsible: \$6,073,184 (Main Building Renovation, and HVAC Replacement and Roof Repairs at Senior Citizen Center and Edna Pilsbury Clinic)

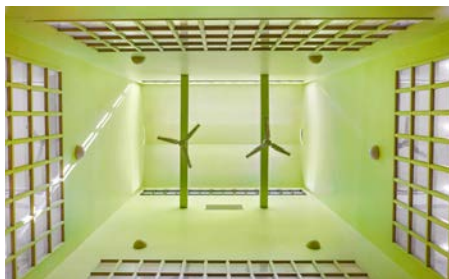

The **Allie Mae Williams Multi-Service Center** is located at 2020 Jackson Avenue in Central City. The Complex is an **important resource in a neighborhood with a long history of advocacy for disadvantaged individuals and groups**. In addition to the designated programs of child care, senior citizen care, public health services and educational opportunity training, the Complex is a hub of **political and social activity**. It provides meeting spaces for community forums and district planning meetings, provides rental space for a privately run health clinic and also provides basic public health screenings.

As a **19th century Jewish cemetery** once occupied the adjacent green space, FEMA mandated an archaeological survey to confirm or refute the presence of any relics still underground. Strict monitoring during construction prevented disturbance to the remains that were detected by the survey.



The existing **Senior Center and Edna Pilsbury Buildings** received roof repairs and replacement of HVAC systems. Renovations to the **Multi-Media Center and Daycare Administration Building** include a Head Start Nursery facility and a branch of the New Orleans Library. The renovated facility, positioned on the Jackson Avenue frontage, presents a **welcoming image** for the surrounding community, connecting visually to the existing buildings on the campus while reflecting the neighborhood's **vernacular 19th and early 20th century retail architecture**.

TEC Professional Services Questionnaire

PROJECT NO. 7		
Project Name, Location and Owner's contact information:	Nature of Firm's Responsibility:	
City of New Orleans Department of Public Works Multi-Purpose Site New Orleans, Louisiana City of New Orleans Capital Projects Administration Robert Vallejo 1300 Perdido Street, Suite 6E15 New Orleans, LA 70112 504-658-8652 rvallejo@nola.gov	Full A/E Services	
Completion Date (Actual or estimated):	Estimated Cost:	
	Entire Project:	Work for which Firm was Responsible:
2020 (A)	\$3,600,000	\$3,600,000



Construction on the **City of New Orleans Department of Public Works (DPW) Maintenance Building and Site Construction Project** included two Phases. The **first phase** was a Master Plan Development for the Department of Public Works as requested by the **Capital Projects Administration**. VRA developed several schemes for site programming. Still standing on the existing site was the massive historic Incinerator Building from the **early 1900s** that the City eventually demolished to allow new site construction. In addition to the equipment and materials used by DPW, including asphalt heating tanks, vacuum trucks, dump trucks, front-end loaders, graders, ditch-cutters, **FEMA** trailers were on the site since after Hurricane Katrina, and the site had also been used for warehouse storage for various City departments. **Extensive environmental testing** was required for several suspect areas of the site, including **storage tanks, crushed asphalt scrap piles, and concrete slabs**. Underground obstructions were also encountered during construction.

The **second phase** consisted of designing a new, **7,217 square foot** multi-purpose building with **4,475 square feet** of office space and a training room for employees. The remaining **2,700 square feet** of the area provides space for **minor vehicle services, equipment repairs, and associated equipment and storage areas**. Site development included accessory parking, a vehicle wash area, and accommodations for material storage for street repair work. Site stormwater management was a **priority**, with permeable paving and landscaping design including bioswales and native plantings to capture **24,000 gallons** of water during a 1.25-inch rain event. The project was **FEMA funded**.



TEC Professional Services Questionnaire

PROJECT NO. 8		
Project Name, Location and Owner's contact information:	Nature of Firm's Responsibility:	
CITY PUTT MINIATURE GOLF CLUB HOUSE, CITY PARK New Orleans, Louisiana City Park New Orleans Mr. Robert Becker, Executive Director (retired) 1 Palm Drive New Orleans, Louisiana 70124 504-421-3389 (mobile number, personal) 504-482-4888 (City Park office) bbecker@nocp.org	Full A/E Services	
Completion Date (Actual or estimated):	Estimated Cost:	
	Entire Project:	Work for which Firm was Responsible:
2013 (A)	\$825,000	\$825,000



VergesRome Architects was selected to design a clubhouse for the new **City Putt miniature golf courses at City Park** as sub-consultant to the Prime Consultant, Cashio Cochran, LLC. Situated on the **west side** of the new Great Lawn, across from Storyland, the new City Putt miniature golf complex is **one of** many planned improvements and unique attractions.

The program called for a conditioned, centrally located lobby for check-in and admissions, golf putters, ball inventory storage, and pickup and returns counters. **In addition**, two party rooms, situated on each side of the admissions area, provide party room rental space with a dedicated ice cube maker/bin in each. Restrooms and storage space to complete the program.

The **3,000 SF** building has a standing-seam metal roof; **the custom color-matched aluminum** storefront supports ample glazing, offering expansive views out over the deck space to the mini-golf courses beyond. Decks and footbridges connect the **Club House** to the two locally-themed miniature golf courses with water features that wind throughout the site. The decks leading to the golf courses provide ample seating for patrons and access to the restrooms.

The facility, built at a cost of **\$825,588**, is a combination of **structural steel and metal stud frame construction** with cement-board siding. Exposed steel framing in the interior of the Lobby lend a rustic look, and the colors are neutrals.



TEC Professional Services Questionnaire

PROJECT NO. 9		
Project Name, Location and Owner's contact information:	Nature of Firm's Responsibility:	
City of New Orleans Municipal & Traffic Courts Temporary VA Relocation New Orleans, Louisiana City of New Orleans Capital Projects Administration Mr. Christopher Sens, Clerk of Court 727 North Broad Street New Orleans, LA 70119 504-658-8500 (temporary facility at VA) cpsens@nola.gov	Full A/E Services	
Completion Date (Actual or estimated):	Estimated Cost:	
	Entire Project:	Work for which Firm was Responsible:
First Quarter 2023 (Est.)	\$17,100,000 (Est.) Temp. VA Relocation \$4,727,416(A)	\$17,100,000 (Est.) Temp. VA Relocation \$4,727,416 (A)



As the work of the **Municipal & Traffic Courts** had to continue during a renovation requiring hazard remediation, the temporary relocation to the **Veterans Administration Hospital** was planned. The VA Hospital Building, owned by the City of New Orleans, had served from 1952 until 2005 when damage from Hurricane Katrina caused significant building infrastructure damage, flooding critical building systems. Federal funds were obligated for a replacement VA Medical Center, which eventually led to VA's donation of the VA Hospital Building to the City. Predecessor firms to **VergesRome Architects, Ernest E. Verges & Associates, and Morton Verges Architects** performed services in the 1970s and 1980s, and some of their work is still evident today.



The City's long-term plan for the VA Building is served by RFQ No. 1611, wherein it is acknowledged that the rehabilitation will require careful planning and design for construction phases. The buildout of **first-floor spaces** to accommodate the Municipal & Traffic Courts is an early step in approaching the long-term goal. The process led to more excellent knowledge about the building's existing conditions and program challenges ahead.

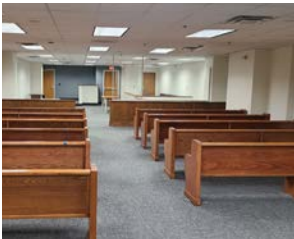

The buildout for the temporary **Court facility** is now in the Close-out, Punch List Phase. In the first floor former clinic space, **VergesRome Architects** captured four courtrooms and administrative, clerk of court, and public areas while providing for building and workers' security. Because cost control was critical for this phase, the building was altered no more than essential. **Current construction cost is \$3,868,832.**

One discovery made during the buildout for the Courts was the severe deficiencies in the **Fire Protection systems** at the building. Fire and Smoke Detectors on the first floor are not **fully functional**. Even though the court would only occupy the first floor, the State Fire Marshal required that Fire Alarm Panels on every floor be **monitored**. As the upper floors are not observed, the State Fire Marshal needed a Fire Watch - Fire Department personnel on-site whenever it is occupied.

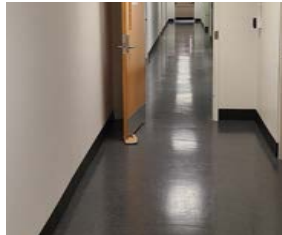

Infrastructure is the priority for the VA Building renovation. From Mechanical, Electrical and Plumbing, Security, Elevators to Fire Alarm and Fire Sprinkler systems, complete rebuilds from scratch are needed. The feasibility of flood mitigation measures might also be investigated.

TEC Professional Services Questionnaire**PROJECT NO. 10**

Project Name, Location and Owner's contact information:	Nature of Firm's Responsibility:	
Orleans Parish Communication District (OPCD) Programming & Schematic Design for Public Safety Campus New Orleans, Louisiana Orleans Parish Communications District (OPCD) Tyrell Morris 118 City Park Avenue New Orleans, LA 70119 504-671-3911 tmorris@911nola.org	Full A/E Services	
Completion Date (Actual or estimated):	Estimated Cost:	
	Entire Project:	Work for which Firm was Responsible:
On Hold	\$25,000,000 (Est.)	\$25,000,000 (Est.)



VergesRome Architects was selected to handle the expansion of **Orleans Parish Communication District (OPCD) 911 Center Schematic Design**. The project was created to operate a more extensive 911/311 emergency facility, to have a more prominent call center floor working **24 hours a day and 7 days a week**, and transfer calls to the Police Department, Fire Department, and EMS. Additionally, the idea was to create a new wing to **accommodate** employees from City Hall and from OPCD with a sleeping and eating station in case of an emergency.

Although it was a promising project with a cost estimate of **\$25,000,000** for the 911 center, as of June 2022, it is on hold indefinitely.

Proposed measures include:

- Fully automated perimeter security upgrades of existing OPCD property
- Revised site to resolve ease of circulation and parking
- On-site amenities to support employee well-being and retention
- Relocated entry and loading facilities
- Training & Testing centers to support applicant load & meeting flexibility
- Unification of certified employees improves cross training & career growth
- Child care facility for OPCD employees, NOPD, NOFD, & EMS
- Improved bunking and dining facilities to be utilized during activation
- Expanded facility storage to accommodate daily & emergency supplies
- State-of-the-art, redundant technology and work spaces
- Storage of occasionally dispatched emergency vehicles
- Deployment of existing generator power for facility growth and redundancy



TEC Professional Services Questionnaire

M. List all prior and/or on-going litigation between Firm and Jefferson Parish. Please attach additional pages if necessary.

Parties:		Status/Result of Case:
Plaintiff:	Defendant:	
1.		
2.		
3.	VergesRome Architects has no prior and/or on-going litigation between firm and Jefferson Parish.	
4.		

N. Use this space to provide any additional information or description of resources supporting Firm's qualifications for the proposed project.

VergesRome Architects proacts on project staffing, updating its staffing needs on a **weekly** basis. VRA has earned its positive reputation for meeting project schedules and budgets. Please see the attached sheets showing the current workload of VRA's proposed team for Jefferson Parish projects.

The wide variety of work VRA has delivered over **59 years of service** to this region is testament to its versatility and commitment. Selected projects shown in Section "L" of this Statement of Qualifications demonstrate the range of **project type, magnitude, complexity and creativity**.

VergesRome is fortunate to include, among its professional staff, specialists on building **waterproofing, roof systems and materials, and the design and construction of parking structures**. The firm is also proud of its successful collaborations with other specialists in the construction industry.

VRA assists its clients by being **well-versed** in Public Bid Law, FEMA compliance, Historic Tax Credits, and working with other governmental and private sources to meet their specific requirements. VRA recently **completed** a multi-family housing development in Lockport, LA, employing **new resilient design and construction standards that enabled it to withstand a direct hit from Hurricane Ida with minimal damage** (less than \$10,000 damage on a \$7 Million development.) VergesRome Architects is committed to finding the best solutions for each design assignment, readily accepts new challenges, and steps up to meet them.

O. To the best of my knowledge, the foregoing is an accurate statement of facts.

Signature:  Print Name: Ernest E. Verges, II

Title: President Date: 06/10/2022

N. Use this space to provide any additional information or description of resources supporting Firm's qualifications for the proposed project.

The current workload of the proposed Project Team is presented below. Intervals are calendar months.

Color Key is at bottom of page.

CURRENT WORKLOAD	2022							2023									
	06	07	08	09	10	11	12	1	2	3	4	5	6	7	8	9	10
ERNEST "CHIP" VERGES, II, AIA, PRINCIPAL IN CHARGE																	
Heirloom Properties 739 Convention Center Blvd. Hotel																	
Archdiocese of N.O. Hurricane Ida Repairs, St. Augustine Church																	
Archdiocese of N.O. Hurricane Ida Repairs, St. Christopher School																	
Archdiocese of N.O. Hurricane Ida Repairs, St. Louis King of France Sch.																	
STEVEN H. ROME, AIA, DIRECTOR OF DESIGN																	
Holy Trinity Academy Master Plan																	
Croatian-American Society Community Center																	
Saint Joseph Seminary College, Benet Hall and Savio Hall Renovations																	
Union Passenger Terminal Central Plant Upgrades																	
Municipal & Traffic Court of New Orleans Renovations																	
Terrebonne Parish School District Hurricane Ida Repairs																	
RICHARD W. FENNER, AIA, SPECIFICATIONS/ QUALITY ASSURANCE																	
Municipal & Traffic Court of New Orleans Renovations																	
Terrebonne Parish School District Hurricane Ida Repairs																	
JPPSS Cherbonnier -Rillieux Elementary School Hurricane Ida Repairs																	
Archdiocese of N.O. Hurricane Ida Repairs, St. Augustine Church																	
Municipal & Traffic Court Renovations and VA Temporary Court Facility																	
MICHAEL ROUSSEL, AIA, PROJECT MANAGER																	
Croatian-American Society Community Center																	
STPSB Little Oak Middle School Classroom Wing																	
STPSB Little Oak Middle School Admin Offices Renovation																	
Holy Trinity Academy Master Plan																	

DESIGN ■ BID ■ CONSTRUCTION ■

The current workload of the proposed Project Team is presented below. Intervals are calendar months.
Color Key is at bottom of page.

CURRENT WORKLOAD	2022							2023									
	06	07	08	09	10	11	12	1	2	3	4	5	6	7	8	9	10
COREY BRIZZOLARA, LEED AP BD+C, ARCHITECTURAL DESIGN & PRODUCTION																	
Heirloom Properties 739 Convention Center Blvd. Hotel																	
Lakeside Shopping Center Ongoing Services to Client: Space Plans/ Lease Plans/ Permitting																	
Lakeside Shopping Center Veterans Blvd. Entrance Renovation																	
Resource Bank New Branch																	
Heirloom Properties O. C. Haley Hotel																	
Housing Authority New Orleans HQ Site Selection (Study Phase Only)																	
RUSS HOGAN, ARCHITECTURAL PRODUCTION																	
Heirloom Properties 739 Convention Center Blvd. Hotel																	
InclusivCare Day Care, Lapalco Facility																	
LANETTE SAVOY, INTERIOR DESIGNER																	
Resource Bank New Retail Facility																	
STPSB Little Oak Middle School Classroom Wing																	
Croatian-American Society Community Center																	
Houma, LA Residential Renovation - Furniture Procurement																	
Saint Joseph Seminary College, Benet Hall and Savio Hall Renovations																	
Covington Residential Renovation Furniture Selection/ Procurement																	
Mandeville Residential Renovation Finishes Selection																	
HAROLD MONTREUIL, JR. - CONSTRUCTION ADMINISTRATION																	
STPSB Little Oak Middle School Classroom Wing																	
Saint Joseph Seminary College, Benet Hall and Savio Hall Renovations																	

VergesRome Architects reviews Project statuses on a weekly basis, with the involvement of all Partner Project Managers.

This ongoing attention to current job status allows (1) project issues to be identified for resolution; (2) staffing adjustments to meet critical milestones or deadlines on specific projects; and (3) compliance with project schedules for all work.

DESIGN  BID  CONSTRUCTION 

Statement of Qualifications

AFFIDAVIT

STATE OF Louisiana

PARISH/COUNTY OF Orleans

BEFORE ME, the undersigned authority, personally came and appeared: _____

Ernest E. Verges, II, (Affiant) who after being by me duly sworn, deposed and said that he/she is the fully authorized President of VergesRome Architects, APAC (Entity), the party who submitted a Statement of Qualifications (SOQ) to SOQ 22-026 - Professional Architectural and Engineering Services for Architectural Type Projects (Briefly describe the services the SOQ will cover), to the Parish of Jefferson.

Affiant further said:

Campaign Contribution Disclosures

(Choose A or B, if option A is indicated please include the required attachment):

Choice A _____ Attached hereto is a list of all campaign contributions, including the date and amount of each contribution, made to current or former elected officials of the Parish of Jefferson by Entity, Affiant, and/or officers, directors and owners, including employees, owning 25% or more of the Entity during the two-year period immediately preceding the date of this affidavit or the current term of the elected official, whichever is greater. Further, Entity, Affiant, and/or Entity Owners have not made any contributions to or in support of current or former members of the Jefferson Parish Council or the Jefferson Parish President through or in the name of another person or legal entity, either directly or indirectly.

Choice B X there are **NO** campaign contributions made which would require disclosure under Choice A of this section.

Affiant further said:

Debt Disclosures

(Choose A or B, if option A is indicated please include the required attachment):

Choice A _____ Attached hereto is a list of all debts owed by the affiant to any elected or appointed official of the Parish of Jefferson, and any and all debts owed by any elected or appointed official of the Parish to the Affiant.

Choice B X There are **NO** debts which would require disclosure under Choice A of this section.

Affiant further said:

Solicitation of Campaign Contribution Disclosures

(Choose A or B, if option A is indicated please include the required attachment):

Choice A _____ Attached hereto is a list of all elected officials of the Parish of Jefferson, whether still holding office at the time of the affidavit or not, where the elected official, individually, either by **telephone or by personal contact**, solicited a campaign contribution or other monetary consideration from the Entity, including the Entity's officers, directors and owners, and employees owning twenty-five percent (25%) or more of the Entity, during the two-year period immediately preceding the date the affidavit is signed. Further, to the extent known to the Affiant, the date of any such solicitation is included on the attached list.

Choice B X there are **NO** solicitations for campaign contributions which would require disclosure under Choice A of this section.

Affiant further said:

Subcontractor Disclosures

(Choose A or B, if option A is indicated please include the required attachment):

Choice A X Affiant further said that attached is a listing of all subcontractors, excluding full time employees, who may assist in providing professional services for the aforementioned SOQ.

Choice B There are **NO** subcontractors which would require disclosure under Choice A of this section.

Affiant further said:

That Affiant has employed no person, corporation, firm, association, or other organization, either directly or indirectly, to secure the public contract under which he received payment, other than persons regularly employed by the Affiant whose services in connection with the construction, alteration or demolition of the public building or project or in securing the public contract were in the regular course of their duties for Affiant; and

[The remainder of this page is intentionally left blank.]

That no part of the contract price received by Affiant was paid or will be paid to any person, corporation, firm, association, or other organization for soliciting the contract, other than the payment of their normal compensation to persons regularly employed by the Affiant whose services in connection with the construction, alteration or demolition of the public building or project were in the regular course of their duties for Affiant.



Signature of Affiant

Ernest E. Verges, II

Printed Name of Affiant

SWORN AND SUBSCRIBED TO BEFORE ME

ON THE 9th DAY OF June, 2022.

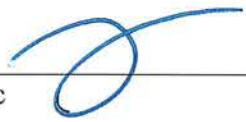

Notary Public
TRINITY M. BERGERON

Printed Name of Notary Public
LA NOTARY PUBLIC ID #85785
Statewide Jurisdiction
Commissioned for Life

Notary/Bar Roll Number



My commission expires _____.

VergesRome Architects
a professional architectural corporation



320 N. Carrollton Avenue, Suite 100, New Orleans, Louisiana 70119
VergesRome.com t. 504.488.7739 f. 504.488.7743

Subcontractor Disclosures (Affidavit Attachment)

SOQ 22-026

Professional Architectural and Engineering Services for Architectural Type Projects

Subcontractors:

Morphy Makofsky, Inc. – Structural Engineer

Lucien T. Vivien Jr. & Associates – Mechanical Engineer

Drake Engineering – Electrical Engineering

Ernest E. (Chip) Verges, II, AIA
Steven H. Rome, AIA

Ernest E. Verges, AIA-E

Richard W. Fenner, AIA
David Glen Reed, AIA
Michael J. Roussel, AIA
Stephanie A. Calamari, AIA
Michael Zaloudek, AIA

State of Louisiana

Board of Architectural Examiners

The firm whose name appears on this certificate is in compliance with the provisions of the Louisiana State Board of Architectural Examiners' Licensing Law and Rules and Regulations and is duly registered and entitled to practice architecture in the State of Louisiana.

CERTIFICATE OF AUTHORITY NO. AC0440

EXPIRES June 30, 2023

Verges Rome Architects, A Professional Architectural Corporation, APAC

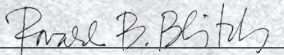
President

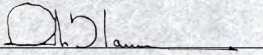
Secretary

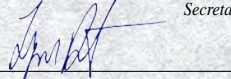
Executive Director



June 9, 2022
Date

\$75.00
Fee Paid

(ALL CERTIFICATES BECOME DELINQUENT AFTER EXPIRATION DATE)

State of Louisiana Board of Architectural Examiners



Registration No. AC0440

Expires June 30, 2023

Verges Rome Architects, A Professional Architectural Corporation, APAC

The above named is duly registered and entitled to practice Architecture in the state of Louisiana until the indicated expiration date.

Executive Director

TEC Questionnaire - Consultants

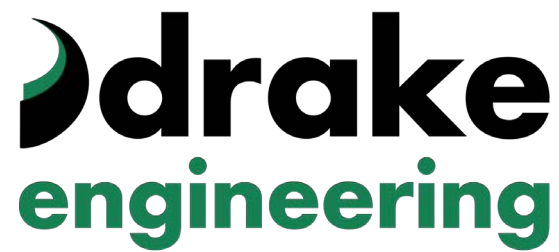

TEC Professional Services Questionnaire

A. Project Name and Advertisement Resolution Number:

SOQ - 22-026: Professional Architectural and Engineering Services for Architectural Type Projects - Resolution: 139630

B. Firm Name & Address:

Drake Engineering, LLC
2783 Lapalco Blvd
Harvey, LA 70058

C. Name, title and contact information of Principal, as defined in Section 2-926 of the Jefferson Parish Code of Ordinances, who is a registered, licensed architect, professional engineer, or surveyor in the State of Louisiana:

Ryan C. Orgeron, P.E.
Managing Principal
ryan@drakeeng.com.com
504-875-2121

D. Name and contact information of employee who is a registered and licensed architect, professional engineer, or surveyor in the State of Louisiana in the applicable discipline. A subcontractor may be substituted here only if the advertised Project requires more than one discipline.

N/A

E. Please provide the number of employees whose primary function corresponds with each category:

<u>1</u> Administrative	<u> </u> Estimators	<u> </u> Specification Writers
<u> </u> Architects (Licensed)	<u> </u> Geologists	<u> </u> Structural Engineers
<u> </u> Chemical Engineers	<u> </u> Geotechnical Engineers	<u> </u> Graduate Engineers
<u> </u> Civil Engineers	<u> </u> Interior Designers	<u>2</u> Project Managers
<u> </u> Construction Inspectors	<u> </u> Landscape Architects	<u> </u> Clerical
<u> </u> Ecologists	<u> </u> Land Surveyor	<u> </u> Grant/Funding Specialist
<u>1</u> Electrical Engineers	<u> </u> Mechanical Engineers	<u> </u> Sanitary Engineers
<u>2</u> Engineer Intern	<u> </u> Environmental Engineers	
<u> </u> Professional Land Surveyors		<u> </u> TOTAL

F. Is this submittal by a JOINT-VENTURE? Please check: YES ☐ NO ☒

If marked "No" skip to Section I. If marked "yes" complete Sections G-H.

TEC Professional Services Questionnaire

G. If submittal is by JOINT-VENTURE, list the firms participating and outline specific areas of responsibility (including administrative, technical, and financial) for each firm. Please attach additional pages if necessary.

1.

N/A

2.

N/A

H. Has this JOINT-VENTURE previously worked together? Please check:

YES ☐ NO ☐

I. List all subcontractors anticipated for this Project. Please note that all subcontractors must submit a fully completed copy of this questionnaire, applicable licenses, and any other information required by the advertisement. See Jefferson Parish Code of Ordinances, Sec. 2-928(a)(3). Please attach additional pages if necessary.

Name & Address:	Specialty:	Worked with Firm Before (Yes or No):
1. N/A		
2. N/A		
3. N/A		

J. Please specify the total number of support personnel that may assist in the completion of this Project:

6 _____

TEC Professional Services Questionnaire

K. List the professional in charge, key persons, specialists, and individual consultants anticipated for this Project and provide their relevant information below. If necessary, please attach additional documentation (i.e. resume) that demonstrates the employment history and experience of the Firm's key persons that may assist in the completion of this Project. Please attach additional pages if necessary.

PROFESSIONAL IN CHARGE OF PROJECT:

Name & Title:

Ryan C. Orgeron, P.E.
Managing Principal
Ryan@drakeeng.com
504-875-2121

Project Assignment:

Ryan will serve as the lead electrical engineer for the project. He will be responsible for designing the power, lighting, fire alarm, intercom, computer, telephone, security, CCTV, clock, and emergency systems on the project. He will be in charge of seamlessly integrating these systems.

Name of Firm with which associated:

Drake Engineering, LLC

Years' experience with this Firm:

21 years

Education: Degree(s)/Year/Specialization:

B.S. Electrical Engineering, 1996

Active registration: Year first registered/discipline:

Licensed Electrical Engineer: Louisiana, Mississippi, Texas, North Carolina, Alabama, & Florida
Licensed Electrical Contractor: Louisiana & Mississippi

Other experience and qualifications relevant to the proposed Project:

Ryan is a licensed professional engineer in the states of Louisiana, Mississippi, and Texas. In addition to his engineering credentials, he is a licensed electrician. His extensive experience in the field brings a practical edge to his designs.

TEC Professional Services Questionnaire

KEY PERSON, SPECIALIST, OR INDIVIDUAL CONSULTANT:

Name & Title:

Mark Kattengell
Senior Project Manager

Project Assignment:

As the lead project manager for the electrical engineering design, Mark will be responsible for designing the power, lighting, fire alarm, and emergency systems on the project.

Name of Firm with which associated:

Drake Engineering, LLC

Years' experience with this Firm:

17 years

Education: Degree(s)/Year/Specialization:

Associate of Science in Electrical Electronics Engineering Technology 2011

Active registration: Year first registered/discipline:**Other experience and qualifications relevant to the proposed Project:**

Mark has over 15 years of electrical design experience with Drake Engineering. He has been responsible for the design of electrical systems in a vast array of commercial and light industrial facilities. Mark is involved in all aspects of the design process, from conceptual development through system commissioning, to ensure the project's overall success.

TEC Professional Services Questionnaire

KEY PERSON, SPECIALIST, OR INDIVIDUAL CONSULTANT:
Name & Title:
John Washington Project Manager
Project Assignment:
Project Manager/Electrical Designer/BIM Coordinator
Name of Firm with which associated:
Drake Engineering, LLC
Years' experience with this Firm:
11 years
Education: Degree(s)/Year/Specialization:
Associate of Applied Science/and Certificate of Technical Studies. Delgado Community College, 2012
Active registration: Year first registered/discipline:
Other experience and qualifications relevant to the proposed Project:
Project manager proficient in all aspects of electrical designs for commercial buildings. Proficient in developing electrical load study, lighting calculations, one line schematics, lighting and power layouts in AutoCAD and Revit MEP, and coordinate the project from design schematic through construction completion.

TEC Professional Services Questionnaire

L. Work by Firm or Joint-Venture members which best illustrates current qualifications relevant to this Project. Please include any and all work performed for Jefferson Parish. Please attach additional pages if necessary.

PROJECT NO. 1

Project Name, Location and Owner's contact information:	Nature of Firm's Responsibility:	
Plaquemines Parish Faculty Housing Buras and Port Sulphur, Louisiana Plaquemines Parish School Board 117 Jarrell Drive Belle Chasse, LA 70037 Chris Barker 504-392-313	Electrical Engineering	
Completion Date (Actual or estimated):	Estimated Cost:	
	Entire Project:	Work for which Firm was Responsible:
2012	\$9,400,000.00	\$1,400,000.00

PROJECT NO. 2

Project Name, Location and Owner's contact information:	Nature of Firm's Responsibility:	
4848 Veterans Memorial Blvd Metairie, LA 70001 4848 Veterans Memorial Blvd Development Covington, LA 70433 Mr. Louis Roussel III 504-837-2230	Electrical engineering	
Completion Date (Actual or estimated):	Estimated Cost:	
	Entire Project:	Work for which Firm was Responsible:
2012	\$5,100,000.00	\$850,000.00

TEC Professional Services Questionnaire

PROJECT NO. 3		
Project Name, Location and Owner's contact information:	Nature of Firm's Responsibility	
Mid-City Market New Orleans, LA Stirling Properties 109 Northpark Blvd, Ste 300 Covington, LA 70433 Mr. Mark Salvetti 985-8898-2022	Electrical Engineering	
Completion Date (Actual or estimated)	Estimated Cost:	
	Entire Project:	Work for which Firm was Responsible:
2013	\$13,800,000.00	\$2,280,000.00

PROJECT NO. 4		
Project Name, Location and Owner's contact information:	Nature of Firm's Responsibility:	
Gretna No. 2 Academy	Electrical Engineering	
Completion Date (Actual or estimated):	Estimated Cost:	
	Entire Project:	Work for which Firm was Responsible:
	\$1,000,000.00 Estimated	\$200,000.00

TEC Professional Services Questionnaire

PROJECT NO. 5		
Project Name, Location and Owner's contact information:	Nature of Firm's Responsibility:	
Ella Dolhonde School General Renovations	Electrical Engineering	
Completion Date (Actual or estimated):	Estimated Cost:	
	Entire Project:	Work for which Firm was Responsible:
2011	\$600,000.00 Estimated	\$150,000.00 Estimated

PROJECT NO. 6		
Project Name, Location and Owner's contact information:	Nature of Firm's Responsibility:	
WB Regional Library Equipment Upgrade	Electrical Engineering	
Completion Date (Actual or estimated):	Estimated Cost:	
	Entire Project:	Work for which Firm was Responsible:
2008	\$200,000.00 Estimated	\$50,000.00 Estimated

TEC Professional Services Questionnaire

PROJECT NO. 7		
Project Name, Location and Owner's contact information:	Nature of Firm's Responsibility:	
Belle Terre Library Renovations	Electrical Engineering	
Completion Date (Actual or estimated):	Estimated Cost:	
	Entire Project:	Work for which Firm was Responsible:
2008	\$500,000.00 Estimated	\$50,000.00 Estimated

PROJECT NO. 8		
Project Name, Location and Owner's contact information:	Nature of Firm's Responsibility:	
Fire Station No. 15	Electrical Engineering	
Completion Date (Actual or estimated):	Estimated Cost:	
	Entire Project:	Work for which Firm was Responsible:
2006	\$2,500,000.00 Estimated	\$200,000.00 Estimated

TEC Professional Services Questionnaire

PROJECT NO. 9		
Project Name, Location and Owner's contact information:	Nature of Firm's Responsibility:	
Fire Station No. 10	Electrical Engineering	
Completion Date (Actual or estimated):	Estimated Cost:	
	Entire Project:	Work for which Firm was Responsible:
2011	\$3,500,000.00 Estimated	\$300,000.00 Estimated

PROJECT NO. 10		
Project Name, Location and Owner's contact information:	Nature of Firm's Responsibility:	
Ella Dolhonde Elementary School Cafeteria Renovation	Electrical Engineering	
Completion Date (Actual or estimated):	Estimated Cost:	
	Entire Project:	Work for which Firm was Responsible:
2009	\$500,000.00 Estimated	\$100,000.00 Estimated

TEC Professional Services Questionnaire

M. List all prior and/or on-going litigation between Firm and Jefferson Parish. Please attach additional pages if necessary.

Parties:		Status/Result of Case:
Plaintiff:	Defendant:	
1. N/A		
2. N/A		
3. N/A		
4. N/A		

N. Use this space to provide any additional information or description of resources supporting Firm's qualifications for the proposed project.

N/A

O. To the best of my knowledge, the foregoing is an accurate statement of facts.

Signature:  **Print Name:** Ryan C. Orgeron
Title: Managing Principal **Date:** 06/10/2022

Statement of Qualifications

AFFIDAVIT

STATE OF Louisiana

PARISH/COUNTY OF Jefferson

BEFORE ME, the undersigned authority, personally came and appeared: Ryan C. Orgeron
_____, (Affiant) who after being by me duly sworn, deposed and said that
he/she is the fully authorized Managing Principal of Drake Engineering (Entity),
the party who submitted a Statement of Qualifications (SOQ) to Provide professional architectural
and engineering services on an as needed basis _____ (Briefly describe the services the SOQ
will cover), to the Parish of Jefferson.

Affiant further said:

Campaign Contribution Disclosures

(Choose A or B, if option A is indicated please include the required attachment):

Choice A _____ Attached hereto is a list of all campaign contributions, including the date and amount of each contribution, made to current or former elected officials of the Parish of Jefferson by Entity, Affiant, and/or officers, directors and owners, including employees, owning 25% or more of the Entity during the two-year period immediately preceding the date of this affidavit or the current term of the elected official, whichever is greater. Further, Entity, Affiant, and/or Entity Owners have not made any contributions to or in support of current or former members of the Jefferson Parish Council or the Jefferson Parish President through or in the name of another person or legal entity, either directly or indirectly.

Choice B x there are **NO** campaign contributions made which would require disclosure under Choice A of this section.

Affiant further said:

Debt Disclosures

(Choose A or B, if option A is indicated please include the required attachment):

Choice A _____ Attached hereto is a list of all debts owed by the affiant to any elected or appointed official of the Parish of Jefferson, and any and all debts owed by any elected or appointed official of the Parish to the Affiant.

Choice B x There are **NO** debts which would require disclosure under Choice A of this section.

Affiant further said:

Solicitation of Campaign Contribution Disclosures

(Choose A or B, if option A is indicated please include the required attachment):

Choice A _____ Attached hereto is a list of all elected officials of the Parish of Jefferson, whether still holding office at the time of the affidavit or not, where the elected official, individually, either by **telephone or by personal contact**, solicited a campaign contribution or other monetary consideration from the Entity, including the Entity's officers, directors and owners, and employees owning twenty-five percent (25%) or more of the Entity, during the two-year period immediately preceding the date the affidavit is signed. Further, to the extent known to the Affiant, the date of any such solicitation is included on the attached list.

Choice B x there are **NO** solicitations for campaign contributions which would require disclosure under Choice A of this section.

Affiant further said:

Subcontractor Disclosures

(Choose A or B, if option A is indicated please include the required attachment):

Choice A _____ Affiant further said that attached is a listing of all subcontractors, excluding full time employees, who may assist in providing professional services for the aforementioned SOQ.

Choice B x There are **NO** subcontractors which would require disclosure under Choice A of this section.

Affiant further said:

That Affiant has employed no person, corporation, firm, association, or other organization, either directly or indirectly, to secure the public contract under which he received payment, other than persons regularly employed by the Affiant whose services in connection with the construction, alteration or demolition of the public building or project or in securing the public contract were in the regular course of their duties for Affiant; and

[The remainder of this page is intentionally left blank.]

That no part of the contract price received by Affiant was paid or will be paid to any person, corporation, firm, association, or other organization for soliciting the contract, other than the payment of their normal compensation to persons regularly employed by the Affiant whose services in connection with the construction, alteration or demolition of the public building or project were in the regular course of their duties for Affiant.



Signature of Affiant

Ryan C. Orgeron

Printed Name of Affiant

SWORN AND SUBSCRIBED TO BEFORE ME

ON THE 9 DAY OF June, 2022

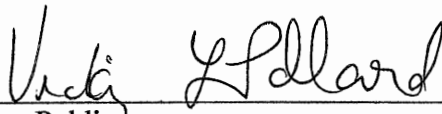

Notary Public

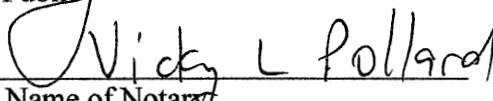

Printed Name of Notary

24606

Notary/Bar Roll Number

My commission expires Dec 4th.



VICKY L. POLLARD
ATTORNEY NOTARY
LBN 24606
STATE OF LOUISIANA
LIFETIME COMMISSION

Louisiana Professional Engineering and Land Surveying Board

Hereby Certifies that

Drake Engineering LLC

*has complied with the regulations of this Board and is authorized to
provide or to offer to provide Engineering services in the State of
Louisiana contingent upon payment of the annual renewal fee.*

Baton Rouge, Louisiana · November 06, 2001



Frank J. Messinger
Chairman
Charles W. Gyle
Secretary

License Number 2732

Louisiana Professional Engineering and Land Surveying Board

Hereby Certifies that
Ryan Carl Orgeron

*having qualified before this Board in accordance with law, is licensed as a
Professional Engineer and, contingent upon payment of the license fee provided
by law, is hereby entitled to practice in the State of Louisiana the profession of*

Electrical Engineering
Baton Rouge · January 23, 2001



Jerry S. Lyle Chairman
Lois L. Murrin Secretary

License Number 29405

TEC Questionnaire - Consultants

LUCIEN T. VIVIEN, JR. & ASSOCIATES INC.

TEC Professional Services Questionnaire**A. Project Name and Advertisement Resolution Number:**

Professional Architectural and Engineering Services for Architectural Type Projects
Resolution No. 139630

B. Firm Name & Address:

Lucien T. Vivien Jr. & Associates, Inc.
3001 22nd Street
Metairie, La 70002

C. Name, title and contact information of Principal, as defined in Section 2-926 of the Jefferson Parish Code of Ordinances, who is a registered, licensed architect, professional engineer, or surveyor in the State of Louisiana:

Karen Vivien, President
kvivien@vivienengineers.com
504-218-5409

D. Name and contact information of employee who is a registered and licensed architect, professional engineer, or surveyor in the State of Louisiana in the applicable discipline. A subcontractor may be substituted here only if the advertised Project requires more than one discipline.

Karen Vivien, President
kvivien@vivienengineers.com
504-218-5409

E. Please provide the number of employees whose primary function corresponds with each category:

<u>2</u> Administrative	<u> </u> Estimators	<u> </u> Specification Writers
<u> </u> Architects (Licensed)	<u> </u> Geologists	<u> </u> Structural Engineers
<u> </u> Chemical Engineers	<u> </u> Geotechnical Engineers	<u>1</u> Graduate Engineers
<u> </u> Civil Engineers	<u> </u> Interior Designers	<u> </u> Project Managers
<u>1</u> Construction Inspectors	<u> </u> Landscape Architects	<u> </u> Clerical
<u> </u> Ecologists	<u> </u> Land Surveyor	<u> </u> Grant/Funding Specialist
<u>1</u> Electrical Engineers	<u>2</u> Mechanical Engineers	<u> </u> Sanitary Engineers
<u>1</u> Engineer Intern	<u> </u> Environmental Engineers	
<u> </u> Professional Land Surveyors		<u>8</u> TOTAL

F. Is this submittal by a JOINT-VENTURE? Please check: YES ☐ NO ☒

If marked "No" skip to Section I. If marked "yes" complete Sections G-H.

TEC Professional Services Questionnaire

G. If submittal is by JOINT-VENTURE, list the firms participating and outline specific areas of responsibility (including administrative, technical, and financial) for each firm. Please attach additional pages if necessary.

1.

N/A

2.

N/A

H. Has this JOINT-VENTURE previously worked together? Please check:

YES ☐ NO ☐

I. List all subcontractors anticipated for this Project. Please note that all subcontractors must submit a fully completed copy of this questionnaire, applicable licenses, and any other information required by the advertisement. See Jefferson Parish Code of Ordinances, Sec. 2-928(a)(3). Please attach additional pages if necessary.

Name & Address:	Specialty:	Worked with Firm Before (Yes or No):
1. N/A		
2. N/A		
3. N/A		

J. Please specify the total number of support personnel that may assist in the completion of this Project:

3 _____

TEC Professional Services Questionnaire

K. List the professional in charge, key persons, specialists, and individual consultants anticipated for this Project and provide their relevant information below. If necessary, please attach additional documentation (i.e. resume) that demonstrates the employment history and experience of the Firm's key persons that may assist in the completion of this Project. Please attach additional pages if necessary.

PROFESSIONAL IN CHARGE OF PROJECT:**Name & Title:**

Karen E. Vivien, President

Project Assignment:

Electrical Engineer

Name of Firm with which associated:

Lucien T. Vivien, Jr. and Associates, Inc.

Years' experience with this Firm:

37

Education: Degree(s)/Year/Specialization:

BS/1999/ Electrical Engineering
BS/1990/Accounting

Active registration: Year first registered/discipline:

2000 EE LA19146

Other experience and qualifications relevant to the proposed Project:

Karen Vivien has over 30 years experience in the engineering and construction industry in a broad range of industry segments. Karen has experience in project development and project delivery and is responsible for the firm's day to day operations. She is also responsible for the coordination and design of electrical systems for projects including interior and exterior lighting systems, site and building power distribution, fire alarm systems, telecommunication systems, fiber-optic backbone system, telephone and data cabling distribution, emergency power distribution, emergency generator systems, primary/ secondary site electrical services, lighting fiber-optic systems, medical/laboratory equipment power design, kitchen equipment power design, commercial computer electrical design, intercom/paging systems, security systems, nurse call systems and hurricane modifications and renovations.

Relevant Experience: Meisler Middle School, Jefferson Parish Law Enforcement District One, Jefferson Parish Fire Station 16, Jefferson Parish Fire Station 19, Jefferson Parish East Bank Consolidated Fire Fleet Maintenance Facility, New Orleans Sewage and Water Board, Delgado Maritime Training Facility, Inclusive Care Healthcare Facility, LSU Tiger Exhibit, New Lakeshore Library, Rosa Keller Library, Northshore Technical Community College. .

TEC Professional Services Questionnaire

KEY PERSON, SPECIALIST, OR INDIVIDUAL CONSULTANT:
Name & Title:
David E. Vivien, PE; Vice President
Project Assignment:
Mechanical Engineer
Name of Firm with which associated:
Lucien T. Vivien Jr. & Associates, Inc
Years' experience with this Firm:
26
Education: Degree(s)/Year/Specialization:
BS /2008/Mechanical Engineering BBA/1992/Business Management
Active registration: Year first registered/discipline:
2011 Mechanical Engineer 3683
Other experience and qualifications relevant to the proposed Project:
<p>David Vivien is responsible for total coordination and design of mechanical systems including plumbing, HVAC and fire protection. His design experience includes office buildings, hospitals, schools, multi-purpose centers, mechanical plants, military installations, hotels, casinos, libraries, laboratories, kitchens, gymnasiums, site utilities, and Hurricane Katrina modifications and renovations, water systems, underground polyethylene gas distribution systems, and laboratory exhaust systems. Fire Protection Systems include automatic sprinkler systems, and deluge sprinkler systems.</p> <p>Relevant Experience: Meisler Middle School, Jefferson Parish Law Enforcement District One, Jefferson Parish Fire Stations 16, 17, & 19, Jefferson Parish East Bank Consolidated Fire Fleet Maintenance Facility, Inclusive Care Healthcare Facility, New Orleans Sewage and Water Board, New Orleans First District Station, NOAB Concourse A, New Lakeshore Library, STEM Center Campus Northshore Technical Community College</p>

TEC Professional Services Questionnaire

KEY PERSON, SPECIALIST, OR INDIVIDUAL CONSULTANT:
Name & Title:
Lucien E. Vivien, PE; Mechanical and Electrical Engineer
Project Assignment:
Mechanical and Electrical Engineer
Name of Firm with which associated:
Lucien T. Vivien Jr., & Associates
Years' experience with this Firm:
57
Education: Degree(s)/Year/Specialization:
Tulane University, New Orleans, LA BS/ 1961, ME
Active registration: Year first registered/discipline:
1961 Mech Engineer/1975 Elec Engineer/LA No. E7955
Other experience and qualifications relevant to the proposed Project:
<p>Gene Vivien is responsible for the total project design and coordination of both the mechanical and electrical engineering for all projects produced by the firm. Experiences include the HVAC systems, plumbing systems, energy management surveys and system applications, fire protection systems, electrical distribution systems, lighting systems, telecommunication systems, energy audits as well as the following: HVAC Systems - single zone systems, fan coil systems, fan powered variable air volume systems, reheat variable air volume systems, packaged terminal air conditioned systems, operating room laminar flow systems, 4-pipe hydronic systems, high temperature hot water systems, variable frequency drive systems, dust collection systems, carbon monoxide exhaust systems, computer room systems, smoke pressurization and control systems, primary-secondary pumping systems, variable speed pumping systems, and hurricane modifications and renovations.</p> <p>Relevant Experience: Jefferson Parish Fire Stations 16, 17, & 19, Jefferson Parish Law Enforcement District One: New First District Station, Rosa Keller Library, STEM Center Campus Northshore Technical Community College, New Orleans Sewage and Water Board, Jefferson Parish East Bank Consolidated Fire Fleet Maintenance Facility</p>

TEC Professional Services Questionnaire

KEY PERSON, SPECIALIST, OR INDIVIDUAL CONSULTANT:
Name & Title:
Raymond Conigliaro, PE; Electrical Engineer
Project Assignment:
Electrical Engineer
Name of Firm with which associated:
Lucien T. Vivien Jr. & Associates
Years' experience with this Firm:
13
Education: Degree(s)/Year/Specialization:
BS University of New Orleans /1996/Electrical Engineering University of New Orleans Masters Engineering Management 2000
Active registration: Year first registered/discipline:
2001/Electrical Engineer 31254
Other experience and qualifications relevant to the proposed Project:
<p>Raymond A. Conigliaro is responsible for Electrical Design, Construction Administration and Project Management. His design experience includes interior and exterior lighting systems, site and building power distribution, fire alarm systems, communication systems, lighting fiber-optic systems, medical/laboratory equipment power design, kitchen equipment power design, commercial computer electrical design, intercom/paging systems, security systems, nurse call systems and energy conservation measures such as lighting control and power demand limiting. He has also designed several LEED Green projects and has completed designs of large power generating systems. Ray has also completed root cause analyses of faulty electrical systems to determine design deficiencies, and remediation requirements.</p> <p>*LEED Green Associate</p> <p>Relevant Experience: Juvenile Justice and Youth Study Center, Delgado Maritime Facility, New Wastewater Treatment Plant Port of St. Bernard, STEM Center Campus Northshore Technical Community College, NOAB Concourse A, St. Tammany Parish Interstate Lighting</p>

TEC Professional Services Questionnaire**KEY PERSON, SPECIALIST, OR INDIVIDUAL CONSULTANT:****Name & Title:**

N/A

Project Assignment:

N/A

Name of Firm with which associated:

N/A

Years' experience with this Firm:

N/A

Education: Degree(s)/Year/Specialization:

N/A

Active registration: Year first registered/discipline:

N/A

Other experience and qualifications relevant to the proposed Project:

N/A

TEC Professional Services Questionnaire

L. Work by Firm or Joint-Venture members which best illustrates current qualifications relevant to this Project. Please include any and all work performed for Jefferson Parish. Please attach additional pages if necessary.

PROJECT NO. 1

Project Name, Location and Owner's contact information:	Nature of Firm's Responsibility:	
<p>Meisler Middle School HVAC Replacement, Jefferson Parish</p> <p>Client: Jefferson Parish School Board 4600 River Road Marrero, LA 70072</p>	<p>LTV provided full MEP services for the replacement of 57 Rooftop units gas piping electrical panels and feeders for Meisler Middle School.</p>	
Completion Date (Actual or estimated):	Estimated Cost:	
	Entire Project:	Work for which Firm was Responsible:
2022(E)	\$1,400,000	\$1,400,000

PROJECT NO. 2

Project Name, Location and Owner's contact information:	Nature of Firm's Responsibility:	
<p>Jefferson Parish Law Enforcement District One: New First District Station, Metairie, LA</p> <p>Client: N-Y Associates, Inc. 2750 Lake Villa Drive Metairie, LA 70002</p> <p>The Parish of Jefferson; 12221 Elmwood Park Blvd., Suite 310, Jefferson LA 70123</p>	<p>LTV provided MEP design services for the two-story, approximately 14,000 sf, New First District Station. The design services included HVAC, plumbing, power, lighting and telecommunications.</p>	
Completion Date (Actual or estimated):	Estimated Cost:	
	Entire Project:	Work for which Firm was Responsible:
2017 (E)	\$4,000,000	\$663

TEC Professional Services Questionnaire

PROJECT NO. 3		
Project Name, Location and Owner's contact information:	Nature of Firm's Responsibility	
Fire Station 16, Jefferson Parish, LA Client: Digital Engineering Thomas Hickey 504-468-6129 527 W. Esplanade, Suite 200 Kenner, LA 70065 The Parish of Jefferson; 1221 Elmwood Park Blvd, Suite 310; Jefferson LA 70123	Provided MEP services which included: HVAC plumbing, fire protection, electrical and fire alarm with lightning protection.	
Completion Date (Actual or estimated)	Estimated Cost:	
	Entire Project:	Work for which Firm was Responsible:
2008 (A)	1,500,000	2,500

PROJECT NO. 4		
Project Name, Location and Owner's contact information:	Nature of Firm's Responsibility:	
Jefferson Parish New Lake Shore Library, Metairie, LA Owner: Jefferson Parish Client: Sizeler Thompson Brown, Archs. 300 Lafayette Mall, Suite 200 New Orleans, LA 70130 504-523-6472	Provided complete MEP design services for the new 7,700 square foot Jefferson Parish Lakeshore Library. Our services included HVAC, plumbing, fire protection, electrical power, lighting and tele/data rough-in for administration offices, meeting room, common area, children's area, teenage study area and a reading cove. Coordination of services was provided to meet FEMA requirements.	
Completion Date (Actual or estimated):	Estimated Cost:	
	Entire Project:	Work for which Firm was Responsible:
2011	2,000,000	540,000

TEC Professional Services Questionnaire

PROJECT NO. 5		
Project Name, Location and Owner's contact information:	Nature of Firm's Responsibility:	
Jefferson Parish East Bank Consolidated Fire Fleet Maintenance Facility, Metairie, LA Client: Linfield, Hunter & Junius, Inc. 3608 18th Street, Suite 200 Metairie, LA 70002 The Parish of Jefferson; 12221 Elmwood Park Blvd., Suite 310, Jefferson LA 70123	LTV provided the MEP design services for the renovations to the Jefferson Parish Fire Fleet Maintenance Facility. Design services included HVAC, plumbing, electrical, lighting power, telecommunication, security and fire alarm system.	
Completion Date (Actual or estimated):	Estimated Cost:	
	Entire Project:	Work for which Firm was Responsible:
2018(A)	\$500,000	\$150,000

PROJECT NO. 6		
Project Name, Location and Owner's contact information:	Nature of Firm's Responsibility:	
STEM Center Campus, Northshore Technical Community College, Lacombe, LA Client: Chenevert Architects 8300 Earhart Blvd. Suite 101 New Orleans, LA 70118 504-314-1404 Mark Baum	Providing mechanical and electrical design services for the new 28,000 sf STEM Center Facility at the New Northshore Technical Community College Campus. Construction consisted of classrooms and an administration building and technical laboratory.	
Completion Date (Actual or estimated):	Estimated Cost:	
	Entire Project:	Work for which Firm was Responsible:
2019 Construction	5,000,000	2,150,000

TEC Professional Services Questionnaire

PROJECT NO. 7		
Project Name, Location and Owner's contact information:	Nature of Firm's Responsibility:	
Wastewater Treatment Plant Port of St. Bernard Client: N-Y Associates, Inc. 2750 Lake Villa Drive Metairie, LA 70002 Dean Nicoladis 504-885-0500 Owner: Port of St. Bernard	LTV provided electrical design services for a prefabricated steel treatment plant. Design services included treatment plant control panel and power design.	
Completion Date (Actual or estimated):	Estimated Cost:	
	Entire Project:	Work for which Firm was Responsible:
2021	\$502,000.00	\$150,000.00

PROJECT NO. 8		
Project Name, Location and Owner's contact information:	Nature of Firm's Responsibility:	
Juvenile Justice And Youth Study Center, New Orleans, LA Client: David Blanchard dblanchard@mathesbrierre.com Mathes Brierre 201 St. Charles Avenue, Suite 4100 New Orleans, LA 70170 504-586-9303 Owner: Kevin Ferguson, Capital Projects Administration 1300 Perdido Street, Suite 6E15, New Orleans, LA 70112 504-658-8662	LTV provided complete MEP design services for an approximately 65,000 SF Youth study facility which includes dorm rooms, cafeteria, kitchen, classrooms, medical facility, gymnasium, lobby/visiting area and basketball courtyard, a 65,000 SF Juvenile Court Building which consists of courtrooms, and administration offices. Our design services included HVAC, plumbing, fire protection, general energy efficient LED lighting, power, emergency generator, and tele/data design. Specialty lighting included courtroom illumination. Lighting design included LED lamps to provide the facility with low maintenance costs. Electrical design also included sound system.	
Completion Date (Actual or estimated):	Estimated Cost:	
	Entire Project:	Work for which Firm was Responsible:
2014	37,000,000	13,000,000

TEC Professional Services Questionnaire

PROJECT NO. 9		
Project Name, Location and Owner's contact information:	Nature of Firm's Responsibility:	
<p>Louis Armstrong New Orleans International Airport North Terminal Concourse A, Kenner, LA</p> <p>Client: LEO A. Daly, tenth Floor, 1201 Connecticut Ave NW, Washington, DC 20036-2683 Amy Clark 202-955-9113</p> <p>Owner: MSY</p>	<p>LTV provided the design and construction administration services including field inspections for the 300,000sf MSY North Terminal Airport Concourse A Expansion and ramp lighting design, including ramp lighting photometric calculation design. The design services were provided through Autodesk Revit and online collaboration of consultants from 6 different states.</p> <p>Our services also included construction administration services for the new 800,000sf MSY North Terminal Airport. Services included Revit modifications to the active model design and field inspections of MEP systems to include ramp and highway lighting systems. Services also included the design and construction administration services including field inspections for the 300,000sf MSY North Terminal Airport Concourse A Expansion and ramp lighting design, including ramp lighting photometric calculation design.</p> <p>Additionally, our services included the design and construction administration for the new East Parking Garage at the North Terminal at MSY. Our Services included full MEP design, consisting of full LED lighting design of a 7 story 2700 space 1,200,000 sf parking garage.</p>	
Completion Date (Actual or estimated):	Estimated Cost:	
	Entire Project:	Work for which Firm was Responsible:
2019	65,000,000 (E)	22,000,000 (E)

PROJECT NO. 10		
Project Name, Location and Owner's contact information:	Nature of Firm's Responsibility:	
<p>St. Tammany Interstate Lighting, St. Tammany, LA</p> <p>Owner/Client: St. Tammany Parish Government, P.O. Box 628, Covington, LA 70434 Bobbie Westerfield, Assistant Director, Dept of Public Works 985-898-342</p>	<p>LTV provided electrical design consultant services for the installation of 5 interchange LED lighting systems. Consultant services included review of existing systems, maintenance records to determine areas for improvement of the design lighting systems. Provided recommendations to St Tammany and LA DOTD to reduce maintenance cost and improve system performance. LTV recommended and obtained approvals from LA DOTD for the installation of the first interstate interchange LED lighting system. We performed maintenance analysis on Oak Harbor interchange lighting to assist LA DOTD with replacement of system. Performed design engineering to assist LA DOTD with the design of the new Oak Harbor interchange lighting system.</p>	
Completion Date (Actual or estimated):	Estimated Cost:	
	Entire Project:	Work for which Firm was Responsible:
2019	\$60,000,000	\$60,000,000

TEC Professional Services Questionnaire

M. List all prior and/or on-going litigation between Firm and Jefferson Parish. Please attach additional pages if necessary.

Parties:		Status/Result of Case:
Plaintiff:	Defendant:	
1. N/A		
2. N/A		
3. N/A		
4. N/A		

N. Use this space to provide any additional information or description of resources supporting Firm's qualifications for the proposed project.

LTV is a multi-disciplined consulting firm offering over 100 years of cumulative experience in mechanical and electrical engineering. LTV has been locally owned and operated in the New Orleans area since its inception in 1929. LTV has built a powerful reputation in delivering a wide range of projects for our clients in the public and private sectors. Our diverse staff of talented engineers, inspectors, and technical and construction professionals have brought their expertise to local community improvement projects to large high-profile projects. LTV is a DBE certified firm with the New Orleans Aviation Board. We are dedicated towards providing consistent high-quality and innovative services with utmost professionalism, and helping our clients complete their projects in a timely, safe and cost-efficient manner.

LTV currently employs 3 electrical engineers, 2 mechanical engineers, 1 design engineer, 1 CAD design, and 2 office administration at our Metairie office located at 3001 22nd Street, Metairie, LA 70002. LTV's employees/professionals stay current with each discipline's requirement for certifications, and specified courses. We use the latest technology and software to maximize our contribution to our projects and clients. Our staff undergoes regular technical and managerial training to continue being responsive and fully capable of proactively solving complex design and construction challenges. The firm's principals and senior management continue to remain involved to ensure that each project is given the attention, time and resources it needs for successful completion and to surpass all clients' expectations. Under the mechanical engineering discipline, we offer HVAC, plumbing, sprinkler system, and site utility designs. Our electrical discipline offers lighting, general building power, emergency generator site service, fire alarm system, fiber optic service, data/telecommunication distribution, and various other special systems designs. Services are offered to industry, private clients, governmental agencies, architects and engineers. Our services include preparation of design drawings and specifications, construction administration, existing condition surveys, engineering studies, construction estimates, and energy conservation submittals.

This firm can also provide HVAC calculations, energy audits, operating cost analysis, construction cost estimations, lighting calculations electrical short circuit, voltage drop and load calculations using our engineering software data base. Our design experience includes airports, office buildings, hospitals, health clinics, coroner's facility, schools, multi-purpose facilities, mechanical plants, military installations, hotels, casinos, libraries, laboratories, kitchens, gymnasiums, recreation facilities, rescue facilities, and site utilities. The complete mechanical and electrical systems as well as Owner/User needs of each project are reviewed at the beginning of the design phase by our firm in order to properly allocate building space for each discipline. Throughout the design of projects, the engineers are aware of the desires, needs, and budget of the Owner/User. The engineers use this information to maintain an affordable construction cost.

We believe our client's satisfaction determines our present and future success. LTV dedicates itself to preventing and solving project problems with the expertise and experience expected of a professional consulting firm. We strive to give our clients the highest quality and most cost-effective projects. Over the past several decades LTV has designed and brought hundreds of projects through construction that demonstrated success to meet the highest standards of quality, service, innovation, and integrity.

O. To the best of my knowledge, the foregoing is an accurate statement of facts.

Signature: Karen E. Vivien Print Name: Karen E. Vivien
 Title: President Date: 06/08/2022

The Louisiana Professional Engineering and Land Surveying Board has the following information on file:

Name:	Public Address:
Lucien T. Vivien, Jr. & Associates	Mr. David E. Vivien3001 22nd Street Metairie, Louisiana 70002

**License/Certificate Information w/
Supervision**

License	Status	First Issuance Date	Expiration Date	Supervisor(s)
EF.0000815	Active	09/28/1984	09/30/2023	Mr. David Eugene Vivien # PE.0036834 - Active ; Mr. Raymond Anthony Conigliaro # PE.0031254 - Active



LOUISIANA PROFESSIONAL ENGINEERING AND LAND SURVEYING BOARD

As of 5/6/2022 the Louisiana Professional Engineering and Land Surveying Board (LAPELS) has the following information on file:

Mr. David Eugene Vivien
3001 22nd Street
Metairie, Louisiana 70002

	LOUISIANA PROFESSIONAL ENGINEERING & LAND SURVEYING BOARD (LAPELS)	
	9643 Brookline Avenue, Suite 121 Baton Rouge, LA 70809 Phone (225) 925-6291 www.lapels.com	
Mr. David Eugene Vivien		
License/Certificate Type - Number	Expiration Date	
PE.0036834	03/31/2024	
Status: Active		
<p>Please be advised that your license must be in "Active" status in order for you to (a) provide or offer to provide engineering or land surveying services in Louisiana or (b) use the words "engineer", "engineering", "land surveyor", "land surveying" or any modification or derivative thereof in your name or in connection with your business or activities in Louisiana. Licensees whose licenses are in "Retired", "Inactive", or "Expired" status are prohibited from engaging in the activities described above in items (a) and (b).</p> <p>LA R. S. 37:689 requires firms practicing or offering to practice engineering or land surveying in the state of Louisiana to be licensed by the Board prior to offering such services.</p>		

Fold Here →

← Cut Here

Print and keep the following information for your record or verification. The pocket card may also be printed on card stock or laminated to keep with you as license/certificate verification.

Disclaimer

All information provided by LAPELS on this web page, and on its other web pages and internet sites, is made available to provide immediate access for the convenience of interested persons. While LAPELS believes the information to be reliable, human or mechanical error remains a possibility, as does delay in the posting or updating of information. Therefore, LAPELS makes no guarantee as to the accuracy, completeness, timeliness, currency, or correct sequencing of the information. Neither LAPELS, nor any of the sources of the information, shall be responsible for any errors or omissions, or for the use or results obtained from the use of this information. Other specific cautionary notices may be included on other web pages maintained by LAPELS.

If you need to make changes to your contact information, please choose one of the following options below:

Contact update for [Individuals and Firms](#)

License/Certificate Types:

EF = Engineering Firm

VF = Land Surveying Firm

CPD = Continuing Professional Development Sponsor/Provider

*PE = Professional Engineer

*PLS = Professional Land Surveyor

*EI = Engineer Intern

*LSI = Land Surveyor Intern

*PE Discipline Codes

AG	Agricultural	ME	Mechanical
AR	Architectural	MI	Mining or Mineral
CH	Chemical	MT	Metallurgical
CE	Civil	MU	Manufacturing
CS	Control Systems	NV	Naval Architecture & Marine
EE	Electrical & Computer	NU	Nuclear
EV	Environmental	ST	Structural *
FP	Fire Protection	PT	Petroleum
IE	Industrial		
* An engineer that has passed the Structural I exam is listed as a Civil Engineer. An engineer that has passed both the Structural I and II exams is listed as Structural (ST) and a Civil (CE) Engineer.			

FOR PUBLIC DISPLAY - NOT TRANSFERABLE

ISSUED BY

SHERIFF AND EX-OFFICIO TAX COLLECTOR-JEFFERSON PARISH, LOUISIANA

2022 Occupational License Tax



LUCIEN T VIVIEN JR & ASSOCIATES INC
PO BOX 9460
METAIRIE, LA 70055



License # **650945309**

Account # **17179373**

Location Address

3001 22ND ST
METAIRIE, LA

Business Class 541611

Administrative Management and General Management
Consulting Services

License Class 1740

Retail Mdse/Service/Rental/etc

Tax	Interest	Penalty	Other	Total	Payment
\$900.00	\$0.00	\$0.00	\$0.00	\$900.00	\$900.00

JOSEPH P. LOPINTO, III
SHERIFF & TAX COLLECTOR

Gregory A. Ruppert, Director
Bureau of Revenue and Taxation

Pursuant to Jefferson Parish Code of Ordinances Chapter 35, Article VI, Section 35-153, the issuance of this occupational license to the person or firm named hereon is a receipt for payment of said tax and entitles the recipient to operate a business at the location shown, provided said business is operated within the confines of the application thereof, and does not violate any parish or state criminal, health, or zoning laws. This license will expire December 31, 2022.

RENEWAL APPLICATIONS ARE DUE PRIOR TO MARCH 1.



LOUISIANA PROFESSIONAL ENGINEERING AND LAND SURVEYING BOARD

As of 5/6/2022 the Louisiana Professional Engineering and Land Surveying Board (LAPELS) has the following information on file:

Mrs. Karen Vivien Conigliaro
220 Kensington Drive
Madisonville, Louisiana 70447

	LOUISIANA PROFESSIONAL ENGINEERING & LAND SURVEYING BOARD (LAPELS) 9643 Brookline Avenue, Suite 121 Baton Rouge, LA 70809 Phone (225) 925-6291 www.lapels.com	
	Mrs. Karen Vivien Conigliaro	
License/Certificate Type - Number	Expiration Date	
EI.0019146	03/31/2024	
Status: Active		
<p>Please be advised that your license must be in "Active" status in order for you to (a) provide or offer to provide engineering or land surveying services in Louisiana or (b) use the words "engineer", "engineering", "land surveyor", "land surveying" or any modification or derivative thereof in your name or in connection with your business or activities in Louisiana. Licensees whose licenses are in "Retired", "Inactive", or "Expired" status are prohibited from engaging in the activities described above in items (a) and (b).</p> <p>LA R. S. 37:689 requires firms practicing or offering to practice engineering or land surveying in the state of Louisiana to be licensed by the Board prior to offering such services.</p>		

← Cut Here

Fold Here →

Print and keep the following information for your record or verification. The pocket card may also be printed on card stock or laminated to keep with you as license/certificate verification.

Disclaimer

All information provided by LAPELS on this web page, and on its other web pages and internet sites, is made available to provide immediate access for the convenience of interested persons. While LAPELS believes the information to be reliable, human or mechanical error remains a possibility, as does delay in the posting or updating of information. Therefore, LAPELS makes no guarantee as to the accuracy, completeness, timeliness, currency, or correct sequencing of the information. Neither LAPELS, nor any of the sources of the information, shall be responsible for any errors or omissions, or for the use or results obtained from the use of this information. Other specific cautionary notices may be included on other web pages maintained by LAPELS.

If you need to make changes to your contact information, please choose one of the following options below:

Contact update for [Individuals and Firms](#)

License/Certificate Types:

EF = Engineering Firm

VF = Land Surveying Firm

CPD = Continuing Professional Development Sponsor/Provider

*PE = Professional Engineer

*PLS = Professional Land Surveyor

*EI = Engineer Intern

*LSI = Land Surveyor Intern

*PE Discipline Codes

AG	Agricultural	ME	Mechanical
AR	Architectural	MI	Mining or Mineral
CH	Chemical	MT	Metallurgical
CE	Civil	MU	Manufacturing
CS	Control Systems	NV	Naval Architecture & Marine
EE	Electrical & Computer	NU	Nuclear
EV	Environmental	ST	Structural *
FP	Fire Protection	PT	Petroleum
IE	Industrial		
* An engineer that has passed the Structural I exam is listed as a Civil Engineer. An engineer that has passed both the Structural I and II exams is listed as Structural (ST) and a Civil (CE) Engineer.			



LOUISIANA PROFESSIONAL ENGINEERING AND LAND SURVEYING BOARD

As of 5/6/2022 the Louisiana Professional Engineering and Land Surveying Board (LPELS) has the following information on file:

Mr. Lucien Eugene Vivien
3001 22nd Street
Metairie, Louisiana 70002

	LOUISIANA PROFESSIONAL ENGINEERING & LAND SURVEYING BOARD (LPELS) 9643 Brookline Avenue, Suite 121 Baton Rouge, LA 70809 Phone (225) 925-6291 www.lapels.com	
	Mr. Lucien Eugene Vivien	
License/Certificate Type - Number	Expiration Date	
PE.0007955	09/30/2022	
Status: Active		

Please be advised that your license must be in "Active" status in order for you to (a) provide or offer to provide engineering or land surveying services in Louisiana or (b) use the words "engineer", "engineering", "land surveyor", "land surveying" or any modification or derivative thereof in your name or in connection with your business or activities in Louisiana. Licensees whose licenses are in "Retired", "Inactive", or "Expired" status are prohibited from engaging in the activities described above in items (a) and (b).

LA R. S. 37:689 requires firms practicing or offering to practice engineering or land surveying in the state of Louisiana to be licensed by the Board prior to offering such services.

Print and keep the following information for your record or verification. The pocket card may also be printed on card stock or laminated to keep with you as license/certificate verification.

Disclaimer

All information provided by LPELS on this web page, and on its other web pages and internet sites, is made available to provide immediate access for the convenience of interested persons. While LPELS believes the information to be reliable, human or mechanical error remains a possibility, as does delay in the posting or updating of information. Therefore, LPELS makes no guarantee as to the accuracy, completeness, timeliness, currency, or correct sequencing of the information. Neither LPELS, nor any of the sources of the information, shall be responsible for any errors or omissions, or for the use or results obtained from the use of this information. Other specific cautionary notices may be included on other web pages maintained by LPELS.

If you need to make changes to your contact information, please choose one of the following options below:

Contact update for [Individuals and Firms](#)

License/Certificate Types:

EF = Engineering Firm

VF = Land Surveying Firm

CPD = Continuing Professional Development Sponsor/Provider

*PE = Professional Engineer

*PLS = Professional Land Surveyor

*EI = Engineer Intern

*LSI = Land Surveyor Intern

*PE Discipline Codes

AG	Agricultural	ME	Mechanical
AR	Architectural	MI	Mining or Mineral
CH	Chemical	MT	Metallurgical
CE	Civil	MU	Manufacturing
CS	Control Systems	NV	Naval Architecture & Marine
EE	Electrical & Computer	NU	Nuclear
EV	Environmental	ST	Structural *
FP	Fire Protection	PT	Petroleum
IE	Industrial		
* An engineer that has passed the Structural I exam is listed as a Civil Engineer. An engineer that has passed both the Structural I and II exams is listed as Structural (ST) and a Civil (CE) Engineer.			



Mayor LaToya Cantrell
City of New Orleans

New Orleans Aviation Board

Hon. Michael G. Bagneris
Chairman

Doug Thornton
Vice-Chairman

Hon. Neil C. Abramson
Todd Francis
Chief Justice (Ret.) Bernette J. Johnson
Ruth Kullman
Joseph Nicolosi, Jr.
Roger H. Ogden
Gary L. Smith, Sr.

Kevin C. Dolliole
Director of Aviation

P. O. Box 20007
New Orleans, LA 70141

P: 504-303-7800
F: 504-303-7566

www.flymsy.com

July 12, 2021

Ms. Karen Vivien
Lucien T. Vivien, Jr. and Associates, Inc.
3001 22nd Street
Metairie, LA 70002

Re: 2021 Annual Update

Dear Ms. Vivien:

Thank you for having responded to our request for your 2021 annual update to maintain your Disadvantaged Business Enterprise (DBE) certification. We have reviewed your Affidavit of No Change, along with the supporting documents, and have determined that your firm continues to meet the DBE guidelines in 49 CFR Part 26. Thus, your firm is certified to fulfill DBE requirements on specified NOAB contracts until your next anniversary date (i.e. *August 17, 2022*).

Service(s):

ARCHITECTURE & ENGINEERING

Area(s) of Work:

54 - Professional, Scientific, and Technical Services
541 - Professional, Scientific, and Technical Services
5413 - Architectural, Engineering, and Related Services
54133 - Engineering Services
541330 - Engineering Services
5416 - Management, Scientific, and Technical Consulting Services
54169 - Other Scientific and Technical Consulting Services
541690 - Other Scientific and Technical Consulting Services
C02 - Mechanical Engineering
C07 - Electrical Engineering

Sincerely,

Philistine Ferrand
DBE Liaison Officer
philisti@flymsy.com - 504.303.7610 - 504.303.7614 fax

PF/SW



LOUISIANA PROFESSIONAL ENGINEERING AND LAND SURVEYING BOARD

As of 12/06/2018, the Louisiana Professional Engineering and Land Surveying Board (LAPELS) has the following information on file:

Mr. Raymond Anthony Co
3001 22nd Street
Metairie, LA 70002

	LOUISIANA PROFESSIONAL ENGINEERING & LAND SURVEYING BOARD (LAPELS)	
	9643 Brookline Avenue, Suite 121 Baton Rouge, LA 70809 Phone (225) 925-6291 www.lapels.com	
Mr. Raymond Anthony Conigliaro		
License/Certificate Type - Number		Expiration Date
PE.0031254		09/30/2022
Status: Active		
<p>Please be advised that your license must be in "Active" status in order for you to (a) provide or offer to provide engineering or land surveying services in Louisiana or (b) use the words "engineer", "engineering", "land surveyor", "land surveying" or any modification or derivative thereof in your name or in connection with your business or activities in Louisiana. Licensees whose licenses are in "Retired", "Inactive", or "Expired" status are prohibited from engaging in the activities described above in items (a) and (b).</p> <p>LA R. S. 37:689 requires firms practicing or offering to practice engineering or land surveying in the state of Louisiana to be licensed by the Board prior to offering such services.</p>		

← Cut Here

Fold Here →

Print and keep the following information for your record or verification. The pocket card may also be printed on card stock or laminated to keep with you as license/certificate verification.

Disclaimer

All information provided by LAPELS on this web page, and on its other web pages and internet sites, is made available to provide immediate access for the convenience of interested persons. While LAPELS believes the information to be reliable, human or mechanical error remains a possibility, as does delay in the posting or updating of information. Therefore, LAPELS makes no guarantee as to the accuracy, completeness, timeliness, currency, or correct sequencing of the information. Neither LAPELS, nor any of the sources of the information, shall be responsible for any errors or omissions, or for the use or results obtained from the use of this information. Other specific cautionary notices may be included on other web pages maintained by LAPELS.

If you need to make changes to your contact information, please choose one of the following options below:

Contact update for [Individuals](#)

Contact update for [Firms](#)

License/Certificate Types:

EF = Engineering Firm

VF = Land Surveying Firm

CPD = Continuing Professional Development Sponsor/Provider

*PE = Professional Engineer

*PLS = Professional Land Surveyor

*EI = Engineer Intern

*LSI = Land Surveyor Intern

*PE Discipline Codes

AG	Agricultural	ME	Mechanical
AR	Architectural	MI	Mining or Mineral
CH	Chemical	MT	Metallurgical
CE	Civil	MU	Manufacturing
CS	Control Systems	NV	Naval Architecture & Marine
EE	Electrical & Computer	NU	Nuclear
EV	Environmental	ST	Structural *
FP	Fire Protection	PT	Petroleum
IE	Industrial		
* An engineer that has passed the Structural I exam is listed as a Civil Engineer. An engineer that has passed both the Structural I and II exams is listed as Structural (ST) and a Civil (CE) Engineer.			

TEC Questionnaire - Consultants

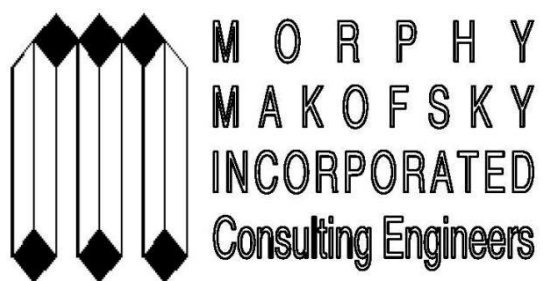

TEC Professional Services Questionnaire

A. Project Name and Advertisement Resolution Number:

**SOQ No. 22-026: Professional Architectural and Engineering Services for Architectural Type Projects
Resolution No. 139630**

B. Firm Name & Address:

Morphy, Makofsky, Inc.
336 N. Norman C. Francis Pkwy.
New Orleans LA 70119

C. Name, title and contact information of Principal, as defined in Section 2-926 of the Jefferson Parish Code of Ordinances, who is a registered, licensed architect, professional engineer, or surveyor in the State of Louisiana:

Jamie L. Saxon, PE
President
336 N. Norman C. Francis Pkwy.
New Orleans LA 70119
(504) 488-1317
j_saxon@mmi-eng.com

D. Name and contact information of employee who is a registered and licensed architect, professional engineer, or surveyor in the State of Louisiana in the applicable discipline. A subcontractor may be substituted here only if the advertised Project requires more than one discipline.

Jonathan A. Sofranko, PE
Secretary/Treasurer
336 N. Norman C. Francis Pkwy.
New Orleans LA 70119
(504) 488-1317
j_sofranko@mmi-eng.com

E. Please provide the number of employees whose primary function corresponds with each category:

<u>2</u> Administrative	<u> </u> Estimators	<u>1</u> Specification Writers
<u> </u> Architects (Licensed)	<u> </u> Geologists	<u>5</u> Structural Engineers
<u> </u> Chemical Engineers	<u> </u> Geotechnical Engineers	<u> </u> Graduate Engineers
<u>1</u> Civil Engineers	<u> </u> Interior Designers	<u> </u> Project Managers
<u> </u> Construction Inspectors	<u> </u> Landscape Architects	<u> </u> Clerical
<u> </u> Ecologists	<u> </u> Land Surveyor	<u> </u> Grant/Funding Specialist
<u> </u> Electrical Engineers	<u> </u> Mechanical Engineers	<u> </u> Sanitary Engineers
<u>2</u> Engineer Intern	<u> </u> Environmental Engineers	
<u> </u> Professional Land Surveyors	<u>5</u> AutoCAD Technicians	<u>16</u> TOTAL

F. Is this submittal by a JOINT-VENTURE? Please check: **NO**

If marked "No" skip to Section I. If marked "yes" complete Sections G-H.

TEC Professional Services Questionnaire

G. If submittal is by JOINT-VENTURE, list the firms participating and outline specific areas of responsibility (including administrative, technical, and financial) for each firm. Please attach additional pages if necessary.

1.

N/A

2.

N/A

H. Has this JOINT-VENTURE previously worked together? Please check:
YES NO

I. List all subcontractors anticipated for this Project. Please note that all subcontractors must submit a fully completed copy of this questionnaire, applicable licenses, and any other information required by the advertisement. See Jefferson Parish Code of Ordinances, Sec. 2-928(a)(3). Please attach additional pages if necessary.

Name & Address:	Specialty:	Worked with Firm Before (Yes or No):
1. N/A		
2. N/A		
3. N/A		

J. Please specify the total number of support personnel that may assist in the completion of this Project:

 N/A

TEC Professional Services Questionnaire

K. List the professional in charge, key persons, specialists, and individual consultants anticipated for this Project and provide their relevant information below. If necessary, please attach additional documentation (i.e. resume) that demonstrates the employment history and experience of the Firm's key persons that may assist in the completion of this Project. Please attach additional pages if necessary.

PROFESSIONAL IN CHARGE OF PROJECT:

Name & Title:

Jamie L. Saxon, PE
President

Project Assignment:

Professional in Charge
Principal Project Manager

Name of Firm with which associated:

Morphy, Makofsky, Inc.

Years' experience with this Firm:

29

Education: Degree(s)/Year/Specialization:

Bachelor of Engineering, Civil Engineering, 1992
University of Adelaide, Australia

Active registration: Year first registered/discipline:

Professional Engineer Louisiana License No. 30529 - 2003

Other experience and qualifications relevant to the proposed Project:

Jamie Saxon has been responsible for foundation and structural design and analysis on residential, commercial, military, industrial, levee structures (earthen and pile supported T-walls), and drainage pump stations. Many of these projects have included dock and wharf structures. His designs have included many complex and unique foundation systems. He has also designed temporary and permanent cantilevered and anchored sheet pile bulkheads and cofferdams as part of the Hurricane Protection systems in the post Katrina landscape. Mr. Saxon also has experience with damaged wharves. His duties have included field investigations to assess damages, formulation and detailing of necessary repairs, cost estimation, and supervision of the repairs. These wharves are located along the Mississippi River, canals, and the Mississippi Delta region.

TEC Professional Services Questionnaire

KEY PERSON, SPECIALIST, OR INDIVIDUAL CONSULTANT:
Name & Title:
Jonathan Sofranko, P.E. Secretary/Treasurer
Project Assignment:
Principal Structural Engineer
Name of Firm with which associated:
Morphy, Makofsky, Inc.
Years' experience with this Firm:
28
Education: Degree(s)/Year/Specialization:
Bachelor of Science, Civil Engineering, 1994 Tulane University, New Orleans, Louisiana
Active registration: Year first registered/discipline:
Professional Engineer Louisiana License No. 28228 – 1999 Also Licensed in 15 other states
Other experience and qualifications relevant to the proposed Project:
<p>During his tenure with MMI, Jonathan Sofranko has worked his way from Junior Engineer to Partner. He has been responsible for the design and production of construction documents for buildings and structures ranging in size from large residential homes to mid-rise hotel towers. He is proficient in designing the super-structures of buildings in steel, conventionally reinforced concrete, post tensioned concrete, and wood. His structural experience includes the design and analysis of reinforced concrete, post-tensioned concrete, structural steel, and composite framing systems, as well as foundations. Mr. Sofranko has performed wind, seismic, and adaptive reuse analyses for multiple types of structures including various high rise hotels, medical facilities, and corporate facilities. He has extensive experience and knowledge in three dimensional modeling.</p>

TEC Professional Services Questionnaire

KEY PERSON, SPECIALIST, OR INDIVIDUAL CONSULTANT:
Name & Title:
Alexander D. Hart, PE, SE Structural Engineer
Project Assignment:
Structural Engineer
Name of Firm with which associated:
Morphy, Makofsky, Inc.
Years' experience with this Firm:
4
Education: Degree(s)/Year/Specialization:
Bachelor of Science, Civil Engineering, 2011 (Structural Specialization) Georgia Institute of Technology, Atlanta, Georgia
Active registration: Year first registered/discipline:
Professional Engineer Louisiana License No. 40504 - 2016
Other experience and qualifications relevant to the proposed Project:
Alex Hart is knowledgeable in the design of structural steel, concrete, wood and masonry structures and has experience in the design of pile and soil supported foundations. He is also proficient with multiple computer design programs including RISA, RAM, Etabs and Elements. Mr. Hart's structural design experience has included working on projects of varying scales of cost and complexity. These projects range from small to mid-rise structures, multistory historic restorations and large school projects.

TEC Professional Services Questionnaire

KEY PERSON, SPECIALIST, OR INDIVIDUAL CONSULTANT:
Name & Title:
Shishir C. Pedamkar, EIT Civil Engineer
Project Assignment:
Civil Engineer
Name of Firm with which associated:
Morphy, Makofsky, Inc.
Years' experience with this Firm:
14
Education: Degree(s)/Year/Specialization:
Master of Engineering, Lamar University, 2003 Bachelor of Science, Civil Engineering, Mumbai University, 2000
Active registration: Year first registered/discipline:
Texas Engineer in Training, 2015
Other experience and qualifications relevant to the proposed Project:
<p>Prior to working at Morphy, Makofsky, Inc., Mr. Pedamkar had spent four years working in and around the construction industry in different districts of Florida and Georgia. He possesses a broad range of technical and leadership skills and uses rigorous logic to come up with effective design solutions to meet the client's requirements.</p> <p>Mr. Pedamkar's experience in the design requirements of Environmental Protection permit programs (DEP, TPDES, TCEQ and NPDES) has proven to be valuable asset to MMI. Mr. Pedamkar is also very proficient with relevant civil engineering design software's such as AutoCAD, Civil 3D, and Storm-Sewer Extensions to Civil 3D.</p>

TEC Professional Services Questionnaire

KEY PERSON, SPECIALIST, OR INDIVIDUAL CONSULTANT:
Name & Title:
Greg Eckert, AIA, NCARB Technical Assistant
Project Assignment:
Specification Writer/Project Coordination
Name of Firm with which associated:
Morphy, Makofsky, Inc.
Years' experience with this Firm:
14
Education: Degree(s)/Year/Specialization:
Bachelor of Arts, Architecture, 2003 Louisiana State University, Baton Rouge, Louisiana
Active registration: Year first registered/discipline:
Louisiana Architectural License No. 8239 – 2015 NCARB Certificate No. 80339
Other experience and qualifications relevant to the proposed Project:
Mr. Eckert is responsible for the production of MMI's construction specifications as a written counterpart to the construction drawings. This role requires a thorough understanding of structural and civil materials with an emphasis in concrete, steel, and pile supported construction as well as an understanding of the quality of construction required by each client. Mr. Eckert is familiar with all MasterSpec formats and ensures that each set of project specifications is tailored to the meet the client's needs and the requirements of the code. Mr. Eckert is practiced in authoring not only the structural and civil components of the project manual, but also coordinating the addition of sub-consultant specifications, Division 00 Procurement & Contracting Documents, and Division 01 General Requirements for the client.

TEC Professional Services Questionnaire

L. Work by Firm or Joint-Venture members which best illustrates current qualifications relevant to this Project. Please include any and all work performed for Jefferson Parish. Please attach additional pages if necessary.

PROJECT NO. 1

Project Name, Location and Owner's contact information:	Nature of Firm's Responsibility:	
<p>Ochsner West Metairie 4400 Veterans Blvd. Metairie, LA 70006</p> <p>Owner: Ochsner Health</p>	<p>Providing structural engineering services for a 185,000 square foot "super clinic." Renovations are under way in the former Sears building at Clearview Mall. The remodeled department store will house Ochsner's newest medical facility in the Metairie area.</p>	
Completion Date (Actual or estimated):	Estimated Cost:	
	Entire Project:	Work for which Firm was Responsible:
2022 (Estimated)	\$97,000,000	\$30,000,000

PROJECT NO. 2

Project Name, Location and Owner's contact information:	Nature of Firm's Responsibility:	
<p>JEDCO Office Building 700 Churchill Pkwy Avondale, Louisiana</p> <p>Owner: JEDCO 3445 Causeway Blvd. Suite 300 Metairie, LA 70002</p>	<p>Provided structural and civil engineering services for three separate buildings built to be energy efficient inside the Churchill Technology and Business Park.</p>	
Completion Date (Actual or estimated):	Estimated Cost:	
	Entire Project:	Work for which Firm was Responsible:
2013 (Actual)	\$4,856,000	\$1,550,000

TEC Professional Services Questionnaire

PROJECT NO. 3		
Project Name, Location and Owner's contact information:	Nature of Firm's Responsibility	
Patrick Taylor Science & Technology Academy 701 Churchill Pkwy Avondale, Louisiana Owner: JEDCO 3445 Causeway Blvd. Suite 300 Metairie, LA 70002	Provided structural and civil engineering services for the construction of the 114,000 square foot state-of-the-art facility. The project includes the construction of three major classroom buildings, cafeteria, auditorium, robotics and biotech laboratories and an 11,000 square foot event center that will be the western gateway to the business park.	
Completion Date (Actual or estimated)	Estimated Cost:	
	Entire Project:	Work for which Firm was Responsible:
2013 (Actual)	\$31,250,000	\$10,000,000

PROJECT NO. 4		
Project Name, Location and Owner's contact information:	Nature of Firm's Responsibility:	
Metairie Manor IV 4937 York Street Metairie, Louisiana Owner: Archdiocese of New Orleans 7887 Walmsley Avenue New Orleans, LA 70125	Provided structural and civil engineering design services for the new construction of an 82 unit, 65,086 square foot assisted living facility. The exterior of the new building was designed to match the existing 3 brick adjacent buildings to seamlessly fit into the landscape of the neighborhood. The new building provided much needed space for the growing senior facility.	
Completion Date (Actual or estimated):	Estimated Cost:	
	Entire Project:	Work for which Firm was Responsible:
2014 (Actual)	\$9,000,000	\$3,000,000

TEC Professional Services Questionnaire

PROJECT NO. 5		
Project Name, Location and Owner's contact information:	Nature of Firm's Responsibility:	
LPV 9.2 – Fronting Protection and Breakwater Modifications Jefferson Lakefront Pumping Stations 1-4 Jefferson Parish, LA Owner: U.S. Army Corps of Engineers 7400 Leake Avenue New Orleans, LA 70118	This project consisted of designing temporary retaining structures (TRS). A TRS consists of a dam across the discharge channel and all other individual temporary retaining structures necessary to support the excavation as required. Design included: Temporary Work Bridge design; Soil / Slope Analysis of excavation inside cofferdam; Crane pads design for 4100 Ringer Cranes; Temporary flood protection design as needed.	
Completion Date (Actual or estimated):	Estimated Cost:	
	Entire Project:	Work for which Firm was Responsible:
2013 (Actual)	\$175,000,000	\$8,000,000

PROJECT NO. 6		
Project Name, Location and Owner's contact information:	Nature of Firm's Responsibility:	
Republic National Distributing Warehouse 809 Jefferson Highway Jefferson Parish, LA Owner: Republic National Distributing 809 Jefferson Highway New Orleans, LA 70121	MMI provided first floor framing and foundation design for this 130,000 square foot warehouse expansion. MMI provided the drainage and pavement design of the approximately 100,000 square feet parking lot and also prepared a stormwater management plan (SWMP) to meet local (Jefferson Parish) and state (DOTD) drainage requirements. The SWMP comprised an underground detention system which included a new weir structure.	
Completion Date (Actual or estimated):	Estimated Cost:	
	Entire Project:	Work for which Firm was Responsible:
2017 (Actual)	N/A	N/A

TEC Professional Services Questionnaire

PROJECT NO. 7		
Project Name, Location and Owner's contact information:	Nature of Firm's Responsibility:	
<p>Ochsner Hospital Pedestrian Bridge Jefferson Parish, LA</p> <p>Owner: Ochsner Hospital 1514 Jefferson Highway New Orleans, LA 70121</p>	<p>MMI provided complete design of air conditioned pedestrian bridge spanning approximately 190 feet in length across Jefferson Highway. The bridge is framed with tube steel trusses on both exterior walls using conventionally framed connector sections to tie into the existing buildings at each end of the bridge.</p>	
Completion Date (Actual or estimated):	Estimated Cost:	
	Entire Project:	Work for which Firm was Responsible:
2012 (Actual)	N/A	N/A

PROJECT NO. 8		
Project Name, Location and Owner's contact information:	Nature of Firm's Responsibility:	
<p>5800 Jefferson Highway Renovations and Modifications Harahan, LA</p> <p>Owner: Feil Organization Property Mgrs. 3900 N. Causeway, Suite 1350 Metairie, LA 70002</p>	<p>MMI provided floor load analysis, construction documents for new truck docks, and new gantry crane foundations.</p>	
Completion Date (Actual or estimated):	Estimated Cost:	
	Entire Project:	Work for which Firm was Responsible:
2016 (Actual)	N/A	N/A

TEC Professional Services Questionnaire

PROJECT NO. 9		
Project Name, Location and Owner's contact information:	Nature of Firm's Responsibility:	
<p style="text-align: center;">700 Metairie Road New Mixed Use Building Metairie, LA</p> <p style="text-align: center;">Owner: J. Caldarera & Co. 201 Woodland Drive LaPlace, LA 70068</p>	<p>MMI provided structural and civil engineering services for the design and development of a new 3 story, 12,500 square foot, mixed use building.</p> <p>Civil engineering included a new drainage system, utility tie-ins, and a new 30 space parking lot.</p>	
Completion Date (Actual or estimated):	Estimated Cost:	
	Entire Project:	Work for which Firm was Responsible:
2016 (Estimated)	\$2,200,000 (Estimated)	\$650,000

PROJECT NO. 10		
Project Name, Location and Owner's contact information:	Nature of Firm's Responsibility:	
<p style="text-align: center;">Oyster Hatchery Building Dept. of Wildlife & Fisheries Grand Isle, LA</p> <p style="text-align: center;">Facility of Planning & Control State of Louisiana P.O. Box 94095 Baton Rouge, LA 70804</p>	<p>MMI provided structural engineering services for the approximately 14,000 square foot structure. The first floor can accommodate heavy tank loads of water. The second level houses the research and administration areas and is 14 feet off the ground. The structure was designed to withstand high velocity winds and sustained winds of 150mph to protect the delicate oyster breeding beds. The walls are concrete/CMU.</p>	
Completion Date (Actual or estimated):	Estimated Cost:	
	Entire Project:	Work for which Firm was Responsible:
2015 (Actual)	\$3,000,000	\$900,000

TEC Professional Services Questionnaire

M. List all prior and/or on-going litigation between Firm and Jefferson Parish. Please attach additional pages if necessary.

Parties:		Status/Result of Case:
Plaintiff:	Defendant:	
1. N/A		
2. N/A		
3. N/A		
4. N/A		

N. Use this space to provide any additional information or description of resources supporting Firm's qualifications for the proposed project.

Morphy, Makofsky, Inc.'s consulting services include design, studies, estimates, contract administration of engineering projects, and the structural phases of architectural projects. MMI currently employs twenty-two structural, foundation, and civil engineers; CAD technicians; construction observers; specification writers; and administrators. Professional personnel are appropriately registered as professional engineers or engineers in training. It is our goal to execute designs which will simplify construction and minimize construction schedules, while maintaining an impeccable standard of care during and after the construction process. The MMI administrative team works closely with all disciplines to ensure that deadlines are met and that projects remain on schedule and on budget. MMI's expert team of drafters produces the highest-quality and most accurate drawings using cutting-edge software including the latest release of Autodesk Revit Structure, AutoCAD, AutoCAD Civil 3D, and Microstation. It has been, and will continue to be, the aim of Morphy, Makofsky, Inc. to render its services in accordance with the highest moral and ethical standards. This knowledge, together with the vast experience accumulated over the years, provides clients with the assurance that Morphy, Makofsky, Inc. is uniquely qualified to render professional engineering services.

O. To the best of my knowledge, the foregoing is an accurate statement of facts.

Signature:  Print Name: Jamie L. Saxon

Title: President Date: June 6, 2022

The Louisiana Professional Engineering and Land Surveying Board has the following information on file:

Name:	Public Address:
Morphy Makofsky, Inc.	Ms. Ann Marciante 336 North Norman C. Francis Parkway New Orleans,LA 70119

License/Certificate Information w/ Supervision

License	Status	First Issuance Date	Expiration Date	Supervisor(s)
EF.0001737	ACTIVE	07/28/1992	03/31/2023	Mr. Hans Stephan Bernick # PE.0029015 - Active Mr. Jamie Lee Saxon # PE.0030529 - Active Mr. Jonathan Andrew Sofranko # PE.0028228 - Active



LOUISIANA PROFESSIONAL ENGINEERING AND LAND SURVEYING BOARD

As of 12/06/2018, the Louisiana Professional Engineering and Land Surveying Board (LAPELS) has the following information on file:

Mr. Jamie Lee Saxon
336 North Norman C. Fran
New Orleans, LA 70119

	LOUISIANA PROFESSIONAL ENGINEERING & LAND SURVEYING BOARD (LAPELS) 9643 Brookline Avenue, Suite 121 Baton Rouge, LA 70809 Phone (225) 925-6291 www.lapels.com	
	Mr. Jamie Lee Saxon	
License/Certificate Type - Number	Expiration Date	
PE.0030529	03/31/2023	
Status: Active		

Fold Here →

Cut Here ←

Please be advised that your license must be in "Active" status in order for you to (a) provide or offer to provide engineering or land surveying services in Louisiana or (b) use the words "engineer", "engineering", "land surveyor", "land surveying" or any modification or derivative thereof in your name or in connection with your business or activities in Louisiana. Licensees whose licenses are in "Retired", "Inactive", or "Expired" status are prohibited from engaging in the activities described above in items (a) and (b).

LA R. S. 37:689 requires firms practicing or offering to practice engineering or land surveying in the state of Louisiana to be licensed by the Board prior to offering such services.

Print and keep the following information for your record or verification. The pocket card may also be printed on card stock or laminated to keep with you as license/certificate verification.

Disclaimer

All information provided by LAPELS on this web page, and on its other web pages and internet sites, is made available to provide immediate access for the convenience of interested persons. While LAPELS believes the information to be reliable, human or mechanical error remains a possibility, as does delay in the posting or updating of information. Therefore, LAPELS makes no guarantee as to the accuracy, completeness, timeliness, currency, or correct sequencing of the information. Neither LAPELS, nor any of the sources of the information, shall be responsible for any errors or omissions, or for the use or results obtained from the use of this information. Other specific cautionary notices may be included on other web pages maintained by LAPELS.

If you need to make changes to your contact information, please choose one of the following options below:

Contact update for [Individuals](#)

Contact update for [Firms](#)

License/Certificate Types:

EF = Engineering Firm

VF = Land Surveying Firm

CPD = Continuing Professional Development Sponsor/Provider

*PE = Professional Engineer

*PLS = Professional Land Surveyor

*EI = Engineer Intern

*LSI = Land Surveyor Intern

*PE Discipline Codes

AG	Agricultural	ME	Mechanical
AR	Architectural	MI	Mining or Mineral
CH	Chemical	MT	Metallurgical
CE	Civil	MU	Manufacturing
CS	Control Systems	NV	Naval Architecture & Marine
EE	Electrical & Computer	NU	Nuclear
EV	Environmental	ST	Structural *
FP	Fire Protection	PT	Petroleum
IE	Industrial		
* An engineer that has passed the Structural I exam is listed as a Civil Engineer. An engineer that has passed both the Structural I and II exams is listed as Structural (ST) and a Civil (CE) Engineer.			



LOUISIANA PROFESSIONAL ENGINEERING AND LAND SURVEYING BOARD

As of 12/06/2018, the Louisiana Professional Engineering and Land Surveying Board (LAPELS) has the following information on file:

Mr. Jonathan Andrew Sofr
600 Labarre Drive
Metairie, LA 70001

	LOUISIANA PROFESSIONAL ENGINEERING & LAND SURVEYING BOARD (LAPELS)	
	9643 Brookline Avenue, Suite 121 Baton Rouge, LA 70809 Phone (225) 925-6291 www.lapels.com	
Mr. Jonathan Andrew Sofranko		
License/Certificate Type - Number	Expiration Date	
PE.0028228	09/30/2022	
Status: Active		
<p>Please be advised that your license must be in "Active" status in order for you to (a) provide or offer to provide engineering or land surveying services in Louisiana or (b) use the words "engineer", "engineering", "land surveyor", "land surveying" or any modification or derivative thereof in your name or in connection with your business or activities in Louisiana. Licensees whose licenses are in "Retired", "Inactive", or "Expired" status are prohibited from engaging in the activities described above in items (a) and (b).</p> <p>LA R. S. 37:689 requires firms practicing or offering to practice engineering or land surveying in the state of Louisiana to be licensed by the Board prior to offering such services.</p>		

Fold Here →

Cut Here ←

Print and keep the following information for your record or verification. The pocket card may also be printed on card stock or laminated to keep with you as license/certificate verification.

Disclaimer

All information provided by LAPELS on this web page, and on its other web pages and internet sites, is made available to provide immediate access for the convenience of interested persons. While LAPELS believes the information to be reliable, human or mechanical error remains a possibility, as does delay in the posting or updating of information. Therefore, LAPELS makes no guarantee as to the accuracy, completeness, timeliness, currency, or correct sequencing of the information. Neither LAPELS, nor any of the sources of the information, shall be responsible for any errors or omissions, or for the use or results obtained from the use of this information. Other specific cautionary notices may be included on other web pages maintained by LAPELS.

If you need to make changes to your contact information, please choose one of the following options below:

Contact update for [Individuals](#)

Contact update for [Firms](#)

License/Certificate Types:

EF = Engineering Firm

VF = Land Surveying Firm

CPD = Continuing Professional Development Sponsor/Provider

*PE = Professional Engineer

*PLS = Professional Land Surveyor

*EI = Engineer Intern

*LSI = Land Surveyor Intern

*PE Discipline Codes

AG	Agricultural	ME	Mechanical
AR	Architectural	MI	Mining or Mineral
CH	Chemical	MT	Metallurgical
CE	Civil	MU	Manufacturing
CS	Control Systems	NV	Naval Architecture & Marine
EE	Electrical & Computer	NU	Nuclear
EV	Environmental	ST	Structural *
FP	Fire Protection	PT	Petroleum
IE	Industrial		
* An engineer that has passed the Structural I exam is listed as a Civil Engineer. An engineer that has passed both the Structural I and II exams is listed as Structural (ST) and a Civil (CE) Engineer.			



LOUISIANA PROFESSIONAL ENGINEERING AND LAND SURVEYING BOARD

As of 12/06/2018, the Louisiana Professional Engineering and Land Surveying Board (LAPELS) has the following information on file:

Mr. Hans Stephan Bernick
1300 Burgundy Street
New Orleans, LA 70116

	LOUISIANA PROFESSIONAL ENGINEERING & LAND SURVEYING BOARD (LAPELS) 9643 Brookline Avenue, Suite 121 Baton Rouge, LA 70809 Phone (225) 925-6291 www.lapels.com	
	Mr. Hans Stephan Bernick	
License/Certificate Type - Number	Expiration Date	
PE.0029015	09/30/2022	
Status: Active		
<p>Please be advised that your license must be in "Active" status in order for you to (a) provide or offer to provide engineering or land surveying services in Louisiana or (b) use the words "engineer", "engineering", "land surveyor", "land surveying" or any modification or derivative thereof in your name or in connection with your business or activities in Louisiana. Licensees whose licenses are in "Retired", "Inactive", or "Expired" status are prohibited from engaging in the activities described above in items (a) and (b).</p> <p>LA R. S. 37:689 requires firms practicing or offering to practice engineering or land surveying in the state of Louisiana to be licensed by the Board prior to offering such services.</p>		

← Cut Here

Fold Here →

Print and keep the following information for your record or verification. The pocket card may also be printed on card stock or laminated to keep with you as license/certificate verification.

Disclaimer

All information provided by LAPELS on this web page, and on its other web pages and internet sites, is made available to provide immediate access for the convenience of interested persons. While LAPELS believes the information to be reliable, human or mechanical error remains a possibility, as does delay in the posting or updating of information. Therefore, LAPELS makes no guarantee as to the accuracy, completeness, timeliness, currency, or correct sequencing of the information. Neither LAPELS, nor any of the sources of the information, shall be responsible for any errors or omissions, or for the use or results obtained from the use of this information. Other specific cautionary notices may be included on other web pages maintained by LAPELS.

If you need to make changes to your contact information, please choose one of the following options below:

Contact update for [Individuals](#)

Contact update for [Firms](#)

License/Certificate Types:

EF = Engineering Firm

VF = Land Surveying Firm

CPD = Continuing Professional Development Sponsor/Provider

*PE = Professional Engineer

*PLS = Professional Land Surveyor

*EI = Engineer Intern

*LSI = Land Surveyor Intern

*PE Discipline Codes

AG	Agricultural	ME	Mechanical
AR	Architectural	MI	Mining or Mineral
CH	Chemical	MT	Metallurgical
CE	Civil	MU	Manufacturing
CS	Control Systems	NV	Naval Architecture & Marine
EE	Electrical & Computer	NU	Nuclear
EV	Environmental	ST	Structural *
FP	Fire Protection	PT	Petroleum
IE	Industrial		
* An engineer that has passed the Structural I exam is listed as a Civil Engineer. An engineer that has passed both the Structural I and II exams is listed as Structural (ST) and a Civil (CE) Engineer.			



LOUISIANA PROFESSIONAL ENGINEERING AND LAND SURVEYING BOARD

As of 1/13/2022 the Louisiana Professional Engineering and Land Surveying Board (LPELS) has the following information on file:

Mr. Alexander Douglas Hart
910 Burdette Street
New Orleans, Louisiana 70118

	LOUISIANA PROFESSIONAL ENGINEERING & LAND SURVEYING BOARD (LPELS)	
	9643 Brookline Avenue, Suite 121 Baton Rouge, LA 70809 Phone (225) 925-6291 www.lapels.com	
Mr. Alexander Douglas Hart		
License/Certificate Type - Number	Expiration Date	
PE.0040504	09/30/2022	
Status: Active		
<p>Please be advised that your license must be in "Active" status in order for you to (a) provide or offer to provide engineering or land surveying services in Louisiana or (b) use the words "engineer", "engineering", "land surveyor", "land surveying" or any modification or derivative thereof in your name or in connection with your business or activities in Louisiana. Licensees whose licenses are in "Retired", "Inactive", or "Expired" status are prohibited from engaging in the activities described above in items (a) and (b).</p> <p>LA R. S. 37:689 requires firms practicing or offering to practice engineering or land surveying in the state of Louisiana to be licensed by the Board prior to offering such services.</p>		

Cut Here (indicated by an arrow pointing to the right side of the card)

Fold Here (indicated by an arrow pointing to the left side of the card)

Print and keep the following information for your record or verification. The pocket card may also be printed on card stock or laminated to keep with you as license/certificate verification.

Disclaimer

All information provided by LPELS on this web page, and on its other web pages and internet sites, is made available to provide immediate access for the convenience of interested persons. While LPELS believes the information to be reliable, human or mechanical error remains a possibility, as does delay in the posting or updating of information. Therefore, LPELS makes no guarantee as to the accuracy, completeness, timeliness, currency, or correct sequencing of the information. Neither LPELS, nor any of the sources of the information, shall be responsible for any errors or omissions, or for the use or results obtained from the use of this information. Other specific cautionary notices may be included on other web pages maintained by LPELS.

If you need to make changes to your contact information, please choose one of the following options below:

Contact update for [Individuals and Firms](#)

License/Certificate Types:

EF = Engineering Firm

VF = Land Surveying Firm

CPD = Continuing Professional Development Sponsor/Provider

*PE = Professional Engineer

*PLS = Professional Land Surveyor

*EI = Engineer Intern

*LSI = Land Surveyor Intern

*PE Discipline Codes

AG	Agricultural	ME	Mechanical
AR	Architectural	MI	Mining or Mineral
CH	Chemical	MT	Metallurgical
CE	Civil	MU	Manufacturing
CS	Control Systems	NV	Naval Architecture & Marine
EE	Electrical & Computer	NU	Nuclear
EV	Environmental	ST	Structural *
FP	Fire Protection	PT	Petroleum
IE	Industrial		
* An engineer that has passed the Structural I exam is listed as a Civil Engineer. An engineer that has passed both the Structural I and II exams is listed as Structural (ST) and a Civil (CE) Engineer.			

Texas Board of Professional Engineers

*By This Certificate Bears Witness That in
Acknowledgement of Intent to Become Licensed*

Shishir Chandrakant Pedamkar

Is Hereby Recognized As An

Engineer-In-Training

Within the State of Texas

Date: June 18th, 2015

Expires: June 18th, 2023

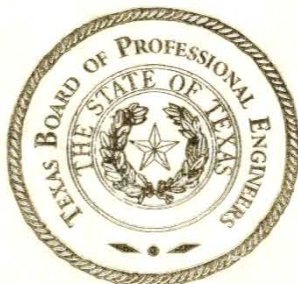

EIT No. 36247

BOARD CHAIR

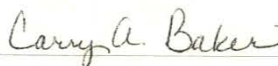
BOARD SECRETARY

THIS IS NOT A LICENSE TO PRACTICE PROFESSIONAL ENGINEERING

State of Louisiana
Board of Architectural Examiners

The individual whose name appears on this certificate is in compliance with the provisions of the Louisiana State Board of Architectural Examiners' Licensing Law and Rules and Regulations and is duly registered and entitled to practice architecture in the State of Louisiana.

LICENSE NO. 8239

EXPIRES December 31, 2022

Gregory J. Eckert, NCARB

President

Secretary

Executive Director

December 7, 2021

\$90.00

Date

Fee Paid



(ALL LICENSES BECOME DELINQUENT AFTER EXPIRATION DATE)

State of Louisiana
Board of Architectural Examiners



License No. 8239

Expires: December 31, 2022

Gregory J. Eckert, NCARB

The above named is duly registered and entitled to practice Architecture in the State of Louisiana until the indicated expiration date.

Ms. K. E. Hillegas, Executive Director