



**5000124279 ONE TIME PURCHASE OF HORIZONTAL SELF-PRIMING
CENTRIFUGAL PUMP FOR THE JEFFERSON PARISH DEPARTMENT OF
SEWERAGE**

Jefferson Parish Government

Project documents obtained from www.CentralBidding.com

08-Oct-2018 09:27:38 AM



Bid Number 50 – 00124279

**ONE TIME PURCHASE OF HORIZONTAL SELF-PRIMING CENTRIFUGAL
PUMP FOR THE JEFFERSON PARISH DEPARTMENT OF SEWERAGE**

OCTOBER 11, 2018 AT 2:00 PM

ATTENTION VENDORS!!!

Please review all pages and respond accordingly, complying with all provisions in the technical specifications and Jefferson Parish Instructions for Bidders and General Terms and Conditions. All bids must be received in the Purchasing Department by the bid due date and time.

**Jefferson Parish Purchasing Department
200 Derbigny Street
General Government Building, Suite 4400
Gretna, LA 70053
Donna Evans
DMEvans@Jeffparish.net
504-364-2691**

DATE: 9/26/2018

BID NO.: 50-00124279

INVITATION TO BID
THIS IS NOT AN ORDER

Page: 1

JEFFERSON PARISH

PURCHASING DEPARTMENT
P.O. BOX 9
GRETN, LA. 70054-0009
504-364-2678

BUYER: DMEVANS@jeffparish.net

BIDS WILL BE RECEIVED IN THE WEST BANK PURCHASING DEPT, SUITE 4400, JEFFERSON PARISH GENERAL GOVERNMENT BUILDING, 200 DERBIGNY STREET, GRETN, LA 70053 UNTIL 2:00 PM, 10/11/2018 AND PUBLICLY OPENED THEREAFTER.

For convenience, bidders may also submit bids in the East Bank Purchasing Department, Suite 404, Jefferson Parish Joseph S. Yenni Building, 1221 Elmwood Park Blvd., Jefferson LA 70123. However, if submitting bids on the day of bid opening, bidders must submit at the West Bank location only. All bids will be publicly opened at the West Bank location.

At no charge, bidders may also submit via Jefferson Parish's electronic procurement page by visiting www.jeffparishbids.net to register for this free site. Additional instructions are included in the text box highlighting electronic procurement.

LATE BIDS WILL NOT BE ACCEPTED

Unless submitting via online (see Page 3), each bid must be submitted in a sealed envelope bearing on the outside; the name of the Bidder, his address, and the name of the project for which the bid is submitted and the bid number.

NOTE: ONLY BIDS WRITTEN IN INK OR TYPEWRITTEN, AND PROPERLY SIGNED BY A MEMBER OF THE FIRM OR AUTHORIZED REPRESENTATIVE, WILL BE ACCEPTED. PENCIL AND/OR PHOTOSTATIC FIGURES OR SIGNATURES SHALL RESULT IN BID REJECTION.

INSTRUCTIONS FOR BIDDERS AND GENERAL CONDITIONS

THE FOLLOWING INSTRUCTIONS APPLY TO ALL BIDS

All bids submitted are subject to these instructions and general conditions and any special conditions and specifications contained herein, all of which are made part of this bid proposal reference. By submitting a bid, vendor agrees to comply with all provisions of Louisiana Law as well be in compliance with the Jefferson Parish Code of Ordinances, Louisiana Code of Ethics, applicable Jefferson Parish ethical standards and Jefferson Parish Resolution No. 113646 and/or Resolution No. 113647.

All vendors submitting bids should register as a Jefferson Parish vendor if not already yet registered. Registration forms may be downloaded from <http://purchasing.jeffparish.net> and by clicking on Vendor Information. Current W-9 forms with respective Tax Identification numbers and vendor applications may be submitted at any time; however, if your company is not registered and/or a current W-9 form is not on file, vendor registration is mandatory. Further, a current W-9 form and respective Tax Identification number must be supplied upon contract execution, should you be awarded a contract and/or issued purchase order. Failure to do so may result in delay of payment.

All quotations shall be based on F.O.B. Agency warehouse or job site, anywhere within the Parish as designated by the Purchasing Department. This provision does not apply to public works projects

JEFFERSON PARISH requires all products to be new (current) and all work must be performed according to standard practices for the project. Unless otherwise specified, no aftermarket parts will be accepted. Unless otherwise specified, all workmanship and materials must have at least one (1) year guaranty, in writing, from the date of delivery and/or acceptance of the project. Any deviations or alterations from the specifications must be indicated and/or supporting documentation supplied with bid submission.

Bidders should submit all questions in writing via email to the buyer's email address as indicated above, no later than Five (5) working days prior to the bid opening. Bid numbers should be mentioned in all requests. If submitting online, vendors may send questions via the E-Procurement site no later than Five (5) working days prior to the bid opening.

If this bid requires a pre-bid conference (see Additional Requirements section), bidders are advised that such conference will be held to allow bidders the opportunity to identify any discrepancies in the bid specifications and seek further clarification regarding instructions. The Purchasing Department will issue a written response to bidders' questions in the form of an Addendum. Please note that all official communication will be expressed in the form of an addendum.

All formal Addenda require written acknowledgement on the bid form by the bidder. Failure to acknowledge an Addendum on the bid form shall cause the bid to be rejected. JEFFERSON PARISH reserves the right to award bid to next lowest responsive and responsible bidder in this event.

The purpose and intention of this invitation to bid is to afford all suppliers an equal opportunity to bid on all construction, maintenance, repair, operating supplies and/or equipment listed in this bid proposal. JEFFERSON PARISH WILL ACCEPT ONE BID ONLY FROM EACH VENDOR. Items bid must meet specifications.

Visit our website at [HTTP://PURCHASING.JEFFPARISH.NET](http://PURCHASING.JEFFPARISH.NET)

JEFFERSON PARISH will accept one price for each item unless otherwise indicated. Two or more prices for one item will result in bid rejection. Bidders are required to complete, sign and return the bid form and/or complete and return the associated line item pricing forms as indicated. Vendors must not alter the bid forms. Doing so will cause the bid to be rejected.

A corporate resolution or written evidence of the individual signing the bid having such authority must be submitted with the bid. Failure to comply will cause bid to be rejected. For corporate entities, such written evidence may be a printout of the Louisiana Secretary of State's website listing the signatory as an officer. Such printout shall be included with the bid submission. Bids submitted by Owners or Sole Proprietorships must include certification that he or she owns the entity for which the bid is signed. This documentation must be submitted with the bid. Failure to do so will result in bid rejection.

NOTE: A sample corporate resolution can be downloaded from our website <http://purchasing.jeffparish.net> or you may provide your own document. A sample certification of sole proprietorship can also be downloaded from our website <http://purchasing.jeffparish.net> or you may provide your own document.

INSTRUCTIONS FOR BIDDERS AND GENERAL CONDITIONS

A. AWARD OF CONTRACT: JEFFERSON PARISH reserves the right to award contracts or place orders on a lump sum or individual item basis, or such combination, as shall in its judgment be in the best interest of JEFFERSON PARISH. Every contract or order shall be awarded to the LOWEST RESPONSIVE and RESPONSIBLE BIDDER, taking into consideration the CONFORMITY WITH THE SPECIFICATIONS and the DELIVERY AND/OR COMPLETION DATE. SPLIT AWARDS MADE TO SEVERAL VENDORS WILL ONLY BE GRANTED TO THOSE DEEMED RESPONSIVE AND RESPONSIBLE.

All bid prices shall remain valid for 45 days. Jefferson Parish and the lowest responsive and responsible bidder(s) by mutual written consent may mutually agree to extend the deadline for award by one (1) or more extensions of thirty (30) calendar days.

PROTESTS: Only those vendors that submitted a bid in response to this solicitation may submit a protest in writing to the Director of the Purchasing within 48 hours of bid opening. The Purchasing Director will review it in connection with the Parish Attorney's Office which will then respond in writing as soon as possible.

PREFERENCE: Unless federal funding is directly spent by Jefferson Parish for this purchase, preference is hereby given to materials, supplies, and provisions produced, manufactured or grown in Louisiana, quality being equal to articles offered by competitors outside the state. "LSA – R.S. 38:2251-2261"

B. USE OF BRAND NAMES AND STOCK NUMBERS: Where brand names and stock numbers are specified, it is for the purpose of establishing certain minimum standards of quality. Bids may be submitted for products of equal quality, provided brand names and stock numbers are specified. Complete product data may be required prior to award.

C. CANCELLATION OF CONTRACT: JEFFERSON PARISH reserves the right to cancel all or any part if not shipped promptly. No charges will be allowed for parking or cartage unless specified in quotation. The order must not be filled at a higher price than quoted. JEFFERSON PARISH reserves the right to cancel any contract at anytime and for any reason by issuing a THIRTY (30) day written notice to the contractor.

For good cause and as consideration for executing a contract with Jefferson Parish, vendor conveys, sells, assigns and transfers to Jefferson Parish or its assigns all rights, title and interest in and to all causes of action it may now or hereafter acquire under the antitrust laws of the United States and the State of Louisiana, relating to the particular good or services purchased or acquired by Jefferson Parish.

D. PRICES: Jefferson Parish is exempt from paying sales tax under LSA-R.S. 47:301 (8)(c). All prices for purchases by Jefferson Parish of supplies and materials shall be quoted in the unit of measure specified and unless otherwise specified, shall be exclusive of state and Parish taxes. The price quoted for work shall be stated in figures. In the event there is a difference in unit prices and totals, the unit price shall prevail.

Quantities listed are for bidding purposes only. Actual requirements may be more or less than quantities listed.

Bidders are not to exclude from participation in, deny the benefits of, or subject to discrimination under any program or activity, any person in the United States on the grounds of race, color, national origin, or sex; nor discriminate on the basis of age under the Age Discrimination Act of 1975, or with respect to an otherwise qualified handicapped individual as provided in Section 504 of the Rehabilitation Act of 1973, or on the basis of religion, except that any exemption from such prohibition against discrimination on the basis of religion as provided in the Civil Rights Act of 1964, or Title VI and VII of the Act of April 11, 1968, shall also apply. This assurance includes compliance with the administrative requirements of the Revenue Sharing final handicapped discrimination provisions contained in Section 51.55 (c), (d), (e), and (k)(5) of the Regulations. New construction or renovation projects must comply with Section 504 of the 1973 Rehabilitation Act, as amended, in accordance with the American National Standard Institute's specifications (ANSI A17.1-1961).

Jefferson Parish and its partners as the recipients of federal funds are fully committed to awarding a contract(s) to firm(s) that will provide high quality services and that are dedicated to diversity and to containing costs. Thus, Jefferson Parish strongly encourages the involvement of minority and/or woman-owned business enterprises (DBE's, including MBE's, WBE's and SBE's) to stimulate participation in procurement and assistance programs.

INSTRUCTIONS FOR BIDDERS AND GENERAL CONDITIONS

Advertised bids will be tabulated and a copy of the tabulation will be forwarded to each responding bidder.

IN ACCORDANCE WITH STATE REGULATIONS JEFFERSON PARISH OFFERS ELECTRONIC PROCUREMENT TO ALL VENDORS

This electronic procurement system allows vendors the convenience of reviewing and submitting bids online. This is a secure site and authorized personnel have limited read access only. Bidders are encouraged to submit electronically using this free service; while the website accepts various file types, one single PDF file containing all appropriate and required bid documents is preferred. Bidders submitting uploaded images of bid responses are solely responsible for clarity. If uploaded images/documents are not legible, then bidder's submission will be rejected. Please note all requirements contained in this bid package for electronic bid submission.

Please visit our E-Procurement Page at www.jeffparishbids.net to register and view Jefferson Parish solicitations. For more information, please visit the Purchasing Department page at <http://purchasing.jeffparish.net>.

The general specifications for construction projects and the purchase of materials, services and/or supplies are those adopted by the JEFFERSON PARISH Council by Resolution No. 113646 or 113647 dated 12/09/09. The general conditions adopted by this resolution shall be considered as much a part of this document as if they were written wholly herein. A copy may be obtained from the Office of the Parish Clerk, Suite 6700, Jefferson Parish General Government Building, 200 Derbigny Street, Gretna, LA 70053. You may also obtain a copy by visiting the Purchasing Department webpage at <http://purchasing.jeffparish.net> and clicking on Online Forms.

ADDITIONAL REQUIREMENTS FOR THIS BID

PLEASE MATCH THE NUMBERS PRINTED IN THIS BOX WITH THE
CORRESPONDING INSTRUCTIONS BELOW.

13,15

1. All bidders must attend the MANDATORY pre-bid conference and will be required to sign in and out as evidence of attendance. In accordance with LSA R.S. 38:2212(I), all prospective bidders shall be present at the beginning of the MANDATORY pre-bid conference and shall remain in attendance for the duration of the conference. Any prospective bidder who fails to attend the conference or remain for the duration shall be prohibited from submitting a bid for the project.
2. Attendance to this pre-bid conference is optional. However, failure to attend the pre-bid conference shall not relieve the bidder of responsibility for information discussed at the conference. Furthermore, failure to attend the pre-bid conference and inspection does not relieve the successful bidder from the necessity of furnishing materials or performing any work that may be required to complete the work in accordance with the specification with no additional cost to the owner.
3. Contractor must hold current applicable JEFFERSON PARISH licenses with the Department of Inspection and Code Enforcement. Contractor shall obtain any and all permits required by the JEFFERSON PARISH Department of Inspection and Code Enforcement. The contractor shall be responsible for the payment of these permits. All permits must be obtained prior to the start of the project. Contractor must also hold any and all applicable Federal and State licenses. Contractor shall be responsible for the payment of these permits and shall obtain them prior to the start of the project.
4. A LA State Contractor's License will be required in accordance with LSA R.S. 37-2150 et. seq. and such license number will be shown on the outside of the bid envelope. Failure to comply will cause the bid to be rejected. Additionally if submitting the bid electronically, then the license number must be entered in the appropriate field in the Electronic Procurement system. Failure to comply will cause the bid to be rejected.
5. It is the bidder's responsibility to visit the job site and evaluate the job before submitting a bid.
6. Job site must be clean and free of all litter and debris daily and upon completion of the contract. Passageways must be kept clean and free of material, equipment, and debris at all times. Flammable material must be removed from the job site daily because storage will not be permitted on the premises. Precautions must be exercised at all times to safeguard the welfare of JEFFERSON PARISH and the general public.

INSTRUCTIONS FOR BIDDERS AND GENERAL CONDITIONS

7. **PUBLIC WORKS BIDS:** All awards for public works in excess of \$5,000.00 will be reduced to a formal contract which shall be recorded at the contractor's expense with the Clerk of Court and Ex-Officio Recorder of Mortgages for the Parish of Jefferson. A price list of recordation costs may be obtained from the Clerk of Court and Ex-Officio Recorder of Mortgages for the Parish of Jefferson. All awards in excess of \$25,000.00 will require both a performance and a payment bond. Unless otherwise stated in the bid specifications, the performance bond requirements shall be 100% of the contract price. Unless otherwise state in the bid specifications, the payment bond requirements shall be 100% of the contract price. Both bonds shall be supplied at the signing of the contract.
8. **NON-PUBLIC WORKS BIDS:** A performance bond will be required for this bid. The amount of the bond will be 100% of the contract price unless otherwise indicated in the specifications. The performance bond shall be supplied at the signing of the contract.
9. **NON-PUBLIC WORKS BIDS:** A payment bond will be required for this bid. The amount of the bond will be 100% of the contract price unless otherwise indicated in the specifications. The payment bond shall be supplied at the signing of the contract.
10. All bidders must comply with the requirements stated in the attached "Standard Insurance Requirements" sheet attached to this bid solicitation. Prior to contract executions/purchase order issuance, the successful bidder will be required to provide final insurance certificates which shall name Jefferson Parish as an additional insured in accordance with the instructions in the aforementioned "Standard Insurance Requirements" sheet.
11. A bid bond will be required with bid submission in the amount of 5% of the total bid, unless otherwise stated in the bid specifications. Acceptable forms shall be limited to cashier's check, certified check, or surety bid bond. All sureties must be in original format (no copies) If submitting a bid online, vendors must submit an electronic bid bond through the respective online clearinghouse bond management system(s) as indicated in the electronic bid solicitation on Central Auction House. No scanned paper copies of any bid bond will be accepted as part of the electronic bid submission.
12. This is a requirements contract to be provided on an as needed basis. JEFFERSON PARISH makes no representations on warranties with regard to minimum guaranteed quantities unless otherwise stated in the bid specifications.
13. Freight charges should be included in total cost when quoting. If not quoted FOB DELIVERED, freight must be quoted as a separate item. Bid may be rejected if not quoted FOB DELIVERED or if freight charges are not indicated on bid form.
14. **PUBLIC WORKS BIDS - Completed, Signed and Properly Notarized Affidavits Required;** This applies to all solicitations for construction, alteration or demolition of public buildings or projects, in conformity with the provisions contained in LSA-RS 38:2212.9, LSA-RS 38:2212.10, LSA-RS 38:2224, and Sec 2-923.1 of the Jefferson Parish Code of Ordinances. For bidding purposes, all bidders must submit with bid submission COMPLETED, SIGNED and PROPERLY NOTARIZED Affidavits, including: Non-Collusion Affidavit, Non-Collusion Affidavit, Campaign Contribution Affidavit, Debt Disclosures Affidavit and E-Verify Affidavit. For the convenience of vendors, all affidavits have been combined into one form entitled PUBLIC WORKS BID AFFIDAVIT. This affidavit must be submitted in its original format, and without material alteration, in order to be compliant and for the bid to be considered responsive. A scanned copy of the completed, signed and properly notarized affidavit may be submitted with the bid, however, the successful bidder must submit the original affidavit in its original format and without material alteration upon contract execution. Failure to comply will result in the bid submission being rejected as non-responsive. The Parish reserves the right to award bid to the next lowest responsive and responsible bidder in this event.
15. **NON PUBLIC WORK BIDS - Completed, Signed and Properly Notarized Affidavits Required** in conformity with the provisions contained in LSA – RS 38:2224 and Sec 2-923.1 of the Jefferson Parish Code of Ordinances. For bidding purposes, all bidders must submit with bid submission COMPLETED, SIGNED and PROPERLY NOTARIZED Affidavits, including: Non-Collusion Affidavit, Debt Disclosures Affidavit and Campaign Contribution Affidavit. For the convenience of vendors, all affidavits have been combined into one form entitled NON PUBLIC WORKS BID AFFIDAVIT. This affidavit must be submitted in its original format, and without material alteration, in order to be compliant and for the bid to be considered responsive. A scanned copy of the completed, signed and properly notarized affidavit may be submitted with the bid, however, the successful bidder must submit the original affidavit in its original format and without material alteration upon contract execution. Failure to comply will result in the bid submission being rejected as non-responsive. The Parish reserves the right to award bid to the next lowest responsive and responsible bidder in this event.
16. The ensuing contract for this bid solicitation may be eligible for FEMA reimbursement and/or Federal funding/reimbursement. As such, the referenced appendix will be applicable accordingly and shall be considered a part of the bid documents. All applicable certifications must be duly completed, signed and submitted with bid submission. Failure to submit applicable certifications with bid submission will result in bid rejection.
17. For this project, the Contractor shall not pay any state or local sales or use taxes on materials and equipment which are affixed and made part of the immovable property of the project or which permanently incorporated in the project (hereinafter referred to as "applicable materials and equipment"). All purchases of applicable materials or equipment shall be made by the contractor on behalf of and as the agent of Jefferson Parish (Owner), a political subdivision of the State of Louisiana. No state and local sales and use taxes are owned on applicable materials and equipment under the provisions of Act 1029 of the 1991 Regular Session – Louisiana Revised Statute 47:301(8)(c). Owner will furnish contractor a certificate form which certifies that Owner is not required to pay such state or local sales and use taxes, and contractor shall furnish a copy of such certificate to all vendors or suppliers of the applicable materials and equipment

It shall be the duty of every parish officer, employee, department, agency, special district, board, and commission: and the duty of every contractor, subcontractor, and licensee of the parish, and the duty of every applicant for certification of eligibility for a parish contract or program, to cooperate with the Inspector General in any investigation, audit, inspection, performance review, or hearing pursuant to Jefferson Parish Code of Ordinances Section 2-155.10(19). By submitting a bid, vendor acknowledges this and will abide by all provisions of the referenced Jefferson Parish Code of Ordinances.

DATE: 9/26/2018

Page: 5

BID NO.: 50-00124279

BID FORM
Non Public Works

All Public Work Projects are required to use the Louisiana Uniform Public Work Bid Form

All prices must be held firm unless an escalation provision is requested in this bid. Jefferson Parish will allow one escalation during the term of the contract, which may not exceed the U.S. Bureau of Labor Statistics National Index for all Urban Consumers, unadjusted 12 month figure. The most recently published figure issued at the time an adjustment is requested will be used. A request must be made in writing by the vendor, and the escalation will only be applied to purchases made after the request is made.

Are you requesting an escalation provision?

YES _____ NO X

MAXIMUM ESCALATION PERCENTAGE REQUESTED _____ %

INITIAL BID PRICES WILL REMAIN FIRM THROUGH THE DATE OF AWARD

For the purposes of comparison of bids when an escalation provision is requested, Jefferson Parish will apply the maximum escalation percentage quoted by the bidder to the period to which it is applied in the bid. The initial price and the escalation will be used to calculate the total bid price. It will be assumed, for comparison of prices only, that an equal amount of material or labor is purchased each month throughout the entire contract.

DELIVERY: FOB JEFFERSON PARISH

INDICATE DELIVERY DATE ON EQUIPMENT AND SUPPLIES

4-6 Weeks

LOUISIANA CONTRACTOR'S LICENSE NO.: (if applicable) _____

THIS SECTION MUST BE COMPLETED BY BIDDER:

FIRM NAME: WASTEWATER SOLUTIONS, LLC

ADDRESS: 102 NE 2nd St., Suite 510

CITY, STATE: Boca Raton, FL

ZIP: 33432

TELEPHONE: (954) 483-9269

FAX: () _____

EMAIL ADDRESS: arturo@wws-llc.com

In the event that addenda are issued with this bid, bidders MUST acknowledge all addenda on the bid form. Bidder must acknowledge receipt of an addendum on the bid form as indicated. Failure to acknowledge any addendum on the bid form will result in bid rejection.

Acknowledge Receipt of Addenda: NUMBER: 1 Received

NUMBER: _____

NUMBER: _____

NUMBER: _____

TOTAL PRICE OF ALL BID ITEMS: \$42,940

AUTHORIZED

SIGNATURE: 

ARTURO GARCIA

Printed Name

TITLE: President

SIGNING INDICATES YOU HAVE READ AND COMPLY WITH THE INSTRUCTIONS AND CONDITIONS.

NOTE: All bids should be returned with the BID NUMBER and BID OPENING DATE indicated on the outside of the envelope submitted to the Purchasing Department.

INVITATION TO BID FROM JEFFERSON PARISH - continued

BID NO.: 50-00124279

SEALED BID

ITEM NUMBER	QUANTITY	U/M	DESCRIPTION OF ARTICLES	UNIT PRICE QUOTED	TOTALS
1	2.00	EA	<p>ONE TIME PURCHASE OF HORIZONTAL SELF-PRIMING CENTRIFUGAL PUMP FOR THE JEFFERSON PARISH DEPARTMENT OF SEWERAGE</p> <p>0010 - Self Priming Centrifugal Pump, with optional discharge spool flange GR Hard Iron - ADI (austempered ductile iron fitted), Gorman-Rupp Model T8A71S-B, Size 8 inch x 8 inch</p> <p>Pump to be mounted on sturdy fab steel base in the vertical v-belt arrangement with drive sheaves and belts with guard and driven by a 40-HP, TEFC, NEMA premium efficiency 3-phase electric motor and coated with our standard shop coating system</p> <p>SEE ATTACHED SPECIFICATIONS</p>	\$21,470	\$42,940

That no part of the contract price received by Affiant was paid or will be paid to any person, corporation, firm, association, or other organization for soliciting the contract, other than the payment of their normal compensation to persons regularly employed by the Affiant whose services in connection with the construction, alteration or demolition of the public building or project were in the regular course of their duties for Affiant.

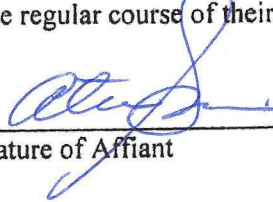

Signature of Affiant

Arturo Garcia

Printed Name of Affiant

SWORN AND SUBSCRIBED TO BEFORE ME

ON THE 10th DAY OF October, 2018.



Notary Public

Meredith Rae

Printed Name of Notary

FF167237

Notary/Bar Roll Number



MEREDITH RAE
MY COMMISSION # FF 167237
EXPIRES: November 13, 2018
Bonded Thru Budget Notary Services

My commission expires 11/13/2018.

SPECIFICATIONS
SUPER T SERIES 8 GR Hard Iron Fitted
HORIZONTAL SELF-PRIMING CENTRIFUGAL PUMP
JEFFERSON PARISH DEPT. OF SEWERAGE
AZALEA & GARDENIA LIFT STATION

PART 1 - GENERAL

1.01 PERFORMANCE CRITERIA

- A. The pump manufacturer must be ISO 9001:2008 revision certified, with scope of registration including design control and service after sales activities.
- B. The pump manufacturer must be registered to the ISO 14001 Environmental Management System standard and as such is committed to minimizing the impact of its activities on the environment and promoting environmental sustainability by the use of best management practices, technological advances, promoting environmental awareness, and continual improvement.
- C. Pumps must be designed to handle raw, unscreened, domestic sanitary sewage. Pumps shall have 8" suction connection, and 8" discharge connection.
- D. Pump Performance Certifications
 - 1. Solids Handling Capability
 - a. All internal passages, impeller vanes, and recirculation ports shall pass a 3 inch spherical solid. Smaller internal passages that create a maintenance nuisance or interfere with priming and pump performance will not be accepted. Upon request, manufacturer's certified drawings showing size and location of the recirculation port(s) shall be submitted for approval.
- E. Reprime Performance
 - 1. Consideration shall be given to the sanitary sewage service anticipated, in which debris is expected to lodge between the suction check valve and its seat, resulting in the loss of the pump suction leg, and siphoning of liquid from the pump casing to the approximate center line of the impeller. Such occurrence shall be considered normal, and the pump must be capable of automatic, unattended operation with an air release line installed.
 - 2. During unattended operation, the pump shall retain adequate liquid in the casing to insure automatic repriming, while operating at its rated speed in a completely open system. The need for a suction check valve or external priming device shall not be required.
 - 3. Pump must reprime at the specified speed and impeller diameter. Reprime lift is defined as the static height of the pump suction above the liquid, while operating with only one-half of the liquid remaining in the pump casing. The pump must reprime and deliver full capacity within five minutes after the pump is energized in the reprime condition. Reprime performance must be confirmed with the following test set-up:
 - a. A check valve to be installed down stream from the pump discharge flange. The check valve size shall be equal (or greater than) the pump discharge diameter.

- b. A length of air release pipe shall be installed between pump and the discharge check valve. This line shall be open to atmosphere at all times, duplicating the air displacement rate anticipated at a typical pump station fitted with an air release valve.
- c. The pump suction check valve shall be removed. No restrictions in the pump or suction piping will prevent the siphon drop of the suction leg. Suction pipe configuration for reprime test shall incorporate a 2 feet minimum horizontal run, a 90° elbow, and vertical run at the specified lift. Pipe size shall be equal to the pump suction diameter.
- d. Impeller clearances shall be set as recommended in the pump service manual.
- e. Repeatability of performance shall be demonstrated by testing five consecutive reprime cycles. Full pump capacity (flow) shall be achieved within five minutes during each cycle.
- f. Liquid to be used for reprime test shall be water.
- g. Upon request, certified reprime performance test results, prepared by the manufacturer, and certified by a registered professional engineer, shall be submitted for approval prior to shipment.

F. Manufacturer's Warranty

- 1. The pump manufacturer shall warrant the pump equipment to be of quality construction, free of defects in material and workmanship. A written warranty shall include specific details described below.
- 2. All equipment, apparatus, and parts furnished shall be warranted for sixty (60) months, excepting only those items that are normally consumed in service, such as oils, grease, packing, gaskets, O-rings, etc. The pump manufacturer shall be solely responsible for warranty of the pump equipment and all components.
- 3. Components failing to perform as specified by the engineer, or as represented by the manufacturer, or as proven defective in service during the warranty period, shall be replaced, repaired, or satisfactorily modified by the manufacturer.
- 4. It is not intended that the pump manufacturer assume liability for consequential damages or contingent liabilities arising from failure of any vendor supplied product or part which fails to properly operate, however caused. Consequential damages resulting from defects in design, or delays in delivery are also beyond the manufacturer's scope of liability.
- 5. This limited warranty shall be valid only when installation is made, and use and maintenance is performed in accordance with manufacturer recommendations. The warranty shall become effective on the date of acceptance by the purchaser or the purchaser's authorized agent, or sixty (60) days after installation, or ninety (90) days after shipment from the factory, whichever occurs first.

Pumps are to be furnished by a Factory Authorized Distributor of the pumps offered who maintains spare parts inventory, as well as a warranty service center.

PART 2 - PRODUCT

2.01 MANUFACTURER

- A. The specified pumps shall be the Gorman-Rupp Model T8A71S-B/F pump with GR "Hard Iron Fitted" option, with all equipment and materials manufactured by The Gorman-Rupp Company manufactured by Gorman-Rupp, or approved equal. The specified pumps are deemed most suitable for the service anticipated. Pumps shall be offered and sold only by a factory authorized sales agent of the manufacturer of the pump offered.
- B. The pumps are to be the Gorman-Rupp SUPER T-Series Model T8A71S-B/F, or approved equal, with optional Gorman-Rupp "Hard Iron" hardened iron impeller, seal plate, and wear plate all hardened to a minimum of 400 Brinell and must be of standard catalog design, totally warranted by the manufacturer. Pumps to be furnished must be manufactured in the USA.
- C. Manufacturer must show proof of USA origin, original product design, and testing. Products violating intellectual property regulations will not be accepted, as they may violate international law and expose the user or engineer to unintended liabilities. "Reverse-engineered" products fabricated to substantially duplicate the design of original product will not be accepted, as they may contain substantial differences in tolerances and material applications addressed in the original design, which may contribute to product failure.
- D. The term "pump manufacturer" shall be defined as the entity which designs, machines, assembles, hydraulically tests, and warranties the final product. Any entity that does not meet this definition will not be considered a "pump manufacturer", and is not an acceptable supplier. For quality control reasons, and future pump and parts availability, all major castings shall be sourced and machined in North America and the pumps must be manufactured in the USA.

2.02 PUMP DESIGN

- A. Pumps shall be horizontal, self-priming centrifugal type, designed specifically for handling raw, unscreened, domestic sanitary sewage. Pump solids handling capability and performance criteria shall be in accordance with requirements listed under PART 1 - GENERAL.
- B. The pump manufacturer must be ISO 9001:2008 revision certified, with scope of registration including design control and service after sales activities.
- C. Materials and Construction Features
 - 1. Pump casing shall be cast iron Class 30, with integral volute scroll. Casing shall incorporate following features:
 - a. Mounting feet sized to prevent tipping or binding when pump is completely disassembled for maintenance.
 - b. Fill port cover plate, 3 ½ inch diameter, shall be opened after loosening a hand nut/clamp bar assembly. In consideration for safety, hand nut threads must provide slow release of pressure, and the clamp bar shall be retained by detent lugs. A Teflon gasket shall prevent adhesion of the fill port cover to the casing.
 - c. Casing drain plug shall be at least 1 ¼ inch NPT to insure complete and rapid draining.

- d. Liquid volume and recirculation port design shall be consistent with performance criteria listed under PART 1 - GENERAL.
2. Cover plate shall be cast iron Class 30. Design must incorporate following maintenance features:
- a. Retained by minimum of 4 nuts for complete access to pump interior. Cover plate removal must provide ample clearance for removal of stoppages, and allow service to the impeller, seal, wear plate, or check valve without removing suction or discharge piping.
 - b. A replaceable wear plate secured to the cover plate by weld studs and nuts shall be GR Hard Iron.
 - c. In consideration for safety, a pressure relief valve shall be supplied in the cover plate. Relief valve shall open at 75-200 PSI.
 - d. Two O-rings of Buna-N material shall seal cover plate to pump casing.
 - e. Pusher bolt capability to assist in removal of cover plate. Pusher bolt threaded holes shall be sized to accept same retaining cap screws as used in rotating assembly.
 - f. Easy-grip handle shall be mounted to face of cover plate.
3. Rotating assembly, which includes impeller, shaft, mechanical shaft seal, lip seals, bearings, seal plate, and bearing housing, must be removable as a single unit without disturbing the pump casing or piping. Design shall incorporate following features:
- a. Seal plate shall be GR Hard Iron and bearing housing shall be cast iron Class 30. Separate oil filled cavities, vented to atmosphere, shall be provided for shaft seal and bearings. Cavities must be cooled by the liquid pumped. Three lip seals will prevent leakage of oil.
 - 1) The bearing cavity shall have an oil level sight gauge and fill plug check valve. The clear sight gauge shall provide easy monitoring of the bearing cavity oil level and condition of oil, without removal of the fill plug check valve. The check valve shall vent the cavity but prevent introduction of moist air to the bearings.
 - 2) The seal cavity shall have an oil level sight gauge and fill/vent plug. The clear sight gauge shall provide easy monitoring of the seal cavity oil level and condition of oil, without removal of the fill/vent plug.
 - 3) Double lip seal shall provide an atmospheric path providing positive protection of bearings, with capability for external drainage monitoring.
 - b. Impeller shall be "ADI" GR Hard Iron, two-vane, semi-open, non-clog, with integral pump out vanes on the back shroud. Impeller shall thread onto the pump shaft and be secured with a lock screw and conical washer.
 - c. Shaft shall be AISI 4140 alloy steel.
 - d. Bearings shall be anti-friction ball type of proper size and design to withstand all radial and thrust loads expected during normal operation. Bearings shall be oil

lubricated from a dedicated reservoir. Pump designs which use the same oil to lubricate the bearings and shaft seal will not be accepted.

- e. Shaft seal shall be cartridge oil lubricated mechanical type. The stationary and rotating seal faces shall be silicon carbide. Each mating surface shall be lapped to within three light bands flatness (35 millionths of an inch), as measured by an optical flat under monochromatic light. The stationary seal seat shall be double floating by virtue of a dual O-ring design; an external O-ring secures the stationary seat to the seal plate, and an internal O-ring holds the faces in alignment during periods of mechanical or hydraulic shock (loads which cause shaft deflection, vibration, and axial/radial movement). Elastomers shall be viton; cage and spring to be 18-8 stainless steel. Seal shall be oil lubricated from a dedicated reservoir. The same oil shall not lubricate both shaft seal and shaft bearings. Seal shall be warranted in accordance with requirements listed under PART 1 - GENERAL.
 - f. Pusher bolt capability to assist in removal of rotating assembly. Pusher bolt threaded holes shall be sized to accept same cap screws as used for retaining rotating assembly.
4. Adjustment of the impeller face clearance (distance between impeller and wear plate) shall be accomplished by external means.
- a. Clearances shall be maintained by a four point external shimless cover plate adjustment system, utilizing a four collar and four adjusting screw design, allowing for incremental adjustment of clearances by hand as required. Each of the four points shall be lockable to prevent inadvertent clearance increases or decreases due to equipment vibration or accidental operator contact. The four point system also allows for equal clearance gaps at all points between the impeller and wear plate. Requirement of realignment of belts, couplings, etc., will not be accepted. Cover plate shall be capable of being removed without disturbing clearance settings. Clearance adjustment systems that utilize less than four points will not be accepted.
 - b. There shall be provisions for additional clearance adjustment in the event that adjustment tolerances have been depleted from the cover plate side of the pump. The removal of stainless steel shims from the rotating assembly side of the pump shall allow for further adjustment, as described above.
 - c. Clearance adjustment which requires movement of the shaft only, thereby adversely affecting seal working length or impeller back clearance, will not be accepted.
5. Suction check valve shall be molded Neoprene with integral steel and nylon reinforcement. A blow-out center shall protect pump casing from hydraulic shock or excessive pressure. Removal or installation of the check valve must be accomplished through the cover plate opening, without disturbing the suction piping. Sole function of check valve shall be to save energy by eliminating need to reprime after each pumping cycle. Pumps requiring a suction check valve to assist reprime will not be accepted.
6. Spool flanges shall be one-piece cast iron, class 30, fitted to suction and/or discharge ports. Each spool shall have one 1-1/4 inch NPT and one 1/4 inch NPT tapped hole with pipe plugs for mounting gauges or other equipment.

2.03 DRIVE UNIT

A. Motors

Pump motors shall be 40 HP, horizontal TEFC, 1,800 RPM, NEMA design B, with cast iron frame, copper windings, induction type, with class F insulation,

and 1.15 Service Factor for normal starting torque and low starting current characteristics, suitable for continuous service. The motors shall not overload at the design condition or at any head in the operating range as specified. Motors shall be suitable for operation using the utility power of 3-phase 240 or 460. Motors are to be NEMA Premium Efficiency. Motors shall be tested in accordance with provisions of ANSI/IEEE Std. 112, Method

B. Drive Transmission

Power to pumps transmitted V-belt drive assemblies. The sheave/belt combination shall provide the speed ratio needed to achieve the specified pump operating conditions.

Each drive assembly shall utilize at least two V-belts providing minimum a combined safety factor of 1.35. Single belt drives or systems with a safety factor of less than 1.5 will not be accepted. Computation of safety factors shall be based on performance data published by the drive manufacturer.

The pump manufacturer shall submit power transmission calculations which document the following:

Ratio of pump/motor speed.

Pitch diameter of driver and driven sheaves.

Number of belts required per drive.

Theoretical horsepower transmitted per belt, based on vendor's data.

Center distance between pump and motor shafts.

Arc-length correction factor applied to theoretical horsepower transmitted.

Service factor applied to established design horsepower.

Safety factor ratio of power transmitted/brake horsepower required.

Pump drives to be enclosed on all sides by a belt guard.

Guards must be completely removable without interference from any unit component, and shall be securely fastened and braced to the unit base.

C. Finish

1. Pumps and exposed steel framework shall be cleaned prior to coating and fully coated with finish paint coating system.

D. Serviceability

1. The pump manufacturer shall demonstrate to the owner's satisfaction that consideration has been given to reducing maintenance costs.
2. No special tools shall be required for replacement of any components within the pump.
3. Field Start-Up Services: Include in the price of each pump a field service call to review the pump installation, to start up, and commission the pump.

CORPORATE RESOLUTION

**** NOT APPLICABLE ****

EXCERPT FROM MINUTES OF MEETING OF THE BOARD OF DIRECTORS OF

INCORPORATED.

AT THE MEETING OF DIRECTORS OF _____
INCORPORATED, DULY NOTICED AND HELD ON _____,
A QUORUM BEING THERE PRESENT, ON MOTION DULY MADE AND SECONDED. IT
WAS:

RESOLVED THAT _____, BE AND IS HEREBY
APPOINTED, CONSTITUTED AND DESIGNATED AS AGENT AND ATTORNEY-IN-
FACT OF THE CORPORATION WITH FULL POWER AND AUTHORITY TO ACT ON
BEHALF OF THIS CORPORATION IN ALL NEGOTIATIONS, BIDDING, CONCERNS
AND TRANSACTIONS WITH THE PARISH OF JEFFERSON OR ANY OF ITS AGENCIES,
DEPARTMENTS, EMPLOYEES OR AGENTS, INCLUDING BUT NOT LIMITED TO, THE
EXECUTION OF ALL BIDS, PAPERS, DOCUMENTS, AFFIDAVITS, BONDS, SURETIES,
CONTRACTS AND ACTS AND TO RECEIVE ALL PURCHASE ORDERS AND NOTICES
ISSUED PURSUANT TO THE PROVISIONS OF ANY SUCH BID OR CONTRACT, THIS
CORPORATION HEREBY RATIFYING, APPROVING, CONFIRMING, AND ACCEPTING
EACH AND EVERY SUCH ACT PERFORMED BY SAID AGENT AND ATTORNEY-IN-
FACT.

I HEREBY CERTIFY THE FOREGOING TO BE
A TRUE AND CORRECT COPY OF AN
EXCERPT OF THE MINUTES OF THE ABOVE
DATED MEETING OF THE BOARD OF
DIRECTORS OF SAID CORPORATION, AND
THE SAME HAS NOT BEEN REVOKED OR
RESCINDED.

SECRETARY-TREASURER

DATE

Non-Public Works Bid Affidavit Instructions

- Affidavit is supplied as a courtesy to Affiants, but it is the responsibility of the affiant to insure the affidavit they submit to Jefferson Parish complies, in both form and content, with federal, state and parish laws.
- Affidavit must be signed by an authorized representative of the entity or the affidavit will not be accepted.
- Affidavit must be notarized or the affidavit will not be accepted.
- Notary must sign name, print name, and include bar/notary number, or the affidavit will not be accepted.
- Affiant **MUST** select either A or B when required or the affidavit will not be accepted.
- Affiants who select choice A must include an attachment or the affidavit will not be accepted.
- If both choice A and B are selected, the affidavit will not be accepted.
- Affidavit marked N/A will not be accepted.
- It is the responsibility of the Affiant to submit a new affidavit if any additional campaign contributions are made after the affidavit is executed but prior to the time the council acts on the matter.

Instruction sheet may be omitted when submitting the affidavit

Non-Public Works Bid

AFFIDAVIT

STATE OF FLORIDA

PARISH/COUNTY OF PALM BEACH

BEFORE ME, the undersigned authority, personally came and appeared: Arturo Garcia
_____, (Affiant) who after being by me duly sworn, deposed and said that
he/she is the fully authorized President of Wastewater Solutions, LLC (Entity),
the party who submitted a bid in response to Bid Number 50-00124279CB, to the Parish of
Jefferson.

Affiant further said:

Campaign Contribution Disclosures

(Choose A or B, if option A is indicated please include the required attachment):

Choice A _____ Attached hereto is a list of all campaign contributions, including the date and amount of each contribution, made to current or former elected officials of the Parish of Jefferson by Entity, Affiant, and/or officers, directors and owners, including employees, owning 25% or more of the Entity during the two-year period immediately preceding the date of this affidavit or the current term of the elected official, whichever is greater. Further, Entity, Affiant, and/or Entity Owners have not made any contributions to or in support of current or former members of the Jefferson Parish Council or the Jefferson Parish President through or in the name of another person or legal entity, either directly or indirectly.

Choice B X there are **NO** campaign contributions made which would require disclosure under Choice A of this section.

Debt Disclosures

(Choose A or B, if option A is indicated please include the required attachment):

Choice A _____ Attached hereto is a list of all debts owed by the affiant to any elected or appointed official of the Parish of Jefferson, and any and all debts owed by any elected or appointed official of the Parish to the Affiant.

Choice B X There are **NO** debts which would require disclosure under Choice A of this section.

Affiant further said:

That Affiant has employed no person, corporation, firm, association, or other organization, either directly or indirectly, to secure the public contract under which he received payment, other than persons regularly employed by the Affiant whose services in connection with the construction, alteration or demolition of the public building or project or in securing the public contract were in the regular course of their duties for Affiant; and

[The remainder of this page is intentionally left blank.]

That no part of the contract price received by Affiant was paid or will be paid to any person, corporation, firm, association, or other organization for soliciting the contract, other than the payment of their normal compensation to persons regularly employed by the Affiant whose services in connection with the construction, alteration or demolition of the public building or project were in the regular course of their duties for Affiant.

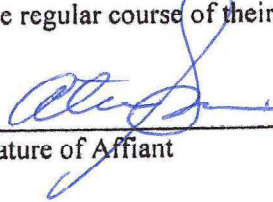

Signature of Affiant

Arturo Garcia

Printed Name of Affiant

SWORN AND SUBSCRIBED TO BEFORE ME

ON THE 10th DAY OF October, 2018.

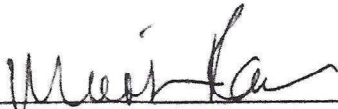

Notary Public

Meredith Rae

Printed Name of Notary

FF167237

Notary/Bar Roll Number



MEREDITH RAE
MY COMMISSION # FF 167237
EXPIRES: November 13, 2018
Bonded Thru Budget Notary Services

My commission expires 11/13/2018.



JEFFERSON PARISH

Department of Purchasing

Michael S. Yenni
Parish President

Renny Simno
Director

July 2018

CHANGES TO JEFFERSON PARISH BIDDING PROCEDURES

The East bank Office of Purchasing is now open! We are located in the Joseph S. Yenni Building, 1221 Elmwood Park Blvd., Suite 404, Jefferson, LA 70123. Bidders may submit bid responses at this location, pending authorization in each bid package. **Bidders should carefully read and must respond accordingly per the requirements of the bid packages. NOTE: Bidders submitting bids on the day of bid opening, bidders must submit at the West Bank location only.**

Other Changes Continued:

- For all advertised sealed bids, written evidence of signature authority must be included with bid submission.
- Current W9 Forms and vendor applications may be submitted at any time; however, if your company is not registered and/or a current W-9 form is not on file, a current W-9 form must be supplied upon contract execution, should you be awarded a contract and/or issued a purchase order.
- **Proof of insurance in the form of a current certificate evidencing coverages is required with bid submission.** Bidders must read the insurance requirements attachment included in each bid package for specific instructions. Upon contract execution, successful bidder must produce final insurance certificates in accordance with Jefferson Parish insurance requirements.

Bidders should reference the "Additional Requirements" section of the bid instructions and/or the "Important Notice to Bidders" included in the bid package for specific requirements to respond accordingly.

For more information, please call Jefferson Parish Purchasing at 504-364-2678.

Joseph S. Yenni Building – 1221 Elmwood Park Blvd., Ste. 404, Jefferson, LA 70123

Office 504.364.2678

General Government Bldg. – 200 Derbigny St – Suite 4400 - Gretna, LA 70053

Office 504.364.2678

Email: Purchasing@jeffparish.net Website: www.jeffparish.net



Wastewater Solutions LLC
102 NE 2nd Street
Suite 510
Boca Raton, FL 33432 US
(954) 483-9269
arturo@wws-llc.com
wws-llc.com

QUOTE

ADDRESS

DONNA EVANS
DMEvans@jeffparish.net
(504) 364 2691
JEFFERSON PARISH
PURCHASING DEPARTMENT
GENERAL GOVERNMENT
BUILDING SUITE 4400
GRETNA, LA 70053

SHIP TO

DONNA EVANS
DMEvans@jeffparish.net
(504) 364 2691
JEFFERSON PARISH
PURCHASING
DEPARTMENT
GENERAL GOVERNMENT
BUILDING SUITE 4400
GRETNA, LA 70053

QUOTE # 2956

DATE 10/10/2018

DELIVERY:

4-6 weeks

DESCRIPTION	QTY	RATE	AMOUNT
Sales	2	21,470.00	42,940.00
WASTECORP TRASH FLOW SELF PRIMING PUMP MODEL TFCC-8B W/ 40HP 3PH 1800RPM PREMIUM EFFICIENT TEFC MOTOR PUMP MOUNTED ON FAB STEEL BASE IN VERTICAL V-BELT ARRANGEMENT WITH SHEEVES, GUARDS AND BELTS AS PER ATTACHED SCOPE AND SPECIFICATIONS INCLUDED DELIVERY AS PER SPECIFICATIONS ONE YEAR WARRANTY INCLUDED.			

BID: 5000124279
ONE TIME PURCHASE OF HORIZONTAL
SELF PRIMING CENTRIFUGAL PUMP FOR
THE JEFFERSON PARISH DEPARTMENT
OF SEWAGE
DUE: OCTOBER 11, 2018 AT 2:00PM

TOTAL

\$42,940.00

WASTEWATER SOLUTIONS LLC
CAGE CODE: 7TWY1
DUNS number: 079918568
EIN: 47-1877641

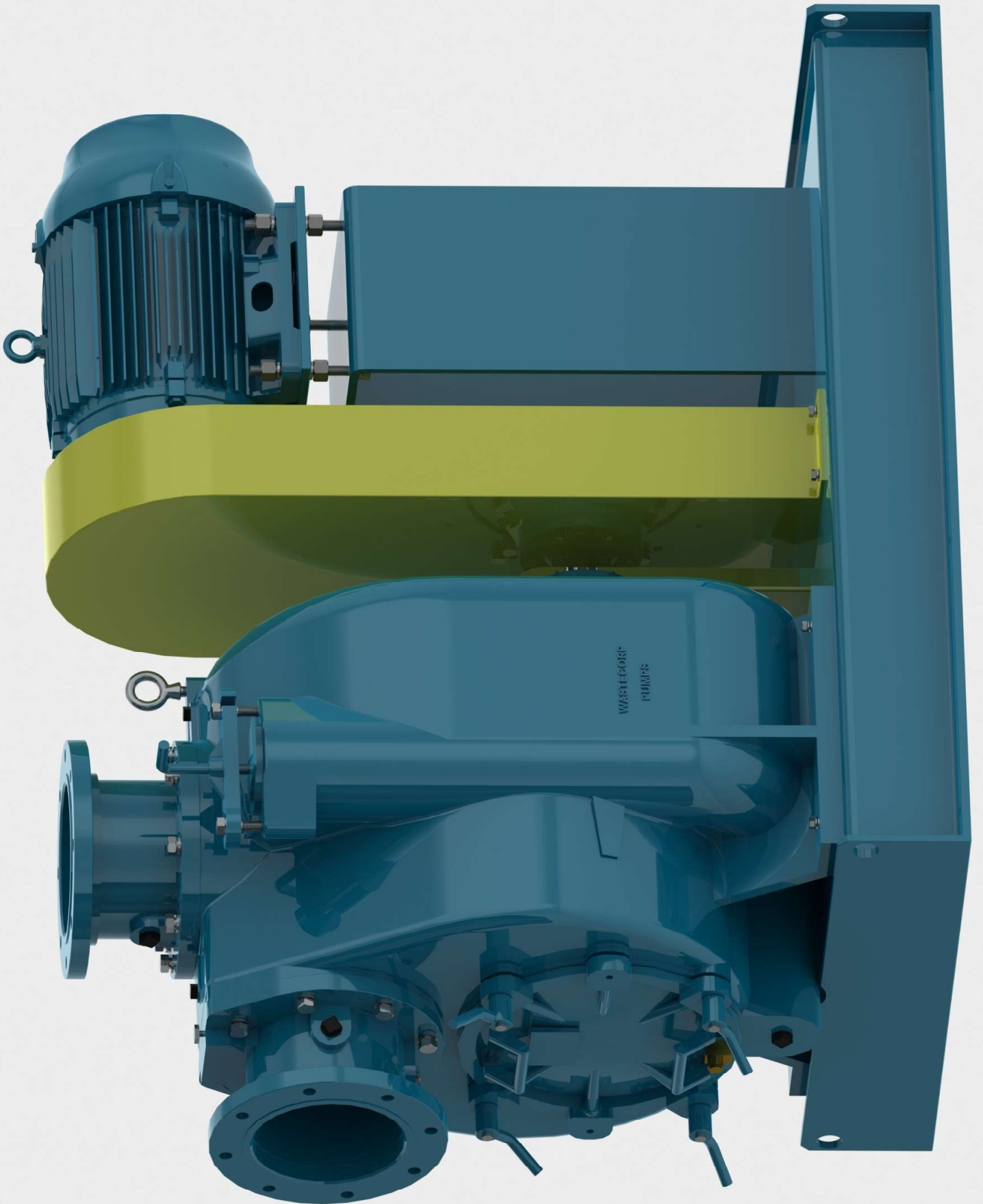



PERFORMANCE CURVE

Pump Model:	TFCC-8B
Design Conditions:	1200 GPM @ 42 ft TDH
Motor Details:	40 HP 3/60/460 1750 RPM belt driven to 1121 rpm (12.75" Impeller trim)

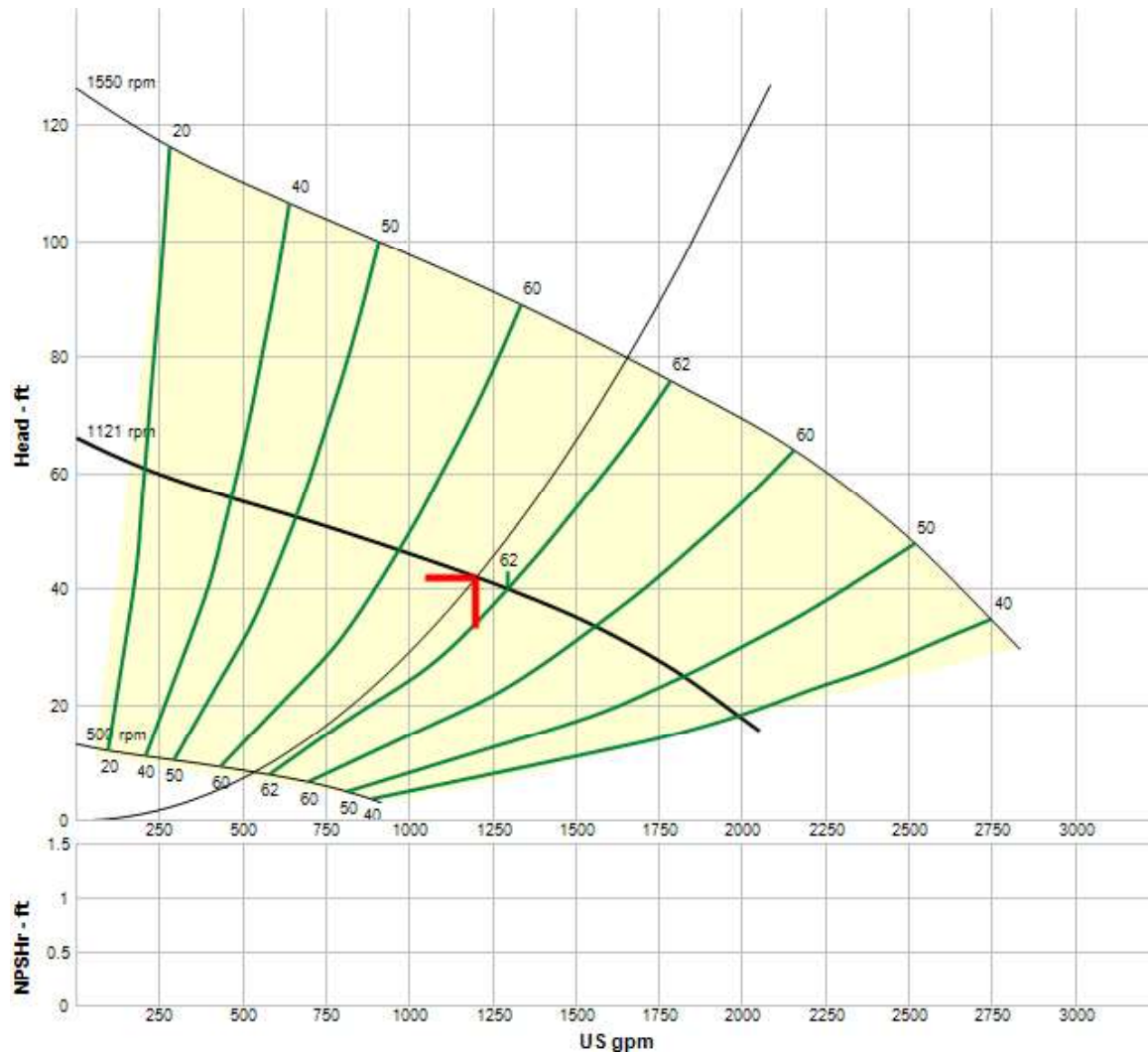

The following performance curves shown below and other published literature were taken from actual tests of standard production pumps, and reflect an average performance of the pumps indicated. Test curves are based on Hydraulic Institute test standards utilizing water with a specific gravity 1.0. Wastecorp Pumps reserves the right to make changes in design, materials and prices without notice.

IF
IN DOUBT,
ASK

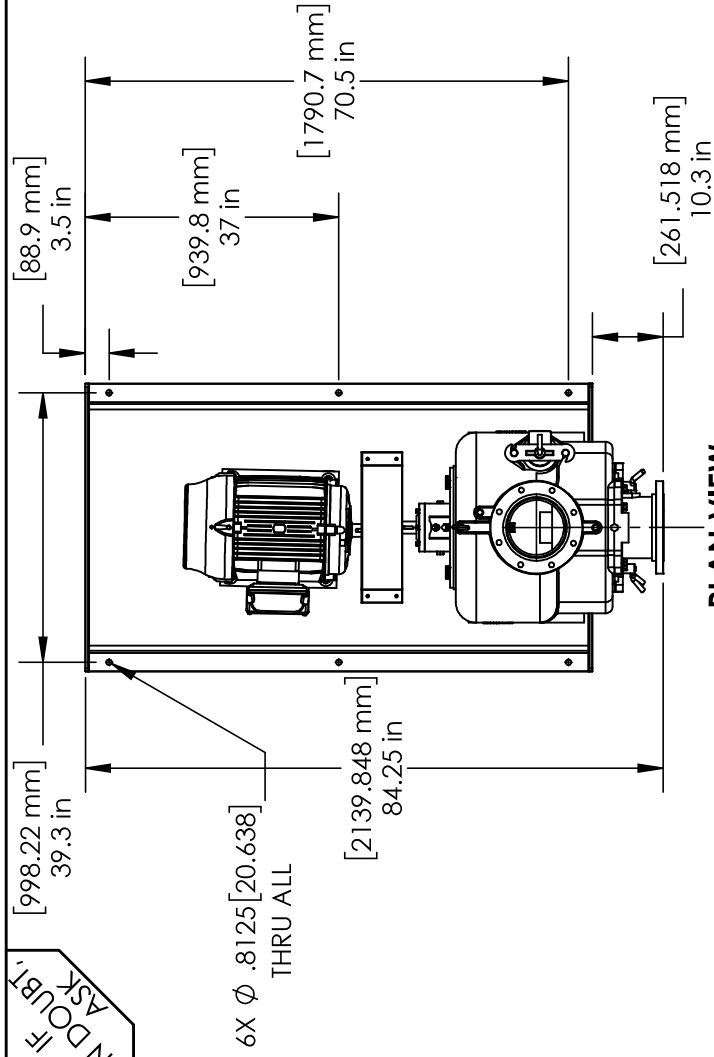

PLAN VIEW

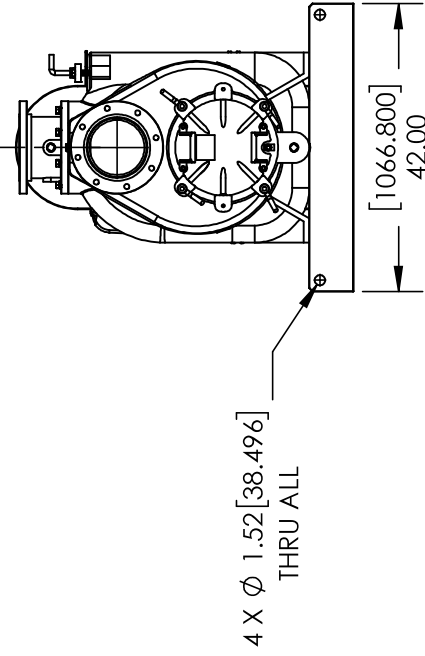

FRONT ELEVATION VIEW

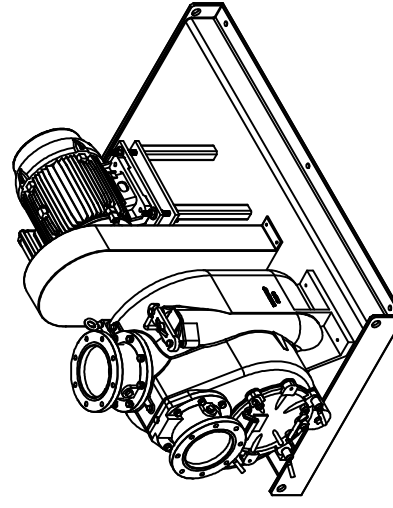

ISO ELEVATION VIEW

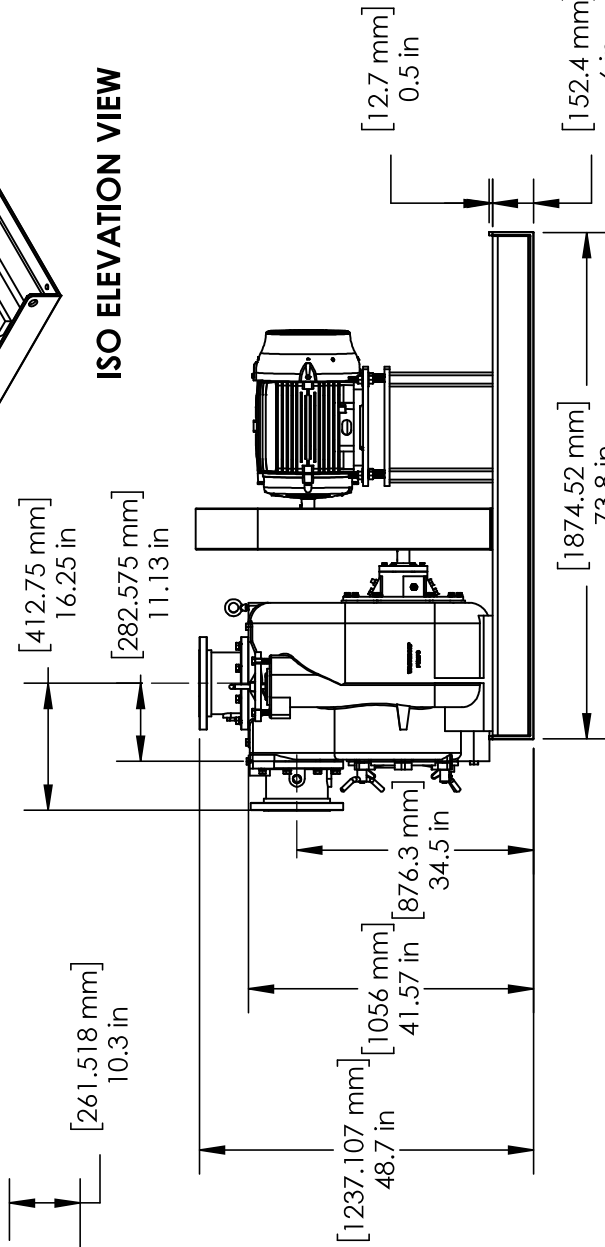

SIDE ELEVATION VIEW

NOTE:

1. CUSTOMER RESPONSIBLE FOR ALL INSTALLATION WORK, PROVIDE CONCRETE FOUNDATION AND ANCHOR BOLTS.
2. NOT CONSTRUCTION PURPOSE UNLESS CERTIFIED.
3. PIPING TO PUMP MUST BE COMPLETELY SELF-SUPPORTING TO PREVENT STRAIN ON PUMP CASTINGS

THIRD ANGLE PROJECTION		DIMENSIONS ARE IN INCHES	
A		INITIAL RELEASE	
LTR.	DATE	BY	APP.
	3/4/14/14	MT	JD
TITLE			
WASTECORP TRASH-FLOW SELF PRIMER PUMP MODEL: TFCC-8B BELT DRIVEN			

ALL INFORMATION CONTAINED IN THIS DOCUMENT IS BOTH CONFIDENTIAL AND PROPRIETARY TO WASTECORP. NO LICENSE, EXPRESSED OR IMPLIED, UNDER ANY PATENT, COPYRIGHT, OR TRADE SECRET OR OTHER INTELLECTUAL PROPERTY RIGHTS IS GRANTED BY THIS DOCUMENT. THIS DOCUMENT MAY BE REPRODUCED, TRANSMITTED, LANGUAGED, STORED IN A RETRIEVAL SYSTEM, TRANSLATED TO ANY LANGUAGE OR COMPUTER LANGUAGE, IN ANY FORM BY ANY MEANS ELECTRONIC, MECHANICAL, OR OTHERWISE WITHOUT WASTECORP CONCENT.

TOLERANCES UNLESS OTHERWISE SPECIFIED		PATTERN MAKER TOLERANCES	
1. ANGULAR ±1/2°		± 1/32" NON ACCUMULATIVE ON FINISHED SURFACES	
2. FRACTIONAL FINISH DIM ± .005"		1/16" FINISH ON FINISHED SURFACES UP TO 8"	
3. FRACTIONAL FINISH DIM ± 1/16" FOR CASTING		3/16" FINISH ON FINISHED SURFACES OVER 8"	
4. FRACTIONAL FINISH DIM ± 1/16" FOR STEEL			
5. PARTS TO BE FREE OF BURRS			
6. FINISH SHOWN IN R.M.S. 0.030" CUT OFF			
DRAWN	MT	CHKD	JD
PRENG		APPD	JD
SCALE	1:28		
DATE	04-14-2016		
DRAWING NUMBER		63407-00	
		SHEET 1 OF 1	



TRASH FLOW®
SELF PRIMING TRASH PUMPS
TFCC-8™

FEATURES

TRANSFER UP TO
2700 GPM (613 m³)

MAX. HEAD 120 FT (37 m)

PUMP UP TO 3" (76.2 mm)
SOLIDS

ADJUSTABLE &
SHIMLESS IMPELLER
CLEARANCE

HEAVY DUTY BEARINGS
AND CASTINGS

EASILY REMOVABLE
ROTATING ASSEMBLY

FULL IMPELLER ACCESS

SOLIDS HANDLING
IMPELLER

QUICK SELF PRIMING
CAPABILITIES

DOUBLE FLOATING
MECHANICAL SEAL

DUAL LIP SEAL BEARING
PROTECTION*

*optional

WASTECORP.COM

8"x8"



AN 8" SELF PRIMER THAT EXCEEDS EXPECTATIONS AND THEN SETS NEW ONES.

With the TFCC-8, you get more than a removable wear plate for easy maintenance and double floating mechanical seals. You get configuration options to suit the needs of your facility like pre-engineered sewage lift stations or engine driven models. Plus, you can transfer up to 2700 GPM with the powerful TFCC-8 Series from Wastecorp Pumps.

TRASH FLOW® CONFIGURATIONS

FLEX COUPLED

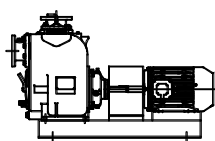

BELT DRIVE VERTICAL

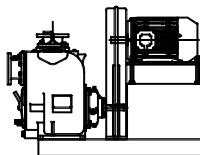

BELT DRIVE HORIZONTAL

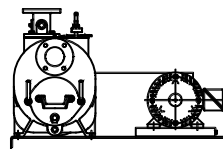

BELT DRIVE PIGGY BACK

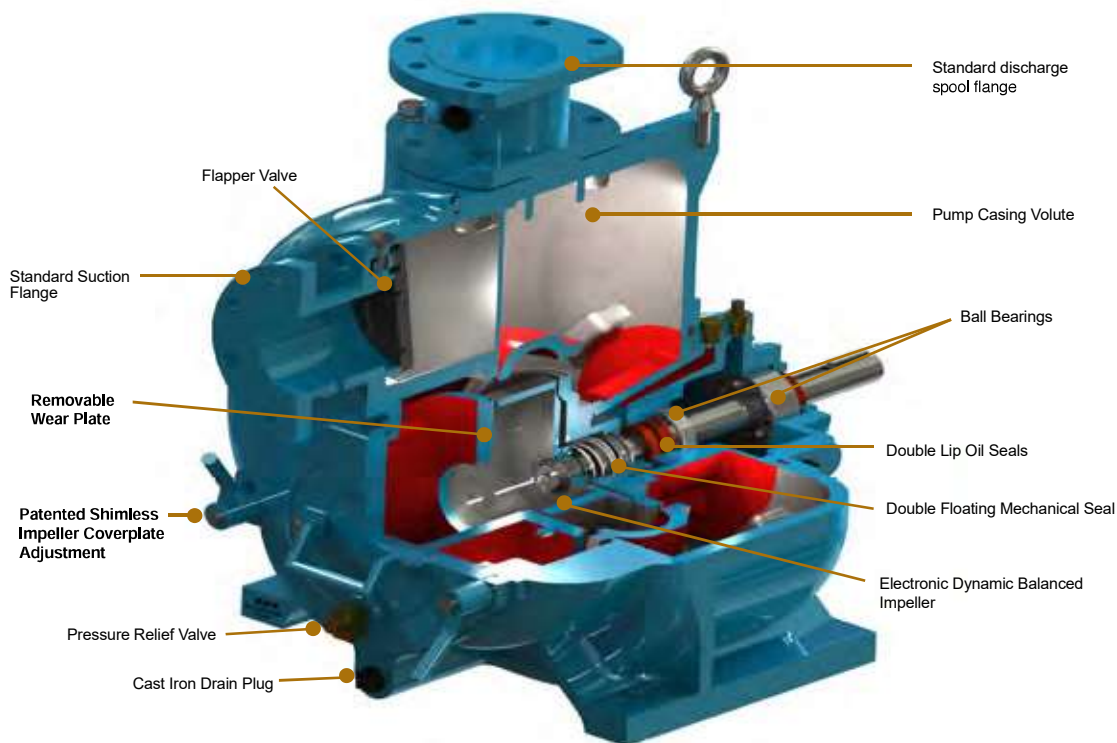
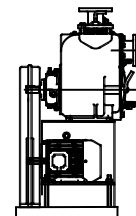

TRASH FLOW® SELF PRIMING TRASH PUMPS TFCC-8™



FEATURES



REMOVABLE ROTATING ASSEMBLY

Experience less downtime and maintenance hassles with the Trash Flow's removable rotating assembly. The pump volute and piping are not disturbed during maintenance.



DOUBLE FLOATING MECHANICAL SEAL

Wastecorp's mechanical seals are designed for the harsh pumping conditions in today's municipal and industrial solids handling jobs.



SOLIDS HANDLING IMPELLERS

Trash Flow pumps feature our standard premium two-vane solids handling impellers with solids handling capabilities up to 3" (75mm).



OPTIONAL SUCTION AND DISCHARGE GAUGES

Monitor operating pressure easily with Wastecorp's optional suction and discharge gauges.

OPTIONAL CONFIGURATIONS



SEWAGE LIFT STATIONS

Let our pump designers engineer the ultimate lift station for your facility. We offer complete packaged solutions including control panels, valves and more.



TRAILER OR SKID MOUNT ENGINE

With our trailer or skid mounted diesel engine trash pumps, you'll get a DOT approved solutions for mobile wastewater transfer

Pump Size	8" x 8" [200 mm x 200 mm] ANSI/DIN
Pump Casing	Cast Iron Class 30
Operating Pressure	Maximum 120 psi (797 kPa)
Impeller	Open type, two vane. Material: Ductile Iron Pumps 3" (76,2 mm) spherical solids
Impeller Shaft	ANSI 4140 HT
Wear Plate, Replaceable	Hardened Steel
Cover Plate	Removable/Adjustable Cast Iron Class 30
Flapper Valve	Neoprene with steel reinforcing ring
Bearing Housing	Cast Iron
Seal Plate	Cast Iron
Shaft Sleeve	ANSI 17-4PH SST
Radial Bearing	Open single ball
Thrust Bearing	Open double ball
Bearing/Seal Cavity Lubrication	SAE No. 30 oil
Flanges	125# Ductile Iron ANSI or DIN
Gaskets	Buna-N, compressed synthetic fibers, vegetable fiber, PTFE, cork, and rubber
O-Rings	Buna-N Teflon coated
Hardware	Plated steel/grade 8/SST
Pressure Release Valve	Brass
Oil Level Sight Gauges	Bearing and Seal Cavity
Net Weight	1300 lbs/590 KG
Optional Equipment and Materials:	Stainless Steel. Automatic air release valve, 120V/240V casing heater. High pump temperature shutdown kit, moisture probe, gauge kit, NPT & DIN standard suction and discharge flanges. Other elastomers available.

Seal Specifications:	Mechanical oil-lubricated, double floating, self-aligning seal. Titanium & Tungsten Carbide rotating and stationary faces. Stainless steel metal components. Maximum temperature of liquid pumped 180°F/83°C.
----------------------	---

Note: Consult factory for applications exceeding maximum pressure and/or temperature indicated.

BARE PUMP DIMENSIONS

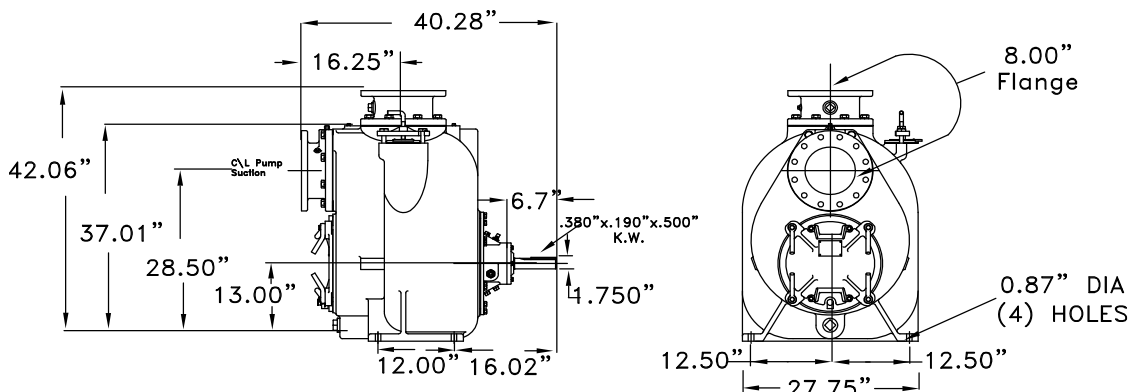

Dimensions and weight are approximate. Wastecorp Pumps reserves the right to make changes in design, materials and operating ranges without notice.



ABRIDGED (SHORT-FORM) TERMS & CONDITIONS OF SALE

ALL PURCHASE ORDERS ACCEPTED ARE SUBJECT TO WASTECORP'S STANDARD TERMS & CONDITIONS OF SALES, WHICH ARE AVAILABLE FOR REVIEW UPON REQUEST. ABRIDGED TERMS & CONDITIONS OF SALE ARE NOTED BELOW.

PRICES: Prices apply to the specific quotation, and does not include any taxes, transportation charges, special packaging or stamping, unless otherwise noted. Prices quoted are subject to change without prior notice. Prices quoted in US dollars unless otherwise stated.

TAXES: Purchaser agrees to pay the amount of any Federal, State, County, City or other tax which may apply to this order, directly to the governing Federal, State, County, City tax department.

PROPOSAL VALIDITY: This quotation shall be firm for a period of thirty (30) days from the date of this quotation.

PAYMENT TERMS: Payment terms are cash-in-advance for all first-time orders, unless established credit terms or other arrangements made between Wastecorp and purchaser, contact us for available payment options. We accept payment by acceptable credit cards VISA, MasterCard, Amex, or Discover for US customers only. Past due accounts are considered after thirty (30) days of unpaid invoice date and may be subject to interest charged at 1.5% per month.

LEAD TIME: Lead times commence upon acceptance of purchase order and payment terms are satisfied. Lead times are based on current availability of parts/pumps and subject to prior sale. Quoted lead times are based on the best availability information as at the date of the quotation. Inventory, factory loading and design backlog are all subject to change. Lead time and/or drawing times for critical items should be verified at the time of purchase order issuance. If any condition arises which prevents compliance with delivery schedules, Wastecorp shall not be liable for damages general, consequential or otherwise for failure to meet the original delivery schedule provided.

SHIPPING/DELIVERY: Pumps are skidded and packaged for transportation in closed top dock-level trucks. NO ALLOWANCE WILL BE MADE FOR LABOR, INSTALLATION, REMOVAL, UNLOADING OR OTHER CHARGES INCURRED BY PURCHASER IN CONNECTION WITH DELIVERY OF GOODS. All shipments are made FOB the factory, unless otherwise specified. Full risk of loss (including, but not limited to, transportation/carrier delays and losses) shall pass to the Purchaser upon delivery of the products to the carrier at the FOB point. If there is a LOSS or APPARENT VISIBLE DAMAGE to a shipment during delivery, the RECEIVER MUST NOTE SUCH DAMAGE ON THE DELIVERY RECEIPT AND HAVE THE CARRIER'S DRIVER SIGN THE BILL OF LADING. Failure to do so will result in a null and void loss claim.

PRODUCT REVISIONS: Wastecorp reserves the right to discontinue, change or improve its products or any portions thereof. Accordingly, Wastecorp shall not be required to change or improve any products sold and/or shipped prior to such a change or improvement.

PURCHASE ORDERS: All customer purchase orders must be submitted via hard copy sent to Wastecorp's customer service department by fax, electronic mail, or mail. All customer purchase orders are subject to Wastecorp's terms and conditions thereto and Wastecorp's acceptance of customer purchase order.

ERRORS AND OMISSIONS: Seller reserves the right to correct clerical or stenographic errors and, or omissions.

RETURN GOODS POLICY: Wastecorp will not accept any product(s) for return unless prior written permission by Wastecorp has been obtained by means of an executed **Return Goods Authorization** form. The RGA number must be listed on the packing list. Product(s) so returned **will be subject to a 40% charge for restocking and re-handling**. All product(s) returned must have transportation charges PREPAID by the Shipper. Product(s) which are obsolete or made to special order i.e., **pumps are not returnable nor refundable**. NO ALLOWANCE WILL BE MADE FOR LABOR, INSTALLATION, REMOVAL, TRANSPORTATION OR OTHER CHARGES INCURRED BY PURCHASER IN CONNECTION WITH THE RETURN OF GOODS.

CANCELLATION: Seller's acceptance of order cancellation or order reduction requests is conditional upon receiving Purchaser's written notification to assume any, or any part of, termination charges as agreed to by the Seller. Custom pumps and products are not returnable.

WARRANTY: Wastecorp warrants for a period of one (1) year from the date of installation or eighteen (18) months from date of shipment, whichever comes first (the "Warranty Period") that the pump and accessories manufactured and sold hereunder shall be free from defects in material and workmanship. Wastecorp does not warrant engines, motors, gauges, electrical control equipment or other product(s) not manufactured by Wastecorp, such being subject to such warranties as may be given by their respective manufacturers. Wear and tear resulting from use and, or long-term storage, and items normally consumed in use are not covered by this Warranty Period. Wastecorp's obligation under this warranty is limited to repair or replacement at its factory of any part(s) subject to this warranty, which will be returned to Wastecorp with transportation charges prepaid, and which Wastecorp's examination shall disclose to its satisfaction to have been defective. Parts of the product(s) repaired or replaced under this warranty will be covered for the Warranty Period only and will be shipped to the Purchaser FOB Wastecorp's factory. NO ALLOWANCE WILL BE MADE FOR LABOR, INSTALLATION, REMOVAL, TRANSPORTATION OR OTHER CHARGES INCURRED BY PURCHASER IN CONNECTION WITH WARRANTY REPAIR OR REPLACEMENT.

LIMITATION OF WARRANTY: THE PROVISIONS OF WARRANTY NOTED ABOVE ARE WASTECORP'S SOLE WARRANTY. SELLER MAKES NO OTHER WARRANTY OF ANY KIND, EXPRESSED OR IMPLIED, AND ALL IMPLIED WARRANTIES OF MERCHANTABILITY AND FITNESS FOR A PARTICULAR PURPOSE WHICH EXCEED SELLER'S AFORESTATED OBLIGATION ARE HEREBY DISCLAIMED BY SELLER AND EXCLUDED FROM THIS WARRANTY. Seller neither assumes nor authorizes any person(s) to assume for it any other obligation in connection with the sale of the Product(s). This warranty shall not apply to any product (s) or parts of the product(s) which a) have been repaired or altered outside of Seller's factory in any manner; or b) have been subject to misuse, negligence or accident, or c) have been used in a manner contrary to Seller's instructions.

SELLER'S LIABILITY: Wastecorp will not be liable for any loss, damage, cost of repair, direct incidental or consequential damages of any kind, whether based upon warranty, contract, tort including negligence or strict liability arising in connection with the sale, use or repair of the Product(s). Seller's maximum liability shall not in any case exceed the contract price for the Product(s) claimed to be defective or unsuitable.

GOVERNING LAWS: The terms of this agreement and all rights and obligations hereunder shall be governed by the laws of the State of Delaware, United State, without giving effect to its conflict of law provisions, for any and all disputes, claims and actions arising from or in connection with the Wastecorp Pump(s) provided to you hereunder. You agree to submit to the jurisdiction of the State of Delaware.

BY ACCEPTING THE ORDER CONFIRMATION ATTACHED, THE PURCHASER IS ACCEPTING OF THE ORDER AND IS IN AGREEMENT WITH THE TERMS AND CONDITIONS OF SALE NOTED ABOVE, AND IN WASTECORP'S STANDARD TERMS & CONDITIONS OF SALES, AND IS HEREBY GIVING WASTECORP PERMISSION TO PROCEED WITH THE PRODUCTION OF THE ORDER.



Minority Business Certification

Wastewater Solutions, LLC

Is certified under the provisions of
287 and 295.187, Florida Statutes, for a period from:

04/20/2017 to 04/20/2019

Erin Rock, Interim Secretary
Florida Department of Management Services

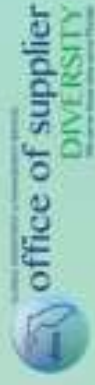



102 NE 2nd Street
Suite 510
Boca Raton FL 33432
(954) 483 9269 Cell
arturo@wws-llc.com
meredith@wws-llc.com
wws-llc.com

WASTEWATER SOLUTIONS REFERENCES OF PAST PERFORMANCE:

US COAST GUARD
SK3 CHELSEA PINCAY
USCG BASE NEW ORLEANS
1790 Saturn Blvd.
New Orleans LA 70129
(504) 253 4896

BUREAU OF RECLAMATION
HOOVER DAM
JENNIFER GARCIA
ACQUISITIONS & ASSISTANCE MANAGEMENT OFFICE
LOWER COLORADO REGION-YUMA AREA OFFICE
7301 Calle Agua Salada
Yuma, AZ 85634
(928) 343-8128

ANDRES DELGADO
DIRECTOR OF PUBLIC WORKS
CITY OF HIALEAH GARDENS
13601 N.W. 107th Avenue
Hialeah Gardens, Florida 33018
adelgado@cityofhialeahgardens.com
Phone: 305-877-8273
Multiple orders totaling over \$100,000

MARCUS SPIEGELBERG
DIRECTOR OF OPERATIONS
Douglas Orr Plumbing
301 Flagler Drive Miami Springs, Fl. 33166
Phone: (305) 887-1687
marcus@orrplumbing.com
Multiple orders totaling over \$200,000

WASTEWATER SOLUTIONS REFERENCES OF PAST PERFORMANCE CONTINUED

RONNIE S. NAVARRO,
PE DEPUTY DIRECTOR / CITY ENGINEER
CITY OF DANIA BEACH
rnavarro@daniabeachfl.gov
Public Services Department
1201 Stirling Road
Dania Beach, FL 33004
Phone: 954-924-6808
Multiple orders totaling over \$150,000

FLORIDA POWER AND LIGHT
ROBERT SHAW
700 Universe Blvd.
Juno Beach, FL 33408
(561) 818 1668

If you have any questions please contact us at:

Arturo Garcia
(954) 483 9269 Cell
arturo@wws-llc.com

State of Florida

Department of State

I certify from the records of this office that WASTEWATER SOLUTIONS LLC is a limited liability company organized under the laws of the State of Florida, filed on August 14, 2014.

The document number of this limited liability company is L14000127855.

I further certify that said limited liability company has paid all fees due this office through December 31, 2018, that its most recent annual report was filed on January 16, 2018, and that its status is active.

*Given under my hand and the
Great Seal of the State of Florida
at Tallahassee, the Capital, this
the Sixteenth day of January, 2018*



Ken DeFina
Secretary of State

Tracking Number: CC7854957981

To authenticate this certificate, visit the following site, enter this number, and then follow the instructions displayed.

<https://services.sunbiz.org/Filings/CertificateOfStatus/CertificateAuthentication>



CERTIFICATE OF LIABILITY INSURANCE

DATE (MM/DD/YYYY)

12/11/2017

THIS CERTIFICATE IS ISSUED AS A MATTER OF INFORMATION ONLY AND CONFERS NO RIGHTS UPON THE CERTIFICATE HOLDER. THIS CERTIFICATE DOES NOT AFFIRMATIVELY OR NEGATIVELY AMEND, EXTEND OR ALTER THE COVERAGE AFFORDED BY THE POLICIES BELOW. THIS CERTIFICATE OF INSURANCE DOES NOT CONSTITUTE A CONTRACT BETWEEN THE ISSUING INSURER(S), AUTHORIZED REPRESENTATIVE OR PRODUCER, AND THE CERTIFICATE HOLDER.

IMPORTANT: If the certificate holder is an **ADDITIONAL INSURED**, the policy(ies) must have **ADDITIONAL INSURED** provisions or be endorsed. If **SUBROGATION** IS **WAIVED**, subject to the terms and conditions of the policy, certain policies may require an endorsement. A statement on this certificate does not confer rights to the certificate holder in lieu of such endorsement(s).

PRODUCER Liberty Mutual Insurance PO Box 188065 Fairfield, OH 45018	CONTACT NAME: PHONE (A/C, No, Ext): 800-962-7132 FAX (A/C, No): 800-845-3666 E-MAIL ADDRESS: BusinessService@LibertyMutual.com
INSURED Wastewater Solutions LLC 102 NE 2nd St, Ste 510 Boca Raton FL 33432	INSURER(S) AFFORDING COVERAGE INSURER A: Ohio Security Insurance Company INSURER B: INSURER C: INSURER D: INSURER E: INSURER F:

COVERAGES**CERTIFICATE NUMBER:** 39160338**REVISION NUMBER:**

THIS IS TO CERTIFY THAT THE POLICIES OF INSURANCE LISTED BELOW HAVE BEEN ISSUED TO THE INSURED NAMED ABOVE FOR THE POLICY PERIOD INDICATED. NOTWITHSTANDING ANY REQUIREMENT, TERM OR CONDITION OF ANY CONTRACT OR OTHER DOCUMENT WITH RESPECT TO WHICH THIS CERTIFICATE MAY BE ISSUED OR MAY PERTAIN, THE INSURANCE AFFORDED BY THE POLICIES DESCRIBED HEREIN IS SUBJECT TO ALL THE TERMS, EXCLUSIONS AND CONDITIONS OF SUCH POLICIES. LIMITS SHOWN MAY HAVE BEEN REDUCED BY PAID CLAIMS.

INSR LTR	TYPE OF INSURANCE	ADDL INSD	SUBR WVD	POLICY NUMBER	POLICY EFF (MM/DD/YYYY)	POLICY EXP (MM/DD/YYYY)	LIMITS
A	<input checked="" type="checkbox"/> COMMERCIAL GENERAL LIABILITY <input type="checkbox"/> CLAIMS-MADE <input checked="" type="checkbox"/> OCCUR GEN'L AGGREGATE LIMIT APPLIES PER: <input checked="" type="checkbox"/> POLICY <input type="checkbox"/> PRO-JECT <input type="checkbox"/> LOC OTHER:			BKS58450670	12/5/2017	12/5/2018	EACH OCCURRENCE \$1,000,000 DAMAGE TO RENTED PREMISES (Ea occurrence) \$300,000 MED EXP (Any one person) \$15,000 PERSONAL & ADV INJURY \$1,000,000 GENERAL AGGREGATE \$2,000,000 PRODUCTS - COMP/OP AGG \$2,000,000 \$
	AUTOMOBILE LIABILITY <input type="checkbox"/> ANY AUTO <input type="checkbox"/> OWNED AUTOS ONLY <input type="checkbox"/> SCHEDULED AUTOS <input type="checkbox"/> HIRED AUTOS ONLY <input type="checkbox"/> NON-OWNED AUTOS ONLY						COMBINED SINGLE LIMIT (Ea accident) \$ BODILY INJURY (Per person) \$ BODILY INJURY (Per accident) \$ PROPERTY DAMAGE (Per accident) \$ \$
	UMBRELLA LIAB <input type="checkbox"/> OCCUR EXCESS LIAB <input type="checkbox"/> CLAIMS-MADE DED <input type="checkbox"/> RETENTION \$						EACH OCCURRENCE \$ AGGREGATE \$ \$
	WORKERS COMPENSATION AND EMPLOYERS' LIABILITY ANY PROPRIETOR/PARTNER/EXECUTIVE OFFICER/MEMBER EXCLUDED? (Mandatory in NH) If yes, describe under DESCRIPTION OF OPERATIONS below	Y / N <input type="checkbox"/>	N / A				PER STATUTE <input type="checkbox"/> OTH-ER <input type="checkbox"/> E.L. EACH ACCIDENT \$ E.L. DISEASE - EA EMPLOYEE \$ E.L. DISEASE - POLICY LIMIT \$

DESCRIPTION OF OPERATIONS / LOCATIONS / VEHICLES (ACORD 101, Additional Remarks Schedule, may be attached if more space is required)

Proof of Insurance

CERTIFICATE HOLDERWastewater Solutions LLC
102 NE 2nd St Ste 510
Boca Raton FL 33432**CANCELLATION**

SHOULD ANY OF THE ABOVE DESCRIBED POLICIES BE CANCELLED BEFORE THE EXPIRATION DATE THEREOF, NOTICE WILL BE DELIVERED IN ACCORDANCE WITH THE POLICY PROVISIONS.

AUTHORIZED REPRESENTATIVE

Adrienne Zolicoffer

© 1988-2015 ACORD CORPORATION. All rights reserved.

ACORD 25 (2016/03)

The ACORD name and logo are registered marks of ACORD



**5000124279 ONE TIME PURCHASE OF HORIZONTAL SELF-PRIMING
CENTRIFUGAL PUMP FOR THE JEFFERSON PARISH DEPARTMENT OF
SEWERAGE**

Jefferson Parish Government

Project documents obtained from www.CentralBidding.com

08-Oct-2018 09:28:36 AM



JEFFERSON PARISH

Department of Purchasing

Michael S. Yenni
Parish President

Renny Simno
Director

October 02, 2018

ADDENDUM # 1

Bid No.: 50-00124279

Bid Opening Date: 10/11/2018

For: ONE TIME PURCHASE OF HORIZONTAL SELF-PRIMING CENTRIFUGAL PUMP BILLS FOR
THE JEFFEON PARISH DEPARTMENT OF SEWERAGE

CLARIFICATION:

QUESTION: Part 2.03.B states: *"The sheave/belt combination shall provide the speed ratio needed to achieve the specified pump operating conditions."*

I am unable to locate the "pump operating conditions" in either the *Description of Articles* or Specifications. Please advise me the "pump operating conditions".

ANSWER: Motor shall be 40 HP, 1760 RPM. Pump is 1200 GPM at 42 HD. Pump operating conditions shall be as follows: Pumps must be designed to handle raw, unscreened, domestic sanitary sewage. Pumps shall have 8" suction connection and 8" discharge connection. All internal passages, impeller vanes and recirculation port shall pass a 3 inch spherical solid.



JEFFERSON PARISH

Department of Purchasing

Michael S. Yenni
Parish President

Renny Simno
Director

Sincerely,

A handwritten signature in blue ink, reading "Donna M. Evans", is written over a horizontal line.

Donna M Evans, Buyer II
Jefferson Parish Purchasing Department

Bidders must acknowledge all addenda on the bid form. Bidder acknowledges receipt of this addendum on the bid form as indicated. Failure to do so will result in bid rejection.

This addendum is a part of the contract documents and modifies the original bidding documents and specifications. The contents of this addendum shall be included in the contract documents. Changes made by this addendum shall take precedence over the documents of earlier date.