



CENTRALBIDDING
FROM CENTRAL AUCTION HOUSE

**5000123897 TWO YEAR MAINTENANCE CONTRACT FOR IRRIGATION
SERVICES AT VARIOUS LOCATIONS FOR JEFFERSON PARISH
DEPARTMENT OF PUBLIC WORKS- PARKWAYS**
Jefferson Parish Government

Project documents obtained from www.CentralBidding.com
22-Aug-2018 10:31:55 AM



Bid Number 50 – 00123897

**TWO YEAR MAINTENANCE CONTRACT FOR IRRIGATION SERVICES AT
VARIOUS LOCATIONS FOR JEFFERSON PARISH DEPARTMENT OF
PUBLIC WORKS- PARKWAYS**

SEPTEMBER 20, 2018 AT 2:00 PM

ATTENTION VENDORS!!!

**Please review all pages and respond accordingly, complying with all provisions
in the technical specifications and Jefferson Parish Instructions for Bidders and
General Terms and Conditions. All bids must be received in the Purchasing
Department by the bid due date and time.**

**Jefferson Parish Purchasing Department
200 Derbigny Street
General Government Building, Suite 4400
Gretna, LA 70053
Donna Evans
DMEvans@Jeffparish.net
504-364-2691**

DATE: 8/22/2018

INVITATION TO BID
THIS IS NOT AN ORDER

Page: 1

BID NO.: 50-00123897

JEFFERSON PARISH

PURCHASING DEPARTMENT
P.O. BOX 9
GRETNA, LA. 70054-0009
504-364-2678

BUYER: DMEVANS@jeffparish.net

BIDS WILL BE RECEIVED IN THE WEST BANK PURCHASING DEPT, SUITE 4400, JEFFERSON PARISH GENERAL GOVERNMENT BUILDING, 200 DERBIGNY STREET, GRETNA, LA 70053 UNTIL 2:00 PM, 9/20/2018 AND PUBLICLY OPENED THEREAFTER.

For convenience, bidders may also submit bids in the East Bank Purchasing Department, Suite 404, Jefferson Parish Joseph S. Yenni Building, 1221 Elmwood Park Blvd., Jefferson LA 70123. However, if submitting bids on the day of bid opening, bidders must submit at the West Bank location only. All bids will be publicly opened at the West Bank location.

At no charge, bidders may also submit via Jefferson Parish's electronic procurement page by visiting www.jeffparishbids.net to register for this free site. Additional instructions are included in the text box highlighting electronic procurement.

LATE BIDS WILL NOT BE ACCEPTED

Unless submitting via online (see Page 3), each bid must be submitted in a sealed envelope bearing on the outside; the name of the Bidder, his address, and the name of the project for which the bid is submitted and the bid number.

NOTE: ONLY BIDS WRITTEN IN INK OR TYPEWRITTEN, AND PROPERLY SIGNED BY A MEMBER OF THE FIRM OR AUTHORIZED REPRESENTATIVE, WILL BE ACCEPTED. PENCIL AND/OR PHOTOSTATIC FIGURES OR SIGNATURES SHALL RESULT IN BID REJECTION.

INSTRUCTIONS FOR BIDDERS AND GENERAL CONDITIONS

THE FOLLOWING INSTRUCTIONS APPLY TO ALL BIDS

All bids submitted are subject to these instructions and general conditions and any special conditions and specifications contained herein, all of which are made part of this bid proposal reference. By submitting a bid, vendor agrees to comply with all provisions of Louisiana Law as well be in compliance with the Jefferson Parish Code of Ordinances, Louisiana Code of Ethics, applicable Jefferson Parish ethical standards and Jefferson Parish Resolution No. 113646 and/or Resolution No. 113647.

All vendors submitting bids should register as a Jefferson Parish vendor if not already yet registered. Registration forms may be downloaded from <http://purchasing.jeffparish.net> and by clicking on Vendor Information. Current W-9 forms with respective Tax Identification numbers and vendor applications may be submitted at any time; however, if your company is not registered and/or a current W-9 form is not on file, vendor registration is mandatory. Further, a current W-9 form and respective Tax Identification number must be supplied upon contract execution, should you be awarded a contract and/or issued purchase order. Failure to do so may result in delay of payment.

All quotations shall be based on F.O.B. Agency warehouse or job site, anywhere within the Parish as designated by the Purchasing Department. This provision does not apply to public works projects

JEFFERSON PARISH requires all products to be new (current) and all work must be performed according to standard practices for the project. Unless otherwise specified, no aftermarket parts will be accepted. Unless otherwise specified, all workmanship and materials must have at least one (1) year guaranty, in writing, from the date of delivery and/or acceptance of the project. Any deviations or alterations from the specifications must be indicated and/or supporting documentation supplied with bid submission.

Bidders should submit all questions in writing via email to the buyer's email address as indicated above, no later than Five (5) working days prior to the bid opening. Bid numbers should be mentioned in all requests. If submitting online, vendors may send questions via the E-Procurement site no later than Five (5) working days prior to the bid opening.

If this bid requires a pre-bid conference (see Additional Requirements section), bidders are advised that such conference will be held to allow bidders the opportunity to identify any discrepancies in the bid specifications and seek further clarification regarding instructions. The Purchasing Department will issue a written response to bidders' questions in the form of an Addendum. Please note that all official communication will be expressed in the form of an addendum.

All formal Addenda require written acknowledgement on the bid form by the bidder. Failure to acknowledge an Addendum on the bid form shall cause the bid to be rejected. JEFFERSON PARISH reserves the right to award bid to next lowest responsive and responsible bidder in this event.

The purpose and intention of this invitation to bid is to afford all suppliers an equal opportunity to bid on all construction, maintenance, repair, operating supplies and/or equipment listed in this bid proposal. JEFFERSON PARISH WILL ACCEPT ONE BID ONLY FROM EACH VENDOR. Items bid must meet specifications.

Visit our website at [HTTP://PURCHASING.JEFFPARISH.NET](http://PURCHASING.JEFFPARISH.NET)

JEFFERSON PARISH will accept one price for each item unless otherwise indicated. Two or more prices for one item will result in bid rejection. Bidders are required to complete, sign and return the bid form and/or complete and return the associated line item pricing forms as indicated. Vendors must not alter the bid forms. Doing so will cause the bid to be rejected.

A corporate resolution or written evidence of the individual signing the bid having such authority must be submitted with the bid. Failure to comply will cause bid to be rejected. For corporate entities, such written evidence may be a printout of the Louisiana Secretary of State's website listing the signatory as an officer. Such printout shall be included with the bid submission. Bids submitted by Owners or Sole Proprietorships must include certification that he or she owns the entity for which the bid is signed. This documentation must be submitted with the bid. Failure to do so will result in bid rejection.

NOTE: A sample corporate resolution can be downloaded from our website <http://purchasing.jeffparish.net> or you may provide your own document. A sample certification of sole proprietorship can also be downloaded from our website <http://purchasing.jeffparish.net> or you may provide your own document.

INSTRUCTIONS FOR BIDDERS AND GENERAL CONDITIONS

A. AWARD OF CONTRACT: JEFFERSON PARISH reserves the right to award contracts or place orders on a lump sum or individual item basis, or such combination, as shall in its judgment be in the best interest of JEFFERSON PARISH. Every contract or order shall be awarded to the LOWEST RESPONSIVE and RESPONSIBLE BIDDER, taking into consideration the CONFORMITY WITH THE SPECIFICATIONS and the DELIVERY AND/OR COMPLETION DATE. SPLIT AWARDS MADE TO SEVERAL VENDORS WILL ONLY BE GRANTED TO THOSE DEEMED RESPONSIVE AND RESPONSIBLE.

All bid prices shall remain valid for 45 days. Jefferson Parish and the lowest responsive and responsible bidder(s) by mutual written consent may mutually agree to extend the deadline for award by one (1) or more extensions of thirty (30) calendar days.

PROTESTS: Only those vendors that submitted a bid in response to this solicitation may submit a protest in writing to the Director of the Purchasing within 48 hours of bid opening. The Purchasing Director will review it in connection with the Parish Attorney's Office which will then respond in writing as soon as possible.

PREFERENCE: Unless federal funding is directly spent by Jefferson Parish for this purchase, preference is hereby given to materials, supplies, and provisions produced, manufactured or grown in Louisiana, quality being equal to articles offered by competitors outside the state. "LSA – R.S. 38:2251-2261"

B. USE OF BRAND NAMES AND STOCK NUMBERS: Where brand names and stock numbers are specified, it is for the purpose of establishing certain minimum standards of quality. Bids may be submitted for products of equal quality, provided brand names and stock numbers are specified. Complete product data may be required prior to award.

C. CANCELLATION OF CONTRACT: JEFFERSON PARISH reserves the right to cancel all or any part if not shipped promptly. No charges will be allowed for parking or cartage unless specified in quotation. The order must not be filled at a higher price than quoted. JEFFERSON PARISH reserves the right to cancel any contract at anytime and for any reason by issuing a THIRTY (30) day written notice to the contractor.

For good cause and as consideration for executing a contract with Jefferson Parish, vendor conveys, sells, assigns and transfers to Jefferson Parish or its assigns all rights, title and interest in and to all causes of action it may now or hereafter acquire under the antitrust laws of the United States and the State of Louisiana, relating to the particular good or services purchased or acquired by Jefferson Parish.

D. PRICES: Jefferson Parish is exempt from paying sales tax under LSA-R.S. 47:301 (8)(c). All prices for purchases by Jefferson Parish of supplies and materials shall be quoted in the unit of measure specified and unless otherwise specified, shall be exclusive of state and Parish taxes. The price quoted for work shall be stated in figures. In the event there is a difference in unit prices and totals, the unit price shall prevail.

Quantities listed are for bidding purposes only. Actual requirements may be more or less than quantities listed.

Bidders are not to exclude from participation in, deny the benefits of, or subject to discrimination under any program or activity, any person in the United States on the grounds of race, color, national origin, or sex; nor discriminate on the basis of age under the Age Discrimination Act of 1975, or with respect to an otherwise qualified handicapped individual as provided in Section 504 of the Rehabilitation Act of 1973, or on the basis of religion, except that any exemption from such prohibition against discrimination on the basis of religion as provided in the Civil Rights Act of 1964, or Title VI and VII of the Act of April 11, 1968, shall also apply. This assurance includes compliance with the administrative requirements of the Revenue Sharing final handicapped discrimination provisions contained in Section 51.55 (c), (d), (e), and (k)(5) of the Regulations. New construction or renovation projects must comply with Section 504 of the 1973 Rehabilitation Act, as amended, in accordance with the American National Standard Institute's specifications (ANSI A17.1-1961).

Jefferson Parish and its partners as the recipients of federal funds are fully committed to awarding a contract(s) to firm(s) that will provide high quality services and that are dedicated to diversity and to containing costs. Thus, Jefferson Parish strongly encourages the involvement of minority and/or woman-owned business enterprises (DBE's, including MBE's, WBE's and SBE's) to stimulate participation in procurement and assistance programs.

Advertised bids will be tabulated and a copy of the tabulation will be forwarded to each responding bidder.

IN ACCORDANCE WITH STATE REGULATIONS JEFFERSON PARISH OFFERS ELECTRONIC PROCUREMENT TO ALL VENDORS

This electronic procurement system allows vendors the convenience of reviewing and submitting bids online. This is a secure site and authorized personnel have limited read access only. Bidders are encouraged to submit electronically using this free service; while the website accepts various file types, one single PDF file containing all appropriate and required bid documents is preferred. Bidders submitting uploaded images of bid responses are solely responsible for clarity. If uploaded images/documents are not legible, then bidder's submission will be rejected. Please note all requirements contained in this bid package for electronic bid submission.

Please visit our E-Procurement Page at www.jeffparishbids.net to register and view Jefferson Parish solicitations. For more information, please visit the Purchasing Department page at <http://purchasing.jeffparish.net>.

The general specifications for construction projects and the purchase of materials, services and/or supplies are those adopted by the JEFFERSON PARISH Council by Resolution No. 113646 or 113647 dated 12/09/09. The general conditions adopted by this resolution shall be considered as much a part of this document as if they were written wholly herein. A copy may be obtained from the Office of the Parish Clerk, Suite 6700, Jefferson Parish General Government Building, 200 Derbigny Street, Gretna, LA 70053. You may also obtain a copy by visiting the Purchasing Department webpage at <http://purchasing.jeffparish.net> and clicking on Online Forms.

ADDITIONAL REQUIREMENTS FOR THIS BID

PLEASE MATCH THE NUMBERS PRINTED IN THIS BOX WITH THE
CORRESPONDING INSTRUCTIONS BELOW.

1,3,5,6,8,10,11,12,13,15

MANDATORY

PRE-BID CONFERENCE TO BE HELD AT: GGB-200 DERBIGNY ST-SUITE 4400-GRETNA, LA
10:00 AM JEFFERSON PAR PURCHASING DEPT
ON 9/06/2018

1. All bidders must attend the MANDATORY pre-bid conference and will be required to sign in and out as evidence of attendance. In accordance with LSA R.S. 38:2212(I), all prospective bidders shall be present at the beginning of the MANDATORY pre-bid conference and shall remain in attendance for the duration of the conference. Any prospective bidder who fails to attend the conference or remain for the duration shall be prohibited from submitting a bid for the project.
2. Attendance to this pre-bid conference is optional. However, failure to attend the pre-bid conference shall not relieve the bidder of responsibility for information discussed at the conference. Furthermore, failure to attend the pre-bid conference and inspection does not relieve the successful bidder from the necessity of furnishing materials or performing any work that may be required to complete the work in accordance with the specification with no additional cost to the owner.
3. Contractor must hold current applicable JEFFERSON PARISH licenses with the Department of Inspection and Code Enforcement. Contractor shall obtain any and all permits required by the JEFFERSON PARISH Department of Inspection and Code Enforcement. The contractor shall be responsible for the payment of these permits. All permits must be obtained prior to the start of the project. Contractor must also hold any and all applicable Federal and State licenses. Contractor shall be responsible for the payment of these permits and shall obtain them prior to the start of the project.
4. A LA State Contractor's License will be required in accordance with LSA R.S. 37-2150 et. seq. and such license number will be shown on the outside of the bid envelope. Failure to comply will cause the bid to be rejected. Additionally if submitting the bid electronically, then the license number must be entered in the appropriate field in the Electronic Procurement system. Failure to comply will cause the bid to be rejected.
5. It is the bidder's responsibility to visit the job site and evaluate the job before submitting a bid.
6. Job site must be clean and free of all litter and debris daily and upon completion of the contract. Passageways must be kept clean and free of material, equipment, and debris at all times. Flammable material must be removed from the job site daily because storage will not be permitted on the premises. Precautions must be exercised at all times to safeguard the welfare of JEFFERSON PARISH and the general public.

INSTRUCTIONS FOR BIDDERS AND GENERAL CONDITIONS

7. PUBLIC WORKS BIDS: All awards for public works in excess of \$5,000.00 will be reduced to a formal contract which shall be recorded at the contractor's expense with the Clerk of Court and Ex-Officio Recorder of Mortgages for the Parish of Jefferson. A price list of recordation costs may be obtained from the Clerk of Court and Ex-Officio Recorder of Mortgages for the Parish of Jefferson. All awards in excess of \$25,000.00 will require both a performance and a payment bond. Unless otherwise stated in the bid specifications, the performance bond requirements shall be 100% of the contract price. Unless otherwise state in the bid specifications, the payment bond requirements shall be 100% of the contract price. Both bonds shall be supplied at the signing of the contract.
8. NON-PUBLIC WORKS BIDS: A performance bond will be required for this bid. The amount of the bond will be 100% of the contract price unless otherwise indicated in the specifications. The performance bond shall be supplied at the signing of the contract.
9. NON-PUBLIC WORKS BIDS: A payment bond will be required for this bid. The amount of the bond will be 100% of the contract price unless otherwise indicated in the specifications. The payment bond shall be supplied at the signing of the contract.
10. All bidders must comply with the requirements stated in the attached "Standard Insurance Requirements" sheet attached to this bid solicitation. Prior to contract executions/purchase order issuance, the successful bidder will be required to provide final insurance certificates which shall name Jefferson Parish as an additional insured in accordance with the instructions in the aforementioned "Standard Insurance Requirements" sheet.
11. A bid bond will be required with bid submission in the amount of 5% of the total bid, unless otherwise stated in the bid specifications. Acceptable forms shall be limited to cashier's check, certified check, or surety bid bond. All sureties must be in original format (no copies) If submitting a bid online, vendors must submit an electronic bid bond through the respective online clearinghouse bond management system(s) as indicated in the electronic bid solicitation on Central Auction House. No scanned paper copies of any bid bond will be accepted as part of the electronic bid submission.
12. This is a requirements contract to be provided on an as needed basis. JEFFERSON PARISH makes no representations on warranties with regard to minimum guaranteed quantities unless otherwise stated in the bid specifications.
13. Freight charges should be included in total cost when quoting. If not quoted FOB DELIVERED, freight must be quoted as a separate item. Bid may be rejected if not quoted FOB DELIVERED or if freight charges are not indicated on bid form.
14. PUBLIC WORKS BIDS - Completed, Signed and Properly Notarized Affidavits Required; This applies to all solicitations for construction, alteration or demolition of public buildings or projects, in conformity with the provisions contained in LSA-RS 38:2212.9, LSA-RS 38:2212.10, LSA-RS 38:2224, and Sec 2-923.1 of the Jefferson Parish Code of Ordinances. For bidding purposes, all bidders must submit with bid submission COMPLETED, SIGNED and PROPERLY NOTARIZED Affidavits, including: Non-Conviction Affidavit, Non-Collusion Affidavit, Campaign Contribution Affidavit, Debt Disclosures Affidavit and E-Verify Affidavit. For the convenience of vendors, all affidavits have been combined into one form entitled PUBLIC WORKS BID AFFIDAVIT. This affidavit must be submitted in its original format, and without material alteration, in order to be compliant and for the bid to be considered responsive. A scanned copy of the completed, signed and properly notarized affidavit may be submitted with the bid, however, the successful bidder must submit the original affidavit in its original format and without material alteration upon contract execution. Failure to comply will result in the bid submission being rejected as non-responsive. The Parish reserves the right to award bid to the next lowest responsive and responsible bidder in this event.
15. NON PUBLIC WORK BIDS - Completed, Signed and Properly Notarized Affidavits Required in conformity with the provisions contained in LSA - RS 38:2224 and Sec 2-923.1 of the Jefferson Parish Code of Ordinances. For bidding purposes, all bidders must submit with bid submission COMPLETED, SIGNED and PROPERLY NOTARIZED Affidavits, including: Non-Collusion Affidavit, Debt Disclosures Affidavit and Campaign Contribution Affidavit. For the convenience of vendors, all affidavits have been combined into one form entitled NON PUBLIC WORKS BID AFFIDAVIT. This affidavit must be submitted in its original format, and without material alteration, in order to be compliant and for the bid to be considered responsive. A scanned copy of the completed, signed and properly notarized affidavit may be submitted with the bid, however, the successful bidder must submit the original affidavit in its original format and without material alteration upon contract execution. Failure to comply will result in the bid submission being rejected as non-responsive. The Parish reserves the right to award bid to the next lowest responsive and responsible bidder in this event.
16. The ensuing contract for this bid solicitation may be eligible for FEMA reimbursement and/or Federal funding/reimbursement. As such, the referenced appendix will be applicable accordingly and shall be considered a part of the bid documents. All applicable certifications must be duly completed, signed and submitted with bid submission. Failure to submit applicable certifications with bid submission will result in bid rejection.
17. For this project, the Contractor shall not pay any state or local sales or use taxes on materials and equipment which are affixed and made part of the immovable property of the project or which permanently incorporated in the project (hereinafter referred to as "applicable materials and equipment"). All purchases of applicable materials or equipment shall be made by the contractor on behalf of and as the agent of Jefferson Parish (Owner), a political subdivision of the State of Louisiana. No state and local sales and use taxes are owned on applicable materials and equipment under the provisions of Act 1029 of the 1991 Regular Session - Louisiana Revised Statute 47:301(8)(c). Owner will furnish contractor a certificate form which certifies that Owner is not required to pay such state or local sales and use taxes, and contractor shall furnish a copy of such certificate to all vendors or suppliers of the applicable materials and equipment

It shall be the duty of every parish officer, employee, department, agency, special district, board, and commission: and the duty of every contractor, subcontractor, and licensee of the parish, and the duty of every applicant for certification of eligibility for a parish contract or program, to cooperate with the Inspector General in any investigation, audit, inspection, performance review, or hearing pursuant to Jefferson Parish Code of Ordinances Section 2-155.10(19). By submitting a bid, vendor acknowledges this and will abide by all provisions of the referenced Jefferson Parish Code of Ordinances.

DATE: 8/22/2018

Page: 5

BID NO.: 50-00123897

BID FORM
Non Public Works

All Public Work Projects are required to use the Louisiana Uniform Public Work Bid Form

All prices must be held firm unless an escalation provision is requested in this bid. Jefferson Parish will allow one escalation during the term of the contract, which may not exceed the U.S. Bureau of Labor Statistics National Index for all Urban Consumers, unadjusted 12 month figure. The most recently published figure issued at the time an adjustment is requested will be used. A request must be made in writing by the vendor, and the escalation will only be applied to purchases made after the request is made.

Are you requesting an escalation provision?

YES _____ NO X

MAXIMUM ESCALATION PERCENTAGE REQUESTED N/A %

INITIAL BID PRICES WILL REMAIN FIRM THROUGH THE DATE OF 10/31/18

For the purposes of comparison of bids when an escalation provision is requested, Jefferson Parish will apply the maximum escalation percentage quoted by the bidder to the period to which it is applied in the bid. The initial price and the escalation will be used to calculate the total bid price. It will be assumed, for comparison of prices only, that an equal amount of material or labor is purchased each month throughout the entire contract.

DELIVERY: FOB JEFFERSON PARISH

INDICATE DELIVERY DATE ON EQUIPMENT AND SUPPLIES

7 days ARO

LOUISIANA CONTRACTOR'S LICENSE NO.: (if applicable) 29959

LA Irrigation Contractors License: 18-0599

THIS SECTION MUST BE COMPLETED BY BIDDER:

FIRM NAME: Rotolo Consultants, Inc.

ADDRESS: 38001 Brownsvillage Rd.

CITY, STATE: Slidell, LA ZIP: 70460

TELEPHONE: (985) 643-2427 FAX: (985) 643-2691

EMAIL ADDRESS: brotolo@rotoloconsultants.com

In the event that addenda are issued with this bid, bidders MUST acknowledge all addenda on the bid form. Bidder must acknowledge receipt of an addendum on the bid form as indicated. Failure to acknowledge any addendum on the bid form will result in bid rejection.

Acknowledge Receipt of Addenda: NUMBER: 1

NUMBER: 2

NUMBER: _____

NUMBER: _____

TOTAL PRICE OF ALL BID ITEMS: \$ 191,654.06

AUTHORIZED

SIGNATURE: 

Brian Rotolo

TITLE: VP of Finance

Printed Name

SIGNING INDICATES YOU HAVE READ AND COMPLY WITH THE INSTRUCTIONS AND CONDITIONS.

NOTE: All bids should be returned with the BID NUMBER and BID OPENING DATE indicated on the outside of the envelope submitted to the Purchasing Department.

INVITATION TO BID FROM JEFFERSON PARISH - continued

BID NO.: 50-00123897

SEALED BID

ITEM NUMBER	QUANTITY	U/M	DESCRIPTION OF ARTICLES	UNIT PRICE QUOTED	TOTALS
			TWO YEAR MAINTENANCE CONTRACT FOR IRRIGATION SERVICES AT VARIOUS LOCATIONS FOR JEFFERSON PARISH DEPARTMENT OF PUBLIC WORKS- PARKWAYS		
1	24.00	MO	0010 MANHATTAN BLVD. MONTHLY WALK THRU/ TEST OF IRRIGATION SYSTEM	\$162.00	\$3,888.00
2	24.00	MO	0020 WEST ESPLANADE WALK THRU/ TEST OF IRRIGATION SYSTEM	\$421.00	\$10,104.00
3	24.00	MO	0030 WEST NAPOLEON WALK THRU/ TEST OF IRRIGATION SYSTEM	\$295.00	\$7,080.00
4	24.00	MO	0040 LAPALCO BRIDGE WALK THRU/ TEST OF IRRIGATION SYSTEM	\$102.00	\$2,448.00
5	24.00	MO	0050 TERRY PARKWAY WALK THRU/ TEST OF IRRIGATION SYSTEM	\$459.00	\$11,016.00
6	24.00	MO	0060 FOCIS STREET WALK THRU/ TEST OF IRRIGATION SYSTEM	\$130.00	\$3,120.00
7	24.00	MO	0070 JEFFERSON POCKET PARK WALK THRU/ TEST OF IRRIGATION SYSTEM	\$133.00	\$5,616.00
8	24.00	MO	0080 SEVERN AVENUE WALK THRU/ TEST OF IRRIGATION SYSTEM	\$234.00	\$687.50
9	10.00	EA	0090 1 INCH IRRIGATION VALVE	\$68.75	\$1,250.00
10	10.00	EA	0100 1.5 INCH IRRIGATION VALVE	\$125.00	\$1,250.00
11	10.00	EA	0110 2 INCH IRRIGATION VALVE	\$156.25	\$1,562.50
12	10.00	EA	0120 12 INCH IRRIGATION POP-UP	\$12.50	\$125.00
13	10.00	EA	0130 4 INCH IRRIGATION POP-UP	\$2.50	\$25.00

INVITATION TO BID FROM JEFFERSON PARISH - continued

BID NO.: 50-00123897

SEALED BID

ITEM NUMBER	QUANTITY	U/M	DESCRIPTION OF ARTICLES	UNIT PRICE QUOTED	TOTALS
14	10.00	EA	0140 IRRIGATION NOZZLE	\$2.50	\$25.00
15	10.00	EA	0150 IRRIGATION TURF ROTOR HEAD	\$12.50	\$125.00
16	10.00	LF	0160 IRRIGATION MAIN LINE REPAIR	\$62.50	\$625.00
17	10.00	LF	0170 IRRIGATION LATERAL LINE REPAIR	\$43.75	\$437.50
18	2.00	EA	0180 IRRIGATION CONTROLLER	\$362.50	\$725.00
19	2.00	EA	0190 IRRIGATION 1 INCH RPA BACKFLOW PREVENTER	\$672.88	\$1,345.76
20	2.00	EA	0200 IRRIGATION 2 INCH RPA BACKFLOW PREVENTER	\$2,187.50	\$4,375.00
21	2.00	EA	0210 CLASS II 1 INCH RPA BACKFLOW COVER (NO BASE) (GREEN)	\$250.00	\$500.00
22	2.00	EA	0220 CLASS II 1 INCH RPA BACKFLOW BASE (NO COVER) (GREEN)	\$250.00	\$500.00
23	2.00	EA	0230 CLASS II 1 INCH RPA BACKFLOW COVER CONCRETE FOUNDATION (GREEN)	\$250.00	\$500.00
24	2.00	EA	0240 CLASS II 2 INCH RPA BACKFLOW COVER (NO BASE) (GREEN)	\$250.00	\$500.00
25	2.00	EA	0250 CLASS II 2 INCH RPA BACKFLOW BASE (NO COVER) (GREEN)	\$250.00	\$500.00
26	2.00	EA	0260 CLASS II 2 INCH RPA BACKFLOW COVER CONCRETE FOUNDATION (GREEN)	\$250.00	\$500.00
27	2.00	EA	0270 6 INCH ROUND IRRIGATION VALVE BOX	\$43.75	\$87.50

INVITATION TO BID FROM JEFFERSON PARISH - continued

BID NO.: 50-00123897

SEALED BID

ITEM NUMBER	QUANTITY	U/M	DESCRIPTION OF ARTICLES	UNIT PRICE QUOTED	TOTALS
28	2.00	EA	0280 10 INCH ROUND IRRIGATION VALVE BOX	\$56.25	\$112.50
29	2.00	EA	0290 14 INCH X 19 INCH IRRIGATION VALVE BOX	\$68.75	\$137.50
30	2.00	EA	0300 13 INCH X 20 INCH IRRIGATION VALVE BOX	\$50.00	\$100.00
31	2.00	EA	0310 13 INCH X 24 INCH IRRIGATION VALVE BOX	\$50.00	\$100.00
32	5.00	HR	0320 IRRIGATION WIRE TRACKING	\$62.50	\$312.50
33	20.00	LF	0330 WIRE REPAIR	\$6.25	\$125.00
34	20.00	EA	0340 WATERPROOF IRRIGATION WIRE SPLICE	\$6.25	\$125.00
35	2.00	LF	0350 IRRIGATION LINE TUNNELING (UNDER 5 FOOT PER)	\$43.75	\$87.50
36	20.00	LF	0360 IRRIGATION LINE MACHINE BORING (OVER 5 FOOT PER)	\$31.25	\$625.00
37	10.00	EA	0370 NIPPLE RISERS 1/2 INCH X 3 INCH (FOR POP UPS)	\$50.00	\$500.00
38	10.00	EA	0380 NIPPLE RISERS 3/4 INCH X 3 INCH (FOR ROTORS)	\$43.75	\$437.50
39	10.00	EA	0390 SOLENOID - (RAIN BIRD)	\$50.00	\$500.00
40	10.00	EA	0400 SOLENOID - (HUNTER)	\$43.75	\$437.50
41	10.00	EA	0410 RAIN BIRD 1800 6 INCH EXTENSIONS RISERS	\$3.75	\$37.50

INVITATION TO BID FROM JEFFERSON PARISH - continued

BID NO.: 50-00123897

SEALED BID

ITEM NUMBER	QUANTITY	U/M	DESCRIPTION OF ARTICLES	UNIT PRICE QUOTED	TOTALS
42	10.00	EA	0420 DIAPHRAM - 1 INCH VALVE (RAIN BIRD)	\$125.00	\$1,250.00
43	10.00	EA	0430 DIAPHRAM - 1.5 INCH (RAIN BIRD)	\$125.00	\$1,250.00
44	10.00	EA	0440 DIAPHRAM 2 INCH - VALVE (RAIN BIRD)	\$125.00	\$1,250.00
45	10.00	EA	0450 DIAPHRAM - 1 INCH VALVE (HUNTER)	\$62.50	\$625.00
46	10.00	EA	0460 DIAPHRAM - 1.5 INCH VALVE (HUNTER)	\$62.50	\$625.00
47	10.00	EA	0470 DIAPHRAM - 2 INCH VALVE (HUNTER)	\$175.00	\$1,750.00
48	10.00	EA	0480 HUNTER M.P. ROTOR NOZZLES	\$18.75	\$187.50
49	10.00	EA	0490 HUNTER XC HYBIRD CONTROLLER WITH STAINLESS STEEL BOX: XCH-600-SS(6 STATION)	\$733.75	\$7,357.50
50	10.00	EA	0500 HUNTER XC HYBIRD CONTROLLER WITH STAINLESS STEEL BOX: XCH-1200-SS(12 STATION)	\$911.25	\$9,112.50
51	10.00	EA	0510 HUNTER I-CORE MODULAR CONTROLLER WITH METAL CABINET (HUNTER IC-600-M)	\$1,161.00	\$11,610.00
52	10.00	EA	0520 HUNTER 6 STATION EXPANSION MODULES (HUNTER ICM-600)	\$151.20	\$1,512.00
53	10.00	EA	0530 16 GAUGE DIRECT BURIAL IRRIGATION WIRE	.27	\$2.70
54	10.00	EA	0540 HUNTER 2-WIRE DECODER CONTROLLER WITH METAL CABINET (HUNTER ACC-99D)	\$3,157.00	\$31,570.00
55	10.00	FT	0550 14 GAUGE SOLID CORE TWISTED IRRIGATION WIRE	.36	\$3.60

INVITATION TO BID FROM JEFFERSON PARISH - continued

BID NO.: 50-00123897

SEALED BID

ITEM NUMBER	QUANTITY	U/M	DESCRIPTION OF ARTICLES	UNIT PRICE QUOTED	TOTALS
56	10.00	EA	0560 HUNTER WIRELESS SOLAR SYNC WEATHER SENSOR (HUNTER WSS-SEN)	\$297.00	\$2,970.00
57	10.00	EA	0570 1 INCH SIGNATURE SOLO RAIN 8015 BATTERY VALVE/TIMER	\$252.00	\$2,520.00
58	10.00	EA	0580 HUNTER DECODER (ICD-100)	\$355.74	\$3,557.40
59	10.00	EA	0590 HUNTER DECODER (ICD-200)	\$596.37	\$5,963.70
60	10.00	EA	0600 HUNTER DECODER GROUNDING ROD	\$78.36	\$783.60
61	10.00	EA	0610 HUNTER NODE BATTERY TIMER (NODE-100)	\$376.65	\$3,766.50
62	10.00	EA	0620 HUNTER NODE BATTERY TIMER (NODE-200)	\$491.73	\$4,917.30
63	10.00	EA	0630 HUNTER NODE BATTERY TIMER (NODE-400)	\$596.37	\$5,963.70
64	10.00	EA	0640 HUNTER NODE BATTERY TIMER (NODE-600)	\$405.00	\$4,050.00
65	10.00	EA	0650 1 INCH HUNTER PGV DC LATCHING SOLENOID VALVE	\$63.87	\$638.70
66	10.00	EA	0660 1 1/2 INCH HUNTER PGV DC LATCHING SOLENOID VALVE	\$63.87	\$638.70
67	10.00	EA	0670 2 INCH HUNTER PGV DC LATCHING SOLENOID VALVE	\$63.87	\$638.70
68	10.00	EA	0680 1 INCH HUNTER ICV VALVE	\$162.00	\$1,620.00

INVITATION TO BID FROM JEFFERSON PARISH - continued

BID NO.: 50-00123897

SEALED BID

ITEM NUMBER	QUANTITY	U/M	DESCRIPTION OF ARTICLES	UNIT PRICE QUOTED	TOTALS
69	10.00	EA	0690 1 1/2 INCH HUNTER ICV VALVE	\$216.00	\$2,160.00
70	10.00	EA	0700 2 INCH HUNTER ICV VALVE	\$292.95	\$2,929.50
71	10.00	EA	0710 1 INCH BRASS GATE VALVE	\$32.07	\$320.70
72	10.00	EA	0720 1 1/2 INCH BRASS GATE VALVE	\$63.06	\$630.60
73	10.00	EA	0730 2 INCH BRASS GATE VALVE	\$85.14	\$851.40
74	10.00	FT	0740 MULTI-STRAND IRRIGATION WIRE	\$1.17	\$11.70
75	10.00	EA	0750 3M DBR/Y-6 WATERPROOF CONNECTORS	\$8.34	\$83.40
76	10.00	EA	0760 25 INCH X 19 INCH RECTANGULAR VALVE BOX	\$83.54	\$835.40
77	1.00	ONLY	0770 DIRECTOR APPROVED INCIDENTAL NO PRICE IS ENTERED FOR THIS ITEM. THIS ITEM IS HERE FOR USE DURING THE CONTRACT TERM FOR ANY ADDITIONAL REPAIR AND OR REPLACEMENT NOT INCLUDED ON THE INCIDENTAL LINE ITEMS SHEET. THIS ITEM WILL NOT BE USED IN DETERMINING THE LOW BIDDER AND WILL NOT BE INCLUDED IN THE OVERALL CONTRACT PRICE.	N/A	N/A
78	10.00	HR	0780 ADDITIONAL LOCATIONS - WESTBANK HOURLY RATE FOR TROUBLESHOOTING FOLLOW INCIDENTAL LIST FOR COST OF REPAIRS	\$75.00	\$750.00
79	10.00	HR	0790 ADDITIONAL LOCATIONS - EASTBANK HOUR RATE FOR TROUBLESHOOTING	\$75.00	\$750.00

INVITATION TO BID FROM JEFFERSON PARISH - continued

BID NO.: 50-00123897

SEALED BID

ITEM NUMBER	QUANTITY	U/M	DESCRIPTION OF ARTICLES	UNIT PRICE QUOTED	TOTALS
			FOLLOW INCIDENTAL LIST FOR COST OF REPAIRS		
80	10.00	EA	0800 ADDITIONAL CONTROLLER CHECK FOR MANHATTAN BLVD	\$104.00	\$1,040.00
			AS REQUESTED BY JEFFERSON PARISH		
81	10.00	EA	0810 ADDITIONAL CONTROLLER CHECK FOR WEST ESPLANADE AVE	\$238.00	\$2,380.00
			AS REQUESTED BY JEFFERSON PARISH		
82	10.00	EA	0820 ADDITIONAL CONTROLLER CHECK FOR WEST NAPOLEON	\$151.00	\$1,510.00
			AS REQUESTED BY JEFFERSON		
83	10.00	EA	0830 ADDITIONAL CONTROLLER CHECK FOR LAPALCO BRIDGE	\$77.00	\$770.00
			AS REQUESTED BY JEFFERSON PARISH		
84	10.00	EA	0840 ADDITIONAL CONTROLLER CHECK FOR TERRY PARKWAY	\$250.00	\$2,500.00
			AS REQUESTED BY JEFFERSON PARISH		
85	10.00	EA	0850 ADDITIONAL CONTROLLER CHECK FOR FOCIS STREET	\$86.00	\$860.00
			AS REQUESTED BY JEFFERSON PARISH		
86	10.00	EA	0860 ADDITIONAL CONTROLLER CHECK FOR JEFFERSON POCKET PARK	\$103.00	\$1,030.00
			AS REQUESTED BY JEFFERSON PARISH		
87	10.00	EA	0870 ADDITIONAL CONTROLLER CHECK FOR SEVERN AREA	\$161.00	\$1,610.00
			AS REQUESTED BY JEFFERSON PARISH		

Bid 50-00123897

SPECIFICATIONS

**Specifications
For
Irrigation
for Jefferson Parish**

Contents

Section 1 Information for Bidders

- 1.1 Bid Requirements
- 1.2 Special Conditions

Section 2 Technical Specifications

- 2.1 Summary of Work
- 2.2 Scope of Work
- 2.3 Location of the Sites

Section 1.0 Information for Bidders

1.1 BID REQUIREMENTS

1.1.1 Contract Terms – This a contract for this two (2) year maintenance contract. The contract end date for this will be second anniversary two years after.

1.1.2 A MANDATORY Pre-Bid Conference will be held at 10:00 am on 09/06/2018 in the GGB Building located at 200 Derbigny Street, Suite 4400, Gretna, La 70053. All bidders must attend the Mandatory pre-bid conference and will be required to sign in and out as evidence of attendance. In accordance with LSA R.S. 38:2212(I), all prospective bidders shall be present at the beginning of the Mandatory pre-bid conference and shall remain in attendance for the duration of the conference. Any prospective bidder who fails to attend the conference or remain for the duration shall be prohibited from submitting a bid for the project.

1.1.3 Bid Bond – a Surety Bond is required in 5% of bid submission and is due with bid submission.

1.1.4 Performance Bond – a performance bond in 50% of the contract amount will be due at the signing of the formal contract.

1.1.5 Required Licenses –The vendor must have a Louisiana Department of Agriculture Business License in the category of Louisiana Department of Agriculture and Forestry Irrigation Contractor's License. A copy of the front and back of the license is required with bid submission or the bid response will be deemed non-responsive. The licenses are required to be valid through the contract term.

1.2 SPECIAL CONDITIONS

1.2.1 Definitions

1.2.1.1 Median – The entire area between the back of curb of opposing multiple travel lanes. For example: A boulevard has two one-direction lanes traveling north and two one-direction lanes traveling south. The lanes are divided by an area 50' wide as measured from the back of curb of the north bound lanes to the back of curb of the southbound lanes. This 50' area is the median.

1.2.1.2 Repair/Replacement – A list of incidental repair items is included with this bid. All bidders shall price the incidental items on the bid form for the possibility of providing and installing the items during the life of the contract. There is no

minimum or maximum quantity of each item that may be required during the contract. Each item, if required during the contract, will be invoiced in addition to the monthly invoice. All items will require prior approval from Jefferson Parish before being purchased and installed. Whenever possible, the contractor shall supply the same manufacturer and product number of any incidental items he repairs/replaces. All incidentals item pricing shall include all freight, taxes, labor, tools and supplies to properly install each item.

Any additional repair and or replacement not included on the incidental line items sheet, including all associated labor, delivery charges and taxes, shall be approved by Jefferson Parish prior to that repair taking place. The Contractor shall provide a written description of the work to be performed and included all pricing for approval by Jefferson Parish prior to performing the work.

1.2.2 Equipment Requirements – The Contractor shall determine the equipment that is to be used. The bid shall include equipment, operators, fuel, maintenance and transportation. All equipment shall be in a good state of operation and shall be maintained to work and perform the tasks it was designed for in an expedient time frame. Continual breakdown, repairs or work stoppage due to equipment failure will not be permitted. Any damage that occurs to the Site related to faulty equipment shall be repaired immediately at the Contractor's expense. All equipment required to complete the associated tasks shall be furnished upon request. The following information shall be included: type, make, model, manufacturer and quantity.

1.2.3 Work Compliance – The proposed work must comply with OSHA, DOT, Jefferson Parish and any other applicable agency requirements and regulations regarding this variety of work. The Contractor will present Jefferson Parish with all licenses and permits required to perform the work upon request.

1.2.4 Associated Costs – It is the Contractor's responsibility to maintain the Sites to the highest standard. However, the Contractor is not responsible for any replacement costs, or labor that exceeds the work outlined in this document.

1.2.5 Maintenance Reports – A monthly maintenance report may be required by the Jefferson Parish Parkways Department to be kept submitted with monthly invoices. These reports, if required, are records used for tracking and quality assurance purposes. The Contractor is required to notify Jefferson Parish within 24 hours of any problems and/or restrictions that would prevent him from performing his duties. The Contractor shall provide his own form.

1.2.6 Inspections – Frequent inspections of area of work performed shall be made by Jefferson Parish personnel to determine the acceptance of the work performed. In the event the work is considered unacceptable, the Contractor will be directed to immediately

employ any and all methods or means to bring the area up to an acceptable level within three (3) days of notice, without any extra cost to Jefferson Parish. The discovery of any fraudulent activities associated with this contract during the inspection process will be grounds for immediate contract termination without further compensation. In addition, such circumstances may initiate possible legal ramifications for the Contractor.

Every month a required walkthrough of all Sites will be part of this bid. The company manager and his job superintendent will walk all portion of the job with the Jefferson Parish horticulturalist to monitor the condition of the maintenance program.

1.2.7 Traffic Control and Signs – The Contractor shall provide all necessary barricades, signs, lights and warning devices or any other item necessary in order to properly move traffic around or through his operations. Set up, removal and maintenance of all traffic control equipment shall be by the Contractor. Slow moving vehicle signs and flashing lights shall be installed on all moving equipment that will use the public rights-of-way for movement of equipment. In the event that a lane of traffic will need to be closed, the Contractor shall provide sufficient notification to the Jefferson Parish Traffic Engineer of necessity to close any portion of the roadway carrying vehicles or pedestrians. The Contractor will request final approval of such closings from the Department of Public Works, Traffic Engineering Division, at least ten (10) working days in advance.

1.2.7.1 The Contractor shall be responsible for providing safe and expedient movement of traffic through the work Sites. The Contractor must have in place prior to work, a method of recording, responding and repairing legitimately broken glass, windshields or any other kind of damage experienced due to the work being performed.

1.2.7.2 The Louisiana State Manual for Uniform Traffic Control shall be strictly enforced.

1.2.8 Work Periods – No work shall be done between 6:00 p.m. and 7:00 a.m., or on Saturdays, Sundays, or legal holidays without permission from Jefferson Parish. However, emergency work may be done without prior permission. In the event that the Contractor wishes to work weekends, holidays or outside the allowed times of the local governing bodies, he must secure permission from Jefferson Parish, and provide at least 72 hours notification of his intentions. Contractor must also be aware of any local event that may affect his scheduled maintenance operation.

1.2.9 Utility Service Interrupt – In the event of interruption of public or private utility service or general damage to public or private properties as a result of accidental breakage or any other actions by the Contractor, he shall immediately notify the proper authority and/or property owner and shall fully cooperate with said authority or owner

until the service is restored to its previous capacity. All costs associated with the notification and repair shall be paid for by the Contractor.

1.2.10 Ongoing Contracts – It is possible that other Contractors may be working within close proximity of the locations of work. The Contractor shall coordinate his work with any other Contractors working in or around the locations. Should a conflict occur, a Parish representative will make all final decisions.

1.2.11 Nuisance Control – The Contractor shall include in his bid the control of dust, noise and odors created by his operations. All controls shall be completed in order that nuisances are minimized and occur within the standards of all governing bodies.

1.2.12 Transferring Contracts – Transfer of this contract shall not be allowed under any circumstances unless an amendment is passed by the Jefferson Parish council.

1.2.13 Safety Precautions – The Contractor shall strictly follow approved and normal safety practices during all operations. The Contractor shall follow the guidelines as noted in the OSHA requirements.

Section 2.0 Technical Specifications

2.1 SUMMARY OF WORK

- 2.1.1 Approach** - Jefferson Parish is the turnkey operation to include, but not limited, automatic irrigation maintenance, and associated maintenance of the sites throughout Jefferson Parish. This will be a more specialized maintenance assistance bid which is intended to supplement the work performed by the current maintenance contract with Jefferson Parish with respect to the maintenance of Parish facilities and public rights-of-way.
- 2.1.2 General Scope** - Jefferson Parish is soliciting bids from qualified Contractors for the turnkey operation to include, but not limited, automatic irrigation maintenance, and associated maintenance of the sites throughout Jefferson Parish. The expression turnkey shall include but may not be limited to all labor, material, equipment, transportation, insurances, licenses, qualifications, experience, removal and disposal, to accomplish the scope of work as defined in Section 2.2. Jefferson Parish will contract with a qualified Contractor capable of providing turnkey planning, management, implementation and the coordination of these efforts with Parish officials.

2.2 SCOPE OF WORK

- 2.2.1 General** - The scope of work shall include all items as listed within Section 2.0 of these specifications. This shall include turnkey maintenance of the designated Sites to include all irrigation pertaining to the listed maintenance for Jefferson Parish.
- 2.2.1.1 Questions** – All questions must be submitted in writing to the Jefferson Parish Purchasing Department a minimum of five (5) working days prior to the bid opening. All questions will be answered in writing, and submitted to all Contractors involved in the bidding process.
- 2.2.2 Bid Amount** – The bid price includes all insurance, products, equipment, labor, operators, fuel and transportation to and from the work Sites. The Contractor shall be aware and shall be held responsible under this contract to the requirements prescribed by the following resolution and all the amendments. Contractor shall refer to resolution **113646** “Provides for a uniform set of general specifications and conditions for all Contractors engaged in performing works or services for the Parish of Jefferson”.

2.2.3 Automatic Irrigation – As an integral part of the improvements, and for the long term success and survivability of the planted areas, an automatic irrigation system has been installed in all garden bed areas turf areas. Monitoring of the system and performing the necessary repairs to the system is required by the Contractor. These tasks include, but may not be limited to, replacement of heads, broken water lines and valves; adjustment of the controller, heads, valves and zone water durations and frequencies. All irrigation repair costs will be as per the incidental list provided by the contractor and shall be performed within two working days of the issue being discovered by the Contractor and/or the Owner. Irrigation repair costs shall be submitted with the monthly invoice. The Contractor must receive approval from Jefferson Parish prior to any repairs.

The Contractor shall be responsible for making a complete walk-through/test of each irrigation system approximately nine (9) to twelve (12) visits per year as directed by Jefferson Parish. The Contractor shall create a report of the system for each site detailing the following information:

- Date/Time of test;
- Irrigation technician performing the test;
- Weather conditions;
- Note the controller settings for that day;
- As needed, or requested by Jefferson Parish, adjust controller settings for each site;
- Note any malfunctioning components of the system;
- Recommend repairs for any discovered malfunctions.

In addition to the monthly test of the irrigation systems, the Contractor shall include approximately six (6) to ten (10) additional site visits for controller adjustment as directed by Jefferson Parish. When requested by Jefferson Parish, the Contractor shall have an irrigation technician adjust the irrigation controllers at each site to account for weather changes. This may included, but not be limited to, watering frequencies and durations.

Sprinkler head adjustment (aiming) is not considered incidental work or part of the required site inspections and controller adjustments, and shall not be charged as such. Head adjustments shall be made, when noticed by the Contractor, at each site(s) visit.

2.2.4 Drainage – Monitor all aspects of the drainage system located within the maintenance sites including catch basins, grates and swales. Clean and discard any blockages as necessary. Clogged or broken drain lines, or defects in catch basins are to be reported to the Jefferson Parish Streets Department as soon as they are discovered.

2.2.5 General – At the discretion of the Jefferson Parish Horticulturalist products, methods and application rates may be adjusted due to cultural changes or plant needs. Any changes in these specifications will not create additional financial obligations for the Contractor.

2.3 LOCATIONS OF THE SITES (BASE BID)

2.3.1 Manhattan – from Lapalco Boulevard to 12th Street

2.3.2 West Esplanade – from Power Boulevard to Orpheum Avenue

2.3.3 West Napoleon – from Michigan Avenue to Kent Avenue

2.3.4 Lapalco Bridge – Northwest side of Lapalco Bridge to Destrehan Avenue

2.3.5 Terry Parkway – from Carol Sue to Laurel Avenue

2.3.6 Focis Street – from Canal Street to Old Metairie Village Shopping Center

2.3.7 Jefferson Pocket Park – 9932 Jefferson Highway, River Ridge

2.3.8 Severn Avenue – 17th Street, 18th Street, 19th Street (N. Arnoult Rd. to Severn Ave.)

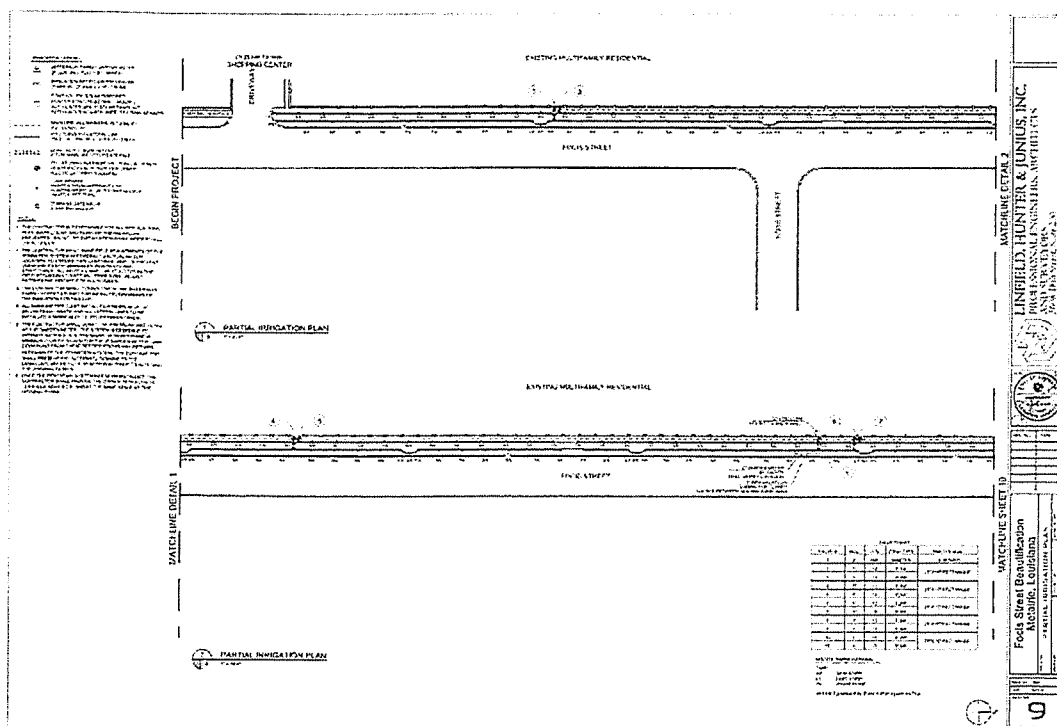

1. THE DESIGNER HAS REVIEWED THE RECORD DRAWINGS AND FIELD SURVEY DATA FOR THE PROJECT AND HAS FOUND THEM TO BE ACCURATE AND COMPLETE.
 2. THE DESIGNER HAS REVIEWED THE RECORD DRAWINGS AND FIELD SURVEY DATA FOR THE PROJECT AND HAS FOUND THEM TO BE ACCURATE AND COMPLETE.
 3. THE DESIGNER HAS REVIEWED THE RECORD DRAWINGS AND FIELD SURVEY DATA FOR THE PROJECT AND HAS FOUND THEM TO BE ACCURATE AND COMPLETE.
 4. THE DESIGNER HAS REVIEWED THE RECORD DRAWINGS AND FIELD SURVEY DATA FOR THE PROJECT AND HAS FOUND THEM TO BE ACCURATE AND COMPLETE.
 5. THE DESIGNER HAS REVIEWED THE RECORD DRAWINGS AND FIELD SURVEY DATA FOR THE PROJECT AND HAS FOUND THEM TO BE ACCURATE AND COMPLETE.
 6. THE DESIGNER HAS REVIEWED THE RECORD DRAWINGS AND FIELD SURVEY DATA FOR THE PROJECT AND HAS FOUND THEM TO BE ACCURATE AND COMPLETE.
 7. THE DESIGNER HAS REVIEWED THE RECORD DRAWINGS AND FIELD SURVEY DATA FOR THE PROJECT AND HAS FOUND THEM TO BE ACCURATE AND COMPLETE.
 8. THE DESIGNER HAS REVIEWED THE RECORD DRAWINGS AND FIELD SURVEY DATA FOR THE PROJECT AND HAS FOUND THEM TO BE ACCURATE AND COMPLETE.
 9. THE DESIGNER HAS REVIEWED THE RECORD DRAWINGS AND FIELD SURVEY DATA FOR THE PROJECT AND HAS FOUND THEM TO BE ACCURATE AND COMPLETE.
 10. THE DESIGNER HAS REVIEWED THE RECORD DRAWINGS AND FIELD SURVEY DATA FOR THE PROJECT AND HAS FOUND THEM TO BE ACCURATE AND COMPLETE.

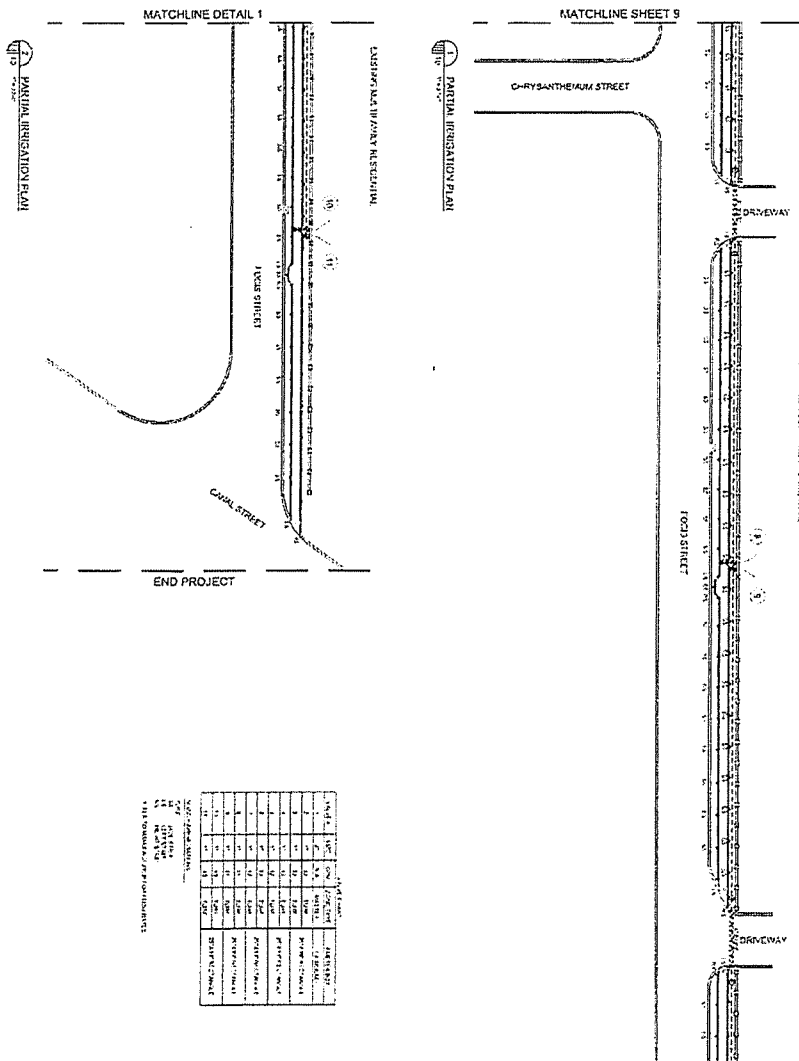

1. THE DESIGNER HAS REVIEWED THE RECORD DRAWINGS AND FIELD SURVEY DATA FOR THE PROJECT AND HAS FOUND THEM TO BE ACCURATE AND COMPLETE.
 2. THE DESIGNER HAS REVIEWED THE RECORD DRAWINGS AND FIELD SURVEY DATA FOR THE PROJECT AND HAS FOUND THEM TO BE ACCURATE AND COMPLETE.
 3. THE DESIGNER HAS REVIEWED THE RECORD DRAWINGS AND FIELD SURVEY DATA FOR THE PROJECT AND HAS FOUND THEM TO BE ACCURATE AND COMPLETE.
 4. THE DESIGNER HAS REVIEWED THE RECORD DRAWINGS AND FIELD SURVEY DATA FOR THE PROJECT AND HAS FOUND THEM TO BE ACCURATE AND COMPLETE.
 5. THE DESIGNER HAS REVIEWED THE RECORD DRAWINGS AND FIELD SURVEY DATA FOR THE PROJECT AND HAS FOUND THEM TO BE ACCURATE AND COMPLETE.
 6. THE DESIGNER HAS REVIEWED THE RECORD DRAWINGS AND FIELD SURVEY DATA FOR THE PROJECT AND HAS FOUND THEM TO BE ACCURATE AND COMPLETE.
 7. THE DESIGNER HAS REVIEWED THE RECORD DRAWINGS AND FIELD SURVEY DATA FOR THE PROJECT AND HAS FOUND THEM TO BE ACCURATE AND COMPLETE.
 8. THE DESIGNER HAS REVIEWED THE RECORD DRAWINGS AND FIELD SURVEY DATA FOR THE PROJECT AND HAS FOUND THEM TO BE ACCURATE AND COMPLETE.
 9. THE DESIGNER HAS REVIEWED THE RECORD DRAWINGS AND FIELD SURVEY DATA FOR THE PROJECT AND HAS FOUND THEM TO BE ACCURATE AND COMPLETE.
 10. THE DESIGNER HAS REVIEWED THE RECORD DRAWINGS AND FIELD SURVEY DATA FOR THE PROJECT AND HAS FOUND THEM TO BE ACCURATE AND COMPLETE.

NO.	DESCRIPTION	DATE	BY	CHECKED BY
1	DESIGN	10/1/00	J. HUNTER	J. HUNTER
2	DESIGN	10/1/00	J. HUNTER	J. HUNTER
3	DESIGN	10/1/00	J. HUNTER	J. HUNTER
4	DESIGN	10/1/00	J. HUNTER	J. HUNTER
5	DESIGN	10/1/00	J. HUNTER	J. HUNTER
6	DESIGN	10/1/00	J. HUNTER	J. HUNTER
7	DESIGN	10/1/00	J. HUNTER	J. HUNTER
8	DESIGN	10/1/00	J. HUNTER	J. HUNTER
9	DESIGN	10/1/00	J. HUNTER	J. HUNTER
10	DESIGN	10/1/00	J. HUNTER	J. HUNTER

10

Focus Street Beautification
Metairie, Louisiana

PARTIAL IRRIGATION PLAN

LINFIELD, HUNTER & JUNIUS, INC.
PROFESSIONAL ENGINEERS, ARCHITECTS
AND SURVEYORS
2608 18th Street, Suite 200
Metairie, Louisiana 70002

[illegible]

^a The authors thank Dr. J. H. Duerksen for his critical reading of the manuscript.

4. Explain the following terms in your own words:
 - a. Aqueous solution
 - b. Solvent
 - c. Solute
 - d. Solubility
 - e. Insoluble
 - f. Miscible
 - g. Immiscible
5. Explain the following terms in your own words:
 - a. Saturated solution
 - b. Unsaturated solution
 - c. Supersaturated solution
6. Explain the following terms in your own words:
 - a. Concentration
 - b. Molarity
 - c. Molality
 - d. Normality
 - e. Percent by mass
 - f. Percent by volume
 - g. Mole fraction
7. Explain the following terms in your own words:
 - a. Dilution
 - b. Titration
 - c. Indicator
 - d. End point
 - e. Equivalence point

[illegible]

1. The first step is to identify the problem or question that needs to be answered. This involves understanding the context and the specific requirements of the task.

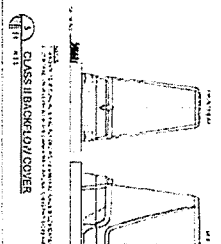
[illegible]

24. *Stachys affinis*
A. Aromatic herb with a square stem, opposite leaves, and whorled flowers. It is a common plant in the field.
B. Aromatic herb with a square stem, opposite leaves, and whorled flowers. It is a common plant in the field.
C. Aromatic herb with a square stem, opposite leaves, and whorled flowers. It is a common plant in the field.
D. Aromatic herb with a square stem, opposite leaves, and whorled flowers. It is a common plant in the field.

22. Auld, S.G. 1971.
A study of the ecology of *Peromyscus maniculatus* in the marshes of the York River, Virginia. *Journal of Wildlife Management* 35: 1-14.

[illegible][illegible]

© 1999 Blackwell Science Ltd, *Journal of Clinical Pharmacy and Therapeutics*, 24, 131–136

[illegible]

It is possible to write a program that will take any number of arguments and will print out the arguments in reverse order. This is a simple program, but it is a good one to write as an exercise. The program is as follows:

```

1  #!/usr/bin/perl
2  my @args = @ARGV;
3  for (my $i = $#args; $i >= 0; $i--) {
4      print $args[$i] . " ";
5  }
6  print "\n";

```

The program is a Perl script. It starts with a shebang line, `#!/usr/bin/perl`, which tells the system that the script should be run using the Perl interpreter. The next line is `my @args = @ARGV;`, which declares a local array named `@args` and assigns it the value of the `@ARGV` array, which contains the command-line arguments. The `for` loop then iterates over the elements of `@args` in reverse order, starting from the last element (`$#args`) and ending at the first element (`0`). Inside the loop, the element at the current index is printed, followed by a space. After the loop, a newline character is printed.

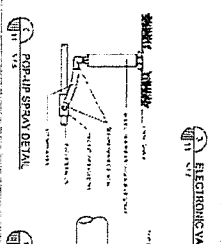
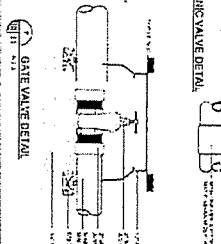

Figure 1 is a schematic diagram of the experimental setup. It shows a cross-section of a container with a liquid level. A vertical tube is inserted into the liquid. A piston is located at the bottom of the tube. A pressure sensor is connected to the tube. A gas inlet is at the top of the tube. A gas outlet is at the bottom of the tube. A gas inlet is at the top of the tube. A gas outlet is at the bottom of the tube. A gas inlet is at the top of the tube. A gas outlet is at the bottom of the tube.

1
11 112A
CONTROLLER DETAIL

Technical drawing of a mechanical component, likely a valve or pump assembly, showing internal parts and a cross-section.



UNIUS, INC.
ARCHITECTS

FIELD, HUNTER
PROFESSIONAL ENGINEER
SURVEYORS
1111 North Street, Suite 200
Baton Rouge, Louisiana 70802

tion	
1. 16	
2. 16	
3. 16	
4. 16	
5. 16	
6. 16	
7. 16	
8. 16	
9. 16	
10. 16	
11. 16	
12. 16	
13. 16	
14. 16	
15. 16	
16. 16	
17. 16	
18. 16	
19. 16	
20. 16	
21. 16	
22. 16	
23. 16	
24. 16	
25. 16	
26. 16	
27. 16	
28. 16	
29. 16	
30. 16	
31. 16	
32. 16	
33. 16	
34. 16	
35. 16	
36. 16	
37. 16	
38. 16	
39. 16	
40. 16	
41. 16	
42. 16	
43. 16	
44. 16	
45. 16	
46. 16	
47. 16	
48. 16	
49. 16	
50. 16	
51. 16	
52. 16	
53. 16	
54. 16	
55. 16	
56. 16	
57. 16	
58. 16	
59. 16	
60. 16	
61. 16	
62. 16	
63. 16	
64. 16	
65. 16	
66. 16	
67. 16	
68. 16	
69. 16	
70. 16	
71. 16	
72. 16	
73. 16	
74. 16	
75. 16	
76. 16	
77. 16	
78. 16	
79. 16	
80. 16	
81. 16	
82. 16	
83. 16	
84. 16	
85. 16	
86. 16	
87. 16	
88. 16	
89. 16	
90. 16	
91. 16	
92. 16	
93. 16	
94. 16	
95. 16	
96. 16	
97. 16	
98. 16	
99. 16	
100. 16	

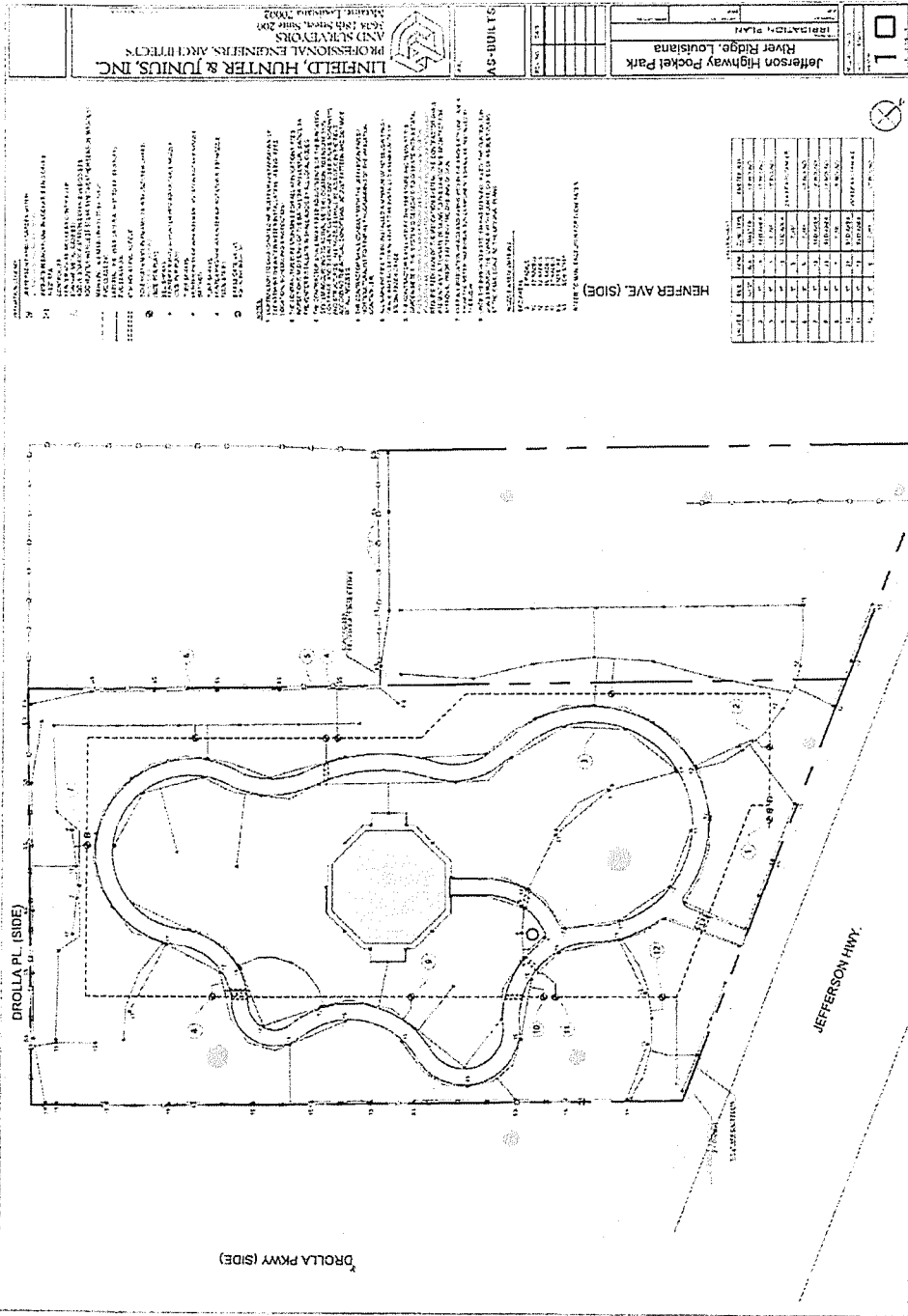

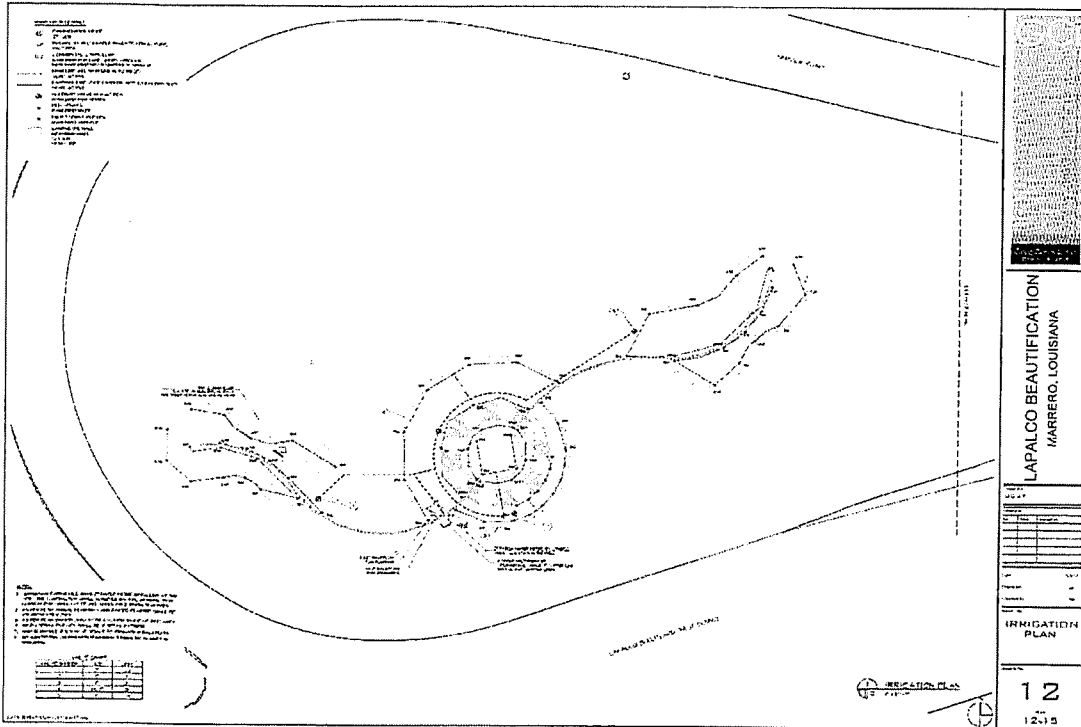

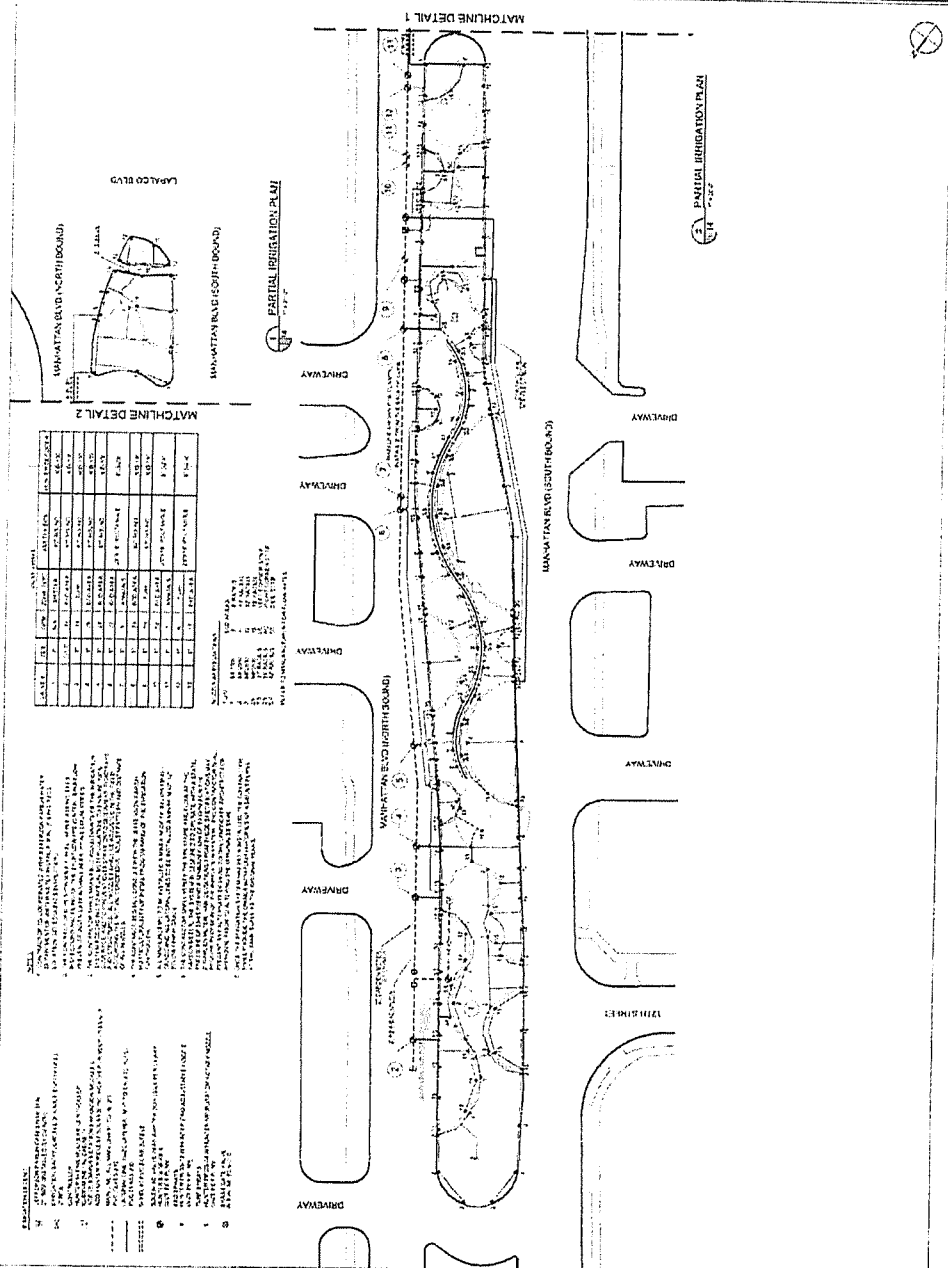

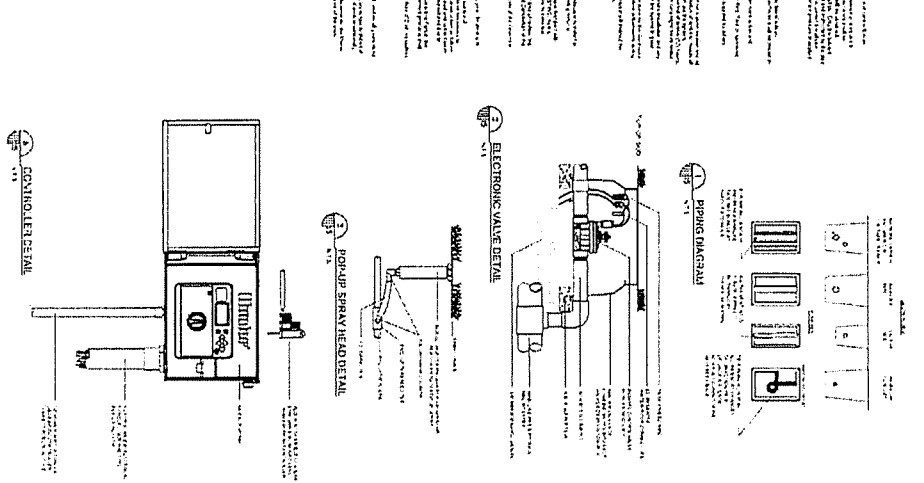
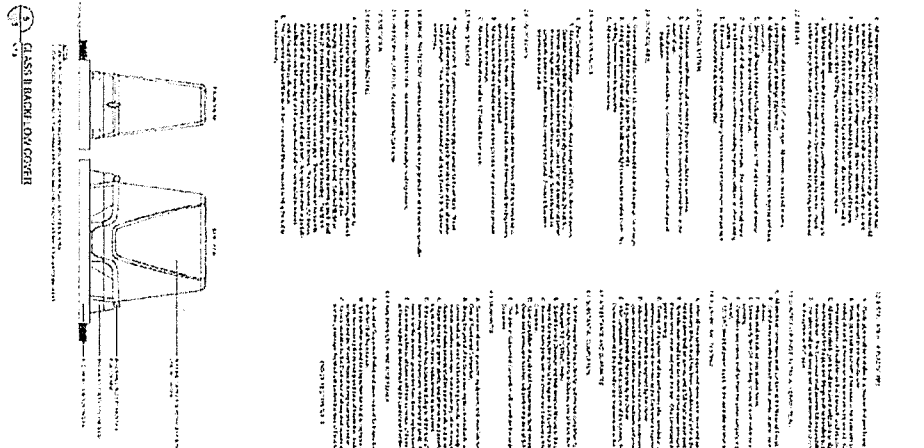
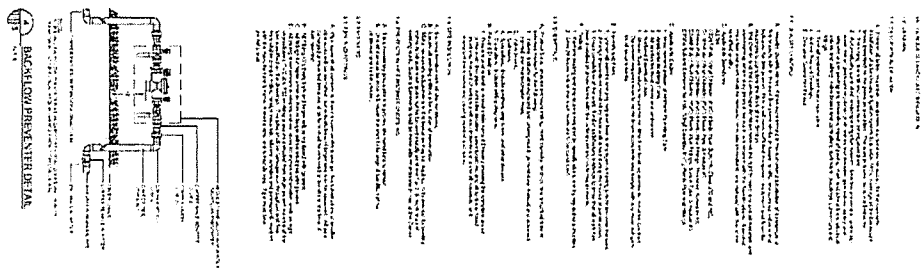

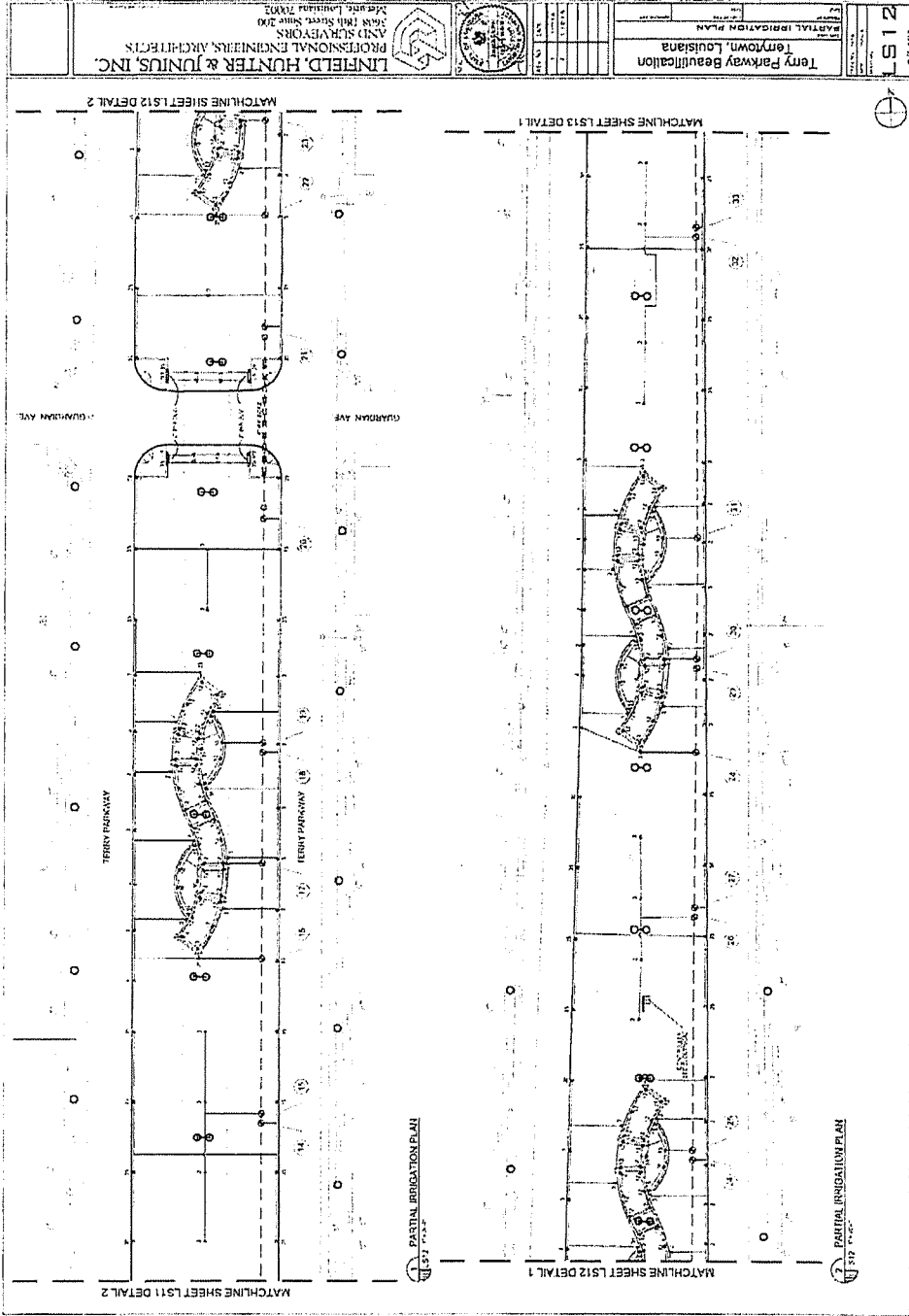

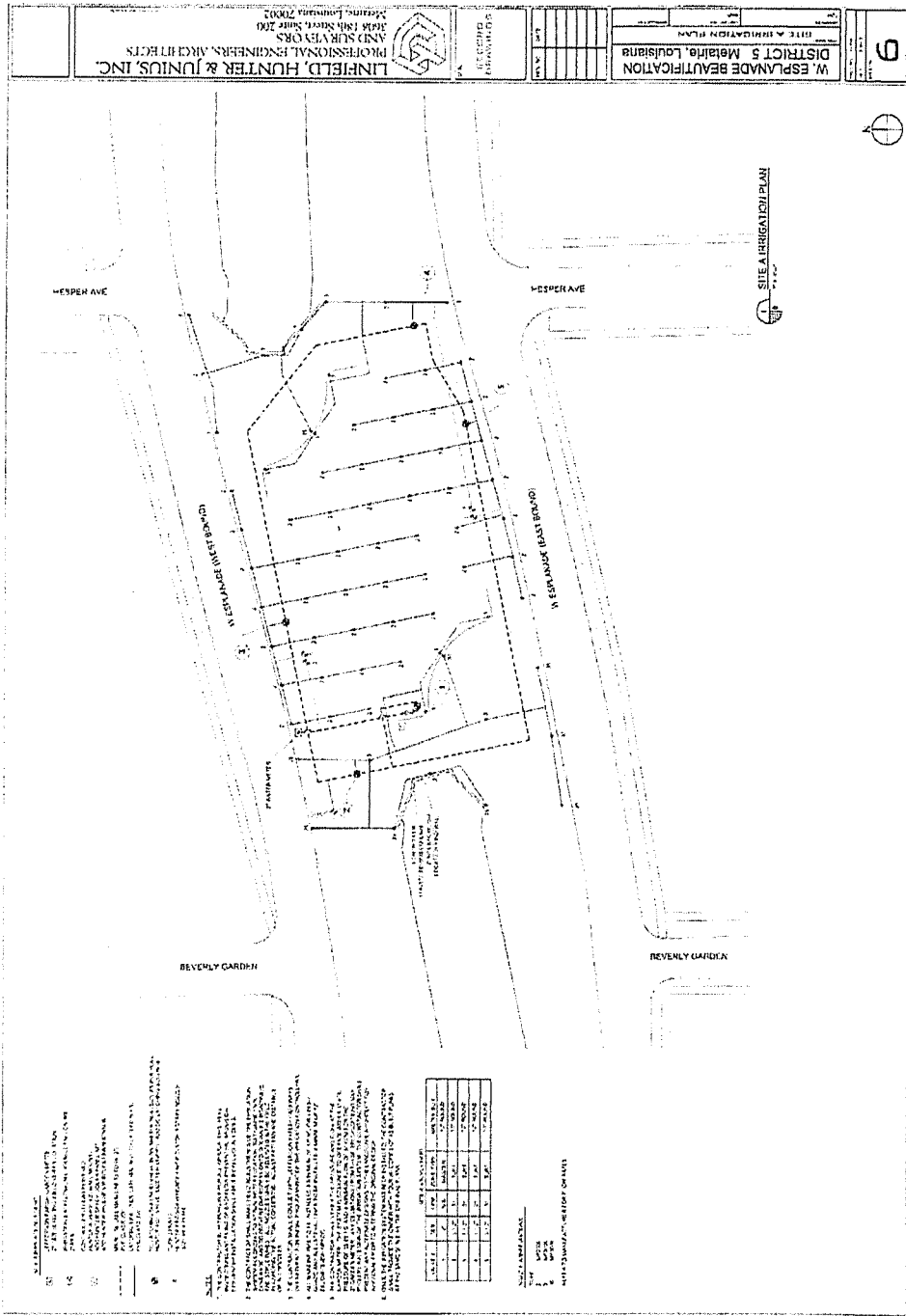

1. THE IRRIGATION SYSTEM SHALL BE DESIGNED TO PROVIDE ADEQUATE WATER TO ALL PLANTS AND TREES IN THE PROJECT AREA.

2. THE IRRIGATION SYSTEM SHALL BE DESIGNED TO PROVIDE ADEQUATE WATER TO ALL PLANTS AND TREES IN THE PROJECT AREA.

3. THE IRRIGATION SYSTEM SHALL BE DESIGNED TO PROVIDE ADEQUATE WATER TO ALL PLANTS AND TREES IN THE PROJECT AREA.

4. THE IRRIGATION SYSTEM SHALL BE DESIGNED TO PROVIDE ADEQUATE WATER TO ALL PLANTS AND TREES IN THE PROJECT AREA.

5. THE IRRIGATION SYSTEM SHALL BE DESIGNED TO PROVIDE ADEQUATE WATER TO ALL PLANTS AND TREES IN THE PROJECT AREA.

6. THE IRRIGATION SYSTEM SHALL BE DESIGNED TO PROVIDE ADEQUATE WATER TO ALL PLANTS AND TREES IN THE PROJECT AREA.

7. THE IRRIGATION SYSTEM SHALL BE DESIGNED TO PROVIDE ADEQUATE WATER TO ALL PLANTS AND TREES IN THE PROJECT AREA.

8. THE IRRIGATION SYSTEM SHALL BE DESIGNED TO PROVIDE ADEQUATE WATER TO ALL PLANTS AND TREES IN THE PROJECT AREA.

9. THE IRRIGATION SYSTEM SHALL BE DESIGNED TO PROVIDE ADEQUATE WATER TO ALL PLANTS AND TREES IN THE PROJECT AREA.

10. THE IRRIGATION SYSTEM SHALL BE DESIGNED TO PROVIDE ADEQUATE WATER TO ALL PLANTS AND TREES IN THE PROJECT AREA.

NO.	DESCRIPTION	AMOUNT
1	1/2" POLYETHYLENE GLASS REINFORCED PIPE	1000.00
2	1/2" POLYETHYLENE GLASS REINFORCED PIPE	1000.00
3	1/2" POLYETHYLENE GLASS REINFORCED PIPE	1000.00
4	1/2" POLYETHYLENE GLASS REINFORCED PIPE	1000.00
5	1/2" POLYETHYLENE GLASS REINFORCED PIPE	1000.00
6	1/2" POLYETHYLENE GLASS REINFORCED PIPE	1000.00
7	1/2" POLYETHYLENE GLASS REINFORCED PIPE	1000.00
8	1/2" POLYETHYLENE GLASS REINFORCED PIPE	1000.00
9	1/2" POLYETHYLENE GLASS REINFORCED PIPE	1000.00
10	1/2" POLYETHYLENE GLASS REINFORCED PIPE	1000.00

NOTES: 1. SEE SPECIFICATIONS FOR MATERIALS AND METHODS OF CONSTRUCTION.

2. SEE SPECIFICATIONS FOR MATERIALS AND METHODS OF CONSTRUCTION.

3. SEE SPECIFICATIONS FOR MATERIALS AND METHODS OF CONSTRUCTION.

4. SEE SPECIFICATIONS FOR MATERIALS AND METHODS OF CONSTRUCTION.

5. SEE SPECIFICATIONS FOR MATERIALS AND METHODS OF CONSTRUCTION.

6. SEE SPECIFICATIONS FOR MATERIALS AND METHODS OF CONSTRUCTION.

7. SEE SPECIFICATIONS FOR MATERIALS AND METHODS OF CONSTRUCTION.

8. SEE SPECIFICATIONS FOR MATERIALS AND METHODS OF CONSTRUCTION.

9. SEE SPECIFICATIONS FOR MATERIALS AND METHODS OF CONSTRUCTION.

10. SEE SPECIFICATIONS FOR MATERIALS AND METHODS OF CONSTRUCTION.

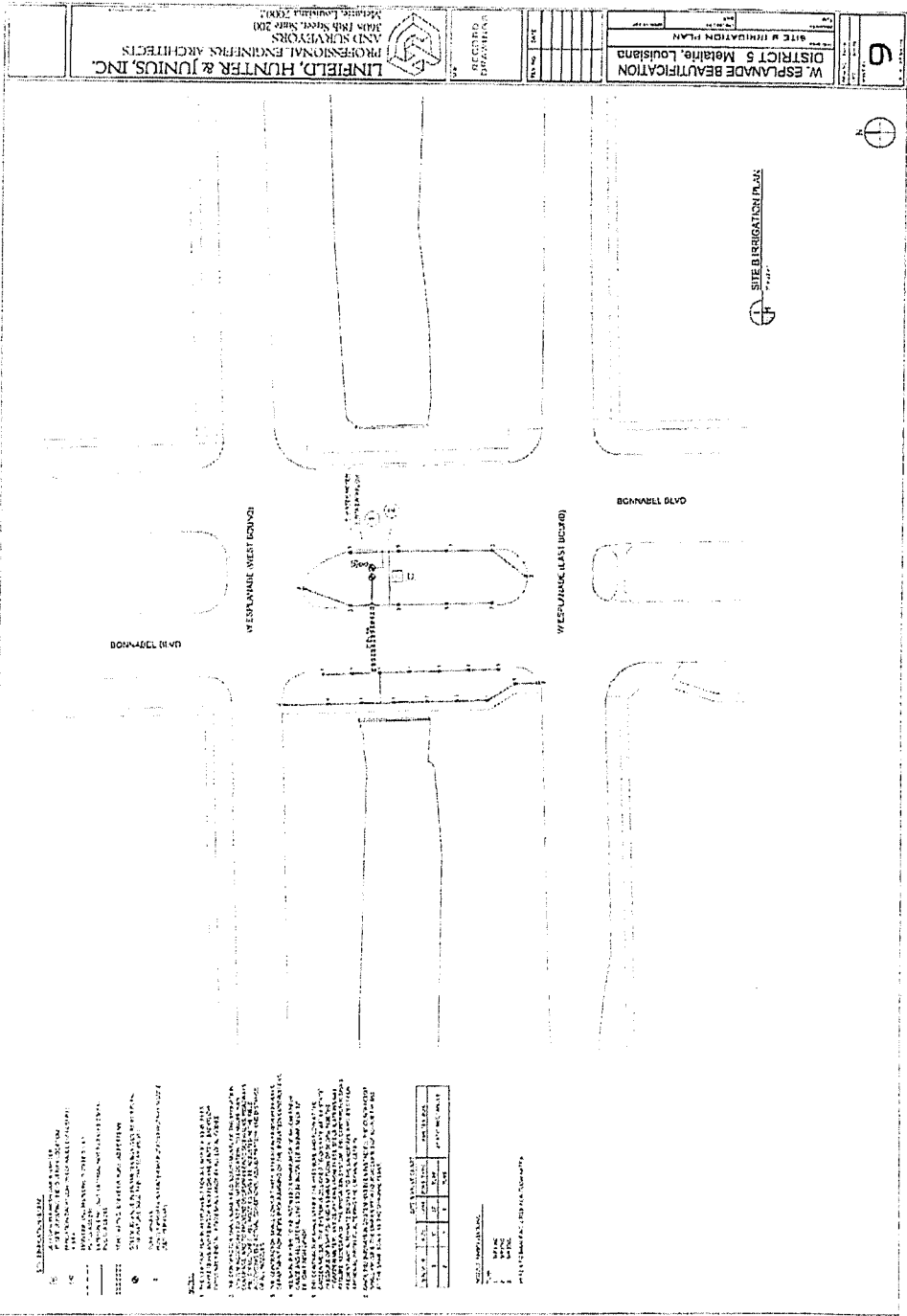

W. ESPLANADE BEAUTIFICATION
DISTRICT 5 Metairie, Louisiana
 SITE & IRRIGATION PLAN
 DATE: 10/15/2011
 DRAWN BY: [Name]
 CHECKED BY: [Name]
 PROJECT NO.: [Number]
 SHEET NO.: [Number] OF [Total]

LINEFIELD, HUNTER & JUNG, INC.
 PROFESSIONAL ENGINEERS & ARCHITECTS
 1000 PINE STREET, SUITE 200
 METairie, Louisiana 70002
 PHONE: (504) 885-1111
 FAX: (504) 885-1112
 WWW.LHJINC.COM

- NOTES:**
1. ALL PLANTINGS SHALL BE INSTALLED IN ACCORDANCE WITH THE LATEST EDITIONS OF THE MISSISSIPPI BOTANICAL GARDEN PLANTING GUIDE.
 2. ALL PLANTINGS SHALL BE INSTALLED IN ACCORDANCE WITH THE LATEST EDITIONS OF THE MISSISSIPPI BOTANICAL GARDEN PLANTING GUIDE.
 3. ALL PLANTINGS SHALL BE INSTALLED IN ACCORDANCE WITH THE LATEST EDITIONS OF THE MISSISSIPPI BOTANICAL GARDEN PLANTING GUIDE.
 4. ALL PLANTINGS SHALL BE INSTALLED IN ACCORDANCE WITH THE LATEST EDITIONS OF THE MISSISSIPPI BOTANICAL GARDEN PLANTING GUIDE.
 5. ALL PLANTINGS SHALL BE INSTALLED IN ACCORDANCE WITH THE LATEST EDITIONS OF THE MISSISSIPPI BOTANICAL GARDEN PLANTING GUIDE.
 6. ALL PLANTINGS SHALL BE INSTALLED IN ACCORDANCE WITH THE LATEST EDITIONS OF THE MISSISSIPPI BOTANICAL GARDEN PLANTING GUIDE.
 7. ALL PLANTINGS SHALL BE INSTALLED IN ACCORDANCE WITH THE LATEST EDITIONS OF THE MISSISSIPPI BOTANICAL GARDEN PLANTING GUIDE.
 8. ALL PLANTINGS SHALL BE INSTALLED IN ACCORDANCE WITH THE LATEST EDITIONS OF THE MISSISSIPPI BOTANICAL GARDEN PLANTING GUIDE.
 9. ALL PLANTINGS SHALL BE INSTALLED IN ACCORDANCE WITH THE LATEST EDITIONS OF THE MISSISSIPPI BOTANICAL GARDEN PLANTING GUIDE.
 10. ALL PLANTINGS SHALL BE INSTALLED IN ACCORDANCE WITH THE LATEST EDITIONS OF THE MISSISSIPPI BOTANICAL GARDEN PLANTING GUIDE.

DATE	BY	DESCRIPTION
10/15/2011	[Name]	Initial Design
10/15/2011	[Name]	Final Design

SCALE: 1" = 40'
 NORTH ARROW: [Symbol]
 PROJECT NO.: [Number]
 SHEET NO.: [Number] OF [Total]

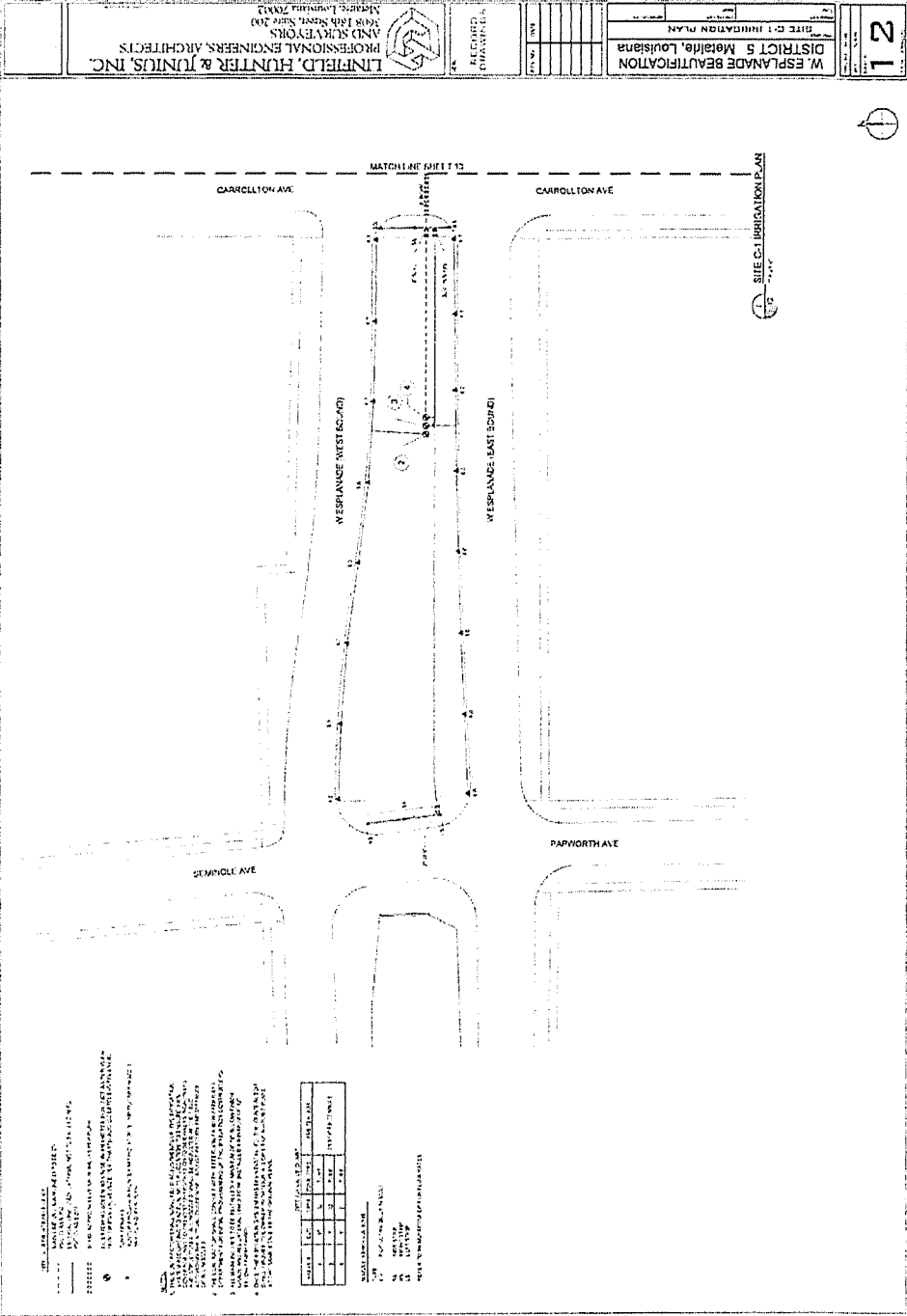

12

W. ESPLANADE BEAUTIFICATION
DISTRICT 5 Metairie, Louisiana

SITE C-1 IRRIGATION PLAN

RECORD
DATE: 10/1/00
BY: [Signature]

21

W. ESPLANADE BEAUTIFICATION
DISTRICT 5 Metairie, Louisiana

SITE C-1 IRRIGATION PLAN

RECORD
DATE: 10/1/00
BY: [Signature]

NOTES:

1. SEE SHEET 12 FOR MATCH LINE.
2. SEE SHEET 12 FOR MATCH LINE.
3. SEE SHEET 12 FOR MATCH LINE.
4. SEE SHEET 12 FOR MATCH LINE.
5. SEE SHEET 12 FOR MATCH LINE.
6. SEE SHEET 12 FOR MATCH LINE.
7. SEE SHEET 12 FOR MATCH LINE.
8. SEE SHEET 12 FOR MATCH LINE.
9. SEE SHEET 12 FOR MATCH LINE.
10. SEE SHEET 12 FOR MATCH LINE.
11. SEE SHEET 12 FOR MATCH LINE.
12. SEE SHEET 12 FOR MATCH LINE.
13. SEE SHEET 12 FOR MATCH LINE.
14. SEE SHEET 12 FOR MATCH LINE.
15. SEE SHEET 12 FOR MATCH LINE.
16. SEE SHEET 12 FOR MATCH LINE.
17. SEE SHEET 12 FOR MATCH LINE.
18. SEE SHEET 12 FOR MATCH LINE.
19. SEE SHEET 12 FOR MATCH LINE.
20. SEE SHEET 12 FOR MATCH LINE.
21. SEE SHEET 12 FOR MATCH LINE.
22. SEE SHEET 12 FOR MATCH LINE.
23. SEE SHEET 12 FOR MATCH LINE.
24. SEE SHEET 12 FOR MATCH LINE.
25. SEE SHEET 12 FOR MATCH LINE.
26. SEE SHEET 12 FOR MATCH LINE.
27. SEE SHEET 12 FOR MATCH LINE.
28. SEE SHEET 12 FOR MATCH LINE.
29. SEE SHEET 12 FOR MATCH LINE.
30. SEE SHEET 12 FOR MATCH LINE.
31. SEE SHEET 12 FOR MATCH LINE.
32. SEE SHEET 12 FOR MATCH LINE.
33. SEE SHEET 12 FOR MATCH LINE.
34. SEE SHEET 12 FOR MATCH LINE.
35. SEE SHEET 12 FOR MATCH LINE.
36. SEE SHEET 12 FOR MATCH LINE.
37. SEE SHEET 12 FOR MATCH LINE.
38. SEE SHEET 12 FOR MATCH LINE.
39. SEE SHEET 12 FOR MATCH LINE.
40. SEE SHEET 12 FOR MATCH LINE.
41. SEE SHEET 12 FOR MATCH LINE.
42. SEE SHEET 12 FOR MATCH LINE.
43. SEE SHEET 12 FOR MATCH LINE.
44. SEE SHEET 12 FOR MATCH LINE.
45. SEE SHEET 12 FOR MATCH LINE.
46. SEE SHEET 12 FOR MATCH LINE.
47. SEE SHEET 12 FOR MATCH LINE.
48. SEE SHEET 12 FOR MATCH LINE.
49. SEE SHEET 12 FOR MATCH LINE.
50. SEE SHEET 12 FOR MATCH LINE.
51. SEE SHEET 12 FOR MATCH LINE.
52. SEE SHEET 12 FOR MATCH LINE.
53. SEE SHEET 12 FOR MATCH LINE.
54. SEE SHEET 12 FOR MATCH LINE.
55. SEE SHEET 12 FOR MATCH LINE.
56. SEE SHEET 12 FOR MATCH LINE.
57. SEE SHEET 12 FOR MATCH LINE.
58. SEE SHEET 12 FOR MATCH LINE.
59. SEE SHEET 12 FOR MATCH LINE.
60. SEE SHEET 12 FOR MATCH LINE.
61. SEE SHEET 12 FOR MATCH LINE.
62. SEE SHEET 12 FOR MATCH LINE.
63. SEE SHEET 12 FOR MATCH LINE.
64. SEE SHEET 12 FOR MATCH LINE.
65. SEE SHEET 12 FOR MATCH LINE.
66. SEE SHEET 12 FOR MATCH LINE.
67. SEE SHEET 12 FOR MATCH LINE.
68. SEE SHEET 12 FOR MATCH LINE.
69. SEE SHEET 12 FOR MATCH LINE.
70. SEE SHEET 12 FOR MATCH LINE.
71. SEE SHEET 12 FOR MATCH LINE.
72. SEE SHEET 12 FOR MATCH LINE.
73. SEE SHEET 12 FOR MATCH LINE.
74. SEE SHEET 12 FOR MATCH LINE.
75. SEE SHEET 12 FOR MATCH LINE.
76. SEE SHEET 12 FOR MATCH LINE.
77. SEE SHEET 12 FOR MATCH LINE.
78. SEE SHEET 12 FOR MATCH LINE.
79. SEE SHEET 12 FOR MATCH LINE.
80. SEE SHEET 12 FOR MATCH LINE.
81. SEE SHEET 12 FOR MATCH LINE.
82. SEE SHEET 12 FOR MATCH LINE.
83. SEE SHEET 12 FOR MATCH LINE.
84. SEE SHEET 12 FOR MATCH LINE.
85. SEE SHEET 12 FOR MATCH LINE.
86. SEE SHEET 12 FOR MATCH LINE.
87. SEE SHEET 12 FOR MATCH LINE.
88. SEE SHEET 12 FOR MATCH LINE.
89. SEE SHEET 12 FOR MATCH LINE.
90. SEE SHEET 12 FOR MATCH LINE.
91. SEE SHEET 12 FOR MATCH LINE.
92. SEE SHEET 12 FOR MATCH LINE.
93. SEE SHEET 12 FOR MATCH LINE.
94. SEE SHEET 12 FOR MATCH LINE.
95. SEE SHEET 12 FOR MATCH LINE.
96. SEE SHEET 12 FOR MATCH LINE.
97. SEE SHEET 12 FOR MATCH LINE.
98. SEE SHEET 12 FOR MATCH LINE.
99. SEE SHEET 12 FOR MATCH LINE.
100. SEE SHEET 12 FOR MATCH LINE.

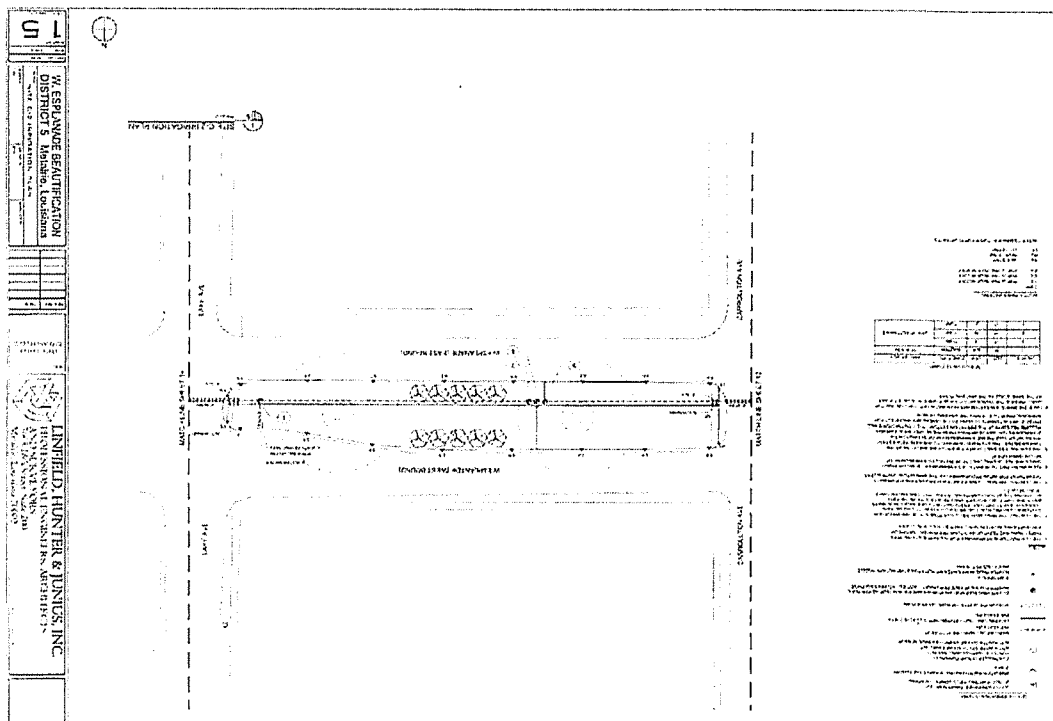

21

W. ESPLADE BEAUTIFICATION
DISTRICT 5 Metairie, Louisiana
SITE OF IRRIGATION

RECEIVED
STANDARD
DATE

LINEFIELD, HUNTER & JUNIUS, INC.
PROFESSIONAL ENGINEERS, ARCHITECTS
1008 P&H BUILDING
Metairie, Louisiana 70002

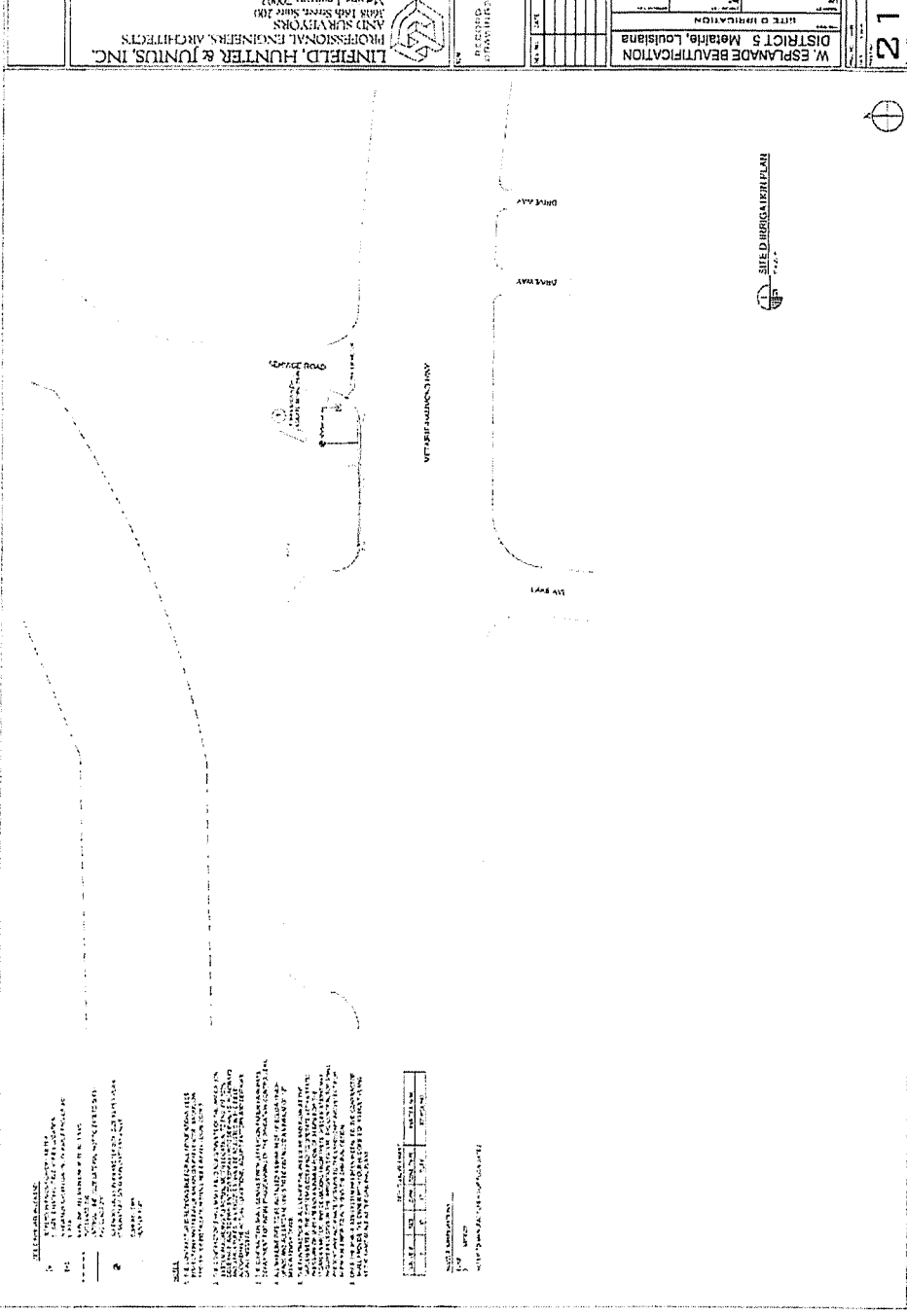

LEGEND

SYMBOL	DESCRIPTION
(Symbol)	EXISTING IRRIGATION
(Symbol)	PROPOSED IRRIGATION
(Symbol)	PROPERTY LINE
(Symbol)	LAKE
(Symbol)	DRIVE WAY
(Symbol)	OFFICE ROAD

NOTES:
1. ALL IRRIGATION SHALL BE INSTALLED IN ACCORDANCE WITH THE LATEST EDITION OF THE IRRIGATION HANDBOOK, 1970, PUBLISHED BY THE IRRIGATION ENGINEERS' SOCIETY OF AMERICA.
2. THE IRRIGATION SYSTEM SHALL BE DESIGNED TO FURNISH ADEQUATE WATER TO ALL AREAS SERVED.
3. THE IRRIGATION SYSTEM SHALL BE DESIGNED TO FURNISH ADEQUATE WATER TO ALL AREAS SERVED.
4. THE IRRIGATION SYSTEM SHALL BE DESIGNED TO FURNISH ADEQUATE WATER TO ALL AREAS SERVED.
5. THE IRRIGATION SYSTEM SHALL BE DESIGNED TO FURNISH ADEQUATE WATER TO ALL AREAS SERVED.



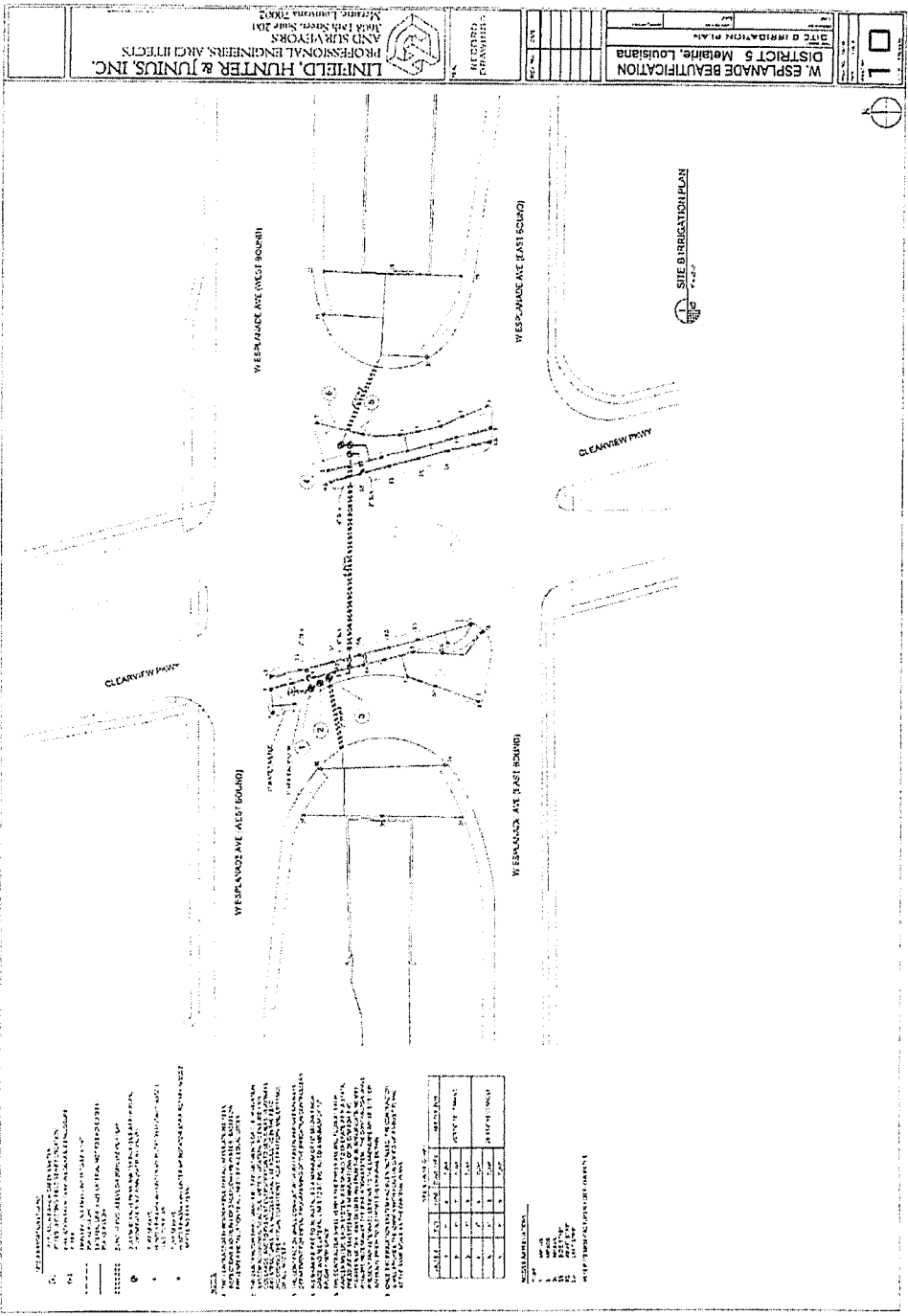

1. ALL PLANTINGS TO BE INSTALLED BY THE CONTRACTOR.
 2. PLANTINGS TO BE INSTALLED IN ACCORDANCE WITH THE FOLLOWING SPECIFICATIONS:
 3. PLANTINGS TO BE INSTALLED IN ACCORDANCE WITH THE FOLLOWING SPECIFICATIONS:
 4. PLANTINGS TO BE INSTALLED IN ACCORDANCE WITH THE FOLLOWING SPECIFICATIONS:
 5. PLANTINGS TO BE INSTALLED IN ACCORDANCE WITH THE FOLLOWING SPECIFICATIONS:
 6. PLANTINGS TO BE INSTALLED IN ACCORDANCE WITH THE FOLLOWING SPECIFICATIONS:
 7. PLANTINGS TO BE INSTALLED IN ACCORDANCE WITH THE FOLLOWING SPECIFICATIONS:
 8. PLANTINGS TO BE INSTALLED IN ACCORDANCE WITH THE FOLLOWING SPECIFICATIONS:
 9. PLANTINGS TO BE INSTALLED IN ACCORDANCE WITH THE FOLLOWING SPECIFICATIONS:
 10. PLANTINGS TO BE INSTALLED IN ACCORDANCE WITH THE FOLLOWING SPECIFICATIONS:
 11. PLANTINGS TO BE INSTALLED IN ACCORDANCE WITH THE FOLLOWING SPECIFICATIONS:
 12. PLANTINGS TO BE INSTALLED IN ACCORDANCE WITH THE FOLLOWING SPECIFICATIONS:
 13. PLANTINGS TO BE INSTALLED IN ACCORDANCE WITH THE FOLLOWING SPECIFICATIONS:
 14. PLANTINGS TO BE INSTALLED IN ACCORDANCE WITH THE FOLLOWING SPECIFICATIONS:
 15. PLANTINGS TO BE INSTALLED IN ACCORDANCE WITH THE FOLLOWING SPECIFICATIONS:

1. ALL PLANTINGS TO BE INSTALLED BY THE CONTRACTOR.
 2. PLANTINGS TO BE INSTALLED IN ACCORDANCE WITH THE FOLLOWING SPECIFICATIONS:
 3. PLANTINGS TO BE INSTALLED IN ACCORDANCE WITH THE FOLLOWING SPECIFICATIONS:
 4. PLANTINGS TO BE INSTALLED IN ACCORDANCE WITH THE FOLLOWING SPECIFICATIONS:
 5. PLANTINGS TO BE INSTALLED IN ACCORDANCE WITH THE FOLLOWING SPECIFICATIONS:
 6. PLANTINGS TO BE INSTALLED IN ACCORDANCE WITH THE FOLLOWING SPECIFICATIONS:
 7. PLANTINGS TO BE INSTALLED IN ACCORDANCE WITH THE FOLLOWING SPECIFICATIONS:
 8. PLANTINGS TO BE INSTALLED IN ACCORDANCE WITH THE FOLLOWING SPECIFICATIONS:
 9. PLANTINGS TO BE INSTALLED IN ACCORDANCE WITH THE FOLLOWING SPECIFICATIONS:
 10. PLANTINGS TO BE INSTALLED IN ACCORDANCE WITH THE FOLLOWING SPECIFICATIONS:
 11. PLANTINGS TO BE INSTALLED IN ACCORDANCE WITH THE FOLLOWING SPECIFICATIONS:
 12. PLANTINGS TO BE INSTALLED IN ACCORDANCE WITH THE FOLLOWING SPECIFICATIONS:
 13. PLANTINGS TO BE INSTALLED IN ACCORDANCE WITH THE FOLLOWING SPECIFICATIONS:
 14. PLANTINGS TO BE INSTALLED IN ACCORDANCE WITH THE FOLLOWING SPECIFICATIONS:
 15. PLANTINGS TO BE INSTALLED IN ACCORDANCE WITH THE FOLLOWING SPECIFICATIONS:

NO.	PLANTING	QUANTITY	UNIT	PRICE	TOTAL
1	PLANTING	1	EA	1.00	1.00
2	PLANTING	1	EA	1.00	1.00
3	PLANTING	1	EA	1.00	1.00
4	PLANTING	1	EA	1.00	1.00
5	PLANTING	1	EA	1.00	1.00
6	PLANTING	1	EA	1.00	1.00
7	PLANTING	1	EA	1.00	1.00
8	PLANTING	1	EA	1.00	1.00
9	PLANTING	1	EA	1.00	1.00
10	PLANTING	1	EA	1.00	1.00
11	PLANTING	1	EA	1.00	1.00
12	PLANTING	1	EA	1.00	1.00
13	PLANTING	1	EA	1.00	1.00
14	PLANTING	1	EA	1.00	1.00
15	PLANTING	1	EA	1.00	1.00

1. ALL PLANTINGS TO BE INSTALLED BY THE CONTRACTOR.
 2. PLANTINGS TO BE INSTALLED IN ACCORDANCE WITH THE FOLLOWING SPECIFICATIONS:
 3. PLANTINGS TO BE INSTALLED IN ACCORDANCE WITH THE FOLLOWING SPECIFICATIONS:
 4. PLANTINGS TO BE INSTALLED IN ACCORDANCE WITH THE FOLLOWING SPECIFICATIONS:
 5. PLANTINGS TO BE INSTALLED IN ACCORDANCE WITH THE FOLLOWING SPECIFICATIONS:
 6. PLANTINGS TO BE INSTALLED IN ACCORDANCE WITH THE FOLLOWING SPECIFICATIONS:
 7. PLANTINGS TO BE INSTALLED IN ACCORDANCE WITH THE FOLLOWING SPECIFICATIONS:
 8. PLANTINGS TO BE INSTALLED IN ACCORDANCE WITH THE FOLLOWING SPECIFICATIONS:
 9. PLANTINGS TO BE INSTALLED IN ACCORDANCE WITH THE FOLLOWING SPECIFICATIONS:
 10. PLANTINGS TO BE INSTALLED IN ACCORDANCE WITH THE FOLLOWING SPECIFICATIONS:
 11. PLANTINGS TO BE INSTALLED IN ACCORDANCE WITH THE FOLLOWING SPECIFICATIONS:
 12. PLANTINGS TO BE INSTALLED IN ACCORDANCE WITH THE FOLLOWING SPECIFICATIONS:
 13. PLANTINGS TO BE INSTALLED IN ACCORDANCE WITH THE FOLLOWING SPECIFICATIONS:
 14. PLANTINGS TO BE INSTALLED IN ACCORDANCE WITH THE FOLLOWING SPECIFICATIONS:
 15. PLANTINGS TO BE INSTALLED IN ACCORDANCE WITH THE FOLLOWING SPECIFICATIONS:

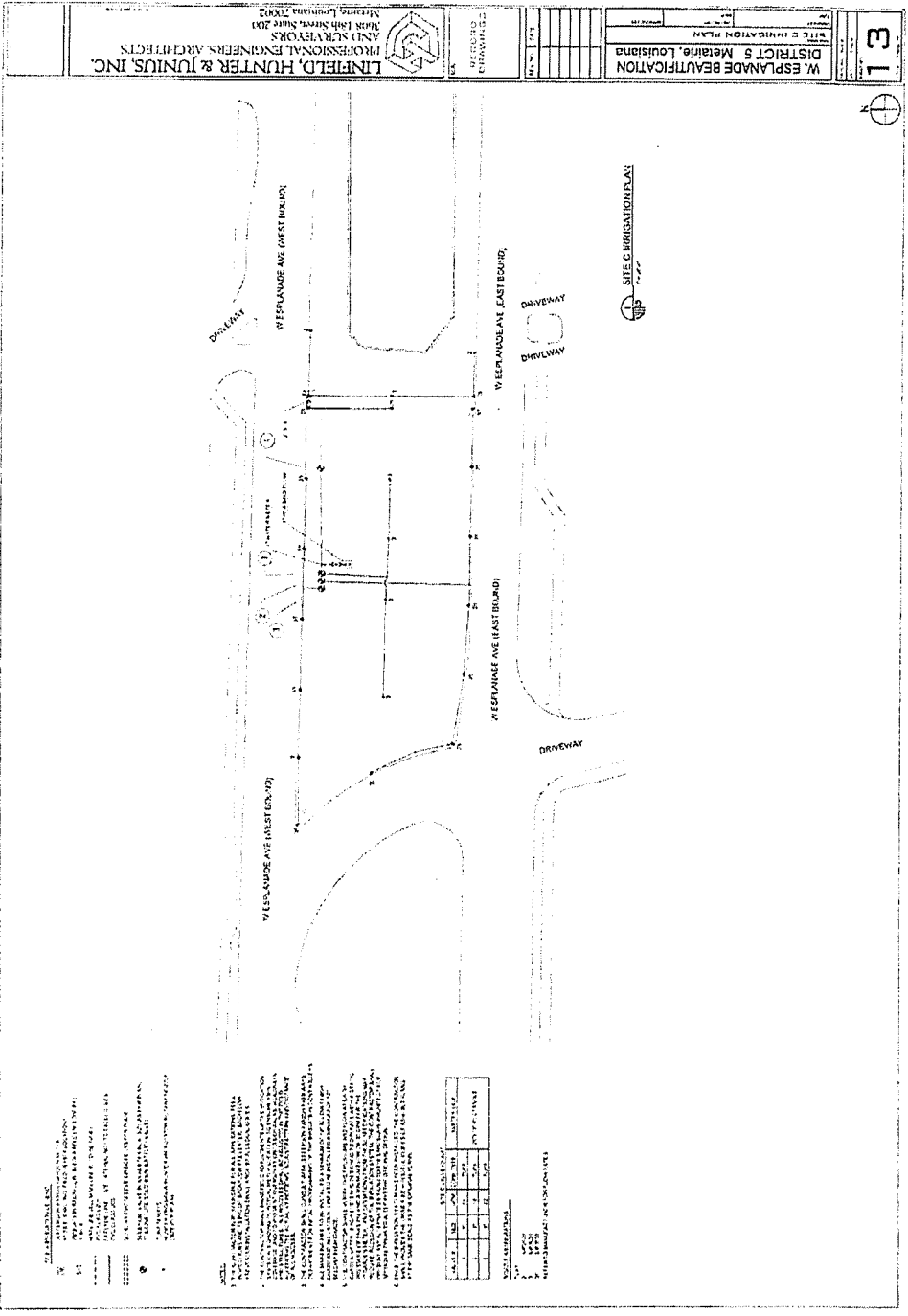

1. ALL IRRIGATION SYSTEMS SHALL BE DESIGNED TO IRRIGATE THE ENTIRE AREA OF THE SITE. THE IRRIGATION SYSTEM SHALL BE DESIGNED TO IRRIGATE THE ENTIRE AREA OF THE SITE. THE IRRIGATION SYSTEM SHALL BE DESIGNED TO IRRIGATE THE ENTIRE AREA OF THE SITE.

2. THE IRRIGATION SYSTEM SHALL BE DESIGNED TO IRRIGATE THE ENTIRE AREA OF THE SITE. THE IRRIGATION SYSTEM SHALL BE DESIGNED TO IRRIGATE THE ENTIRE AREA OF THE SITE. THE IRRIGATION SYSTEM SHALL BE DESIGNED TO IRRIGATE THE ENTIRE AREA OF THE SITE.

SITE DATA		SITE DATA	
AREA	1.00	PERCENT	100.00
PERCENT	100.00	PERCENT	100.00
PERCENT	100.00	PERCENT	100.00
PERCENT	100.00	PERCENT	100.00

SITE C IRRIGATION PLAN

W. ESPLANADE BEAUVILLAIN
 DISTRICT 5 Metairie, Louisiana
 SITE C IRRIGATION PLAN

LINFIELD, HUNTER & JUNIUS, INC.
 PROFESSIONAL ENGINEERS AND ARCHITECTS
 1001 Poydras Street, Suite 2000
 New Orleans, Louisiana 70112

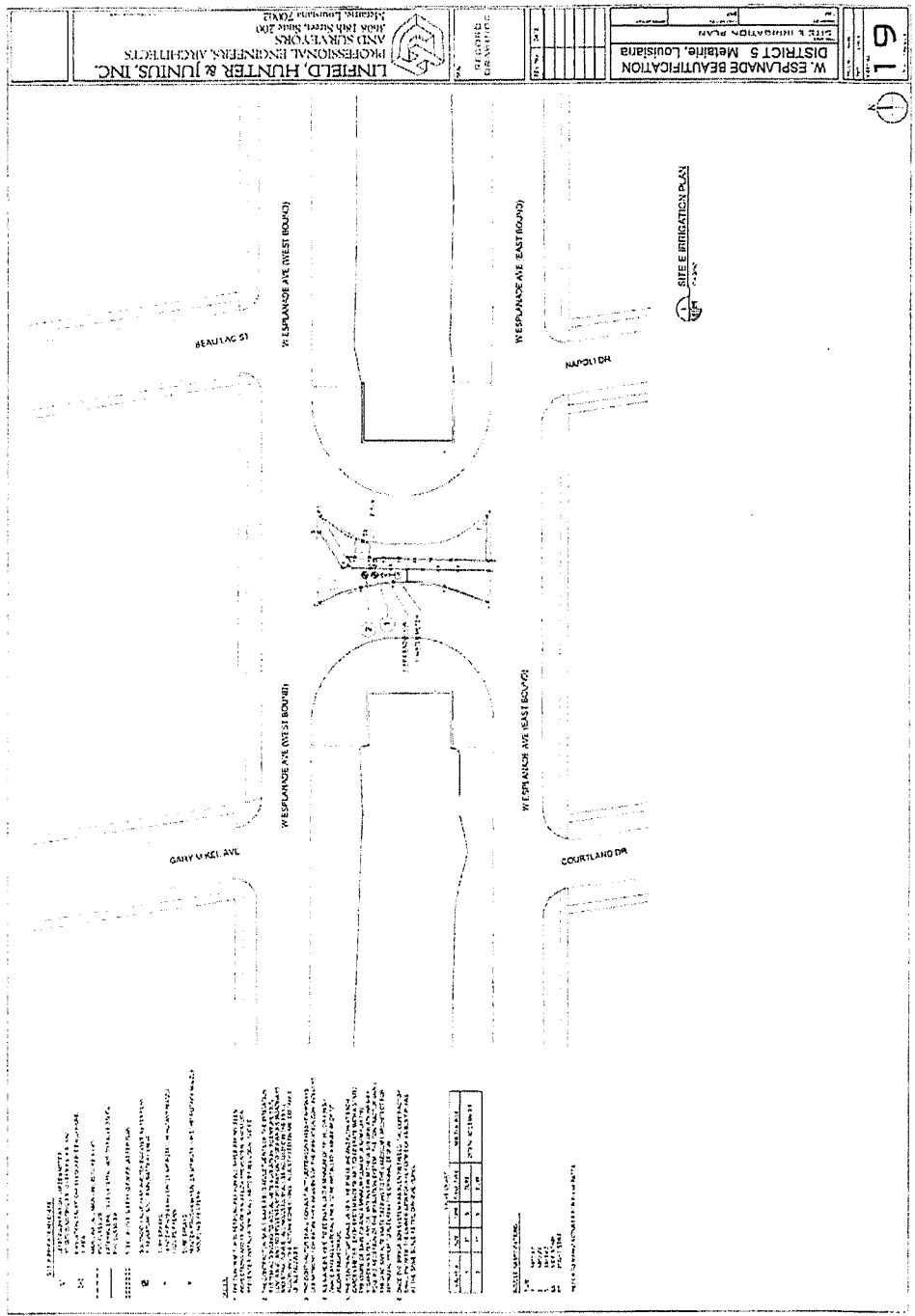

W. ESPLANADE BEAUTIFICATION
DISTRICT 5, Metairie, Louisiana

SITE IRRIGATION PLAN

DATE: 10/1/01
BY: [Signature]

61

PROJECT NO. 101-01-01
SHEET NO. 101-01-01-01

UNFIELD, HUNTER & JUNIUS, INC.
PROFESSIONAL ENGINEERS, ARCHITECTS
1000 14th Street, Suite 200
Metairie, Louisiana 70001

REVISIONS

NO.	DESCRIPTION	DATE
1	ISSUED FOR PERMIT	10/1/01

NOTES:

1. SEE GENERAL NOTES TO SPECIFICATIONS FOR IRRIGATION.
2. THE IRRIGATION SYSTEM SHALL BE DESIGNED AND CONSTRUCTED TO MAINTAIN THE GRASS AND PLANTINGS IN THE BEST OF HEALTH AND TO PREVENT ANY DRAINAGE PROBLEMS.
3. THE IRRIGATION SYSTEM SHALL BE DESIGNED AND CONSTRUCTED TO MAINTAIN THE GRASS AND PLANTINGS IN THE BEST OF HEALTH AND TO PREVENT ANY DRAINAGE PROBLEMS.
4. THE IRRIGATION SYSTEM SHALL BE DESIGNED AND CONSTRUCTED TO MAINTAIN THE GRASS AND PLANTINGS IN THE BEST OF HEALTH AND TO PREVENT ANY DRAINAGE PROBLEMS.
5. THE IRRIGATION SYSTEM SHALL BE DESIGNED AND CONSTRUCTED TO MAINTAIN THE GRASS AND PLANTINGS IN THE BEST OF HEALTH AND TO PREVENT ANY DRAINAGE PROBLEMS.
6. THE IRRIGATION SYSTEM SHALL BE DESIGNED AND CONSTRUCTED TO MAINTAIN THE GRASS AND PLANTINGS IN THE BEST OF HEALTH AND TO PREVENT ANY DRAINAGE PROBLEMS.
7. THE IRRIGATION SYSTEM SHALL BE DESIGNED AND CONSTRUCTED TO MAINTAIN THE GRASS AND PLANTINGS IN THE BEST OF HEALTH AND TO PREVENT ANY DRAINAGE PROBLEMS.
8. THE IRRIGATION SYSTEM SHALL BE DESIGNED AND CONSTRUCTED TO MAINTAIN THE GRASS AND PLANTINGS IN THE BEST OF HEALTH AND TO PREVENT ANY DRAINAGE PROBLEMS.
9. THE IRRIGATION SYSTEM SHALL BE DESIGNED AND CONSTRUCTED TO MAINTAIN THE GRASS AND PLANTINGS IN THE BEST OF HEALTH AND TO PREVENT ANY DRAINAGE PROBLEMS.
10. THE IRRIGATION SYSTEM SHALL BE DESIGNED AND CONSTRUCTED TO MAINTAIN THE GRASS AND PLANTINGS IN THE BEST OF HEALTH AND TO PREVENT ANY DRAINAGE PROBLEMS.

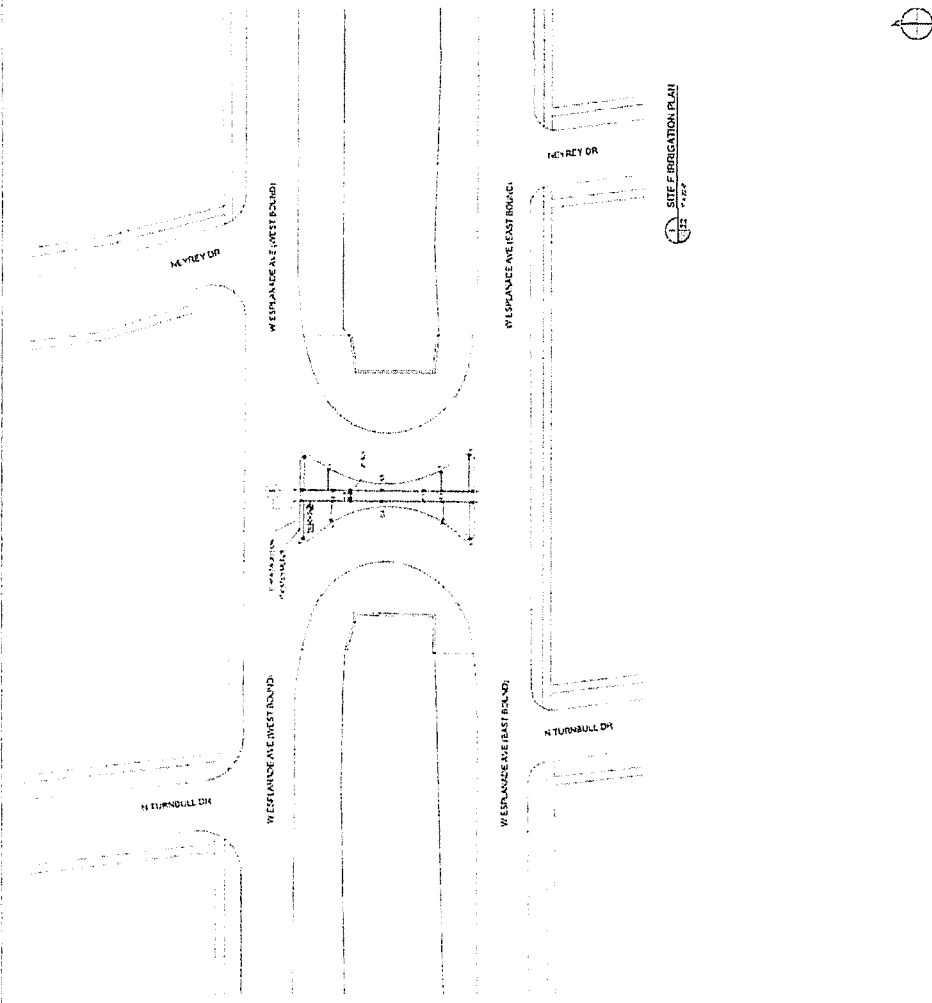

DATE	TIME	BY	NO.	TYPE
1944-11-11	10:00	W. H. H.	1	1000
1944-11-11	10:00	W. H. H.	2	1000
1944-11-11	10:00	W. H. H.	3	1000
1944-11-11	10:00	W. H. H.	4	1000
1944-11-11	10:00	W. H. H.	5	1000
1944-11-11	10:00	W. H. H.	6	1000
1944-11-11	10:00	W. H. H.	7	1000
1944-11-11	10:00	W. H. H.	8	1000
1944-11-11	10:00	W. H. H.	9	1000
1944-11-11	10:00	W. H. H.	10	1000
1944-11-11	10:00	W. H. H.	11	1000
1944-11-11	10:00	W. H. H.	12	1000
1944-11-11	10:00	W. H. H.	13	1000
1944-11-11	10:00	W. H. H.	14	1000
1944-11-11	10:00	W. H. H.	15	1000
1944-11-11	10:00	W. H. H.	16	1000
1944-11-11	10:00	W. H. H.	17	1000
1944-11-11	10:00	W. H. H.	18	1000
1944-11-11	10:00	W. H. H.	19	1000
1944-11-11	10:00	W. H. H.	20	1000
1944-11-11	10:00	W. H. H.	21	1000
1944-11-11	10:00	W. H. H.	22	1000
1944-11-11	10:00	W. H. H.	23	1000
1944-11-11	10:00	W. H. H.	24	1000
1944-11-11	10:00	W. H. H.	25	1000
1944-11-11	10:00	W. H. H.	26	1000
1944-11-11	10:00	W. H. H.	27	1000
1944-11-11	10:00	W. H. H.	28	1000
1944-11-11	10:00	W. H. H.	29	1000
1944-11-11	10:00	W. H. H.	30	1000
1944-11-11	10:00	W. H. H.	31	1000
1944-11-11	10:00	W. H. H.	32	1000
1944-11-11	10:00	W. H. H.	33	1000
1944-11-11	10:00	W. H. H.	34	1000
1944-11-11	10:00	W. H. H.	35	1000
1944-11-11	10:00	W. H. H.	36	1000
1944-11-11	10:00	W. H. H.	37	1000
1944-11-11	10:00	W. H. H.	38	1000
1944-11-11	10:00	W. H. H.	39	1000
1944-11-11	10:00	W. H. H.	40	1000
1944-11-11	10:00	W. H. H.	41	1000
1944-11-11	10:00	W. H. H.	42	1000
1944-11-11	10:00	W. H. H.	43	1000
1944-11-11	10:00	W. H. H.	44	1000
1944-11-11	10:00	W. H. H.	45	1000
1944-11-11	10:00	W. H. H.	46	1000
1944-11-11	10:00	W. H. H.	47	1000
1944-11-11	10:00	W. H. H.	48	1000
1944-11-11	10:00	W. H. H.	49	1000
1944-11-11	10:00	W. H. H.	50	1000
1944-11-11	10:00	W. H. H.	51	1000
1944-11-11	10:00	W. H. H.	52	1000
1944-11-11	10:00	W. H. H.	53	1000
1944-11-11	10:00	W. H. H.	54	1000
1944-11-11	10:00	W. H. H.	55	1000
1944-11-11	10:00	W. H. H.	56	1000
1944-11-11	10:00	W. H. H.	57	1000
1944-11-11	10:00	W. H. H.	58	1000
1944-11-11	10:00	W. H. H.	59	1000
1944-11-11	10:00	W. H. H.	60	1000
1944-11-11	10:00	W. H. H.	61	1000
1944-11-11	10:00	W. H. H.	62	1000
1944-11-11	10:00	W. H. H.	63	1000
1944-11-11	10:00	W. H. H.	64	1000
1944-11-11				

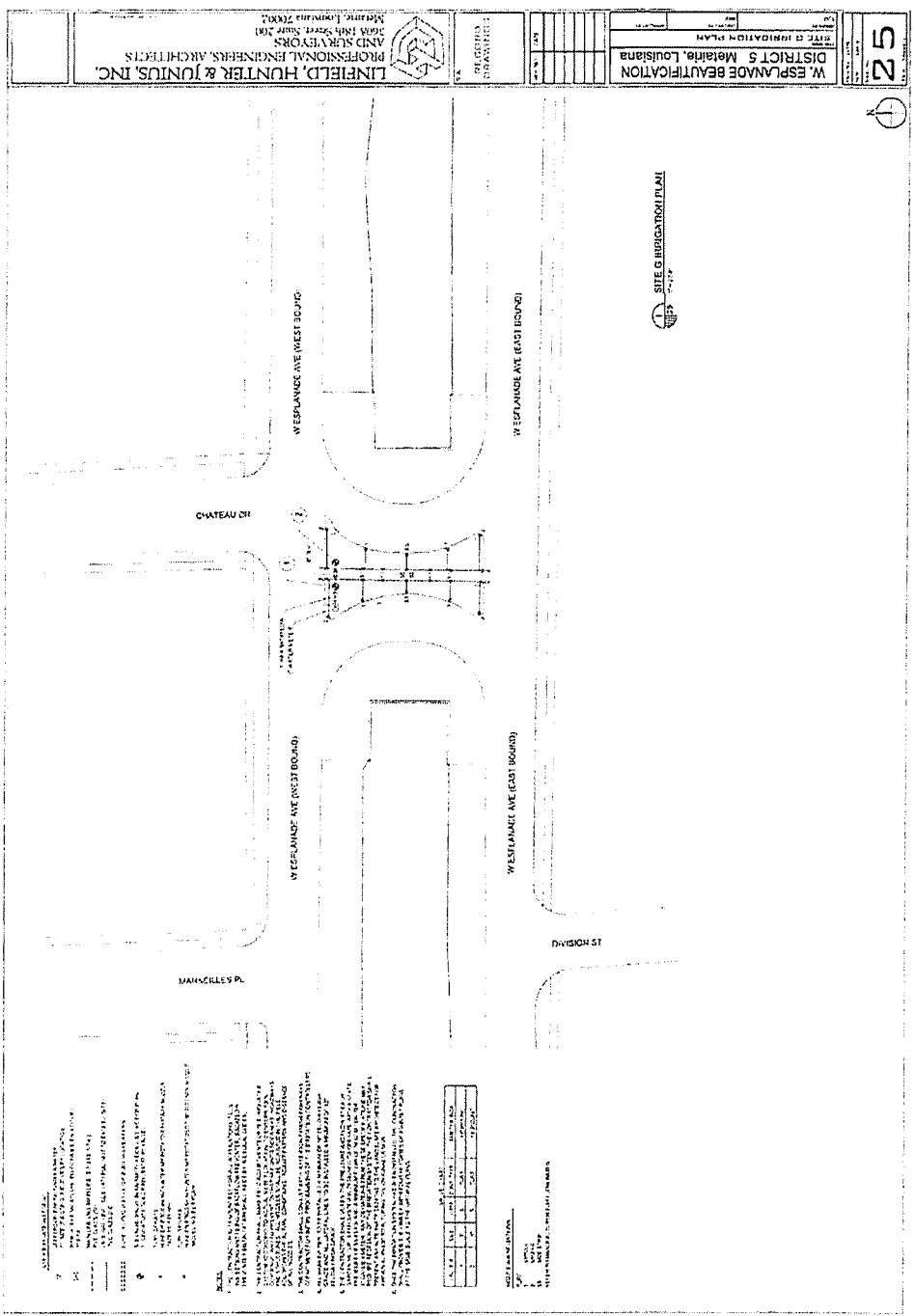

SITE IRRIGATION PLAN

W. ESPLANADE BEAUTIFICATION
DISTRICT 5 Metairie, Louisiana

DATE: 10/1/00
BY: [Signature]

REVISIONS
1. 10/1/00

CLIENT
LINFIELD, HUNTER & JONINS, INC.

PROFESSIONAL ENGINEERS, ARCHITECTS
AND SURVEYORS
METairie, Louisiana 70002

1008 10th Street, Suite 200
Metairie, Louisiana 70002

NOTES:
1. SEE PLAN FOR IRRIGATION SYSTEM LAYOUT.
2. SEE PLAN FOR IRRIGATION SYSTEM LAYOUT.
3. SEE PLAN FOR IRRIGATION SYSTEM LAYOUT.
4. SEE PLAN FOR IRRIGATION SYSTEM LAYOUT.
5. SEE PLAN FOR IRRIGATION SYSTEM LAYOUT.
6. SEE PLAN FOR IRRIGATION SYSTEM LAYOUT.
7. SEE PLAN FOR IRRIGATION SYSTEM LAYOUT.
8. SEE PLAN FOR IRRIGATION SYSTEM LAYOUT.
9. SEE PLAN FOR IRRIGATION SYSTEM LAYOUT.
10. SEE PLAN FOR IRRIGATION SYSTEM LAYOUT.

NO.	DATE	BY	DESCRIPTION
1	10/1/00	[Signature]	ISSUED FOR PERMIT

SCALE: 1" = 40'

DATE: 10/1/00

BY: [Signature]

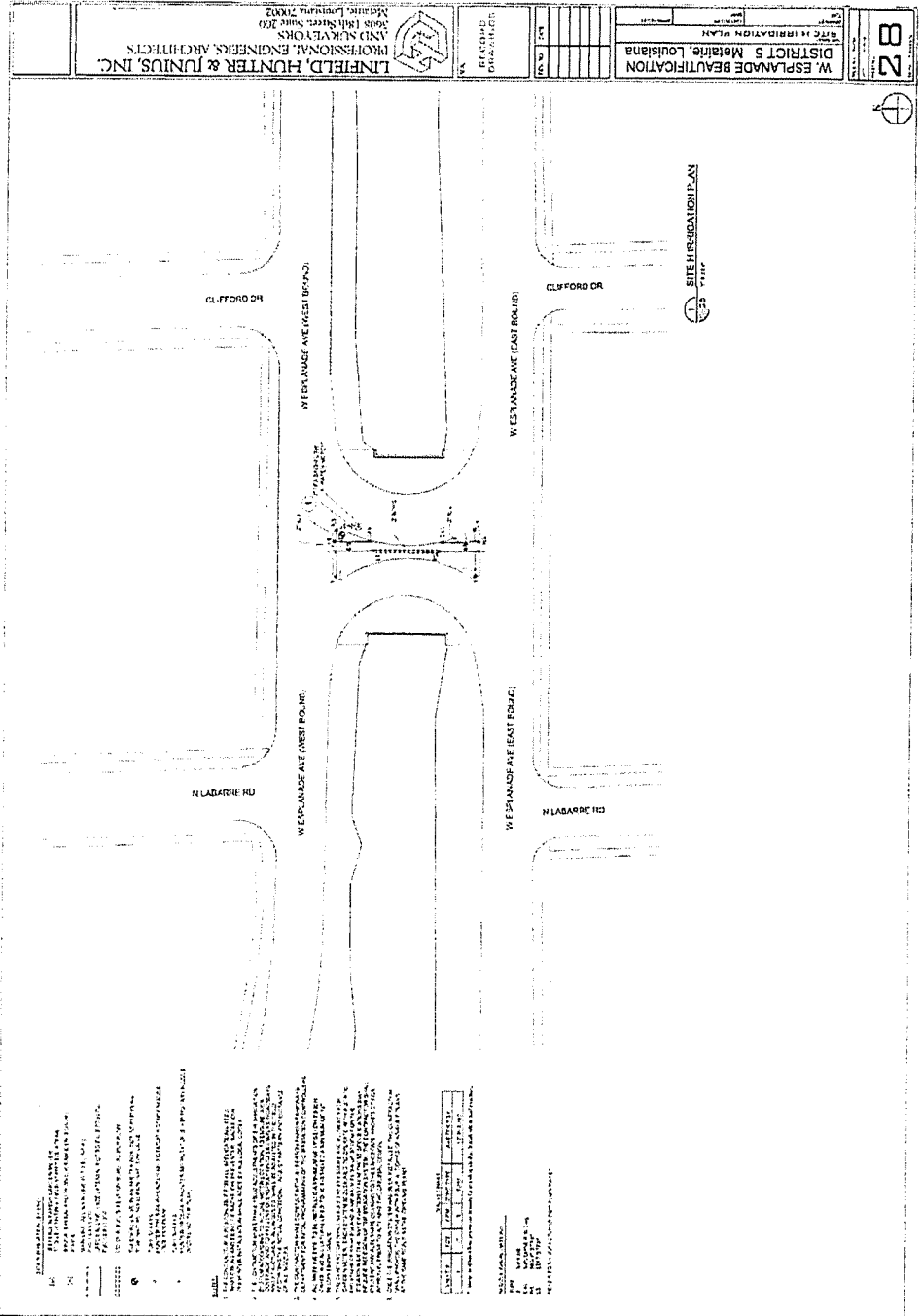

LINFIELD, HUNTER & JUNIUS, INC.
 PROFESSIONAL ENGINEERS, ARCHITECTS
 AND SURVEYORS
 1000 N. RIVER ST., SUITE 200
 METairie, LOUISIANA 70002

W. ESPLAND BEAUFORTIFICATION
 DISTRICT 5 Metairie, Louisiana
 SITE IRRIGATION PLAN

1. THE IRRIGATION SYSTEM IS TO BE DESIGNED TO PROVIDE ADEQUATE WATER TO ALL AREAS OF THE SITE.
 2. THE IRRIGATION SYSTEM IS TO BE DESIGNED TO PROVIDE ADEQUATE WATER TO ALL AREAS OF THE SITE.
 3. THE IRRIGATION SYSTEM IS TO BE DESIGNED TO PROVIDE ADEQUATE WATER TO ALL AREAS OF THE SITE.
 4. THE IRRIGATION SYSTEM IS TO BE DESIGNED TO PROVIDE ADEQUATE WATER TO ALL AREAS OF THE SITE.
 5. THE IRRIGATION SYSTEM IS TO BE DESIGNED TO PROVIDE ADEQUATE WATER TO ALL AREAS OF THE SITE.
 6. THE IRRIGATION SYSTEM IS TO BE DESIGNED TO PROVIDE ADEQUATE WATER TO ALL AREAS OF THE SITE.
 7. THE IRRIGATION SYSTEM IS TO BE DESIGNED TO PROVIDE ADEQUATE WATER TO ALL AREAS OF THE SITE.
 8. THE IRRIGATION SYSTEM IS TO BE DESIGNED TO PROVIDE ADEQUATE WATER TO ALL AREAS OF THE SITE.
 9. THE IRRIGATION SYSTEM IS TO BE DESIGNED TO PROVIDE ADEQUATE WATER TO ALL AREAS OF THE SITE.
 10. THE IRRIGATION SYSTEM IS TO BE DESIGNED TO PROVIDE ADEQUATE WATER TO ALL AREAS OF THE SITE.

NO.	DATE	DESCRIPTION
1	10/1/00	PRELIMINARY DESIGN
2	10/1/00	FINAL DESIGN
3	10/1/00	CONSTRUCTION
4	10/1/00	MAINTENANCE
5	10/1/00	REPAIRS
6	10/1/00	REPLACEMENT
7	10/1/00	UPGRADE
8	10/1/00	RENOVATION
9	10/1/00	DEMOLITION
10	10/1/00	RECONSTRUCTION

W. ESPINARDE BEAUFICATION DISTRICT 5 Metairie, Louisiana

ILLUSTRATION SHEET, DETAILS

3. BACKFLOW PREVENTER DETAIL

4. CLASS II BACKFLOW COVER DETAIL

5. POP-UP SPRAY HEAD DETAIL

6. BATTERY VALVE DETAIL

7. PIPING DIAGRAM

1. GENERAL NOTES

1. All work shall be in accordance with the latest edition of the Uniform Plumbing Code and the latest edition of the International Association of Plumbing and Mechanical Officials (IAPMO) Standard for Backflow Prevention Devices.
2. All materials and workmanship shall be of the highest quality and shall be subject to inspection and approval by the City Engineer.
3. All valves shall be of the double check type and shall be installed in accordance with the manufacturer's instructions.
4. All piping shall be of the standard size and shall be installed in accordance with the manufacturer's instructions.
5. All work shall be completed within the specified time frame and shall be subject to inspection and approval by the City Engineer.

2. SPECIFICATIONS

1. The backflow preventer shall be of the double check type and shall be installed in accordance with the manufacturer's instructions.
2. The Class II backflow cover shall be of the standard size and shall be installed in accordance with the manufacturer's instructions.
3. The pop-up spray head shall be of the standard size and shall be installed in accordance with the manufacturer's instructions.
4. The battery valve shall be of the standard size and shall be installed in accordance with the manufacturer's instructions.
5. The piping shall be of the standard size and shall be installed in accordance with the manufacturer's instructions.

LINEFIELD, HUNTER & JUNIUS, INC.
PROFESSIONAL ENGINEERS, ARCHITECTS
1009 PINE STREET, SUITE 200
METairie, LOUISIANA 70002

34

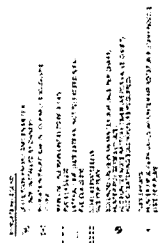

2/1	2/1	2/1
-----	-----	-----

1991

Melville Company

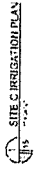
[illegible]

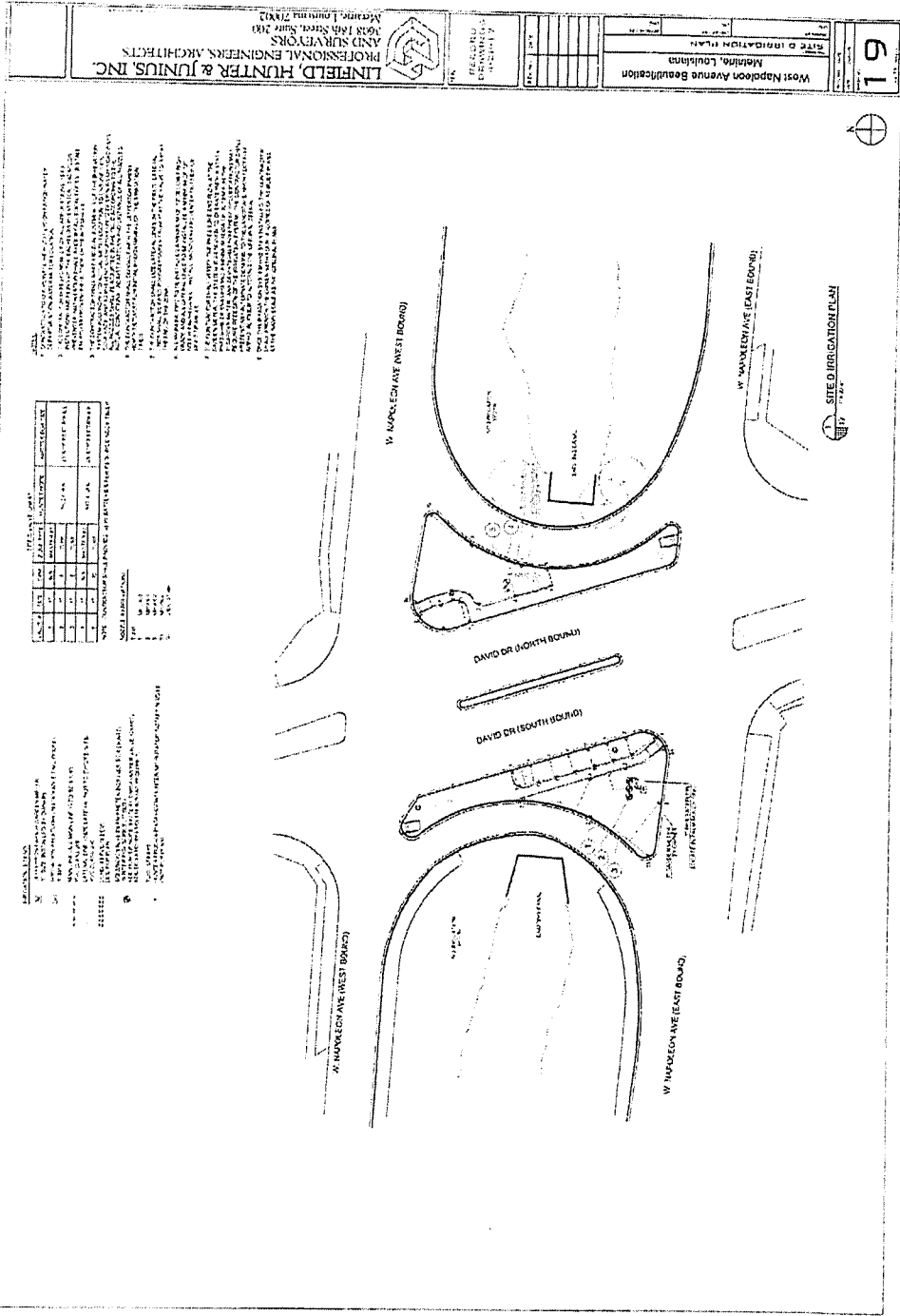

THIS PLAN IS A PRELIMINARY DESIGN AND IS NOT TO BE USED FOR CONSTRUCTION. IT IS THE RESPONSIBILITY OF THE CLIENT TO OBTAIN ALL NECESSARY PERMITS AND APPROVALS FROM THE APPROPRIATE AGENCIES. THE DESIGNER ASSUMES NO LIABILITY FOR ANY ERRORS OR OMISSIONS IN THIS PLAN. THE CLIENT AGREES TO HOLD THE DESIGNER HARMLESS FROM ANY AND ALL CLAIMS, DAMAGES, LOSSES, AND EXPENSES, INCLUDING ATTORNEY'S FEES, ARISING OUT OF OR RESULTING FROM THE USE OF THIS PLAN. THE CLIENT AGREES TO INDEMNIFY AND HOLD THE DESIGNER HARMLESS FROM ANY AND ALL CLAIMS, DAMAGES, LOSSES, AND EXPENSES, INCLUDING ATTORNEY'S FEES, ARISING OUT OF OR RESULTING FROM THE USE OF THIS PLAN. THE CLIENT AGREES TO INDEMNIFY AND HOLD THE DESIGNER HARMLESS FROM ANY AND ALL CLAIMS, DAMAGES, LOSSES, AND EXPENSES, INCLUDING ATTORNEY'S FEES, ARISING OUT OF OR RESULTING FROM THE USE OF THIS PLAN.

SITE DATA		TOTAL AREA		TOTAL VOLUME	
NO.	DESCRIPTION	AREA (SQ. FT.)	VOLUME (CU. YD.)	AREA (SQ. FT.)	VOLUME (CU. YD.)
1	GRAVEL	10,000	100	10,000	100
2	GRAVEL	10,000	100	10,000	100
3	GRAVEL	10,000	100	10,000	100
4	GRAVEL	10,000	100	10,000	100
5	GRAVEL	10,000	100	10,000	100
6	GRAVEL	10,000	100	10,000	100
7	GRAVEL	10,000	100	10,000	100
8	GRAVEL	10,000	100	10,000	100
9	GRAVEL	10,000	100	10,000	100
10	GRAVEL	10,000	100	10,000	100
11	GRAVEL	10,000	100	10,000	100
12	GRAVEL	10,000	100	10,000	100
13	GRAVEL	10,000	100	10,000	100
14	GRAVEL	10,000	100	10,000	100
15	GRAVEL	10,000	100	10,000	100
16	GRAVEL	10,000	100	10,000	100
17	GRAVEL	10,000	100	10,000	100
18	GRAVEL	10,000	100	10,000	100
19	GRAVEL	10,000	100	10,000	100
20	GRAVEL	10,000	100	10,000	100

LEGEND:
 1. GRAVEL
 2. GRAVEL
 3. GRAVEL
 4. GRAVEL
 5. GRAVEL
 6. GRAVEL
 7. GRAVEL
 8. GRAVEL
 9. GRAVEL
 10. GRAVEL
 11. GRAVEL
 12. GRAVEL
 13. GRAVEL
 14. GRAVEL
 15. GRAVEL
 16. GRAVEL
 17. GRAVEL
 18. GRAVEL
 19. GRAVEL
 20. GRAVEL

ENCLOSURE

West Napoleon Avenue Beautification
Metairie, Louisiana
SITING & IRRIGATION PLAN

RECORDING
SUBDIVISION
SHEET NO. 1
OF 1



LINEFIELD, HUNTER & JUNIUS, INC.
PROFESSIONAL ENGINEERS, ARCHITECTS
1208 PINE STREET, SUITE 200
METairie, Louisiana 70002



1. SITE IRRIGATION PLAN

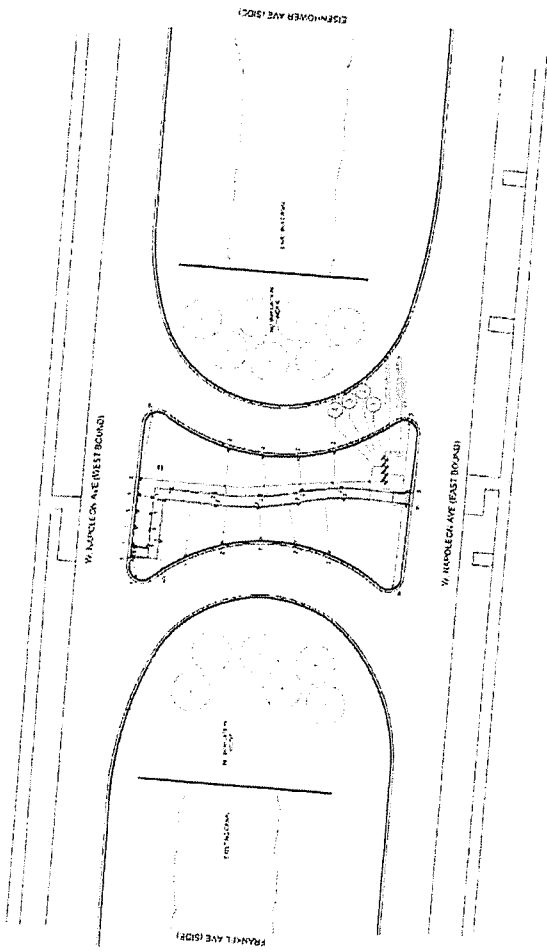

THE IRRIGATION SYSTEM IS DESIGNED TO PROVIDE ADEQUATE WATER TO THE PLANTS AND TREES PLANTED ALONG THE SIDEWALKS OF THE PROJECT. THE SYSTEM IS DESIGNED TO BE MAINTAINED AND OPERATED BY THE CITY OF METAIRIE. THE SYSTEM IS DESIGNED TO BE MAINTAINED AND OPERATED BY THE CITY OF METAIRIE. THE SYSTEM IS DESIGNED TO BE MAINTAINED AND OPERATED BY THE CITY OF METAIRIE.

NO.	DESCRIPTION	QTY.	UNIT	AMOUNT
1	1/2" CPVC PIPE	100	FT.	100.00
2	1/2" CPVC ELBOW	20	EA.	20.00
3	1/2" CPVC TEE	10	EA.	10.00
4	1/2" CPVC VALVE	5	EA.	5.00
5	1/2" CPVC FITTING	10	EA.	10.00
6	1/2" CPVC END CAP	5	EA.	5.00
7	1/2" CPVC GROMMET	10	EA.	10.00
8	1/2" CPVC GLAND	10	EA.	10.00
9	1/2" CPVC NUT	10	EA.	10.00
10	1/2" CPVC WASHER	10	EA.	10.00
11	1/2" CPVC BOLT	10	EA.	10.00
12	1/2" CPVC LOCKWASHER	10	EA.	10.00
13	1/2" CPVC LOCKWASHER	10	EA.	10.00
14	1/2" CPVC LOCKWASHER	10	EA.	10.00
15	1/2" CPVC LOCKWASHER	10	EA.	10.00
16	1/2" CPVC LOCKWASHER	10	EA.	10.00
17	1/2" CPVC LOCKWASHER	10	EA.	10.00
18	1/2" CPVC LOCKWASHER	10	EA.	10.00
19	1/2" CPVC LOCKWASHER	10	EA.	10.00
20	1/2" CPVC LOCKWASHER	10	EA.	10.00

THE IRRIGATION SYSTEM IS DESIGNED TO PROVIDE ADEQUATE WATER TO THE PLANTS AND TREES PLANTED ALONG THE SIDEWALKS OF THE PROJECT. THE SYSTEM IS DESIGNED TO BE MAINTAINED AND OPERATED BY THE CITY OF METAIRIE. THE SYSTEM IS DESIGNED TO BE MAINTAINED AND OPERATED BY THE CITY OF METAIRIE. THE SYSTEM IS DESIGNED TO BE MAINTAINED AND OPERATED BY THE CITY OF METAIRIE.

1. The first step in the process is to identify the problem or issue that needs to be addressed. This involves gathering information and understanding the context of the problem.

2. Once the problem is identified, the next step is to define the objectives and goals of the project. This helps to clarify what needs to be achieved and provides a clear direction for the team.

3. The third step is to develop a plan or strategy to address the problem. This involves breaking down the problem into smaller, manageable tasks and determining the resources needed to complete each task.

4. The fourth step is to implement the plan. This involves assigning tasks to team members, setting deadlines, and monitoring progress. It is important to communicate regularly and provide support to team members throughout the process.

5. The final step is to evaluate the results of the project. This involves comparing the actual outcomes to the objectives and goals defined at the beginning. It is important to identify any areas for improvement and learn from the experience for future projects.

TABLE 1. *Effect of the concentration of the polymer solution on the properties of the films*

Concentration of the polymer solution, g/dl	Mechanical properties				Tensile strength, MPa	Elongation at break, %	Modulus of elasticity, GPa
	Tensile strength, MPa	Elongation at break, %	Modulus of elasticity, GPa	Tensile strength, MPa			
0.5	1.2	1.5	1.8	1.5	1.2	1.5	1.8
1.0	1.5	1.8	2.1	1.8	1.5	1.8	2.1
1.5	1.8	2.1	2.4	2.1	1.8	2.1	2.4
2.0	2.1	2.4	2.7	2.4	2.1	2.4	2.7
2.5	2.4	2.7	3.0	2.7	2.4	2.7	3.0
3.0	2.7	3.0	3.3	3.0	2.7	3.0	3.3
3.5	3.0	3.3	3.6	3.3	3.0	3.3	3.6
4.0	3.3	3.6	3.9	3.6	3.3	3.6	3.9
4.5	3.6	3.9	4.2	3.9	3.6	3.9	4.2
5.0	3.9	4.2	4.5	4.2	3.9	4.2	4.5
5.5	4.2	4.5	4.8	4.5	4.2	4.5	4.8
6.0	4.5	4.8	5.1	4.8	4.5	4.8	5.1
6.5	4.8	5.1	5.4	5.1	4.8	5.1	5.4
7.0	5.1	5.4	5.7	5.4	5.1	5.4	5.7
7.5	5.4	5.7	6.0	5.7	5.4	5.7	6.0
8.0	5.7	6.0	6.3	6.0	5.7	6.0	6.3
8.5	6.0	6.3	6.6	6.3	6.0	6.3	6.6
9.0	6.3	6.6	6.9	6.6	6.3	6.6	6.9
9.5	6.6	6.9	7.2	6.9	6.6	6.9	7.2
10.0	6.9	7.2	7.5	7.2	6.9	7.2	7.5

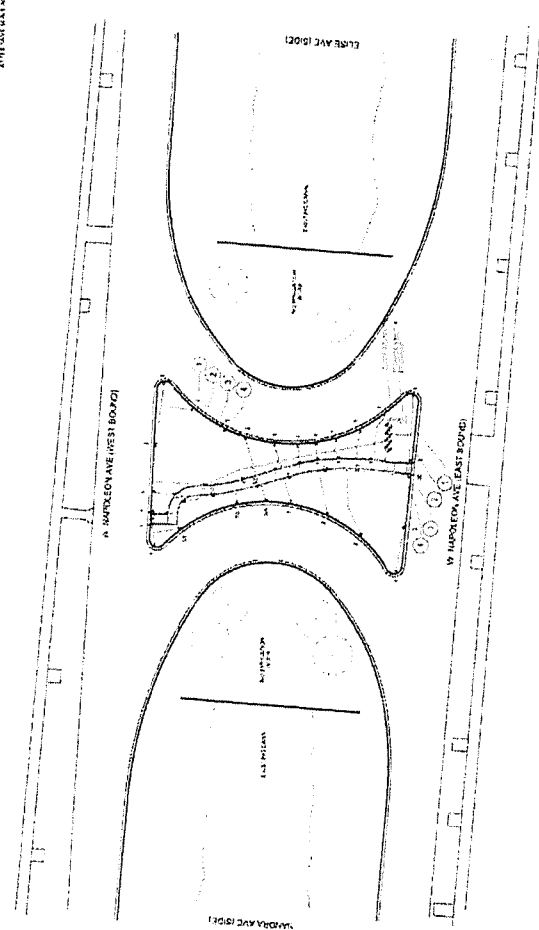
[illegible]

SITE IRRIGATION PLAN

Non-Public Works Bid Affidavit Instructions

- Affidavit is supplied as a courtesy to Affiants, but it is the responsibility of the affiant to insure the affidavit they submit to Jefferson Parish complies, in both form and content, with federal, state and parish laws.
- Affidavit must be signed by an authorized representative of the entity or the affidavit will not be accepted.
- Affidavit must be notarized or the affidavit will not be accepted.
- Notary must sign name, print name, and include bar/notary number, or the affidavit will not be accepted.
- Affiant **MUST** select either A or B when required or the affidavit will not be accepted.
- Affiants who select choice A must include an attachment or the affidavit will not be accepted.
- If both choice A and B are selected, the affidavit will not be accepted.
- Affidavit marked N/A will not be accepted.
- It is the responsibility of the Affiant to submit a new affidavit if any additional campaign contributions are made after the affidavit is executed but prior to the time the council acts on the matter.

Instruction sheet may be omitted when submitting the affidavit

Non-Public Works Bid

AFFIDAVIT

STATE OF Louisiana

PARISH/COUNTY OF St. Tammany

BEFORE ME, the undersigned authority, personally came and appeared: _____
Brian Rotolo, (Affiant) who after being by me duly sworn, deposed and said that
he/she is the fully authorized VP of Finance of Rotolo Consultants, Inc. (Entity),
the party who submitted a bid in response to Bid Number 5000123897, to the Parish of
Jefferson.

Affiant further said:

Campaign Contribution Disclosures

(Choose A or B, if option A is indicated please include the required attachment):

Choice A _____ Attached hereto is a list of all campaign contributions, including the date and amount of each contribution, made to current or former elected officials of the Parish of Jefferson by Entity, Affiant, and/or officers, directors and owners, including employees, owning 25% or more of the Entity during the two-year period immediately preceding the date of this affidavit or the current term of the elected official, whichever is greater. Further, Entity, Affiant, and/or Entity Owners have not made any contributions to or in support of current or former members of the Jefferson Parish Council or the Jefferson Parish President through or in the name of another person or legal entity, either directly or indirectly.

Choice B X there are **NO** campaign contributions made which would require disclosure under Choice A of this section.

Debt Disclosures

(Choose A or B, if option A is indicated please include the required attachment):

Choice A _____ Attached hereto is a list of all debts owed by the affiant to any elected or appointed official of the Parish of Jefferson, and any and all debts owed by any elected or appointed official of the Parish to the Affiant.

Choice B X _____ There are **NO** debts which would require disclosure under Choice A of this section.

Affiant further said:

That Affiant has employed no person, corporation, firm, association, or other organization, either directly or indirectly, to secure the public contract under which he received payment, other than persons regularly employed by the Affiant whose services in connection with the construction, alteration or demolition of the public building or project or in securing the public contract were in the regular course of their duties for Affiant; and

[The remainder of this page is intentionally left blank.]

That no part of the contract price received by Affiant was paid or will be paid to any person, corporation, firm, association, or other organization for soliciting the contract, other than the payment of their normal compensation to persons regularly employed by the Affiant whose services in connection with the construction, alteration or demolition of the public building or project were in the regular course of their duties for Affiant.

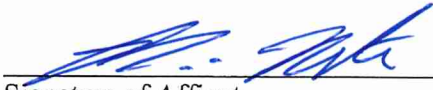

Signature of Affiant

Brian Rotolo

Printed Name of Affiant

SWORN AND SUBSCRIBED TO BEFORE ME
ON THE 20th DAY OF September, 2018.



Notary Public
Crystal Gravois

Printed Name of Notary
066725

Notary/Bar Roll Number



My commission expires until life.



JEFFERSON PARISH

Department of Purchasing

Michael S. Yenni
Parish President

Renny Simno
Director

September 06, 2018

ADDENDUM # 1

Bid No.: 50-00123897

Bid Opening Date: 09/20/2018

**For: TWO YEAR CONTRACT FOR IRRIGATION SERVICES AT VARIOUS LOCATIONS FOR THE
JEFFERSON PARISH DEPARTMENT OF PUBLIC WORKS- PARKWAYS**

CLARIFICATION:

La State Contractors License number in the category of Building Construction and/or Landscaping, Grading and Beautification has been added as an additional requirement.

NOTE: BID HAS BEEN REVISED PER ADDENDUM 1

Sincerely,

A handwritten signature in cursive script, reading "Donna M Evans", is written over a horizontal line.

Donna M Evans, Buyer II
Jefferson Parish Purchasing Department

**Bidders must acknowledge all addenda on the bid form. Bidder acknowledges receipt of
this addendum on the bid form as indicated. Failure to do so will result in bid rejection.**

This addendum is a part of the contract documents and modifies the original bidding documents and specifications. The contents of this addendum shall be included in the contract documents. Changes made by this addendum shall take precedence over the documents of earlier date.



JEFFERSON PARISH

Department of Purchasing

Michael S. Yenni
Parish President

Renny Simno
Director

September 12, 2018

ADDENDUM # 2

Bid No.: 50-00123897

Bid Opening Date: 09/20/2018

**For: TWO YEAR CONTRACT FOR IRRIGATION SERVICES AT VARIOUS LOCATIONS FOR THE
JEFFERSON PARISH DEPARTMENT OF PUBLIC WORKS- PARKWAYS**

CLARIFICATION:

Please see attached- Irrigation plans for Site 2.3.8- Severn Avenue.

Sincerely,

Donna M Evans, Buyer II
Jefferson Parish Purchasing Department

**Bidders must acknowledge all addenda on the bid form. Bidder acknowledges receipt of
this addendum on the bid form as indicated. Failure to do so will result in bid rejection.**

This addendum is a part of the contract documents and modifies the original bidding documents and specifications. The contents of this addendum shall be included in the contract documents. Changes made by this addendum shall take precedence over the documents of earlier date.

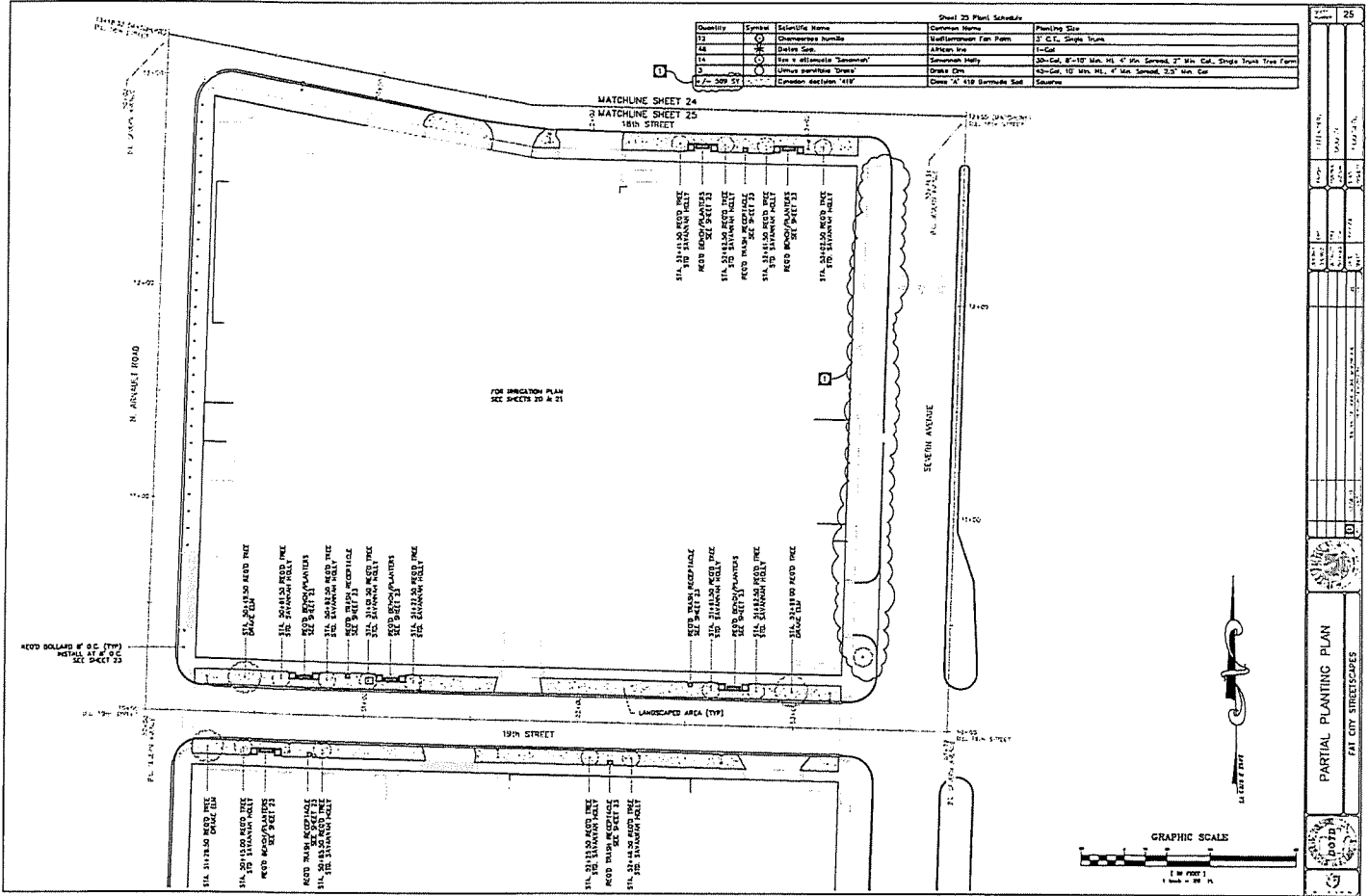

State of Louisiana

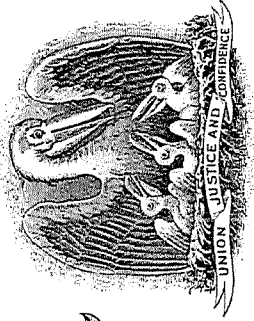

State Licensing Board for Contractors

This is to Certify that:

ROTOLO CONSULTANTS, INC.
38001 Brownsville Road
Slidell, LA 70460

is duly licensed and entitled to practice the following classifications

BUILDING CONSTRUCTION; MUNICIPAL AND PUBLIC WORKS CONSTRUCTION; SPECIALTY:
FENCING; SPECIALTY: LANDSCAPING, GRADING AND BEAUTIFICATION; SPECIALTY: RECREATION &
SPORTING FACILITIES & GOLF COURSES; SPECIALTY: SWIMMING POOLS, WATER FEATURES AND
FOUNTAINS



Expiration Date: July 20, 2019

License No: 29959

Witness our hand and seal of the Board dated,
Baton Rouge, LA 21st day of July 2016

Michael B. McCall

Director

Lee M. Mallett

Chairman

Andy R. Rame

Treasurer

This License Is Not Transferrable



HORTICULTURE REGISTRATION:

AARON WILLIAM BROCKUP

Date: 03/15/2018

LDAF ID: 136986

LICENSE(S): IRRIGATION CONTRACTOR 18-0599

CEU Expiration Date Mar 8 2020

LANDSCAPE HORTICULTURIST 18-3892

Please verify information for correctness. If changes are necessary, make corrections and promptly return to issuing agency.

LOUISIANA DEPARTMENT OF AGRICULTURE & FORESTRY

MIKE STRAIN, DVM, COMMISSIONER

Agricultural & Environmental Sciences, 5825 Florida Blvd., Suite 3002, Baton Rouge, LA 70806, (225) 952-8100, FAX (225) 925-3760

Be it known, that effective 03/08/2018 through 03/31/2019 having complied with all relevant requirements of the Louisiana Revised Statutes, the individual named below is hereby licensed in the following profession(s):

LICENSE(S): IRRIGATION CONTRACTOR 18-0599

CEU Expiration Date

Mar 8 2020

LANDSCAPE HORTICULTURIST

18-3892

AARON WILLIAM BROCKUP

1103 HICKORY DRIVE

LONG BEACH MS 39560

Commissioner

DISPLAY IN A PROMINENT PLACE

LDAF ID:

136986





CERTIFICATE OF LIABILITY INSURANCE

DATE (MM/DD/YYYY)

9/20/2018

THIS CERTIFICATE IS ISSUED AS A MATTER OF INFORMATION ONLY AND CONFERS NO RIGHTS UPON THE CERTIFICATE HOLDER. THIS CERTIFICATE DOES NOT AFFIRMATIVELY OR NEGATIVELY AMEND, EXTEND OR ALTER THE COVERAGE AFFORDED BY THE POLICIES BELOW. THIS CERTIFICATE OF INSURANCE DOES NOT CONSTITUTE A CONTRACT BETWEEN THE ISSUING INSURER(S), AUTHORIZED REPRESENTATIVE OR PRODUCER, AND THE CERTIFICATE HOLDER.

IMPORTANT: If the certificate holder is an ADDITIONAL INSURED, the policy(ies) must have ADDITIONAL INSURED provisions or be endorsed. If SUBROGATION IS WAIVED, subject to the terms and conditions of the policy, certain policies may require an endorsement. A statement on this certificate does not confer rights to the certificate holder in lieu of such endorsement(s).

PRODUCER Arthur J. Gallagher Risk Management Services, Inc. 235 Highlandia Drive, Suite 200 Baton Rouge LA 70810	CONTACT NAME: Mandy Nesom PHONE (A/C, No, Ext): 225-292-3515 E-MAIL ADDRESS: Mandy_Nesom@ajg.com FAX (A/C, No): 225-292-3893														
INSURED Rotolo Consultants Inc dba RCI 38001 Brownsville Rd Slidell, LA 70460	<table><tr><th>INSURER(S) AFFORDING COVERAGE</th><th>NAIC #</th></tr><tr><td>INSURER A : National Trust Insurance Company</td><td>20141</td></tr><tr><td>INSURER B : FCCI Advantage Insurance Company</td><td>12842</td></tr><tr><td>INSURER C :</td><td></td></tr><tr><td>INSURER D :</td><td></td></tr><tr><td>INSURER E :</td><td></td></tr><tr><td>INSURER F :</td><td></td></tr></table>	INSURER(S) AFFORDING COVERAGE	NAIC #	INSURER A : National Trust Insurance Company	20141	INSURER B : FCCI Advantage Insurance Company	12842	INSURER C :		INSURER D :		INSURER E :		INSURER F :	
INSURER(S) AFFORDING COVERAGE	NAIC #														
INSURER A : National Trust Insurance Company	20141														
INSURER B : FCCI Advantage Insurance Company	12842														
INSURER C :															
INSURER D :															
INSURER E :															
INSURER F :															

COVERAGES**CERTIFICATE NUMBER:** 1919042749**REVISION NUMBER:**

THIS IS TO CERTIFY THAT THE POLICIES OF INSURANCE LISTED BELOW HAVE BEEN ISSUED TO THE INSURED NAMED ABOVE FOR THE POLICY PERIOD INDICATED. NOTWITHSTANDING ANY REQUIREMENT, TERM OR CONDITION OF ANY CONTRACT OR OTHER DOCUMENT WITH RESPECT TO WHICH THIS CERTIFICATE MAY BE ISSUED OR MAY PERTAIN, THE INSURANCE AFFORDED BY THE POLICIES DESCRIBED HEREIN IS SUBJECT TO ALL THE TERMS, EXCLUSIONS AND CONDITIONS OF SUCH POLICIES. LIMITS SHOWN MAY HAVE BEEN REDUCED BY PAID CLAIMS.

INSR LTR	TYPE OF INSURANCE	ADDL SUBR INSD WVD	POLICY NUMBER	POLICY EFF (MM/DD/YYYY)	POLICY EXP (MM/DD/YYYY)	LIMITS
A	<input checked="" type="checkbox"/> COMMERCIAL GENERAL LIABILITY <input type="checkbox"/> CLAIMS-MADE <input checked="" type="checkbox"/> OCCUR GEN'L AGGREGATE LIMIT APPLIES PER: <input type="checkbox"/> POLICY <input checked="" type="checkbox"/> PROJECT <input type="checkbox"/> LOC OTHER:	Y	CPP0016919	6/30/2018	6/30/2019	EACH OCCURRENCE \$ 1,000,000 DAMAGE TO RENTED PREMISES (Ea occurrence) \$ 100,000 MED EXP (Any one person) \$ 5,000 PERSONAL & ADV INJURY \$ 1,000,000 GENERAL AGGREGATE \$ 2,000,000 PRODUCTS - COMP/OP AGG \$ 2,000,000 \$
A	<input checked="" type="checkbox"/> AUTOMOBILE LIABILITY <input checked="" type="checkbox"/> ANY AUTO <input type="checkbox"/> OWNED AUTOS ONLY <input type="checkbox"/> SCHEDULED AUTOS <input checked="" type="checkbox"/> HIRED AUTOS ONLY <input checked="" type="checkbox"/> NON-OWNED AUTOS ONLY <input checked="" type="checkbox"/> Sym 10 - PD	Y	CA10000327103	6/30/2018	6/30/2019	COMBINED SINGLE LIMIT (Ea accident) \$ 1,000,000 BODILY INJURY (Per person) \$ BODILY INJURY (Per accident) \$ PROPERTY DAMAGE (Per accident) \$ \$
A	<input checked="" type="checkbox"/> UMBRELLA LIAB <input checked="" type="checkbox"/> OCCUR <input type="checkbox"/> EXCESS LIAB <input type="checkbox"/> CLAIMS-MADE DED <input checked="" type="checkbox"/> RETENTION \$ 10,000		UMB100015210	6/30/2018	6/30/2019	EACH OCCURRENCE \$ 5,000,000 AGGREGATE \$ 5,000,000 \$
B	WORKERS COMPENSATION AND EMPLOYERS' LIABILITY ANY PROPRIETOR/PARTNER/EXECUTIVE OFFICER/MEMBER EXCLUDED? (Mandatory in NH) If yes, describe under DESCRIPTION OF OPERATIONS below	Y/N N	WC000022224	6/30/2018	6/30/2019	<input checked="" type="checkbox"/> PER STATUTE <input type="checkbox"/> OTHER E.L. EACH ACCIDENT \$ 1,000,000 E.L. DISEASE - EA EMPLOYEE \$ 1,000,000 E.L. DISEASE - POLICY LIMIT \$ 1,000,000
A B	Equipment Floater Workers Comp-MS, TN, AL		CPP0016919 010WC18A71066	6/30/2018 6/30/2018	6/30/2019 6/30/2019	Leased/Rented Policy Limit \$500,000 \$1,000,000

DESCRIPTION OF OPERATIONS / LOCATIONS / VEHICLES (ACORD 101, Additional Remarks Schedule, may be attached if more space is required)

CERTIFICATE HOLDER**CANCELLATION**

Jefferson Parish Purchasing Department
200 Derbigny St.
General Government Building, Suite 4400
Gretna LA 70053

SHOULD ANY OF THE ABOVE DESCRIBED POLICIES BE CANCELLED BEFORE THE EXPIRATION DATE THEREOF, NOTICE WILL BE DELIVERED IN ACCORDANCE WITH THE POLICY PROVISIONS.

AUTHORIZED REPRESENTATIVE

© 1988-2015 ACORD CORPORATION. All rights reserved.

AGENCY CUSTOMER ID: _____

LOC #: _____



ADDITIONAL REMARKS SCHEDULE

Page 1 of 1

AGENCY Arthur J. Gallagher Risk Management Services, Inc.		NAMED INSURED Rotolo Consultants Inc dba RCI 38001 Brownsville Rd Slidell, LA 70460	
POLICY NUMBER		EFFECTIVE DATE:	
CARRIER	NAIC CODE		

ADDITIONAL REMARKS

THIS ADDITIONAL REMARKS FORM IS A SCHEDULE TO ACORD FORM,

FORM NUMBER: 25 **FORM TITLE:** CERTIFICATE OF LIABILITY INSURANCE

Blanket Additional Insured provided if required by written contract as respect General Liability form for both ongoing and completed operations#CGL084 10/13
 Blanket Additional Insured-Primary Non-Contributory, if required by written contract included in CGL025 11/08
 Blanket Additional Insured where required in a written contract - Auto Liability form #CAU058 (01 15)
 Blanket Waiver of Subrogation provided if required by written contract as respect General Liability CGL088 1013
 Blanket Waiver of Subrogation -Auto Liability CAU058 0115
 Blanket Waiver of Subrogation - Workers' Compensation WC0003 13(All States)

Excess/Umbrella follows form for Additional Insured Status

All policies - 30 day notice of cancellation except 10 days for non payment to insured

Rented/Leased Equipment \$500,000 Aggregate

Installation/Builders Risk Floater - 6/30/18 to 6/30/19 - \$1,000,000 Limit; Policy #CPP0016919 - National Trust Ins. Co.

Professional Liability - 6/30/18-19; Policy #03114129; Carrier-Allied World Assurance Co. - Each Claim \$1,000,000/\$2,000,000 Aggregate
 Includes Pollution Liability - \$1,000,000 Per Claim/\$2,000,000 Aggregate

R. Kyle Ardoin
Secretary of State

**State of
Louisiana
Secretary of
State**



COMMERCIAL DIVISION
225.925.4704

Fax Numbers
225.932.5317 (Admin. Services)
225.932.5314 (Corporations)
225.932.5318 (UCC)

Name	Type	City	Status
ROTOLO CONSULTANTS, INC.	Business Corporation	SLIDELL	Active

Previous Names

Business: ROTOLO CONSULTANTS, INC.

Charter Number: 34480469D

Registration Date: 12/15/1994

Domicile Address

38001 BROWNSVILLAGE RD
SLIDELL, LA 70460

Mailing Address

38001 BROWNSVILLAGE ROAD
SLIDELL, LA 70460

Principal Office Address

38001 BROWNSVILLAGE RD
SLIDELL, LA 70460

Status

Status: **Active**

Annual Report Status: **In Good Standing**

File Date: 12/15/1994

Last Report Filed: 12/5/2017

Type: Business Corporation

Registered Agent(s)

Agent:	C T CORPORATION SYSTEM
Address 1:	3867 PLAZA TOWER DR.
City, State, Zip:	BATON ROUGE, LA 70816
Appointment Date:	8/27/2015

Officer(s)

Additional Officers: No

Officer:	KEITH ROTOLO
Title:	Director, President
Address 1:	38001 BROWNSVILLAGE RD

City, State, Zip: SLIDELL, LA 70460**Officer:** BRIAN ROTOLO
Title: Secretary/Treasurer, Director
Address 1: 38001 BROWNSVILLAGE RD
City, State, Zip: SLIDELL, LA 70460**Amendments on File (9)**

Description	Date
Appointing, Change, or Resign of Officer	1/15/2010
Appointing, Change, or Resign of Officer	5/1/2013
Disclosure of Ownership	7/1/2015
Amendment	7/1/2015
Restated Articles	8/27/2015
Domicile, Agent Change or Resign of Agent	8/27/2015
Domicile, Agent Change or Resign of Agent	10/18/2015
Domicile, Agent Change or Resign of Agent	11/9/2016
Appointing, Change, or Resign of Officer	3/19/2018

Print



Bond Number: SLA18873420

Contractor Information

Principal: Rotolo Consultants Inc.

Address: 38001 Brownsville Road Slidell Louisiana 70460 United States

Owner/Obligee Information

Bond Form: Bid Bond in accordance with Contract Specifications

Owner/Obligee: Jefferson Parish

Address: 200 Derbigny Street Gretna Louisiana 70053 United States

Bond Information

Surety: Westfield Insurance Company

Bid Date: 9/20/2018

Estimated Contract Price:

Time For Completion:

Liquidated Damages:

Estimated Work On Hand:

Amount of Bid Security: 5%

Contract # or IFB #: 5000123897

Description of Job: TWO (2) YEAR MAINTENANCE CONTRACT FOR IRRIGATION SERVICES AT VARIOUS LOCATIONS FOR THE JEFFERSON PARISH DEPARTMENT OF PUBLIC WORKS - PARKWAYS

Job Breakdown:

Electronic Bidding Information

Bid Security Percentage: 5

Bid Security Maximum:

Owner Assigned Contractor Number: BX116

Primary Agency:

BXS Insurance, Inc.

Power of Attorney Limited to: unlimited

Executed

Entered By: Charles E. Reagin, III - 9/19/2018 10:23:42 AM ET

Approved & Executed By:

Charles E. Reagin, III

Charles E. Reagin, III (Signed: 19-Sep-2018 10:24 AM EDT (UTC-04:00))
Signature Information

Know all men by these presents that Westfield Insurance Company, a Corporation duly organized under the laws of the State of Ohio, are held and firmly bound unto the above owner/obligee by this transmission. The surety agrees to waive the Statute of Fraud defense and further agrees that the owner/obligee is a third party beneficiary of the waiver for the purposes of enforcing this bid bond.

© S2000, Inc.

Document ID: S2000-1000971898