

DATE: 1/10/2017

INVITATION TO BID
THIS IS NOT AN ORDER

Page: 4

BID NO.: 50-00118641

JEFFERSON PARISH

PURCHASING DEPARTMENT
P.O. BOX 9
GRETN, LA. 70054-0009
504-364-2678

VENDOR: _____

BUYER: SFOLSE

As per LSA-RS 47:301 et seq., all governmental bodies are excluded from payment of sales taxes to any Louisiana taxing body. Quotations shall be based on F.O.B. Agency warehouse or jobsite, anywhere within the Parish as designated by the Purchasing Department.

JEFFERSON PARISH reserves the right to cancel all or any part of an order if not shipped promptly. No charges will be allowed for parking or cartage unless specified in quotation. The order must not be filled at a higher price than quoted. JEFFERSON PARISH reserves the right to cancel at any time and for any reason by issuing a THIRTY (30) day written notice to the contractor.

JEFFERSON PARISH is expecting all products to be new and all work is to be done in a workman-like manner, according to standard practices. Any deviations or alterations from the specifications must be indicated and backup documentation supplied with your quotation.

DELIVERY: FOB JEFFERSON PARISH

INDICATE DELIVERY DATE ON EQUIPMENT AND SUPPLIES

7-9 DAYS

INDICATE STARTING TIME (IN DAYS) FOR CONSTRUCTION WORK

INDICATE COMPLETION TIME (IN DAYS) FOR CONSTRUCTION WORK

In the event that addenda are issued with this bid, bidders MUST acknowledge all addenda on the bid form. Bidder must acknowledge receipt of an addendum on the bid form as indicated. Failure to acknowledge any addendum on the bid form will result in bid rejection.

Acknowledge Receipt of Addenda: NUMBER: _____

NUMBER: _____

NUMBER: _____

NUMBER: _____

LOUISIANA CONTRACTOR'S LICENSE NO.: (if applicable) _____

*** ALL BIDDERS MUST COMPLETE SECTION BELOW ***	
FIRM NAME: <u>Cinco</u>	
SIGNATURE: (Must be signed here)	TITLE: <u>Sales</u>
PRINT OR TYPE NAME: <u>Jeff Deunier</u>	
ADDRESS: <u>1840 LTA Rd</u>	
CITY, STATE: <u>Metairie, LA</u>	ZIP: <u>70001</u>
TELEPHONE: <u>504 835 7319</u>	FAX: <u>504 832 0820</u>
EMAIL ADDRESS: <u>Jeff@Cinco.com</u>	

TOTAL PRICE OF ALL BID ITEMS: \$ 34152.84

DATE: 1/10/2017

INVITATION TO BID FROM JEFFERSON PARISH - continued

Page: 5

BID NO.: 50-00118641

SEALED BID

ITEM NUMBER	QUANTITY	U/M	DESCRIPTION OF ARTICLES	UNIT PRICE QUOTED	TOTALS
			STOCK SUPPLIES FOR THE JEFFERSON PARISH PUBLIC WORKS CENTRAL WAREHOUSE		
1	3.00	EA	0010 REDUCER, CONCENTRIC, 6 IN X 3 IN, DUCTILE IRON, FLANGED, FUSION EPOXY COATED, WITHOUT ACCESSORIES, MUST HAVE AWWA, ASTM, OR ANSI APPROVAL AND WRITTEN PROOF OF ISO9001 CERTIFICATION SK# 00-0091020	75 ⁰⁰	225 ⁰⁰
2	16.00	EA	0020 SADDLE, DOUBLE STRAP, 4 INCH X 3/4 INCH CC TAP, 8 INCH WIDTH, 2 INCH WIDE STRAPS, ALL STAINLESS STEEL, O.D. RANGE 04.36 - 05.66, DOMESTIC, POWERSEAL #3422AS CS22-0566-0100 SK# 00-0160400	70 ⁰⁰	1120 ⁰⁰
3	6.00	EA	0030 SADDLE, DOUBLE STRAP, 12 INCH X 3/4 INCH CC TAP, 8 INCH WIDTH, 2 INCH STRAPS, ALL 304 STAINLESS, GRADE 30 GASKET, O.D. RANGE 13.14 - 14.44, DOMESTIC, CASCADE #CS22-1444-3/4CC SK# 00-0162100	82 ⁰⁰	492 ⁰⁰
4	36.00	EA	0040 CLAMP, 3 INCH X 12 INCH LONG, ALL STAINLESS, 3.70 - 3.95 RANGE, FULL GASKET, DOMESTIC, POWERSEAL #3121AS-3X12 SK# 00-0164550 CR1 01-0400-12	82 ⁰⁰	2952 ⁰⁰
5	60.00	EA	0060 CLAMP, 6 INCH X 15 INCH LONG, ALL STAINLESS, 6.84 - 7.24 RANGE, SINGLE BAND, FULL GASKET, DOMESTIC, FORD #FS1-724X15 SK# 00-0165100	79 ⁰⁰	4740 ⁰⁰
6	18.00	EA	0070 CLAMP, PIPE REPAIR, 8 INCH X 16 INCH LONG, SINGLE BAND, ALL STAINLESS STEEL, O.D. RANGE 09.40 - 09.80, FULL FACED GASKET, DOMESTIC, CASCADE #CR1-0980-16 SK# 00-0165900	156 ⁰⁰	2808 ⁰⁰
7	10.00	EA	0080 CLAMP, PIPE REPAIR, 12 INCH X 20 INCH LONG, SINGLE BAND, ALL STAINLESS STEEL INCLUDING BOLTS/NUTS, O.D. RANGE 13.10 - 13.50, SBR FULL FACED GASKET, DOMESTIC, CASCADE #CR1-1320-20 SK# 00-0166600	295 ⁰⁰	2950 ⁰⁰
8	6.00	EA	0090 CLAMP, PIPE REPAIR, 12 INCH X 20 INCH LONG, SINGLE BAND, ALL STAINLESS	312 ⁰⁰	1872 ⁰⁰

DATE: 1/10/2017

INVITATION TO BID FROM JEFFERSON PARISH - continued

Page: 6

BID NO.: 50-00118641

SEALED BID

ITEM NUMBER	QUANTITY	U/M	DESCRIPTION OF ARTICLES	UNIT PRICE QUOTED	TOTALS
9	6.00	EA	STEEL INCLUDING BOLTS/NUTS, O.D. RANGE 14.00 - 14.40, FULL FACED GASKET, DOMESTIC, CASCADE #CR1-1400-20 SK# 00-0166620	2300 ⁰⁰	13800 ⁰⁰
10	6.00	EA	0100 CLAMP, 24 IN X 24 IN LONG, ALL STAINLESS, 29.50 - 30.30 RANGE, DOUBLE BAND, FULL GASKET, DOMESTIC, POWERSEAL #3122AS SK# 00-0168460 <i>CR303-3082-24</i>	N/A	N/A
11	12.00	EA	0110 CLAMP, SINGLE BAND, 6 IN X 3/4 CC TAP X 16 IN LONG, ALL STAINLESS, 7.25 - 7.65 RANGE, FULL GASKET, DOMESTIC, POWERSEAL #3131AS SK# 00-0170400	24.07	312.84
12	6.00	EA	0120 CLAMP, PATCH, 1 INCH X 8 INCH LONG, ALL STAINLESS, 1.12 - 1.32 O.D., TAPERED WAFFLE GASKET, FULL CIRCLE, DOMESTIC, POWERSEAL MODEL #3151AS SK# 00-0184500 <i>FORD FLSC-132-9</i>	N/A	N/A
13	2.00	EA	0130 EXTENSION KIT COMPLETE, 12 INCH LONG, FOR A 5-1/4 INCH AMERICAN DARLING #B-84-B TRAFFIC MODEL OPEN RIGHT HYDRANT MUST BE O.E.M. SK# 00-0350860	286 ⁰⁰	572 ⁰⁰
14	16.00	EA	0140 SPOOL, VALVE, 3 INCH X 60 INCH LONG, FLANGED X PLAIN END, PRIME COATED, CLASS 52 OR 53 DUCTILE IRON PIPE SK# 00-050051G	107 ⁰⁰	1712 ⁰⁰
15	3.00	EA	0150 SPOOL, VALVE, 6 INCH X 24 INCH LONG FLANGED X PLAIN END, PRIME COATED, CLASS 52 OR 53 DUCTILE IRON PIPE SK# 00-0500550	199 ⁰⁰	597 ⁰⁰
			0160 SPOOL, VALVE, 10 INCH X 24 INCH LONG, FLANGED X PLAIN END, PRIME COATED, CLASS 52 OR 53 DUCTILE IRON PIPE SK# 00-0500570		

FEATURES

- Widest Range Saddle Available
- Fits All Standard Diameters for Pipes in Nominal Sizes
- Full Hoop Support - Saddle Body Conforms to Pipe O.D.
- Certified ANSI/NSF-61

MATERIAL SPECIFICATIONS

Body T-304 Stainless Steel

Outlet T-304 Stainless Steel

Gasket Triple O-Ring surrounded by full grid matt — SBR, Patent 6,588,767B2



Fasteners T-304 Stainless Steel 5/8-11, NC Rolled Thread; Xylan Coated Heavy Hex Nut

One saddle fits all types of pipe (AC, PVC, DI, Steel, CI)

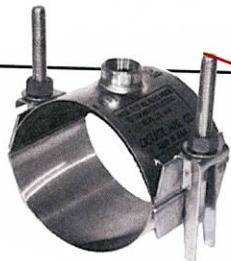

STYLE CS12 • 5" WIDE DOUBLE BAND SADDLE

3/4", 1", 1 1/4", 1 1/2" AND 2" C.C. OR I.P.

Nominal Pipe Size (inches)	O.D. Range (inches)	Catalog Number	Weight Each (lbs.)
4	4.36–5.66	CS12-0566-TAP	3.5
5	5.40–6.70	CS12-0670-TAP	3.7
6	6.43–7.73	CS12-0773-TAP	4.0
8	8.52–9.82	CS12-0982-TAP	4.4
10	10.65–11.95	CS12-1195-TAP	4.8
12	12.30–13.60	CS12-1360-TAP	5.0
	13.14–14.44	CS12-1444-TAP	

SHELL WIDTH 5"
MAXI-STRETCH
(RANGE - APPROX. 1.30")

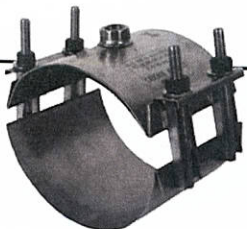

STYLE CS22 • 8" WIDE DOUBLE BAND SADDLE

3/4", 1", 1 1/4", 1 1/2" AND 2" C.C. OR I.P.

Nominal Pipe Size (inches)	O.D. Range (inches)	Catalog Number	Weight Each (lbs.)
4	4.36–5.66	CS22-0566-TAP	6.1
5	5.40–6.70	CS22-0670-TAP	6.6
6	6.43–7.73	CS22-0773-TAP	7.1
8	8.52–9.82	CS22-0982-TAP	8.0
10	10.65–11.95	CS22-1195-TAP	8.1
12	12.70–14.00	CS22-1400-TAP	9.1
	13.10–14.40	CS22-1440-TAP	
14	14.00–15.30	CS22-1530-TAP	9.6
	15.40–16.70	CS22-1670-TAP	
16	16.20–17.50	CS22-1750-TAP	10.6
	17.90–19.20	CS22-1920-TAP	
18	19.20–20.40	CS22-2040-TAP	11.0
20	21.50–22.80	CS22-2280-TAP	11.6
24	25.70–27.00	CS22-2700-TAP	12.6

SHELL WIDTH 8"
MAXI-STRETCH
(RANGE - APPROX. 1.30")

TO ORDER: Select desired catalog number and add tap size.

EXAMPLE: An 8" wide double band saddle for 6" pipe with a 2" iron pipe tap would be CS22-0773-2" IP.

NOTE: Other ranges and tap sizes available upon request.

STYLE CR1

SINGLE SECTION NORMAL RANGE



To Order: Determine desired range and length, then select corresponding catalog number.

Note: Other ranges and lengths not listed are available upon request. For higher pressures, clamp length should be equal to or in excess of pipe O.D.

Conductivity Strips available upon request.

Nominal Pipe Size (Inches)	Clamp O.D. Range (Inches)	Catalog Number	Approximate Shipping Weight (lbs.) per length							
			6"	8"	10"	12"	16"	20"	24"	30"
2	2.32-2.63	CR1 - 263 - Length	4	5	6	7	10	—	—	—
2 1/4	2.57-2.87	CR1 - 287 - Length	4	5	6	7	10	—	—	—
2 1/4-2 1/2	2.70-3.00	CR1 - 300 - Length	4	5	6	7	10	—	—	—
3	2.95-3.25	CR1 - 325 - Length	4	5	6	8	10	—	—	—
	3.40-3.70	CR1 - 370 - Length	4	6	7	9	12	—	—	—
3 & 4	3.71-4.00	CR1 - 400 - Length	—	6	7	9	12	—	—	—
4	4.45-4.75	CR1 - 475 - Length	—	7	8	10	13	17	—	—
	4.75-5.15	CR1 - 515 - Length	—	7	8	10	13	17	20	25
4 & 5	4.95-5.35	CR1 - 535 - Length	—	7	8	11	14	18	20	25
	5.20-5.60	CR1 - 560 - Length	—	7	8	11	14	18	20	26
	5.95-6.35	CR1 - 635 - Length	—	8	10	11	15	19	22	30
	6.55-6.95	CR1 - 695 - Length	—	8	10	11	15	19	23	30
6	6.84-7.24	CR1 - 724 - Length	—	9	11	12	16	20	24	32
	7.05-7.45	CR1 - 745 - Length	—	9	11	12	17	21	25	32
	7.45-7.85	CR1 - 785 - Length	—	9	11	13	18	22	26	34
	7.90-8.30	CR1 - 830 - Length	—	9	12	14	19	23	28	35
8	8.59-8.99	CR1 - 899 - Length	—	9	12	14	19	23	28	35
	9.00-9.40	CR1 - 940 - Length	—	10	13	14	20	24	29	37
	9.30-9.70	CR1 - 970 - Length	—	10	13	15	20	25	31	38
8 & 10	9.75-10.15	CR1 - 1015 - Length	—	11	13	16	21	27	32	40
	10.65-11.05	CR1 - 1105 - Length	—	11	14	17	22	28	34	42
	11.04-11.44	CR1 - 1144 - Length	—	12	14	17	22	29	36	44
10	11.35-11.75	CR1 - 1175 - Length	—	12	14	17	23	30	37	45
	11.75-12.15	CR1 - 1215 - Length	—	13	15	18	24	30	37	46
	11.95-12.35	CR1 - 1235 - Length	—	13	15	18	26	31	38	47
	12.65-13.05	CR1 - 1305 - Length	—	14	16	19	28	32	38	48
12	13.10-13.50	CR1 - 1350 - Length	—	15	17	20	28	32	38	48
	13.40-13.80	CR1 - 1380 - Length	—	15	18	21	29	33	39	48
	13.70-14.10	CR1 - 1410 - Length	—	16	18	21	29	33	39	48
12 & 14	14.00-14.40	CR1 - 1440 - Length	—	16	19	22	29	35	41	52
Number of Studs			2	2	3	3	4	5	6	8

STYLE CR3

THREE SECTION EXTENDED RANGE

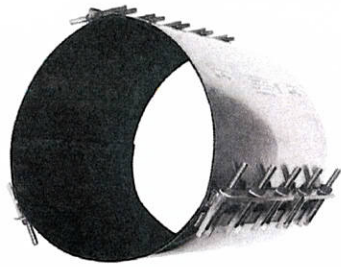

To Order: Determine desired range and length, then select corresponding catalog number.

Note: Other ranges and lengths not listed are available upon request. For higher pressures, clamp length should be equal to or in excess of pipe O.D.

Conductivity Strips available upon request.

Clamp O.D. Range (Inches)	Catalog Number	Approximate Shipping Weight (lbs.) per length					
		10"	12"	16"	20"	24"	30"
11.04-12.24	CR3 - 1224 - Length	26	31	41	53	61	82
13.14-14.34	CR3 - 1434 - Length	28	33	43	54	65	84
13.65-14.85	CR3 - 1485 - Length	29	34	44	55	66	86
14.85-16.05	CR3 - 1605 - Length	30	35	45	56	67	88
15.92-17.12	CR3 - 1712 - Length	32	37	47	58	70	94
17.15-18.35	CR3 - 1835 - Length	33	38	48	59	72	96
18.46-19.66	CR3 - 1966 - Length	34	39	49	62	75	98
19.45-20.65	CR3 - 2065 - Length	36	40	53	67	80	102
21.52-22.72	CR3 - 2272 - Length	—	42	63	72	84	107
23.28-24.48	CR3 - 2448 - Length	—	43	64	77	87	117
24.38-25.58	CR3 - 2558 - Length	—	45	65	78	92	120
25.70-26.90	CR3 - 2690 - Length	—	47	66	80	95	123
26.48-27.68	CR3 - 2768 - Length	—	48	66	82	97	127
27.65-28.85	CR3 - 2885 - Length	—	50	67	85	102	130
28.73-29.93	CR3 - 2993 - Length	—	52	69	88	106	136
29.62-30.82	CR3 - 3082 - Length	—	51	70	78	108	138
31.22-32.42	CR3 - 3242 - Length	—	54	71	90	110	140
Number of Studs		9	9	12	15	18	24

STYLE CRT & CDRT

TAPPED REPAIR CLAMPS

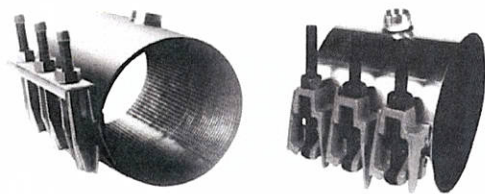

All CR1, CR2, CR2-SR, CR3, and CDR1, CDR2, and CDR3 repair clamps are available with tapped outlets. Outlets are T304 stainless steel permanently bonded to the clamp by Heliarc welding and fully passivated.

To Order:

Select size, length and style of clamp. Select type and size of thread for outlet. Add list price for outlet to list price for clamp. Insert the letter "T" into the catalog number and indicate tap size and type style at the end. Consult catalog or factory for specification or application information.

Example:

A single band clamp for 6" D.I.P. - 12" long with a 3/4" CC Outlet = CRT1-724-12-3/4CC

Tap Size Available	Type of Threads Available
3/4"	IP or CC
1"	IP or CC
1 1/4"	IP or CC
1 1/2"	IP or CC
2"	IP or CC
2 1/2"	IP only
3"	IP only

SUBMITTAL INFORMATION

Repair Clamps - (FS1-xxx-Length style)

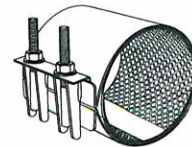

6" AND 8" ALL STAINLESS STEEL CIRCLE REPAIR CLAMPS

Optional Stainless Taps

ASTM A240 type 304 stainless steel tig welded to band. Available with AWWA or I.P. threads.

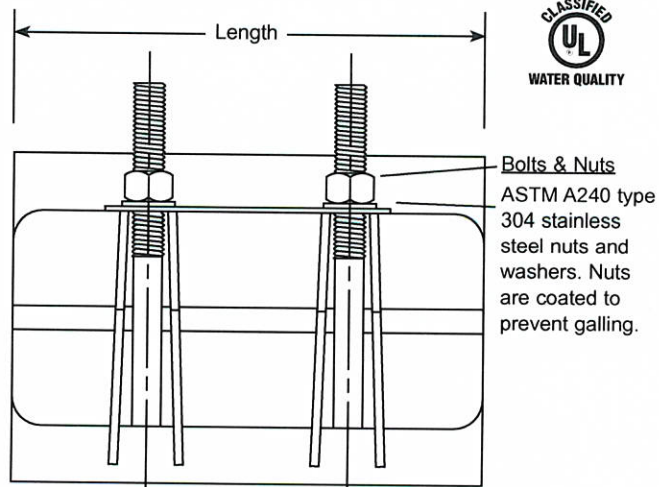
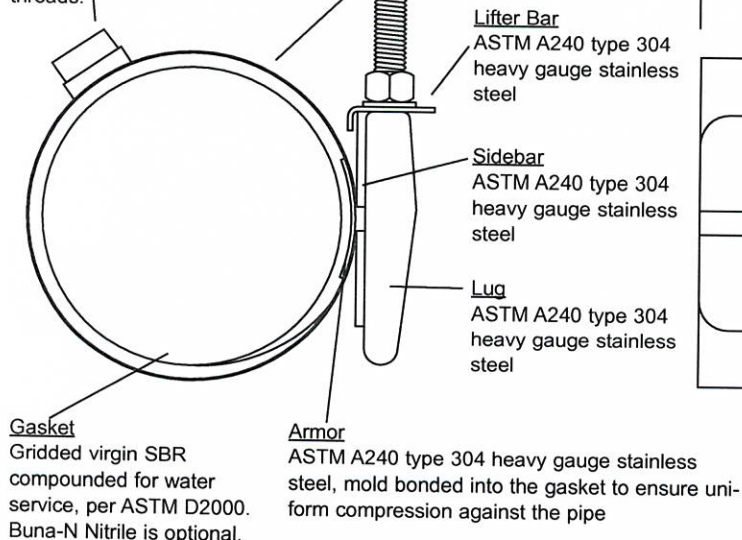

OUTLET THREAD TAP CODE

CC (AWWA) THREAD		IP THREAD	
THREAD	CODE NUMBER	THREAD	CODE NO.
3/4" CC	-CC3	3/4" IP	-IP3
1" CC	-CC4	1" IP	-IP4
1-1/4" CC	-CC5	1-1/4" IP	-IP5
1-1/2" CC	-CC6	1-1/2" IP	-IP6
2" CC	-CC7	2" IP	-IP7

Note: Tapped clamps are non-returnable

NOM. PIPE SIZE	PIPE O.D. RANGE	LENGTH AND APPROXIMATE WEIGHT (LBS.)								BOLT SIZE	BAND THICKNESS	CATALOG NUMBER FS1-xxx-LENGTH	✓ SUBMITTED ITEM(S)
		7.5"	10"	12.5"	15"	20"	24"	30"	36"				
6"	5.95 - 6.35	7	9	10	14	17	21	27	34	5/8" 11 UNC	20 GA.	FS1-635-	
	6.56 - 6.96											FS1-696-	
	6.84 - 7.24											FS1-724-	
	7.05 - 7.45											FS1-745-	
	7.25 - 7.65											FS1-765-	
8"	7.45 - 7.85	8	10	11	15	19	24	30	39			FS1-785-	
	7.95 - 8.35											FS1-835-	
	8.54 - 8.94											FS1-894-	
	8.99 - 9.39											FS1-939-	
	9.27 - 9.67											FS1-967-	
Number of Bolts		2	3	3	4	6	7	9	10				

FEATURES

- Buna-N gasket and conductivity strips are available
- Also available in two-and three-section clamps for a wider range of pipe sizes and tolerances
- Optional outlet taps are available for repair of service line pull-outs. Add tapping code to catalog number
- All welds are fully passivated to restore corrosion resistant characteristics of stainless steel
- UL classified to ANSI/NSF Standard 61

The Ford Meter Box Company considers the information in this submittal form to be correct at the time of publication. Item and option availability, including specifications, are subject to change without notice. Please verify that your product information is current.



The Ford Meter Box Company, Inc.
P.O. Box 443, Wabash, Indiana U.S.A. 46992-0443
Phone: 260-563-3171 / Fax: 800-826-3487
Overseas Fax: 260-563-0167
www.fordmeterbox.com

05/12/14

Submitted By:

SUBMITTAL INFORMATION

Snap Clamps - (FLSC-xxx-x style)



ALL STAINLESS STEEL REPAIR CLAMPS FOR SMALL LEAKS

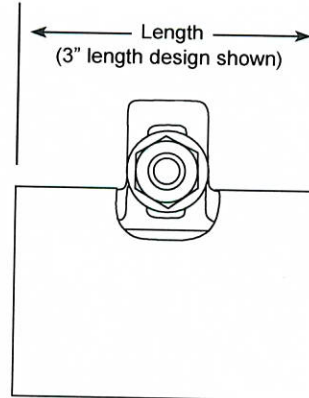
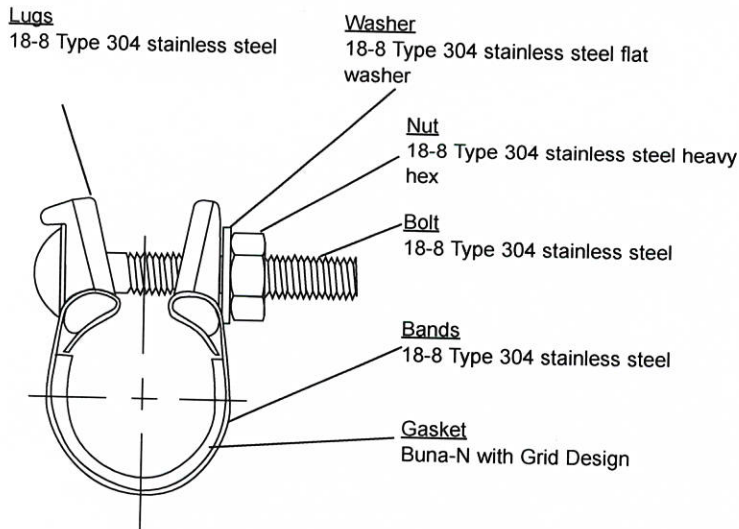

NOM. PIPE SIZE	PIPE O.D. RANGE	LENGTH AND APPROXIMATE WEIGHT (LBS.)				BOLT SIZE	CATALOG NUMBER FLSC-xxx-LENGTH*	✓ SUBMITTED ITEM(S)
		3"	6"	9"	12"			
1/2"	0.08	0.6	1.21	-	-	3/8"x3-1/2"	FLSC-084-	
3/4"	1.05	0.65	1.28	1.91	-		FLSC-105-	
1"	1.32	0.66	1.31	2.0	-		FLSC-132-	
1-1/4"	1.66	0.73	1.42	2.15	-		FLSC-166-	
1-1/2"	1.90	0.74	1.44	2.75	2.86		FLSC-190-	
2"	2.38	1.0	2.0	3.2	4.0	7/16"x4"	FLSC-238-	
2-1/2"	2.88	1.0	2.2	3.3	4.2		FLSC-288-	
3"	3.50	1.4	2.6	4.0	5.2		FLSC-350-	
3-1/2"	4.00	1.4	2.7	4.2	5.4		FLSC-400-	
4"	4.50	1.4	2.8	4.2	5.6		FLSC-450-	
5"	5.56	1.6	3.0	4.8	6.4		FLSC-556-	
6"	6.00	1.9	3.5	5.0	6.7		FLSC-600-	
	6.63	2.2	3.7	5.6	7.4		FLSC-663-	
8"	8.00	2.2	4.4	6.6	8.0		FLSC-800-	
	8.63	2.5	4.9	6.9	8.8		FLSC-863-	
Number of Bolts		1	2	3	4			

*Add length option (3, 6, 9, or 12) to complete catalog number. Example: FLSC-084-3

FEATURES

- Drop-in bolt design allows bolts to remain attached - no loose parts to lose in the ditch
- Gaskets are heavy-grid design and extend lug to lug (3.50" and 4.50" gasket do not extend lug to lug)

The Ford Meter Box Company considers the information in this submittal form to be correct at the time of publication. Item and option availability, including specifications, are subject to change without notice. Please verify that your product information is current.



The Ford Meter Box Company, Inc.
P.O. Box 443, Wabash, Indiana U.S.A. 46992-0443
Phone: 260-563-3171 / Fax: 800-826-3487
Overseas Fax: 260-563-0167
<http://www.fordmeterbox.com>

03/09/12

Submitted By:

FABRICATED FLANGE PIPES

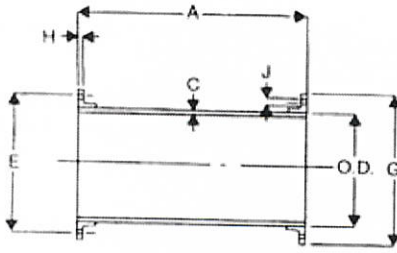

FLG. x FLG.

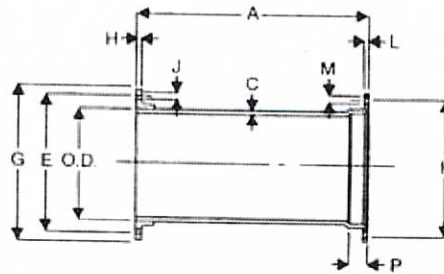

FLG. x M.J.

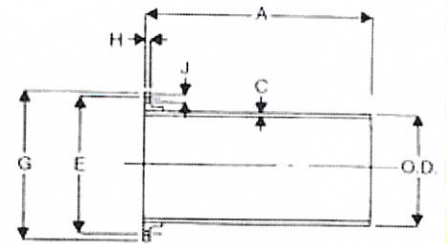

FLG. x P.E.

Cement Lined Prime Coated

SIZE	A	B	C	O.D.		E	G	H		NO. OF FLG'D BOLT HOLES	J	K		L		NO. OF M.J. BOLT HOLES	M		P
				MIN.	MAX.			MIN.	MAX.			MIN.	MAX.	MIN.	MAX.		MIN.	MAX.	
3	•	•	0.31	3.90	4.02	6.00	7.50	0.63	0.87	4	0.75	6.13	6.25	0.88	0.94	4	0.75	0.81	2.50
4	A	A	0.32	4.74	4.86	7.50	9.00	0.82	1.06	8	0.75	7.44	7.56	0.94	1.00	4	0.875	0.935	2.50
6	S	S	0.34	6.84	6.96	9.50	11.00	0.88	1.12	8	0.875	9.44	9.56	1.00	1.06	6	0.875	0.935	2.50
8	•	•	0.36	8.99	9.11	11.75	13.50	1.00	1.24	8	0.875	11.69	11.81	1.04	1.12	6	0.875	0.935	2.50
10	•	•	0.38	11.04	11.16	14.25	16.00	1.07	1.31	12	1.00	13.94	14.06	1.11	1.19	8	0.875	0.935	2.50
12	R	R	0.40	13.14	13.26	17.00	19.00	1.13	1.37	12	1.00	16.19	16.31	1.17	1.25	8	0.875	0.935	2.50
14	E	E	0.42	15.22	15.35	18.75	21.00	1.19	1.57	12	1.125	18.69	18.81	1.19	1.31	10	0.875	0.935	3.50
16	Q	Q	0.43	17.32	17.45	21.25	23.50	1.25	1.63	16	1.125	20.94	21.06	1.26	1.38	12	0.875	0.935	3.50
18	U	U	0.44	19.42	19.55	22.75	25.00	1.37	1.75	16	1.25	23.19	23.31	1.32	1.44	12	0.875	0.935	3.50
20	I	I	0.45	21.52	21.65	25.00	27.50	1.50	1.88	20	1.25	25.44	25.56	1.38	1.50	14	0.875	0.935	3.50
24	R	R	0.47	25.72	25.85	29.50	32.00	1.69	2.07	20	1.375	29.94	30.06	1.50	1.62	16	0.875	0.935	3.50
30	E	E	0.51	31.94	32.08	36.00	38.75	1.87	2.37	28	1.375	36.82	36.94	1.69	1.81	20	1.125	1.185	4.00
36	D	D	0.58	38.24	38.38	42.75	46.00	2.13	2.63	32	1.625	43.69	43.81	1.88	2.00	24	1.125	1.185	4.00
42	•	•	0.65	44.44	44.58	49.50	53.00	2.37	2.87	36	1.625	50.56	50.68	1.88	2.00	28	1.375	1.435	4.00
48	•	•	0.72	50.74	50.88	56.00	59.50	2.50	3.00	44	1.625	57.44	57.56	1.88	2.00	32	1.375	1.435	4.00
54	•	•	0.81	57.40	57.64	62.75	62.75	2.75	3.25	44	1.875	N/A	N/A	N/A	N/A	N/A	N/A	N/A	N/A
60	•	•	0.83	61.51	61.65	69.25	73.00	2.87	3.37	52	2.00	N/A	N/A	N/A	N/A	N/A	N/A	N/A	N/A
64	•	•	0.87	65.57	65.71	76.00	80.00	3.13	3.63	52	2.00	N/A	N/A	N/A	N/A	N/A	N/A	N/A	N/A

x 60"

x 24"

x 24"

1. Tolerance on length of FLG. x FLG. and FLG. x M.J. pipe shall be $\pm 0.125"$.
2. Tolerance on length of FLG. x P.E. shall be $\pm 0.25"$.
3. Above material shall meet all applicable sections of ANSI A21.10, A21.15, A21.51, B2.1, B16.1/ AWWA, C110, C115, C150, C151, and all revisions thereto.
4. Flanged pipe shall be ductile iron pipe with ductile iron flanges threaded on.
5. Flange pipe is provided with cement lining per AWWA C204/A21.4. If other linings are required, contact your local sales representative.
6. The mechanical joint bell for 30" & 36" sizes of ductile iron pipe have thicknesses different from those shown in ANSI A21.11, which are based on gray iron pipe. These reduced thicknesses provide a lighter-weight bell which is compatible with the wall thickness of ductile iron pipe.
7. Submitted material only. Consult engineer for application.
8. 250 lb. faced and drilled flanges available upon request.

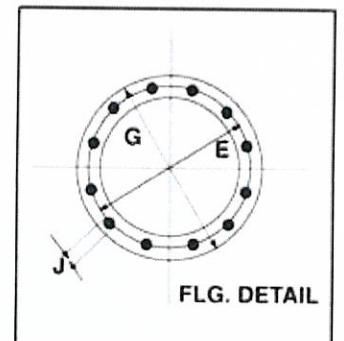

FLG. DETAIL

U.S. PIPE FABRICATION, LLC

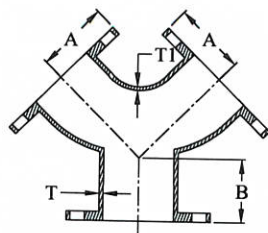

TRUE WYES*

SIZE	A	B	T	T1	Wt.
4 X 4 X 4	6.50	3.00	0.52	0.52	50
6 X 4 X 4	8.00	3.50	0.55	0.52	75
6 X 6 X 6	8.00	3.50	0.55	0.55	80
8 X 6 X 6	9.00	4.50	0.60	0.55	120
8 X 8 X 8	9.00	4.50	0.60	0.60	125

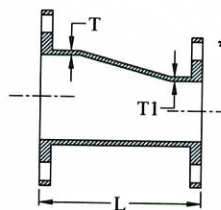
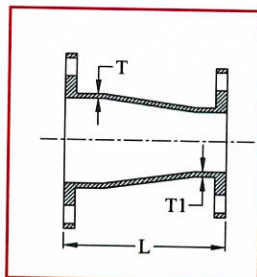

FBE Coated

REDUCERS

SIZE	L	T	T1	Wt.
*3 X 2	6.00	0.48	0.31	16
*4 X 2	7.00	0.52	0.31	25
4 X 3	7.00	0.52	0.48	30
*6 X 2	7.00	0.55	0.31	35
6 X 3	9.00	0.55	0.48	40
6 X 4	9.00	0.55	0.52	45
*6 X 5	9.00	0.55	0.52	52
*8 X 3	11.00	0.60	0.48	60
8 X 4	11.00	0.60	0.52	65
*8 X 5	11.00	0.60	0.52	70
8 X 6	11.00	0.60	0.55	75
10X 4	12.00	0.68	0.52	85
10X 6	12.00	0.68	0.55	90
10X 8	12.00	0.68	0.60	110
12X 4	14.00	0.75	0.52	120
12X 6	14.00	0.75	0.55	130
12X 8	14.00	0.75	0.60	145
12X10	14.00	0.75	0.68	170
14X 6	16.00	0.66	0.55	155
14X 8	16.00	0.66	0.60	175
14X10	16.00	0.66	0.68	190
14X12	16.00	0.66	0.75	220
16X 6	18.00	0.70	0.55	190
16X 8	18.00	0.70	0.60	210
16X10	18.00	0.70	0.68	235
16X12	18.00	0.70	0.75	265
16X14	18.00	0.70	0.66	280
18X 8	19.00	0.75	0.60	240
18X10	19.00	0.75	0.68	265
18X12	19.00	0.75	0.75	295
18X14	19.00	0.75	0.66	310

SIZE	L	T	T1	Wt.
18X16	19.00	0.75	0.70	340
20X10	20.00	0.80	0.68	310
20X12	20.00	0.80	0.75	345
20X14	20.00	0.80	0.66	355
20X16	20.00	0.80	0.70	390
20X18	20.00	0.80	0.75	410
24X12	24.00	0.80	0.75	480
24X14	24.00	0.89	0.66	490
24X16	24.00	0.89	0.70	525
24X18	24.00	0.89	0.75	550
24X20	24.00	0.89	0.80	590
*30X12	30.00	1.03	0.75	825
*30X16	30.00	1.03	0.70	770
30X18	30.00	1.03	0.75	810
30X20	30.00	1.03	0.80	870
30X24	30.00	1.03	0.89	970
*36X16	36.00	1.15	0.79	1105
36X20	36.00	1.15	0.80	1230
36X24	36.00	1.15	0.89	1345
36X30	36.00	1.15	1.03	1555
*42X20	42.00	1.28	0.80	1712
42X24	42.00	1.28	0.89	1820
42X30	42.00	1.28	1.03	2060
42X36	42.00	1.28	1.15	2345
48X30	48.00	1.42	1.03	2625
48X36	48.00	1.42	1.15	2950
48X42	48.00	1.42	1.28	3320
*54X30	32.00	0.90	0.61	1625
*54X36	28.00	0.90	0.66	1680
*54X42	25.00	0.90	0.76	1800
*54X48	18.00	0.90	0.80	1695

All Dimensions in Inches.

Weights shown are approximate in lbs.

* Not included in AWWA C110.