

DATE: 4/29/2021
BID NO.: 50-00134452

INVITATION TO BID
THIS IS NOT AN ORDER

Page: 5

JEFFERSON PARISH

PURCHASING DEPARTMENT
P.O. BOX 9
GRETNA, LA. 70054-0009
504-364-2678

VENDOR:

BUYER: DABRAHAM

As per LSA-RS 47:301 et seq., all governmental bodies are excluded from payment of sales taxes to any Louisiana taxing body. Quotations shall be based on F.O.B. Agency warehouse or jobsite, anywhere within the Parish as designated by the Purchasing Department.

JEFFERSON PARISH reserves the right to cancel all or any part of an order if not shipped promptly. No charges will be allowed for parking or cartage unless specified in quotation. The order must not be filled at a higher price than quoted. JEFFERSON PARISH reserves the right to cancel at any time and for any reason by issuing a THIRTY (30) day written notice to the contractor.

JEFFERSON PARISH is expecting all products to be new and all work to be done in workman-like manner, according to standard practices. Any deviations or alteration from the specifications must be indicated on the bid form for each item and upon request, product data for same must be submitted by the time specified by the Purchasing Department.

DELIVERY: FOB JEFFERSON PARISH

INDICATE DELIVERY DATE ON EQUIPMENT AND SUPPLIES 12 Weeks from Order

INDICATE STARTING TIME (IN DAYS) FOR CONSTRUCTION WORK _____

INDICATE COMPLETION TIME (IN DAYS) FOR CONSTRUCTION WORK _____

In the event that addenda are issued with this bid, bidders MUST acknowledge all addenda on the bid form. Bidder must acknowledge receipt of an addendum on the bid form by placing the addendum number as indicated. Failure to acknowledge any addendum on the bid form will result in bid rejection.

Acknowledge Receipt of Addenda: NUMBER: none

NUMBER: _____

NUMBER: _____

NUMBER: _____

LOUISIANA CONTRACTOR'S LICENSE NO.: (if applicable) _____

*** ALL BIDDERS MUST COMPLETE SECTION BELOW ***	
FIRM NAME: Tolar Manufacturing Company, Inc	
SIGNATURE: (Must be signed here)	TITLE: EVP
PRINT OR TYPE NAME: Patrick Merrick	
ADDRESS: 258 Mariah Circle	
CITY, STATE: Corona, CA	ZIP: 92879
TELEPHONE: (951) 808-0081	FAX: (951) 808-0041
EMAIL ADDRESS: pmerrick@tolarmfg.com	

TOTAL PRICE OF ALL BID ITEMS: \$ 6,575.00

DATE: 4/29/2021

Page: 6

INVITATION TO BID FROM JEFFERSON PARISH - continued

BID NO.: 50-00134452

SEALED BID

ITEM NUMBER	QUANTITY	U/M	DESCRIPTION OF ARTICLES	UNIT PRICE QUOTED	TOTALS
1	5.00	EA	A one time purchase of (5) benches for the Jefferson Parish Parks Department	\$ 1,035.00	\$ 5,175.00
			0010 - UltraSite Jackson Model #96-S6 6' Benches with backrest and vertical slat pattern. (see alternate) Color: Black	(12915-121)	
2	1.00	EA	Tolar Steel Strap Bench Model 12915-121 0020 - Freight **see attached drawing		\$ 1,400.00
			For: Elmwood Square Benches Requested by: Ethan Landry		
			Deliver to: JPRD Eastbank Warehouse 6925 Saints Dr. Metairie, LA 70003		

ZONE	REV	DESCRIPTION	DATE	APPROVED

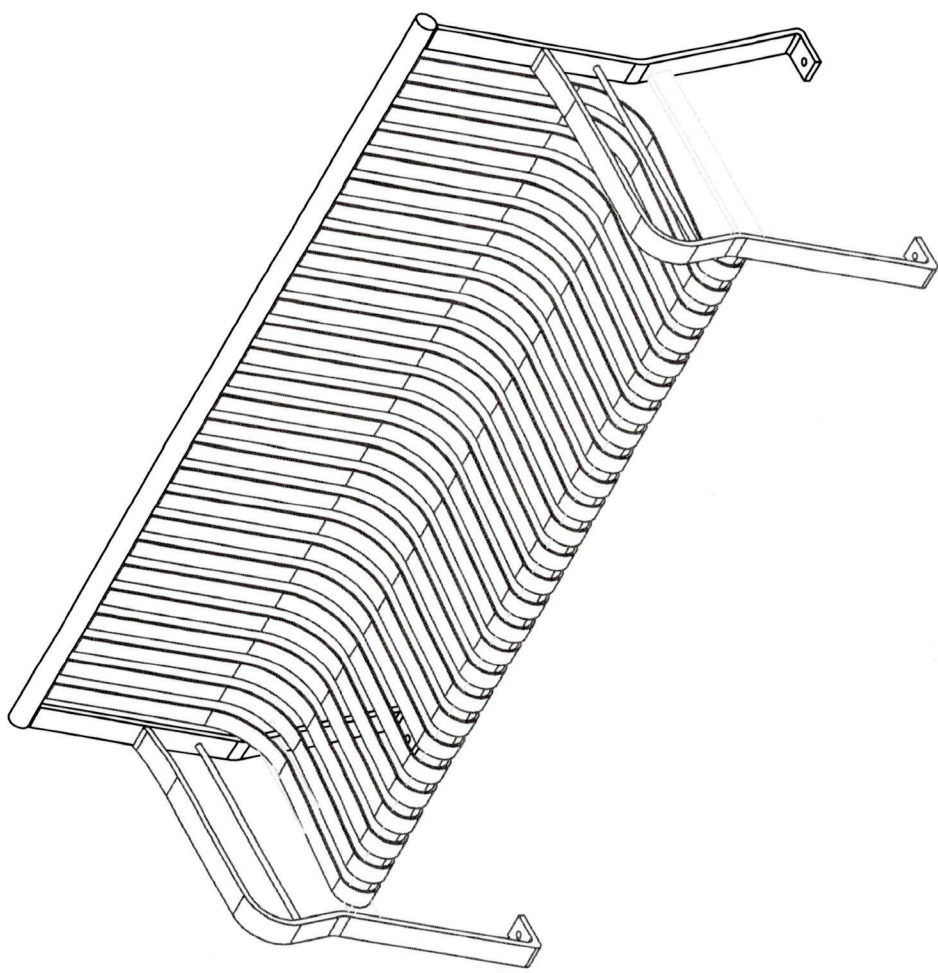

EXAMPLE: 1 2 9 1 5 - 1 1 1 1

DRAWING NUMBER CONFIGURATION A CONFIGURATION B CONFIGURATION C

CONFIGURATION A	
1	PLANT 1
2	PLANT 2

CONFIGURATION B - ANCHORS	
0	NO ANCHORS
1	1/2" X 3 3/4" SUP-R ANCHORS, ZINC
2	1/2" X 3 3/4" SUP-R ANCHORS, STN STL
3	1/2" X 4 1/4" SUP-R ANCHORS, ZINC
4	1/2" X 4 1/4" SUP-R ANCHORS, STN STL
5	1/2" X 3 3/4" HILTI TZ ANCHORS, ZINC
6	1/2" X 3 3/4" HILTI TZ ANCHORS, STN STL
7	1/2" X 4 1/2" HILTI TZ ANCHORS, ZINC
8	1/2" X 4 1/2" HILTI TZ ANCHORS, STN STL
9	SPECIAL - SPECIFIED ON SALES ORDER

CONFIGURATION C - FINISH	
0	NONE
1	STANDARD POWDER COAT
2	STANDARD POWDER COAT WITH CLEAR COAT
3	PREMIUM POWDER COAT
4	PREMIUM POWDER COAT WITH CLEAR COAT
5	TBD
6	TBD
7	TBD
8	TBD
9	SPECIAL - SPECIFIED ON SALES ORDER

SHEET 1 OF 2

TOLAR
Tolar Manufacturing Company, Inc.
258 Marich Circle, Corona, CA 92879

DESCRIPTION: BENCH, 6" STRAP BACK W/NO VAGRANT

CUSTOMER/VENDOR: [Blank]

SIZE: [Blank] INCH

SCALE: [Blank]

DATE: 06/15/10

DESIGNER: [Blank]

DATE: 12/9/15

REV: [Blank]

DATE: [Blank]

DESIGNER: [Blank]

THIS DRAWING IS A DESIGN CONCEPT AND IS NOT TO BE USED FOR CONSTRUCTION. IT IS THE PROPERTY OF TOLAR MANUFACTURING COMPANY, INC. AND IS NOT TO BE REPRODUCED OR TRANSMITTED IN ANY FORM OR BY ANY MEANS, ELECTRONIC OR MECHANICAL, WITHOUT PERMISSION IN WRITING FROM TOLAR MANUFACTURING COMPANY, INC.

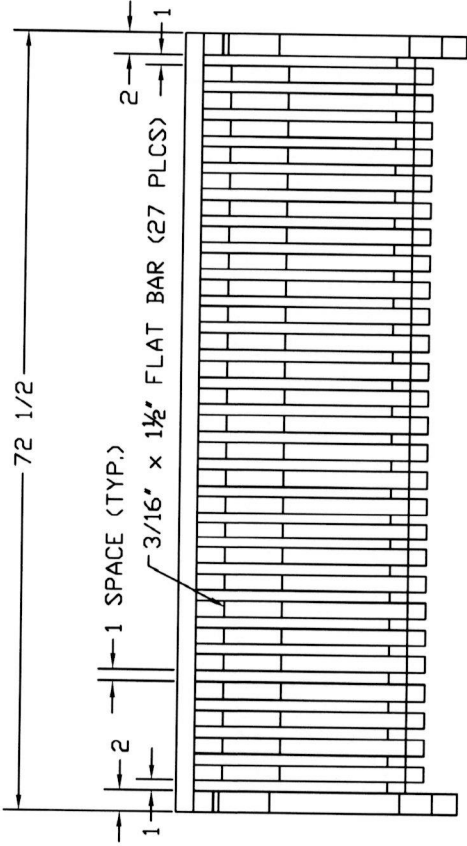

TOP VIEW

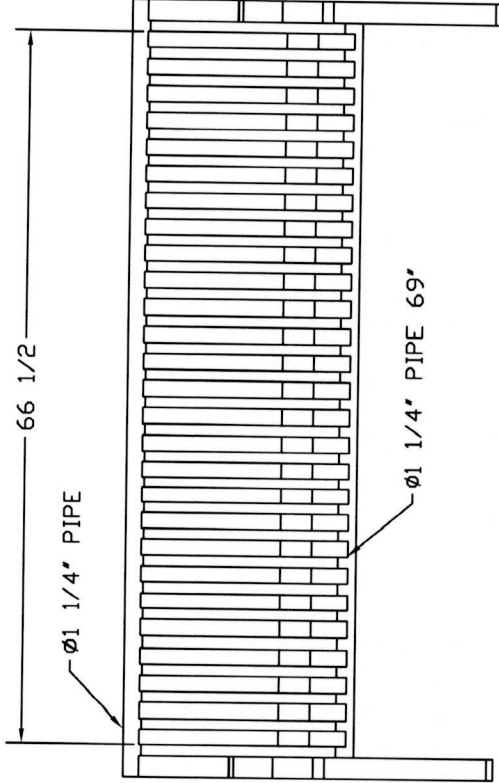
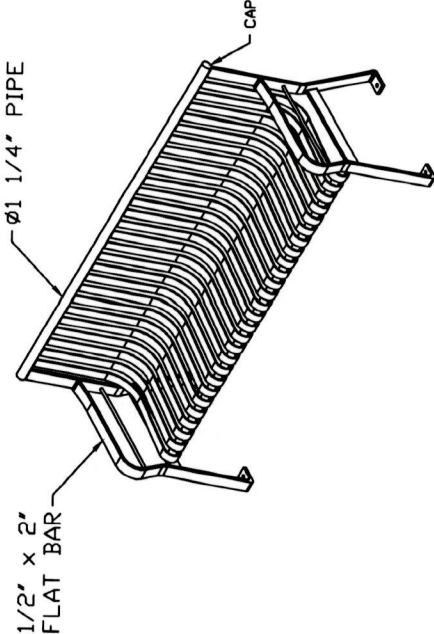

FRONT VIEW

REVISION
SEE DWG #2386-00

Ø1/2" ROUND ROD

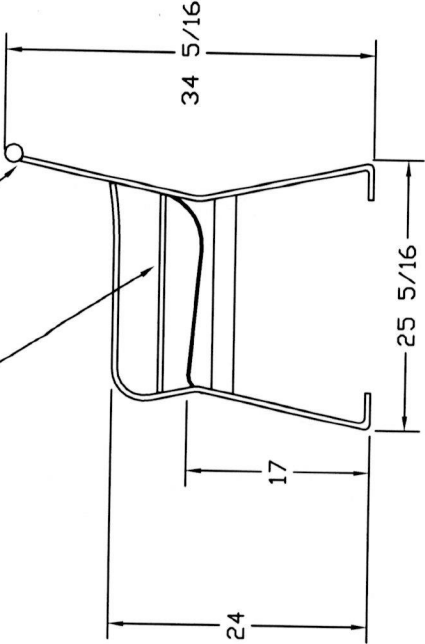

END VIEW

TOLAR		Tolar Manufacturing Company, Inc.	
258 Mariah Circle, Corona, CA 92879		258 Mariah Circle, Corona, CA 92879	
BENCH, 6' STRAP BACK W/NO VAGRANT		BENCH, 6' STRAP BACK W/NO VAGRANT	
DATE	06/15/10	REV	12915-00
SCALE	1" = 1'-0"	DATE	06/15/10
BY	EM	DATE	06/15/10

ZONE	REV	DATE	APPROVED