

Jefferson Parish, Louisiana

Wastequip Bid Response



Bid No.: 5000117153

Bid Title: 6 Cubic Yard Dumpsters

Bid Due: July 20, 2016 at 11:00 am



(Corporate Headquarters)

6525 Morrison Blvd., Suite 300

Charlotte, NC 28211

877.468.9278

www.wastequip.com

ORIGINAL

Table of Contents

Introduction and Company Information

Corporate Profile	
Wastequip Fact Sheet	

Bid Forms

Bid Documents	
Wastequip Quote.....	

Wastequip Supporting Documents

Wastequip Brochure	
Wastequip Container Warranty	

Wastequip Additional Information

Points of Contact.....	
Wastequip Evidence of Insurance	
Wastequip W-9	

WASTEQUIP®

Corporate Profile

Wastequip was founded in 1989 by Chuck Walton, with the mission of creating a national waste equipment manufacturing company. Walton acquired several privately owned companies to create a North American footprint of 40 locations by 2007. Over the next few years, many of the smaller, regional brands were consolidated under other Wastequip brands.



Since its formation, Wastequip has developed a reputation for superior quality waste handling and recycling equipment. With a strong history of manufacturing expertise and product innovation, Wastequip manufactures a full line of products, systems, and solutions for the collection and transportation of solid waste, recyclables, liquid waste, and organics. Based in Charlotte, N.C., Wastequip employs more than 1,500 associates with operations in the U.S., Canada, and Mexico.

Wastequip has locations throughout the U.S. and Canada, which allows us to serve our customer base on a local level while delivering economies of scale not possible with smaller manufacturers. This makes us uniquely able to manufacture product to local specifications while making our entire line of products readily available throughout North America. We have the product you need in stock, where you need it and available for fast delivery.

Our product line includes:

- **WASTEQUIP** brand compaction equipment to include stationary and self-contained compactors and vertical balers
- **WASTEQUIP** brand steel containers to include front load, rear load, side load and roll-off containers
- **ACCURATE** brand intermodal products
- **TOTER** brand plastic roll carts and containers
- **GALBREATH** brand hoists, container handlers and trailers
- **MOUNTAIN TARP** and **PIONEER** brand tarps and tarping systems
- **CUSCO** brand Industrial vacuum trucks and hydro excavators
- **GO TO PARTS** offers OEM and aftermarket parts

With extensive product knowledge and industry experience, the WASTEQUIP sales team focuses on developing relationships with customers to better understand their needs and requirements. WASTEQUIP has product specialists and a strong service group to support customers along with one of the best dealer networks in the industry for aftermarket installation and support.



Company Fact Sheet

- Since 1989, Wastequip® has cultivated a superior reputation for quality waste handling and recycling equipment. With a strong history of manufacturing expertise and product innovation, the company manufactures a full line of products, systems, and solutions for the collection and transportation of solid waste, recyclables, liquid waste, and organics.
- Based in Charlotte, N.C., Wastequip employs more than 1,600 associates across 32 locations, including operations in the U.S., Canada, and Mexico.
- The company is organized under four distinct operating divisions:

Mobile Division: Wastequip's Mobile Division's products are engineered to withstand the punishment of hauling waste, recyclables, and scrap. The division includes branded products such as Galbreath® hoists, container handlers, and trailers; Mountain Tarp™ and Pioneer™ tarping systems; and Cusco™ industrial vacuum trucks.

Plastics Division: The iconic Toter® brand is at the heart of Wastequip's Plastics Division. With a wide range of products including stationary waste containers, plastic dumpsters/containers, tilt trucks, and cart lifters, the brand is most known for "The World's Toughest Carts™" – two-wheeled carts used primarily for automated curbside waste, recycling, and organics collection.

Steel Division: Wastequip's Steel Division manufactures a wide range of front-load, roll-off, and rear-load containers, compactors, industrial balers, and self-dumping hoppers for all types of waste and recycling. The division also makes specialty containers for handling sludge, grease, and other tough waste, along with dewatering, vacuum, and intermodal containers.

Parts Division: Wastequip's Parts Division stocks genuine Galbreath, Wastequip, Cusco, and Accurate parts for hoists, compactors, containers, and more. The division offers the most comprehensive selection of aftermarket parts – with the convenience of online shopping, same-day shipping, and competitive pricing.

- In June 2012, Wastequip, LLC, was recapitalized with its majority interests purchased by Centerbridge Partners, L.P. Since this company-wide transition – which included naming of a new CEO, Martin "Marty" Bryant – Wastequip has thrived within its industry and among its competitors.

Leadership Team

Martin (Marty) Bryant
Chief Executive Officer

Vance Tabb
President, Steel Division

Henry Retamal
President, Plastics Division

John Defenbaugh
President, Mobile Division

Mark Taylor
President, Parts Division

Corporate Headquarters

6525 Morrison Boulevard, Suite 300
Charlotte, NC 28211
877.468.9278
sales@wastequip.com
www.wastequip.com





CENTRALBIDDING
FROM CENTRAL AUCTION HOUSE

5000117153 6 CUBIC YARD DUMPSTERS
Jefferson Parish Government

Project documents obtained from www.CentralBidding.com

12-Jul-2016 02:04:32 PM

DATE: 7/12/2016

INVITATION TO BID
THIS IS NOT AN ORDER

Page: 1

BID NO.: 50-00117153

JEFFERSON PARISH

PURCHASING DEPARTMENT
P.O. BOX 9
GRETN, LA. 70054-0009
504-364-2678

VENDOR: 27118 BLANK BID COPY VENDOR

BUYER: CGasper

Bids will be received until 11:00 AM, 7/20/2016 via fax: 504-364-2693 or via online at www.jeffparish.net

All bids submitted are subject to these instructions and general conditions and any special conditions and specifications contained herein, all of which are made part of this bid proposal reference. By submitting a bid, vendor agrees to comply with all provisions of Louisiana Law, as well be in compliance with the Jefferson Parish Code of Ordinances, Louisiana Code of Ethics, applicable Jefferson Parish ethical standards and Jefferson Parish Resolution No. 113646 and/or Resolution No. 113647. A copy of these resolutions may be obtained from the Office of the Parish Clerk, Suite 6700, Jefferson Parish General Government Building, 200 Derbigny Street, Gretna, LA 70053. You may also obtain a copy by visiting the Purchasing Department webpage at www.purchasing.jeffparish.net and clicking on On-line forms.

All vendors submitting bids must register as a Jefferson Parish vendor if not already yet registered. Bidders may be required to furnish current W-9 Forms and respective Tax Identification Numbers within 10 days after bid opening if such information is not on file or not up to date. Registration forms may be downloaded from www.purchasing.jeffparish.net and clicking on Vendor Information.

As per LSA-RS 47:301 et seq., all governmental bodies are excluded from payment of sales taxes to any Louisiana taxing body. Quotations shall be based on F.O.B. Delivered, anywhere within the Parish as designated by the Purchasing Department. JEFFERSON PARISH WILL ACCEPT ONE BID ONLY FROM EACH VENDOR. Items bid must meet specifications. JEFFERSON PARISH will accept one price for each item unless otherwise indicated. Two or more prices for one item will result in bid rejection. Bidders are required to complete, sign and return the bid form and/or complete and return the associated line item pricing forms as indicated. The price quoted for work shall be stated in figures. In the event there is a difference in unit prices and totals, the unit prices shall prevail.

JEFFERSON PARISH reserves the right to award contracts or place orders on a lump sum or individual item basis, or such combination, as shall in its judgment be in the best interest of JEFFERSON PARISH. Every contract or order shall be awarded to the LOWEST RESPONSIVE and RESPONSIBLE BIDDER, taking into consideration the CONFORMITY WITH THE SPECIFICATIONS and the DELIVERY AND/OR COMPLETION DATE

JEFFERSON PARISH reserves the right to cancel all or any part of an order if not shipped promptly. No charges will be allowed for parking or cartage unless specified in the quotation. The order must not be filled at a higher price than quoted. JEFFERSON PARISH reserves the right to cancel at any time and for any reason by issuing a THIRTY (30) day written notice to the contractor.

JEFFERSON PARISH requires all products to be new (current) and all work must be performed according to standard practices for the project. Unless otherwise specified, no aftermarket parts will be accepted. Unless otherwise specified, all workmanship and materials must have at least one (1) year guaranty, in writing, from the date of delivery and/or acceptance of the project. Any deviations or alterations from the specifications must be indicated and/or supporting documentation supplied with bid submission.

If this bid requires a pre-bid conference (see Additional Requirements section), bidders are advised that such conference will be held to allow bidders the opportunity to identify any discrepancies in the bid specifications and seek further clarification regarding instructions. The Purchasing Department will issue a written response to bidders' questions in the form of an Addendum.

All formal Addenda require written acknowledgment on the bid form by the bidder. Failure to acknowledge an Addendum on the bid form shall cause the bid to be rejected; JEFFERSON PARISH reserves the right to award bid to next lowest responsive and responsible bidder in this event.

USE OF BRAND NAMES AND STOCK NUMBERS: Where brand names and stock numbers are specified, it is for the purpose of establishing certain minimum standards of quality. Bids may be submitted for products of equal quality, provided brand names and stock numbers are specified. Complete product data may be required prior to award.

Quantities listed are for bidding purposes only. Actual requirements may be more or less than quantities listed.

Bidders are not to exclude from participation in, deny the benefits of, or subject to discrimination under any program or activity, any person in the United States on the grounds of race, color, national origin, or sex; nor discriminate on the basis of age under the Age Discrimination Act of 1975, or with respect to an otherwise qualified handicapped individual as provided in Section 504 of the Rehabilitation Act of 1973, or on the basis of religion, except that any exemption from such prohibition against discrimination on the basis of religion as provided in the Civil Rights Act of 1964, or Title VI and VII of the Act of April 11, 1968, shall also apply. This assurance includes compliance with the administrative requirements of the Revenue Sharing final handicapped discrimination provisions contained in Section 51.55 (c), (d), (e), and (k)(5) of the Regulations. New construction or renovation projects must comply with Section 504 of the 1973 Rehabilitation Act, as amended, in accordance with the American National Standard Institute's specifications (ANSI A117.1-1991).

INSTRUCTIONS FOR BIDDERS AND GENERAL CONDITIONS**IN ACCORDANCE WITH STATE REGULATIONS JEFFERSON PARISH OFFERS ELECTRONIC PROCUREMENT TO ALL VENDORS**

This electronic procurement system allows vendors the convenience of reviewing and submitting bids online. This is a secure site and authorized personnel have limited read access only. Bidders are encouraged to submit electronically using this free serve; while the website accepts various file types, one single PDF file containing all appropriate and required bid documents is preferred. Bidders submitting uploaded images of bid responses are solely responsible for clarity. If uploaded images/documents are not legible, then bidder's submission will be rejected. Please note all requirements contained in this bid package for electronic bid submission.

ADDITIONAL REQUIREMENTS FOR THIS BID

PLEASE MATCH THE NUMBERS PRINTED IN THIS BOX WITH THE
CORRESPONDING INSTRUCTIONS BELOW.

10,13

1. All bidders must attend the MANDATORY pre-bid conference and will be required to sign in and out as evidence of attendance. In accordance with LSA R.S. 38:2212(I), all prospective bidders shall be present at the beginning of the MANDATORY pre-bid conference and shall remain in attendance for the duration of the conference. Any prospective bidder who fails to attend the conference or remain for the duration shall be prohibited from submitting a bid for the project.
2. Attendance to this pre-bid conference is optional. However, failure to attend the pre-bid conference shall not relieve the bidder of responsibility for information discussed at the conference. Furthermore, failure to attend the pre-bid conference and inspection does not relieve the successful bidder from the necessity of furnishing materials or performing any work that may be required to complete the work in accordance with the specification with no additional cost to the owner.
3. Contractor must hold current applicable JEFFERSON PARISH licenses with the Department of Inspection and Code Enforcement. Contractor shall obtain any and all permits required by the JEFFERSON PARISH Department of Inspection and Code Enforcement. The contractor shall be responsible for the payment of these permits. All permits must be obtained prior to the start of the project. Contractor must also hold any and all applicable Federal and State licenses. Contractor shall be responsible for the payment of these permits and shall obtain them prior to the start of the project.
4. A LA State Contractor's License will be required in accordance with LSA R.S. 37-2150 et. seq. and such license number will be shown on the outside of the bid envelope. Failure to comply will cause the bid to be rejected. Additionally if submitting the bid electronically, then the license number must be entered in the appropriate field in the Electronic Procurement system. Failure to comply will cause the bid to be rejected.
5. It is the bidder's responsibility to visit the job site and evaluate the job before submitting a bid.
6. Job site must be clean and free of all litter and debris daily and upon completion of the contract. Passageways must be kept clean and free of material, equipment, and debris at all times. Flammable material must be removed from the job site daily because storage will not be permitted on the premises. Precautions must be exercised at all times to safeguard the welfare of JEFFERSON PARISH and the general public.

INSTRUCTIONS FOR BIDDERS AND GENERAL CONDITIONS

7. **PUBLIC WORKS BIDS:** All awards for public works in excess of \$5,000.00 will be reduced to a formal contract which shall be recorded at the contractor's expense with the Clerk of Court and Ex-Officio Recorder of Mortgages for the Parish of Jefferson. A price list of recordation costs may be obtained from the Clerk of Court and Ex-Officio Recorder of Mortgages for the Parish of Jefferson. All awards in excess of \$25,000.00 will require both a performance and a payment bond. Unless otherwise stated in the bid specifications, the performance bond requirements shall be 100% of the contract price. Unless otherwise state in the bid specifications, the payment bond requirements shall be 100% of the contract price. Both bonds shall be supplied at the signing of the contract.
8. **NON-PUBLIC WORKS BIDS:** A performance bond will be required for this bid. The amount of the bond will be 100% of the contract price unless otherwise indicated in the specifications. The performance bond shall be supplied at the signing of the contract.
9. **NON-PUBLIC WORKS BIDS:** A payment bond will be required for this bid. The amount of the bond will be 100% of the contract price unless otherwise indicated in the specifications. The payment bond shall be supplied at the signing of the contract.
10. Unless otherwise stated in the bid specifications, the successful bidder will be required to procure standard insurance policies evidencing Parish-mandated insurance requirements as indicated on the attached sheet. The current certificate of insurance must be submitted by low bidder within 10 days after bid opening to the Purchasing Department. Failure to comply will cause bid to be rejected. JEFFERSON PARISH reserves the right to award bid to the next lowest responsive and responsible bidder in this event.
11. A bid bond will be required with bid submission in the amount of 5% of the total bid, unless otherwise stated in the bid specifications. Acceptable forms shall be limited to cashier's check, certified check, or surety bid bond. All sureties must be in original format (no copies). If submitting a bid online, vendors must submit an electronic bid bond through the respective online clearinghouse bond management system(s) as indicated in the electronic bid solicitation on Central Auction House. No scanned paper copies of any bid bond will be accepted as part of the electronic bid submission.
12. This is a requirements contract to be provided on an as needed basis. JEFFERSON PARISH makes no representations on warranties with regard to minimum guaranteed quantities unless otherwise stated in the bid specifications.
13. Freight charges should be included in total cost when quoting. If not quoted FOB DELIVERED, freight must be quoted as a separate item. Bid may be rejected if not quoted FOB DELIVERED or if freight charges are not indicated on bid form.
14. **PUBLIC WORKS BIDS - Completed, Signed and Properly Notarized Affidavits (in Original Format) required;** Non-Conviction Affidavit, Non-Collusion Affidavit, Campaign Contribution Affidavit and E-Verify Affidavit must be completed, signed, notarized and submitted by low bidder within 10 days after bid opening to the Purchasing Department on all solicitations for construction, alteration or demolition of public building or project, including but not limited to requirements found in LSA-RS 38:2212.9; LSA-RS 38:2212.10; LSA-RS 38:2224; Code of Ordinances, Jefferson Parish, Louisiana, Sec 2-923.1. Failure to comply will cause bid to be rejected; the Parish reserves the right to award bid to the next lowest responsive and responsible bidder in this event. For the convenience of vendors, all affidavits have been combined into one form entitled PUBLIC WORKS BID AFFIDAVIT. This affidavit must be submitted in its original format for the bid to be considered responsive.
15. **NON PUBLIC WORK BIDS - Completed, Signed and Properly Notarized Affidavits (in Original Format) required;** Non-Collusion Affidavit, and Campaign Contribution Affidavit must be completed, signed, notarized and submitted by low bidder within 10 days after bid opening to the Purchasing Department. See LSA-RS 38:2212.10; LSA-RS 38:2224; Code of Ordinances, Jefferson Parish, Louisiana, Sec 2-923.1 Failure to comply will cause bid to be rejected; the Parish reserves the right to award bid to the next lowest responsive and responsible bidder in this event. For the convenience of vendors, all affidavits have been combined into one form entitled NON PUBLIC WORKS BID AFFIDAVIT. This affidavit must be submitted in its original format for the bid to be considered responsive.
16. The ensuing contract for this bid solicitation may be eligible for FEMA reimbursement and/or Federal funding reimbursement. As such, the referenced attachment will be applicable accordingly and shall be considered a part of the bid documents. All applicable certifications must be duly completed, signed and submitted within 10 days of bid opening. Failure to submit applicable certifications within 10 days of bid opening will result in bid rejection.

It shall be the duty of every parish officer, employee, department, agency, special district, board, and commission: and the duty of every contractor, subcontractor, and licensee of the parish, and the duty of every applicant for certification of eligibility for a parish contract or program, to cooperate with the Inspector General in any investigation, audit, inspection, performance review, or hearing pursuant to Jefferson Parish Code of Ordinances Section 2-155.10(19). By submitting a bid, vendor acknowledges this and will abide by all provisions of the referenced Jefferson Parish Code of Ordinances.

DATE: 7/12/2016

INVITATION TO BID
THIS IS NOT AN ORDER

Page: 4

BID NO.: 50-00117153

JEFFERSON PARISH
PURCHASING DEPARTMENT
P.O. BOX 9
GRETNA, LA. 70054-0009
504-364-2678

VENDOR: 27118 BLANK BID COPY VENDOR

BUYER: CGasper

As per LSA-RS 47:301 et seq., all governmental bodies are excluded from payment of sales taxes to any Louisiana taxing body. Quotations shall be based on F.O.B. Agency warehouse or jobsite, anywhere within the Parish as designated by the Purchasing Department.

JEFFERSON PARISH reserves the right to cancel all or any part of an order if not shipped promptly. No charges will be allowed for parking or cartage unless specified in quotation. The order must not be filled at a higher price than quoted. JEFFERSON PARISH reserves the right to cancel at any time and for any reason by issuing a THIRTY (30) day written notice to the contractor.

JEFFERSON PARISH is expecting all products to be new and all work is to be done in a workman-like manner, according to standard practices. Any deviations or alterations from the specifications must be indicated and backup documentation supplied with your quotation.

DELIVERY: FOB JEFFERSON PARISH

INDICATE DELIVERY DATE ON EQUIPMENT AND SUPPLIES	<u>45 days ARO</u>
INDICATE STARTING TIME (IN DAYS) FOR CONSTRUCTION WORK	<u>Not applicable</u>
INDICATE COMPLETION TIME (IN DAYS) FOR CONSTRUCTION WORK	<u>Not applicable</u>

In the event that addenda are issued with this bid, bidders MUST acknowledge all addenda on the bid form. Bidder must acknowledge receipt of an addendum on the bid form as indicated. Failure to acknowledge any addendum on the bid form will result in bid rejection.

Acknowledge Receipt of Addenda: NUMBER: None
NUMBER: _____
NUMBER: _____
NUMBER: _____

LOUISIANA CONTRACTOR'S LICENSE NO.: (if applicable) Not applicable

*** ALL BIDDERS MUST COMPLETE SECTION BELOW ***	
FIRM NAME: <u>Wastequip Mfg. Co. LLC</u>	
SIGNATURE: (Must be signed here)	TITLE: <u>CFO</u>
PRINT OR TYPE NAME: <u>Stephen Svetik</u>	
ADDRESS: <u>(Bid Location) 841 Meacham Road</u>	
CITY, STATE: <u>Statesville, NC</u>	ZIP: <u>28677</u>
TELEPHONE: <u>(800)424-0422 Ext. 244</u>	FAX: <u>(704) 878-0734</u>
EMAIL ADDRESS: <u>mjenkins@wastequip.com</u>	

TOTAL PRICE OF ALL BID ITEMS: \$ 1,854.00

INVITATION TO BID FROM JEFFERSON PARISH - continued

BID NO.: 50-00117153

SEALED BID

ITEM NUMBER	QUANTITY	U/M	DESCRIPTION OF ARTICLES	UNIT PRICE QUOTED	TOTALS
1	2.00	EA	6 CUBIC YARD DUMPSTER 0010 6 cubic yard dumpster	\$702.00	\$1,404.00 + freight
2	2.00	EA	0020 Delivery charge per dumpster -		\$450.00
				*Wastequip #125534 - 6 cubic yard SLANT style. Customer to offload at time of delivery. Does not include any taxes.	



1261 W. Industrial Park Rd. NW, Brookhaven,
MS, 39601

PHONE: 601-835-0922 FAX: 601-835-5036

WQ-10021617

Sell To:

Contact Name	Carol Gasper	Ship To Name	Jefferson Parish
Bill To Name	Jefferson Parish	Ship To	200 Derbigny St Fl 4
Bill To	200 Derbigny St Fl 4		Gretna, LA 70053-5850
	Gretna, LA 70053-5850		United States
	United States	Customer Job	5000117153 6 CUBIC YARD DUMPSTERS
Email	cgasper@jeffparish.net	Reference	
Phone	(504) 364-2678		

Quote Information

Salesperson	Steve Hurtt	Created Date	7/14/2016
Salesperson Email	shurtt@wastequip.com	Expiration Date	7/28/2016
Salesperson Phone	(469) 853-7729	Quote Number	WQ-10021617
			Please Reference Quote Number on all Purchase Orders

Model	Product Description	Description	Quantity	Sales Price	Total Price
125534	6 Cubic Yard Standard Duty Slant Front Load Container - Floor: 10 gauge, Walls: 12 gauge, Pockets: Heavy Duty with Three Way Fork Entry Guide, Interlocking Top Channels with formed 10 gauge Bottom Runners, Primed and Painted Any Standard Color	Customer to offload at time of delivery!	2.00	\$702.00	\$1,404.00

Payment Terms	Net 30 Days	Subtotal	\$1,404.00
Shipping Terms	FOB Origin	Shipping and Handling	\$450.00
		Tax	\$0.00
		Grand Total	\$1,854.00

Additional Information

Additional Terms Our quote is a good faith estimate, based on our understanding of your needs. Subject to our acceptance, your Order is an offer to purchase our Products and services in accordance with the Wastequip Terms and Conditions, including our limited warranties, the terms of which are incorporated herein by reference, which constitutes the entire agreement between the parties. The Wastequip Terms and Conditions are available on our website at: <http://www.wastequip.com/terms-conditions.cfm>

Pricing is based on your anticipated Order, including product specifications, quantities and timing - any differences to your order may result in different pricing. Due to volatility in petrochemical, steel and related product material markets, actual prices, as well as freight, are subject to change and will be confirmed prior to acceptance of an Order. Unless otherwise stated, materials and container sizes indicated on sales literature, invoices, price lists, quotations and delivery tickets are nominal sizes and representations - actual volume, Products and materials are subject to manufacturing and commercial variations and Wastequip's practices, and may vary from nominal sizes and materials. All prices are in US dollars; this quotation may not include all applicable taxes, brokerage fees or duties.

Wastequip, Toter, Galbreath, Cusco, Accurate, Mountain Tarp, Pioneer, and Parts Place are registered trademarks, trade names and subsidiaries of Wastequip, LLC.

Additional Information Due to extremely volatile petrochemical and steel markets, actual prices and freight are subject to change and must be confirmed before acceptance of an order. Above pricing is based on orders placed in the quantities stated above. Orders placed for other than these quantities may be subject to additional freight and cost. Unless otherwise stated, container



1261 W. Industrial Park Rd. NW, Brookhaven,
MS, 39601

PHONE: 601-835-0922 FAX: 601-835-5036

WQ-10021617

sizes indicated on sales literature, invoices, price lists, quotations and delivery tickets are nominal sizes. Actual volume may vary from nominal sizes. This proposal is subject to Wastequip/Toter standard terms and conditions. Quotation does not include any applicable taxes other than those specifically listed on this document.

Signatures

Accepted By: _____

Company Name: _____

Date: _____

Purchase Order: _____

Please Reference Quote Number on all Purchase Orders

INSURANCE REQUIREMENTS - BIDS

All insurance requirements shall conform to Jefferson Parish Resolution No. 113646 or No. 113647. The contractor shall not commence work under this contract until he has obtained all insurance and complied with the requirements of the specifications and said Parish Resolutions. Except as otherwise provided by law, the Parish Attorney's Office with the concurrence of the Director of Risk Management is authorized to omit in whole or part the insurance requirements of this section in connection with contracts. Vendors inquiring about this shall submit his written request to the Purchasing Department prior to the due date of the bid. Contractor must deliver and maintain such insurances as provided; failure to do so shall be grounds for suspension, discontinuation or termination of the contract.

Successful bidder will be required to procure standard insurance policies evidencing Parish mandated insurance requirements indicated below. The current certificate of insurance must be submitted by low bidder within 10 days after bid opening to the Purchasing Department. Failure to comply will cause bid to be rejected.

1. WORKER'S COMPENSATION INSURANCE

As required by Louisiana State Statute, exception; Employer's Liability, Section B shall be \$1,000,000 per occurrence when Work is to be over water and involves maritime exposures to cover all employees not covered under the State Worker's Compensation Act, otherwise this limit shall be no less than \$500,000 per occurrence.

2. COMMERCIAL GENERAL LIABILITY

Shall provide limits not less than the following: \$1,000,000.00 Combined Single Limit per Occurrence for bodily injury and property damage.

3. COMPREHENSIVE AUTOMOBILE LIABILITY

Bodily injury liability \$1,000,000.00 each person; \$1,000,000.00 each occurrence.
Property Damage Liability \$1,000,000.00 each occurrence.

DEDUCTIBLES

No insurance required shall include a deductible not greater than \$10,000.00. The cost of the deductible shall be borne by the contractor.

NOTE: If the vendor requires a change in deductibles, the request must be submitted in writing to the Purchasing Department prior to the due date of the bid. Such request shall be reviewed by the Parish Attorney's Office.

UMBRELLA LIABILITY COVERAGE

An umbrella policy or excess may be used to meet minimum requirements.

CONSTRUCTION AND RENOVATION PROJECTS:

Unless otherwise specified in the bid, these additional insurance is required. Such insurance is due upon contract execution.

OWNER'S PROTECTIVE LIABILITY

To be for the same limits of liability for bodily injury and property damage liability established for commercial general liability.

BUILDER'S RISK INSURANCE

The contractor shall maintain Builder's Risk Insurance at his own expense to insure both the owner (Parish of Jefferson) and contractor as their interest may appear.

NOTE for CERTIFICATE HOLDER:

All insurance certificates shall list the certificate holder as follows:

"The Parish of Jefferson, its Districts, Departments and Agencies under the direction of the Parish President and the Parish Council." Additionally, the address on the Certificates should reflect the department which is letting the bid and reference the respective bid number.

Revised 2.10.2014

FRONT END LOAD (FEL) CONTAINERS



STEEL FEL CONTAINERS

Wastequip's **Front End Load Containers (FELs)** are engineered using heavy-gauge steel to withstand the stress of continued use. Standard models feature **12 gauge sides, 10 gauge bottoms, high-density polyethylene lids, and fully welded in-seams.**

Our heavy-duty models have 10 gauge sides and 7 gauge bottoms for added strength and durability.

Containers are primed inside and outside to reduce corrosion. Wastequip containers meet ANSI safety specifications and dimensional standards for haulers. With locations throughout North America, Wastequip can meet all your container needs quickly.



Available Styles:

Flat, Slant, Hatchback, and Nestable (Slant and Flat)
(Specialty and Regional Styles also Available)

Sizes Available:

2-, 3-, 4-, 6-, 8-, and 10-cubic-yards

FEATURES & BENEFITS

1 FORK POCKETS:

- 3-way flared fork pockets protect from damage by truck forks, and easily guides forks into pockets.
- Taco gussets welded to bottom of fork pockets help extend pocket life by providing added strength to bottom of pockets.
- Fully welded pockets at critical stress points reduce fork damage and ensure long service life.

2 CONSTRUCTION:

- Rounded bumper pads help prevent damage to front of container.
- Floor channels are capped at both ends to prevent debris from getting inside, and extend up the front and back walls to create extra support.
- Fully welded, no-step gusset across top of fork pocket provides added safety and support.

CONSTRUCTION (CONT'D):

- Top edges are rounded and smooth for added safety during loading.
- Interlocking top channel frame provides added strength.
- Primed inside and outside to reduce corrosion.
- Available in multiple standard colors.
- Nestable 2-, 3- and 4-yard containers reduce shipping costs and required storage space.

3 LIDS:

- Single-wall, double-lip lids ensure durability.
- Optional lids available upon request.

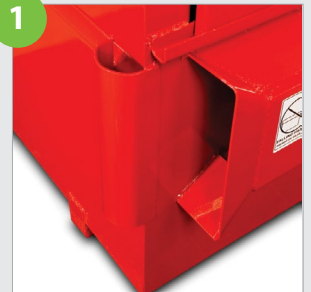

FLAT-TOP FEL CONTAINERS

2-YARD FLAT (NESTABLE)

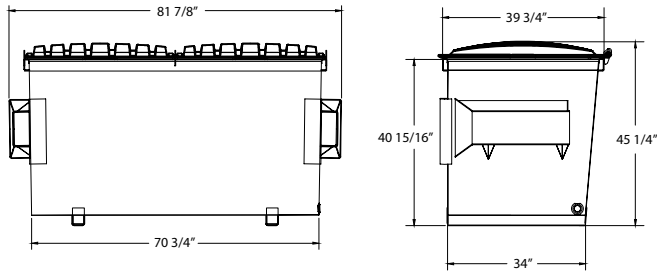

3-YARD FLAT (NESTABLE)

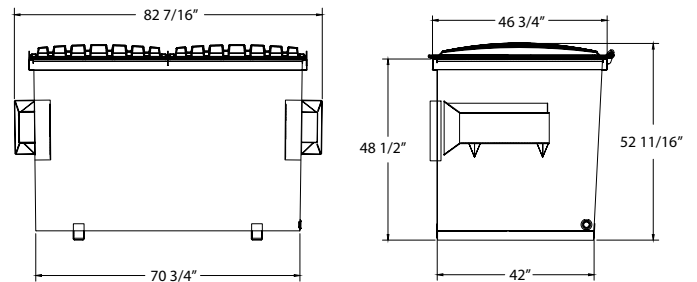

4-YARD FLAT

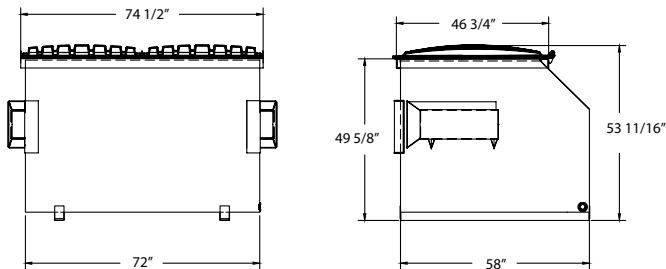

6-YARD FLAT

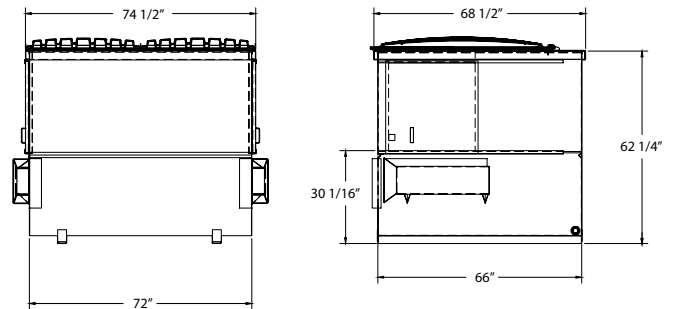

8-YARD FLAT

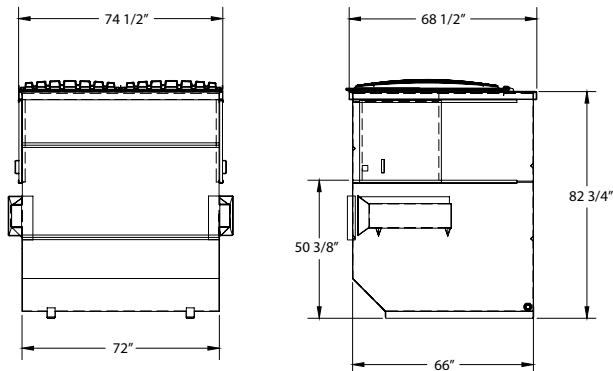

10-YARD FLAT

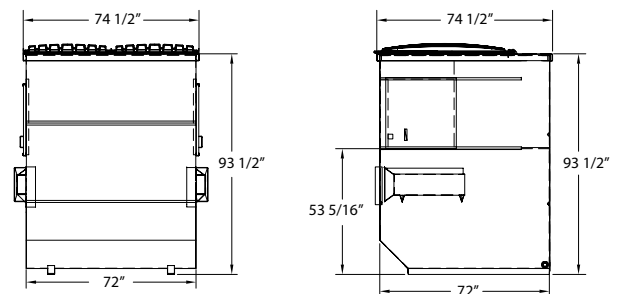

	2-YARD*	3-YARD*	4-YARD	6-YARD	8-YARD	10-YARD
48-foot Trailer (Flat / Drop)	42 / 52	28 / 36	18 / 18	8 / 14	8 / 8	7 / 7
53-foot Trailer (Flat / Drop)	45 / 57	32 / 42	20 / 20	9 / 16	9 / 9	8 / 8
Plastic Lid Standard	37" x 41" Single Wall	37" x 48" Single Wall	37" x 48" Single Wall	37" x 58" Single Wall	37" x 58" Single Wall	37" x 58" Single Wall
Sides	12 gauge	12 gauge	12 gauge	12 gauge	12 gauge	12 gauge
Bottom	10 gauge	10 gauge	10 gauge	10 gauge	10 gauge	10 gauge
Weight	505 lbs.	602 lbs.	732 lbs.	971 lbs.	1,110 lbs.	1,543 lbs.

* Nestable

SLANT-TOP FEL CONTAINERS

2-YARD SLANT (NESTABLE)

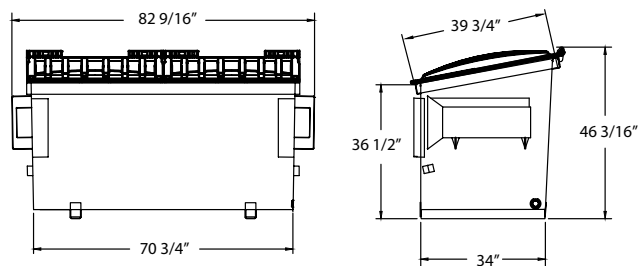

3-YARD SLANT (NESTABLE)

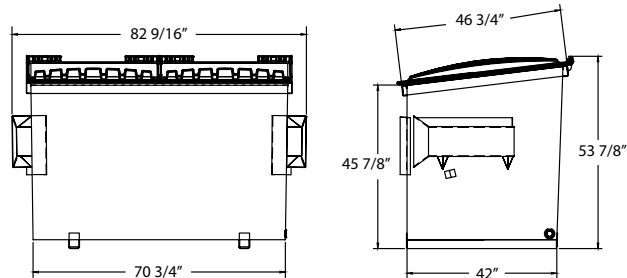

4-YARD SLANT (NESTABLE)

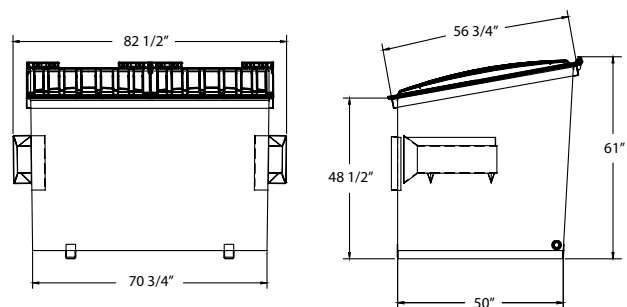

6-YARD SLANT

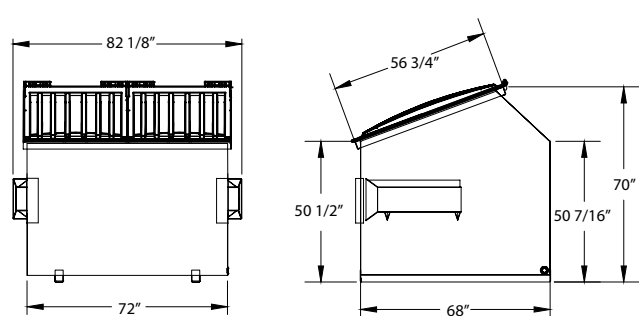

8-YARD SLANT

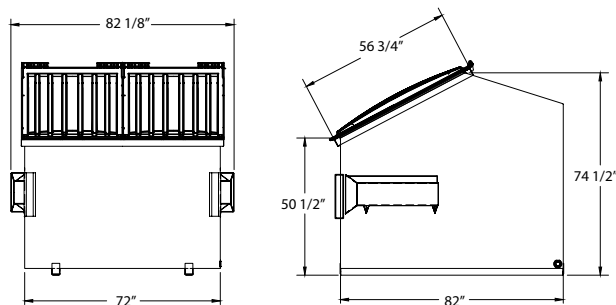

	2-YARD*	3-YARD*	4-YARD*	6-YARD	8-YARD
48-foot Trailer (Flat / Drop)	42 / 52	24 / 33	20 / 28	8 / 14	7 / 7
53-foot Trailer (Flat / Drop)	48 / 60	26 / 36	22 / 31	9 / 16	8 / 8
Plastic Lid Standard	37" x 41" Single Wall	37" x 48" Single Wall	37" x 58" Single Wall	37" x 58" Single Wall	37" x 58" Single Wall
Sides	12 gauge	12 gauge	12 gauge	12 gauge	12 gauge
Bottom	10 gauge	10 gauge	10 gauge	10 gauge	10 gauge
Weight	504 lbs.	608 lbs.	709 lbs.	900 lbs.	1,103 lbs.

*Nestable



Tel: 877.468.9278 | sales@wastequip.com | www.wastequip.com

Wastequip is the leading North American manufacturer of waste and recycling equipment for collecting, processing, and transporting recyclables and solid or liquid waste.

© Wastequip, all rights reserved. Specifications subject to improvement without notice. Equipment displayed should be operated by properly trained personnel. Operators should become familiar with OSHA, ANSI and any other applicable standards or laws for using this equipment. Improper use, misuse, or lack of maintenance could cause injury to people and/or property. Photos used in the literature are illustrative only. Wastequip assumes no liability or responsibility for proper training/operation of equipment not manufactured by Wastequip. We reserve the right to make changes at any time without notice. Information contained within this literature is intended to be the most accurate available at time of printing.

WQP034-042016



CONTAINER LIMITED WARRANTY

WASTEQUIP warrants all other products of its manufacture against operational failure caused by defective material or workmanship, **which occurs during normal use within twelve (12) months from date of shipment from our factory.**

WASTEQUIP will replace all parts of our manufacture free of charge that our inspection at our factory shows to us to be defective in accordance with the above paragraph. **Written permission must be obtained from authorized Wastequip personnel for any repairs performed other than in our factory.** All claims for reimbursement must be filed with proper documentation no later than forty-five (45) days after occurrence to be allowed.

All products purchased by WASTEQUIP from an outside vendor shall be covered by the warranty of that respective vendor only, and WASTEQUIP does not participate in or obligate itself to any such warranty.

No freight, travel cost, meals, lodging, or loss of hydraulic oil shall be covered by this warranty, all labor costs allowed shall be in accordance with WASTEQUIP'S established rate; in case of alleged defect, product shall be returned to WASTEQUIP with transportation charges prepaid. No freight collect shipment will be accepted.

WASTEQUIP makes no warranty on any of its equipment used in any way except as it was designed, intended, and sold to perform.

DISCLAIMER OF WARRANTIES: THE LIMITED AND CONDITIONAL WARRANTY AND REMEDIES SET FORTH ABOVE ARE EXCLUSIVE AND IN LIEU OF ANY AND ALL REPRESENTATIONS, SPECIFICATIONS, WARRANTIES AND REMEDIES, EITHER EXPRESS OR IMPLIED, HEREIN OR ELSEWHERE, OR WHICH MIGHT ARISE UNDER LAW OR EQUITY, OR PURSUANT TO ANY COURSE OF DEALING OR CUSTOM OR USAGE OF TRADE, INCLUDING WITHOUT LIMITATION, ANY WARRANTIES OF MERCHANTABILITY AND OF FITNESS FOR ANY SPECIFIED OR INTENDED PURPOSE.

LIMITATION OF REMEDIES AND LIABILITY: PURCHASER'S SOLE AND EXCLUSIVE REMEDY AGAINST WASTEQUIP SHALL BE THE REMEDY OF DEFECTS IN PRODUCTS DELIVERED HEREUNDER AS PROVIDED BY, AND WITHIN THE TIME PERIOD SPECIFIED IN, WASTEQUIP'S LIMITED WARRANTY SET FORTH ABOVE. WASTEQUIP'S LIMITED WARRANTY CONSTITUTES THE SOLE REMEDY WITH RESPECT TO OR ARISING OUT OF THE EQUIPMENT, PRODUCTS OR SERVICES OF WASTEQUIP. NOTWITHSTANDING ANY OTHER PROVISIONS HEREOF, IN NO EVENT SHALL WASTEQUIP BE LIABLE IN CONTRACT, TORT OR EQUITY FOR ANY LOSS OF ANTICIPATED PROFITS, LOST SALES, INJURY TO PERSONS OR PROPERTY, LOSS BY REASON OF PLANT SHUTDOWN, NON-OPERATION OR INCREASED EXPENSE OF OPERATION, SERVICE INTERRUPTIONS, CLAIMS OF CUSTOMERS, COST OF MONEY, LOSS OF USE OF CAPITAL OR REVENUE, OR FOR ANY SPECIAL, INCIDENTAL OR CONSEQUENTIAL LOSSES OR DAMAGES OF ANY KIND WHATSOEVER.

All claims shall be processed through the WASTEQUIP Service Department or your authorized WASTEQUIP dealer.



Points of Contact for the State of Louisiana

Bid Information: Marya M. Jenkins, Bid/Contract Specialist
841 Meacham Road
Statesville, NC 28677
Direct: 800-424-0422 Ext 244
Fax: 704-878-0734
Email: MJenkins@wastequip.com

Account Rep: Steve Hurtt, Regional Sales Manager
Direct: 469-853-7729
Email: SHurtt@wastequip.com

P.O. Remit: Wastequip
1261 East Park Lane NW
Brookhaven, MS 39601
Direct: 800-242-0122
Fax: 361-358-0418

Invoice Remit: Wastequip, LLC
PO Box 603008
Charlotte, NC 28260-3008
Direct: 704-366-7140



CERTIFICATE OF LIABILITY INSURANCE

4/1/2017

DATE (MM/DD/YYYY)

3/29/2016

THIS CERTIFICATE IS ISSUED AS A MATTER OF INFORMATION ONLY AND CONFERS NO RIGHTS UPON THE CERTIFICATE HOLDER. THIS CERTIFICATE DOES NOT AFFIRMATIVELY OR NEGATIVELY AMEND, EXTEND OR ALTER THE COVERAGE AFFORDED BY THE POLICIES BELOW. THIS CERTIFICATE OF INSURANCE DOES NOT CONSTITUTE A CONTRACT BETWEEN THE ISSUING INSURER(S), AUTHORIZED REPRESENTATIVE OR PRODUCER, AND THE CERTIFICATE HOLDER.

IMPORTANT: If the certificate holder is an ADDITIONAL INSURED, the policy(ies) must be endorsed. If SUBROGATION IS WAIVED, subject to the terms and conditions of the policy, certain policies may require an endorsement. A statement on this certificate does not confer rights to the certificate holder in lieu of such endorsement(s).

PRODUCER Lockton Companies 1185 Avenue of the Americas, Suite 2010 New York 10036 646-572-7300	CONTACT NAME:	
	PHONE (A/C, No. Ext): FAX (A/C, No):	
INSURED 1315809 WASTEQUIP MANUFACTURING CO., LLC 841 MEACHAM ROAD STATESVILLE NC 28677	E-MAIL ADDRESS:	
	INSURER(S) AFFORDING COVERAGE	
	INSURER A: First Specialty Insurance Corporation	NAIC # 34916
	INSURER B: Liberty Mutual Fire Insurance Company	23035
	INSURER C: Travelers Property Casualty Co of America	25674
	INSURER D: Liberty Insurance Corporation	42404
	INSURER E:	
INSURER F:		

COVERAGES WASQU01 **CERTIFICATE NUMBER:** 13986754 **REVISION NUMBER:** XXXXXXXX

THIS IS TO CERTIFY THAT THE POLICIES OF INSURANCE LISTED BELOW HAVE BEEN ISSUED TO THE INSURED NAMED ABOVE FOR THE POLICY PERIOD INDICATED. NOTWITHSTANDING ANY REQUIREMENT, TERM OR CONDITION OF ANY CONTRACT OR OTHER DOCUMENT WITH RESPECT TO WHICH THIS CERTIFICATE MAY BE ISSUED OR MAY PERTAIN, THE INSURANCE AFFORDED BY THE POLICIES DESCRIBED HEREIN IS SUBJECT TO ALL THE TERMS, EXCLUSIONS AND CONDITIONS OF SUCH POLICIES. LIMITS SHOWN MAY HAVE BEEN REDUCED BY PAID CLAIMS.

INSR LTR	TYPE OF INSURANCE	ADDL INSD	SUBR WVD	POLICY NUMBER	POLICY EFF (MM/DD/YYYY)	POLICY EXP (MM/DD/YYYY)	LIMITS
A	<input checked="" type="checkbox"/> COMMERCIAL GENERAL LIABILITY <input type="checkbox"/> CLAIMS-MADE <input checked="" type="checkbox"/> OCCUR <input checked="" type="checkbox"/> \$100,000 SIR GEN'L AGGREGATE LIMIT APPLIES PER: <input type="checkbox"/> POLICY <input type="checkbox"/> PRO-JECT <input type="checkbox"/> LOC OTHER:	N	N	IRG 200101203	4/1/2016	4/1/2017	EACH OCCURRENCE \$ 2,000,000 DAMAGE TO RENTED PREMISES (Ea occurrence) \$ 500,000 MED EXP (Any one person) \$ 5,000 PERSONAL & ADV INJURY \$ 2,000,000 GENERAL AGGREGATE \$ 4,000,000 PRODUCTS - COMP/OP AGG \$ 4,000,000 \$
B	<input checked="" type="checkbox"/> AUTOMOBILE LIABILITY <input checked="" type="checkbox"/> ANY AUTO <input checked="" type="checkbox"/> ALL OWNED AUTOS <input checked="" type="checkbox"/> HIRED AUTOS <input checked="" type="checkbox"/> SCHEDULED AUTOS <input checked="" type="checkbox"/> NON-OWNED AUTOS	N	N	AS2-681-053630-066	4/1/2016	4/1/2017	COMBINED SINGLE LIMIT (Ea accident) \$ 2,000,000 BODILY INJURY (Per person) \$ XXXXXXXX BODILY INJURY (Per accident) \$ XXXXXXXX PROPERTY DAMAGE (Per accident) \$ XXXXXXXX \$ XXXXXXXX
C	<input checked="" type="checkbox"/> UMBRELLA LIAB <input checked="" type="checkbox"/> OCCUR <input type="checkbox"/> EXCESS LIAB <input type="checkbox"/> CLAIMS-MADE DED <input checked="" type="checkbox"/> RETENTION \$ 10,000	N	N	ZUP-10N82720-16-NF	4/1/2016	4/1/2017	EACH OCCURRENCE \$ 2,000,000 AGGREGATE \$ 2,000,000 \$ XXXXXXXX
D	<input checked="" type="checkbox"/> WORKERS COMPENSATION AND EMPLOYERS' LIABILITY ANY PROPRIETOR/PARTNER/EXECUTIVE OFFICER/MEMBER EXCLUDED? (Mandatory in NH) If yes, describe under DESCRIPTION OF OPERATIONS below	Y/N N	N/A	WC7-681-053630-046	4/1/2016	4/1/2017	<input checked="" type="checkbox"/> PER STATUTE <input type="checkbox"/> OTH-ER E.L. EACH ACCIDENT \$ 1,000,000 E.L. DISEASE - EA EMPLOYEE \$ 1,000,000 E.L. DISEASE - POLICY LIMIT \$ 1,000,000

DESCRIPTION OF OPERATIONS / LOCATIONS / VEHICLES (ACORD 101, Additional Remarks Schedule, may be attached if more space is required)

CERTIFICATE HOLDER

13986754
EVIDENCE OF INSURANCE

CANCELLATION

SHOULD ANY OF THE ABOVE DESCRIBED POLICIES BE CANCELLED BEFORE THE EXPIRATION DATE THEREOF, NOTICE WILL BE DELIVERED IN ACCORDANCE WITH THE POLICY PROVISIONS.

AUTHORIZED REPRESENTATIVE

Michael A. Calabrese

© 1988-2014 ACORD CORPORATION. All rights reserved.

Request for Taxpayer Identification Number and Certification

Give Form to the
requester. Do not
send to the IRS.

Print or type
See Specific Instructions on page 2.

1 Name (as shown on your income tax return). Name is required on this line; do not leave this line blank.

Wastequip Manufacturing Company LLC

2 Business name/disregarded entity name, if different from above

3 Check appropriate box for federal tax classification; check only **one** of the following seven boxes:

- ☐ Individual/sole proprietor or single-member LLC
☐ C Corporation
☐ S Corporation
☐ Partnership
☐ Trust/estate
☒ Limited liability company. Enter the tax classification (C=C corporation, S=S corporation, P=partnership) ▶ **C**
Note. For a single-member LLC that is disregarded, do not check LLC; check the appropriate box in the line above for the tax classification of the single-member owner.
☐ Other (see instructions) ▶

4 Exemptions (codes apply only to certain entities, not individuals; see instructions on page 3):
Exempt payee code (if any) _____
Exemption from FATCA reporting code (if any) _____
(Applies to accounts maintained outside the U.S.)

5 Address (number, street, and apt. or suite no.)

(Corporate Location) 6525 Morrison Blvd., Suite 300

Requester's name and address (optional)

6 City, state, and ZIP code

Charlotte, NC 28211

7 List account number(s) here (optional)

Part I Taxpayer Identification Number (TIN)

Enter your TIN in the appropriate box. The TIN provided must match the name given on line 1 to avoid backup withholding. For individuals, this is generally your social security number (SSN). However, for a resident alien, sole proprietor, or disregarded entity, see the Part I instructions on page 3. For other entities, it is your employer identification number (EIN). If you do not have a number, see *How to get a TIN* on page 3.

Note. If the account is in more than one name, see the instructions for line 1 and the chart on page 4 for guidelines on whose number to enter.

Social security number

____ - ____ - ____

or

Employer identification number

2 2 - 3 1 9 1 6 2 4

Part II Certification

Under penalties of perjury, I certify that:

1. The number shown on this form is my correct taxpayer identification number (or I am waiting for a number to be issued to me); and
2. I am not subject to backup withholding because: (a) I am exempt from backup withholding, or (b) I have not been notified by the Internal Revenue Service (IRS) that I am subject to backup withholding as a result of a failure to report all interest or dividends, or (c) the IRS has notified me that I am no longer subject to backup withholding; and
3. I am a U.S. citizen or other U.S. person (defined below); and
4. The FATCA code(s) entered on this form (if any) indicating that I am exempt from FATCA reporting is correct.

Certification instructions. You must cross out item 2 above if you have been notified by the IRS that you are currently subject to backup withholding because you have failed to report all interest and dividends on your tax return. For real estate transactions, item 2 does not apply. For mortgage interest paid, acquisition or abandonment of secured property, cancellation of debt, contributions to an individual retirement arrangement (IRA), and generally, payments other than interest and dividends, you are not required to sign the certification, but you must provide your correct TIN. See the instructions on page 3.

Sign
Here

Signature of
U.S. person ▶

Stephen Svetik, CFO Date ▶ **3-25-16**

General Instructions

Section references are to the Internal Revenue Code unless otherwise noted.

Future developments. Information about developments affecting Form W-9 (such as legislation enacted after we release it) is at www.irs.gov/fw9.

Purpose of Form

An individual or entity (Form W-9 requester) who is required to file an information return with the IRS must obtain your correct taxpayer identification number (TIN) which may be your social security number (SSN), individual taxpayer identification number (ITIN), adoption taxpayer identification number (ATIN), or employer identification number (EIN), to report on an information return the amount paid to you, or other amount reportable on an information return. Examples of information returns include, but are not limited to, the following:

- Form 1099-INT (interest earned or paid)
- Form 1099-DIV (dividends, including those from stocks or mutual funds)
- Form 1099-MISC (various types of income, prizes, awards, or gross proceeds)
- Form 1099-B (stock or mutual fund sales and certain other transactions by brokers)
- Form 1099-S (proceeds from real estate transactions)
- Form 1099-K (merchant card and third party network transactions)

• Form 1098 (home mortgage interest), 1098-E (student loan interest), 1098-T (tuition)

• Form 1099-C (canceled debt)

• Form 1099-A (acquisition or abandonment of secured property)

Use Form W-9 only if you are a U.S. person (including a resident alien), to provide your correct TIN.

If you do not return Form W-9 to the requester with a TIN, you might be subject to backup withholding. See *What is backup withholding?* on page 2.

By signing the filled-out form, you:

1. Certify that the TIN you are giving is correct (or you are waiting for a number to be issued),
2. Certify that you are not subject to backup withholding, or
3. Claim exemption from backup withholding if you are a U.S. exempt payee. If applicable, you are also certifying that as a U.S. person, your allocable share of any partnership income from a U.S. trade or business is not subject to the withholding tax on foreign partners' share of effectively connected income, and
4. Certify that FATCA code(s) entered on this form (if any) indicating that you are exempt from the FATCA reporting, is correct. See *What is FATCA reporting?* on page 2 for further information.