

DATE: 12/07/2018

INVITATION TO BID  
THIS IS NOT AN ORDER

Page: 4

BID NO.: 50-00124804

JEFFERSON PARISH

PURCHASING DEPARTMENT  
P.O. BOX 9  
GRETN, LA. 70054-0009  
504-364-2678

VENDOR: DYNA-PLAY LLC

BUYER: DNELSON

As per LSA-RS 47:301 et seq., all governmental bodies are excluded from payment of sales taxes to any Louisiana taxing body. Quotations shall be based on F.O.B. Agency warehouse or jobsite, anywhere within the Parish as designated by the Purchasing Department.

JEFFERSON PARISH reserves the right to cancel all or any part of an order if not shipped promptly. No charges will be allowed for parking or cartage unless specified in quotation. The order must not be filled at a higher price than quoted. JEFFERSON PARISH reserves the right to cancel at any time and for any reason by issuing a THIRTY (30) day written notice to the contractor.

JEFFERSON PARISH is expecting all products to be new and all work to be done in workman-like manner, according to standard practices. Any deviations or alteration from the specifications must be indicated on the bid form for each item and upon request, product data for same must be submitted by the time specified by the Purchasing Department.

DELIVERY: FOB JEFFERSON PARISH

INDICATE DELIVERY DATE ON EQUIPMENT AND SUPPLIES

8-9 weeks ARO

INDICATE STARTING TIME (IN DAYS) FOR CONSTRUCTION WORK

N/A

INDICATE COMPLETION TIME (IN DAYS) FOR CONSTRUCTION WORK

N/A

In the event that addenda are issued with this bid, bidders MUST acknowledge all addenda on the bid form. Bidder must acknowledge receipt of an addendum on the bid form as indicated. Failure to acknowledge any addendum on the bid form will result in bid rejection.

Acknowledge Receipt of Addenda: NUMBER: \_\_\_\_\_

NUMBER: \_\_\_\_\_

NUMBER: \_\_\_\_\_

NUMBER: \_\_\_\_\_

LOUISIANA CONTRACTOR'S LICENSE NO.: (if applicable) 43833

*** ALL BIDDERS MUST COMPLETE SECTION BELOW ***	
FIRM NAME: DYNA-PLAY LLC	
SIGNATURE: (Must be signed here)	TITLE: ESTIMATING
PRINT OR TYPE NAME: JOHN LAGARDE	
ADDRESS: PO Box 6497	
CITY, STATE: METAIRIE, LA	ZIP: 70009
TELEPHONE: ( ) 504-342-2875	FAX: ( ) 504-342-2873
EMAIL ADDRESS: john@dynaplay.com	

TOTAL PRICE OF ALL BID ITEMS: \$ 21,244.00

## INVITATION TO BID FROM JEFFERSON PARISH - continued

BID NO.: 50-00124804

SEALED BID

ITEM NUMBER	QUANTITY	U/M	DESCRIPTION OF ARTICLES	UNIT PRICE QUOTED	TOTALS
1	44.00	EA	<p>ONE TIME PURCHASE OF A QUANTITY OF A QUANTITY OF RECEPTACLES AND TRASH CAN LINERS FOR JEFFERSON PARISH DEPARTMENT OF PARKS AND RECREATION</p> <p><i>PREMIER POLYSTEEL</i></p> <p>0010 Receptacles must be <del>Webash Valley</del> Item# <del>LR300P</del> or equal. They must be</p> <p>32-gallon, blue, perforated receptacles.</p>	<i>\$303.00</i>	<i>\$13,332.00</i>
2	44.00	EA	<p>0020 Receptacle Lids</p> <p><i>PREMIER POLYSTEEL</i></p> <p><del>Webash</del> Accessory Lid Item# <del>LR100N</del> OR EQUAL</p> <p>32-gallon receptacle lid, dome top, color blue</p>	<i>\$117.00</i>	<i>\$5,148.00</i>
3	48.00	EA	<p>0030 Receptacle Liners</p> <p><i>PREMIER POLYSTEEL</i></p> <p><del>Webash Valley</del> Item# <del>LR340N</del> OR EQUAL</p> <p>32-gallon rigid plastic receptacle liner</p>	<i>\$18.00</i>	<i>\$864.00</i>
4	1.00	EA	<i>FREIGHT</i>	<i>\$1,900.00</i>	<i>\$1,900.00</i>



# Receptacles

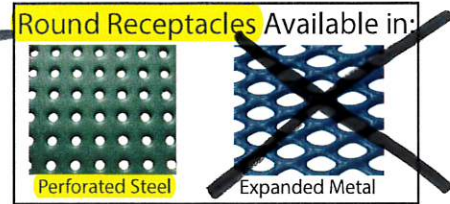
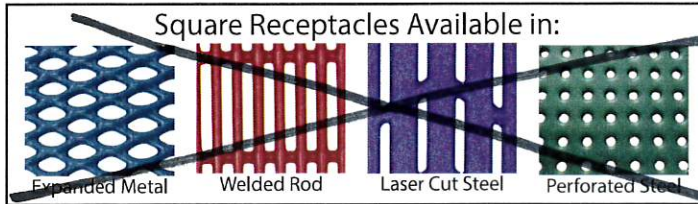

Description	Expanded	Welded Rod	Perforated	Laser Cut	Weight LBS
32 Gal. Square Receptacle, Arch Lid	996-031	993-031	992-031	994-031	130
55 Gal. Square Receptacle, Arch Lid	996-051	993-051	992-051	994-051	165
32 Gal. Square Receptacle, Flat Lid	996-F31	993-F31	992-F31	994-F31	110
55 Gal. Square Receptacle, Flat Lid	996-F51	993-F51	992-F51	994-F51	150

Description	Model	Weight LBS
22 Gal. One-piece Round Receptacle	988-131	38
32 Gal. One-piece Round Receptacle - PERFORATED	995-1P1	48
55 Gal. One-piece Round Receptacle	989-131	66
32 Gal. Round Receptacle, Ships Flat Unassembled	995-031	100

Description	Model	Weight LBS
Flat Lid for 22 Gal. with 8" hole	995-002	15
Flat Lid for 22 Gal. with 16" hole	995-006	15
Flat Lid for 32 Gal. with 8" hole	995-001	17
Flat Lid for 32 Gal. with 16" hole	995-005	17
Flat Lid for 55 Gal. with 8" hole	995-003	23
Flat Lid for 55 Gal. with 16" hole	995-007	23
Polydome Lid for 32 Gal. Receptacle*	DOMELID	9
Direct Bury Kit for in-ground mounting (PVC coated steel)	99DBKIT	2
Liner - specify 22 ga., 32 ga., or 55 ga. (black)	LINER	5



**993-031**  
32 Gal. Arch Lid



**DOMELID**  
Polydome Lid (32 Gal.)  
\* Colors: Black, Brown, Blue, Gray, Red, Yellow



**996-031**  
32 Gal. Arch Lid



**996-051**  
55 Gal. Arch Lid



**995-131**  
32 Gal. One Pc  
**995-001**  
Flat Lid (32 gal) 8" hole



**998-131**  
22 Gal. One Pc  
**995-002**  
Flat Lid (22 gal) 8"

**989-131**  
55 Gal. One Pc  
**995-003**  
Flat Lid (55 gal) 8"



[www.dynaplay.com](http://www.dynaplay.com)



**PREMIER POLYSTEEL**  
The Best Commercial Outdoor Furniture Available. Period.







# PREMIER POLYSTEEL

The Best Commercial Outdoor Furniture Available. Period.



Phone: 641-324-2750 • Toll Free US & Canada: 877-746-3826 • Web: [www.premierpolysteel.com](http://www.premierpolysteel.com) • Email: [sales@premierpolysteel.com](mailto:sales@premierpolysteel.com)

## Premier Polysteel Specifications for Receptacle and Planter

Last updated June, 2017

### Specifications for Receptacle and Planter

**Base** is made of 10 gauge HR steel. Optional surface mounting plate included.

**Top** is made of 16 gauge HR steel.

**Receptacle Arch Lid** is made of 16 gauge HR steel.

**Side Bars** are made of 11 gauge steel

**Expanded Metal Sides** for square receptacle and planter are made of 3/4" #9 expanded metal. Round receptacle sides are made of 3/4" #9 flat expanded metal.

**Welded Rod Sides** are made of 1/2" welded rod.

**Laser Cut Steel Sides** are 12 gauge HR steel.

**Perforated Sides** are made of 12 gauge steel.

*16 ga. steel*

All above are coated with UV and fungus resistant plastisol to a thickness of 1/8". All hardware is .305 stainless steel.

### Specifications for Plastisol (PVC) Poly-Vinyl Chloride Coating

Material: Plastisol (PVC) shall have:

**Antimicrobial** (non-leaching) to help prevent microbiological attack on the plastisol (PVC) surface that can cause the loss of aesthetic appearance, mildew odors, embrittlement and premature product failure. Testing Data available Per ASTM G21-90.

Tensile strength of no less than 1800 psi per ASTM D412.

Elongation of no less than 200% per ASTM D412

Tear strength of no less than 300lb/in per ASTM D624.

Hardness of 90 ± 5 (Durometer, Shore A (Instant)) per ASTM D2240.

**Flammability** – Pass per FMVSS 302

**UV stabilized** – guaranteed to not show significant fading for 5 years per written warranty

Process: Prior to plastisol coating, each part shall be chemically washed, dried, heated and coated in a heat activated primer and dried.

After drying, each part shall be pre-heated in a convection oven to a temperature of no less than 400° F, dipped into liquid Plastisol (PVC) and cured in a convection oven at a temperature no less than 350° F. **All parts shall have a coating thickness of .125"-.25".**

Premier Polysteel products are completely plastisol coated (frames and legs included) with a thick, UV stabilized, mold and mildew resistant plastisol coating which is compliant with worldwide standards. Premier Polysteel is committed to being an environmentally conscious company and recognizes the importance of being committed to continually finding ways to support our environment.



# 32 Gallon Perforated Round Receptacle

995-1P1

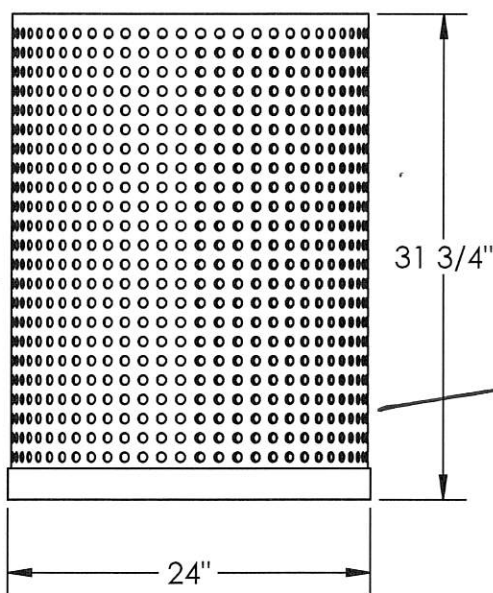
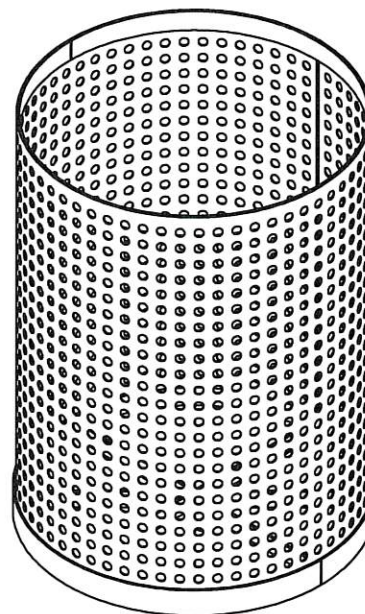
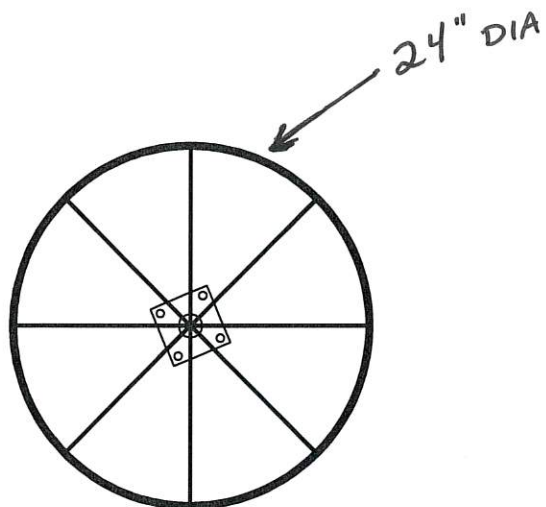

In accordance to California law: WARNING - This product contains a chemical known to the State of California to cause cancer and birth defects or other reproductive harm.



## PREMIER POLYSTEEL

The Best Commercial Outdoor Furniture Available. Period.



SIZE  
A

REV. X.01 | SHEET 1 OF 1

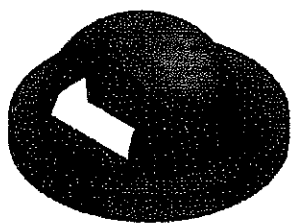

Blue

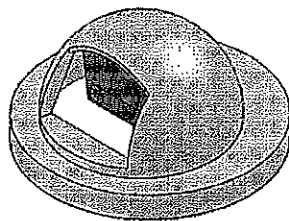

Gray

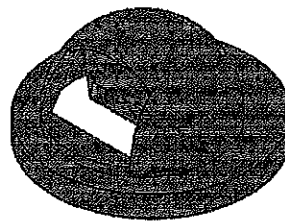

Brown

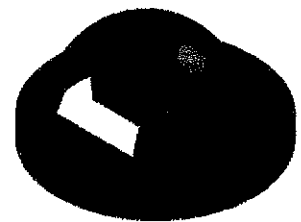

Black

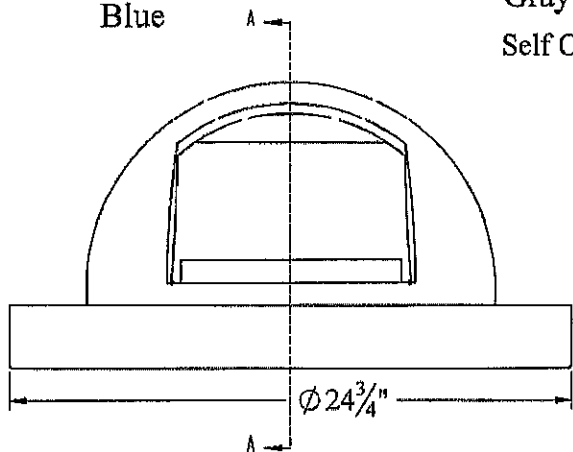

Self Closing Push Door

Heavy Molded Plastic

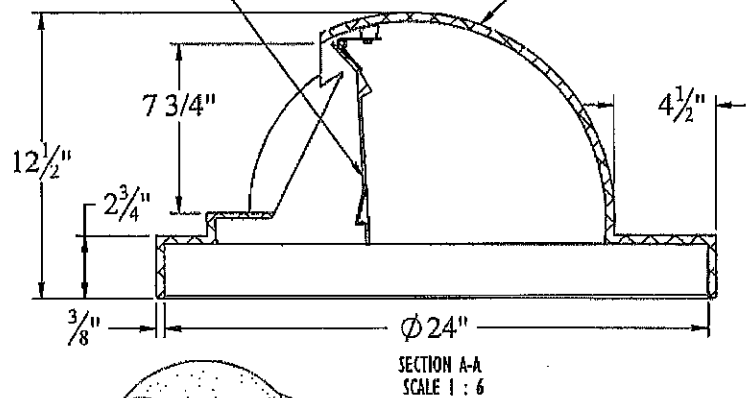

SECTION A-A  
SCALE 1 : 6

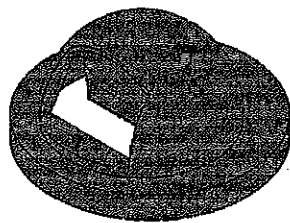

Red

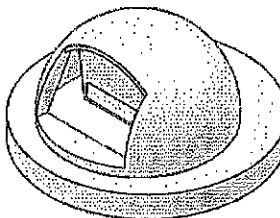
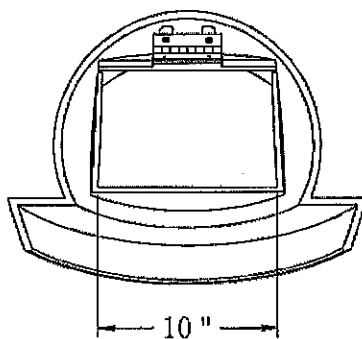

Yellow

DESC. 24" ID PLASTIC DOMED LID, FITS INSIDE 132LR w/SLATS, OVER 132LRVP & RLR2132			
MODEL NUMBER DLNP3255			WT.
DRAWN BY PAVEL	DATE 2/28/2013	Sheet 1 of 3	SCALE NONE





## **PREMIER POLYSTEEL**

**The Best Commercial Outdoor Furniture Available. Period.**

### **20 Year Limited Warranty**

Premier Polysteel, because of its very high quality standards and superior design and materials, is pleased to provide a twenty year limited warranty on all of its standard products from date of purchase by the original user. Although our limited warranty applies to normal wear and our plastics are very fade resistant, we cannot warrant against natural fading due to sunlight. This warranty is based upon the product being used as per its originally designed purpose, and specifically excludes any failure that is caused by misuse, neglect, accident, or improper maintenance. Premier Polysteel will repair or replace, on a pro-rated basis, all parts which fail to perform under the circumstances outlined above. All freight and installation charges are to be paid by user.

**Premier Polysteel, a division of ADA Enterprises, Inc.**

PO Box 77, 305 Enterprize Drive

Northwood, Iowa 50459

Phone 641-324-2750 • Toll Free U.S.A. & Canada 877-746-3826 • Email [sales@premierpolysteel.com](mailto:sales@premierpolysteel.com)

[www.premierpolysteel.com](http://www.premierpolysteel.com)



# PREMIER POLYSTEEL

The Best Commercial Outdoor Furniture Available. Period.

## Premier Polysteel Standard Colors

### Contact Us:

Phone: 641-324-2750

Toll Free: 877-746-3826 (US & CAN)

Fax: 641-324-1092

Email: [sales@premierpolysteel.com](mailto:sales@premierpolysteel.com)

Web: [www.premierpolysteel.com](http://www.premierpolysteel.com)



Red



Burgundy



Orange

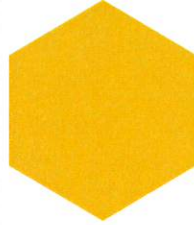

Yellow



Hunter Green



Evergreen

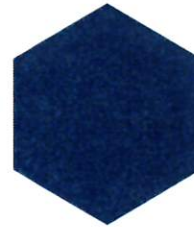

Blue



Purple



Ivory



Gray



Brown

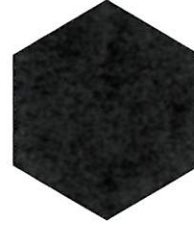

Black

Actual product colors may vary from colors shown on your monitor. Color samples are available upon request. [Click here to contact us.](#)