



CENTRALBIDDING
FROM CENTRAL AUCTION HOUSE

**5000119296 ELECTRICAL STOCK SUPPLIES NEEDED FOR THE
JEFFERSON PARISH EB SEWERAGE DEPARTMENT**
Jefferson Parish Government

Project documents obtained from www.CentralBidding.com
20-Mar-2017 10:47:56 AM

DATE: 3/20/2017

INVITATION TO BID
THIS IS NOT AN ORDER

Page: 1

BID NO.: 50-00119296

JEFFERSON PARISH
PURCHASING DEPARTMENT
P.O. BOX 9
GRETN, LA. 70054-0009
504-364-2678

VENDOR:

BUYER: SFOLSE

Bids will be received until 11:00 AM, 3/24/2017 via fax: 504-364-2693 or via online at www.jeffparishbids.net.

This site is free for all Jefferson Parish vendors. For additional information on registration or use of this free site, please see the text box highlighting electronic procurement.

All bids submitted are subject to these instructions and general conditions and any special conditions and specifications contained herein, all of which are made part of this bid proposal reference. By submitting a bid, vendor agrees to comply with all provisions of Louisiana Law, as well be in compliance with the Jefferson Parish Code of Ordinances, Louisiana Code of Ethics, applicable Jefferson Parish ethical standards and Jefferson Parish Resolution No. 113646 and/or Resolution No. 113647. A copy of these resolutions may be obtained from the Office of the Parish Clerk, Suite 6700, Jefferson Parish General Government Building, 200 Derbigny Street, Gretna, LA 70053. You may also obtain a copy by visiting the Purchasing Department webpage at purchasing.jeffparish.net and clicking on On-line forms.

All vendors submitting bids should register as a Jefferson Parish vendor if not already yet registered. Registration forms may be downloaded from <http://purchasing.jeffparish.net> and by clicking on Vendor Information. Current W-9 forms with respective Tax Identification numbers and vendor applications may be submitted at any time; however, if your company is not registered and/or a current W-9 form is not on file, vendor registration is mandatory. Further, a current W-9 form and respective Tax Identification number must be supplied upon contract execution, should you be awarded a contract and/or issued purchase order. Failure to do so may result in delay of payment.

As per LSA-RS 47:301 et seq., all governmental bodies are excluded from payment of sales taxes to any Louisiana taxing body. Quotations shall be based on F.O.B. Delivered, anywhere within the Parish as designated by the Purchasing Department. JEFFERSON PARISH WILL ACCEPT ONE BID ONLY FROM EACH VENDOR. Items bid must meet specifications. JEFFERSON PARISH will accept one price for each item unless otherwise indicated. Two or more prices for one item will result in bid rejection. Bidders are required to complete, sign and return the bid form and/or complete and return the associated line item pricing forms as indicated. The price quoted for work shall be stated in figures. In the event there is a difference in unit prices and totals, the unit prices shall prevail.

JEFFERSON PARISH reserves the right to award contracts or place orders on a lump sum or individual item basis, or such combination, as shall in its judgment be in the best interest of JEFFERSON PARISH. Every contract or order shall be awarded to the LOWEST RESPONSIVE and RESPONSIBLE BIDDER, taking into consideration the CONFORMITY WITH THE SPECIFICATIONS and the DELIVERY AND/OR COMPLETION DATE

PROTESTS: Only those vendors that submitted a bid in response to this solicitation may submit a protest in writing to the Director of the Purchasing within 48 hours of bid opening. The Purchasing Director will review it in connection with the Parish Attorney's Office as appropriate and a written response will be provided as soon as possible.

JEFFERSON PARISH reserves the right to cancel all or any part of an order if not shipped promptly. No charges will be allowed for parking or cartage unless specified in the quotation. The order must not be filled at a higher price than quoted. JEFFERSON PARISH reserves the right to cancel at any time and for any reason by issuing a THIRTY (30) day written notice to the contractor.

JEFFERSON PARISH requires all products to be new (current) and all work must be performed according to standard practices for the project. Unless otherwise specified, no aftermarket parts will be accepted. Unless otherwise specified, all workmanship and materials must have at least one (1) year guaranty, in writing, from the date of delivery and/or acceptance of the project. Any deviations or alterations from the specifications must be indicated and/or supporting documentation supplied with bid submission.

If this bid requires a pre-bid conference (see Additional Requirements section), bidders are advised that such conference will be held to allow bidders the opportunity to identify any discrepancies in the bid specifications and seek further clarification regarding instructions. The Purchasing Department will issue a written response to bidders' questions in the form of an Addendum.

All formal Addenda require written acknowledgment on the bid form by the bidder. Failure to acknowledge an Addendum on the bid form shall cause the bid to be rejected; JEFFERSON PARISH reserves the right to award bid to next lowest responsive and responsible bidder in this event.

USE OF BRAND NAMES AND STOCK NUMBERS: Where brand names and stock numbers are specified, it is for the purpose of establishing certain minimum standards of quality. Bids may be submitted for products of equal quality, provided brand names and stock numbers are specified. Complete product data may be required prior to award.

Quantities listed are for bidding purposes only. Actual requirements may be more or less than quantities listed.

Bidders are not to exclude from participation in, deny the benefits of, or subject to discrimination under any program or activity, any person in the United States on the grounds of race, color, national origin, or sex; nor discriminate on the basis of age under the Age Discrimination Act of 1975, or with respect to an otherwise qualified handicapped individual as provided in Section 504 of the Rehabilitation Act of 1973, or on the basis of religion, except that any exemption from such prohibition against discrimination on the basis of religion as provided in the Civil Rights Act of 1964, or Title VI and VII of the Act of April 11, 1968, shall also apply. This assurance includes compliance with the administrative requirements of the Revenue Sharing final handicapped discrimination provisions contained in Section 51.55 (c), (d), (e), and (k)(5) of the Regulations. New construction or renovation projects must comply with Section 504 of the 1973 Rehabilitation Act, as amended, in accordance with the American National Standard Institute's specifications (ANSI A117.1-1961).

Jefferson Parish and its partners as the recipients of federal funds are fully committed to awarding a contract(s) to firm(s) that will provide high quality services and that are dedicated to diversity and to containing costs. Thus, Jefferson Parish strongly encourages the involvement of minority and/or woman-owned business enterprises (DBE's, including MBE's, WBE's and SBE's) to stimulate participation in procurement and assistance programs.

INSTRUCTIONS FOR BIDDERS AND GENERAL CONDITIONS

IN ACCORDANCE WITH STATE REGULATIONS JEFFERSON PARISH OFFERS ELECTRONIC PROCUREMENT TO ALL VENDORS

This electronic procurement system allows vendors the convenience of reviewing and submitting bids online. This is a secure site and authorized personnel have limited read access only. Bidders are encouraged to submit electronically using this free service; while the website accepts various file types, one single PDF file containing all appropriate and required bid documents is preferred. Bidders submitting uploaded images of bid responses are solely responsible for clarity. If uploaded images/documents are not legible, then bidder's submission will be rejected. Please note all requirements contained in this bid package for electronic bid submission.

Please visit our E-Procurement Page at www.jeffparishbids.net to register and view Jefferson Parish solicitations. For more information, please visit the Purchasing Department page at <http://purchasing.jeffparish.net>.

ADDITIONAL REQUIREMENTS FOR THIS BID

PLEASE MATCH THE NUMBERS PRINTED IN THIS BOX WITH THE CORRESPONDING INSTRUCTIONS BELOW.

13

1. All bidders must attend the MANDATORY pre-bid conference and will be required to sign in and out as evidence of attendance. In accordance with LSA R.S. 38:2212(I), all prospective bidders shall be present at the beginning of the MANDATORY pre-bid conference and shall remain in attendance for the duration of the conference. Any prospective bidder who fails to attend the conference or remain for the duration shall be prohibited from submitting a bid for the project.
2. Attendance to this pre-bid conference is optional. However, failure to attend the pre-bid conference shall not relieve the bidder of responsibility for information discussed at the conference. Furthermore, failure to attend the pre-bid conference and inspection does not relieve the successful bidder from the necessity of furnishing materials or performing any work that may be required to complete the work in accordance with the specification with no additional cost to the owner.
3. Contractor must hold current applicable JEFFERSON PARISH licenses with the Department of Inspection and Code Enforcement. Contractor shall obtain any and all permits required by the JEFFERSON PARISH Department of Inspection and Code Enforcement. The contractor shall be responsible for the payment of these permits. All permits must be obtained prior to the start of the project. Contractor must also hold any and all applicable Federal and State licenses. Contractor shall be responsible for the payment of these permits and shall obtain them prior to the start of the project.
4. A LA State Contractor's License will be required in accordance with LSA R.S. 37-2150 et. seq. and such license number will be shown on the outside of the bid envelope. Failure to comply will cause the bid to be rejected. Additionally if submitting the bid electronically, then the license number must be entered in the appropriate field in the Electronic Procurement system. Failure to comply will cause the bid to be rejected.
5. It is the bidder's responsibility to visit the job site and evaluate the job before submitting a bid.
6. Job site must be clean and free of all litter and debris daily and upon completion of the contract. Passageways must be kept clean and free of material, equipment, and debris at all times. Flammable material must be removed from the job site daily because storage will not be permitted on the premises. Precautions must be exercised at all times to safeguard the welfare of JEFFERSON PARISH and the general public.

INSTRUCTIONS FOR BIDDERS AND GENERAL CONDITIONS

7. **PUBLIC WORKS BIDS:** All awards for public works in excess of \$5,000.00 will be reduced to a formal contract which shall be recorded at the contractor's expense with the Clerk of Court and Ex-Officio Recorder of Mortgages for the Parish of Jefferson. A price list of recordation costs may be obtained from the Clerk of Court and Ex-Officio Recorder of Mortgages for the Parish of Jefferson. All awards in excess of \$25,000.00 will require both a performance and a payment bond. Unless otherwise stated in the bid specifications, the performance bond requirements shall be 100% of the contract price. Unless otherwise stated in the bid specifications, the payment bond requirements shall be 100% of the contract price. Both bonds shall be supplied at the signing of the contract.
8. **NON-PUBLIC WORKS BIDS:** A performance bond will be required for this bid. The amount of the bond will be 100% of the contract price unless otherwise indicated in the specifications. The performance bond shall be supplied at the signing of the contract.
9. **NON-PUBLIC WORKS BIDS:** A payment bond will be required for this bid. The amount of the bond will be 100% of the contract price unless otherwise indicated in the specifications. The payment bond shall be supplied at the signing of the contract.
10. Unless otherwise stated in the bid specifications, the successful bidder will be required to procure standard insurance policies evidencing Parish-mandated insurance requirements as indicated on the attached "insurance requirements" sheet. All bidders must comply with the instructions in this sheet. Failure to comply will cause bid to be rejected.
11. A bid bond will be required with bid submission in the amount of 5% of the total bid, unless otherwise stated in the bid specifications. Acceptable forms shall be limited to cashier's check, certified check, or surety bid bond. All sureties must be in original format (no copies). If submitting a bid online, vendors must submit an electronic bid bond through the respective online clearinghouse bond management system(s) as indicated in the electronic bid solicitation on Central Auction House. No scanned paper copies of any bid bond will be accepted as part of the electronic bid submission.
12. This is a requirements contract to be provided on an as needed basis. JEFFERSON PARISH makes no representations on warranties with regard to minimum guaranteed quantities unless otherwise stated in the bid specifications.
13. Freight charges should be included in total cost when quoting. If not quoted FOB DELIVERED, freight must be quoted as a separate item. Bid may be rejected if not quoted FOB DELIVERED or if freight charges are not indicated on bid form.
14. **PUBLIC WORKS BIDS - Completed, Signed and Properly Notarized Affidavits Required;** This applies to all solicitations for construction, alteration or demolition of public buildings or projects, in conformity with the provisions contained in LSA-RS 38:2212.9, LSA-RS 38:2212.10, LSA-RS 38:2224, and Sec 2-923.1 of the Jefferson Parish Code of Ordinances. For bidding purposes, all bidders must submit with bid submission COMPLETED, SIGNED and PROPERLY NOTARIZED Affidavits, including: Non-Conviction Affidavit, Non-Collusion Affidavit, Campaign Contribution Affidavit, Debt Disclosures Affidavit and E-Verify Affidavit. For the convenience of vendors, all affidavits have been combined into one form entitled PUBLIC WORKS BID AFFIDAVIT. This affidavit must be submitted in its original format, and without material alteration, in order to be compliant and for the bid to be considered responsive. A scanned copy of the completed, signed and properly notarized affidavit may be submitted with the bid, however, the successful bidder must submit the original affidavit in its original format and without material alteration upon contract execution. Failure to comply will result in the bid submission being rejected as non-responsive. The Parish reserves the right to award bid to the next lowest responsive and responsible bidder in this event.
15. **NON PUBLIC WORK BIDS - Completed, Signed and Properly Notarized Affidavits Required** in conformity with the provisions contained in LSA – RS 38:2224 and Sec 2-923.1 of the Jefferson Parish Code of Ordinances. For bidding purposes, all bidders must submit with bid submission COMPLETED, SIGNED and PROPERLY NOTARIZED Affidavits, including: Non-Collusion Affidavit, Debt Disclosures Affidavit and Campaign Contribution Affidavit. For the convenience of vendors, all affidavits have been combined into one form entitled NON PUBLIC WORKS BID AFFIDAVIT. This affidavit must be submitted in its original format, and without material alteration, in order to be compliant and for the bid to be considered responsive. A scanned copy of the completed, signed and properly notarized affidavit may be submitted with the bid, however, the successful bidder must submit the original affidavit in its original format and without material alteration upon contract execution. Failure to comply will result in the bid submission being rejected as non-responsive. The Parish reserves the right to award bid to the next lowest responsive and responsible bidder in this event.
16. The ensuing contract for this bid solicitation may be eligible for FEMA reimbursement and/or Federal funding/reimbursement. As such, the referenced appendix will be applicable accordingly and shall be considered a part of the bid documents. All applicable certifications must be duly completed, signed and submitted with bid submission. Failure to submit applicable certifications with bid submission will result in bid rejection.

It shall be the duty of every parish officer, employee, department, agency, special district, board, and commission; and the duty of every contractor, subcontractor, and licensee of the parish, and the duty of every applicant for certification of eligibility for a parish contract or program, to cooperate with the Inspector General in any investigation, audit, inspection, performance review, or hearing pursuant to Jefferson Parish Code of Ordinances Section 2-155.10(19). By submitting a bid, vendor acknowledges this and will abide by all provisions of the referenced Jefferson Parish Code of Ordinances.

DATE: 3/20/2017

INVITATION TO BID
THIS IS NOT AN ORDER

Page: 4

BID NO.: 50-00119296

JEFFERSON PARISH

PURCHASING DEPARTMENT
P.O. BOX 9
GRETN, LA. 70054-0009
504-364-2678

VENDOR: _____

BUYER: SFOLSE

As per LSA-RS 47:301 et seq., all governmental bodies are excluded from payment of sales taxes to any Louisiana taxing body. Quotations shall be based on F.O.B. Agency warehouse or jobsite, anywhere within the Parish as designated by the Purchasing Department.

JEFFERSON PARISH reserves the right to cancel all or any part of an order if not shipped promptly. No charges will be allowed for parking or cartage unless specified in quotation. The order must not be filled at a higher price than quoted. JEFFERSON PARISH reserves the right to cancel at any time and for any reason by issuing a THIRTY (30) day written notice to the contractor.

JEFFERSON PARISH is expecting all products to be new and all work is to be done in a workman-like manner, according to standard practices. Any deviations or alterations from the specifications must be indicated and backup documentation supplied with your quotation.

DELIVERY: FOB JEFFERSON PARISH

INDICATE DELIVERY DATE ON EQUIPMENT AND SUPPLIES

2-3 wks

INDICATE STARTING TIME (IN DAYS) FOR CONSTRUCTION WORK

INDICATE COMPLETION TIME (IN DAYS) FOR CONSTRUCTION WORK

In the event that addenda are issued with this bid, bidders MUST acknowledge all addenda on the bid form. Bidder must acknowledge receipt of an addendum on the bid form as indicated. Failure to acknowledge any addendum on the bid form will result in bid rejection.

Acknowledge Receipt of Addenda: NUMBER: _____

NUMBER: _____

NUMBER: _____

NUMBER: _____

LOUISIANA CONTRACTOR'S LICENSE NO.: (if applicable) _____

*** ALL BIDDERS MUST COMPLETE SECTION BELOW ***

FIRM NAME:

SIGNATURE:

(Must be signed here)

TITLE:

PRINT OR TYPE NAME:

ADDRESS:

CITY, STATE:

ZIP:

TELEPHONE:

FAX:

EMAIL ADDRESS:

TOTAL PRICE OF ALL BID ITEMS: \$

19,237.73

INVITATION TO BID FROM JEFFERSON PARISH - continued

BID NO.: 50-00119296

SEALED BID

ITEM NUMBER	QUANTITY	U/M	DESCRIPTION OF ARTICLES	UNIT PRICE QUOTED	TOTALS
			ELECTRICAL STOCK SUPPLIES NEEDED FOR THE JEFFERSON PARISH EB SEWERAGE DEPARTMENT		
1	4.00	EA	0001 - Kit, solenoid rebuild, Asco Red-Hat part no. 224150 (0626480)	\$ 75 ¹⁰	\$ 300 ⁴⁰
2	6.00	EA	0002 - Kit, contact, auxiliary, Furnas no. 49AAFO, size 00 thru 3-1/2 (0851990)	\$ 46 ⁶⁸	\$ 280 ⁰⁸
3	30.00	EA	0003 - Fuse, glass, type 3AG, 5 AMP, Bussmann no. MDL-5 (0855380)	.64/	\$ 19 ²⁰
4	50.00	EA	0004 - Fuse, sub miniature, Cefco part, no. CMA-1.25 (0856960)	.65/	\$ 32 ⁵⁰
5	200.00	EA	0005 - Connector, female, Sta-Con, 12-10 wire range, insulated, T and B no. 10RC2577 (0870300)	.37/	\$ 74 ⁰⁰
6	300.00	EA	NSI # IFS12-250-3N 0006 - Connector, female, Sta-Con, 16-14 wire range, insulated, . T and B no. 14RB250F (0870380)	.09/	\$ 27 ⁰⁰
7	100.00	EA	NSI # F16-250-3V 0007 - Ring, Sta-Kon, 12-10, no. 10 insulated, Thomas and Betts no. 10RC10 (0870580)	.15/	\$ 15 ⁰⁰
8	200.00	EA	NSI # R12-10V 0008 - Ring, Sta-Kon, 12-10, 1/4 hole, insulated, Thomas and Betts no. 10RC14 (0870590)	.18/	\$ 36 ⁰⁰
9	8.00	EA	NSI # R12-14V 0009 - Switch, pressure, adjustable range 5-80 PSI, Barksdale model no. D1H-A80 (0872630)	\$ 199 ¹⁷	\$ 1,593 ³⁶
10	6.00	EA	0010 - Switch, safety, 100 amp, 240 volt, 4 wire, fusible, type 3R EQUAL GE # TG 4323R	\$ 148 ⁴³	\$ 890 ⁵⁸

INVITATION TO BID FROM JEFFERSON PARISH - continued

BID NO.: 50-00119296

SEALED BID

ITEM NUMBER	QUANTITY	U/M	DESCRIPTION OF ARTICLES	UNIT PRICE QUOTED	TOTALS
11	2.00	EA	enclosure, Cutler Hammer no. DG323NRB (0874000) 0011 - Switch, disconnect, rainproof, 30A, 240 VAC, 3 poles, 4 wire, 3 fuses, GE no. TG4321R (0874010)	\$ 492 ³	\$ 984 ⁶
12	6.00	EA	0012 - Switch, safety, 60 amperes, 240 volt, non-fusible, type 3R enclosure, Cutler-Hammer no. DG322URB (087406A) GE # TGN3322R	\$ 840 ⁵	\$ 504 ³⁰
13	3.00	EA	0013 - Switch, safety, 100 amp, 600 volt, 3 pole, non-fusible, NEMA 3R, with 2 in hub, Cutler-Hammer no. DH363UR (0874140) GE # THN 3363R w/hub	\$ 216 ⁰⁸	\$ 648 ²⁴
14	100.00	EA	0014 - Connector, cable, nonmetallic sheathed (Romex), die cast zinc, two screw, 3/8 in for 1/2 in KO, 14-2 to 12-2 cable, Appleton no. C-500 (087796A) ARZN # 841	.159	\$ 1590
15	50.00	EA	0015 - Strap, 2 hole, for 1-1/4 inch emt conduit (0879990) ARZN # 363	.16	\$ 800
16	16.00	EA	0016 - Holder, fuse, 30 amperes, 600 volt, 3 pole, Shawmut no. 30353 (0880260) Bussman # BC6033B	\$ 2789	\$ 44624
17	6.00	EA	0017 - Cap, service entrance, 2 in, aluminum, clamp type, Peco no. 175 (0880300) ARZN # 145	\$ 734	\$ 4404
18	20.00	EA	0018 - Receptacle, duplex, brown, 15 amp, 125 volt, Pass and Seymour no. 3232 (0880620)	.60	\$ 1200
19	12.00	EA	0019 - Fixture body, Hubbell no. VFC-100	\$ 2870	\$ 34440

DATE: 3/20/2017

INVITATION TO BID FROM JEFFERSON PARISH - continued

Page: 7

BID NO.: 50-00119296

SEALED BID

ITEM NUMBER	QUANTITY	U/M	DESCRIPTION OF ARTICLES	UNIT PRICE QUOTED	TOTALS
20	30.00	EA	(0880700) 0020 - Cover, duplex outlet, brown (0880880)	.27/	\$ 8 ¹⁰
21	50.00	EA	0021 - Connector, female, two conductor grounded, 15 amperes, 125 VAC, Woodhead no. 1547 (0881000)	\$ 11 ¹⁹	\$ 559 ⁵⁰
22	60.00	EA	0022 - Fixture, fluorescent, Lithonia no. DMW248HOAR*CW20 or equal, 120/277volt, for wet location for 2-F48T12HO high output 54 watt lamps (0881200) <i>Quoting LED</i> <i>LED # LLVT-4FT-40W-50K-D</i>	\$ 103 ⁵⁵	\$ 6,213 ⁶⁰
23	6.00	EA	0023 - Nipple, aluminum conduit, 1-1/2 inch x 2 inch long (0881880)	\$ 4 ¹⁰	\$ 24 ⁶⁰
24	1,250.00	LF	0024 - Wire, Romex, 12/2 with ground, type NMB12/2WGRD, 250 ft per carton, PVC Jacket (0882760)	.23/	\$ 287 ⁵⁰
25	100.00	LF	0025 - Wire, electrical, no. 14 stranded 4-conductor SOW-A/SO, ul listed, black neoprene jacket, copper (0882800)	.55/	\$ 55 ⁰⁰
26	10.00	EA	0026 - Relay, triplexor alternator, 120 volt, 3 pump led's, 1 power led, Sta-Con brand no. 009-120-23 (0858010)	\$ 314 ³⁴	\$ 3,143 ⁴⁰
27	36.00	EA	0027 - Base, relay, 8-pin, SPDT/DPDT/3PDT, 10 amp, 300 volt, Iddec no. SR2P-05 (0858450)	\$ 4 ⁹²	\$ 177 ¹²
28	20.00	EA	0028 - Switch, micro, style 1, 15 amperes, SPDT, steel rod actuator, part no. 1AC2 (0872510)	\$ 65 ⁴⁹	\$ 1309 ⁸⁰

DATE: 3/20/2017

Page: 8

INVITATION TO BID FROM JEFFERSON PARISH - continued

BID NO.: 50-00119296

SEALED BID

ITEM NUMBER	QUANTITY	U/M	DESCRIPTION OF ARTICLES	UNIT PRICE QUOTED	TOTALS
29	9.00	EA	0029 - Lever, standard, micro switch part no. MS-LSZ51D (0873070)	\$ 10. ⁹³	98. ³⁷
30	6.00	EA	0030 - Switch, micro limit, Honeywell no. 1LS1-L (0873110)	\$ 156. ⁴⁴	\$ 938. ⁴⁴
31	50.00	EA	0031 - Locknut, conduit, 3/4 in, bonding type, Appleton no. GL-75 (0879470)	\$ 1. ⁰⁹	54. ⁵⁰
32	2.00	EA	0032 - Motor, electric, 5 HP, 1725 RPM, 230/460 VAC, 3 phase, NEMA 184T, Baldor no. M3615T, TEFC (0891150)	\$ 489. ²⁵	\$ 978. ⁵⁰

[Home](#) / [Products](#) / [Miniterms, Switches and Indicator Lights](#) / [Spade, Ring, Locking and Other Terminals](#) / 12-10 Nylon Fully Insulated

12-10 Nylon Fully Insulated



Part # IFS12-250-3N

12-10 AWG Nylon Insulated, 50/Pack

In Stock

Item #5

Mouse over image for enlarged view

[Zoom](#)[Share](#)

Product Information

Documents

Type:	Nylon Fully Insulated Female Sleeved Barrel
Wire Size:	12-10 AWG
Terminal Size:	.250 x .032
Material:	Nylon Insulation
Color:	Yellow
Voltage Rating:	600 V
Temp Rating:	105 C
Number Of Terminals:	1
Application:	Wire Termination
Standard:	cULus

Related Products

**Easy-Twist™ Winged Blue**
- Bulk

WWC-B

[View Details](#)**Easy-Twist™ Winged Yellow**
- Bulk

WWC-Y

[View Details](#)**Polaris™ Grey Multi-Tap**
3/0 2 Port OS

ITOG-3/0

[View Details](#)**Toggle Switch Bat**

78160TS

[View Details](#)

Home / Products / Miniterms, Switches and Indicator Lights / Spade, Ring, Locking and Other Terminals / 16-14 Vinyl Female Disc, 100 Per Pack

16-14 Vinyl Female Disc, 100 Per Pack



Part # F16-250-3V
16-14 AWG Vinyl Insulated Female Disc ,250X.032 Tab - 100 Per Pack
In Stock

Item # 6

Mouse over image for enlarged view

Zoom Share

Product Information Documents

Type:	Vinyl Insulated Female Disconnect
Wire Size:	16-14 AWG
Terminal Size:	.250 x .032
Material:	Vinyl Insulation
Color:	Blue
Voltage Rating:	300 V
Temp Rating:	75 C
Number Of Terminals:	1
Application:	Wire Termination
Standard:	cULus

Related Products



Easy-Twist™ Winged Blue
- Bulk

WWC-B

[View Details](#)



Easy-Twist™ Winged
Yellow - Bulk

WWC-Y

[View Details](#)



Polaris™ Grey Multi-Tap
3/0 2 Port OS

ITOG-3/0

[View Details](#)



Toggle Switch Bat

78160TS

[View Details](#)

Home / Products / Miniterms, Switches and Indicator Lights / Spade, Ring, Locking and Other Terminals / 12-10 Vinyl Ring #10 Stud, 50 Per Pack

12-10 Vinyl Ring #10 Stud, 50 Per Pack



Part # R12-10V

12-10 AWG Vinyl Insulated Ring #10 Stud, 50 Per Pack

In Stock

Item #7

Mouse over image for enlarged view

Zoom

Share

Product Information

Documents

Type:	Vinyl Insulated Ring Terminal
Wire Size:	12-10 AWG
Terminal Size:	# 10
Material:	Vinyl Insulation
Color:	Yellow
Voltage Rating:	300 V
Temp Rating:	75 C
Number Of Terminals:	1
Application:	Wire Termination
Standard:	cULus

Related Products



**Easy-Twist™ Winged Blue
- Bulk**

WWC-B

[View Details](#)



**Easy-Twist™ Winged
Yellow - Bulk**

WWC-Y

[View Details](#)



**Polaris™ Grey Multi-Tap
3/0 2 Port OS**

ITOG-3/0

[View Details](#)



Toggle Switch Bat

78160TS

[View Details](#)

[Home](#) / [Products](#) / [Miniterms, Switches and Indicator Lights](#) / [Spade, Ring, Locking and Other Terminals](#) / 12-10 Vinyl Ring 1/4" Stud, 50 Per Pack

12-10 Vinyl Ring 1/4" Stud, 50 Per Pack



Part # R12-14V

12-10 AWG Vinyl Insulated Ring 1/4" Stud, 50 Per Pack

In Stock

Item #8

Mouse over image for enlarged view

[Zoom](#)[Share](#)

Product Information

Documents

Type:	Vinyl Insulated Ring Terminal
Wire Size:	12-10 AWG
Terminal Size:	1/4
Material:	Vinyl Insulation
Color:	Yellow
Voltage Rating:	300 V
Temp Rating:	75 C
Number Of Terminals:	1
Application:	Wire Termination
Standard:	cULus

Related Products

Easy-Twist™ Winged Blue
- Bulk

WWC-B

[View Details](#)Easy-Twist™ Winged
Yellow - Bulk

WWC-Y

[View Details](#)Polaris™ Grey Multi-Tap
3/0 2 Port OS

ITOG-3/0

[View Details](#)

Toggle Switch Bat

78160TS

[View Details](#)

**Catalog No. TG4323R****Description: 100A 3P GD N3R 240V FUSIBLESW****UPC No 783164008661****Products > Switches & Disconnects > Disconnect & Safety Switches > Safety Switches > General Duty**

- Designed for residential and light commercial applications where duty is not severe.
- Listed to UL standard 98 enclosed and dead front switches.
- Suitable for use as service equipment when installed in accordance with the National Electrical Code.
- Certified to CSA standard 22.2 no. 4-04 enclosed and dead front switches.
- Meets or exceeds NEMA KS1 standard for enclosed switches - type GD.
- Fusible and non-fusible switches available (consult BuyLog for interrupt ratings).
- Quick-make, quick-break mechanism (30-200 amp).
- 60/75°C conductor rating.

Descriptors

Category	General Duty
----------	--------------

Specifications

Amperage	100 A
Poles	3
Wires	4
Fusing	Fusible
Enclosure	NEMA 3R (Outdoor)
Wire Range (Cu/Al)	10-1/0
240 Vac, NEC Std, 1-ph	7.5 hp
240 Vac, NEC Std, 3-ph	15.0 hp
240 Vac, Time Delay, 1-ph	15.0 hp
240 Vac, Time Delay, 3-ph	30.0 hp
250 Vdc	20.0 hp
GSA Compliance	Yes

Classifications

CSA Certified	Yes
---------------	-----

Dimensions

Height	21.0 in
Depth	5.0 in
Width	9.3 in
Weight	17.0 lb

**Catalog No. TGN3322R****Description: 60A 3P GD N3R 240V NONFUSE SW****UPC No 783164008791****Products > Switches & Disconnects > Disconnect & Safety Switches > Safety Switches > General Duty**

- Designed for residential and light commercial applications where duty is not severe.
- Listed to UL standard 98 enclosed and dead front switches.
- Certified to CSA standard 22.2 no. 4-04 enclosed and dead front switches.
- Meets or exceeds NEMA KS1 standard for enclosed switches - type GD.
- Fusible and non-fusible switches available (consult BuyLog for interrupt ratings).
- Quick-make, quick-break mechanism (30-200 amp).
- 60/75°C conductor rating.

Descriptors

Category

General Duty

Specifications

Amperage

60 A

Poles

3

Wires

3

Fusing

No Fuse

Enclosure

NEMA 3R (Outdoor)

Wire Range (Cu/Al)

12-2

240 Vac, NEC Std, 1-ph

10.0 hp

240 Vac, NEC Std, 3-ph

15.0 hp

250 Vdc

10.0 hp

GSA Compliance

Yes

Classifications

CSA Certified

Yes

Dimensions

Height

13.7 in

Depth

3.9 in

Width

8.4 in

Weight

10.0 lb

**Catalog No. THN3363R****Description: 100A 3P HD N3R 600V NONFUSE SW****UPC No 783164011333****Products > Switches & Disconnects > Disconnect & Safety Switches > Safety Switches > Heavy Duty**

- Designed for commercial and industrial applications where safety, high performance and continuity of service are essential.
- Listed to UL standard 98 enclosed and dead front switches.
- Suitable for use as service equipment when installed in accordance with the National Electrical Code.
- Certified to CSA standard 22.2 no. 4-04 enclosed and dead front switches.
- Meets or exceeds NEMA KS1 standard for enclosed switches - type HD.
- Fusible and non-fusible switches available (consult BuyLog for interrupt ratings).
- Quick-make, quick-break mechanism.
- 60/75°C conductor rating.
- Full cover interlocks.

Descriptors

Category	Heavy Duty
GO Schedule	S1

Specifications

Voltage	600 AC
Amperage	100 A
Poles	3
Wires	3
Fusing	No Fuse
Enclosure	NEMA 3R (Outdoor)
Options	None
Wire Range (Cu/Al)	10-1/0
240 Vac, NEC Std, 1-ph	20.0 hp
240 Vac, NEC Std, 3-ph	40.0 hp
480 Vac, NEC Std, 1-ph	30.0 hp
480 Vac, NEC Std, 3-ph	75.0 hp
600 Vac, NEC Std, 1-ph	40.0 hp
600 Vac, NEC Std, 3-ph	100.0 hp
250 Vdc	20.0 hp
GSA Compliance	Yes

Classifications

CSA Certified	Yes
UL Listed	Yes

Dimensions

Height	17.3 in
Depth	4.9 in
Width	9.3 in

SNAP-TITE®

Connectors

With spring steel clip. For NM • SE
• MCI • MCIA • Flex • AC cable. For
steel and aluminum jacketed cables.
Zinc die-cast.



840ST



8400ST

CATALOG NUMBER	UPC/DCI/NAED MFG #018997	TRADE SIZE	KO SIZE	UNIT PKG	STD PKG	DIM A	DIM B	DIM C	CABLE RANGE
840ST	80070	3/8	1/2	100	1000	.485	.879	.858	.225 - .612
8400ST	80074	3/8	1/2	100	1000	.485	.879	.858	.225 - .612

Refer to pages C-13 and C-14 for complete cable ranges.

SNAP-TITE® products have been tested and listed by UL in accordance with UL's ground fault requirements. For additional information see page 7.

For connectors that cost less and install faster see page C-8.

PATENTED.



E28474 LR49636

See Page E-1 for ring
removal instructions

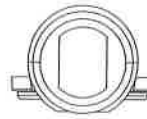

840ST



8400ST

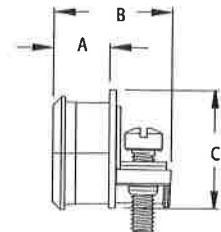

NM Cable Connector

For NM cable. Zinc die-cast.



CATALOG NUMBER	UPC/DCI/NAED MFG #018997	TRADE SIZE	KO SIZE	UNIT PKG	STD PKG	DIM A	DIM B	DIM C	CABLE RANGE
841	00841	3/8	1/2	100	1000	.422	.825	1.105	.225 - .612

Refer to pages C-13 and C-14 for complete cable ranges.

For connectors that cost less and install faster see page C-8.



E28474 LR49636

Item 14

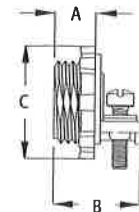

SNAP-TITE®

Connector

With spring steel clip. For NM cable.
Zinc die-cast.



CATALOG NUMBER	UPC/DCI/NAED MFG #018997	TRADE SIZE	KO SIZE	UNIT PKG	STD PKG	DIM A	DIM B	DIM C	CABLE RANGE
841ST	80068	3/8	1/2	100	1000	.510	.912	.920	.225 - .612

Refer to pages C-13 and C-14 for complete cable ranges.

SNAP-TITE® products have been tested and listed by UL in accordance with UL's ground fault requirements. For additional information see page 7.

PATENTED.



E28474 LR49636

See Page E-1 for ring
removal instructions

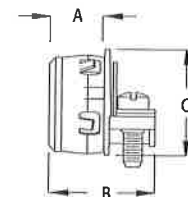



Arlington

Heavy-Duty 1-Hole EMT Straps

Plated steel, Click-on.



CATALOG NUMBER	UPC/DCI/NAED MFG #018997	EMT SIZE	UNIT PKG	STD PKG	DIM A	DIM B	DIM C	DIM D
370	00370	1/2	100	1000	1.700	.700	.562	.250
371	00371	3/4	100	1000	1.935	.975	.625	.250
372	00372	1	50	500	2.210	2.210	.750	.312
373	00373	1-1/4	25	250	2.800	2.800	.875	.375
374	00374	1-1/2	25	100	3.140	3.140	1.000	.375
375	00375	2	25	100	3.890	3.890	1.125	.437
346	00346	2-1/2	25	25	4.927	4.927	1.250	.562
347	00347	3	25	25	5.560	5.560	1.250	.562
348	00348	3-1/2	10	10	6.337	6.337	1.250	.562
349	00349	4	10	10	6.811	6.811	1.250	.562



E186443 LR104691

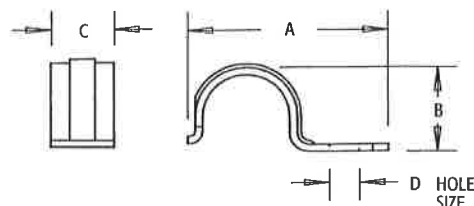

2-Hole EMT Straps

Plated steel, Click-on.



Item 15

CATALOG NUMBER	UPC/DCI/NAED MFG #018997	EMT SIZE	UNIT PKG	STD PKG	DIM A	DIM B	DIM C	DIM D
360	00360	1/2	100	1000	2.200	.790	.562	.187
361	00361	3/4	50	500	2.700	.980	.625	.187
362	00362	1	50	250	2.975	1.185	.688	.187
363	00363	1-1/4	50	250	3.650	1.535	.750	.253
364	00364	1-1/2	25	250	4.250	1.670	.875	.253
365	00365	2	25	250	4.775	2.300	1.000	.375
356	00356	2-1/2	25	100	5.850	2.855	1.000	.375
357	00357	3	25	25	6.460	3.425	1.000	.375
358	00358	3-1/2	10	10	7.300	3.925	1.000	.375
359	00359	4	10	10	7.895	4.390	1.000	.375

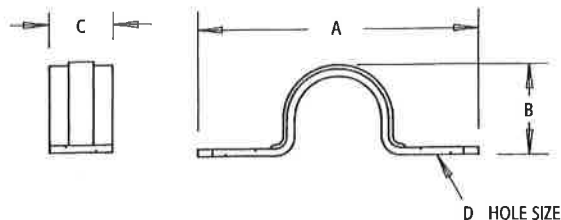

Class CC, Type M and Class G Fuse Blocks

BC Series

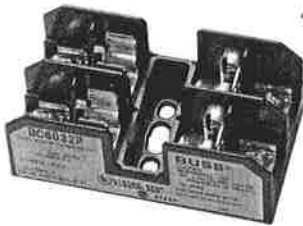

Specifications

Description: Class CC fuse blocks for use with Class CC fuses (Bussmann LP-CC, KTK-R, and FNQ-R).

Dimensions: See Data Sheet 1105

Poles: 1 to 3

Ratings:

Volts: — 600V

Amps: — 1/4-30A

SCCR: — 200kA RMS Sym.

Agency Information: CE, UL Listed (Guide IZLT, File E14853), CSA (Class 6225-01, File 47235)

Flammability Rating: UL 94V0

DIN-Rail Adapters: See page 413 for DRA-1 & DRA-2

Catalog Numbers

Terminal Type				
Screw	Screw with Quick Connect*	Pressure Plate	Pressure Plate w/ Quick Connect*	Box Lug
BC6031S	BC6031SQ	BC6031P	BC6031PQ	BC6031B
BC6032S	BC6032SQ	BC6032P	BC6032PQ	BC6032B
BC6033S	BC6033SQ	BC6033P	BC6033PQ	BC6033B
				↓ Poles
				1
				2
				3

Data Sheet: 1105

BCCM Series

Description: 3-pole fuse block for use with (2) Class CC fuses and (1) 1/2" x 1 1/2" fuse

Catalog Numbers

Catalog Numbers	Terminal Type
BCCM6033SQ	Screw with Quick-Connect*
BCCM6033PQ	Pressure Plate w/Quick-Connect*

*Quick-connect terminal rated for 20A max.

Recommended Cover Puller

- PF1-WH (White)
- PF1-BK (Black)

BM Series Type M

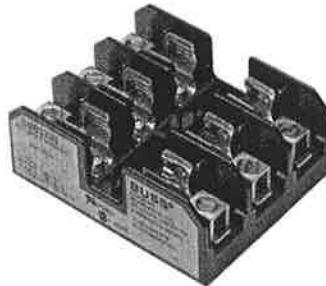

Specifications

Description: Supplementary fuse blocks for use with any 1/2" x 1 1/2" fuses (Bussmann KTK, PVM, FNQ, FNM, BAF, PV, and AGU).

Dimensions: See Data Sheet 1104

Poles: 1 to 3

DIN-Rail Adapters: See page 413 for DRA-1 & DRA-2

Ratings:

Volts: — 600Vac/dc

Amps: — 1/4-30A

SCCR: — 10kA RMS Sym.

Agency Information: CE, UL Recognized (Guide IZLT2, File E14853), CSA (Class 6225-01, File 47235).

Flammability Rating: UL 94V0.

Catalog Numbers

Terminal Type			
Screw with Quick Connect*	Pressure Plate w/ Quick Connect*	Box Lug	Poles
BM6031SQ	BM6031PQ	BM6031B	1
BM6032SQ	BM6032PQ	BM6032B	2
BM6033SQ	BM6033PQ	BM6033B	3

*20A max for Quick Connect terminals.

Recommended Cover Puller

- PF1-WH (White)
- PF1-BK (Black)

Data Sheet: 1104

BG & G Series



Specifications

Description: Class G fuse blocks for use with Class G fuses (Bussmann SC).

Dimensions: See Data Sheet 1106

Poles: 1 to 3

Ratings:

Volts: — 600Vac/dc (0-20A)

— 480Vac/dc (25-60A)

Amps: — 1-60A (See Catalog Numbers table)

SCCR: — 100kA RMS Sym.

Agency Information: CE, UL Listed 35-60A (Guide IZLT, File E14853), UL Recognized 1-30A, (Guide IZLT2, File E14853), CSA (Class 6225-01, File 47235).

DIN-Rail Adapters: See page 413 for DRA-1 & DRA-2.

Catalog Numbers

Terminal Type				
Screw with Quick Connect*	Pressure Plate w/ Quick Connect*	Box Lug	Box Lug w/retaining clip	Amps
BG3011SQ	BG3011PQ	BG3011B	—	1
BG3012SQ	BG3012PQ	BG3012B	—	1-15
BG3013SQ	BG3013PQ	BG3013B	—	2
BG3021SQ	BG3021PQ	BG3021B	—	3
BG3022SQ	BG3022PQ	BG3022B	—	1
BG3023SQ	BG3023PQ	BG3023B	—	20
BG3031S	BG3031P	BG3031B	—	2
BG3032S	BG3032P	BG3032B	—	3
BG3033S	BG3033P	BG3033B	—	1
—	—	—	G30060-1CR	25-30
—	—	—	G30060-2CR	2
—	—	—	G30060-3CR	3

Recommended Cover Puller

- PF1-WH (White)
- PF1-BK (Black)

Data Sheet: 1106

Service Entrance Hoods

Non-metallic.



CATALOG NUMBER	UPC/DCI/NAED MFG #018997	CABLE SIZES	STD PKG	DIM A	DIM B	DIM C
EH200	58201	(3) 1/0 to (3) 2/0	1	4.250	6.000	2.000
EH201	43630	(3) 1/0 to (3) 4/0	1	6.000	6.187	2.500

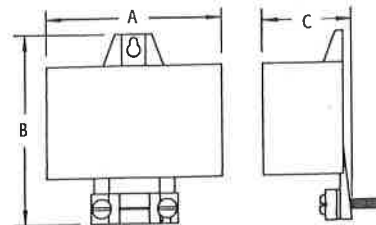

Entrance Caps Clamp-On Type

For rigid • IMC • EMT.



Item # 17

CATALOG NUMBER	UPC/DCI/NAED MFG #018997	TRADE SIZE	UNIT PKG	STD PKG	DIM A	DIM B	HOLE SIZES
140	00140	1/2	10	10	2.60	2.68	(4) .30
141	00141	3/4	10	10	2.72	3.80	(2) .38 (3) .40
142	00142	1	10	10	3.11	3.32	(2) .44 (3) .50
143	00143	1-1/4	5	25	3.20	4.46	(2) .42 (3) .63
144	00144	1-1/2	3	15	4.34	4.85	(2) .60 (3) .75
145	00145	2	10	10	4.55	6.62	(2) .75 (3) 1.00 (1) .53
146	00146	2-1/2	1	1	7.80	9.74	(3) 1.31 (3) .87 (1) .99
147	00147	3	1	1	8.00	10.50	(3) 1.73 (4) 1.10
148	00148	3-1/2	1	1	9.25	12.50	(3) 1.73 (4) 1.10
149	00149	4	1	1	9.25	12.50	(3) 1.73 (4) 1.10

See Page F-1 for PVC alternatives.

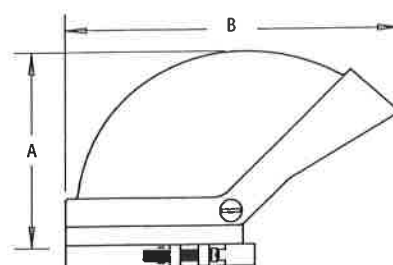



5320-CP



Color:



Brown

UPC Code: 07847715130

NEMA:
5-15R



5320-CP

Brand Features

Leviton's comprehensive Residential Grade Receptacles portfolio includes devices rated for all residential applications in a variety of standard configurations. They are produced in an array of colors in both Decora and traditional styles. All duplex receptacles are designed with thermoplastic construction and feature a shallow build for maximum wiring room. Each duplex is also equipped with break-off plaster ears and tabs to allow for easy alignment and two-circuit conversion.

Item Description

15 Amp, 125 Volt, NEMA 5-15R, 2P, 3W, With Ears Duplex Receptacle, Straight Blade, Residential Grade, Grounding, All Screws Backed Out Contractor Pack, Quickwire Push-In & Side Wired, Steel Strap, - Brown

Technical Information

Product Features

Strap Material: Steel

Grounding: Grounding

Face Material: Thermoplastic

Warranty: 2 Year Limited

Color: Brown

Termination: Quickwire Push-In & Side

Wire: 3

Feature: All Screws Backed Out

NEMA: 5-15R

Body Material: Thermoplastic

Voltage: 125 Volt

Amperage: 15 Amp

Standards and Certifications: UL

Pole: 2

Item # 18

Item # 27

CR420

Plug-In Relays

Outlines and Dimensions

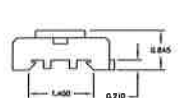

CR420KA2 Socket

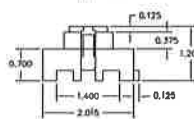

CR420KA3 Socket

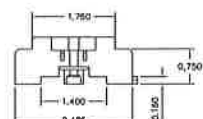

CR420MA Socket

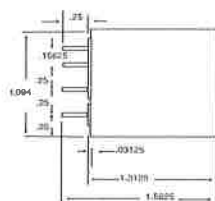

CR420MP

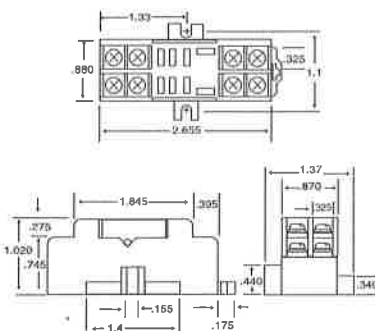
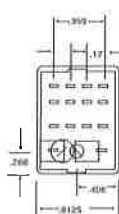

CR420NA2 Socket

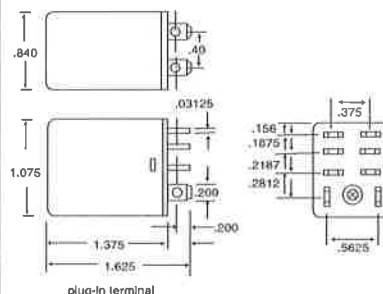

CR420N SPDT/DPDT

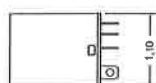
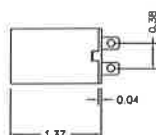

CR420NT SPDT/DPDT

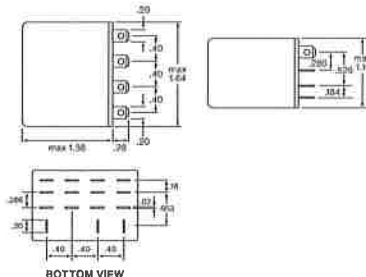

CR420NP 4PDT



Product Number Selection Instructions: See page 10-2

Item 22

WESTGATE

THE FUTURE IS HERE...AND IT'S QUITE BRIGHT!

JOB NAME: _____

DATE: _____

TYPE: _____



DIMENSIONS:

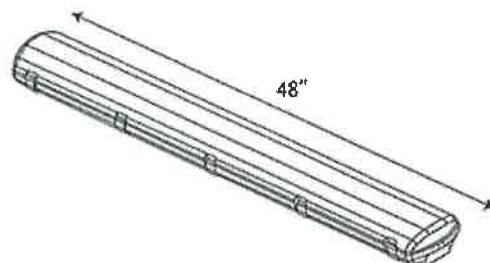

LLVT-4FT-40W-50K-D LLVT-4FT-40W-40K-D

LED Linear Vapor Light

Ideal for one-on-one replacement of conventional lighting systems such as HID and fluorescent.

ELECTRICAL SPECIFICATIONS:

- Voltage: 100~277 AC
- Wattage: 40W
- Lumens: 4400LM
- Color temperatures: 5000K and 4000K
- CRI: >80
- Power factor: >0.95
- Operating Temperature: -30°~110°F
- Dimmable (0~10V dimming)
- Housing: Polycarbonate
- Clamps: Stainless steel
- Lens: Opal PC
- LED SMD type: Edison 2835
- Driver: Towin

CERTIFICATIONS:

- Tested in accordance with IESNA LM-79 and LM-80 standard.



- Consult factory for special orders: Emergency Battery Backup, Motion Sensor, Step-dimming Sensor, and any other color temperature.

WESTGATE MFG., INC

2041 Davie Avenue, Commerce, CA 90040 • Phone: (877) 805-2252 • Fax (877) 809-2252

APPLICATION:

- Westgate LED Vaportight fixture is ideal for parking garages, industrial freezers, livestock's livery, under awnings and balconies, and other harsh & wet environment lighting applications. The Westgate LED Vapors can endure dust, dirt, vapor, smoke, high levels of humidity, and risk of corrosion.

CONSTRUCTION:

- Westgate LED Vapor Tight Fixture features lightweight, flexible and durable polycarbonate body with UV stabilized PC housing and lens that are constructed to resist breakage and are lineal ribbed to reduce glare. Designed for easy mounting and maintenance with an easy to move gear tray.

ELECTRONICS:

- Long-life LED system coupled with electrical driver to deliver optimal performance. LED's available in 4000 and 5000K with a CRI >82. Electronic drivers are available for 120-277V applications. A 0-10V(1-10V) dimming control is available.

WARRANTY: 5 years