

LA CONTRACTING ENTERPRISE, LLC  
1645 ST. PATRICK ST  
THIBODAUX, LA 70301  
bidding@la-cont.com  
985-446-2212  
STATE LICENSE NO. 34263

TO:

Jefferson Parish  
Purchasing Department  
200 Derbigny Street, Suite 4400  
Gretna, LA 70053

OWNER:

Jefferson Parish  
Purchasing Department  
200 Derbigny Street, Suite 4400  
Gretna, LA 70053

PROJECT NAME:

Construction of COVID Memorial Park

PROJECT NO:

50-00142373

BID DATE & TIME:

June 27, 2023 @ 2:00 PM

ADDENDUM:

#1(6-22-23)

SEALED BID

LOUISIANA UNIFORM PUBLIC WORK BID FORM

TO: Jefferson Parish Purchasing  
200 Derbigny Street, Suite 4400  
Gretna, La. 70053

BID FOR: COVID Memorial Park

Bid # 50-00142373

Revised as per Addenda # 1

(Owner to provide name and address of owner)

(Owner to provide name of project and other identifying information)

The undersigned bidder hereby declares and represents that she/he: a) has carefully examined and understands the Bidding Documents, b) has not received, relied on, or based his bid on any verbal instructions contrary to the Bidding Documents or any addenda, c) has personally inspected and is familiar with the project site, and hereby proposes to provide all labor, materials, tools, appliances and facilities as required to perform, in a workmanlike manner, all work and services for the construction and completion of the referenced project, all in strict accordance with the Bidding Documents prepared by: Manning, APC and dated: 6/22/2023

(Owner to provide name of entity preparing bidding documents.)

Bidders must acknowledge all addenda. The Bidder acknowledges receipt of the following **ADDENDA**: (Enter the number the Designer has assigned to each of the addenda that the Bidder is acknowledging) #1(6-22-23)

**TOTAL BASE BID:** For all work required by the Bidding Documents (including any and all unit prices designated "Base Bid" \* but not alternates) the sum of:

Two million, eight hundred sixty two thousand & no cents 2,862,000.00 Dollars (\$           )

**ALTERNATES:** For any and all work required by the Bidding Documents for Alternates including any and all unit prices designated as alternates in the unit price description.

**Alternate No. 1 (1 (One) Year Landscape Maintenance Costs for COVID Memorial Project )** for the lump sum of:

thirty eight thousand & no cents 38,000.00 Dollars (\$           )

**Alternate No. 2 (Owner to provide description of alternate and state whether add or deduct)** for the lump sum of:

N/A Dollars (\$           )

**Alternate No. 3 (Owner to provide description of alternate and state whether add or deduct)** for the lump sum of:

N/A Dollars (\$           )

**NAME OF BIDDER:** LA Contracting Enterprise, LLC

**ADDRESS OF BIDDER:** 1645 Saint Patrick Street

Thibodaux, LA 70301

**LOUISIANA CONTRACTOR'S LICENSE NUMBER:** 34263

**NAME OF AUTHORIZED SIGNATORY OF BIDDER:** Jeremy Landry

**TITLE OF AUTHORIZED SIGNATORY OF BIDDER:** Member

**SIGNATURE OF AUTHORIZED SIGNATORY OF BIDDER \*\*:** 

**DATE:** 6-27-2023

**THE FOLLOWING ITEMS ARE TO BE INCLUDED WITH THE SUBMISSION OF THIS LOUISIANA UNIFORM PUBLIC WORK BID FORM:**

\* The Unit Price Form shall be used if the contract includes unit prices. Otherwise it is not required and need not be included with the form. The number of unit prices that may be included is not limited and additional sheets may be included if needed.

\*\* A **CORPORATE RESOLUTION OR WRITTEN EVIDENCE** of the authority of the person signing the bid for the public work as prescribed by LA R.S. 38:2212(B)(5).

**BID SECURITY** in the form of a bid bond, certified check or cashier's check as prescribed by LA R.S. 38:2218(A) attached to and made a part of this bid.

**Public Works Bid**

**AFFIDAVIT**

**STATE OF** Louisiana

**PARISH/COUNTY OF** Lafourche

BEFORE ME, the undersigned authority, personally came and appeared: Jeremy  
Landry, (Affiant) who after being by me duly sworn, deposed and said that  
he/she is the fully authorized Member LA Contracting Enterprise, LLC  
of \_\_\_\_\_ (Entity),  
the party who submitted a bid in response to Bid Number 50-00142373, to the Parish of  
Jefferson.

Affiant further said:

Campaign Contribution Disclosures

**(Choose A or B, if option A is indicated please include the required attachment):**

**Choice A** \_\_\_\_\_ Attached hereto is a list of all campaign contributions, including the date and amount of each contribution, made to current or former elected officials of the Parish of Jefferson by Entity, Affiant, and/or officers, directors and owners, including employees, owning 25% or more of the Entity during the two-year period immediately preceding the date of this affidavit or the current term of the elected official, whichever is greater. Further, Entity, Affiant, and/or Entity Owners have not made any contributions to or in support of current or former members of the Jefferson Parish Council or the Jefferson Parish President through or in the name of another person or legal entity, either directly or indirectly.

**Choice B** X there are **NO** campaign contributions made which would require disclosure under Choice A of this section.

Affiant further said:

Debt Disclosures

**(Choose A or B, if option A is indicated please include the required attachment):**

**Choice A** \_\_\_\_\_ Attached hereto is a list of all debts owed by the affiant to any elected or appointed official of the Parish of Jefferson, and any and all debts owed by any elected or appointed official of the parish to the Affiant.

**Choice B** X \_\_\_\_\_ There are **NO** debts which would require disclosure under Choice A of this section.

Affiant further said:

That Affiant has employed no person, corporation, firm, association, or other organization, either directly or indirectly, to secure the public contract under which he received payment, other than persons regularly employed by the Affiant whose services in connection with the construction, alteration or demolition of the public building or project or in securing the public contract were in the regular course of their duties for Affiant; and

That no part of the contract price received by Affiant was paid or will be paid to any person, corporation, firm, association, or other organization for soliciting the contract, other than the payment of their normal compensation to persons regularly employed by the Affiant whose services in connection with the construction, alteration or demolition of the public building or project were in the regular course of their duties for Affiant.

Affiant further said:

Affiant personally has not been convicted of, nor has he/she entered into a plea of guilty or nolo contendere to any of the crimes or equivalent federal crimes listed below. No individual partner, incorporator, director, manager, officer, organizer, or member, who has a minimum of a ten percent ownership in the Bidding Entity, has been convicted of, or has entered a plea of guilty or nolo contendere to any of the crimes or equivalent federal crimes listed below. A conviction of or plea of guilty or nolo contendere to the following state crimes or equivalent federal crimes shall permanently bar any person or the bidding entity from bidding on public projects:

- (a) Public bribery (R.S. 14:118)
- (b) Corrupt influencing (R.S. 14:120)
- (c) Extortion (R.S. 14:66)
- (d) Money laundering (R.S. 14:230)



A conviction of or plea of guilty or nolo contendere to the following state crimes or equivalent federal crimes shall bar any person or the bidding entity from bidding on public projects for a period of five years from the date of conviction or from the date of the entrance of the plea of guilty or nolo contendere:

- (a) Theft (R.S. 14:67)
- (b) Identity Theft (R.S. 14:67, 16)
- (c) Theft of a business record (R.S. 14:67.20)
- (d) False accounting (R.S. 14:70)
- (e) Issuing worthless checks (R.S. 14:71)
- (f) Bank fraud (R.S. 14:71.1)
- (g) Forgery (R.S. 14:72)
- (h) Contractors; misapplication of payments (R.S. 14:202)
- (i) Malfeasance in office (R.S. 14:134)

The five-year prohibition provided for in this section shall apply only if the crime was committed during the solicitation or execution of a contract or bid awarded pursuant to these provisions. If evidence is submitted substantiating that a false attestation has been made and the project must be readvertised or the contract cancelled, the awarded entity making the false attestation shall be responsible to the public entity for the costs of rebidding, additional costs due to increased costs of bids and any and all delay costs due to the rebid or cancellation of this project.

*[The remainder of this page is intentionally left blank.]*

Affiant further said:

- (1) Entity is registered and participates in a status verification system to verify that all employees in the State of Louisiana are legal citizens of the United States or are legal aliens.
- (2) Entity shall continue, during the term of the contract, to utilize a status verification system to verify the legal status of all new employees in the State of Louisiana.
- (3) Entity shall require all subcontractors to submit to the Entity a sworn affidavit verifying compliance with statements (1) and (2).

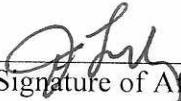
  
\_\_\_\_\_  
Signature of Affiant

Jeremy Landry  
\_\_\_\_\_  
Printed Name of Affiant

SWORN AND SUBSCRIBED TO BEFORE ME

ON THE 27<sup>th</sup> DAY OF June, 2023.

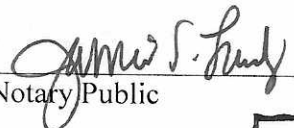
  
\_\_\_\_\_  
Notary Public

\_\_\_\_\_  
Printed Name of Notary

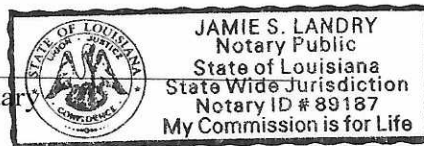

\_\_\_\_\_  
Notary/Bar Roll Number

My commission expires \_\_\_\_\_.

SEE ATTACHED

CORPORATE RESOLUTION

EXCERPT FROM MINUTES OF MEETING OF THE BOARD OF DIRECTORS OF  
\_\_\_\_\_  
INCORPORATED.

AT THE MEETING OF DIRECTORS OF \_\_\_\_\_  
INCORPORATED, DULY NOTICED AND HELD ON \_\_\_\_\_,  
A QUORUM BEING THERE PRESENT, ON MOTION DULY MADE AND SECONDED. IT  
WAS:

RESOLVED THAT \_\_\_\_\_, BE AND IS HEREBY  
APPOINTED, CONSTITUTED AND DESIGNATED AS AGENT AND ATTORNEY-IN-  
FACT OF THE CORPORATION WITH FULL POWER AND AUTHORITY TO ACT ON  
BEHALF OF THIS CORPORATION IN ALL NEGOTIATIONS, BIDDING, CONCERNS  
AND TRANSACTIONS WITH THE PARISH OF JEFFERSON OR ANY OF ITS AGENCIES,  
DEPARTMENTS, EMPLOYEES OR AGENTS, INCLUDING BUT NOT LIMITED TO, THE  
EXECUTION OF ALL BIDS, PAPERS, DOCUMENTS, AFFIDAVITS, BONDS, SURETIES,  
CONTRACTS AND ACTS AND TO RECEIVE ALL PURCHASE ORDERS AND NOTICES  
ISSUED PURSUANT TO THE PROVISIONS OF ANY SUCH BID OR CONTRACT, THIS  
CORPORATION HEREBY RATIFYING, APPROVING, CONFIRMING, AND ACCEPTING  
EACH AND EVERY SUCH ACT PERFORMED BY SAID AGENT AND ATTORNEY-IN-  
FACT.

I HEREBY CERTIFY THE FOREGOING TO BE  
A TRUE AND CORRECT COPY OF AN  
EXCERPT OF THE MINUTES OF THE ABOVE  
DATED MEETING OF THE BOARD OF  
DIRECTORS OF SAID CORPORATION, AND  
THE SAME HAS NOT BEEN REVOKED OR  
RESCINDED.

\_\_\_\_\_  
SECRETARY-TREASURER

\_\_\_\_\_  
DATE

UNITED STATES OF AMERICA  
State of Louisiana



**Jox McKeithen**  
SECRETARY OF STATE

*As Secretary of State, of the State of Louisiana, I do hereby Certify that*  
a copy of the Articles of Organization and Initial Report of

LA CONTRACTING ENTERPRISE, L.L.C.

Domiciled at BERWICK, LOUISIANA,

Was filed and recorded in this Office on June 05, 1998.

And all fees having been paid as required by law, the  
limited liability company is authorized to transact business  
in this State, subject to the restrictions imposed by law,  
including the provisions of R.S. Title 12, Chapter 22.

*In testimony whereof, I have hereunto set  
my hand and caused the Seal of my Office  
to be affixed at the City of Baton Rouge on,*

June 5, 1998

*Jox McKeithen*

BBE 34649410K

*Secretary of State*





**Tom Schedler**  
SECRETARY OF STATE

*As Secretary of State of the State of Louisiana I do hereby Certify that*  
the attached document(s) of

**LA CONTRACTING ENTERPRISE, L.L.C.**

are true and correct and are filed in the Louisiana Secretary of State's Office.  
40982854 Amendments 10/31/2012 3 pages

In testimony whereof, I have hereunto set my  
hand and caused the Seal of my Office to be  
affixed at the City of Baton Rouge on,  
October 31, 2012

*Secretary of State*

JL 34649410K



Certificate ID: 10320748#NVM73

To validate this certificate, visit the following  
web site, go to **Commercial Division**,  
**Certificate Validation**, then follow the  
instructions displayed.  
[www.sos.louisiana.gov](http://www.sos.louisiana.gov)

**ARTICLES OF AMENDMENT AND RESTATEMENT TO  
ARTICLES OF ORGANIZATION OF  
LA CONTRACTING ENTERPRISE, L.L.C.**

The undersigned Sole Member/Manager of LA CONTRACTING ENTERPRISE, L.L.C. (the "Company"), does hereby certify that the Articles of Organization of the Company were amended by unanimous consent at a meeting held on the 30<sup>th</sup> day of October, 2012.

Articles I, II, III of the Articles of Organization are amended and Article IV, V and VI were added by said resolution so that the Amended and Restated Articles read in its entirety as follows:

**ARTICLE I**

**Name**

The name of the Limited Liability Company is LA CONTRACTING ENTERPRISE, L.L.C.

**ARTICLE II**

**Purpose**

The Limited Liability Company's purpose is to engage in any lawful activity for which Limited Liability Companies may be formed under the laws of the State of Louisiana.

**ARTICLE III**

**Management**

The Limited Liability Company shall be managed by the Sole Member/Manager, Jeremy Landry until the Articles are amended and filed with the Secretary of State of the State of Louisiana.

**ARTICLE IV**

**Voting**

Each member shall have one vote which is proportionate to his ownership interest in the Limited Liability Company.

## **ARTICLE V**

### **Amendments and Addendums**

Amendments and addendums to these Articles of Organization shall be made by unanimous vote of the members of the Limited Liability Company.

## **ARTICLE VI**

### **Duration**

Unless dissolved by law or agreement, the existence of the Company shall be perpetual.

## **ARTICLE VII**

### **Powers of the Manager**

The Manager shall have all powers and duties conferred upon him by law, including specifically the power to issue bids and sign contracts under LA. R.S. 38:2212.

## **ARTICLE VIII**

### **Reliance**

Persons dealing with the company may rely upon a certificate of any one of the certifying officials listed below to establish the membership of any member, the authenticity of any records of the company, including without limitation, the Operating Agreement, or the authority of any person to act on behalf of the company, including, without limitation, the authority to take the actions referred to in La. Rev. Statutes § 12:1318(B). The following persons are hereby named authorized certified officials of the company, and any one of them may exercise the full authority granted by La. Rev. Statutes § 12:130(C)(5) without the need to obtain the written approval or certification of any other certified official: Jeremy Landry.

These Articles of Amendment are dated October 30, 2012.

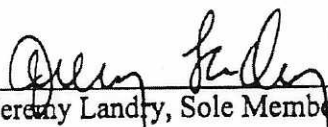
  
\_\_\_\_\_  
Jeremy Landry, Sole Member/Manager

STATE OF LOUISIANA

PARISH OF LAFOURCHE

BE IT KNOWN, that on this 30<sup>th</sup> day of October, 2012, before me, the undersigned Notary Public, duly commissioned, qualified, and sworn within and for the State and Parish aforesaid, personally came and appeared JEREMY LANDRY, to me known to be a Sole Member/Manager of LA CONTRACTING ENTERPRISE, L.L.C. and one of the persons who executed the foregoing Articles of Amendment in such capacity, and who declared and acknowledged to me, Notary, in the presence of the undersigned competent witnesses, that he is authorized to and did execute the foregoing Articles of Amendment in such capacity for the said company, as its and his free act and deed.

WITNESSES:

Amiee Bolotte  
Amiee Bolotte  
Bridget Marie Landry  
Bridget Marie Landry

Jeremy Landry  
JEREMY LANDRY

Jamie S. Landry  
NOTARY PUBLIC

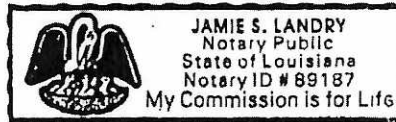



# Lafourche Parish Recordation Certificate

Vernon H. Rodrigue  
CLERK OF COURT  
PO BOX 818  
303 W 3rd St  
Thibodaux, LA 70302  
(985) 447-4841

**First VENDOR**

LA CONTRACTING ENTERPRISE LLC

**First VENDEE**

LANDRY, JEREMY

Index Type : Conveyance

Inst Number : 1142645

Type of Document : Certificate Of Authority

Book : 1901

Page : 630

Recording Pages : 2

**Recorded Information**

On (Recorded Date) : 10/11/2012

At (Recorded Time) : 9:23:59:000 AM

Recordation Certified On : 10/11/2012



Doc ID - 030646700002

Deputy Clerk

*Cheryl L. Sanchez*



AFFIDAVIT OF CERTIFICATE OF AUTHORITY  
UNDER LA. REV. STAT. 38:2212(0)  
FOR JEREMY LANDRY TO SIGN BIDS  
FOR LA CONTRACTING ENTERPRISE, LLC  
ON PUBLIC CONTRACTS

STATE OF LOUISIANA  
PARISH OF LAFOURCHE

BEFORE ME, the undersigned notary public, personally appeared:

JEREMY LANDRY

known to me, swore as follows:

1.

He is the sole member of LA Contracting Enterprise, LLC and that he is authorized to act on behalf of LA Contracting Enterprise, LLC to submit bids on public contracts in the submission of all bids on behalf of LA Contracting Enterprise, LLC, and to sign any such bids to bind LA Contracting Enterprise, LLC.

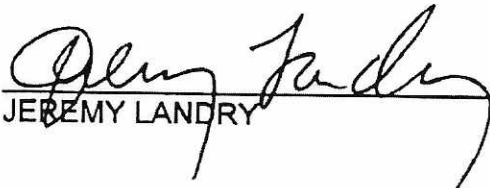
  
JEREMY LANDRY

SWORN TO AND SUBSCRIBED  
before me, this 10<sup>th</sup> day of  
October, 2012.

  
NOTARY PUBLIC

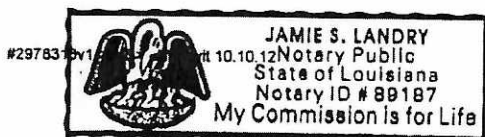

CERTIFICATE OF AUTHENTICITY

STATE OF LOUISIANA  
PARISH OF LAFOURCHE

I, Jeremy Landry, do hereby certify that I am the sole member and manager of LA Contracting Enterprise, LLC, and that I am authorized to, and do, certify that the attached papers are authentic copies of the "Organizational Documents" of LA Contracting Enterprise, LLC. I make this certification in accordance with La Rev Stat. 12:1317C.

  
JEREMY LANDRY

SWORN TO AND SUBSCRIBED  
before me, this 27<sup>th</sup> day of  
June, 2023.

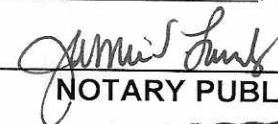
  
NOTARY PUBLIC

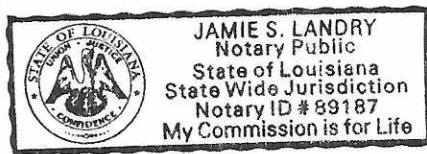

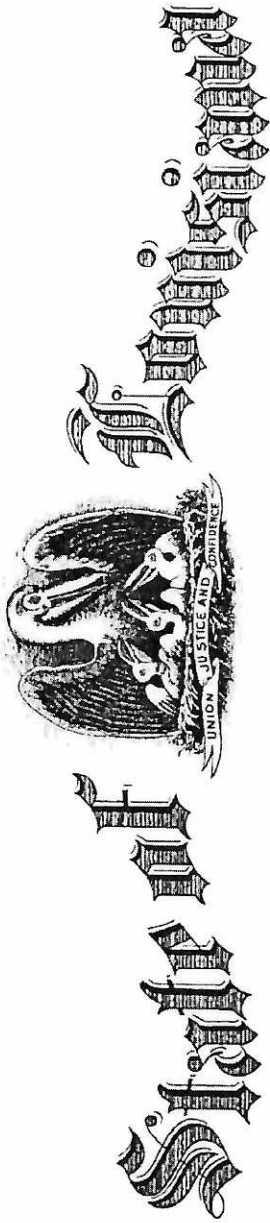

## State Licensing Board for Contractors

This is to Certify that:

LA CONTRACTING ENTERPRISE, L.L.C.  
1645 Saint Patrick Street  
Thibodaux, LA 70301

is duly licensed and entitled to practice the following classifications

BUILDING CONSTRUCTION; ELECTRICAL WORK (STATEWIDE); HEAVY CONSTRUCTION; HIGHWAY,  
STREET AND BRIDGE CONSTRUCTION; MUNICIPAL AND PUBLIC WORKS CONSTRUCTION



Expiration Date: February 18, 2024

License No: 34263

Witness our hand and seal of the Board dated,  
Baton Rouge, LA 19th day of February 2021

Will B. McCoy Director

Lee M. Mallett Chairman

Andy M. Mallett Treasurer

This License Is Not Transferrable



LACONTR-01

JCOMEAX

## CERTIFICATE OF LIABILITY INSURANCE

DATE (MM/DD/YYYY)

12/29/2022

THIS CERTIFICATE IS ISSUED AS A MATTER OF INFORMATION ONLY AND CONFERS NO RIGHTS UPON THE CERTIFICATE HOLDER. THIS CERTIFICATE DOES NOT AFFIRMATIVELY OR NEGATIVELY AMEND, EXTEND OR ALTER THE COVERAGE AFFORDED BY THE POLICIES BELOW. THIS CERTIFICATE OF INSURANCE DOES NOT CONSTITUTE A CONTRACT BETWEEN THE ISSUING INSURER(S), AUTHORIZED REPRESENTATIVE OR PRODUCER, AND THE CERTIFICATE HOLDER.

**IMPORTANT:** If the certificate holder is an ADDITIONAL INSURED, the policy(ies) must have ADDITIONAL INSURED provisions or be endorsed. If SUBROGATION IS WAIVED, subject to the terms and conditions of the policy, certain policies may require an endorsement. A statement on this certificate does not confer rights to the certificate holder in lieu of such endorsement(s).

<b>PRODUCER</b> Laris Insurance Agency 810 Crescent Avenue Lockport, LA 70374	<b>CONTACT NAME:</b> Allison Lovell		
	<b>PHONE (A/C, No, Ext):</b> (985) 532-5576	<b>FAX (A/C, No):</b> (985) 532-5001	
	<b>E-MAIL ADDRESS:</b> allison.lovell@larisinsurance.com		
<b>INSURED</b>  LA Contracting Enterprise, LLC 1645 Saint Patrick Street Thibodaux, LA 70301	<b>INSURER(S) AFFORDING COVERAGE</b>		<b>NAIC #</b>
	<b>INSURER A:</b> The Travelers Indemnity Company of Connecticut		25682
	<b>INSURER B:</b> The Travelers Indemnity Company of America		25666
	<b>INSURER C:</b> Travelers Property Casualty Company of America		25674
	<b>INSURER D:</b> American Interstate Insurance Company		31895
	<b>INSURER E:</b> Westchester Surplus Lines Insurance Company		10172
	<b>INSURER F:</b>		

## COVERAGES

CERTIFICATE NUMBER:

REVISION NUMBER:

THIS IS TO CERTIFY THAT THE POLICIES OF INSURANCE LISTED BELOW HAVE BEEN ISSUED TO THE INSURED NAMED ABOVE FOR THE POLICY PERIOD INDICATED. NOTWITHSTANDING ANY REQUIREMENT, TERM OR CONDITION OF ANY CONTRACT OR OTHER DOCUMENT WITH RESPECT TO WHICH THIS CERTIFICATE MAY BE ISSUED OR MAY PERTAIN, THE INSURANCE AFFORDED BY THE POLICIES DESCRIBED HEREIN IS SUBJECT TO ALL THE TERMS, EXCLUSIONS AND CONDITIONS OF SUCH POLICIES. LIMITS SHOWN MAY HAVE BEEN REDUCED BY PAID CLAIMS.

INSR LTR	TYPE OF INSURANCE	ADDL INSD	SUBR WVD	POLICY NUMBER	POLICY EFF (MM/DD/YYYY)	POLICY EXP (MM/DD/YYYY)	LIMITS
A	<input checked="" type="checkbox"/> COMMERCIAL GENERAL LIABILITY <input type="checkbox"/> CLAIMS-MADE <input checked="" type="checkbox"/> OCCUR  GEN'L AGGREGATE LIMIT APPLIES PER: <input type="checkbox"/> POLICY <input checked="" type="checkbox"/> PRO-JECT <input type="checkbox"/> LOC OTHER:			DTCO4F156972TIA23	1/1/2023	1/1/2024	EACH OCCURRENCE \$ 1,000,000 DAMAGE TO RENTED PREMISES (Ea occurrence) \$ 300,000 MED EXP (Any one person) \$ 5,000 PERSONAL & ADV INJURY \$ 1,000,000 GENERAL AGGREGATE \$ 2,000,000 PRODUCTS - COM/POP AGG \$ 2,000,000
B	<input checked="" type="checkbox"/> AUTOMOBILE LIABILITY <input checked="" type="checkbox"/> ANY AUTO OWNED AUTOS ONLY <input type="checkbox"/> SCHEDULED AUTOS <input type="checkbox"/> HIRED AUTOS ONLY <input type="checkbox"/> NON-OWNED AUTOS ONLY			BA3L0174162326G	1/1/2023	1/1/2024	COMBINED SINGLE LIMIT (Ea accident) \$ 1,000,000 BODILY INJURY (Per person) \$ BODILY INJURY (Per accident) \$ PROPERTY DAMAGE (Per accident) \$
C	<input checked="" type="checkbox"/> UMBRELLA LIAB <input checked="" type="checkbox"/> OCCUR <input type="checkbox"/> EXCESS LIAB <input type="checkbox"/> CLAIMS-MADE DED <input checked="" type="checkbox"/> RETENTION \$ 10,000			CUP0K1146822326	1/1/2023	1/1/2024	EACH OCCURRENCE \$ 4,000,000 AGGREGATE \$ 4,000,000
D	<input checked="" type="checkbox"/> WORKERS COMPENSATION AND EMPLOYERS' LIABILITY ANY PROPRIETOR/PARTNER/EXECUTIVE OFFICER/MEMBER EXCLUDED? (Mandatory in NH) <input checked="" type="checkbox"/> Y/N If yes, describe under DESCRIPTION OF OPERATIONS below		N/A	AVWCLA3147792023	1/1/2023	1/1/2024	<input checked="" type="checkbox"/> PER STATUTE <input type="checkbox"/> OTH-ER E.L. EACH ACCIDENT \$ 1,000,000 E.L. DISEASE - EA EMPLOYEE \$ 1,000,000 E.L. DISEASE - POLICY LIMIT \$ 1,000,000
E	Contractor Pollution			G28356584003	1/1/2023	1/1/2024	Each Condition \$ 1,000,000

DESCRIPTION OF OPERATIONS / LOCATIONS / VEHICLES (ACORD 101, Additional Remarks Schedule, may be attached if more space is required)  
Equipment Floater Policy #DTCO4F156972TIA23 - Effective 1/1/23-24 - Travelers Indemnity Co. of America - Rented/Leased Equipment From Others Limit \$300,000 - Deductible \$2,500 except for wind/hail/flood/earthquake is \$5,000 deductible. Includes Blanket Loss Payee, ATIMA.  
Blanket Installation Floater Policy #MKLM4IM0052827 - Effective 4/23/22-23 - Markel American Ins. Co. - Special Coverage form including Flood - Blanket Installation Floater Limit \$2,500,000 - Transit Limit \$100,000 - Deductible \$10,000 except 3% Named Storm Deductible subject to \$50,000 minimum - Flood Limit \$250,000 with 3% deductible subject to \$50,000 minimum

Please see attached addendum for additional coverages;

## CERTIFICATE HOLDER

## CANCELLATION

"INSURED COPY ONLY"  
1645 St. Patrick Street  
Thibodaux, LA 70301

SHOULD ANY OF THE ABOVE DESCRIBED POLICIES BE CANCELLED BEFORE THE EXPIRATION DATE THEREOF, NOTICE WILL BE DELIVERED IN ACCORDANCE WITH THE POLICY PROVISIONS.

AUTHORIZED REPRESENTATIVE

*Ross Laris* Ross Laris



## ADDITIONAL REMARKS SCHEDULE

Page 1 of 1

AGENCY <b>Laris Insurance Agency</b>		NAMED INSURED <b>LA Contracting Enterprise, LLC</b> 1645 Saint Patrick Street Thibodaux, LA 70301	
POLICY NUMBER <b>SEE PAGE 1</b>			
CARRIER <b>SEE PAGE 1</b>	NAIC CODE <b>SEE P 1</b>	EFFECTIVE DATE: <b>SEE PAGE 1</b>	

## ADDITIONAL REMARKS

THIS ADDITIONAL REMARKS FORM IS A SCHEDULE TO ACORD FORM,

FORM NUMBER: ACORD 25 FORM TITLE: Certificate of Liability Insurance

## Addendum

General Liability Includes but not limited to:

Blanket Additional Insured as required by written contract

Blanket Waiver of Subrogation as required by written contract

Primary &amp; Non-Contributory Wording

Contractual Liability

Designated Projects General Aggregate Limit

30 Day Notice of Cancellation to Certificate holders.

Commercial Auto Includes but not limited to:

Blanket Additional Insured as required by written contract

Blanket Waiver of Subrogation as required by written contract

Primary &amp; Non-Contributory Wording

WC policy includes but not limited to:

USL&amp;H

Blanket Waiver of Subrogation as required by written contract

Blanket Alternate Employer as required by signed, written contract

Umbrella Policy is follow form coverage over the General Liability, Auto and Employers Liability Policies.

See attached addendum for additional coverages All policies will provide thirty (30) days notice of cancellation, (except ten (10) days for non-payment of premium), as well as changes to the policy, only to the first named insured. We are diligently working to resolve this global issue with the carriers, whereby specifically named additional insureds will be afforded cancellation notification also.

The Certificate of Insurance to which this addendum is a part of does not constitute a contract between the issuing insurer(s), authorized representative or producer, and the certificate holder, nor does it affirmatively or negatively amend, extend or alter the coverage afforded by the policies listed thereon. If any provisions of this addendum conflicts in whole or in part with the terms of the insurance policy(ies), then the provisions of the insurance policy(ies) will prevail.

## PUBLIC WORKS BID INSTRUCTIONS

### A. LOUISIANA CONTRACTOR'S LICENSE FOR THIS PROJECT

Must be in the following category:

Building Construction

Each bidder shall comply with all rules and regulations of the Louisiana State Licensing Board for Contractors in accordance with existing state laws, and shall comply with the Licensing Requirements of Jefferson Parish Ordinance No. 13574, as amended a copy of which may be obtained from the Office of the Parish Clerk, Suite 6700, Jefferson Parish General Government Building, 200 Derbigny Street, Gretna, Louisiana 70053.

### B. PROBABLE CONSTRUCTION RANGES AND PRICES

Range of the Probable Construction Cost for Base Bid: \$2,500,000 - \$5,000,000

Range of the Probable Construction Cost for Alternate No. 1: \$0 - \$ 250,000

Range of the Probable Construction Cost for Alternate No. 2: N/A

Range of the Probable Construction Cost for Alternate No. 3: N/A

Range of the Previous Contract Cap  
(Public Work Maintenance Contract): N/A

The purpose and intention of this invitation to bid is to afford all suppliers/contractors an equal opportunity to bid on construction, maintenance, repair, operating, services, supplies and/or equipment listed in this bid proposal. Jefferson Parish will accept one bid only from each vendor. Items bid on must meet or exceed specifications. Where brand names, make, manufacturer or stock numbers are specified, it is for the purpose of establishing certain minimum standards of quality. Bidders may submit for products of equal quality, style, type and character, provided brand names and stock numbers are specified. Complete product data may be required prior to award.

The price quoted for the work shall be stated in figures. In the event there is a difference in unit prices and totals, the unit prices shall prevail. In the event there is a difference in unit prices, written unit prices shall prevail over numerical unit prices.

The quantities listed on the bid form are prepared for comparison of bids and may be approximate. Payment to the contractor will be made in accordance with measurement and payment requirements for bid items and other requirements of the project specifications. Bid item quantities may be increased, decreased, or omitted as provided in the specifications.

Jefferson Parish requires all products to be new (current), and all work must be performed according to standard practices for the project. Unless otherwise specified, no after market parts will be accepted. Unless otherwise specified, all workmanship and materials must have at least a one (1) year guaranty, in writing, from the date of delivery/acceptance of the project.



## **C. METHODS OF BID SUBMISSION**

All bids shall be submitted electronically through Jefferson Parish's eProcurement System online at no charge via Jefferson Parish's electronic procurement page by visiting [www.jeffparishbids.net](http://www.jeffparishbids.net). Registration and use of this site are free to Jefferson Parish vendors. Additional instructions are included in the text box highlighting electronic procurement.

Only bids properly signed (see more below) will be accepted. NO LATE BIDS WILL BE ACCEPTED. The name of the bidder must be legibly shown. If the bidder is an individual, their name and address should be shown. If the bidder is an entity, the name of the person given the requisite authority to submit the bid on behalf of the entity shall be shown and the address of the entity's place of business should be shown.

Evidence of agency, corporate, limited liability or partnership authority of the person submitting and signing the bid is required for submission of bid. A copy of a corporate resolution or other signature authorization shall be required for submission of the bid. Failure to include a copy of the appropriate signature authorization will result in the rejection of the bid unless bidder has complied with LSA-R.S. 38:2212(B)(5). Photostatic or font signatures shall result in the bid being rejected. However, an electronic signature as defined in LSA-R.S. 9:2602(8) is acceptable. Signature must be a secured digital signature. A sample corporate resolution and sample certification of sole proprietorship can be downloaded from the Jefferson Parish Purchasing Department's website <http://purchasing.jeffparish.net>, or you may provide your own document.

## **D. TIMELINES**

### **1. Prior to the closing time for receipt of scheduled bids**

A bid may be withdrawn at any time prior to the scheduled closing time for receipt of bids, provided a request in writing, executed by the bidder or his duly authorized representative, is filed with the Parish prior to that time. When such a request is received, the bid will be returned to the bidder unopened. However, no bid can be modified, corrected or withdrawn after the time set for closing such bid, except as provided by LSA-R.S. 38:2214(C) & (D).

The Parish, its engineers, architects or anyone distributing plans and specifications for Parish public work projects, equal to or over the contract limit as defined in LA-R.S. 38:2212, shall furnish all prime bidders who request bid documents and who are properly licensed by the Louisiana State Licensing Board for Contractors with at least one set of complete bid documents. A deposit or fee may be charged on the documents as authorized by LA-R.S. 38:2212.

Addenda may be issued, as authorized by LA-R.S. 38:2212 (O). All formal Addenda require written acknowledgment on the bid form by the bidder. Failure to acknowledge an Addendum on the bid form shall cause the bid to be rejected. Jefferson Parish reserves the right to award the bid to the next lowest responsive and responsible bidder in this event.

Prior to submitting a bid each bidder shall visit the site of the proposed work and fully acquaint himself with all surface and subsurface conditions as they may exist so that he may fully understand the facilities, difficulties, and restrictions attending the execution of the work under this Contract. Bidders shall also thoroughly examine and be familiar with Drawings, Specifications, and Contract Documents. The failure or omission of any bidder to receive or examine any form, instrument, drawing, or document or to visit the site and acquaint himself with conditions there existing, shall in no way relieve any bidder from any obligation with respect to



his bid and the responsibility in the premises rests with him. Submission of a bid shall be considered prima facie evidence that the bidder has made such examination and is satisfied as to the conditions to be encountered in performing the work and as to requirements of the plans, project specifications, Resolution No. 141125, as amended, and contract forms.

Any pre-bid test and boring data in connection with subsurface conditions which have been completed by the Parish or its engineers and furnished to the bidder shall not be considered as fully representative of subsurface conditions existing throughout the area tested nor shall they in any way be binding upon the Parish, it being understood that said data is furnished the bidder for his convenience only and the bidder shall be solely responsible for conducting his own boring explorations he deems necessary in preparing his bid. Any prospective bidder wishing to conduct boring explorations on Parish property must obtain written permission from Jefferson Parish prior to such explorations.

No claims shall be made against the Parish for additional compensation due to unforeseen subsurface conditions arising during progress of the work and which might be in variance with the Parish's pre-bid boring data.

## **2. Post-closing time for receipt of scheduled bids**

Except as where provided by law, bidder agrees that this bid shall be legally binding and may not be withdrawn for a period of forty-five (45) calendar days after the scheduled closing time for receiving bids. In the event the Parish issues the Letter of Award (copy of adopted resolution awarding bid by Jefferson Parish Council) during this period, the bid accepted shall continue to remain binding pending execution of the Contract.

Bidder agrees to execute the ensuing Contract and will deliver applicable Bonds to secure the faithful performance thereof.

The Parish of Jefferson reserves the right to cancel this contract for convenience by issuing a thirty (30) day written notice to contractor.

## **E. BID REVIEW AND AWARD**

### **1. Rejection of Bids**

- a. Jefferson Parish may reject any and all bids for just cause in accordance with LA R.S. 38:2214(B). Just cause, for the purpose of the construction of public works, is defined, but is not limited to, the following circumstances:
  - (1) The public entity's unavailability of funds sufficient for the construction of the proposed public work.
  - (2) The failure of any bidder to submit a bid within an established threshold of the preconstruction estimates for that public work, as part of the bid specifications.
  - (3) A substantial change by the public entity prior to the award in the scope or design of the proposed public work.
  - (4) A determination by the public entity not to build the proposed public work within twelve months of the date for the public opening and reading of bids.
  - (5) The disqualification by the public entity of all bidders.

- b. Additionally, bids may be considered irregular and be rejected for any of the following, but is not limited to the following circumstances:
- (1) If the bid form is on a form other than that furnished by the Parish or if the form is altered or any part thereof is detached.
  - (2) If affidavits included in bid form and/or required by law are not returned with the bid or are not properly executed and notarized.
  - (3) If there are unauthorized additions, conditional or alternate bids or irregularities which alter the general terms and conditions, the plans or specifications, or make the bid incomplete, indefinite, or ambiguous as to its meaning.
  - (4) If the bidder adds provisions reserving the right to accept or reject the award or to enter into the contract pursuant to the award.
  - (5) If an owner or a principal officer of the bidding firm is an owner or a principal officer of a firm which has been declared by the Parish to be ineligible to bid.
  - (6) If the proposed bid security does not meet the requirements of Section J.
  - (7) If more than one proposal for the same work, services, materials or supplies is received from an individual, partner, firm, corporation, joint venture, other legal entity, or combination thereof under the same or a different name.
  - (8) The bid is not properly signed or the authority of the signature person submitting the bid is deemed insufficient or unacceptable.
  - (9) If the bidder does not possess the proper license(s) required as noted in the specifications.
  - (10) Any other reasons for rejection set forth by State or Parish laws, Ordinances or Resolutions.
- c. In awarding contracts for materials and supplies, Jefferson Parish shall reject the lowest bid if received from a bidder domiciled in a Communist country, or if the materials or supplies are manufactured in a Communist country, including but not limited to China, North Korea and Vietnam, and to award the contract to the next lowest bidder. This Section shall not apply to any country having established trade relations agreements or approvals from the government of the United States. (LSA-R.S. 38:2212.3)

## **2. Disqualification of Bids**

- a. The causes for disqualification from consideration for award of a contract with Jefferson Parish are as follows (Jefferson Parish Code of Ordinances, Section 2-912):
- (1) Conviction for commission of a criminal offense as an incident to obtaining or attempting to obtain a public or private contract or subcontract, or in the performance of such contract or subcontract;
  - (2) Conviction under state or federal statutes of embezzlement, theft, forgery, bribery, falsification or destruction of records, receiving stolen property, or any other offense indicating a lack of business integrity or business honesty which currently, seriously, and directly affects responsibility as a Parish contractor;
  - (3) Conviction under state or federal antitrust statutes arising out of the submission of bids or proposals;
  - (4) Violation of contract provisions, as set forth below, of a character which is regarded by the Purchasing Director or his designee for Jefferson Parish to be serious as to justify disqualification:
    - i. Deliberate failure without good cause to perform in accordance with the specifications or within the time limit provided in the contract; or

- ii. A recent record of failure to perform or of unsatisfactory performance in accordance with the terms of one or more contracts; provided that failure to perform or unsatisfactory performance caused by acts beyond the control of the contractor shall not be considered to be a basis for disqualification; or
    - iii. Failure to timely pay, without cause, a subcontractor for work performed under a construction contract as required under Section 2-976 in Chapter 2, Article VII, of the Jefferson Parish Code of Ordinances, provided disqualification on such basis shall not exceed a period of one (1) year from the deadline to pay the subcontractor.
  - (5) Any other cause the Purchasing Director determines to be so serious and compelling as to affect responsibility as a Parish contractor, including debarment by another governmental entity for any cause;
  - (6) Violation of the State Code of Ethics or the ethical standards set forth in the Jefferson Parish Code of Ordinances;
  - (7) Failure to secure and/or maintain necessary licenses and/or permits;
  - (8) Failure to comply with the Jefferson Parish Code of Ordinances and/or the Jefferson Parish Comprehensive Zoning Ordinance; or failure to comply with or meet bid specifications and/or failure to be a responsible bidder.
  - (9) A bid which is not responsive to, or does not meet bid specifications, will be rejected as being non-responsive, but that bidder will not be disqualified from future Parish bids, nor will that bidder be given a hearing pursuant to procedure listed below.
- b. The procedures for disqualification from consideration for award of a contract with Jefferson Parish are set forth in Sec. 2- 912 (b).

### **3. Award of Contract**

The award of the contract, if it be awarded, will be by the Parish to the lowest responsive and responsible bidder whose proposal shall have complied with all the bid requirements. The successful bidder will be notified via the e-Procurement site that his bid has been accepted. No contract shall be executed with any contractor until their certificates of insurance, performance bonds, labor and materials payment bonds, or any other bonds required are made satisfactory to the Parish.

Jefferson Parish reserves the right to award contracts or place orders on a lump sum or individual item basis, or such combination as shall, in its judgment, be in the best interest of Jefferson Parish. Every contract or order shall be awarded to the lowest responsible bidder, taking into consideration the conformity with the specifications, and the delivery and/or completion date.

Preference will be given to bidders requesting a preference in their bid in accordance with LSA-R.S. 38:2251-2261 for materials, supplies, and provisions, produced, manufactured or grown in Louisiana, quality being equal to articles offered by competitors outside the State of Louisiana, unless federal funding is directly spent by Jefferson Parish on this project.

The successful bidder shall execute the contract with the Parish in the form of the contract included in the specifications, a copy of which is annexed hereto, in such number of counterparts as the Parish may request within twelve (12) days after receipt of notice of award of the contract by the Parish. One copy of the executed contract with all documents forming a part thereof shall be filed at the expense of the contractor, with the Recorder of Mortgages in Jefferson Parish.

**PROTESTS:** Only those vendors that submit bids in response to this solicitation may protest any element of the procurement, in writing to the Director of the Purchasing Department. Written protest must be received within 48 hours of the release of the bid tabulation by the Purchasing Department. After consultation, the Parish Attorney's Office will then respond to protests in writing. (For more information, please see Chapter 2, Article VII, Division 2, Sec. 2-913 of the Jefferson Parish Code of Ordinances.)

Upon full execution of the contract and receiving a written notice to proceed, the bidder agrees that all work shall be completed as follows:

The work shall be substantially complete within <sup>279</sup> calendar days of the written notice to proceed and completed and shall be ready for final acceptance no more than 30 calendar days after substantial completion.

#### F. SALES TAX EXEMPTION

For this project, the contractor shall not pay any state or local sales or use taxes on materials and equipment which are affixed and made part of the immovable property of the project or which is permanently incorporated in the project (hereinafter referred to as "applicable materials and equipment"). All purchases of applicable materials or equipment shall be made by the contractor on behalf of and as the agent of Jefferson Parish (Parish), a political subdivision of the State of Louisiana. No state and local sales and use taxes are owed on applicable materials and equipment under the provisions of Act 1029 of the 1991 Regular Session – Louisiana Revised Statute 47:301(8)(c). Parish will furnish to contractor a certificate form which certifies that Parish is not required to pay such state or local sales and use taxes, and contractor shall furnish a copy of such certificate to all vendors or suppliers of the applicable materials and equipment, and report to Parish the amount of taxes not incurred.

#### G. LIQUIDATED DAMAGES

In accordance with Resolution No. 141125, as amended, Bidder agrees to pay, as liquidated damages, the sum of \$<sup>500</sup> for: (1) each consecutive calendar day after the agreed date of substantial completion that the work remains substantially incomplete, and (2) each consecutive calendar day after the 30th day following the actual date of substantial completion that the work has not been finally completed.

In addition to, but not in lieu of the per diem liquidated damages, Parish shall also be entitled to recover from the contractor or the contractor's surety additional liquidated damages as detailed in Resolution No. 141125, as amended. These additional liquidated damages may include, but are not limited to the following, in the amounts and for each of the items identified in the Supplementary Conditions:

(1)	Extended Architectural and/or Engineering Fees	\$ <u>175</u> /hour
(2)	Extended Resident Project Representative Fee	\$ <u>N/A</u> /hour
(3)	Extended Construction Management Fees	\$ <u>175</u> /day
(4)	Extended Parish's Overhead and Personnel Expenses	\$ <u>N/A</u> /hour

- (5) Parish's Other Costs Directly Related to the Delay in Completion Beyond the Contract Times.

Whenever contractor's work requires inspections in excess of the budgeted amount for inspection, the contractor shall reimburse the Parish for the additional costs incurred by the Parish attributable to inspection of the contracted project in excess of the budgeted amount for inspections.

The reasonable budget for such inspections is \$ N/A. Resident Project Representative overtime rates shall be calculated at 1.2 times the hourly rate. The cost of inspection in excess of this budgeted amount shall be assessed against Contractor's progress payments, all in accordance with Louisiana Public Bid Law.

#### **H. ETHICAL STANDARDS AND COOPERATION WITH THE OFFICE OF THE INSPECTOR GENERAL, INCLUDING CONFLICTS OF INTEREST**

Vendor agrees by bid submission to comply with all provisions of Louisiana Law as well as compliance with the Jefferson Parish Code of Ordinances, Louisiana Code of Ethics, as published on <http://ethics.la.gov> and applicable Jefferson Parish ethical standards and Jefferson Parish Terms and Conditions.

Inspector General: It shall be the duty of every Parish officer, employee, department, agency, special district, board, and commission; and the duty of every contractor, subcontractor, and licensee of the Parish, and the duty of every applicant for certification of eligibility for a Parish contract or program, to cooperate with the Inspector General in any investigation, audit, inspection, performance review, or hearing pursuant to JPCO 2-155.10(19). Every Parish contract and every bid, proposal, application or solicitation for a Parish contract, and every application for certification of eligibility for a Parish contract or program shall contain a statement that the corporation, partnership, or person understands and will abide by all provisions of JPCO 2-155.10. By submitting a bid, Bidder acknowledges this and will abide by all provisions of the referenced JPCO.

Conflicts of Interest: Jefferson Parish adheres to the Louisiana Code of Governmental Ethics, contained in Louisiana Revised Statutes Annotated, R.S. 42:1101, et seq. Vendor/Proposer by this submission warrants that there are no "conflicts of interest" related to this procurement that would violate applicable Louisiana Law. Violation of the Louisiana Code of Governmental Ethics may result in rescission of contract, permit or licenses, and the imposition of fines and/or penalties, without contractual liability to the public in accordance with applicable law.

#### **I. REQUIRED AFFIDAVITS**

For convenience, all legally mandated affidavits have been combined into one form, entitled **Public Works Bid Affidavit**. All bidders must submit with their bid submission, a completed, signed and properly notarized affidavit in its original format and without alteration in order to be compliant and for the bid to be considered responsive. A scanned copy of the completed, signed and properly notarized affidavit may be submitted with the bid; however, the successful bidder must submit the original affidavit in its original format and without material alteration prior to, or at contract execution. Failure to comply will result in the bid submission being rejected as non-responsive. The Parish reserves the right to award bid to the next lowest responsive and responsible bidder in this event.



The person submitting the bid, and whose authority to submit has been evidenced on the Corporate Resolution is the proper party to execute the **Public Works Bid Affidavit**.

**J. BID REQUIREMENTS (BID DOCUMENTS, SPECIFICATIONS, BONDS, W-9 AND PAYMENT INFO)**

Bidders must review the bid specifications and include any required documentation including but not limited to the LA Public Works Uniform Bid Form, Bid Security, Corporate Resolution or written evidence of signature authority, and the Public Works Affidavit. Pursuant to LA R.S. 38:2212(B)(3)(b), bidders shall also be responsible for providing any other documentation as required. Please note that the payment and performance bonds must be supplied by the successful bidder at contract signing.

No oral interpretation will be made to any bidder as to the meaning of the drawings, specifications, or contract documents. Every request for such interpretation shall be made in writing and addressed and forwarded to the Engineer, Architect or person distributing plans and specifications. No inquiry received within five (5) days prior to the day fixed for opening of the bids will be given consideration. Every interpretation made to the bidder shall be in the form of an addendum to the specifications and shall be issued as authorized by LA-R.S. 38:2212(O).

All such addenda shall become a part of the contract documents. Failure of any bidder to receive any such interpretation shall not relieve any bidder from any obligation under his bid as submitted without modification.

The specifications and plans are complementary of each other and all work called for or reasonably implied by either shall be performed as if called for by both. In case of conflict between the requirements of the specifications and plans, the specifications shall take precedence. Figured dimensions shall take precedence over scale dimensions, and larger scale details shall take precedence over smaller scale details in the general work drawings.

All vendors submitting bids shall register as a Jefferson Parish vendor, if not already registered. Registration forms may be downloaded from <http://purchasing.jeffparish.net> and click on Vendor Information. Current W-9 forms with respective Tax Identification numbers and vendor applications may be submitted at any time; however, if your company is not registered and/or a current W-9 form is not on file, vendor registration is mandatory. Vendors may experience a delay in payment if your company is not a registered vendor with Jefferson Parish.

Bidders must comply with all provisions of this Notice, the Standard General Conditions of the Construction Contract and any special conditions and specifications contained herein, all of which are made part of this bid proposal. Resolution No. 141125, as amended, will be considered a part of the bid whether attached or not. A copy of these terms and resolutions may be obtained from the Office of the Parish Clerk, Suite 6700, Jefferson Parish General Government Building, 200 Derbigny Street, Gretna, Louisiana 70053. Bidders may also obtain a copy by visiting the Purchasing Department's webpage at <http://purchasing.jeffparish.net> and clicking on online forms.

**Bid Security:** Bidders shall provide bid security in the form of an electronic bid bond in the amount of five percent (5%) of the total bid price (Base Bid and any Alternates) (as per R.S. 38:2218). The Bid Security shall remain valid until the contract is executed or until final disposition is made of the bids submitted. Such security will become the property of the Parish in the event the successful bidder fails or refuses to execute the contract or fails to produce performance and payment bonds upon contract signing. Bids shall remain binding for at least forty-five (45) days after the date set for the Bid Opening. In the event the Parish issues the Letter of Award during this period, the bid

accepted shall continue to remain binding until the execution of contract. Jefferson Parish and the lowest responsible bidder, by mutual written consent, may agree to extend the deadline for award by one or more extensions of thirty (30) calendar days.

When submitting online, bidders must submit an electronic bid bond through the respective online clearinghouse bond management system(s) as indicated in the electronic bid solicitation on Central Auction House. No scanned paper copies of any bid bond will be accepted as part of the electronic bid submission.

**Performance Bond:** A performance bond is required in 100% of the contract amount and is due at the signing of the formal contract, unless another percentage is required in the bid specifications. In the event of a conflict between these instructions and the bid specifications, the bid specifications shall control.

**Payment Bond:** A payment bond is required in 100% of the contract amount and is due at the signing of the formal contract, unless another percentage is required in the bid specifications. In the event of a conflict between these instructions and the bid specifications, the bid specifications shall control.

To the extent permitted by law, the bond requirements as set forth herein are waived insofar as Community Development Housing Rehabilitation Construction Contracts are concerned for single family, owner-occupied dwellings. The Parish Attorney's Office will omit the requirements in connection with Community Development Housing Rehabilitation Construction Contracts for single family, owner-occupied dwellings.

#### **K. INSURANCE REQUIREMENTS**

All bidders must submit with bid submission a current (valid) insurance certificate evidencing required coverages. Failure to comply will cause the bid to be rejected. The current insurance certificate will be used for proof of insurance at time of evaluation. Thereafter, and prior to contract execution, the low bidder will be required to provide final insurance certificates to the Parish which shall name the **Jefferson Parish, its Districts, Departments and Agencies under the direction of the Parish President and the Parish Council** as additional insureds regarding negligence by the contractor for the Commercial General Liability and the Comprehensive Automobile Liability policies. **Additionally, said certificates should reflect the name of the Parish Department receiving goods and services and reference the respective Jefferson Parish bid number.**

#### **JEFFERSON PARISH REQUIRED STANDARD INSURANCE**

##### **☒ WORKER'S COMPENSATION INSURANCE**

As required by Louisiana State Statute, exception; Employer's Liability, Section B shall be \$1,000,000 per occurrence when Work is to be over water and involves maritime exposures to cover all employees not covered under the State Worker's Compensation Act, otherwise this limit shall be no less than \$500,000 per occurrence.

☒ **COMMERCIAL GENERAL LIABILITY**

Shall provide limits not less than the following: \$1,000,000 Combined Single Limit per Occurrence for bodily injury and property damage.

☒ **COMPREHENSIVE AUTOMOBILE LIABILITY**

Bodily injury liability \$1,000,000 each person; \$1,000,000 each occurrence. Property Damage Liability \$1,000,000 each occurrence.

**UMBRELLA LIABILITY COVERAGE**

An umbrella policy or excess may be used to meet minimum requirements.

**FOR CONSTRUCTION AND RENOVATION PROJECTS:**

The following are required if selected. Such insurance is due upon contract execution.

☒ **OWNER'S PROTECTIVE LIABILITY**

To be for the same limits of liability for bodily injury and property damage liability established for commercial general liability.

☒ **BUILDER'S RISK INSURANCE**

The contractor shall maintain Builder's Risk Insurance at his own expense to insure both the Parish of Jefferson and contractor as their interest may appear.

**INSURANCE DEDUCTIBLES** - The Parish Attorney with concurrence of the Director of Risk Management have waived the deductible section of the Terms and Conditions for all Invitations to Bid, until further notice.

**L. INDEMNIFICATION**

Bidder acknowledges that bidder recovered the cost of any required insurance in the contract price as required by LA R.S. 9:2780.1(l) and that bidder recovered any such cost for the purposes of insuring an obligation to indemnify Jefferson Parish, defend Jefferson Parish, or hold Jefferson Parish harmless and that bidder's indemnity liability is limited to the amount of the proceeds that are payable under the insurance policy or policies that bidder has obtained.

**M. FAMILIARITY WITH LAWS AND ORDINANCES**

Bidders shall familiarize themselves with and shall comply with all applicable Federal and State Laws, Parish/Municipal Ordinances, Resolutions, and the rules and regulations of all authorities having jurisdiction over construction of the project, which may directly or indirectly affect the work or its prosecution.

These laws and/or ordinances will be deemed to be included in the contract, the same as though herein written in full.



In case of conflict between the requirements of these specifications and any State and/or Federal Regulations or Laws, the State and/or Federal Regulations or Laws shall take precedence in all cases in which State and/or Federal Funding of the contract, in whole or in part, depends upon compliance with said State and/or Federal Regulations or Laws.

#### **N. MISCELLANEOUS**

The successful bidder may be required to furnish a statement of the origin, composition, and manufacture of materials to be used in construction of the work together with samples, which samples may be subjected to testing to determine their quality and fitness for the work, as specified.

Bidders are not to exclude from participation in, deny the benefits of, or subject to discrimination under any program or activity, any person in the United States on the grounds of race, color, national origin, sex or religion except that any exemption from such prohibition against discrimination on the basis of religion as provided in the Civil Rights Acts of 1964, or Title VI and VII of the Act of April 11, 1968 shall also apply, as amended; nor discriminate on the basis of age under the Age Discrimination Act of 1975, as amended; nor with respect to an otherwise qualified handicapped individual as provided in Section 504 of the Rehabilitation Act of 1973, as amended. This assurance includes compliance with the administrative requirements of the Revenue Sharing final handicapped discrimination provisions contained in Section 51.55 (c), (d), (e), and (k) (5) of the Regulations.

Non-negotiable contract terms include but are not limited to taxes, assignment of contract, audit of records, EEOC and ADA compliance, record retention, content of contract/order of precedence, contract changes, force majeure, governing law, including ethics statements, claims or controversies, and termination based on contingency of appropriation of funds, as applicable.

COVID Memorial Park

Bid Proposal No. 50-00142373

Addendum No. 1

Date: 06/22/2023

Page 1 of 23

**Contract Documents, Specifications**

**And**

**Contract Drawings for**

**COVID Memorial Park**

**Jefferson Parish Department of Parks and Recreation**

**Parks and Recreation Project No. 20152**

**Bid Proposal No. 50-00142373**

---

**Addendum No. 1**

**Date Issued: June 22, 2023**

---

**NEW BID DATE: June 27, 2023**

**BID LOCATION: Jefferson Parish General Government Building**

**Jefferson Parish Purchasing Dept., Suite 4400**

**200 Derbigny St., Gretna, LA 70053**

---

This addendum shall be part of the Contract Documents as provided in the Instructions to Bidders.

The following items are issued to add to, modify, and clarify the Contract Documents. These items shall have full force and effect as the Contract Documents, and the cost involved shall be included in the bid prices.

Acknowledge receipt of the addendum by inserting its number on the Bid Form of the Bid Documents. Failure to do so will subject the bidder to rejection.

The Addendum No. 1 consists of 23 pages including the drawing sheets and attachments.

# ADDENDUM

## COVID MEMORIAL PARK

BID No.: 50-00142373

Date	June 22, 2023	Addendum No.	01
Re	Jefferson Parish	Issued By	Manning
	COVID Memorial Park		650 Poydras Street, Suite 1250
			New Orleans, LA 70130
	5858 Westbank Expy.		Telephone: 504-412-2000
	Marrero, LA 70072		Facsimile: 504-412-2001
Issued To	All bidders		

This addendum is a part of the Documents and shall be included in the Documents. Changes made by the addenda take precedence over information published at an earlier date. Acknowledge receipt of this addendum on the bid form. Failure to acknowledge receipt of this addendum in your proposal may render your bid non-responsive.

### GENERAL CLARIFICATIONS:

1. The sign in sheets from the Pre-Bid Conference are included with this Addendum for reference.
2. The revised Bid Form is included with this Addendum.
3. The following clarifications are from the project's original bid for reference:
  - a. The granite panels included in the project are to serve as the mounting surface for engrave metal plates to be mounted. The engraved metal plates are not included in this project and will be the responsibility of the Owner.
  - b. Regarding the permeable brick pavers, follow the paver assembly shown on 2/ L401. The intent is the brick pavers are laid in the sand bed shown with a sand filled 3/16" joint, as stated in the detail referenced, to still allow water to permeate. No concrete mortar is called out in the detail.

### INTERROGATIVES:

1. Can civil drawings be re-issued as electronic copy. The quality on current C drawings is too poor to accurately take-off. Being that this job is being bid lump sum, this is very important.  
**The drawings are being reissued as part of this Addendum.**
2. Civil details depict 7'-6" walking path width, architectural drawings indicate 8' walking path width. Please clarify.  
**If the Bidder is referring to Section 201 on C-0003 where we indicate a 7'-6" wide sidewalk / walking path, that width is correct based on the width shown on the Site Plan (Sheet C-0004) where Section 201 is taken. Please provide the specific "Architectural Drawings" that conflict with that stated width.**
3. Civil Section 201 on Sheet C-0003 indicates a 5' walking path opposite the 7'-6" walking path. No 5' path is shown on plan view at that location. Please clarify.  
**Correct, the 5' Walking Path should be removed from the Parking Lot Section – Detail 201 on Sheet No. C-0003. Barrier curb and gutter shall be installed on the east side of the Parking Lot, and all areas where there is no adjoining proposed concrete walkway.**
4. No curb and gutter depicted on plan view (sheet C-0004), but shown in section 200 on C-0004. Are we to include curb and gutter only at drive section or around all asphalt?

## ADDENDUM

### COVID MEMORIAL PARK

BID No.: 50-00142373

There is no Section 200 on Sheet No. C-0004, Section 200 is on Sheet No. C-0003. We believe the Bidder is stating that Section 200 on Sheet No. C-0003 shows concrete barrier curb and gutter on both sides, but it's not shown on Sheet No. C-0004. The concrete barrier curb and gutter for the driveway is specified in Callout I on Sheet No. C-0004. **Concrete barrier curb and gutter shall be installed on both sides of the Driveway.**

5. Asphalt Paving Detail 201 / Sheet C-0003 shows a section view of the asphalt pavement at the parking lot. If you look at the ends where the asphalt parking lot meets the concrete sidewalk, it shows that the asphalt parking lot and the concrete sidewalk are flush. Can you verify that there is no curb & gutter at these areas where the asphalt pavement meets the concrete sidewalk?

**Please refer to Sheet No. C-0003, Rev. 2 to be issued in an Addendum. There is no concrete barrier curb and gutter where the 7'-6" sidewalk adjoins the Parking Lot. Concrete barrier curb and gutter is required where the 5' sidewalk was originally shown in the Rev. 1 and original versions of Sheet No. C-0003.**

Also, if you look to the right of Detail 201/ Sheet C-0003, you will see a 5' Wide Concrete Sidewalk. However, this 5' Wide Sidewalk is not shown on any of the Site Plans. Can you verify that this 5' Sidewalk is included in this bid?

**Please refer to Sheet No. C-0003, Rev. 2 to be issued in an Addendum. The 5' sidewalk has been removed, and concrete barrier curb and gutter is now required.**

6. Curb and Gutter Detail 200 / Sheet C-0003 shows a section view where it splits the driveway section. This section view shows a concrete barrier curb and gutter on the outsides of the asphalt paving driveway. The civil, architectural, & landscape plans are very unclear to the limits of this concrete barrier curb and gutter. Can you verify the linear feet and limits of this concrete barrier curb and gutter?

**The concrete barrier curb and gutter is applicable for the entire length of the Driveway on both sides as shown in the Section. It will extend for the entire length of the median.**

7. Concrete Sidewalk Section 027060 Concrete Walks, Drives, And Incidental Paving Specs, Part 2 Section 2.2 (A.) Details that ¾" Redwood shall be used for the Joint Materials. However, Part 3 Section 3.6 (A.) Details that the expansion joints shall be ½" thick. Can you clarify what size expansion joints shall be used?

**Please refer to Jefferson Parish Standard Detail titled "Typical Sidewalk Detail". Expansion joints shall be ¾" thick redwood.**

8. Please provide source for the granite panels at the covid memorial walls.

**No specific source limitation is provided. Owner preference is source to be local and color selection to be made from company's standard color options with final selection by Owner.**

9. Please clarify if Memorial foundation slab is to be integral color as shown in the architectural plan? Or Is there another slab on top of the foundation slab that will be integral color / regular colored concrete?

**Integral color.**

10. LANDSCAPE PLANTING – What is the spacing O.C. for the Royal Purple Liriope planting?  
**12" OC**

11. TIFGREEN BERMUDA GRASS SEED – Please provide a source for the seed.

**If the Tifgreen Bermuda Seed is not readily available, the bidder can choose from the approved alternatives below:**

- Oasis Bermuda Grass
- Arden 15 Bermuda Grass
- Blackjack Bermuda Grass
- LaPrima XD Bermuda Grass

12. TREES – What caliper or container size is the Southern Live Oak and the Southern Catalpa?

**Southern Live Oak: The Live Oak must meet the requirements noted on the schedule**

**Southern Catalpa: The Catalpa must be a minimum of 2" caliper and meet the other noted requirements in the planting schedule**

## ADDENDUM

### COVID MEMORIAL PARK

BID No.: 50-00142373

13. Please verify the number of Handicapped Parking Spots? There are some discrepancies between the Civil, Architectural, and Landscape Plans.  
**Sheet No. C-0004, Rev. 2 (& Rev. 3 to be issued in an Addendum) indicate five (5) Handicap Parking Spaces per Callout F. We cannot address what is shown in the Architectural and Landscape Plans based on the information provided by the Bidder.**
14. Detail 100/ C-0002 Sheet says the Sign shall read As Indicated on Plan. I am unable to locate anywhere in the plans what this site signage needs to read. Please verify what the Site Signs need to display, the quantity, and the location(s)?  
**The referenced Detail applies at Handicap Parking Stalls. Please see Detail C-171 on Sheet No. C-0002 where the sign is specified.**
15. Sheet C-0003 - Please verify the limits & locations of the 8" Wide Slotted Trench Drain?  
**Please refer to Callout U on Sheet No. C-0004.**
16. The plans are vague about the locations of the Pedestrian Ramp(s) and the ADA Ramp(s). Can you clarify the locations of these Ramp(s)?  
**Sheet No. C-0004, Rev. 2 (& Rev. 3 to be issued in an Addendum) indicate two (2) ADA Ramps to be constructed per Callout M or shown with a solid filled square.**
17. In the front end of the specifications, it notes the awarded contractor will need to perform a Final Property Survey at the completion of the project. Can you elaborate on exactly what needs to be surveyed? Are we talking about final elevations of concrete foundation for flood purposes, or surveying the entire construction area?  
**Final property survey to include final elevations of all new and existing project elements, all project component locations, all roads, curbing, and major landscape elements within the project boundary. This item is in addition to as-built/ record drawings required at project completion.**
18. The scope of work for specifications Heavy Timber Truss (061360) and Shop Fabricated Wood Truss (061753) don't show up on the plans. Has this scope been eliminated from the project?  
**Yes, heavy timber scope has been eliminated. Pavilion shelters to be tube steel, reference structural drawings.**
19. Does detail #1 on sheet L401 only occur at two locations shown on L201 to the plan South of the fountain and around the fountain? There seems to be similar markings on the drawings around planting areas at the asphalt paving, but there is no cut section to indicate there should be a flush concrete curb.  
**Detail 1/L401 is only where indicated on sheet L201.**
20. Plan sheet C004 has decorative concrete islands illustrated around the asphalt paving areas, but plan sheet L201 is showing landscaped planting areas in those same locations. Which is correct?  
**C0004 calls out "Decorative Island/Median" consistent with the landscape plans.**
21. On plan sheet L201, around the fountain, there is concrete that will be integrally colored concrete (in strips). This was removed from the project the first time this project bid, likely due to the complexity/difficulty to pour the concrete with the strips being integral colored concrete. Will this scope remain in the project for this bid?  
**Bid the project as presented in this bid package.**
22. Plans have seed specified. There is written specifications for sod but not any for seed?? Can you please provide a seed specification.  
**Reference specification 32 92 01\_Grass Seed Specifications included as part of this addendum.**
23. Metal edging is in the specifications but none shown in the plans. Can you please clarify and provide a detail of where the edging is to be located.  
**If metal edging is not called out in the plans or details, then it is not in the scope of the project.**

#### SPECIFICATIONS:

1. Grass Seed Specification

# ADDENDUM

## COVID MEMORIAL PARK

BID No.: 50-00142373

### DRAWINGS:

*Replace the following drawings in their entirety.*

1. All Civil drawings are being reissued due to previous print quality. Revisions to the following sheets include:
  - a. Sheet No. C-0003
    - i. Revised Section 201 to delete proposed 5' sidewalk, and added concrete barrier curb and gutter....this change address Bidder's below Comment No. 3.
    - ii. Revised Section 200 to indicate a constant median width of 11.6' to meet LDOTD Driveway Permit requirements.
  - b. Sheet No. C-0004
    - i. Revised to meet LDOTD Driveway Permit requirements such that the Entrance travel lane width will be 20' and the Exit travel lane width will be 12'
  - c. Sheet No. C-0005
    - i. Revised to meet LDOTD Driveway Permit requirements such that the Entrance travel lane width will be 20' and the Exit travel lane width will be 12'
2. Architectural Drawings included below to match Civil changes referenced above:
  - a. A102 – Enlarged Site Plan – COVID Memorial
  - b. A103 – Geometry Plan
  - c. A211 – COVID Memorial

### PRIOR APPROVALS:

*Review and approval/ denial of substitution requests are for general comparison to the original specified product. It is the responsibility of the bidder to confirm all components, finishes, quality, and fitment meet the original specifications. Final color/ finish selection at the discretion of the Architect post bid.*

1. Light Fixtures
  - a. See attached prior approval letter included with this addendum.

### REVISED PUBLIC WORK BID FORM:

1. Revised to declare the preparer of the bidding documents.

### ATTACHMENTS:

1. Revised Public Work Bid Form
2. Pre-Bid Sign In Sheets
3. Grass Seed Specification
4. Drawings referenced above
5. Prior approval letter referenced above

END OF ADDENDUM



# PRE-BID CONFERENCE SIGN-IN SHEET

Page 1

BID #:50-00142373  
 LOCATION:5851 5th Street Marrero, La. 70072  
 DATE AND TIME:06/08/2023 @ 9:00AM  
 START TIME: 9:05AM STOP TIME: 4:25AM

COMPANY NAME	COMPANY REPRESENTATIVE	PHONE	EMAIL ADDRESS	SIGN-IN TIME
Jefferson Parish Purchasing	Donna Reamey	504-364-2684	Dreamey@jeffparish.net	
JP Purchasing	Misty Guardelle	504-364-2685	mccainade11e@jeffparish.net	8:49 AM
Manning	RYAN BERTNER	504-412-2000	mb@manninc.xyz	8:50
CM Combs Construction, LLC	CAROL SCOTT	985-867-4960	Frontdesic@cmcombsconstruction.com	8:51
Thru Construction	Don Bruce	(504) 305-8849	Bidsoff@thruconstruction.com	8:53
NPG Construction	Eric Turner	205-936-9431	ETurner@veriusproperty.com	8:57
MANNING, APC	MARK CLAYTON	504-412-2000	MWC@manninc.xyz	8:57
JPRD	Gerry "Buzze" Constant	(504) 839-4413	gconstant@jeffparish.net	8:59

**PRE-BID CONFERENCE SIGN-IN SHEET**

Page 2

BID #:50-00142373      DESCRIPTION: COVID Memorial  
 LOCATION:5851 5th Street Marrero, La. 70072  
 DATE AND TIME:06/08/2023 @ 9:00AM

COMPANY NAME	COMPANY REPRESENTATIVE	PHONE	EMAIL ADDRESS	SIGN-IN TIME
JPRD	Jaxette Carmouche	(504) 296-0039	JCarmouche@JeffPard.com	9:00



SECTION 32 92 01 – Grass Seed

PART 1 - GENERAL

1.1 SUMMARY

- A. The scope of work includes all labor, materials, appliances, tools, equipment, facilities, transportation and services necessary for, and incidental to performing all operations in connection with furnishing, delivery, and installation of seed (also known as "landscaping" complete as shown on the drawings and as specified herein.
- B. The scope of work in this section includes, but is not limited to, the following:
  - 1. Preparation of subsoil.
  - 2. Placing topsoil.
  - 3. Fertilizing.
  - 4. Seed installation.
  - 5. Maintenance.

1.2 CONTRACT DOCUMENTS

- A. Shall consist of specifications and general conditions and the construction drawings. The intent of these documents is to include all labor, materials, and services necessary for the proper execution of the work. The documents are to be considered as one. Whatever is called for by any parts shall be as binding as if called for in all parts.

1.3 RELATED DOCUMENTS AND REFERENCES

- A. Drawings and general provisions of contract including general and supplementary conditions and Division I specifications apply to work of this section.
- B. Related Specification Sections
  - 1. Section 32 93 00 – Plant Installation
  - 2. Section 32 91 00 – Soil Preparation
- C. References: LADOTD (Louisiana Department of Transportation and Development - Guideline Specifications to Seeding.

1.4 DEFINITIONS

- A. Weeds: Includes but is not limited to Dandelion, Jimsonweed, Quackgrass, Horsetail, Morning Glory, Rush Grass, Mustard, Lambsquarter, Chickweed, Cress, Crabgrass, Canadian Thistle, Nutgrass, Poison Oak, Blackberry, Tansy Ragwort, Johnson Grass, Poison Ivy, Nut Sedge, Nimble Will, Bindweed, Bent Grass, Wild Garlic, Perennial Sorrel, and Brome Grass.

1.5 MAINTENANCE DATA

- A. Operation Data: Submit for continuing Owner maintenance.

- B. Maintenance Data: Include maintenance instructions, cutting method and maximum grass height; types, application frequency, and recommended coverage of fertilizer.
- 1.6 QUALITY ASSURANCE
  - A. Labeling: Every shipment of grass seed shall be accompanied by an invoice or sales slip indicating whether the material is of a single variety, a blend or a mixture and the quality.
- 1.7 QUALIFICATIONS
  - A. Seed Producer: Company specializing in plant seed production.
  - B. Installer Qualifications: Company specializing in seed installation and licensed by the State of Louisiana.
  - C. The contractor shall have a current and valid Louisiana Landscape Horticulturalist License as issued by the Louisiana State Horticultural Commission. The Contractor or Subcontractor shall be required to perform the work specified in the drawings and specifications. All Landscape Horticulturalists shall also have appropriate experience related to the work specified herein.
  - D. The Contractor shall provide proof of qualifications for verification.
- 1.8 REGULATORY REQUIREMENTS
  - A. Comply with regulatory agencies for fertilizer and herbicide composition.
- 1.9 DELIVERY, STORAGE, AND HANDLING
  - A. Deliver, store, protect and handle products to site.
- 1.10 COORDINATION
  - A. Coordinate work under this section and other related work.
- 1.11 MAINTENANCE SERVICE
  - A. Maintain seeded areas immediately after placement until grass is well established and fully rooted into the subsoil and exhibits a vigorous growing condition for two cuttings prior to acceptance.

## PART 2 - PRODUCTS

### 2.1 MATERIALS

- A. Seed:
  - 1. Seed shall comply with the requirements of Louisiana law. The minimum percentage of pure live seed for specified Bermuda shall be 83%.
  - 2. Bermuda Grass (*Cynodon dactylon*) hybrids; acceptable varieties include Oasis, Maya (Blackjack II), Tifsport, or Tifway 419.
  - 3. Each variety of seed shall be furnished and delivered in separate bags or other containers.

4. Seed furnished shall be the previous season's crop (the last crop year for the crop kind in question)
  5. Noxious weeds shall be interpreted to mean that list of weeds, except Bermuda, which has been adopted by the Louisiana Seed Commission as being noxious in Louisiana. Noxious weed seeds shall not exceed the limitations prescribed in the regulations and in no case shall they exceed 500 seeds per pound.
- B. Soil fill for fine grading:
1. Refer to Section 32 91 00 for soil preparation as included in project specifications.
  2. Unless otherwise specified, topsoil shall be a loamy sand, sandy loam, clay loam, loam, silt loam, sandy clay loam or other soil approved by the Landscape Architect. It shall not have a mixture of subsoil and shall contain no slag, cinders, stones, lumps of soil, sticks, roots, trash or other extraneous materials larger than 1.5 inches (40 mm) in diameter.
  3. If included in topsoil mixture, Mississippi River pump sand must be free of sticks, roots, stones, lumps of clay, debris and other objectionable materials. Spillway dirt will not be accepted.
  4. Topsoil must also be free of viable plants or plant parts of common bermudagrass, quackgrass, johnsongrass, nutsedge, poison ivy, Canada thistle, or others as may be specified.
  5. Unless otherwise specified, all topsoil shall be tested by a reputable laboratory for pH and soluble salts; results must be submitted to the Landscape Architect prior to installation.
  6. As needed, pH correction material shall be applied at a rate sufficient to correct the pH to a range of 6.0 to 7.0. Soluble salts shall not be higher than 500 parts per million.
- C. Fertilizer: Soil tests shall be made to determine the exact requirements for any amendments. Soil tests shall be conducted by a reputable laboratory and results provided to the Landscape Architect.
1. All fertilizers (either granular or liquid) shall be uniform in composition, free flowing and suitable for application with approved equipment.
  2. Fertilizers shall be delivered to the site fully labeled, according to applicable fertilizer laws and shall bear the name, trade name or trademark, and warranty of the producer or manufacturer.
  3. Fertilizer applications shall be determined by soil tests. If soil testing is waived where there is insufficient time for complete soil tests, fertilizer materials that supply the following levels of nutrients can be applied: nitrogen – fifteen percent (15%), phosphoric acid – five percent (5%), soluble potash – ten percent (10%).

- 4. Fertilizers shall be distributed uniformly over the entire area(s) where turfgrass seed is to be installed.
- D. Water: Clean, fresh and free of substances or matter which could inhibit vigorous growth of grass. Do not use brackish, chemically contaminated, or oily water.
- 2.2 TESTS
  - A. Testing is not required if recent tests are available for imported topsoil. Submit these test results to a reputable testing laboratory or the LSU AgCenter for recommendations regarding necessary amendments, fertilizers, or pH adjustments necessary.
  - B. Use the test results and recommendations to determine the quantities of agricultural lime and fertilizer required for pre-planting applications.
  - C. Provide a copy of the results and/or recommendations to the Landscape Architect.

### PART 3 - EXECUTION

#### 3.1 PREPARATION OF SEED BED

- A. Verify that the prepared soil base is ready to receive the work of this section.

#### 3.2 PREPARATION OF SUBSOIL

- A. See Part 3 of Section 32 91 00, Soil Preparation.
- B. Prepare seed beds by disking, harrowing, or other approved methods. On slopes of 3-horizontal-to-1 vertical and flatter, till the soil to a minimum of 4" depth. On slopes between 3-horizontal-to-1 vertical and 1-horizontal-to-1 vertical, till the soil to a minimum of 2 inches depth by scarifying with heavy rakes or other methods. Use rototillers where soil conditions and length of slope permit. On slopes 1-horizontal-to-1 vertical and steeper, no soil tillage is required.
- C. Maintain drainage patterns as indicated on the plans. Completely pulverize areas compacted by construction operations by tillage. Apply the pH adjuster, fertilizer, and soil conditioner during this procedure. The prepared surface shall be a maximum of 1 inch below the adjoining grade of any surfaced area. Blend new surfaces to existing areas. Lightly rake the completed surfaces to remove debris.
- D. Lawn Area Debris: Remove debris and stones greater than 5/8 inch in any dimension from the surfaces designated on the plans as lawn areas or as directed by the Landscape Architect.

#### 3.3 PLACING TOPSOIL

- A. See Part 3 of Section 32 91 00, Soil Preparation.

#### 3.4 FERTILIZING

- A. See Part 3 of Section 32 91 00, Soil Preparation.

3.5 PROTECTION

- A. Protect prepared surface area from compaction or damage by vehicular or pedestrian traffic and surface erosion.

3.6 SEEDING

1. Plant seed during the Spring months after March 21<sup>st</sup>. Other times in the calendar year must be approved in writing by the landscape architect.

3.7 MAINTENANCE

A. WATERING

1. When necessary due to dry conditions, periodically water seeded areas until final acceptance.

B. SEED ESTABLISHMENT PERIOD

1. The seed establishment period shall begin on the first day of seeding work under the contract and shall end 3 months after the last day of the seeding operation. The contractor shall provide a written calendar time period for the seed. When there is more than one seed establishment period, the boundaries of each seeded area covered by each period shall be described. The seed establishment period may be modified for inclement weather, shut down periods, or for separate completion dates of areas as approved by the engineer. Bermuda turf will be considered to be established and completed when the areas to be turfed have produced Bermuda grass stems or runners which overlap adjacent Bermuda grass growth over a minimum of 85 percent of the entire area and no spots greater than 4 square feet are void of Bermuda grass. This will be determined by the landscape architect in random sampling on a square yard basis. Acceptance of the entire turfed area will be based on the landscape architect's visual inspection and determination of the required coverage. Acceptance will be based on coverage by Bermuda grass only. Dying or dead turf and eroded areas will not be accepted. Correct deficient areas at no direct pay. Partial areas will not be accepted unless determined by the landscape architect to be in the best interest of the Owner.

END OF SECTION

[illegible]

\_\_\_\_\_

---



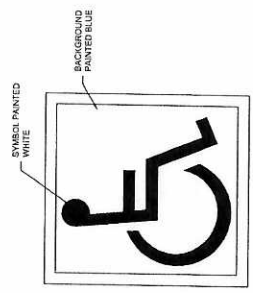

**HANDICAP SYMBOL**  
SCALE: N.T.S. (22"x34" SHEET)

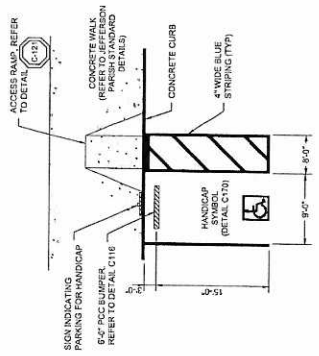

**HANDICAP PARKING STALL**  
SCALE: N.T.S. (22"x34" SHEET)

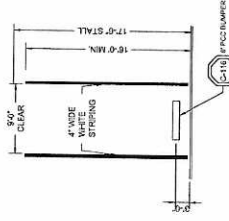

**PARKING STALL**  
SCALE: N.T.S. (22"x34" SHEET)

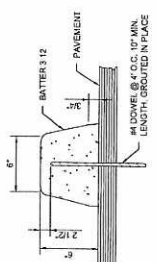

- NOTES:
1. CURB SHALL BE CONSTRUCTED OF PORTLAND CEMENT CONCRETE.
  2. CURB SHALL BE 4" HIGH AND 12" WIDE TO PAVED SURFACE.
  3. PRIOR TO INSTALLATION OF PCC CURB.
  4. ALL EXPOSED CORNERS ON PCC CURBS AND GUTTERS TO BE ROUNDED TO A MINIMUM RADIUS OF 1/4" UNLESS OTHERWISE INDICATED.

**PCC BUMPER**  
SCALE: N.T.S. (22"x34" SHEET)

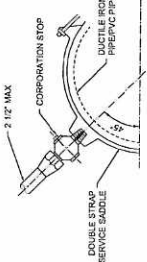

- NOTES:
1. FOR LARGER CONNECTIONS PROVIDE TAPPING TEE ON TEE FITTING.
  2. FOR PVC PIPE STAGGER ADJACENT TAP 2' 1/2" CENTER.

**SERVICE TAP**  
SCALE: N.T.S. (22"x34" SHEET)

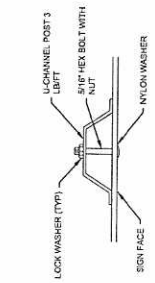
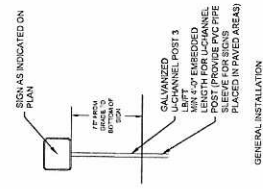

**SITE SIGNAGE**  
SCALE: N.T.S.

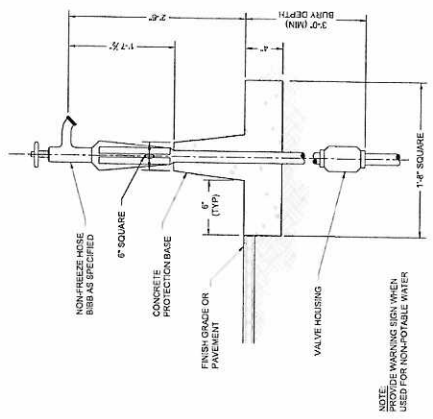

**SURFACE MOUNTED NON-FREEZE HOSE BIBB**  
SCALE: N.T.S. (22"x34" SHEET)

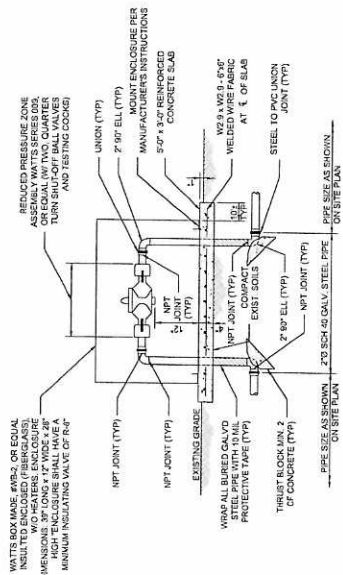

**BACKFLOW PREVENTER**  
SCALE: N.T.S. (22"x34" SHEET)

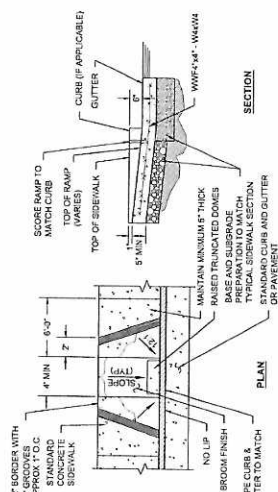

**PEDESTRIAN RAMP**  
SCALE: N.T.S. (22"x34" SHEET)





CURVE NO.	ARC LENGTH (FT)	CURVE RADIUS (FT)
1	46.48	25.0
2	57.00	50.0
3	18.88	5.0
4	18.88	5.0
5	50.00	5.0
6	50.00	5.0
7	25.00	25.0
8	102.50	42.5
9	157.26	42.5
10	232.36	150.0
11	25.33	31.2
12	21.18	19.0
13	14.14	7.7
14	14.14	7.7
15	30.90	30.9
16	18.56	12.0
17	170.02	128.9
18	163.32	128.9
19	12.37	5.0
20	39.34	75.0
21	14.14	7.7
22	39.34	75.0
23	15.71	5.0
24	82.05	160.0
25	13.00	10.0
26	15.87	10.0
27	64.64	125.0
28	17.19	10.0
29	78.48	440.0
30	22.79	15.0
31	14.14	7.7
32	215.15	125.0
33	34.43	20.0
34	45.43	440.0
35	23.78	100.0
36	78.35	100.0
37	30.32	35.0
38	138.25	40.0
39	20.51	250.0
40	20.51	250.0
41	118.88	41.0
42	280.28	207.0
43	18.31	12.0
44	15.71	5.0
45	150.07	142.5
46	15.71	5.0
47	15.71	5.0
48	15.71	5.0
49	15.71	5.0
50	15.71	5.0
51	15.71	5.0
52	15.71	5.0
53	15.71	5.0
54	15.71	5.0
55	15.71	5.0
56	15.71	5.0
57	15.71	5.0
58	15.71	5.0
59	15.71	5.0
60	15.71	5.0
61	15.71	5.0
62	15.71	5.0
63	15.71	5.0
64	15.71	5.0
65	15.71	5.0
66	15.71	5.0
67	15.71	5.0
68	15.71	5.0
69	15.71	5.0
70	15.71	5.0
71	15.71	5.0
72	15.71	5.0
73	15.71	5.0
74	15.71	5.0
75	15.71	5.0
76	15.71	5.0
77	15.71	5.0
78	15.71	5.0
79	15.71	5.0
80	15.71	5.0
81	15.71	5.0
82	15.71	5.0
83	15.71	5.0
84	15.71	5.0
85	15.71	5.0
86	15.71	5.0
87	15.71	5.0
88	15.71	5.0
89	15.71	5.0
90	15.71	5.0
91	15.71	5.0
92	15.71	5.0
93	15.71	5.0
94	15.71	5.0
95	15.71	5.0
96	15.71	5.0
97	15.71	5.0
98	15.71	5.0
99	15.71	5.0
100	15.71	5.0
101	15.71	5.0
102	15.71	5.0
103	15.71	5.0
104	15.71	5.0
105	15.71	5.0
106	15.71	5.0
107	15.71	5.0
108	15.71	5.0
109	15.71	5.0
110	15.71	5.0
111	15.71	5.0
112	15.71	5.0
113	15.71	5.0
114	15.71	5.0
115	15.71	5.0
116	15.71	5.0
117	15.71	5.0
118	15.71	5.0
119	15.71	5.0
120	15.71	5.0
121	15.71	5.0
122	15.71	5.0
123	15.71	5.0
124	15.71	5.0
125	15.71	5.0
126	15.71	5.0
127	15.71	5.0
128	15.71	5.0
129	15.71	5.0
130	15.71	5.0
131	15.71	5.0
132	15.71	5.0
133	15.71	5.0
134	15.71	5.0
135	15.71	5.0
136	15.71	5.0
137	15.71	5.0
138	15.71	5.0
139	15.71	5.0
140	15.71	5.0
141	15.71	5.0
142	15.71	5.0
143	15.71	5.0
144	15.71	5.0
145	15.71	5.0
146	15.71	5.0
147	15.71	5.0
148	15.71	5.0
149	15.71	5.0
150	15.71	5.0
151	15.71	5.0
152	15.71	5.0
153	15.71	5.0
154	15.71	5.0
155	15.71	5.0
156	15.71	5.0
157	15.71	5.0
158	15.71	5.0
159	15.71	5.0
160	15.71	5.0
161	15.71	5.0
162	15.71	5.0
163	15.71	5.0
164	15.71	5.0
165	15.71	5.0
166	15.71	5.0
167	15.71	5.0
168	15.71	5.0
169	15.71	5.0
170	15.71	5.0
171	15.71	5.0
172	15.71	5.0
173	15.71	5.0
174	15.71	5.0
175	15.71	5.0
176	15.71	5.0
177	15.71	5.0
178	15.71	5.0
179	15.71	5.0
180	15.71	5.0
181	15.71	5.0
182	15.71	5.0
183	15.71	5.0
184	15.71	5.0
185	15.71	5.0
186	15.71	5.0
187	15.71	5.0
188	15.71	5.0
189	15.71	5.0
190	15.71	5.0
191	15.71	5.0
192	15.71	5.0
193	15.71	5.0
194	15.71	5.0
195	15.71	5.0
196	15.71	5.0
197	15.71	5.0
198	15.71	5.0
199	15.71	5.0
200	15.71	5.0

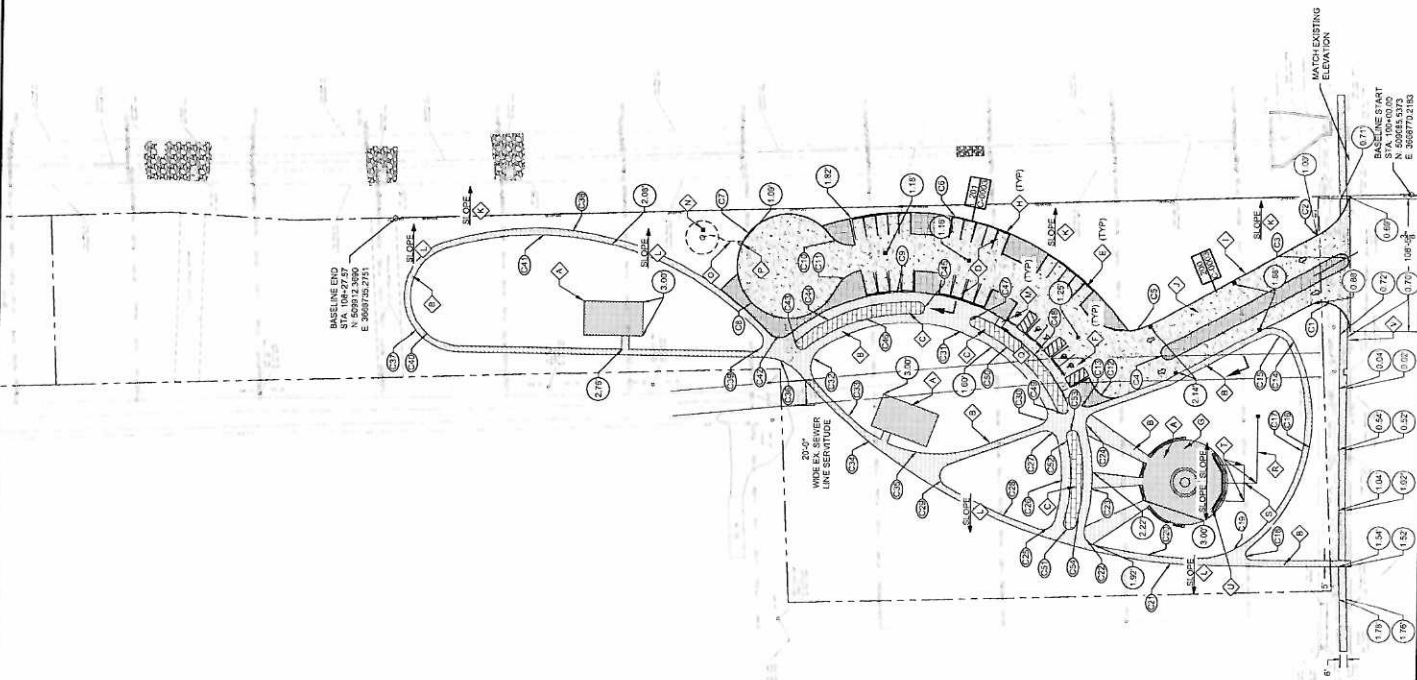

# NOTES

TO CONNECT TO THE EXISTING 6" PIPE, A SECTION OF THE EXISTING PIPE WOULD HAVE TO BE CUT AND REPLACED WITH 6" PIPE AND CONNECTION THE NEW PIPE TO THE EXISTING WATER LINE WITH LONG BODY TRANSITIONAL COUPLINGS AND CONNECTING THE FIRE SERVICE LINE TO THE PARISH WATER LINE WITH A TEE. COORDINATE ALL TAPPING WITH THE PARISH WATER DEPT. TO SHUT OFF THE WATER LINE. IF A FIRE WATCH IS REQUIRED, ALL COSTS WILL BE AT CONTRACTOR EXPENSE.

FOR METERS 7" OR SMALLER, THE WATER DEPT. SHALL TAP THE MAIN LINE, INSTALL VALVES AND DOMESTIC LINE, FURNISH AND INSTALL THE METER. THE OWNER/CONTRACTOR SHALL PAY ALL FEES PRIOR TO THE WORK.

ENCLOSE THE LATEST JEFFERSON PARISH WATER STANDARD SHEETS WITH THE PLANS. YOU CAN OBTAIN THIS INFORMATION ON THE PARISH WEB SITE AT [www.jeffparish.net](http://www.jeffparish.net).

THE ENGINEER SHALL SUBMIT "AS-BUILT" DRAWINGS TO THE DEPARTMENT OF ENGINEERING BEFORE A "USE AND OCCUPANCY PERMIT" IS RELEASED. A MINIMUM OF ONE MYLAR, 3 BLUE LINES AND ONE DIGITAL CD SHALL BE SUBMITTED.

ALL WORK SHALL BE DONE AS PER THE LATEST JEFFERSON PARISH STANDARD WATER, SEWERAGE AND DRAINAGE DETAILS AND SPECS FOR SEWERAGE (APPENDIX A AND B) AND WATER (APPENDIX C). THIS INFORMATION CAN BE OBTAINED ON THE PARISH WEB SITE AT [www.jeffparish.net](http://www.jeffparish.net).

BEFORE TAPPING THE EXISTING PARISH WATERLINES AND INSTALLING NEW WATERLINES INSIDE PARISH RIGHTS-OF-WAY OR WATER SERVITUDES, A PARISH REPRESENTATIVE MUST BE PRESENT WHO POSSESSES CLASS IV WATER DISTRIBUTION LICENSE. THE CONTRACTOR MUST POSSESS A MUNICIPAL-PUBLIC WORKS/MECHANICAL LICENSE.

ALL JOINTS MUST BE RESTRAINED AND ALL DUCTILE IRON PIPES AND FITTINGS SHALL BE ENCASED IN A MINIMUM 8 MIL THICK POLYETHYLENE.

ALL HYDRANT TEES SHALL BE SWIVEL TYPE WITH 6" VALVES PLACED ON HYDRANT LEADS.

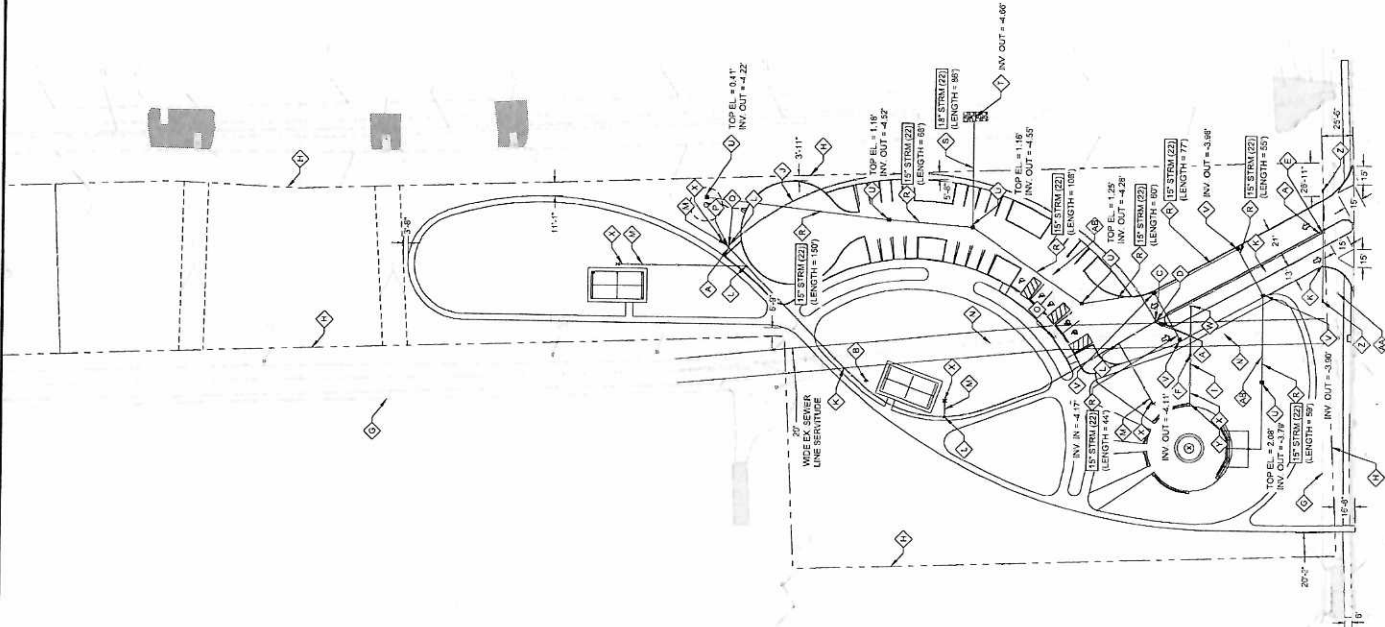

## LEGEND

- PROPOSED 1" WATER LINE
- PROPOSED 2" WATER LINE
- PROPOSED 4" WATER LINE
- PROPOSED 6" WATER LINE
- X PROPOSED HOSE RIBB
- X PROPOSED WATER FEATURE

## GENERAL NOTES

1. VERIFY ALL DIMENSIONS AND COORDINATES FOR AGREEMENT PRIOR TO CONSTRUCTION.
2. SEE SPECIFICATIONS FOR ADDITIONAL REQUIREMENTS RELATED TO SITE UTILITIES.
3. COORDINATE ALL SITE UTILITY WORK WITH THE SITE GRADING PLAN.
4. SEE THE PIPING SCHEDULE FOR ADDITIONAL INFORMATION.
5. PROVIDE BEDDING AND BACKFILL FOR ALL SITE UTILITIES PER DETAILS.
6. PROVIDE BEDDING AND BACKFILL FOR CATCH BASINS AND MANHOLES PER DETAILS.

## NOTES BY SYMBOL

1. 6" VALVE WITH VALVE BOX PER JEFFERSON PARISH STANDARD DETAILS
2. 6" VALVE WITH VALVE BOX PER JEFFERSON PARISH STANDARD DETAILS
3. 6" VALVE WITH VALVE BOX PER JEFFERSON PARISH STANDARD DETAILS
4. 6" VALVE WITH VALVE BOX PER JEFFERSON PARISH STANDARD DETAILS
5. 6" VALVE WITH VALVE BOX PER JEFFERSON PARISH STANDARD DETAILS
6. 6" VALVE WITH VALVE BOX PER JEFFERSON PARISH STANDARD DETAILS
7. 6" VALVE WITH VALVE BOX PER JEFFERSON PARISH STANDARD DETAILS
8. 6" VALVE WITH VALVE BOX PER JEFFERSON PARISH STANDARD DETAILS
9. 6" VALVE WITH VALVE BOX PER JEFFERSON PARISH STANDARD DETAILS
10. 6" VALVE WITH VALVE BOX PER JEFFERSON PARISH STANDARD DETAILS
11. 6" VALVE WITH VALVE BOX PER JEFFERSON PARISH STANDARD DETAILS
12. 6" VALVE WITH VALVE BOX PER JEFFERSON PARISH STANDARD DETAILS
13. 6" VALVE WITH VALVE BOX PER JEFFERSON PARISH STANDARD DETAILS
14. 6" VALVE WITH VALVE BOX PER JEFFERSON PARISH STANDARD DETAILS
15. 6" VALVE WITH VALVE BOX PER JEFFERSON PARISH STANDARD DETAILS
16. 6" VALVE WITH VALVE BOX PER JEFFERSON PARISH STANDARD DETAILS
17. 6" VALVE WITH VALVE BOX PER JEFFERSON PARISH STANDARD DETAILS
18. 6" VALVE WITH VALVE BOX PER JEFFERSON PARISH STANDARD DETAILS
19. 6" VALVE WITH VALVE BOX PER JEFFERSON PARISH STANDARD DETAILS
20. 6" VALVE WITH VALVE BOX PER JEFFERSON PARISH STANDARD DETAILS
21. 6" VALVE WITH VALVE BOX PER JEFFERSON PARISH STANDARD DETAILS
22. 6" VALVE WITH VALVE BOX PER JEFFERSON PARISH STANDARD DETAILS
23. 6" VALVE WITH VALVE BOX PER JEFFERSON PARISH STANDARD DETAILS
24. 6" VALVE WITH VALVE BOX PER JEFFERSON PARISH STANDARD DETAILS
25. 6" VALVE WITH VALVE BOX PER JEFFERSON PARISH STANDARD DETAILS
26. 6" VALVE WITH VALVE BOX PER JEFFERSON PARISH STANDARD DETAILS
27. 6" VALVE WITH VALVE BOX PER JEFFERSON PARISH STANDARD DETAILS
28. 6" VALVE WITH VALVE BOX PER JEFFERSON PARISH STANDARD DETAILS
29. 6" VALVE WITH VALVE BOX PER JEFFERSON PARISH STANDARD DETAILS
30. 6" VALVE WITH VALVE BOX PER JEFFERSON PARISH STANDARD DETAILS
31. 6" VALVE WITH VALVE BOX PER JEFFERSON PARISH STANDARD DETAILS
32. 6" VALVE WITH VALVE BOX PER JEFFERSON PARISH STANDARD DETAILS
33. 6" VALVE WITH VALVE BOX PER JEFFERSON PARISH STANDARD DETAILS
34. 6" VALVE WITH VALVE BOX PER JEFFERSON PARISH STANDARD DETAILS
35. 6" VALVE WITH VALVE BOX PER JEFFERSON PARISH STANDARD DETAILS
36. 6" VALVE WITH VALVE BOX PER JEFFERSON PARISH STANDARD DETAILS
37. 6" VALVE WITH VALVE BOX PER JEFFERSON PARISH STANDARD DETAILS
38. 6" VALVE WITH VALVE BOX PER JEFFERSON PARISH STANDARD DETAILS
39. 6" VALVE WITH VALVE BOX PER JEFFERSON PARISH STANDARD DETAILS
40. 6" VALVE WITH VALVE BOX PER JEFFERSON PARISH STANDARD DETAILS
41. 6" VALVE WITH VALVE BOX PER JEFFERSON PARISH STANDARD DETAILS
42. 6" VALVE WITH VALVE BOX PER JEFFERSON PARISH STANDARD DETAILS
43. 6" VALVE WITH VALVE BOX PER JEFFERSON PARISH STANDARD DETAILS
44. 6" VALVE WITH VALVE BOX PER JEFFERSON PARISH STANDARD DETAILS
45. 6" VALVE WITH VALVE BOX PER JEFFERSON PARISH STANDARD DETAILS
46. 6" VALVE WITH VALVE BOX PER JEFFERSON PARISH STANDARD DETAILS
47. 6" VALVE WITH VALVE BOX PER JEFFERSON PARISH STANDARD DETAILS
48. 6" VALVE WITH VALVE BOX PER JEFFERSON PARISH STANDARD DETAILS
49. 6" VALVE WITH VALVE BOX PER JEFFERSON PARISH STANDARD DETAILS
50. 6" VALVE WITH VALVE BOX PER JEFFERSON PARISH STANDARD DETAILS
51. 6" VALVE WITH VALVE BOX PER JEFFERSON PARISH STANDARD DETAILS
52. 6" VALVE WITH VALVE BOX PER JEFFERSON PARISH STANDARD DETAILS
53. 6" VALVE WITH VALVE BOX PER JEFFERSON PARISH STANDARD DETAILS
54. 6" VALVE WITH VALVE BOX PER JEFFERSON PARISH STANDARD DETAILS
55. 6" VALVE WITH VALVE BOX PER JEFFERSON PARISH STANDARD DETAILS
56. 6" VALVE WITH VALVE BOX PER JEFFERSON PARISH STANDARD DETAILS
57. 6" VALVE WITH VALVE BOX PER JEFFERSON PARISH STANDARD DETAILS
58. 6" VALVE WITH VALVE BOX PER JEFFERSON PARISH STANDARD DETAILS
59. 6" VALVE WITH VALVE BOX PER JEFFERSON PARISH STANDARD DETAILS
60. 6" VALVE WITH VALVE BOX PER JEFFERSON PARISH STANDARD DETAILS
61. 6" VALVE WITH VALVE BOX PER JEFFERSON PARISH STANDARD DETAILS
62. 6" VALVE WITH VALVE BOX PER JEFFERSON PARISH STANDARD DETAILS
63. 6" VALVE WITH VALVE BOX PER JEFFERSON PARISH STANDARD DETAILS
64. 6" VALVE WITH VALVE BOX PER JEFFERSON PARISH STANDARD DETAILS
65. 6" VALVE WITH VALVE BOX PER JEFFERSON PARISH STANDARD DETAILS
66. 6" VALVE WITH VALVE BOX PER JEFFERSON PARISH STANDARD DETAILS
67. 6" VALVE WITH VALVE BOX PER JEFFERSON PARISH STANDARD DETAILS
68. 6" VALVE WITH VALVE BOX PER JEFFERSON PARISH STANDARD DETAILS
69. 6" VALVE WITH VALVE BOX PER JEFFERSON PARISH STANDARD DETAILS
70. 6" VALVE WITH VALVE BOX PER JEFFERSON PARISH STANDARD DETAILS
71. 6" VALVE WITH VALVE BOX PER JEFFERSON PARISH STANDARD DETAILS
72. 6" VALVE WITH VALVE BOX PER JEFFERSON PARISH STANDARD DETAILS
73. 6" VALVE WITH VALVE BOX PER JEFFERSON PARISH STANDARD DETAILS
74. 6" VALVE WITH VALVE BOX PER JEFFERSON PARISH STANDARD DETAILS
75. 6" VALVE WITH VALVE BOX PER JEFFERSON PARISH STANDARD DETAILS
76. 6" VALVE WITH VALVE BOX PER JEFFERSON PARISH STANDARD DETAILS
77. 6" VALVE WITH VALVE BOX PER JEFFERSON PARISH STANDARD DETAILS
78. 6" VALVE WITH VALVE BOX PER JEFFERSON PARISH STANDARD DETAILS
79. 6" VALVE WITH VALVE BOX PER JEFFERSON PARISH STANDARD DETAILS
80. 6" VALVE WITH VALVE BOX PER JEFFERSON PARISH STANDARD DETAILS
81. 6" VALVE WITH VALVE BOX PER JEFFERSON PARISH STANDARD DETAILS
82. 6" VALVE WITH VALVE BOX PER JEFFERSON PARISH STANDARD DETAILS
83. 6" VALVE WITH VALVE BOX PER JEFFERSON PARISH STANDARD DETAILS
84. 6" VALVE WITH VALVE BOX PER JEFFERSON PARISH STANDARD DETAILS
85. 6" VALVE WITH VALVE BOX PER JEFFERSON PARISH STANDARD DETAILS
86. 6" VALVE WITH VALVE BOX PER JEFFERSON PARISH STANDARD DETAILS
87. 6" VALVE WITH VALVE BOX PER JEFFERSON PARISH STANDARD DETAILS
88. 6" VALVE WITH VALVE BOX PER JEFFERSON PARISH STANDARD DETAILS
89. 6" VALVE WITH VALVE BOX PER JEFFERSON PARISH STANDARD DETAILS
90. 6" VALVE WITH VALVE BOX PER JEFFERSON PARISH STANDARD DETAILS
91. 6" VALVE WITH VALVE BOX PER JEFFERSON PARISH STANDARD DETAILS
92. 6" VALVE WITH VALVE BOX PER JEFFERSON PARISH STANDARD DETAILS
93. 6" VALVE WITH VALVE BOX PER JEFFERSON PARISH STANDARD DETAILS
94. 6" VALVE WITH VALVE BOX PER JEFFERSON PARISH STANDARD DETAILS
95. 6" VALVE WITH VALVE BOX PER JEFFERSON PARISH STANDARD DETAILS
96. 6" VALVE WITH VALVE BOX PER JEFFERSON PARISH STANDARD DETAILS
97. 6" VALVE WITH VALVE BOX PER JEFFERSON PARISH STANDARD DETAILS
98. 6" VALVE WITH VALVE BOX PER JEFFERSON PARISH STANDARD DETAILS
99. 6" VALVE WITH VALVE BOX PER JEFFERSON PARISH STANDARD DETAILS
100. 6" VALVE WITH VALVE BOX PER JEFFERSON PARISH STANDARD DETAILS

DATE	DESCRIPTION
2/20/21	REVISED FOR 2" WATER LINE
5/12/21	WATER LINE IN
8/2/21	REVISED FOR 4" WATER LINE



**SITE PLAN**  
**GENERAL NOTES:**

- [illegible]

**SITE PLAN INFO:**

LOT NAME RESIDENTIAL EXTENSION LOT A-1  
PRIMARY ZONING R-1AC2  
TOTAL AREA 221,726 SQFT  
TOTAL VEHICULAR AREA 28,264 SQFT  
TOTAL LANDSCAPED AREA 115,763 SQFT  
REQUIRED PARKING SPACES NA  
PROVIDED PARKING SPACES 31

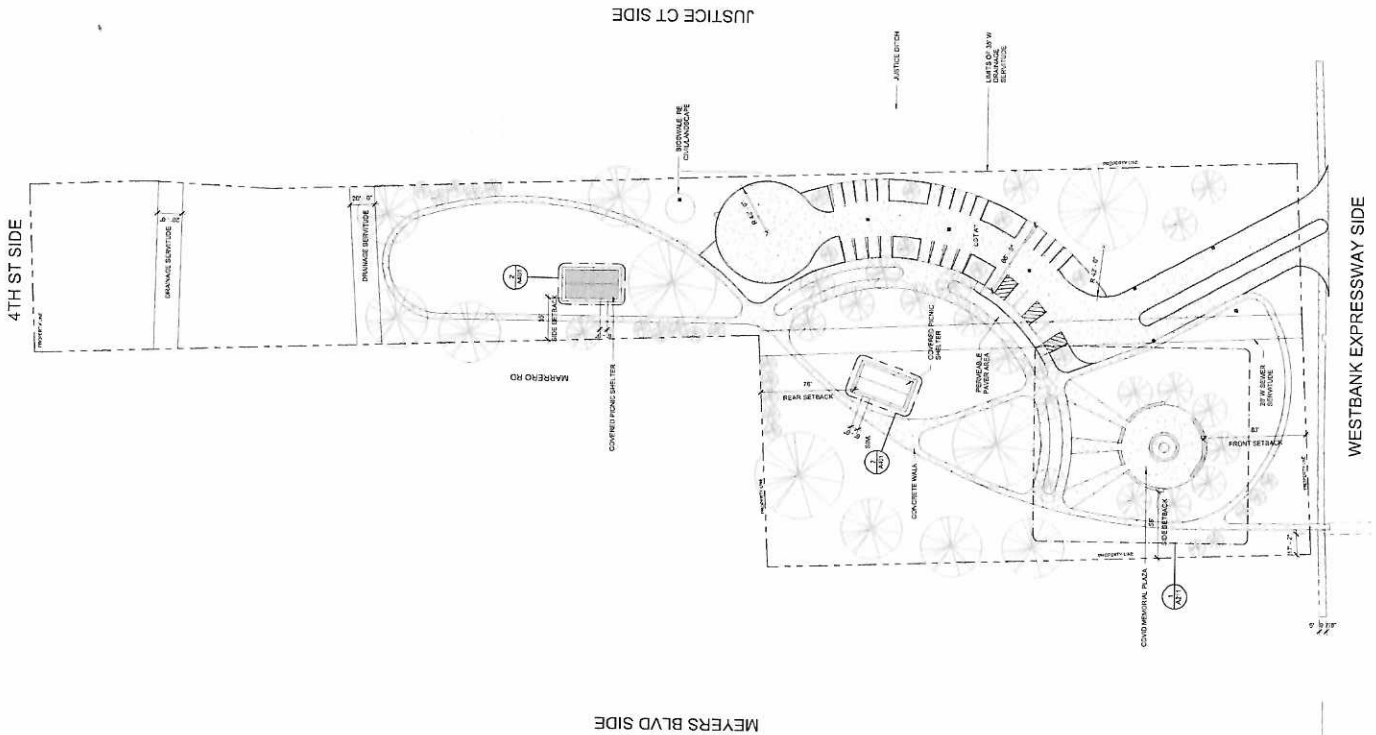

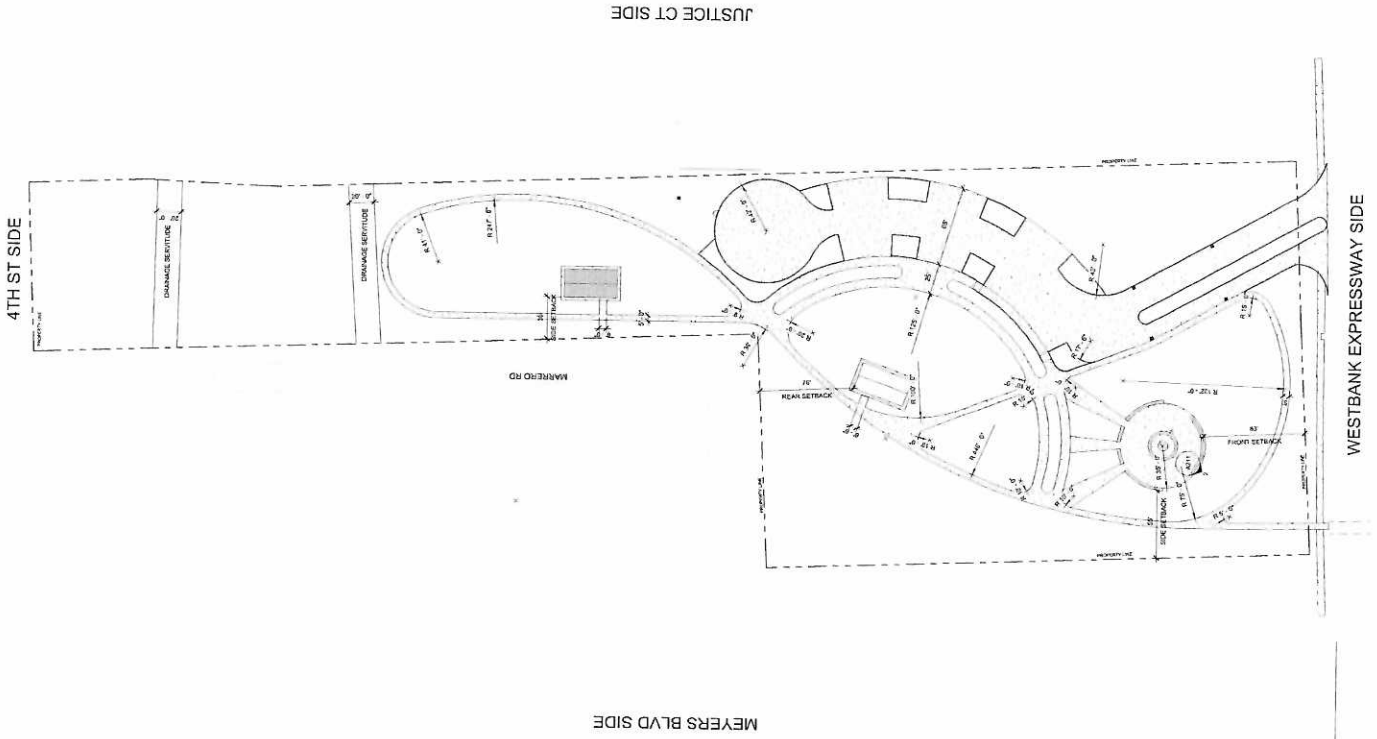

[illegible]

Date: June 9, 2023

Manning Architects

Attention: Ryan Bertucci

Project: COVID Memorial Park – COVID Memorial

Title: Prior Approvals

### **PRIOR APPROVALS**

The Following Manufacturers Are Approved, Provided the Products Meet the Project Construction Documents.

- Lighting fixture type "F1" 8-OEC-LED-6000L/8000L/10000L-DIM10-MVOLT-35K/40K/50K-85-OCGSS from Elite Lighting is approved.
- Lighting fixture type "L1" BLDB-TM1-120-3FT-CSL-N10-40K-CRI80-3-(FINISH)-DIM-BH-CSL-N10-40K-CRI80-3 from Lumenpulse Lighting INC. is approved.
- Lighting fixture type "L2" LBIL-WO-120/277-40K-(OPTIC)-CL-DIM-FLH-SSB-RBO-HRS-UL from Lumenpulse Lighting INC. is approved.
- Lighting fixture type "L3" BOCA-CA-50W4K-U-5-PC1-PT-N-(FINISH) from PEMCO Lighting is approved.
- Lighting fixture type "L3" CLX-LED-GRV-V-36LED-NW-120-PT-(FINISH)-CSA from US Arch & Sun Valley is approved.
- Lighting fixture type "S" VLL-PLED-III-80LED-700MA-40K-UNV-1-(FINISH)-RPA from US Arch & Sun Valley is approved.
- Lighting pole "S" RNTS-235-11-1-(FINISH) from US Arch & Sun Valley is approved.
- Lighting fixture type "W3" VLL-PLED-III-40LED-525MA-40K-UNV-1-(FINISH)-RPA from US Arch & Sun Valley is approved.
- Lighting pole "W3" RNTS-124-11-1-(FINISH) from US Arch & Sun Valley is approved.



Date: June 20, 2023

Manning Architects

Attention: Ryan Bertucci

Project: COVID Memorial Park – COVID Memorial

Title: Prior Approvals

### **PRIOR APPROVALS**

The Following Manufacturers Are Approved, Provided the Products Meet the Project Construction Documents.

- Lighting fixture type "F1" 8TSNX-66SL-LW-UNV-L835-CD1-UAYC-CHAIN/SET-U from Metalux is approved.
- Lighting fixture type "L1" BL8511-[LENS]-M010LDD-N-40K-[FINISH] from American Nailplate is approved.
- Lighting fixture type "L1-ALT" UPRA-10012-14W LED-T3-W40-[FINISH]-120/277V-DIM from Ligan Lighting USA is approved.
- Lighting fixture type "L2" 1185-[FINISH]-MF-40-C-MV-[LENS]-[DIMMING]-B34 from Vista Professional Lighting is approved.
- Lighting fixture type "L3" LA160-P046LD4D-[OPTICS]-40K-[MOUNTING]-[FINISH] from American Nailplate is approved.
- Lighting fixture type "L3" CLX-LED-GRV-V-36LED-NW-120-PT-(FINISH)-CSA from US Arch & Sun Valley is approved.
- Lighting fixture type "S" GALN-SA4C-740-U-[DIST]-[FINISH] from McGraw-Edison is approved.
- Lighting fixture type "W3" GALN-SA2A-740-U-[DIST]-[FINISH] from McGraw-Edison is approved.