

Jefferson Parish, Louisiana

Wastequip Bid Response



(Corporate Headquarters)

6525 Morrison Blvd., Suite 300

Charlotte, NC 28211

877.468.9278

www.wastequip.com

Project No. 5000114916

Bid Title: Front Load 8 Yard

Dumpster

Bid Due: November 6, 2015

Bid Opening Time: 11:00 am

ORIGINAL

Table of Contents

Introduction and Company Information

Corporate Profile	
Wastequip Fact Sheet	

Bid Forms

Bid Documents	
Wastequip Quote.....	

Wastequip Supporting Documents

Wastequip Front Load Container Brochure	
Wastequip Container Warranty	

Wastequip Additional Information

Points of Contact.....	
------------------------	--

WASTEQUIP®

Corporate Profile

Wastequip was founded in 1989 by Chuck Walton, with the mission of creating a national waste equipment manufacturing company. Walton acquired several privately owned companies to create a North American footprint of 40 locations by 2007. Over the next few years, many of the smaller, regional brands were consolidated under other Wastequip brands.



Since its formation, Wastequip has developed a reputation for superior quality waste handling and recycling equipment. With a strong history of manufacturing expertise and product innovation, Wastequip manufactures a full line of products, systems, and solutions for the collection and transportation of solid waste, recyclables, liquid waste, and organics. Based in Charlotte, N.C., Wastequip employs more than 1,500 associates with operations in the U.S., Canada, and Mexico.

Wastequip has locations throughout the U.S. and Canada, which allows us to serve our customer base on a local level while delivering economies of scale not possible with smaller manufacturers. This makes us uniquely able to manufacture product to local specifications while making our entire line of products readily available throughout North America. We have the product you need in stock, where you need it and available for fast delivery.

Our product line includes:

- **WASTEQUIP** brand compaction equipment to include stationary and self-contained compactors and vertical balers
- **WASTEQUIP** brand steel containers to include front load, rear load, side load and roll-off containers
- **ACCURATE** brand intermodal products
- **TOTER** brand plastic roll carts and containers
- **GALBREATH** brand hoists, container handlers and trailers
- **MOUNTAIN TARP** and **PIONEER** brand tarps and tarping systems
- **CUSCO** brand Industrial vacuum trucks and hydro excavators
- **GO TO PARTS** offers OEM and aftermarket parts

With extensive product knowledge and industry experience, the WASTEQUIP sales team focuses on developing relationships with customers to better understand their needs and requirements. WASTEQUIP has product specialists and a strong service group to support customers along with one of the best dealer networks in the industry for aftermarket installation and support.



Company Fact Sheet

- Since 1989, Wastequip® has cultivated a superior reputation for quality waste handling and recycling equipment. With a strong history of manufacturing expertise and product innovation, the company manufactures a full line of products, systems, and solutions for the collection and transportation of solid waste, recyclables, liquid waste, and organics.
- Based in Charlotte, N.C., Wastequip employs more than 1,600 associates across 33 locations, including operations in the U.S., Canada, and Mexico.
- The company is organized under five distinct operating divisions:

Mobile Division: Wastequip's Mobile Division's products are engineered to withstand the punishment of hauling waste, recyclables, and scrap. The division includes branded products such as Galbreath® hoists, container handlers, and trailers; Mountain Tarp™ and Pioneer™ tarping systems; and Cusco™ industrial vacuum trucks.

Plastics Division: The iconic Toter® brand is at the heart of Wastequip's Plastics Division. With a wide range of products including stationary waste containers, plastic dumpsters/containers, tilt trucks, and cart lifters, the brand is most known for "The World's Toughest Carts™" – two-wheeled carts used primarily for automated curbside waste, recycling, and organics collection.

Technical Division: Wastequip's Technical Division manufactures Wastequip-branded compactors and industrial balers. These powerful products withstand the demands of both commercial and industrial use.

Containers Division: Wastequip's Containers Division manufactures a wide range of front-load, roll-off, and rear-load containers, as well as self-dumping hoppers for all types of waste and recycling. The division also makes specialty containers for handling sludge, grease, and other tough waste, along with dewatering, vacuum, and intermodal containers.

Parts Division: Wastequip's Parts Division stocks genuine Galbreath, Pioneer, Mountain Tarp, Wastequip, Cusco, Accurate, and Toter parts for hoists, compactors, tarping systems, containers, and more. The division offers the most comprehensive selection of aftermarket parts – with the convenience of online shopping, same-day shipping, and competitive pricing.

- In June 2012, Wastequip, LLC, was recapitalized with its majority interests purchased by Centerbridge Partners, L.P. Since this company-wide transition – which included naming of a new CEO, Martin "Marty" Bryant – Wastequip has thrived within its industry and among its competitors.

Leadership Team

Martin (Marty) Bryant
Chief Executive Officer

Vance Tabb
President, Containers Division

Mark Taylor
President, Technical Products Division

John Defenbaugh
President, Mobile Division

Robert Munroe
President, Parts Division

Corporate Headquarters

6525 Morrison Boulevard, Suite 300
Charlotte, NC 28211
877.468.9278

sales@wastequip.com
www.wastequip.com





CENTRALBIDDING
FROM CENTRAL AUCTION HOUSE

5000114916 FRONT LOAD 8 YARD DUMPSTER ONE TIME PURCHASE
Jefferson Parish Government

Project documents obtained from www.CentralBidding.com

04-Nov-2015 08:39:18 AM

DATE: 10/30/2015

INVITATION TO BID
THIS IS NOT AN ORDER

Page: 1

BID NO.: 50-00114916

JEFFERSON PARISH

PURCHASING DEPARTMENT
P.O. BOX 9
GRETN, LA. 70054-0009
504-364-2678

VENDOR: 27118 BLANK BID COPY VENDOR

BUYER: CGasper

Bids will be received until 11:00 AM, 11/06/2015 via fax: 504-364-2693 or via online at www.jeffparish.net

All bids submitted are subject to these instructions and general conditions and any special conditions and specifications contained herein, all of which are made part of this bid proposal reference. By submitting a bid, vendor agrees to comply with all provisions of Louisiana Law, as well be in compliance with the Jefferson Parish Code of Ordinances, Louisiana Code of Ethics, applicable Jefferson Parish ethical standards and Jefferson Parish Resolution No. 113646 and/or Resolution No. 113647. A copy of these resolutions may be obtained from the Office of the Parish Clerk, Suite 6700, Jefferson Parish General Government Building, 200 Derbigny Street, Gretna, LA 70053. You may also obtain a copy by visiting the Purchasing Department webpage at www.purchasing.jeffparish.net and clicking on On-line forms.

All vendors submitting bids must register as a Jefferson Parish vendor if not already yet registered. Bidders may be required to furnish current W-9 Forms and respective Tax Identification Numbers within 10 days after bid opening if such information is not on file or not up to date. Registration forms may be downloaded from www.purchasing.jeffparish.net and clicking on Vendor Information.

As per LSA-RS 47:301 et seq., all governmental bodies are excluded from payment of sales taxes to any Louisiana taxing body. Quotations shall be based on F.O.B. Delivered, anywhere within the Parish as designated by the Purchasing Department. JEFFERSON PARISH WILL ACCEPT ONE BID ONLY FROM EACH VENDOR. Items bid must meet specifications. JEFFERSON PARISH will accept one price for each item unless otherwise indicated. Two or more prices for one item will result in bid rejection. Bidders are required to complete, sign and return the bid form and/or complete and return the associated line item pricing forms as indicated. The price quoted for work shall be stated in figures. In the event there is a difference in unit prices and totals, the unit prices shall prevail.

JEFFERSON PARISH reserves the right to award contracts or place orders on a lump sum or individual item basis, or such combination, as shall in its judgment be in the best interest of JEFFERSON PARISH. Every contract or order shall be awarded to the LOWEST RESPONSIVE and RESPONSIBLE BIDDER, taking into consideration the CONFORMITY WITH THE SPECIFICATIONS and the DELIVERY AND/OR COMPLETION DATE

JEFFERSON PARISH reserves the right to cancel all or any part of an order if not shipped promptly. No charges will be allowed for parking or cartage unless specified in the quotation. The order must not be filled at a higher price than quoted. JEFFERSON PARISH reserves the right to cancel at any time and for any reason by issuing a THIRTY (30) day written notice to the contractor.

JEFFERSON PARISH requires all products to be new (current) and all work must be performed according to standard practices for the project. Unless otherwise specified, no aftermarket parts will be accepted. Unless otherwise specified, all workmanship and materials must have at least one (1) year guaranty, in writing, from the date of delivery and/or acceptance of the project. Any deviations or alterations from the specifications must be indicated and/or supporting documentation supplied with bid submission.

If this bid requires a pre-bid conference (see Additional Requirements section), bidders are advised that such conference will be held to allow bidders the opportunity to identify any discrepancies in the bid specifications and seek further clarification regarding instructions. The Purchasing Department will issue a written response to bidders' questions in the form of an Addendum.

All formal Addenda require written acknowledgment on the bid form by the bidder. Failure to acknowledge an Addendum on the bid form shall cause the bid to be rejected; JEFFERSON PARISH reserves the right to award bid to next lowest responsive and responsible bidder in this event.

USE OF BRAND NAMES AND STOCK NUMBERS: Where brand names and stock numbers are specified, it is for the purpose of establishing certain minimum standards of quality. Bids may be submitted for products of equal quality, provided brand names and stock numbers are specified. Complete product data may be required prior to award.

Quantities listed are for bidding purposes only. Actual requirements may be more or less than quantities listed.

Bidders are not to exclude from participation in, deny the benefits of, or subject to discrimination under any program or activity, any person in the United States on the grounds of race, color, national origin, or sex; nor discriminate on the basis of age under the Age Discrimination Act of 1975, or with respect to an otherwise qualified handicapped individual as provided in Section 504 of the Rehabilitation Act of 1973, or on the basis of religion, except that any exemption from such prohibition against discrimination on the basis of religion as provided in the Civil Rights Act of 1964, or Title VI and VII of the Act of April 11, 1968, shall also apply. This assurance includes compliance with the administrative requirements of the Revenue Sharing final handicapped discrimination provisions contained in Section 51.55 (c), (d), (e), and (k)(5) of the Regulations. New construction or renovation projects must comply with Section 504 of the 1973 Rehabilitation Act, as amended, in accordance with the American National Standard Institute's specifications (ANSI A117.1-1961).

INSTRUCTIONS FOR BIDDERS AND GENERAL CONDITIONS

IN ACCORDANCE WITH STATE REGULATIONS JEFFERSON PARISH OFFERS ELECTRONIC PROCUREMENT TO ALL VENDORS

This Electronic Procurement System allows vendors the convenience of reviewing and submitting bids online. This is a secure site and authorized personnel have limited read access only.

Please visit the Purchasing Department webpage at <http://purchasing.jeffparish.net> to register and review Jefferson Parish solicitations.

ADDITIONAL REQUIREMENTS FOR THIS BID

PLEASE MATCH THE NUMBERS PRINTED IN THIS BOX WITH THE CORRESPONDING INSTRUCTIONS BELOW.

13

1. All bidders must attend the pre-bid conference in relation to this bid; attendance is mandatory. Failure to attend will prohibit a company from submitting a bid. Vendors are hereby noticed that any vendor arriving after the mandatory pre-bid conference begins will not be allowed to sign in as evidence of attendance.
2. Attendance to this pre-bid conference is optional. However, failure to attend the pre-bid conference shall not relieve the bidder of responsibility for information discussed at the conference. Furthermore, failure to attend the pre-bid conference and inspection does not relieve the successful bidder from the necessity of furnishing materials or performing any work that may be required to complete the work in accordance with the specification with no additional cost to the owner.
3. Contractor must hold current applicable JEFFERSON PARISH licenses with the Department of Inspection and Code Enforcement. Contractor shall obtain any and all permits required by the JEFFERSON PARISH Department of Inspection and Code Enforcement. The contractor shall be responsible for the payment of these permits. All permits must be obtained prior to the start of the project. Contractor must also hold any and all applicable Federal and State licenses. Contractor shall be responsible for the payment of these permits and shall obtain them prior to the start of the project.
4. A LA State Contractor's License will be required in accordance with LSA R.S. 37-2150 et. seq. and such license number will be shown on the outside of the bid envelope. Failure to comply will cause the bid to be rejected. Additionally if submitting the bid electronically, then the license number must be entered in the appropriate field in the Electronic Procurement system. Failure to comply will cause the bid to be rejected.
5. It is the bidder's responsibility to visit the job site and evaluate the job before submitting a bid.
6. Job site must be clean and free of all litter and debris daily and upon completion of the contract. Passageways must be kept clean and free of material, equipment, and debris at all times. Flammable material must be removed from the job site daily because storage will not be permitted on the premises. Precautions must be exercised at all times to safeguard the welfare of JEFFERSON PARISH and the general public.

INSTRUCTIONS FOR BIDDERS AND GENERAL CONDITIONS

7. **PUBLIC WORKS BIDS:** All awards for public works in excess of \$5,000.00 will be reduced to a formal contract which shall be recorded at the contractor's expense with the Clerk of Court and Ex-Officio Recorder of Mortgages for the Parish of Jefferson. A price list of recordation costs may be obtained from the Clerk of Court and Ex-Officio Recorder of Mortgages for the Parish of Jefferson. All awards in excess of \$25,000.00 will require both a performance and a payment bond. Unless otherwise stated in the bid specifications, the performance bond requirements shall be 100% of the contract price. Unless otherwise state in the bid specifications, the payment bond requirements shall be 100% of the contract price. Both bonds shall be supplied at the signing of the contract.
8. **NON-PUBLIC WORKS BIDS:** A performance bond will be required for this bid. The amount of the bond will be 100% of the contract price unless otherwise indicated in the specifications. The performance bond shall be supplied at the signing of the contract.
9. **NON-PUBLIC WORKS BIDS:** A payment bond will be required for this bid. The amount of the bond will be 100% of the contract price unless otherwise indicated in the specifications. The payment bond shall be supplied at the signing of the contract.
10. Unless otherwise stated in the bid specifications, the successful bidder will be required to procure standard insurance policies evidencing Parish-mandated insurance requirements as indicted on the attached sheet. The current certificate of insurance must be submitted by low bidder within 10 days after bid opening to the Purchasing Department. Failure to comply will cause bid to be rejected. JEFFERSON PARISH reserves the right to award bid to the next lowest responsive and responsible bidder in this event.
11. A bid bond will be required with bid submission in the amount of 5% of the total bid, unless otherwise stated in the bid specifications. Acceptable forms shall be limited to cashier's check, certified check, or surety bid bond. All sureties must be in original format (no copies). If submitting a bid online, vendors must submit an electronic bid bond through the respective online clearinghouse bond management system(s) as indicated in the electronic bid solicitation on Central Auction House. No scanned paper copies of any bid bond will be accepted as part of the electronic bid submission.
12. This is a requirements contract to be provided on an as needed basis. JEFFERSON PARISH makes no representations on warranties with regard to minimum guaranteed quantities unless otherwise stated in the bid specifications.
13. Freight charges should be included in total cost when quoting. If not quoted FOB DELIVERED, freight must be quoted as a separate item. Bid may be rejected if not quoted FOB DELIVERED or if freight charges are not indicated on bid form.
14. **PUBLIC WORKS BIDS - Completed, Signed and Properly Notarized Affidavits (in Original Format) required; Non-Conviction Affidavit, Non-Collusion Affidavit, Campaign Contribution Affidavit and E-Verify Affidavit must be completed, signed, notarized and submitted by low bidder within 10 days after bid opening to the Purchasing Department on all solicitations for construction, alteration or demolition of public building or project, including but not limited to requirements found in LSA-RS 38:2212.9; LSA-RS 38:2212.10; LSA-RS 38:2224; Code of Ordinances, Jefferson Parish, Louisiana, Sec 2-923.1. Failure to comply will cause bid to be rejected; the Parish reserves the right to award bid to the next lowest responsive and responsible bidder in this event. For the convenience of vendors, all affidavits have been combined into one form entitled PUBLIC WORKS BID AFFIDAVIT. This affidavit must be submitted in its original format for the bid to be considered responsive.**
15. **NON PUBLIC WORK BIDS - Completed, Signed and Properly Notarized Affidavits (in Original Format) required; Non-Collusion Affidavit, and Campaign Contribution Affidavit must be completed, signed, notarized and submitted by low bidder with bid submission or within 10 days after bid opening to the Purchasing Department. See LSA-RS 38:2212.10; LSA-RS 38:2224; Code of Ordinances, Jefferson Parish, Louisiana, Sec 2-923.1 Failure to comply will cause bid to be rejected; the Parish reserves the right to award bid to the next lowest responsive and responsible bidder in this event. For the convenience of vendors, all affidavits have been combined into one form entitled NON PUBLIC WORKS BID AFFIDAVIT. This affidavit must be submitted in its original format for the bid to be considered responsive.**
16. Since a bid surety is required, bid response may not be faxed. Bid submission will only be accepted online or as delivered to the Purchasing Department, 200 Derbigny Street, Suite 4400, Gretna, LA 70053 by 11am on the bid due date. All sureties must be in original format (no copies).

It shall be the duty of every parish officer, employee, department, agency, special district, board, and commission: and the duty of every contractor, subcontractor, and licensee of the parish, and the duty of every applicant for certification of eligibility for a parish contract or program, to cooperate with the Inspector General in any investigation, audit, inspection, performance review, or hearing pursuant to Jefferson Parish Code of Ordinances Section 2-155.10(19). By submitting a bid, vendor acknowledges this and will abide by all provisions of the referenced Jefferson Parish Code of Ordinances.

DATE: 10/30/2015
BID NO.: 50-00114916

INVITATION TO BID
THIS IS NOT AN ORDER

Page: 4

JEFFERSON PARISH

PURCHASING DEPARTMENT
P.O. BOX 9
GRETNA, LA. 70054-0009
504-364-2678

VENDOR: 27118 BLANK BID COPY VENDOR

BUYER: CGasper

As per LSA-RS 47:301 et seq., all governmental bodies are excluded from payment of sales taxes to any Louisiana taxing body. Quotations shall be based on F.O.B. Agency warehouse or jobsite, anywhere within the Parish as designated by the Purchasing Department.

JEFFERSON PARISH reserves the right to cancel all or any part of an order if not shipped promptly. No charges will be allowed for parking or cartage unless specified in quotation. The order must not be filled at a higher price than quoted. JEFFERSON PARISH reserves the right to cancel at any time and for any reason by issuing a THIRTY (30) day written notice to the contractor.

JEFFERSON PARISH is expecting all products to be new and all work is to be done in a workman-like manner, according to standard practices. Any deviations or alterations from the specifications must be indicated and backup documentation supplied with your quotation.

DELIVERY: FOB JEFFERSON PARISH

INDICATE DELIVERY DATE ON EQUIPMENT AND SUPPLIES

30 Days ARO

INDICATE STARTING TIME (IN DAYS) FOR CONSTRUCTION WORK

INDICATE COMPLETION TIME (IN DAYS) FOR CONSTRUCTION WORK

In the event that addenda are issued with this bid, bidders MUST acknowledge all addenda on the bid form. Bidder must acknowledge receipt of an addendum on the bid form as indicated. Failure to acknowledge any addendum on the bid form will result in bid rejection.

Acknowledge Receipt of Addenda: NUMBER: 1 Dated 11-5-15
NUMBER: _____
NUMBER: _____
NUMBER: _____

LOUISIANA CONTRACTOR'S LICENSE NO.: (if applicable) N/A

*** ALL BIDDERS MUST COMPLETE SECTION BELOW ***	
FIRM NAME: <u>Wastequip Mfg. Co., LLC</u>	
SIGNATURE: (Must be signed here)	TITLE: <u>CFO</u>
PRINT OR TYPE NAME: <u>Stephen Svetik</u>	
ADDRESS: <u>(Bid Location) 841 Meacham Road</u>	
CITY, STATE: <u>Statesville, NC</u>	ZIP: <u>28677</u>
TELEPHONE: <u>(800) 424-0422 Ext 244</u>	FAX: <u>(704) 878-0734</u>
EMAIL ADDRESS: <u>mjenkins@wastequip.com</u>	

TOTAL PRICE OF ALL BID ITEMS: \$ \$2,925.00

INVITATION TO BID FROM JEFFERSON PARISH - continued

BID NO.: 50-00114916

SEALED BID

ITEM NUMBER	QUANTITY	U/M	DESCRIPTION OF ARTICLES	UNIT PRICE QUOTED	TOTALS
1	3.00	EA	<p>8 yard front load dumpster - one time purchase.</p> <p>0010 8 yard front load dumpsters. One time purchase. Price includes shipping and delivery.</p> <p>Usage: Replace bad dumpsters in back</p>	<p>\$975.00</p> <p>Wastequip 8 Cubic Yard SLANT Style Front Load Container - Item # 125535 Customer to offload at time of delivery</p>	<p>\$2,925.00</p>

FRONT END LOAD CONTAINERS



 **WASTEQUIP**

Toter®

Galbreath®

 **Accurate**

 **MOUNTAIN TARP
PIONEER**

CUSCO

**PARTS
PLACE**

Steel Front End Load (FEL) Containers

Wastequip Front End Load Containers (FELs) are engineered using heavy gauge steel to withstand the stress of continued use. Standard models feature 12 gauge sides and 10 gauge bottoms, high density polyethylene lids and fully welded in-seams. Our heavy duty models have 10 gauge sides and 7 gauge bottoms for added strength and durability. Containers are primed inside and outside to reduce corrosion. Wastequip containers meet ANSI safety specifications and dimensional standards for haulers. With locations throughout North America, Wastequip can meet your container needs quickly.



Styles: Flat, slant, hatchback and nestable (slant and flat)
Sizes: 2, 3, 4, 6, 8, and 10 cubic yards

Wastequip's standard steel FEL models feature 12 gauge sides and 10 gauge bottoms, high density polyethylene lids and fully welded in-seams.

FEATURES

1) FORK POCKETS:

- 3-way flared fork pockets protect from damage by the trucks forks and easily guides forks into the pockets
- Taco gussets welded to the bottom of the fork pockets help extend pocket life by providing added strength to the bottom of the pockets
- Fully welded pockets at critical stress points reduce fork damage and ensure long service life

2) CONSTRUCTION:

- Rounded bumper pads help prevent damage to the front of the container
- Floor channels are capped at both ends to prevent debris from getting inside and extend up the front and back walls to create extra support

2) CONSTRUCTION (CONT'D):

- Fully welded no-step gusset across the top of the fork pocket provides added safety and support
- Top edges are rounded and smooth for added safety during customer loading
- Interlocking top channel frame provides added strength
- Primed inside and outside to reduce corrosion
- Painted in one of several standard colors
- Nestable 2, 3 & 4 yard containers reduce shipping costs and required storage space

3) LIDS:

- Single wall, double lip lids ensure durability
- Optional lids upon request



FRONT END LOAD CONTAINERS // SLANT TOP

2 YARD SLANT NESTABLE

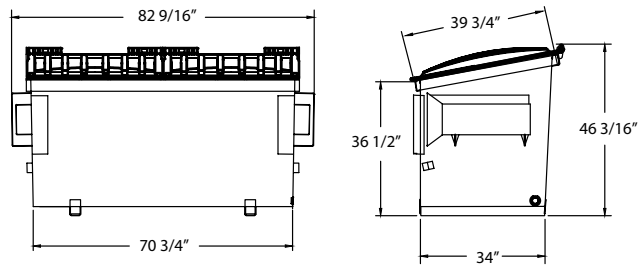

6 YARD SLANT

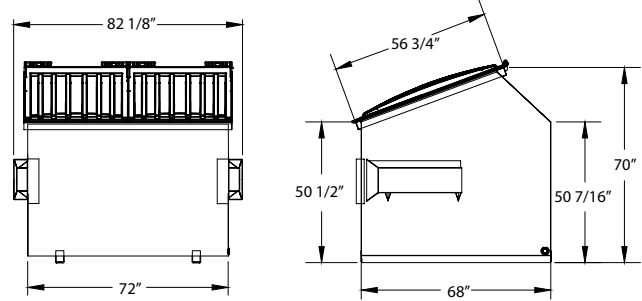

3 YARD SLANT NESTABLE

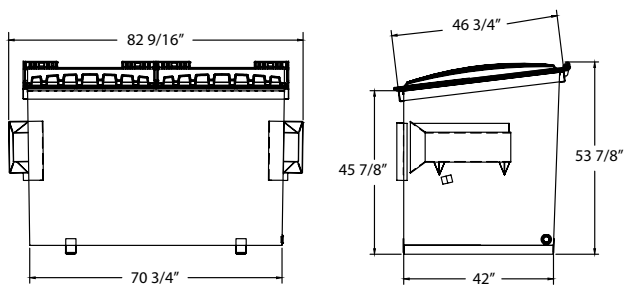

8 YARD SLANT

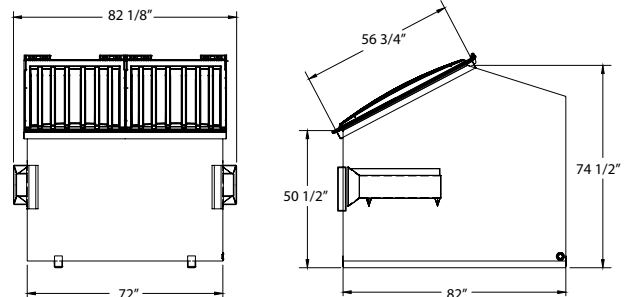

4 YARD SLANT NESTABLE

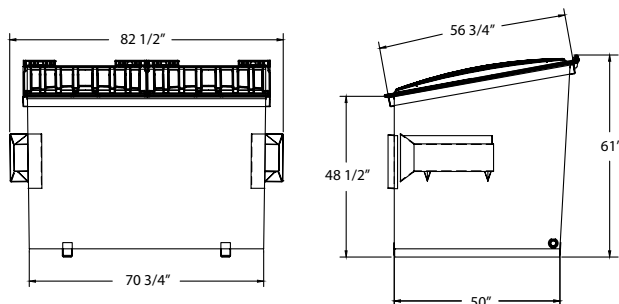

	2 YARD*	3 YARD*	4 YARD*	6 YARD	8 YARD
48 ft. trailer flat / drop	42 / 52	24 / 33	20 / 28	8 / 14	7 / 7
53 ft. trailer flat / drop	48 / 60	26 / 36	22 / 31	9 / 16	8 / 8
Plastic lid standard	37" x 41" single wall	37" x 48" single wall	37" x 58" single wall	37" x 58" single wall	37" x 58" single wall
Sides	12 gauge	12 gauge	12 gauge	12 gauge	12 gauge
Bottom	10 gauge	10 gauge	10 gauge	10 gauge	10 gauge
Weight	504 lbs.	608 lbs.	709 lbs.	971 lbs.	1,103 lbs.

* Nestable



877-468-9278 | wastequip.com



CONTAINER LIMITED WARRANTY

WASTEQUIP warrants all other products of its manufacture against operational failure caused by defective material or workmanship, **which occurs during normal use within twelve (12) months from date of shipment from our factory.**

WASTEQUIP will replace all parts of our manufacture free of charge that our inspection at our factory shows to us to be defective in accordance with the above paragraph. **Written permission must be obtained from authorized Wastequip personnel for any repairs performed other than in our factory.** All claims for reimbursement must be filed with proper documentation no later than forty-five (45) days after occurrence to be allowed.

All products purchased by WASTEQUIP from an outside vendor shall be covered by the warranty of that respective vendor only, and WASTEQUIP does not participate in or obligate itself to any such warranty.

No freight, travel cost, meals, lodging, or loss of hydraulic oil shall be covered by this warranty, all labor costs allowed shall be in accordance with WASTEQUIP'S established rate; in case of alleged defect, product shall be returned to WASTEQUIP with transportation charges prepaid. No freight collect shipment will be accepted.

WASTEQUIP makes no warranty on any of its equipment used in any way except as it was designed, intended, and sold to perform.

DISCLAIMER OF WARRANTIES: THE LIMITED AND CONDITIONAL WARRANTY AND REMEDIES SET FORTH ABOVE ARE EXCLUSIVE AND IN LIEU OF ANY AND ALL REPRESENTATIONS, SPECIFICATIONS, WARRANTIES AND REMEDIES, EITHER EXPRESS OR IMPLIED, HEREIN OR ELSEWHERE, OR WHICH MIGHT ARISE UNDER LAW OR EQUITY, OR PURSUANT TO ANY COURSE OF DEALING OR CUSTOM OR USAGE OF TRADE, INCLUDING WITHOUT LIMITATION, ANY WARRANTIES OF MERCHANTABILITY AND OF FITNESS FOR ANY SPECIFIED OR INTENDED PURPOSE.

LIMITATION OF REMEDIES AND LIABILITY: PURCHASER'S SOLE AND EXCLUSIVE REMEDY AGAINST WASTEQUIP SHALL BE THE REMEDY OF DEFECTS IN PRODUCTS DELIVERED HEREUNDER AS PROVIDED BY, AND WITHIN THE TIME PERIOD SPECIFIED IN, WASTEQUIP'S LIMITED WARRANTY SET FORTH ABOVE. WASTEQUIP'S LIMITED WARRANTY CONSTITUTES THE SOLE REMEDY WITH RESPECT TO OR ARISING OUT OF THE EQUIPMENT, PRODUCTS OR SERVICES OF WASTEQUIP. NOTWITHSTANDING ANY OTHER PROVISIONS HEREOF, IN NO EVENT SHALL WASTEQUIP BE LIABLE IN CONTRACT, TORT OR EQUITY FOR ANY LOSS OF ANTICIPATED PROFITS, LOST SALES, INJURY TO PERSONS OR PROPERTY, LOSS BY REASON OF PLANT SHUTDOWN, NON-OPERATION OR INCREASED EXPENSE OF OPERATION, SERVICE INTERRUPTIONS, CLAIMS OF CUSTOMERS, COST OF MONEY, LOSS OF USE OF CAPITAL OR REVENUE, OR FOR ANY SPECIAL, INCIDENTAL OR CONSEQUENTIAL LOSSES OR DAMAGES OF ANY KIND WHATSOEVER.

All claims shall be processed through the WASTEQUIP Service Department or your authorized WASTEQUIP dealer.



Points of Contact for the State of Louisiana

Bid Information: Marya M. Jenkins, Bid/Contract Specialist
841 Meacham Road
Statesville, NC 28677
Direct: 800-424-0422 Ext 244
Fax: 704-878-0734
Email: MJenkins@wastequip.com

Account Rep: Steve Hurtt, Regional Sales Manager
Direct: 469-853-7729
Email: SHurtt@wastequip.com

P.O. Remit: Wastequip
1261 East Park Lane NW
Brookhaven, MS 39601
Direct: 800-242-0122
Fax: 361-358-0418

Invoice Remit: Wastequip, LLC
PO Box 603008
Charlotte, NC 28260-3008
Direct: 704-366-7140