

STATEMENT OF QUALIFICATIONS  
SURVEYING SERVICES ON AN  
AS-NEEDED BASIS



**ALL SOUTH CONSULTING ENGINEERS, LLC**  
652 PAPWORTH AVENUE  
METAIRIE, LOUISIANA 70005  
(504) 322-2783

## TEC Professional Services Questionnaire

### A. Project Name and Advertisement Resolution Number:

SOQ To Provide Professional Surveying Services - Resolution 137285

### B. Firm Name & Address where Project work will be performed:



652 Papworth Avenue,  
Metairie, Louisiana 70005

### C. Name, title and contact information of Principal, as defined in Section 2-926 of the Jefferson Parish Code of Ordinances, who is a registered, licensed architect, professional engineer, or surveyor in the State of Louisiana:

Timothy P. Bonura, P.E.  
Managing Partner  
504-322-2783  
[tim@ascellc.com](mailto:tim@ascellc.com)

### D. Name and contact information of employee who is a registered and licensed architect, professional engineer, or surveyor in the State of Louisiana in the applicable discipline. A subcontractor may be substituted here only if the advertised Project requires more than one discipline.

John Teegarden, P.L.S.  
Vice President, Survey Division Manager  
504-322-2783  
[jteegarden@ascellc.com](mailto:jteegarden@ascellc.com)

### E. Please provide the number of employees whose primary function corresponds with each category:

<u>5</u>	Administrative	<u>0</u>	Estimators	<u>1</u>	Specification Writers
<u>0</u>	Architects (Licensed)	<u>0</u>	Geologists	<u>3</u>	Structural Engineers
<u>0</u>	Chemical Engineers	<u>0</u>	Geotechnical Engineers	<u>1</u>	Graduate Engineers
<u>9</u>	Civil Engineers	<u>0</u>	Interior Designers	<u>3</u>	Project Managers
<u>9</u>	Construction Inspectors	<u>0</u>	Landscape Architects	<u>2</u>	Clerical
<u>0</u>	Ecologists	<u>0</u>	Land Surveyor	<u>6</u>	Grant/Funding Specialist
<u>0</u>	Electrical Engineers	<u>0</u>	Mechanical Engineers	<u>0</u>	Sanitary Engineers
<u>3</u>	Engineer Intern	<u>0</u>	Environmental Engineers		
<u>1</u>	Professional Land Surveyor			<u>53</u>	<b>TOTAL</b>

### F. Is this submittal by a JOINT-VENTURE? Please check: YES \_\_\_\_\_ NO ☒

If marked "No" skip to Section I. If marked "yes" complete Sections G-H.

## TEC Professional Services Questionnaire

**G. If submittal is by JOINT-VENTURE, list the firms participating and outline specific areas of responsibility (including administrative, technical, and financial) for each firm. Please attach additional pages if necessary.**

1. NA

2.

**H. Has this JOINT-VENTURE previously worked together? Please check:**  
 YES \_\_\_\_\_ NO \_\_\_\_\_

**I. List all subcontractors anticipated for this Project. Please note that all subcontractors must submit a fully completed copy of this questionnaire, applicable licenses, and any other information required by the advertisement. See Jefferson Parish Code of Ordinances, Sec. 2-928(a)(3). Please attach additional pages if necessary.**

Name & Address:	Specialty:	Worked with Firm Before (Yes or No):
1.		
2.		
3.		

**J. Please specify the total number of support personnel that may assist in the completion of this Project:**

6 \_\_\_\_\_

## **TEC Professional Services Questionnaire**

**K. List the professional in charge, key persons, specialists, and individual consultants anticipated for this Project and provide their relevant information below. If necessary, please attach additional documentation (i.e. resume) that demonstrates the employment history and experience of the Firm's key persons that may assist in the completion of this Project. Please attach additional pages if necessary.**

### **PROFESSIONAL IN CHARGE OF PROJECT:**

**Name & Title:**

**John Teegarden, PLS**  
Vice President, Survey Division Manager

**Project Assignment:**

Senior Professional Land Surveyor, Survey Project Manager

**Name of Firm with which associated:**

All South Consulting Engineers, LLC

**Years' experience with this Firm:**

6

**Education: Degree(s)/Year/Specialization:**

International Correspondence School, Surveying and Mapping Course (2-year course completed)

**Active registration: Year first registered/discipline:**

1990/ Professional Land Surveyor/ Louisiana License No. 4635  
1999/ Professional Land Surveyor/ Mississippi License No. 2782

**Other experience and qualifications relevant to the proposed Project:**

John S. Teegarden, PLS joined All South Consulting Engineers, LLC in 2014 as Vice President and Survey Division Manager. Mr. Teegarden has extensive experience in all aspects of land surveying including boundary, elevation, topographic, hydrographic, industrial, and construction projects.

Over his 38-year career, he has participated in or directed surveys for a wide variety of clientele including local municipal and governmental agencies, state agencies, and federal agencies (including the U.S. Army Corps of Engineers). In his career, he has served as a Field Party Chief, Field Supervisor, CAD Technician, Project Manager, and Division Manager.

Mr. Teegarden's varied project experience includes high precision survey control, single and multibeam hydrographic surveys, large boundary surveys, surveys for public right-of-way taking, topographic route surveys, mapping of subsurface utilities based on the markings provided by a subsurface utility engineering firm, coastal restoration projects, laser scanning surveys and GPS project surveys, to name just a few. This experience includes over 20 years' experience in directing and performing hydrographic surveys. He has executed and/or supervised hydrographic surveying projects throughout Coastal Louisiana, including Breton Sound, the Barataria Basin, and the lower Mississippi River area including Southeast Pass, Tiger Pass, and Baptiste Collette.

**Silt and Debris Measurement in Jefferson Parish Canals** *Jefferson Parish, Louisiana*

Mr. Teegarden is providing topographic and bathymetric survey services for the Jefferson Parish Drainage Department. We are surveying canals to determine the amount of silt build up utilizing All South's Z-Boat, a six-foot-long remotely controlled vessel equipped with GPS, a dual-frequency echosounder and a laptop to record the data.

## **TEC Professional Services Questionnaire**

### **Geisenheimer Canal Topographic Survey** *Jefferson Parish, Louisiana*

Mr. Teegarden led our survey teams in the preparation of a topographic survey that included the location of the Geisenheimer Canal Box Canal and the adjoining surface features from the north curb line of Airline Highway into the fairway of Metairie Country Club adjacent to Airline Highway.

### **Woodvine Ditch Topographic Survey** *Jefferson Parish, Louisiana*

Mr. Teegarden is providing a topographic survey over the existing 54" RCP drain line followed the line from Nassau Drive south across the Metairie Country Club Golf course to its tie in point at Geisenheimer Canal. Improvements along that route were located along with trees, with size and species and topographic features on the golf course, that included ties, sand traps and the raised greens that fell in the route.

### **Loumor Outfall Ditch Topographic Survey** *Jefferson Parish, Louisiana*

Mr. Teegarden and the All South survey staff provided a topographic survey of the route that follows the 78" X 122" RCAP along the western edge of Metairie Country Club Golf course, then southeasterly and finally south to Geisenheimer Canal just north of Airline Highway. Improvements along that route were located along with trees, with size and species and topographic features on the golf course, that included ties, sand traps and the raised greens that fell in the route.

### **Tudor and Tallulah Drainage Analysis** *River Ridge, Jefferson Parish, Louisiana*

Mr. Teegarden provided topographic survey services and collected field data for the Tudor and Tallulah drainage project. This work included picking up horizontal and vertical data in the drainage area, including locating the multiple subsurface utilities that could affect the project. Cost \$60,000

### **Canal No. 10 Underground Utility Locations** *Jefferson Parish, Louisiana*

Mr. Teegarden provided topographic survey services for the West Esplanade at Canal 10 Drainage Improvements project. His responsibilities included a topographic survey of canal crossing, location of underground utilities located by subsurface utility engineering contractor and added to an existing topographic survey.

### **Lake Cataouatche Pump Station Topographic Survey** *Jefferson Parish, Louisiana*

Mr. Teegarden and his team prepared a topographic survey at the site of the current Lake Cataouatche pump station located on Churchill Farms. The survey area adjacent to the existing pump station will be the site for a new pump station under design. The survey included cross sections of the site and the adjacent canal along with the location of improvements in the project area.

### **Upper LA 45 Basin Tidal Surge Protection** *Lafitte, Louisiana*

Mr. Teegarden and his team conducted topographic, magnetometer and bathymetric surveys for the design of a tidal surge protection system for the Upper LA 45 basin in the Lafitte Levee District. The team surveyed three routes, one along Bayou Barataria for the design of a floodwall and two possible routes for a rear protection levee through swamp and marsh areas. RTK GPS, Robotic Total stations, remotely operated Z-Boat and a Marine Magnetics Sea-Spy magnetometer were used for this project. The survey deliverables included plan and profile sheets and plotted cross sections.

### **Rosethorne Path – LA 45** *Lafitte, Louisiana*

Mr. Teegarden and his team conducted a topographic survey along the route of a proposed walk and bike path along LA Hwy 45 in the Lafitte area. RTK GPS and robotic total stations were used to located improvements, utilities and take cross sections along the survey route.

### **40 Arpent Canal Levee Walk and Cycling Path and Pedestrian Bridge** *St. Bernard Parish, Louisiana*

Mr. Teegarden and his team conducted a topographic survey along the 40 Arpent Levee in St. Bernard parish for the design of a walk and bike path. RTK GPS was used to locate improvement and take cross sections along the proposed survey route. The area surveyed began at the St. Bernard/Orleans parish line and continued southeasterly to Paris Road.



## **TEC Professional Services Questionnaire**

<b>KEY PERSON, SPECIALIST, OR INDIVIDUAL CONSULTANT:</b>
<b>Name &amp; Title:</b>
Taylor Casteigne, LSI Land Surveyor Intern, Survey Supervisor
<b>Project Assignment:</b>
Land Surveyor Intern
<b>Name of Firm with which associated:</b>
All South Consulting Engineers, LLC
<b>Years' experience with this Firm:</b>
1
<b>Education: Degree(s)/Year/Specialization:</b>
Bachelor of Science / 2019 / Geomatics
<b>Active registration: Year first registered/discipline:</b>
2021/ Land Surveyor Intern/ Louisiana License No. 0000714
<b>Other experience and qualifications relevant to the proposed Project:</b>
<p>Mr. Casteigne is a graduate from Nicholls State University with a degree in Geomatics. After graduation, he served as party chief and AutoCAD draftsman doing a variety of surveys for both roadways and pump stations in the state of Louisiana. He is well versed in the latest in surveying equipment technology to ensure a fast and accurate project survey.</p> <p><b>Riverbend Oxidation Pond</b> <i>Jefferson Parish, Louisiana</i> Mr. Casteigne performed full topographic survey and CAD services, including locating all subsurface utilities in accordance with department standards for the design and construction of improvements for the Riverbend Oxidation Pond Pump Station and the installation of a new sewer force main. This included performing the necessary field work for the survey, then processing the data into a useable format. Once the data was in a useable format it is imported into Auto CAD, where the data is used to build a TIN surface. With this surface cross sections are generated over the required areas based on the scope. Contours are then generated showing lines of constant elevation. The budget for the project was tracked daily ensuring that the survey was completed on time and under budget. This included placing LA One Call tickets, giving field crews the list of tasks needed to complete the project, and ensuring the project was completed in an orderly fashion.</p> <p><b>Jefferson Parish Juvenile Services Survey</b> <i>Metairie, Louisiana</i> Mr. Casteigne performed full topographic survey and CAD services, including locating all subsurface utilities in accordance with department standards for the design and construction of facility improvements. This included performing the necessary field work for the survey, then processing the data into a useable format. Once the data was</p>

## **TEC Professional Services Questionnaire**

in a useable format it is imported into Auto CAD, where the data is used to build a TIN surface. With this surface cross sections are generated over the required areas based on the scope. Contours are then generated showing lines of constant elevation. The budget for the project was tracked daily ensuring that the survey was completed on time and under budget. This included placing LA One Call tickets, giving field crews the list of tasks needed to complete the project, and ensuring the project was completed in an orderly fashion.

### **Savanne Rd Drainage Improvements *Houma, Louisiana***

Mr. Casteigne performed full boundary surveying services for the acquisition of a servitude by Terrebonne Parish for drainage Improvements. This included performing the necessary field work for the survey, then processing the data into a useable format. Once the data was in a useable format it is imported into Auto CAD where a boundary map could be prepared.

### **St. Louis Canal Rd *Houma, Louisiana***

Mr. Casteigne performed full boundary surveying services for the acquisition of a servitude by Terrebonne Parish for drainage Improvements. This included performing the necessary field work for the survey, then processing the data into a useable format. Once the data was in a useable format it is imported into Auto CAD and have a boundary map prepared.

### **Bayou Barataria Waterline Crossing *Lafitte, Louisiana***

Mr. Casteigne performed full topographic and hydrographic survey services including data collection, data processing, data management, CAD, and project budget oversight. This includes performing the necessary field work for the survey, then processing the data into a fieldbook file. Once the data was in a fieldbook it is imported into Auto CAD, where the data is used to build a TIN surface. With this surface, Plan and Profile sheets could be generated along with cross sections across Bayou Barataria. This project was done at the request of Jefferson Parish for the installation of a new waterline running along Rosethourne Rd then crossing Bayou Barataria.

### **Avoca Island Topographic Survey *St. Mary Parish, Louisiana***

Mr. Casteigne performed full survey services including data collection, data processing, data management, CAD, and project budget oversight. This includes performing the necessary field work for the survey, then processing the data into a fieldbook file. Once the data was in a fieldbook it is imported into Auto CAD, where the data is used to build a TIN surface. With this surface cross sections are generated over the required areas based on the scope. This project was done at the request of Avoca Island for drainage improvements to be made on the island.

### **Lisa Park Development *Houma, Louisiana***

Mr. Casteigne performed full survey services including data collection, data processing, data management, CAD, and project budget oversight for improvements to be made in the open space at Lisa Park Elementary School. This included performing the necessary field work for the survey, then processing the data into a useable format. Once the data was in a useable format it is imported into Auto CAD, where the data is used to build a TIN surface. With this surface cross sections are generated over the required areas based on the scope. Contours are then generated showing lines of constant elevation. The budget for the project was tracked daily ensuring that the survey was completed on time and under budget. This included placing LA One Call tickets, giving field crews the list of tasks needed to complete the project, and ensuring the project was completed in an orderly fashion. This included placing LA One Call tickets, giving field crews the list of tasks needed to complete the project, and ensuring the project was completed in an orderly fashion.

## TEC Professional Services Questionnaire

<b>KEY PERSON, SPECIALIST, OR INDIVIDUAL CONSULTANT:</b>
<b>Name &amp; Title:</b>  <b>Lyle Langley</b> Survey Party Chief
<b>Project Assignment:</b>  Survey Party Chief
<b>Name of Firm with which associated:</b>  All South Consulting Engineers, LLC
<b>Years' experience with this Firm:</b>  6
<b>Education: Degree(s)/Year/Specialization:</b>  SOWELA Technical Community College/ 2012/ Drafting
<b>Active registration: Year first registered/discipline:</b>  <div style="text-align: center; opacity: 0.5; font-size: 2em;">   State of Louisiana         </div>
<b>Other experience and qualifications relevant to the proposed Project:</b>  <p>Mr. Langley has worked on a wide variety of surveying projects and assisted in the integration of a robotic total station and our hydrographic software to track the hydrographic boat in areas where GPS was not feasible. He has the necessary training to use hydrographic equipment, HDS Laser Scanner and is familiar with Hypack hydrographic software. His work experience includes hydrographic surveys using a rod and tape, a total station, GPS and single beam echo sounders to record the data, using side scan sonar to identify underwater obstructions and using a magnetometer to sweep for pipelines and other ferrous metal debris. He has supervised field crews on many topographic and boundary surveys. His current and previous projects include, but not limited to:</p> <p><b>Silt and Debris Measurement in Jefferson Parish Canals, Jefferson Parish, Louisiana</b>          Mr. Langley has provided topographic and bathymetric survey services for the Jefferson Parish Drainage Department. His tasks on this project included providing cross sections, topography and bathymetric surveys.</p> <p><b>Canal No. 10 Underground Utility Locations, Jefferson Parish, Louisiana</b>          Mr. Langley located underground utilities as marked by a Subsurface Utility Engineer and added to an existing topographic survey.</p> <p><b>Lake Cataouatche Pump Station Topographic Survey, Jefferson Parish, Louisiana</b>          Mr. Langley and his team prepared a topographic survey at the site of the current Lake Cataouatche pump station located on Churchill Farms. The survey area adjacent to the existing pump station will be the site for a new pump station</p>



## **TEC Professional Services Questionnaire**

under design. The survey included cross sections of the site and the adjacent canal along with the location of improvements in the project area.

### **Bayou Country Sports Complex** *Houma, Terrebonne Parish, Louisiana*

Mr. Langley is providing construction layout services for the construction of baseball fields, softball fields, soccer fields and improvements for the sports complex.

### **Woodvine Ditch Topographic Survey** *Jefferson Parish, Louisiana*

Mr. Langley and his crew provided a topographic survey over the existing 54" RCP drain line followed the line from Nassau Drive south across the Metairie Country Club Golf course to its tie in point at Geisenheimer Canal. Improvements along that route were located along with trees, with size and species and topographic features on the golf course, that included ties, sand traps and the raised greens that fell in the route.

### **Loumor Outfall Ditch Topographic Survey** *Jefferson Parish, Louisiana*

Mr. Langley provided a topographic survey of the route that follows the 78" X 122" RCAP along the western edge of Metairie Country Club Golf course, then southeasterly and finally south to Geisenheimer Canal just north of Airline Highway. Improvements along that route were located along with trees, with size and species and topographic features on the golf course, that included ties, sand traps and the raised greens that fell in the route.

### **40 Arpent Canal Levee Walk and Cycling Path and Pedestrian Bridge** *St. Bernard Parish, Louisiana*

Mr. Langley assisted with the topographic survey along the 40 Arpent Levee in St. Bernard parish for the design of a walk and bike path. RTK GPS was used to locate improvement and take cross sections along the proposed survey route. The area surveyed began at the St. Bernard/Orleans parish line and continued southeasterly to Paris Road.

### **Blimp Road Sewer Phases 1 & 2** *Houma, Terrebonne Parish, Louisiana*

Mr. Langley provided topographic survey services for the Blimp Road Sewer Phases 1 & 2 Improvements for the Houma Terrebonne Airport Commission. Phase 1 of this project included the installation of approximately 2,540' of gravity sewer lines. Phase 2 of this project included the installation of approximately 1,400' of gravity sewer lines. These lines are 8" in diameter, consistent with the Terrebonne Parish Consolidated Government standards for such improvements.

### **Reach K and L Mitigation** *Lafourche Parish, Louisiana*

Mr. Langley conducted both bathymetric and topographic survey of the Reach K Mitigation area. This 40-acre marsh creation area consists of a network of oilfield canals and shallow ponds. This survey also required the location of various underground utilities and pipelines. Equipment used on this project was RTK GPS, a remotely controlled hydrographic boat and a magnetometer.

### **Bayou Terre Aux Bouefs Ridge Restoration Armoring** *St. Bernard Parish, Louisiana*

Mr. Langley and his team provided the topographic and hydrographic survey data. The survey also included sections of Bayou Lery and Bayou Gentilly. Overbank cross sections and a hydrographic survey were conducted to aid in the design of bank armoring to help stem the further erosion of the existing shoreline. Transects were also ran across approximately 10,000 acres of additional marshland. A magnetometer survey was also conducted to identify submerged pipelines.

### **Upper LA 45 Basin Tidal Surge Protection** *Lafitte, Jefferson Parish, Louisiana*

Mr. Langley is currently working on a topographic survey of a proposed route for approximately three miles of new levee and floodwalls to provide protection against tidal surge in the upper area of Lafitte, Louisiana along LA Hwy. 45.

## **TEC Professional Services Questionnaire**

<b>KEY PERSON, SPECIALIST, OR INDIVIDUAL CONSULTANT:</b>
<b>Name &amp; Title:</b>
William Lambert Survey Party Chief
<b>Project Assignment:</b>
Survey Party Chief
<b>Name of Firm with which associated:</b>
All South Consulting Engineers, LLC
<b>Years' experience with this Firm:</b>
.5
<b>Education: Degree(s)/Year/Specialization:</b>
High School Diploma
<b>Active registration: Year first registered/discipline:</b>
<b>Other experience and qualifications relevant to the proposed Project:</b>
<p>Mr. Lambert joined All South Consulting Engineers, LLC in April of 2021. He has over 15 years of experience in land surveying and has served as an instrument man to a survey party chief. He has performed topographic surveys, right-of-way, ALTAs, as-builts, stakeouts, boundaries, and elevation certificates, using Leica robotic instrument and Trimble GPS. He has also performed construction layout using Trimble Robotics and GPS and served as a survey helper in industrial surveys.</p> <p><b>LALD Lower Lafitte Drainage Improvements</b> <i>Jefferson Parish, Louisiana</i> Mr. Lambert has completed a full topographic survey of approximately 5500ft of streets for the purpose of improving the existing drainage in the area. This included establishing project control and temporary benchmarks and supervising the survey crew ensuring that the project was completed based on the scope of work in an efficient manner.</p> <p><b>Marrero St. Pump Station</b> <i>Jefferson Parish, Louisiana</i> Mr. Lambert has completed a full topographic survey of the Marrero St. Pump Station for the purpose of making improvements to the pump station. This included establishing project control and temporary benchmarks and supervising the survey crew ensuring that the project was completed based on the scope of work in an efficient manner.</p>

## **TEC Professional Services Questionnaire**

<b>KEY PERSON, SPECIALIST, OR INDIVIDUAL CONSULTANT:</b>
<b>Name &amp; Title:</b>
Austin Bowman Survey Technician
<b>Project Assignment:</b>
Survey Technician
<b>Name of Firm with which associated:</b>
All South Consulting Engineers, LLC
<b>Years' experience with this Firm:</b>
.5
<b>Education: Degree(s)/Year/Specialization:</b>
A.A.S. HVAC NCCER Level Graduate/ 2020/ Nunez Community College
<b>Active registration: Year first registered/discipline:</b>
<b>Other experience and qualifications relevant to the proposed Project:</b>
<p>Mr. Bowman joined All South Consulting Engineers, LLC in March of 2021 as a survey assistant. He received an Associate of Applied Science degree in HVAC NCCER Level from Nunez Community College in 2020. Since joining All-South, Mr. Bowman has assisted in full topographic and hydrographic surveys.</p> <p><b>Bayou Barataria Waterline Crossing Lafitte, Louisiana</b>  This project was done at the request of Jefferson Parish for the installation of a new waterline running along Rosethourne Rd then crossing Bayou Barataria. For this project, Mr. Bowman assisted the Survey Party Chief in collecting all the field data necessary for the completion of the survey. This project included full topographic and hydrographic survey services including data collection, data processing, data management, CAD, and project budget oversight. This includes performing the necessary field work for the survey, then processing the data into a fieldbook file. Once the data was in a fieldbook it is imported into Auto CAD, where the data is used to build a TIN surface. With this surface, Plan and Profile sheets could be generated along with cross sections across Bayou Barataria.</p> <p><b>Jefferson Parish Fire Training Center Jefferson Parish, Louisiana</b>  Mr. Bowman assisted in the completion of a topographic survey of the Jefferson Parish Fire Training Center for the purpose improvements to be made to the facility. This included establishing project control and collecting field data for the project.</p>

## **TEC Professional Services Questionnaire**

<b>KEY PERSON, SPECIALIST, OR INDIVIDUAL CONSULTANT:</b>
<b>Name &amp; Title:</b>
Jackson Sorrells <i>Senior CADD Technician, Drafting Supervisor</i>
<b>Project Assignment:</b>
CADD Technician III/ Draftsman
<b>Name of Firm with which associated:</b>
All South Consulting Engineers, LLC
<b>Years' experience with this Firm:</b>
4
<b>Education: Degree(s)/Year/Specialization:</b>
Associate of Applied Science / 2017/ Civil Construction and Engineering Technology Associate of Applied Science / 2011/ Drafting and Design
<b>Active registration: Year first registered/discipline:</b>
<b>Other experience and qualifications relevant to the proposed Project:</b>
<p>Mr. Sorrells joined the All South team after 8 years in the Land Surveying industry. His experience includes AutoCAD C3D which he utilizes in survey and design projects that include topographic, boundary, route corridor surveys, hydrographic surveys, ALTAs, field data input, plan and profile sheets, import/export of survey points, proposed design corridors, and volume calculations. Mr. Sorrells coordinates with field crews, drafters, engineers, and clients to generate AutoCAD C3D drawings and plan sheet sets from the beginning of a project to final stamped plans. His current and previous projects include, but not limited to:</p> <p><b>Fire Station No. 12 Jefferson, LA</b> Mr. Sorrells prepared the design plans for the construction of a new fire station for Jefferson Parish. The plans included new site plan, structural design, details, grading plan, drainage plan and utility plan. Mr. Sorrells coordinated with the project engineer and sub-contractors to conform and finalize plans.</p> <p><b>Westgate Drainage Kenner, Louisiana</b> Mr. Sorrells prepared the Record Drawings for this project. Although coming in late to this project Mr. Sorrells developed the record drawings for this project by coordinating with the project engineer, inspectors and sub-contractors. Ensuring that the record drawings incorporated all as-built conditions of this project.</p> <p><b>South Kenner Avenue Rehabilitation (Between Live Oak Blvd. and Chenevert Rd.) Jefferson Parish, Louisiana</b> Mr. Sorrells provided drafting support for this project, including plan sheets, cross sections, and existing subsurface pipe networks. Showing the existing roadway and existing sidewalk, which were to be developed in a wider and improved asphalt roadway with new sidewalks and subsurface drainage. This project conformed to the Jefferson Parish criteria.</p>



## **TEC Professional Services Questionnaire**

### **Lake Trail Drive Drainage Improvements** *Kenner, Louisiana*

Mr. Sorrells prepared the topographic and right-of-way drawings for Lake Trail Drive, from its intersection with the northern right-of-way of Bruin Drive, north to the southern right-of-way of West Esplanade Avenue; approx. 2880 LF. The drawings included elevation shots of Lake Trail Drive, right-of-way to right-of-way for the creation of cross sections every 50'. He also created a 3D surface, a centerline profile, and underground utility profiles for this project.

### **Plaquemines Parish Government Complex** *Plaquemines Parish, LA*

Mr. Sorrells prepared the design plans for the renovations to the Plaquemines Parish Government pavilion. The plans included the new entry patio slab, entry sidewalk, HVAC equipment slab, sections and details. Mr. Sorrells coordinated with the project engineer and sub-contractors to conform and finalize the plans.

### **Russell St Pump Station** *River Ridge, Louisiana*

Mr. Sorrells prepared proposed location of a new pump station to be installed by Ralph J. Bunche Elementary School (Russell St. Pump Station) in Jefferson Parish, Louisiana. These plans included an overall site plan, plan view and a typical section. Coordination with the project engineer to properly show the existing utilities, railroad and rights-of-way was very important in this project.

### **FEMA Recovery Roads Program (Viavant – Lake Catherine – Venetian Isles)** *New Orleans, Louisiana*

Mr. Sorrells prepared plan surveys for multiple streets in the Viavant-Lake Catherine area. These surveys depicted the elevations of the streets to show centerline and gutter line profiles, the surface created showed the many imperfections and potholing in the streets. Included in this area were Catherine St, Victoria St, Reynes St., and America St. This project was approximately 1800' and included invert depths for the drainage, sewerage and water underground utilities.

### **FEMA Submerged Road Program (Audubon, Black Pearl, East Carrollton, Uptown, West Riverside, Pines Village)** *New Orleans, Louisiana*

Mr. Sorrells prepared survey baseline drawings, plan sheets and profiles depicting the underground utilities for the streets in the Uptown project. These surveys depicted the elevations of the streets to show centerline and gutter line profiles, and the surface created showed the many imperfections and potholing in the streets. Utility information was researched and observed to show the areas in need of repair or replacement of major drainage, sewer and water lines. Also included were right-of-way lines, apparent lot lines, 3D surface, and cross sections.

### **Rosethorne Path – LA. 45** *Jefferson Parish, Louisiana*

Mr. Sorrells prepared the topographic survey for this project. This project was approx. 9500 LF along Rosethorne Rd./Jean Lafitte Hwy. The plans included plan and profile showing the existing drainage/sewer/ water with inverts. TBMs were set along 500' increments and the right-of-way of the highway was calculated from reference maps and put into the drawings.

### **Upper LA Hwy. 45 Tidal Surge Protection** *Jefferson Parish, Louisiana*

Mr. Sorrells prepared the topographic and hydrographic survey for this project. The project included two alignments which were called North and South portions. The north portion was approx. 7650 LF along the shoreline of Bayou Barataria, included in this portion was the hydrographic survey and topography, profile, cross sections were cut along the baseline. The south portion of this project was along the levee south of Jean Lafitte Blvd. approx. 8225 LF. These plans included profile and cross sections along the survey baseline.

### **HMGP Canal Crossing Project-Golden Drive St.** *Bernard Parish, Louisiana*

Mr. Sorrells prepared the plan set for the Golden Drive Canal Crossing. This project included the replacement/improvement of a drainage canal crossing, removing damaged CMP and replace with a precast arch bridge system and associated roadway and utilities. Mr. Sorrells assisted the project engineer in completing the proposed plan set and the new site design. Mr. Sorrells also assisted in computing the quantities and detour plan used for this project.



## TEC Professional Services Questionnaire

**L. Work by Firm or Joint-Venture members which best illustrates current qualifications relevant to this Project. Please include any and all work performed for Jefferson Parish. Please attach additional pages if necessary.**

### PROJECT NO. 1

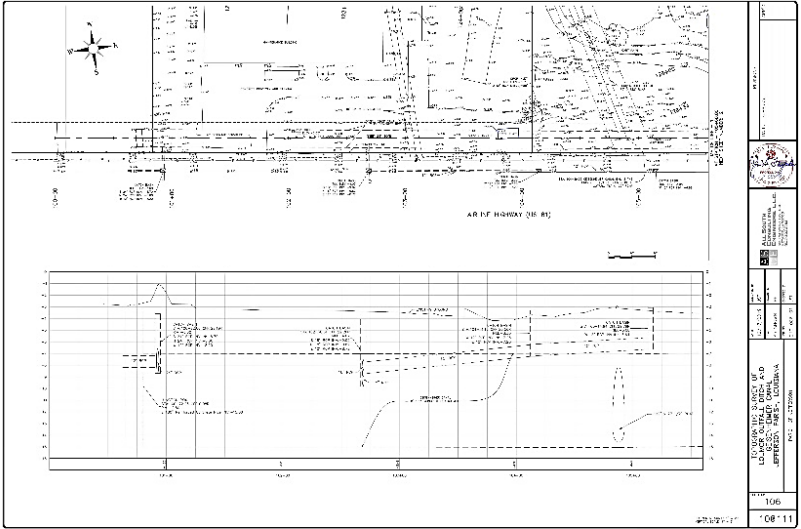
Project Name, Location and Owner's contact information:	Nature of Firm's Responsibility:	
<p><b>Geisenheimer Canal Topographic Survey</b>  <i>Jefferson Parish, Louisiana</i></p> <p>Jefferson Parish Government            Mr. Neil Schneider, P.E.            Director of Capital Projects            1221 Elmwood Park Blvd            Jefferson, Louisiana 70123            (504)736-6753</p>	<p>This survey was prepared to provide the field data necessary to design drainage improvements for the Geisenheimer Canal which flows to Hoey's Canal and from there to 17<sup>th</sup> Street Canal and Lake Pontchartrain.</p> <p>In order to accomplish this, we prepared a topographic survey of the surface area above Geisenheimer Canal from the maintenance facility for the Metairie Country Club to the tie in point at Hoey's Canal. For this route we located all surface improvements, visible signs of utilities, trees with size and species and cross sections at 50' intervals.</p> <p>We were able to locate the underground concrete box canal by accessing it through an access cover where we set a control point in the bottom of the box we then located the sides and roof and the tie in point for the concrete arch pipe outfall for the Loumor Ditch. From a drop inlet cover near the Woodvine Ditch outfall we located the outfall and determined the invert. This was verified by probing the outfall pipe at the edge of the box. At Hoey's Canal we probed the top of the Geisenheimer Canal box and the Hoey's Canal box to determine the point of intersection.</p> <p>The deliverable for this survey were plan and profile drawings of Geisenheimer Canal which were included in a master set with Loumor Ditch and Woodvine Ditch.</p> <div style="text-align: center;">  </div>	
<b>Completion Date (Actual or estimated):</b>	<b>Estimated Cost:</b>	
	<b>Entire Project:</b>	<b>Entire Project:</b>
February 2020	N/A	Survey Cost: \$25,920

## TEC Professional Services Questionnaire

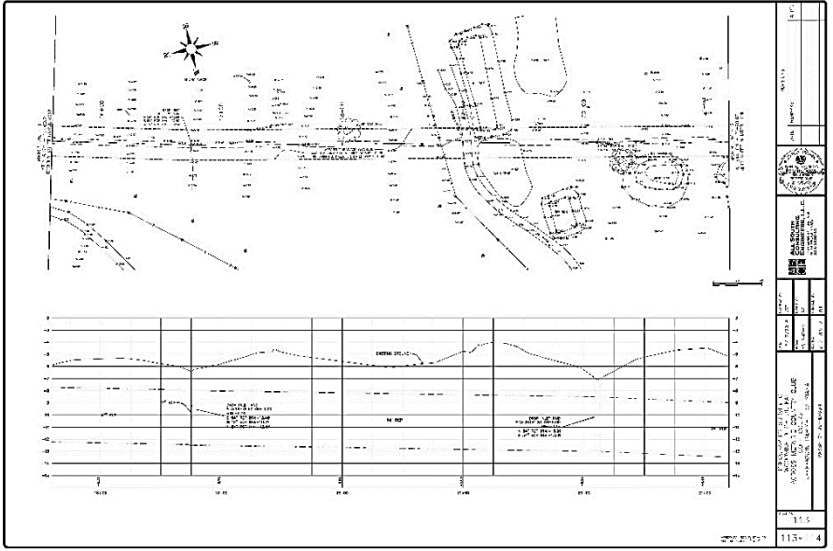
<b>PROJECT NO. 2</b>		
<b>Project Name, Location and Owner's contact information:</b>	<b>Nature of Firm's Responsibility:</b>	
<p><b>Woodvine Ditch Topographic Survey</b>  <i>Jefferson Parish, Louisiana</i></p> <p>Jefferson Parish Government            Mr. Neil Schneider, P.E.            Director of Capital Projects            1221 Elmwood Park Blvd            Jefferson, Louisiana 70123            (504)736-6753</p>	<p>This survey is for drainage improvements to the Woodvine Ditch beginning at the western right of way of Nassau Drive and following the drain line west-southwesterly across the parking lot that lies on the north side of the swimming pools and tennis courts to the eastern side of the golf course where the drain line turns in a southerly direction and heads south-southwest to its discharge point into Geisenheimer Canal at the north right of way of Airline Highway.</p> <p>The topographic survey over the existing 54" RCP drain line followed the line from Nassau Drive south across the Metairie Country Club Golf course to its tie in point at Geisenheimer Canal. Improvements along that route were located along with trees, with size and species and topographic features on the golf course, that included ties, sand traps and the raised greens that fell in the route.</p> <p>Deliverables were plan and profile sheets that were included with the master set of Loumor Ditch Outfall, Geisenheimer Canal and Woodvine Ditch.</p> <div style="text-align: right; margin-top: 20px;">  </div>	
<b>Completion Date (Actual or estimated):</b>	<b>Estimated Cost:</b>	
	<b>Entire Project:</b>	<b>Work for which Firm was Responsible:</b>
February 2020	N/A	Survey Cost: \$16,720

## TEC Professional Services Questionnaire

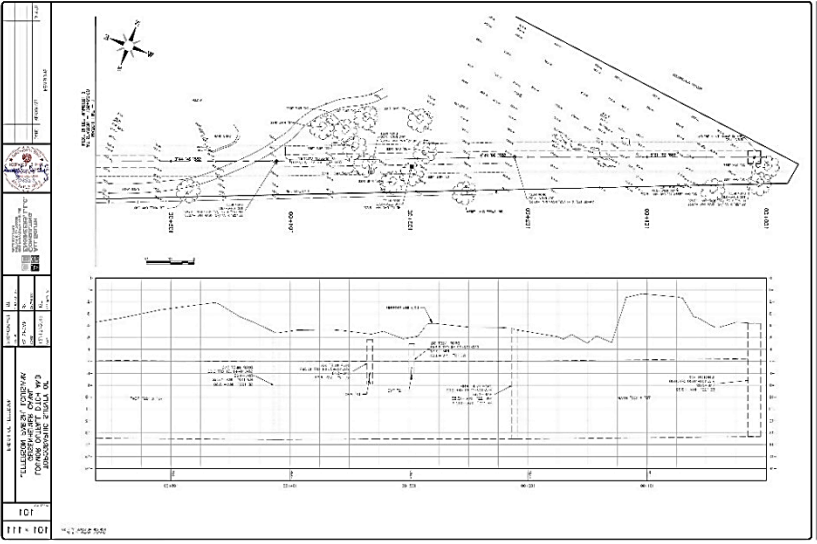
<b>PROJECT NO. 3</b>						
<b>Project Name, Location and Owner's contact information:</b>	<b>Nature of Firm's Responsibility:</b>					
<p><b>Loumor Outfall Ditch Topographic Survey</b>  <i>Jefferson Parish, Louisiana</i></p> <p>Mr. Neil Schneider, P.E.            Director of Capital Projects            1221 Elmwood Park Blvd            Jefferson, Louisiana 70123            (504)736-6753</p>	<p>This survey is for drainage improvements to the Loumor Outfall Ditch beginning at the southwest corner of Pontiff Playground and running southeast then turning in a south-southwesterly direction along the northern and western boundary of Metairie Club Estates Subdivision to its discharge point into Geisenheimer Canal and the north right of way of Airline Highway.</p> <p>This survey route follows the 78" X 122" RCAP along the western edge of Metairie Country Club Golf course, then southeasterly and finally south to Geisenheimer Canal just north of Airline Highway. Improvements along that route were located along with trees, with size and species and topographic features on the golf course, that included ties, sand traps and the raised greens that fell in the route.</p> <p>We also located the maintenance facility for the golf course, ponds and a pump house that were near the drain route.</p> <p>Deliverables for this project were plan and profile sheets that were included with the master set of Loumor Ditch Outfall, Geisenheimer Canal and Woodvine Ditch.</p> <div style="text-align: center;">  </div>					
<p><b>Completion Date (Actual or estimated):</b></p>	<p style="text-align: center;"><b>Estimated Cost:</b></p> <table border="1" style="width: 100%; border-collapse: collapse;"> <tr> <td style="width: 50%; padding: 5px; vertical-align: top;"><b>Entire Project:</b></td> <td style="width: 50%; padding: 5px; vertical-align: top;"><b>Work for which Firm was Responsible:</b></td> </tr> <tr> <td style="width: 50%; padding: 5px; text-align: center;">N/A</td> <td style="width: 50%; padding: 5px; text-align: center;">Survey Cost: \$19,340</td> </tr> </table>		<b>Entire Project:</b>	<b>Work for which Firm was Responsible:</b>	N/A	Survey Cost: \$19,340
<b>Entire Project:</b>	<b>Work for which Firm was Responsible:</b>					
N/A	Survey Cost: \$19,340					
<p>February 2020</p>						

## TEC Professional Services Questionnaire

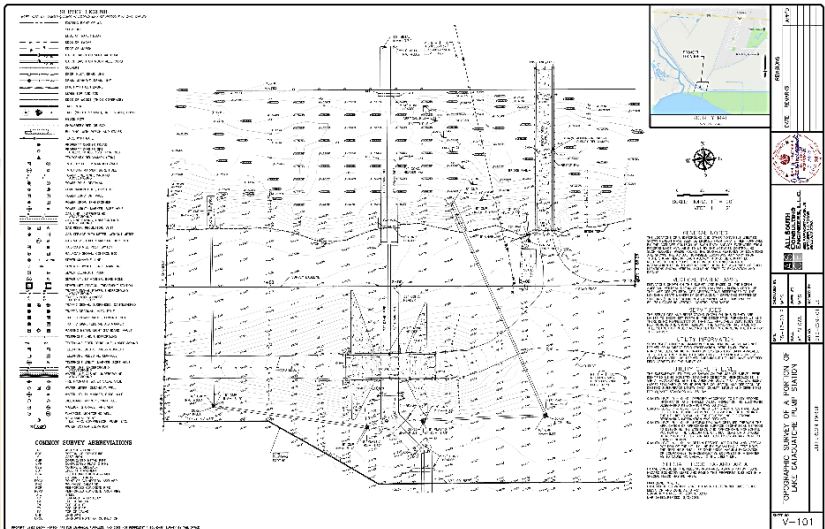
<b>PROJECT NO. 4</b>						
<b>Project Name, Location and Owner's contact information:</b>	<b>Nature of Firm's Responsibility:</b>					
<p><b>Lake Cataouatche Pump Station Topographic Survey</b>  <i>Jefferson Parish, Louisiana</i></p> <p>Jefferson Parish Drainage Department            Jefferson Parish Government            Mitchell T. Theriot, P.E., Director of Drainage            1221 Elmwood Park Blvd            Jefferson, Louisiana 70123            (504)736-6753</p>	<p>All South prepared a topographic survey at the site of the proposed pump station on the northern shore of Lake Cataouatche. The new site lies south of the existing pump station and just north of the flood wall. The survey included cross sections of the proposed site and adjacent canal, location of improvements, the existing discharge pipes, roadways and the floodwall.</p> <div style="text-align: center;">  </div>					
<p><b>Completion Date (Actual or estimated):</b></p>	<p style="text-align: center;"><b>Estimated Cost:</b></p> <table border="1" style="width: 100%; border-collapse: collapse;"> <tr> <td style="width: 50%; padding: 5px; vertical-align: top;"><b>Entire Project:</b></td> <td style="width: 50%; padding: 5px; vertical-align: top;"><b>Work for which Firm was Responsible:</b></td> </tr> <tr> <td style="width: 50%; padding: 5px; text-align: center;">N/A</td> <td style="width: 50%; padding: 5px; text-align: center;">Survey Cost: \$4,495</td> </tr> </table>		<b>Entire Project:</b>	<b>Work for which Firm was Responsible:</b>	N/A	Survey Cost: \$4,495
<b>Entire Project:</b>	<b>Work for which Firm was Responsible:</b>					
N/A	Survey Cost: \$4,495					
<p>May 2019</p>						

# TEC Professional Services Questionnaire

## PROJECT NO. 5

Project Name, Location and Owner's contact information:	Nature of Firm's Responsibility:					
<p style="text-align: center;"><b>Duncan Canal Box Culverts</b> <i>Kenner, Louisiana</i></p> <p>Jefferson Parish Government Mitchell T. Theriot, P.E., Director of Drainage 1221 Elmwood Park Blvd Jefferson, Louisiana 70123 (504)736-6753</p>	<p>All South was tasked with providing a survey to show the depth of silt that has accumulated within the 11' x 22' box culverts that start south of Veterans Boulevard to a point south of the intersection with Canal No. 5 (West Metairie Avenue) and the end of the double box culvert. All South's remotely controlled boat was utilized with a dual frequency echosounder to obtain depths to the top of silt and the concrete bottom of the box culvert. The deliverable for this project was a report of the survey results and plotted profile sheets prepared for each box.</p> <div style="border: 1px solid black; padding: 5px; margin-top: 10px;"> </div> <div style="border: 1px solid black; padding: 5px; margin-top: 10px;"> <p style="text-align: center;"><b>DUNCAN CANAL EASTERN BOX CULVERT</b></p> </div>					
<p><b>Completion Date (Actual or estimated):</b></p> <p style="text-align: center;">September 2018</p>	<p><b>Estimated Cost:</b></p> <table border="1" style="width: 100%; border-collapse: collapse;"> <tr> <th style="width: 50%; text-align: left; padding: 5px;">Entire Project:</th><th style="width: 50%; text-align: left; padding: 5px;">Work for which Firm was Responsible:</th></tr> <tr> <td style="text-align: center; padding: 10px;">N/A</td><td style="padding: 10px;">Survey Cost: \$11,000</td></tr> </table>		Entire Project:	Work for which Firm was Responsible:	N/A	Survey Cost: \$11,000
Entire Project:	Work for which Firm was Responsible:					
N/A	Survey Cost: \$11,000					

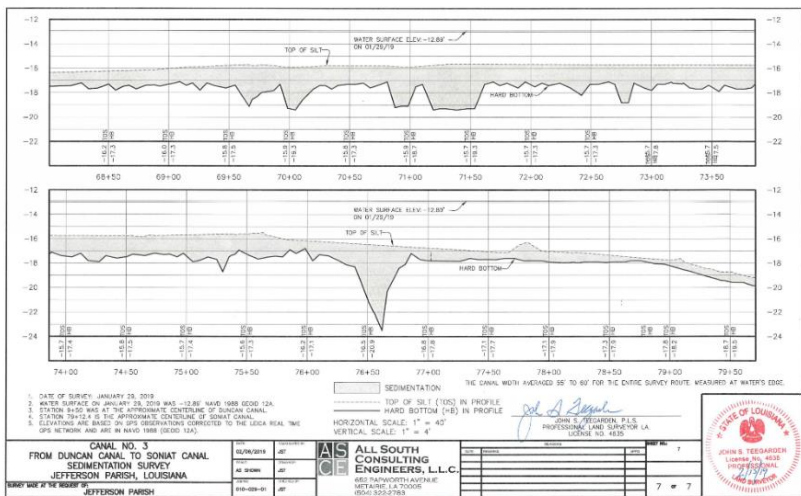

## TEC Professional Services Questionnaire

<b>PROJECT NO. 6</b>		
<b>Project Name, Location and Owner's contact information:</b>	<b>Nature of Firm's Responsibility:</b>	
<p><b>Jefferson Parish Canal Sedimentation and Debris Surveys</b>  <i>Jefferson Parish, Louisiana</i></p> <p>Jefferson Parish Government            Mitchell T. Theriot, P.E., Director of Drainage            1221 Elmwood Park Blvd            Jefferson, Louisiana 70123            (504)736-6753</p>	<p>All South is performing hydrographic surveys of selected drainage canals and box culverts in the Jefferson Parish Drainage System. The purpose of these surveys is to monitor the amount of sediment accumulating in the drainage system. All South utilizes its Z-Boat (a 6-foot long remotely controlled hydrographic survey boat) to perform these surveys. The Z-Boat is equipped with a single beam dual frequency echo sounder capable of defining the amount of sediment accumulating in the canals and drainage structures. This is accomplished by using two frequency during the survey.</p> <div style="display: flex; align-items: center;">  </div> <p>The high frequency sound waves are reflected by the top of the sediment layer and the low frequency sound waves penetrate the sediment and are reflected by the solid bottom. These surveys are presented as profiles and show the top of sediment elevations and the elevation of the solid bottom.</p>	
		
<b>Completion Date (Actual or estimated):</b>	<b>Estimated Cost:</b>	
	<b>Entire Project:</b>	<b>Work for which Firm was Responsible:</b>
Project is Ongoing by Task Assignments	N/A	Survey Cost: \$75,000

## TEC Professional Services Questionnaire

<b>PROJECT NO. 7</b>		
<b>Project Name, Location and Owner's contact information:</b>	<b>Nature of Firm's Responsibility:</b>	
<p><b>Ruby and Wright Lift Station Topographic Survey</b>  <i>Jefferson Parish, Louisiana</i></p> <p>GreenPoint Engineering  Amer Tufail, PE, BCEE  701 Loyola Ave., Suite 801  New Orleans, LA 70113  (504) 708-2020</p>	<p>All South Consulting Engineers, LLC was hired as subconsultant to GreenPoint Engineering to provide Topographic and Boundary Survey services for the Improvements to the Ruby and Wright Avenue Lift Station. This survey was done so the existing lift station could be moved back from its present position that was close to the Wright Avenue traffic lanes.</p> <p>The scope of work for this project included:</p> <ul style="list-style-type: none"> <li>Survey control both horizontal and vertical. The horizontal control datum will be in the Louisiana State Plane Coordinate System, South Zone (1702) NAD 1983 (2011) and the vertical control datum will be NAVD 1988 Geoid 12B. Control points will be established outside of the likely construction area. A TBM will be set out of the construction area.</li> <li>Located the existing lift station with inverts and sizes. We also located existing improvements that include fences, roadways, curbing, etc.</li> <li>Locations of visible evidence of above and below ground utilities and those utilities marked by the subscribers to the 811 system. We will also plot the approximate location from maps supplied by the controlling agencies.</li> <li>The locations of water, sewer and drainage structures in the survey area with elevations shown on the top of casting, invert elevations and size and type of material of piping.</li> <li>Locations of any trees 4" or larger at chest height with type.</li> <li>Elevations taken across the site at 25 foot intervals and at all breaks in grade</li> <li>Establish the property boundaries adjacent to the site.</li> <li>The finished product was a 24" X 36" site plan.</li> </ul>	
<b>Completion Date (Actual or estimated):</b>	<b>Estimated Cost:</b>	
	<b>Entire Project:</b>	<b>Work for which Firm was Responsible:</b>
March 2018	N/A	Survey Cost: \$5,865

## TEC Professional Services Questionnaire

<b>PROJECT NO. 8</b>						
<b>Project Name, Location and Owner's contact information:</b>	<b>Nature of Firm's Responsibility:</b>					
<p><b>Power and 39<sup>th</sup> Sewer Pump Station Topographic Survey</b> <i>Jefferson Parish, Louisiana</i></p> <p style="text-align: center;">MSMM Scott G. Chehardy 4640 South Carrollton Ave. Suite 220 New Orleans, LA 700119 (985) 233-9763</p>	<p>The topographic survey for this project encompassed an area approximately 100 feet by 100 feet located at the southeast corner of the intersection of Power Boulevard and 39<sup>th</sup> Street.</p> <p>The scope of services for this project included the following:</p> <ul style="list-style-type: none"> <li>Control points and TBM's at the site. Baseline is not needed.</li> <li>Complete benchmark location &amp; description.</li> <li>Topo within limits shown on the attachment. Include all features within these limits (utility poles, ditches, culverts, etc.)</li> <li>Any utilities within limits (We placed a LA One Call ticket and located any utilities marked by their subscribers. Existing manholes catch basins and wet well inverts were collected during this survey.</li> <li>Elevations on a 25-foot grid across the site to include the adjacent roadways.</li> <li>We provided a 25' grid of spot elevations throughout project site.</li> <li>The deliverables included a PLS stamped PDF of survey and CAD files suitable for use with ACAD 18.</li> <li>Boundary evidence was located along the right of way of Power Boulevard and 39<sup>th</sup> Street along with ownership for the pump station building. This information was used to develop the existing right of way of the streets and pump station.</li> </ul>					
<p><b>Completion Date (Actual or estimated):</b></p>	<p style="text-align: center;"><b>Estimated Cost:</b></p> <table border="1" style="width: 100%; border-collapse: collapse;"> <tr> <th style="width: 50%; padding: 5px;"><b>Entire Project:</b></th> <th style="width: 50%; padding: 5px;"><b>Work for which Firm was Responsible:</b></th> </tr> <tr> <td style="width: 50%; text-align: center; padding: 10px;">N/A</td> <td style="width: 50%; text-align: center; padding: 10px;">Survey Cost: \$4,410</td> </tr> </table>		<b>Entire Project:</b>	<b>Work for which Firm was Responsible:</b>	N/A	Survey Cost: \$4,410
<b>Entire Project:</b>	<b>Work for which Firm was Responsible:</b>					
N/A	Survey Cost: \$4,410					

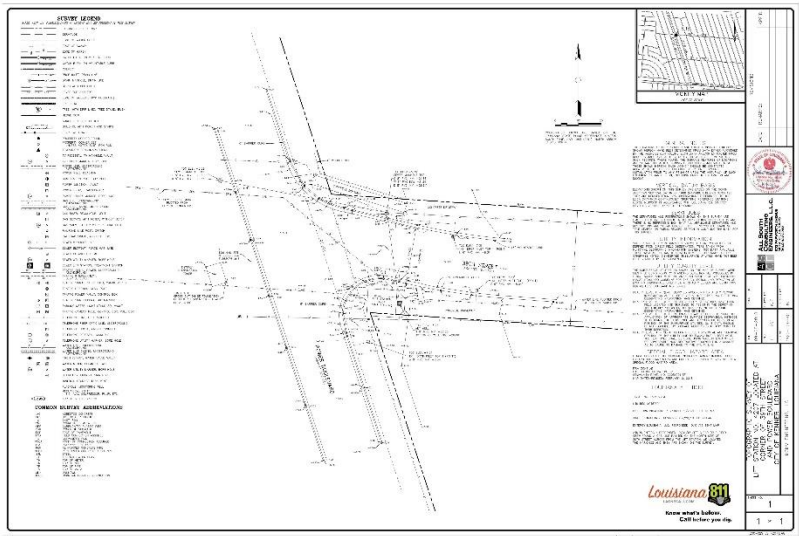

## TEC Professional Services Questionnaire

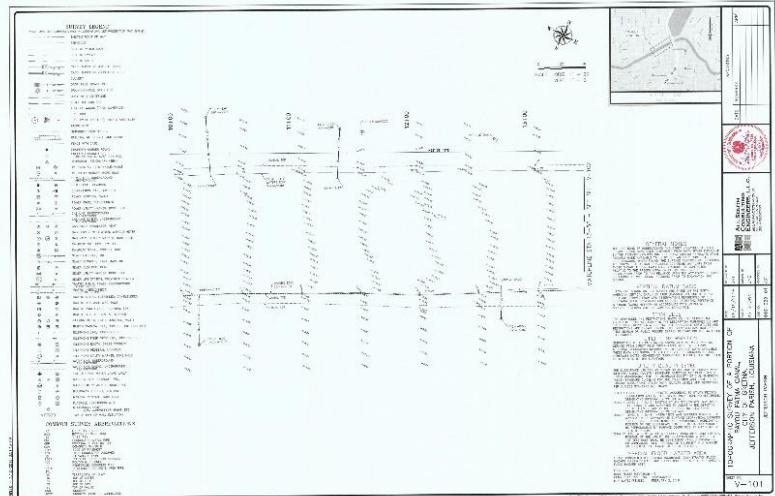
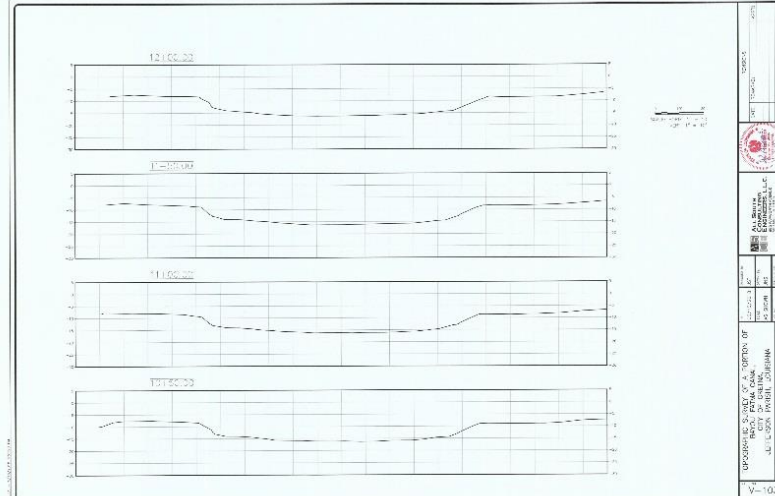
<b>PROJECT NO. 9</b>						
<b>Project Name, Location and Owner's contact information:</b>	<b>Nature of Firm's Responsibility:</b>					
<p><b>Bayou Fatma at Wall Blvd</b>  <i>Jefferson Parish, Louisiana</i></p> <p>Jefferson Parish Government            Mitchell T. Theriot, P.E., Director of Drainage            1221 Elmwood Park Blvd            Jefferson, Louisiana 70123            (504)736-6753</p>	<p>All South provided cross sections of Bayou Fatma from the western edge of the southbound bridge of Wall Boulevard over Bayou Fatma for 500 feet in a westerly direction to aid in bank repairs. The cross sections extended from right of way to right of way and included the location and inverts of drainage culverts emptying into the canal. To obtain depths within the canal All South utilized a remotely controlled boat with GPS and an echosounder linked to a laptop to record the data.</p> <div style="display: flex; justify-content: space-around; align-items: center;">   </div>					
<p><b>Completion Date (Actual or estimated):</b></p>	<p style="text-align: center;"><b>Estimated Cost:</b></p> <table border="1" style="width: 100%; border-collapse: collapse;"> <tr> <td style="width: 50%; padding: 5px; text-align: center;"><b>Entire Project:</b></td> <td style="width: 50%; padding: 5px; text-align: center;"><b>Work for which Firm was Responsible:</b></td> </tr> <tr> <td style="width: 50%; padding: 5px; text-align: center;">N/A</td> <td style="width: 50%; padding: 5px; text-align: center;">Survey Cost: \$1,491.30</td> </tr> </table>		<b>Entire Project:</b>	<b>Work for which Firm was Responsible:</b>	N/A	Survey Cost: \$1,491.30
<b>Entire Project:</b>	<b>Work for which Firm was Responsible:</b>					
N/A	Survey Cost: \$1,491.30					
<p>May 2018</p>						

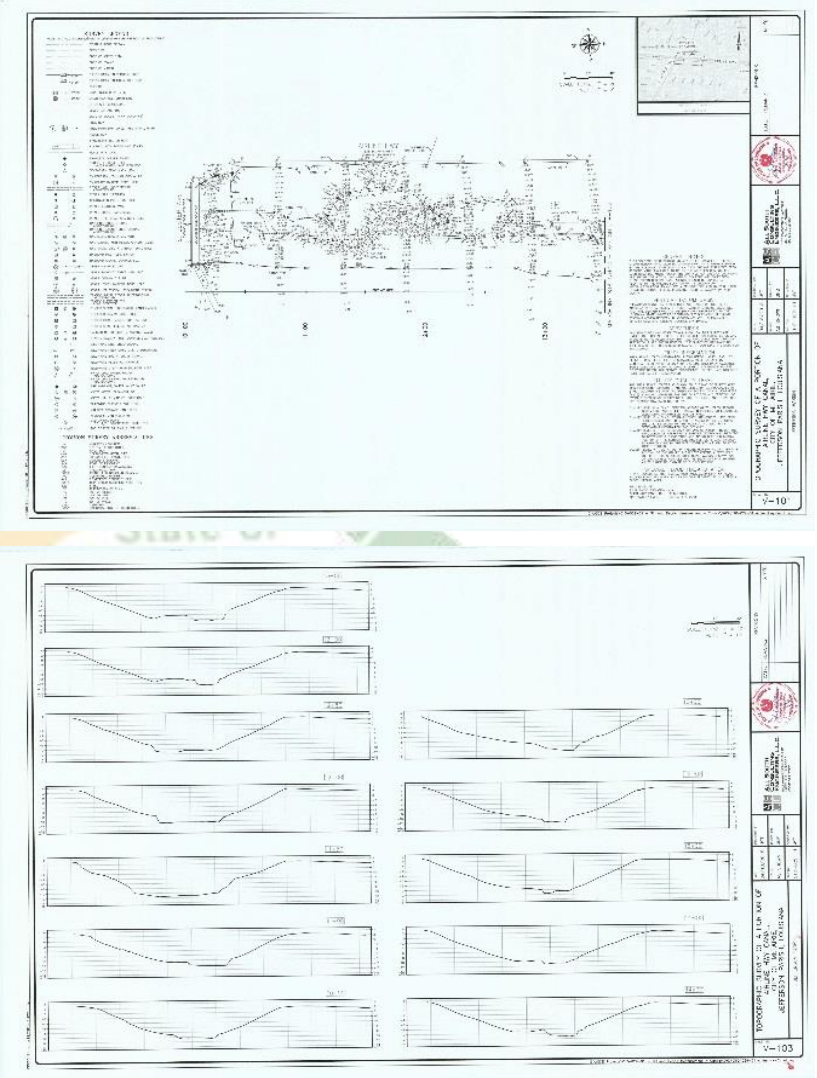

## TEC Professional Services Questionnaire

<b>PROJECT NO. 10</b>						
<b>Project Name, Location and Owner's contact information:</b>	<b>Nature of Firm's Responsibility:</b>					
<p style="text-align: center;"><b>Airline Highway Canal</b> <i>Jefferson Parish, Louisiana</i></p> <p>Jefferson Parish Government Mitchell T. Theriot, P.E., Director of Drainage 1221 Elmwood Park Blvd Jefferson, Louisiana 70123 (504)736-6753</p>	<p>All South was directed to survey a section of Airline Highway Canal from the eastern side of the Lester Avenue Bridge to a point <math>\pm 620</math> east of the bridge and from the southern curb line of Airline Highway to 25 feet south of the south top of bank of the Airline Highway Canal. The purpose of this survey was to aid the parish in the repair of bank failures in the Airline Highway Canal. Cross sections were taken at 50-foot intervals and the survey included the location of plastic bulkhead that had been installed and the location and inverts of drainage culverts within the survey area. Deliverable included a plan view of the survey and plotted cross sections.</p> <div style="text-align: center;">  <p>The image shows two survey documents. The top document is a plan view of the Airline Highway Canal, showing the canal's alignment, the Lester Avenue Bridge, and various survey points and measurements. The bottom document is a set of plotted cross sections of the canal, showing the canal's width, depth, and the location of the plastic bulkhead and drainage culverts.</p> </div>					
<p><b>Completion Date (Actual or estimated):</b></p>	<p style="text-align: center;"><b>Estimated Cost:</b></p> <table border="1" style="width: 100%; border-collapse: collapse;"> <tr> <th style="width: 50%; padding: 5px;"><b>Entire Project:</b></th> <th style="width: 50%; padding: 5px;"><b>Work for which Firm was Responsible:</b></th> </tr> <tr> <td style="width: 50%; padding: 5px; text-align: center;">N/A</td> <td style="width: 50%; padding: 5px; text-align: center;">Survey Cost: \$606.96</td> </tr> </table>		<b>Entire Project:</b>	<b>Work for which Firm was Responsible:</b>	N/A	Survey Cost: \$606.96
<b>Entire Project:</b>	<b>Work for which Firm was Responsible:</b>					
N/A	Survey Cost: \$606.96					
<p>May 2018</p>						



## **TEC Professional Services Questionnaire**

**M. List all prior and/or on-going litigation between Firm and Jefferson Parish. Please attach additional pages if necessary.**

<b>Parties:</b>		<b>Status/Result of Case:</b>
<b>Plaintiff:</b>	<b>Defendant:</b>	
<b>1. IMC Construction</b>	<b>Jefferson Parish</b>	<b>Jefferson Parish filed 3<sup>rd</sup> party demand to All South Consulting Engineers, LLC. Status is pending</b>
<b>2.</b>		
<b>3.</b>		
<b>4.</b>		

**N. Use this space to provide any additional information or description of resources supporting Firm's qualifications for the proposed project.**

All South Consulting Engineers, LLC is a Limited Liability Corporation owned by Timothy Bonura, Jens J. Nielsen Jr., and Stephen Smith. Established in May 2004, All South was founded to provide professional engineering services to municipalities and governmental agencies, as well as private clients throughout the South. All South has since experienced tremendous growth and is proudly recognized as one of the Gulf South's leading Surveying firms, as well.

All South's Surveying Division has a client list that includes the following parishes, municipal and state organizations: Jefferson Parish, Plaquemines Parish, St. Bernard Parish, Orleans Parish, St. Tammany Parish, Lafourche Parish, Terrebonne Parish, East Baton Rouge Parish, Livingston Parish, Ascension Parish, Coastal Protection and Restoration Authority, City of Gretna and City of Slidell. Projects range from topographic surveys for design of new facilities and infrastructure to bathymetric surveys for coastal restoration and drainage maintenance.

### **PROFESSIONAL TRAINING AND EXPERIENCE**

All South offers outstanding surveying services from leading professionals, including our Professional Land Surveyor. As Vice President and Survey Division Manager, Mr. John S. Teegarden, PLS has extensive experience in all aspects of land surveying which he has acquired over his 30-year career. All South's substantial local experience providing Professional Land Surveying services can be found throughout the TEC Professional Services Questionnaire. Firm capabilities and services include but are not limited to the following:

- **Control Surveys** – Establish the horizontal and vertical survey info via deep rod monuments and GPS network surveys
- **Boundary/ALTA-NSPS Surveys** – ALTA-NSPS (American Land Title Association-National Society of Professional Surveyors) surveys for large property transactions
- **Topographic Surveys** – Route and corridor surveys and development site surveys
- **Elevation Surveys** – Elevation certifications and effects of subsidence over time

## **TEC Professional Services Questionnaire**

- **Hydrographic Surveys** – Coastal restoration, maintenance dredging, dock construction and maintenance, USACE permitting surveys, and using side scan single beam and multi-beam hydrographic profiles
- **HDS (High Definition Survey) Laser Scanning** – High resolution point clouds to verify measurements, monitor movement of a structure, and provide a 3D model of area surveyed using 360° scans at our survey sites for this reason
- **GIS Data Acquisition** – Collect data for infrastructure inventory, complete with geocoded photographs of each item
- **Pipeline Surveying** – Collect pipe tally measurements, record heat, weld and joint numbers, record horizontal and depth of cover

### **LAND SURVEY, HYDROGRAPHIC SURVEY SERVICES:**

All South possesses the staff and capability to offer licensed surveying services, including land and hydrographic survey services. Our land survey crews have completed multiple coastal and flood protection relation projects, including all the projects listed above, through the pre-site survey, setting project control points, dredging and borrow quantity measurement, and as-built surveys.

All South is a leading provider of hydrographic surveying services. We are experienced with single-beam, multi-beam, and side-scan sonar surveys and efficiently process hydrographic data with HYPACK software. Our 26' survey vessel is outfitted with a dual-frequency echosounder to take on large hydro projects. The 6' Z-Boat remote survey boat allows us to access sites where a manned boat can't be used.

### **EQUIPMENT:**

- GPS (Global Positioning System)
- Leica GS-14 GPS Receivers
- AutoCAD Stations Civil 3D, Microstation, InRoads, CadConform
- 26' Scully Aluminum Boat with Dual 150 h.p. motors
- 14' Aluminum Flat Boat
- 6' Z-boat, remotely operated hydrographic survey boat
- Odom Hydrographic CV100 dual frequency Echosounder
- Tritech Starfish 990F side scan sonar
- Getac X500 Laptop with Hypack Hydrographic Software
- G-882 Magnetometer
- Four wheel off road vehicles / marsh buggies



### **SOFTWARE:**

- Hypack – Hydrographic software
- LEICA Geo – GPS Software

### **SIZE OF FIRM**

The All South team includes 53 professionals driven to excellence and focused on our client's needs. We are made up of 12 Louisiana Licensed Professional Civil Engineers, 3 Engineering Interns, **1 Professional Land Surveyor, 1 Land Surveyor Intern, 2 Survey Party Chiefs, and 3 Survey Technicians.** Our staff also includes program managers, CADD technicians/draftsmen, grant specialist, inspectors, field monitors, survey crews, and administrative support staff, all of which provide years of experience to help ensure that our work is exceptional.

### **CAPACITY FOR TIMELY COMPLETION**

With 53 employees and ample resources, All South has more than enough capacity to meet any deadlines that the Parish requests. At All South, we understand the importance and value of time. We take pride in completing our projects ahead of schedule. We would not sign an agreement to complete a project if we could not meet or exceed the schedule designated by the owner. Our team is committed to and capable of meeting all schedules and deadlines that the Parish requests to ensure timely completion of this project.

## TEC Professional Services Questionnaire

Additionally, we will utilize Team Gantt software for this project as a means of communication and accountability between consultants and Parish personnel. Team Gantt is an excellent project management tool designed to help create, manage, and finish projects on time and on budget. This software allows us to change start and end dates, reorder tasks, and adjust timelines seamlessly. It allows us to see every project update and document on a single page and quickly share them with both internal and external stakeholders. Team Gantt allows us to effectively manage resources, stay on budget, and ensure everyone is working but not overloaded. We can compare the original timeline projection with the actual timeline of the project with a baseline report. Parish personnel will be issued access to Team Gantt, so they can remain updated on the progress of the project at their own convenience.

### PAST PERFORMANCE

As mentioned in the above referenced project descriptions, All South has substantial local experience providing Surveying services on various projects. Aside from our technical experience, All South stands out amongst competitors because of our unrivaled devotion to our clients and ability to meet their needs.

The satisfaction expressed by our clients can be directly accredited to not only our ability to deliver exceptional work that meets all contractual, time, and budgetary obligations, but also the genuine and lasting relationships we build throughout the process. At All South, we understand the grave role we play in each project and thus, uphold the highest standard of personal and professional integrity and competence.

### LOCATION OF THE PRINCIPAL OFFICE

All South's home office is located at 652 Papworth Avenue, Metairie, Louisiana 70005.

### ADVERSARIAL LEGAL PROCEEDINGS

Please refer to section M of this TEC Questionnaire.

### PRIOR SUCCESSFUL COMPLETION

Please refer to the project descriptions listed above to see All South's prior successful completion of similar projects, as well as, their respective verifiable references.

**O. To the best of my knowledge, the foregoing is an accurate statement of facts.**

Signature:  Print Name: John S. Teegarden, P.L.S.  
Title: Vice President/ Survey Division Manager Date: April 30, 2021

## Statement of Qualifications

### AFFIDAVIT

STATE OF Louisiana

PARISH/COUNTY OF Jefferson

BEFORE ME, the undersigned authority, personally came and appeared: Timothy P. Bonura, P.E.

\_\_\_\_\_, (Affiant) who after being by me duly sworn, deposed and said that

he/she is the fully authorized Managing Partner of All South Consulting Engineers, LLC (Entity),

the party who submitted a Statement of Qualifications (SOQ) to Provide Professional Surveying Services

on an As-Needed Basis (Briefly describe the services the SOQ will cover), to the Parish of Jefferson.

Affiant further said:

#### Campaign Contribution Disclosures

**(Choose A or B, if option A is indicated please include the required attachment):**

**Choice A**   X  

Attached hereto is a list of all campaign contributions, including the date and amount of each contribution, made to current or former elected officials of the Parish of Jefferson by Entity, Affiant, and/or officers, directors and owners, including employees, owning 25% or more of the Entity during the two-year period immediately preceding the date of this affidavit or the current term of the elected official, whichever is greater. Further, Entity, Affiant, and/or Entity Owners have not made any contributions to or in support of current or former members of the Jefferson Parish Council or the Jefferson Parish President through or in the name of another person or legal entity, either directly or indirectly.

**Choice B**       

there are **NO** campaign contributions made which would require disclosure under Choice A of this section.

Affiant further said:

Debt Disclosures

**(Choose A or B, if option A is indicated please include the required attachment):**

**Choice A** \_\_\_\_\_ Attached hereto is a list of all debts owed by the affiant to any elected or appointed official of the Parish of Jefferson, and any and all debts owed by any elected or appointed official of the Parish to the Affiant.

**Choice B**   X   There are **NO** debts which would require disclosure under Choice A of this section.

Affiant further said:

Solicitation of Campaign Contribution Disclosures

**(Choose A or B, if option A is indicated please include the required attachment):**

**Choice A** \_\_\_\_\_ Attached hereto is a list of all elected officials of the Parish of Jefferson, whether still holding office at the time of the affidavit or not, where the elected official, individually, either by **telephone or by personal contact**, solicited a campaign contribution or other monetary consideration from the Entity, including the Entity's officers, directors and owners, and employees owning twenty-five percent (25%) or more of the Entity, during the two-year period immediately preceding the date the affidavit is signed. Further, to the extent known to the Affiant, the date of any such solicitation is included on the attached list.

**Choice B**   X   there are **NO** solicitations for campaign contributions which would require disclosure under Choice A of this section.



Affiant further said:

Subcontractor Disclosures

**(Choose A or B, if option A is indicated please include the required attachment):**

**Choice A** \_\_\_\_\_ Affiant further said that attached is a listing of all subcontractors, excluding full time employees, who may assist in providing professional services for the aforementioned SOQ.

**Choice B**   <sup>x</sup>   There are **NO** subcontractors which would require disclosure under Choice A of this section.

Affiant further said:

That Affiant has employed no person, corporation, firm, association, or other organization, either directly or indirectly, to secure the public contract under which he received payment, other than persons regularly employed by the Affiant whose services in connection with the construction, alteration or demolition of the public building or project or in securing the public contract were in the regular course of their duties for Affiant; and

*[The remainder of this page is intentionally left blank.]*

That no part of the contract price received by Affiant was paid or will be paid to any person, corporation, firm, association, or other organization for soliciting the contract, other than the payment of their normal compensation to persons regularly employed by the Affiant whose services in connection with the construction, alteration or demolition of the public building or project were in the regular course of their duties for Affiant.



\_\_\_\_\_  
Signature of Affiant

\_\_\_\_\_  
Timothy P. Bonura, P.E.

\_\_\_\_\_  
Printed Name of Affiant

SWORN AND SUBSCRIBED TO BEFORE ME

ON THE 29 DAY OF April, 2021.



\_\_\_\_\_  
Notary Public

Stephen C Smith

\_\_\_\_\_  
Printed Name of Notary

21886

\_\_\_\_\_  
Notary/Bar Roll Number

My commission expires at death.

All South Consulting Engineers, LLC

Contributions made to elected official of Jefferson Parish

Name of Councilman	Contribution Amounts (list singly)	Date Contributed	Name of Councilman	Contribution Amounts (list singly)	Date Contributed
Scott Walker At Large – Division B	\$ 5000 \$ 1000	11/5/2019 11/12/2020	Deano Bonano District 2	\$ 500 \$ 1000 \$ 1000 \$ 2500 \$ 1000	4/4/2019 4/25/2019 8/8/2019 10/15/2019 2/20/2020
Marion Edwards District 1	\$ 2500	7/2/2019	Byron Lee District 3	\$ 2500 \$ 2500	10/24/2019 12/12/2019
Jennifer Van Vrancken District 5	\$ 1000 \$ 1000 \$ 500	6/24/2019 8/29/2019 3/4/2021	Dominick Impastato District 4	\$ 500 \$ 1000* \$ 500	04/01/2019 05/01/2019 9/4/2019
Ricky Templet At Large – Division A	\$ 1000 \$ 1000 * \$ 500 * \$ 1000	04/04/2019 04/24/2019 08/01/2019 03/17/2021	Cynthia Lee-Sheng Parish President	\$ 2500 \$ 500*	6/25/2019 6/28/2019
<p>*Denotes personal check from Timothy P. Bonura  ** Denotes personal check from Jens J. Nielsen, Jr.  *** Denotes personal check from Stephen C. Smith</p>					

4/13/21