

DATE: 3/01/2017

Page: 5

BID NO.: 50-00119043

BID FORM
Non Public Works

All Public Work Projects are required to use the Louisiana Uniform Public Work Bid Form

All prices must be held firm unless an escalation provision is requested in this bid. Jefferson Parish will allow one escalation during the term of the contract, which may not exceed the U.S. Bureau of Labor Statistics National Index for all Urban Consumers, unadjusted 12 month figure. The most recently published figure issued at the time an adjustment is requested will be used. A request must be made in writing by the vendor, and the escalation will only be applied to purchases made after the request is made.

Are you requesting an escalation provision?

YES _____ NO ☒

MAXIMUM ESCALATION PERCENTAGE REQUESTED _____ %

INITIAL BID PRICES WILL REMAIN FIRM THROUGH THE DATE OF _____

For the purposes of comparison of bids when an escalation provision is requested, Jefferson Parish will apply the maximum escalation percentage quoted by the bidder to the period to which it is applied in the bid. The initial price and the escalation will be used to calculate the total bid price. It will be assumed, for comparison of prices only, that an equal amount of material or labor is purchased each month throughout the entire contract.

DELIVERY: FOB JEFFERSON PARISH

INDICATE DELIVERY DATE ON EQUIPMENT AND SUPPLIES

2-3 weeks

LOUISIANA CONTRACTOR'S LICENSE NO.: (if applicable) _____

THIS SECTION MUST BE COMPLETED BY BIDDER:

FIRM NAME: GEAV Enterprise LLC
ADDRESS: 12292 Juliet Street
CITY, STATE: Gonzales, LA ZIP: 70737
TELEPHONE: (225) 571-3338 FAX: (225) 644-6566
EMAIL ADDRESS: Rogere.geaumentprise.com

In the event that addenda are issued with this bid, bidders MUST acknowledge all addenda on the bid form. Bidder must acknowledge receipt of an addendum on the bid form as indicated. Failure to acknowledge any addendum on the bid form will result in bid rejection.

Acknowledge Receipt of Addenda: NUMBER: n/a

NUMBER: _____

NUMBER: _____

NUMBER: _____

TOTAL PRICE OF ALL BID ITEMS: \$ 23,580.00AUTHORIZED SIGNATURE: R J GautreauTITLE: MemberRoger J. Gautreau
Printed Name

SIGNING INDICATES YOU HAVE READ AND COMPLY WITH THE INSTRUCTIONS AND CONDITIONS.

NOTE: All bids should be returned with the BID NUMBER and BID OPENING DATE indicated on the outside of the envelope submitted to the Purchasing Department.

INVITATION TO BID FROM JEFFERSON PARISH - continued

BID NO.: 50-00119043

SEALED BID

ITEM NUMBER	QUANTITY	U/M	DESCRIPTION OF ARTICLES	UNIT PRICE QUOTED	TOTALS
1	2.00	EA	PURCHASE OF HYPOCHLORITE AND SUBMERSIBLE PUMPS FOR THE SEWER PLANTS FOR THE JEFFERSON PARISH DEPARTMENT OF SEWERAGE <i>Zoeller F6125</i> 0010 - Hydromatic 4 inch Submersible Pumps, Model S4SD500M3-4, 5 H.P., 230/3/60, 1750 RPM, 20 Foot Cord, for Jefferson Parish Department of Sewerage Jonathan Davis Wastewater Treatment Plant NOTE: SEE ATTACHED SPECIFICATIONS	<i>3930⁰⁰</i>	<i>7860⁰⁰</i>
2	4.00	EA	<i>Zoeller F6125</i> 0020 - Hydromatic 4 inch Submersible Pumps, Model S4SD500M4-4, 5 H.P., 460/3/60, 1750 RPM, 20 Foot Cord, for Jefferson Parish Department of Sewerage Rosethorne Wastewater Treatment Plant	<i>3930⁰⁰</i>	<i>15720⁰⁰</i>
3	4.00	EA	0030 - Seepex Sodium Hypochlorite Progressive Cavity Pumps, Model MD025-12T, with Titanium Rotor Shaft Seal Casing Material and Driven by a 1/2 H.P., 115/1/60, AC Asynchronous Motor with Built in VFD, for Jefferson Parish Department of Sewerage Harvey Wastewater Treatment Plant	<i>No Bid</i>	<i>—</i>
Offering Alternates Zoeller Pump Per Listed Specs					
See Attached Zoeller Specifications Sheet					



MODELS 611 - 661

SPECIFICATION SHEET

3" & 4" FLANGED HORIZONTAL DISCHARGE UNITS



APPLICATIONS

- Pumping Station
- Storm Water Removal
- All Wastewater Removal
- Industrial Waste

SPECIFICATIONS

PUMP:

- Solids - 2½" spherical capability
- Discharge Size - 3" or 4" horizontal flanged
- Seals - dual mechanical carbon/rotary, ceramic/stationary, buna-n elastomers
- Construction - Cast Iron ASTM A-48, Class 30, 30,000# tensile strength, protected with a 2-part corrosion resistant powder coated epoxy finish.
- Attaching Hardware - 304 stainless steel
- "O" Ring Elastomers - Buna-N
- Ductile Iron Impeller - 2 blade semi-open with top pump out vanes
- Optional: ☐ Additional Cord Length _____
☐ Rail systems

MOTOR:

- 1 Phase - 230 Volt, 1725 RPM
- 3 Phase - 200/230/460/575 Volt, 1725 RPM
- 1 thru 7½ HP
- Stator - Class F insulation and lead wires
Nema B design
- Housing - Cast Iron, oil-filled
- Ball Bearings - Dual high carbon chromium steel
- Power Cable Length - 25'

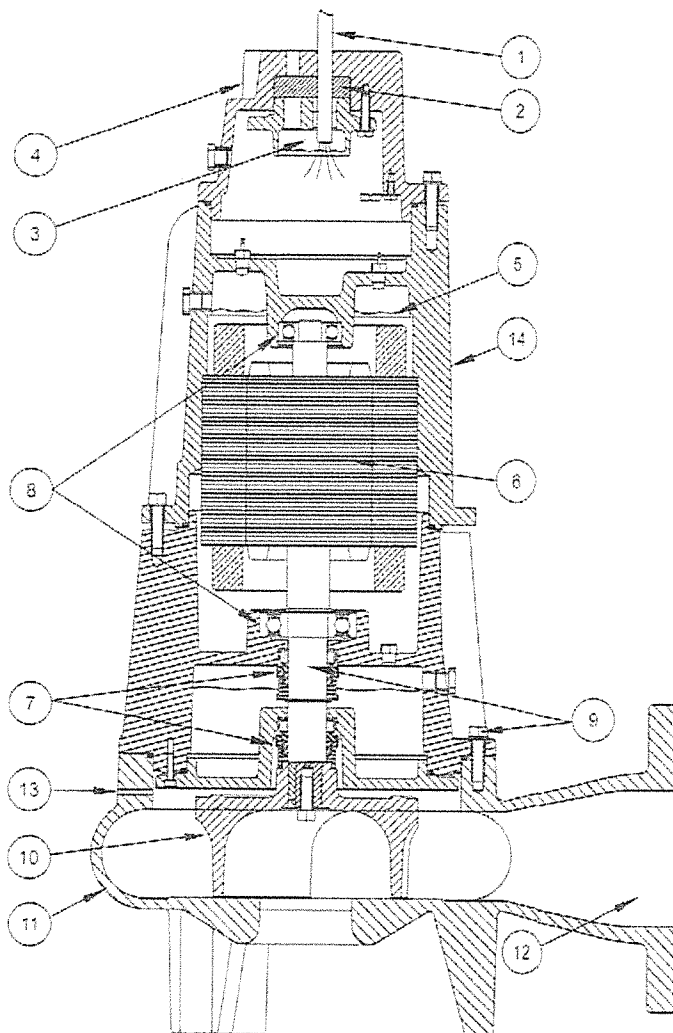

ZEP-04F2D

FEATURES

1. 25' of extra heavy duty power cable.
2. Heavy wall and clamps for protection of cable assemblies from chafing at cable entrance.
3. Protected cable entrance. The compression grommet allows for field replacement of the cable and each conductor is individually sealed to eliminate cord wicking of liquids.
4. Lifting lugs integral part of housing (not shown).
5. Oil-filled motor housing assures uniform heat distribution, lubricates bearings, and conducts heat for cooler running.
6. Heavy duty motor features ball bearing construction. Class F motor insulation is double dipped and baked. End connections and lead wires are Class F. At maximum load, winding temperature will not exceed 250° with motor housing not submerged.
7. Dual independent seals. Carbon/rotating, ceramic/stationary, buna-n elastomers.
8. Upper and lower high carbon chromium steel ball bearings.
9. Stainless steel shaft and hardware resists corrosion.

10. Balanced 2 vane semi-open impeller with top pump out vanes for seal protection keyed and bolted to shaft.
11. Concentric case reduces radial loading for longer bearing and seal life.
12. 3" and 4" flanged horizontal discharge available.
13. Vent hole helps prevent air locking.
14. Entire unit protected with a corrosion resistant powder coated epoxy finish.

For additional information on Models 611 thru 661 series pumps, refer to catalog on Performance and Dimensional data, FM1591; Guide Specifications, FM1020; Owners Manual, FM1798; Replacement Parts List and Service Manual, FM1799.

For information on additional Zoeller products refer to catalog on Variable Control Switches, FM0526; Electrical Alternator, FM0486; Sump/Sewage Basins, FM0487; Alarm System, FM0732; Simplex Controls, FM1696; Rail Systems, FM0787; and Junction Boxes FM1697.

CORPORATE RESOLUTION

EXCERPT FROM MINUTES OF MEETING OF THE BOARD OF DIRECTORS OF
GEAU Enterprise, LLC
INCORPORATED.

AT THE MEETING OF DIRECTORS OF GEAU Enterprise, LLC
INCORPORATED, DULY NOTICED AND HELD ON January 6, 2017.
A QUORUM BEING THERE PRESENT, ON MOTION DULY MADE AND SECONDED. IT
WAS:

RESOLVED THAT Roger Gautreau, BE AND IS HEREBY
APPOINTED, CONSTITUTED AND DESIGNATED AS AGENT AND ATTORNEY-IN-
FACT OF THE CORPORATION WITH FULL POWER AND AUTHORITY TO ACT ON
BEHALF OF THIS CORPORATION IN ALL NEGOTIATIONS, BIDDING, CONCERNS
AND TRANSACTIONS WITH THE PARISH OF JEFFERSON OR ANY OF ITS AGENCIES,
DEPARTMENTS, EMPLOYEES OR AGENTS, INCLUDING BUT NOT LIMITED TO, THE
EXECUTION OF ALL BIDS, PAPERS, DOCUMENTS, AFFIDAVITS, BONDS, SURETIES,
CONTRACTS AND ACTS AND TO RECEIVE ALL PURCHASE ORDERS AND NOTICES
ISSUED PURSUANT TO THE PROVISIONS OF ANY SUCH BID OR CONTRACT, THIS
CORPORATION HEREBY RATIFYING, APPROVING, CONFIRMING, AND ACCEPTING
EACH AND EVERY SUCH ACT PERFORMED BY SAID AGENT AND ATTORNEY-IN-
FACT.

I HEREBY CERTIFY THE FOREGOING TO BE
A TRUE AND CORRECT COPY OF AN
EXCERPT OF THE MINUTES OF THE ABOVE
DATED MEETING OF THE BOARD OF
DIRECTORS OF SAID CORPORATION, AND
THE SAME HAS NOT BEEN REVOKED OR
RESCINDED.

Sharon Gautreau
SECRETARY-TREASURER

3-14-2017
DATE

Sworn to and subscribed
before, me Notary this
14th day of March 2017
Anita D. Amedee
Anita D. Amedee #264

Non-Public Works Bid

AFFIDAVIT

STATE OF Louisiana

PARISH/COUNTY OF Ascension

BEFORE ME, the undersigned authority, personally came and appeared: _____

Roger Gautreau, (Affiant) who after being by me duly sworn, deposed and said that he/she is the fully authorized member of GEAU Enterprise (Entity), the party who submitted a bid in response to Bid Number 50-00119043, to the Parish of Jefferson.

Affiant further said:

Campaign Contribution Disclosures

(Choose A or B, if option A is indicated please include the required attachment):

Choice A _____ Attached hereto is a list of all campaign contributions, including the date and amount of each contribution, made to current or former elected officials of the Parish of Jefferson by Entity, Affiant, and/or officers, directors and owners, including employees, owning 25% or more of the Entity during the two-year period immediately preceding the date of this affidavit or the current term of the elected official, whichever is greater. Further, Entity, Affiant, and/or Entity Owners have not made any contributions to or in support of current or former members of the Jefferson Parish Council or the Jefferson Parish President through or in the name of another person or legal entity, either directly or indirectly.

Choice B ✓ there are NO campaign contributions made which would require disclosure under Choice A of this section.

Debt Disclosures

(Choose A or B, if option A is indicated please include the required attachment):

Choice A _____ Attached hereto is a list of all debts owed by the affiant to any elected or appointed official of the Parish of Jefferson, and any and all debts owed by any elected or appointed official of the Parish to the Affiant.

Choice B ☒ There are NO debts which would require disclosure under Choice A of this section.

Affiant further said:

That Affiant has employed no person, corporation, firm, association, or other organization, either directly or indirectly, to secure the public contract under which he received payment, other than persons regularly employed by the Affiant whose services in connection with the construction, alteration or demolition of the public building or project or in securing the public contract were in the regular course of their duties for Affiant; and

[The remainder of this page is intentionally left blank.]

That no part of the contract price received by Affiant was paid or will be paid to any person, corporation, firm, association, or other organization for soliciting the contract, other than the payment of their normal compensation to persons regularly employed by the Affiant whose services in connection with the construction, alteration or demolition of the public building or project were in the regular course of their duties for Affiant.

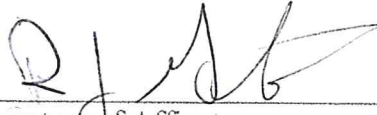

Signature of Affiant

Roger J. Gautreau

Printed Name of Affiant

SWORN AND SUBSCRIBED TO BEFORE ME

ON THE 15th DAY OF March, 2017.

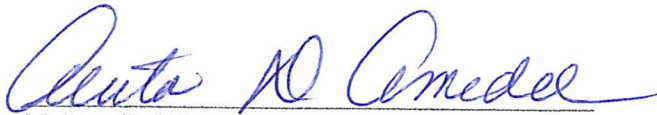

Notary Public

Anita D. Amedee

Printed Name of Notary

264

Notary/Bar Roll Number

My commission expires at death

[Print](#)

Notary Search - Detail

Name: MS. ANITA D. AMEDEE
Address: 12443 COON TRAP RD
GONZALES, LA 70737-6362

Phone: (225) 647-4521
Phone 2: (225) 907-7132

Notary ID Number: 264

Parish: ASCENSION with authority in the following parishes:
EAST BATON ROUGE, EAST FELICIANA, IBERVILLE, LIVINGSTON, POINTE COUPEE, WEST BATON ROUGE, WEST FELICIANA

Agency: N/A

Notary Type: Non Attorney

Status: Active

Commission Date: 03/04/1985

Oath Date: 03/07/1985

Surety Expiration Date: 02/20/2021

Annual Report Current: Yes

Notary Events

Suspension From: 02/22/2016 To: 02/25/2016

Suspension From: 05/05/2014 To: 05/06/2014

Suspension From: 05/06/2013 To: 05/09/2013

Deceased, Inactivated, Leave of Absence, Pre-Assessment Registration, Pre-Assessment Taken, Resigned, Retirement, and Revoked events are not available prior to February 11, 2012.

[Back to Search Results](#)[New Search](#)

Username

Password

[Log In](#)[Forgot Username?](#)[Forgot Password?](#)[Create an Account](#)

Entity Dashboard

[Entity Overview](#)[Entity Registration](#)

- ▶ [Core Data](#)
- ▶ [Assertions](#)
- ▶ [Reps & Certs](#)
- ▶ [POCs](#)

[Exclusions](#)

- ▶ [Active Exclusions](#)
- ▶ [Inactive Exclusions](#)
- ▶ [Excluded Family Members](#)

[RETURN TO SEARCH](#)

GEAU ENTERPRISE LLC

DUNS: 003863766 CAGE Code: 790X5

Status: Expired

Expiration Date: 10/27/2015

Purpose of Registration: All Awards

12292 JULIET ST

GONZALES, LA, 70737-6598 ,

UNITED STATES

Entity Overview

Entity Registration Summary

Name: GEAU ENTERPRISE LLC
Business Type: Business or Organization
Last Updated By: Roger Gautreau
Registration Status: Expired
Activation Date: 10/29/2014
Expired On: 10/27/2015

Exclusion Summary

Active Exclusion Records? No



IBM v1.P.62.20170224-1621

WWW1

[Search Records](#)
[Data Access](#)
[Check Status](#)
[About](#)
[Help](#)

[Disclaimers](#)
[Accessibility](#)
[Privacy Policy](#)

[FAPIS.gov](#)
[GSA.gov/IAE](#)
[GSA.gov](#)
[USA.gov](#)

#285515

Form W-9
Rev. December 2011
Department of the Treasury
Internal Revenue Service

Request for Taxpayer Identification Number and Certification

Give Form to the requester. Do not send to the IRS.

Name (as shown on your income tax return)
GEAU Enterprise, LLC
Business name disregarded entity name, if different from above

Check appropriate line for federal tax classification:
☐ Individual sole proprietor ☐ Corporation ☐ S Corporation ☐ Partnership ☐ Trust/estate
☒ Limited liability company. Enter the tax classification (S, C, corporation, trust, partnership, etc.) **LLC** ☐ Cannot provide

Address (provide street and apt. or suite no.)
12292 Juliet Street
City, state and ZIP code
Gonzales, Louisiana 70137
Enter amount number(s) here (optional)

Requester's name and address (optional)

Part I Taxpayer Identification Number (TIN)
Enter your TIN in the appropriate box. The TIN provided must match the name given on the "Name" line to avoid backup withholding. For individuals, this is your social security number (SSN). However, for a resident alien, sole proprietor, or disregarded entity, see the Part I instructions on page 3. For other entities, it is your employer identification number (EIN). If you do not have a number, see *How to get a TIN* on page 3.
 Social security number
 Employer identification number
 7 4 - 3 1 2 1 2 8 9

Part II Certification
Under penalties of perjury, I certify that:
 1. The number shown on this form is my correct taxpayer identification number (or I am waiting for a number to be issued to me); and
 2. I am not subject to backup withholding because: (a) I am exempt from backup withholding, or (b) I have not been notified by the Internal Revenue Service (IRS) that I am subject to backup withholding as a result of a failure to report all interest or dividends, or (c) the IRS has notified me that I am no longer subject to backup withholding; and
 3. I am a U.S. citizen or other U.S. person (defined below).
Certification instructions. You must cross out item 2 above if you have been notified by the IRS that you are currently subject to backup withholding because you have failed to report all interest and dividends on your tax return. For real estate transactions, item 2 does not apply. For mortgage interest paid, acquisition or abandonment of secured property, cancellation of debt, contribution to an individual retirement arrangement (IRA), and generally payments other than interest and dividends, you are not required to sign this certification, but you must provide your correct TIN. See the instructions on page 4.
 Sign Here Signature of U.S. person *[Signature]*
 Date **1-4-12**

General Instructions
Section references are to the Internal Revenue Code unless otherwise noted.

Purpose of Form
A person who is required to file an information return with the IRS must obtain your correct taxpayer identification number (TIN) to report, for example, income paid to you, real estate transactions, mortgage interest you paid, acquisition or abandonment of secured property, cancellation of debt or contributions you made to an IRA.
 Use Form W-9 only if you are a U.S. person (including a resident alien) to provide your correct TIN to the person requesting it (the requester) and, when applicable, to:
 1. Certify that the TIN you are giving is correct (or you are waiting for a number to be issued).
 2. Certify that you are not subject to backup withholding, or
 3. Claim exemption from backup withholding if you are a U.S. exempt payee. If applicable, you are also certifying that as a U.S. person, your allocable share of any partnership income from a U.S. trade or business is not subject to the withholding tax on foreign partners' share of effectively connected income.

Definition of a U.S. person. For federal tax purposes, you are considered a U.S. person if you are:
 • An individual who is a U.S. citizen or U.S. resident alien.
 • A partnership, corporation, company, or association created or organized in the United States or under the laws of the United States.
 • An estate (other than a foreign estate), or
 • A domestic trust (as defined in Regulations section 301.7701-7).
Special rules for partnerships. Partnerships that conduct a trade or business in the United States are generally required to pay a withholding tax on any foreign partners' share of income from such business. Further, in certain cases where a Form W-9 has not been received, a partnership is required to presume that a partner is a foreign person and pay the withholding tax. Therefore, if you are a U.S. person that is a partner in a partnership conducting a trade or business in the United States, provide Form W-9 to the partnership to establish your U.S. status and avoid withholding on your share of partnership income.