

Alphalite

PROJECT NAME

CATALOG NO.

TYPE

DATE

NOTE

LED Outdoor Non-Cutoff and Semi-Cutoff Wall Pack

WPTA Series

Outdoor Luminaire Series

DESCRIPTION

The Alpha Series LED Traditional wall pack is a integrated LED solution that delivers long life and energy savings. The rugged housing offers advanced thermal management and protection against outdoor environments without compromising aesthetics.

APPLICATION

Outdoor wall-mount applications. Building facade. Commercial, industrial, retail, hospitality buildings that demand long service life and low maintenance.

SPECIFICATION FEATURES

Construction

Rugged die-cast aluminum housing withstands outdoor environments. Outer surface treated with durable powder coating to provide resistance to corrosion, rust, weathering, and UV degradation. Performance-engineered, integral heat dissipation fins provides superior thermal management for long life and reliability. Housing and optics maintain IP65 rating with all internal components including optional integrated sensor.

Mounting

Luminaire mounting designed for standard J-Box. Can be mounted directly to surface. Features multiple conduit entries.

Optics

Glass lenses provide various photometric distributions depending on application. LED lenses optimize performance and increase delivered light to desired areas.



Electrical

Luminaire utilizes long life, high efficacy LEDs and a highly efficient, reliable LED driver. 120V-277V input voltage for increased versatility. For higher lumen, high mounting height models, dimming option available. Comes equipped with quick disconnect for compliance with US code. 0-10V dimming comes standard.

Finish

Outer surface treated with durable powder coating to provide resistance to corrosion, rust, weathering, and UV degradation.

Certifications / Regulatory

UL listed. DLC QPL listed. All components have safety approvals.

Warranty

7-year limited warranty. See complete warranty terms for details.

Quick Ship Product

WPTA-P240/850
WPTA-P260/850
WPTA-P280/850

ORDERING INFORMATION

Sample Number: WPTA-P280/850

WPTA	P280	850	(Blank)	(Blank)	(Blank)
Series	Lumen Package	CCT	Input Voltage	Beam Angle	Finish Color
WPTA - LED	P240 - 40W	840 - 4000K	(Blank) - 120V-277V	(Blank) - Type III	(Blank) - Dark Bronze
Traditional Wall Pack	P260 - 60W	850 - 5000K			
	P280 - 80W				
	P2100 - 100W				
	P2120 - 120W				
	*See energy data for details				

Options

Accessory

DSS - Dark Sky Shield
PC - Photocell



Specifications and dimensions subject to change without notice.

10715 Springdale Ave, Ste 4, Santa Fe Springs, CA 90670

Tel: 888.287.9228

Fax: 888.258.9183

www.alphalite.com

SUMMARY

Input Voltage	100V-277V
Input Power	See energy data for details
Power Factor	> 0.95
THD (Max.)	20%
Efficacy	> 140 LPW
Delivered Lumens	See energy data for details
Controls/ Dimming	0-10V dimming option available.
CRI	> 80
CCT	4000K, 5000K
Operating Temp.	-22°F ~ 104°F (-30°C ~ +40°C)
Rated Life	50,000 hours
IP Grade	IP65

ENERGY PERFORMANCE DATA

Part No.	Rated Wattage (W)	Delivered Lumens (lm)	Efficacy (lm/W)
WPTA-P240/840	40	5983	142
WPTA-P240/850		6029	146
WPTA-P260/840	60	9149	144
WPTA-P260/850		9252	146
WPTA-P280/840	80	11567	145
WPTA-P280/850		11637	146
WPTA-P2100/840	100	14657	147
WPTA-P2100/850		14664	148
WPTA-P2120/840	120	17363	145
WPTA-P2120/850		17673	147

DARK SKY SHIELD

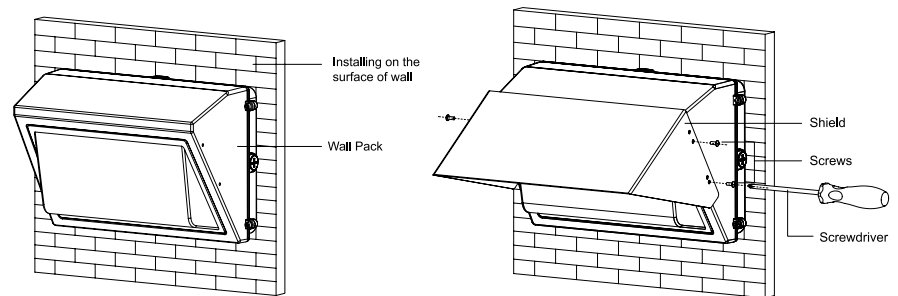

PHYSICAL PARAMETERS

DIMENSION

