

Statement of Qualifications

SOQ No. 24-036

Miscellaneous Architecture and Engineering Services on an As-Needed Basis

Jefferson Parish Government

Resolution No. 145324



A Joint Venture Between:



PRINCIPAL Infrastructure®

Architecture ♦ Engineering ♦ Construction



Architecture

♦ Engineering

♦ Construction

December 19, 2024

Jefferson Parish Government
Procurement Department
200 Derbigny St., Suite 4400
Gretna, LA 70053

RE: SOQ No. 24-036 – Miscellaneous Architecture and Engineering Services on an As-Needed Basis
Resolution No. 145324

Dear Sir or Madam,

Principal Infrastructure – A/E/C, LLC is pleased to submit our Statement of Qualifications to Jefferson Parish Government in consideration for a contract to perform Architectural & Engineering Services.

Principal Infrastructure – A/E/C, LLC is a Joint Venture between Principal Engineering, Inc. (**LAPELS No. 3168**) and Hardy & Associates/Architect, PLLC (**Architect Board Firm License No. AF0581**). Principal Engineering and Hardy & Associates have a ten-year relationship working together as a team on various federal and local A/E design and construction management projects.

We are a federal verified *Service-Disabled Veteran Owned Small Business (SDVOSB)* with an exceptionally qualified team of professionals capable of providing consulting A/E services.

We look forward to the opportunity to serve Jefferson Parish Government by providing quality A/E design & consulting services for facility improvement projects under the Parish's jurisdiction. If you have any questions or require additional information, please contact me at the number above.

Sincerely,
PRINCIPAL Infrastructure

A handwritten signature in blue ink that reads 'Henry I. DiFranco, Jr.'.

Henry I. DiFranco, Jr. PE
President



Principal Engineering, Inc.
128 Northpark Blvd.
Covington, LA 70433

Hardy & Associates Architect, PLLC
15260 Big John Road, Suite A
Biloxi, MS 39532

TEC Professional Services Questionnaire

A. Project Name and Advertisement Resolution Number:

SOQ NO 24-036 – Miscellaneous Architectural and Engineering Services on an As-Needed Basis
Resolution No. 145324

B. Firm Name & Address:



Principal Infrastructure - A/E/C, LLC (Joint-Venture)
Principal Engineering, Inc. (LAPELS #3168)
Hardy & Associates/Architect, PLLC (LSBAE #AF0581)
128 Northpark Blvd.
Covington, LA 70433

C. Name, title and contact information of Principal who is a licensed, registered architect or a professional engineer in the State of Louisiana.

Henry I. DiFranco, Jr., PE
President
128 Northpark Blvd.
Covington, LA 70433
(985) 624-5001 | henry@pi-aec.com

D. Name and contact information of professional in charge of the Project who is a licensed, registered architect in the State of Louisiana with a minimum of five (5) years' experience.

Marion "Marty" Hardy, AIA
LA Licensed Architect #7077
15260 Big John Road, Suite A
Biloxi, MS 39532
(228) 215-1851 | marty@hardyarchitect.com

E. Please provide the number of employees whose primary function corresponds with each category:

<u>2</u> Administrative	<u> </u> Estimators	<u> </u> Specification Writers
<u>2</u> Architects (Licensed)	<u> </u> Geologists	<u>1</u> Structural Engineers
<u> </u> Chemical Engineers	<u> </u> Geotechnical Engineers	<u> </u> Graduate Engineers
<u>3</u> Civil Engineers	<u>1</u> Interior Designers	<u>4</u> Project Managers
<u>5</u> Construction Inspectors	<u> </u> Landscape Architects	<u>1</u> Clerical
<u> </u> Ecologists	<u> </u> Land Surveyor	<u> </u> Grant/Funding Specialist
<u>1</u> Electrical Engineers	<u> </u> Mechanical Engineers	<u> </u> Sanitary Engineers
<u>2</u> Engineer Intern	<u> </u> Environmental Engineers	
<u> </u> Professional Land Surveyors	<u>4</u> Other (Planners, Tech Support)	<u>26</u> TOTAL

F. Is this submittal by a JOINT-VENTURE? Please check: YES X NO

If marked "No" skip to Section I. If marked "yes" complete Sections G-H.

TEC Professional Services Questionnaire

G. If submittal is by JOINT-VENTURE, list the firms participating and outline specific areas of responsibility (including administrative, technical, and financial) for each firm. Please attach additional pages if necessary.

1. Principal Engineering, Inc. – Lead/Majority Firm of the JV - A/E Design, A/E CAD, Administrative, Financial, Technical and Construction Administration

2. Hardy & Associates/Architect, PLLC – Architectural and Interior Design, Architectural CAD

H. Has this JOINT-VENTURE previously worked together? Please check:
YES ☒ NO ☐

I. List all subcontractors anticipated for this Project. Please note that all subcontractors must submit a fully completed copy of this questionnaire, applicable licenses, and any other information required by the advertisement. See Jefferson Parish Code of Ordinances, Sec. 2-928(a)(3). Please attach additional pages if necessary.

Name & Address:	Specialty:	Worked with Firm Before (Yes or No):
N/A		

J. Please specify the total number of support personnel that may assist in the completion of this Project:

26

TEC Professional Services Questionnaire

K. List the professional in charge, key persons, specialists, and individual consultants anticipated for this Project and provide their relevant information below. If necessary, please attach additional documentation (i.e. resume) that demonstrates the employment history and experience of the Firm's key persons that may assist in the completion of this Project. Please attach additional pages if necessary.

PROFESSIONAL IN CHARGE OF PROJECT:

Name & Title:

Marion "Marty" A. Hardy, Architect

Project Assignment:

Principal Architect - Professional In Charge/Project Manager – Meets the Minimum Requirement #2-, "A professional in charge of the Project who is a licensed, registered architect in the State of Louisiana with a minimum of five (5) years' experience in the disciplines involved

Name of Firm with which associated:



Years' experience with this Firm:

15

Education: Degree(s)/Year/Specialization:

Architecture, Bachelor of Science, 1995

Active registration: Year first registered/discipline:

8/2006 LA, Architect #7077 - MS, Architect #4060 - AL, Architect #6568 - TX, Architect #26345

Other experience and qualifications relevant to the proposed Project:

Member of: American Institute of Architects (AIA) - Member National Council of Architectural Registration Boards (NCARB) - Member of Mississippi Hospital Engineers Association

GRH Radiology Relocation / Consolidation George Regional Hospital - Lucedale, MS

Relocation of X-ray, fluoro, nuclear med, MRI, CT and mammography to a central location between the ER and patient wings and support spaces. Provided full A/E services 5,787 sf COST: \$2.2M (no equip)

OSH Interventional Radiology / Angio Renovation Ocean Springs Hospital – Ocean Springs, MS

New Interventional Radiology Room, Equipment Room, Control Room, Slobin area, entry vestibule, storage and UPS room. Provided Full A/E services. 1,250 sf COST: 675,000 (no equipment or UPS)

TEC Professional Services Questionnaire

Marty Hardy continued....

YGH 2nd Floor Addition for Gero-psych Unit Yalobusha General Hospital – Water Valley, MS

Addition of a 2nd floor on an existing one-story building. Existing structure was enhanced with carbon fiber wraps and surfaces to allow for the second floor to be added to house a new geropsych unit, elevators, stairs and support spaces. Provided Full A/E services 7,565 sf COST: \$5,850,000

SRH Central Sterile Renovation Singing River Hospital, Pascagoula, MS

Complete renovation of existing central sterile to reorganize the flow and ergonomics of the space, including decontamination, washers, sterile process, Auto claves, sterile storage, offices, general storage and restrooms. 5,975 sf COST: \$2,450,000

OSH MRI Renovation Ocean Springs Hospital - Ocean Springs, MS

Replace existing MRI equipment, equipment room, shielding, control room and dressing room. Upgrade to meet ADA. Provided full A/E 1,050 sf COST: \$425,000

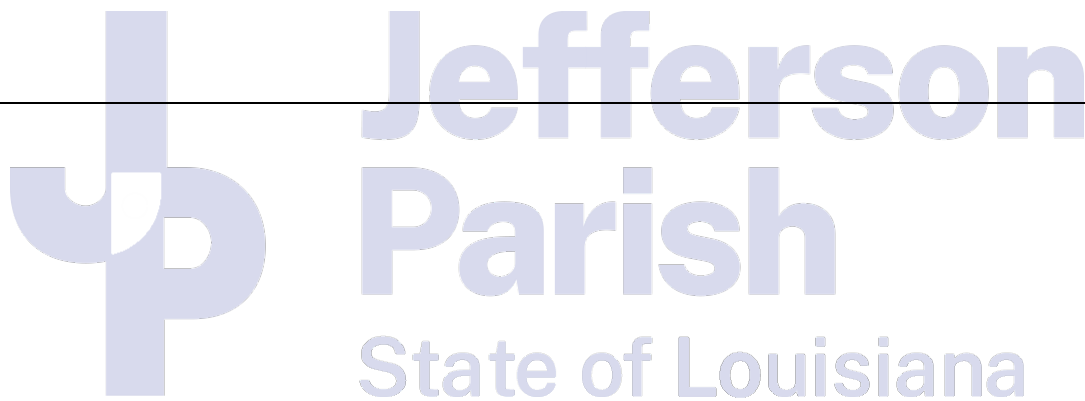

TEC Professional Services Questionnaire

KEY PERSON, SPECIALIST, OR INDIVIDUAL CONSULTANT:
Name & Title:
Henry I. DiFranco, P.E. President
Project Assignment:
Contract and Project Manager Principal Engineer
Name of Firm with which associated:

Years' experience with this Firm:
20
Education: Degree(s)/Year/Specialization:
Bachelor of Science in Civil Engineering (BSCE), 1991 Master of Business Administration (MBA), 1998
Active registration: Year first registered/discipline:
Active Registration: 1997 Branch: Civil License No.: 27448
Other experience and qualifications relevant to the proposed Project:
<p>Mr. DiFranco has extensive experience in Public Works engineering and management serving as the Director of Public Works & Utilities for St. John Parish and holding numerous positions as a public works engineer and consulting engineer over his 33-year career. Mr. DiFranco is a graduate of Air War College, Air Command & Staff College, and Squadron Officer School.</p> <p>A retired Lt. Colonel in the Air Force Reserves, Mr. DiFranco deployed to Baghdad, Iraq in support of OPERATION IRAQI FREEDOM. As a civil engineering officer, he was responsible for approximately \$15 million dollars of infrastructure improvements in and around the Baghdad area and was assigned to the Air Force Civil Engineering Center where he supported Air Force Civil Engineering worldwide.</p>

TEC Professional Services Questionnaire

Henry DiFranco continued...

Civilian Experience:

LA DOTD - Civil Engineer Intern - 1991 to 1994
Consulting Civil Engineer - 1994 to 1997
Public Works Engineer - 1997 to 2000
Public Works & Utilities Director - 2000 to 2004
Vice-President of Consulting Firm - 2005 to 2008
President of Principal Engineering, Inc. - 2004 to Present

Military Experience:

LA ARNG- Heavy Equip. Operator – Sgt - 1986 to 1990
LA ARNG- Civil Engineer - 1st LT - 1990 to 1994
LA Air National Guard - Civil Engineer - Capt - 1999 to 2005
Veteran of Operation of Noble Eagle - 2001 to 2002
Veteran of Operation Iraqi Freedom - 2003 to 2004
Air Force Civil Engineer Center - Major - 2005 to 2014
Air Force Reserve Civil Engineer - Lt. Col- 2014-2022

As president of Principal Engineering, Inc., Mr. DiFranco is responsible for all daily operations, ensuring the highest quality product is delivered on time and within the established budget. As the Principal-in-Charge, Mr. DiFranco provided planning, design guidance and quality assurance/final design review for the following relevant projects:

Renovate Pathology, 2E/2N, OBVAMC Shreveport, LA, Project No. 667-16-103 – Contract No. VA256-16-C-0127

Owner: *Department of Veterans Affairs*

Mr. DiFranco performed contract management and QA/QC for this project to renovate the existing Inpatient Wards on 6-West, 7-West and 8-West (approximately 31,000 GSF). Cost \$4M.

East Bank Sign Shop ADA Compliance Renovation

Owner: *Jefferson Parish Government, La.*

Mr. DiFranco was in charge of the design of the reconstruction of male and female restrooms for ADA compliance.

Cleary & Bright Playground Gym Renovation

Owner: *Jefferson Parish Parks & Recreation, La.*

Mr. DiFranco was in charge of the design of renovating the interior of both gyms, replacing the roof at Bright and performing other misc. repairs and improvements.

Girard Park Playground & Pressbox Renovation

Owner: *Jefferson Parish Parks & Recreation, La.*

Mr. DiFranco was in charge of the design of renovating the concession area, pressbox area, provision of sidewalk access to the baseball dugouts, modification of the site for ADA compliance, fencing replacement, a water fountain replacement, and supporting accessory items of work.

Live Oak New Kindergarten Classroom Building & Covered Gym/Play Area

Owner: *Jefferson Parish Public School System, La.*

Mr. DiFranco was in charge of the design of a new 5,000 square foot, two classroom kindergarten building and a new 4,500 square foot covered play area/gymnasium.

TEC Professional Services Questionnaire

KEY PERSON, SPECIALIST, OR INDIVIDUAL CONSULTANT:
Name & Title:
Andre C. Monnot, P.E. Vice President
Project Assignment:
Project Manager
Name of Firm with which associated:

Years' experience with this Firm:
13
Education: Degree(s)/Year/Specialization:
Bachelor of Science in Civil Engineering (BSCE), 2002
Active registration: Year first registered/discipline:
Active Registration: 2007 Branch: Civil License No.: 33626
Other experience and qualifications relevant to the proposed Project:
<p>Mr. Monnot has a diverse range of engineering and management experience in both the public sector as a military engineer and as a private consultant. He was deployed in support of Operation Iraqi Freedom, during which time he was the Chief Maintenance Engineer for the installation. He led construction on several emergency power projects, completed a comprehensive mapping and inventory of the base's roadway and drainage systems, and managed \$5 million in service contracts for garbage collection, custodial services, and potable water delivery. Since 2000, in the military and as a consultant, Mr. Monnot has designed an array of projects encompassing water, wastewater, roadway, drainage, structural, and airfield paving. This included preparation of engineering calculations, drawings, technical specifications, and contract documents; and managing personnel and costs related to the projects.</p> <p>Andre Monnot will interface with Jefferson Parish on the overall direction and major project decisions; advise JP of key planning, design, or construction decisions that may have cost, schedule, health, safety, or operational implications; oversee project progress and provide direction and support to the project team; and be responsible for the day-to-day correspondence, schedule, budget development, progress assessment, risk management, quality management, and reporting.</p>

TEC Professional Services Questionnaire

Andre Monnot continued...

Mr. Monnot has been the Project Manager for the following relevant projects:

East Bank Sign Shop ADA Compliance Renovation

Owner: *Jefferson Parish Government, LA*

Mr. Monnot was the project manager for the design of the reconstruction of male and female restrooms for ADA compliance.

Cleary & Bright Playground Gym Renovation

Owner: *Jefferson Parish Parks & Recreation, LA*

Mr. Monnot. Is the project manager for the design of renovating the interior of both gyms, replacing the roof at Bright and performing other misc. repairs and improvements.

Girard Park Playground & Press-Box Renovation

Owner: *Jefferson Parish Parks & Recreation, LA*

Mr. Monnot is the project manager for the design of renovating the concession area, pressbox area, provision of sidewalk access to the baseball dugouts, modification of the site for ADA compliance, fencing replacement, a water fountain replacement, and supporting accessory items of work.

CWU Access and Enhancement Project (Welcome Center and Boat Rental Shop)

Owner: *St. Bernard Parish, LA*

Mr. Monnot is the project manager of the plan and execution of architectural and engineering services for Phase I which consists of access road, boat house, welcome center, various wooden piers and lookout decks.

Cath Lab Expansion, 6E, OBVAMC, Shreveport, LA, Project No. 667-15-104 – Cont. No. VA256-16-C-0130

Owner: *Department of Veterans Affairs*

Mr. Monnot provided structural engineering design to renovate and expand the existing Cath Lab services, located on the sixth floor, east wing (6E), within the main hospital, building 1, Overton Brooks Medical Center, Shreveport, LA. The area is 8,230 square feet. Estimated Cost: \$3.1M

Emergency Room Renovations and Structural Foundation Replacement, GCVHCS, Biloxi, MS, Project No. 520-16-102 – Contract No. 36C25618R0759

Owner: *Department of Veterans Affairs*

Mr. Monnot was the PM on this effort to perform an investigation/evaluation of the ER slab foundation settlement issue and developing alternative options to fix and prevent future settlement. Principal prepared a report of findings with alternative options and cost estimates and will do a presentation to the VA staff with the recommendation. The project also includes the complete renovation of the Hospital Emergency Room. Estimated Cost: \$4.0M

TEC Professional Services Questionnaire

KEY PERSON, SPECIALIST, OR INDIVIDUAL CONSULTANT:

Name & Title:

Jaime Locknane, Architect

Project Assignment:

Professional Architect

Name of Firm with which associated:**Years' experience with this Firm:**

12 Years

Education: Degree(s)/Year/Specialization:

Bachelor of Science in Architecture, Mississippi State University, 2001

Active registration: Year first registered/discipline:

Mississippi, Architect #5293

Other experience and qualifications relevant to the proposed Project:

For the past 25 years, Jaime has worked closely with her clients to deliver them what they are looking for while following Code and staying within budget. Jaime is proficient in Revit and produces renderings for our clients.

Member National Council of Architectural Registration Boards – NCARB

St. Bernard Parish Fire Station #10 | St. Bernard Parish, LA

Provided full A/E service for new fire station. 3 stories encompassing 4 truck bays, lockers, training room, full sleeping & living quarters and a lookout tower. This station can also serve as a command center during states of emergency. Jaime provided renderings for this project.

Singing River Healthcare Academy – Training Center | Ocean Springs, MS

Hardy & Associates provided full A/E services. Total square footage is 48,000 Construction Cost \$12,369,000. Renderings were provided by Jaime.

TEC Professional Services Questionnaire

Ms. Locknane Continued...

Tomaston Ambulatory Surgery Center | Biloxi, MS

Hardy & Associates provided full A/E Services. This is a 2-story building and will include 2 operating rooms, 8 exam rooms, and 12,000 sf of additional leasable space. Renderings provided by Jaime.
28,000 S.F. Construction Budgeted at \$11,000,000

Creekbend K-8 School | D'Iberville, MS

Hardy & Associates provided full A/E Services. This school will accommodate 1300 students and can be expanded to accommodate 2,000 students. Includes 2 gyms, a band hall, cafetorium, media center and 52 classrooms. 136,000 S.F. Construction Cost \$29,585,366

Treasure Bay Casino – Master Planning | Biloxi, MS

Hardy & Associates provided full A/E Services. Jaime is involved in all aspects of this project. This is a 15-parcel master plan incorporating various building types. Jaime also provided renderings and presentation materials for this project.

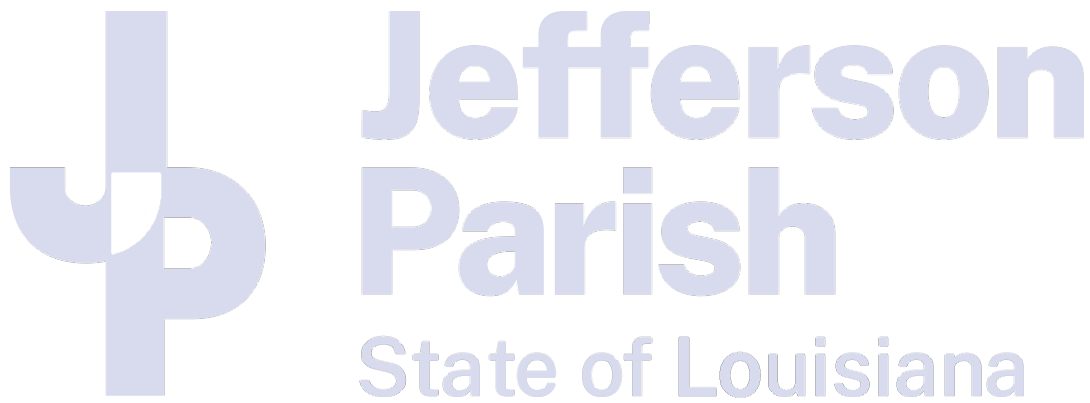

TEC Professional Services Questionnaire

KEY PERSON, SPECIALIST, OR INDIVIDUAL CONSULTANT:

Name & Title:

Rick House, Project Manager

Project Assignment:

Professional Architectural and Engineering Services on an as-needed basis for architectural type projects located throughout the Parish for an approximate two-year period.

Name of Firm with which associated:**Years' experience with this Firm:**

13 Years

Education: Degree(s)/Year/Specialization:

Bachelor of Architecture, Drury University, 1997

Active registration: Year first registered/discipline:

N/A

Other experience and qualifications relevant to the proposed Project:

OBVAMC – Renovate Pathology 2E – 2N – Department of Veterans Affairs, Shreveport, LA

OBVAMC - Cath Lab Expansion 6E – Department of Veterans Affairs, Shreveport, LA

D'Iberville City Hall Moisture Remediation – Study to determine source of moisture and leaks. Replaced all windows and stucco. 22,546 sf

Yalobusha General Hospital – Gero Psych Addition/Renovation - Water Valley, MS
Full Architectural services for the renovation of the YGH GeroPsych addition/reno. 16,200 sf project
Budgeted at \$6,200,000.

TEC Professional Services Questionnaire

KEY PERSON, SPECIALIST, OR INDIVIDUAL CONSULTANT:
Name & Title:
Tom Schreiner, P.E. Vice President
Project Assignment:
Senior Project Engineer - Meets the minimum Requirement #3, "employee who is a licensed, registered professional engineer in the State of Louisiana in the applicable discipline involved."
Name of Firm with which associated:

Years' experience with this Firm:
2
Education: Degree(s)/Year/Specialization:
Bachelor of Science in Civil Engineering, 1980
Active registration: Year first registered/discipline:
Louisiana, Civil & Environmental, #21892 Mississippi, Civil # 9891
Other experience and qualifications relevant to the proposed Project:
<p>Mr. Schreiner has worked successfully as a project manager and program manager on municipal, commercial, institutional, and industrial projects. He has cohesively worked with multiple governmental agencies on a broad spectrum of projects. Mr. Schreiner's experience includes both private and governmental positions. Professional Affiliations: American Society of Civil Engineers (ASCE), American Water-Works Association (AWWA).</p> <p>Public Work Director, City of Kenner, LA Mr. Schreiner directed the Capital Infrastructure Improvement programs for stormwater drainage, MS4 compliance, long term planning, and daily O&M operations for Louisiana's fourth largest City.</p> <p>Rachel Street Pump Station, Lafitte Levee District, LA Project consists of designing a new pump station in the Goose Bayou area to accommodate a 10-year storm event in accordance with Jefferson Parish Standards. Drainage shall be designed to be tied into the existing drainage system. Principal is responsible for providing construction documents and a probable construction cost.</p>

TEC Professional Services Questionnaire

Mr. Schreiner continued...

Grand Isle Drainage Pump Station, Jefferson Parish, LA

Principal is designing a new stormwater drainage pump station at the north end of Chighizola Lane in Grand Isle. The station is designed on an elevated platform and will discharge stormwater into the marsh. Project includes replacing large diameter CMP culvert adjacent to the station. Principal is also responsible for survey coordination, construction administration and resident inspection.

Bogue Chitto State Park, Covington, LA

Designed the site layout, drainage and auxiliary roads for a new 1800-acre state park. Designed the water supply and distribution system, as well as the wastewater collection and treatment system (approx. 35,000 gpd) Provided construction administration.

Riverwood and Covington Country Club Drainage Improvements, St. Tammany Parish, LA

Project Manager for the preparation of a statewide flood control application to relieve flooding in the Riverwood and Covington Country Club subdivisions in St. Tammany Parish, Louisiana. The application was successful. Design, bidding and construction management followed.



TEC Professional Services Questionnaire

KEY PERSON, SPECIALIST, OR INDIVIDUAL CONSULTANT:
Name & Title:
Brien Croff, P.E. Project Engineer
Project Assignment:
Engineering Design
Name of Firm with which associated:

Years' experience with this Firm:
3
Education: Degree(s)/Year/Specialization:
Bachelor of Science in Civil Engineering, 2015
Active registration: Year first registered/discipline:
Professional Engineer - Civil, 2022, Louisiana License No. 46408 Professional Engineer - Civil, 2020, Ohio License No. 86190.
Other experience and qualifications relevant to the proposed Project:
<p>Mr. Croff will have responsibility for planning, reports, and reviews. Brien has experience in project management, design drafting, hydraulic modeling and analysis, and technical report writing specifically in the areas of water supply and wastewater infrastructure.</p> <p><i>Experience in Program/Contract Management:</i></p> <ul style="list-style-type: none">-Data Analysis and Management-Environmental, Biological and Infrastructure Surveys-Environmental Studies and Reports-Water Resources Planning-Meeting/Reporting Requirements

TEC Professional Services Questionnaire

Mr. Croff Continued...

Fontainebleau State Park Force Main, City of Mandeville, La.

Mr. Croff is assisting with the design of this project in addition to completing the Coastal use permit application, permit drawings in progress, & submission of preliminary design draft as of early Jan. 2022. PRINCIPAL is performing Engineering Design and producing plans and specifications suitable for public bid, to replace the sanitary force main between City Lift Station 3, and the east bank of Bayou Castine. Design Submittals include 60%, 95% Pre-Final, and 100% Final. Engineer shall revise documents in accordance with City comments. Technical scope shall be according to the revised Pontchartrain Restoration Program (PRP) Work Plan.

Lyons Water Treatment Plant 1.0 MGD Expansion; St. John the Baptist Parish, La.

Mr. Croff established design criteria and is performing design services for this project that includes a 1.0 MGD expansion of the WTP. The Lyons WTP project includes a 1.0 MGD filter addition, existing filter media replacement, new filter building and sludge pit expansion.

Quentin Road EQ Basin and Pump Station Improvements, Eastlake, Ohio

On this project, Mr. Croff was the design engineer. Responsibilities included developing a basis of design, drafting of construction plans, cost estimate, permit applications, and specifications. The purpose of the project was to construct a 1-million-gallon equalization storage basin on the site of an existing sewage pump station, as well as improvements to the existing pump station. The cost of the project was \$2.2 million.

Troy Oaks Pump Station – Geauga County, Ohio

On this project, Mr. Croff had the role of County project manager during design and construction. The purpose of the project was to decommission an existing wastewater treatment plant and construct a 75,000 gpd pump station in its place, which would discharge to another nearby treatment facility. The cost of the project was \$1.8 million.

Chardon Township Sanitary Sewer and WWTP, Geauga County, OH.

The scope of this project was design and construction of a new sanitary sewer collection system and WWTP facility which would serve 115 residential properties. During the design phase of the project, Mr. Croff worked collaboratively with a consulting engineering firm to develop the plans for the WWTP facility, pump station and sanitary sewer. As assistant sanitary engineer for the County, he made decisions on process control, facility layout, specifications, and other operational needs. During the bidding phase he worked closely with the County administration to advertise and commission the project. During the construction phase Mr. Croff reviewed submittals from the contractor and made the decisions on whether to approve or reject products on the basis on conformance to specifications and made decisions on change orders, partial payment applications, and RFIs.

List of Most Recent Projects Working:

- **Third Street Drainage – Jefferson Parish**
- **Stall Ditch Drainage – Jefferson Parish**
- **Jung & Falcone Lift Station Improvements – Jefferson Parish**
- **Herwig Bluff Lift Station Improvements – St. Tammany Parish**
- **Water Storage Tank Inspection and Rehab. – St. John The Baptist**
- **Rachel St. Pump Station – Lafitte Levee Dist.**
- **Effluent Pipeline Extension – City of Mandeville**

TEC Professional Services Questionnaire

KEY PERSON, SPECIALIST, OR INDIVIDUAL CONSULTANT:
Name & Title:
Natalya Munger, P.H., E.I. Project Manager
Project Assignment:
Engineering Design Support
Name of Firm with which associated:

Years' experience with this Firm:
3
Education: Degree(s)/Year/Specialization:
Master's Degree/1995/Civil Engineering
Active registration: Year first registered/discipline:
American Institute of Hydrology/Professional Hydrologist (P.H.) No. 11-H-3005 E.I. Louisiana No. 0030985
Other experience and qualifications relevant to the proposed Project:
<p>Ms. Munger received her degree in civil engineering with minors in surface water hydrology and surveying (Accreditation Board for Engineering and Technology [ABET] accredited). She has professional qualifications as a professional hydrologist (surface water) from the American Institute of Hydrology and has received professional qualifications as a Certified Engineer Intern. Ms. Munger has computer skills that enhance her credentials even further. Her computer skills include but are not limited to <i>AutoCAD</i>, <i>LA DOTD HYDROWINT</i>, <i>PCSWMM</i>, <i>FHWA WSPRO</i>, <i>HEC-18</i>, and <i>HEC-RA</i>.</p> <p>Prior Related Contract Roles:</p> <ul style="list-style-type: none">-H&H Modeling-Environmental and Risk Assessment Modeling-Water Resources Planning

TEC Professional Services Questionnaire

Ms. Munger continued...

Lake Vista Neighborhood Group E / FEMA Recovery Roads Program | New Orleans, LA (RR077)

The scope of this project includes subsurface drainage improvements, concrete roadway re-design and replacement, and water main improvements. Principal performed the engineering design of all roadway and drainage improvements, and partial water main improvements. Mr. Melendez assisted with the preparation and design of construction drawings.

St. Charles Parish East Bank Master Drainage Plan | St. Charles Parish, LA

Ms. Munger assisted in the preparation of Phase I of the East Bank Master Drainage Plan for the Montz, Norco, New Sarpy, and Ormond drainage basins. The model for this effort was developed through analysis of various datasets provided by the parish using XPSTORM, EPASWMM, and AutoDesk's Storm and Sanitary Analysis, resulting in detailed drainage improvement recommendations. (2020-2021)

Hammond LOMR | City of Hammond, LA

Ms. Munger performed H&H modeling analysis for a 66 square mile watershed and made detailed study of the 29 square miles central around Hammond City Limits. The scope of the assignment is to re-model the City of Hammond and surrounding watersheds to correct over-predicted Base Flood Elevations (BFE) established by FEMA in the FIRMs. Using a 2D HEC RAS model, Modeling shows over 60% of the mapped floodplain withing City Limits as removed from mapped Flood Zone.

Grand Isle Drainage Pump Station | Jefferson Parish, LA

Ms. Munger created the design criteria and H&H modeling to size and design a drainage pump station in Grand Isle. The project includes the construction of a new drainage pump station. She analyzed area hydrology and performed hydraulic calculations to establish/verify proposed subsurface pipe sizes and to design a 100 CFS drainage pump station. Cost \$3.0M

Mid-Barataria Sediment Diversion (MBSD) | CPRA (Client), Plaquemines Parish, LA

Ms. Munger performed H&H modeling analysis for the inverted syphon. The scope of the project is to divert and convey about 75,000 cfs sediment-laden water from the Mississippi River to the Barataria Basin to promote delta-building in the subsiding coastal marsh. The major features of the project include about 200 ft wide and 25 ft deep gated intake on the west bank of the river, about 2-mile-long, 25 ft deep conveyance channel, an outfall transition feature, a state highway, and a railroad bridge crossing. Cost \$1.0B

Yellow Water Road Bridge Replacement (H&H Report and Scour Depth Calculations) | Tangipahoa Parish, LA

Ms. Munger prepared H&H report and scour depth calculations for the Yellow Water Road bridge replacement project. To address the issue of computing flood magnitude and corresponding water level in the river, design floods at a bridge site were estimated using various approaches, and the hydraulic modeling of the river reach with the bridge was carried out using HEC-RAS.

TEC Professional Services Questionnaire

KEY PERSON, SPECIALIST, OR INDIVIDUAL CONSULTANT:
Name & Title:
Eric Glynn, E.I. Project Engineer
Project Assignment:
Engineering Design
Name of Firm with which associated:

Years' experience with this Firm:
3
Education: Degree(s)/Year/Specialization:
Bachelor of Science in Mechanical Engineering, 2020.
Active registration: Year first registered/discipline:
2021/Engineer Intern (E.I.); Louisiana No. 0035028
Other experience and qualifications relevant to the proposed Project:
<p>Mr. Glynn has been with Principal for 3 years working on large-scale drainage models and public infrastructure design documents. He has experience performing Master Drainage Plans utilizing XP-STORM, EPA-SWMM, PCSWMM, and AutoCAD Storm & Sanitary Analysis. Mr. Glynn serves as the Vice President of the APWA Northshore Branch.</p> <p>St. Charles Parish East Bank Master Drainage Plan St. Charles Parish, LA</p> <p>Mr. Glynn performed H&H Modeling for the development of an East Bank Master Drainage plan for St. Charles Parish for the Montz, Norco, New Sarpy and Ormond drainage basins (~5,000 acres). His team utilized XP-STORM, EPA SWMM and AutoDesk's Storm and Sanitary Analysis software platform to conduct H&H modeling for the 25-yr. and 100-yr. design storms (NOAA Atlas 14). The hydraulic model for this effort was developed using various datasets such as field surveys, GIS information and prior flood/drainage studies performed by the Parish. As a result, PRINCIPAL provided various drainage improvement recommendations for the 25-yr. and 100 yr. storm event.</p>

TEC Professional Services Questionnaire

Mr. Glynn Continued...

Read Boulevard West Group C | City of New Orleans, LA

Mr. Glynn assisted the Project Manager for the construction phase of this \$10.0 M project. The scope of this project includes subsurface drainage improvements, concrete roadway re-design and replacement, and water main improvements. Principal performed the engineering design of all roadway and drainage improvements, and partial water main improvements.

Lake Vista Group E – Department of Public Works | City of New Orleans, LA

Mr. Glynn oversaw the revision of drawings and specifications based on client comments to advertise the project for bidding. In addition, this project was set to be two separate projects and was combined to be completed all at once with a staged sequence of construction. Subsurface drainage improvements, concrete roadway re-design and replacement, and water main improvements.

Ozone Woods Drainage Improvements (H&H Modeling Report) | St. Tammany Parish Government, LA

Mr. Glynn performed H&H Modeling for this Phase of the Ozone Woods Drainage Improvement project that consisted of detailed topographic survey, build of a calibrated existing condition hydrologic & hydraulic model in the EPA SWMM software platform for the 10-yr and 100-yr recurrence rainfall event, and modeling of improvement alternatives (~600 acres). Hydrologic and Hydraulic analysis of the widespread area was performed. Two improvement alternatives were presented, each satisfying one of the design criteria developments, and the construction cost estimations. Given fiscal constraints, a reduced-criteria alternative was developed at lower construction cost; named the *Modified 10-yr Improvement Alternative*.

Plaquemines Parish Pump Stations Rehabilitation Projects | Plaquemines Parish, LA

Mr. Glynn assisted in conducting the assessment of mechanical, structural, and electrical rehabilitation of 6 drainage pump stations from Hurricane Ida. These 6 stations are comprised of 16 pumps ranging in size from 16" to 72, powered by manually operated diesel engines, and a system consisting of diesel-powered air compressors, diesel powered vacuum pumps, electric air compressor, diesel electric generator, right angle gear drives, and chain drives. Principal Engineering coordinated inspections to evaluate damage to mechanical and electrical equipment, enclosures, and other site features. From the resulting observations, produced comprehensive written assessments of facility conditions, including description of observed damages to equipment and enclosures, estimated costs of rehabilitation, and design drawings for construction. Made recommendations for facility repairs and improvements and developed grant applications for project funding.

TEC Professional Services Questionnaire

KEY PERSON, SPECIALIST, OR INDIVIDUAL CONSULTANT:
Name & Title:
Nestor Houghton, P.E. Electrical Engineer
Project Assignment:
Electrical Engineer
Name of Firm with which associated:
 The logo for Principal Engineering features a stylized blue and yellow square icon to the left of the word "PRINCIPAL" in blue, with "Engineering" in a smaller, italicized font below it.
Years' experience with this Firm:
4
Education: Degree(s)/Year/Specialization:
Bachelor of Engineering Science, 1978
Active registration: Year first registered/discipline:
Louisiana, Electrical #22300
Other experience and qualifications relevant to the proposed Project:
<p>Mr. Houghton completed numerous electrical design projects while employed by Principal Engineering. Most recently, Mr. Houghton was the electrical engineer for the City of Mandeville Hurricane Isaac Recovery Program which consisted of Sunset Point and Fishing Pier Rehabilitation and Lift Station Panel Replacement due to damage caused by Hurricane Isaac. He has also performed the design on numerous backup/standby generator projects – all including the installation of automatic transfer switches.</p> <p>Westwego, LA Drainage Pump Station Jefferson Parish, LA Mr. Houghton provided electrical engineering services for the upgrade of one 500 HP Drainage electric driven drainage pump (4160 Volts). New Stand by diesel generator, automatic transfer switch, fuel pumps compressor, MCC 480/277-volt, control panel, motor operated gate valves.</p> <p>Lake Cataouatche Drainage Pump Station for US Army Corp of Engineers Jefferson Parish, LA Mr. Houghton provided electrical engineering design services which consisted of the upgrade of five diesel driven drainage pumps. Also included a New Stand by diesel generator, automatic transfer switch, fuel pumps,</p>

TEC Professional Services Questionnaire

Mr. Houghton Continued...

air compressor, MCC 480/277-volt, control panel, motor operated gate valves.

Pump Station 11, Drainage Pump Station | New Orleans Sewage and Water Board, LA

Mr. Houghton provided electrical engineering services for five diesel driven drainage pumps, stand by diesel generator, automatic transfer switch, fuel pumps, air compressor, MCC (480/277 volt), control panel, motor operated gate valves.

Fisher House Site Prep, SLVHCS | New Orleans, LA Project No. 629-18-104 – Contract No. 36C25618C0171

Mr. Houghton provided electrical engineering for this project where the firm performed A/E design, construction document preparation and construction period services for a Site Preparation project to accommodate a new Fisher House on the NOLA VA campus, including, but not limited to civil, mechanical, electrical, and plumbing engineering. Work includes the design of water systems, sewer, drainage, electrical, irrigation, natural gas and other miscellaneous utilities. Construction Est. - \$900K



TEC Professional Services Questionnaire

L. Work by Firm or Joint-Venture members which best illustrates current qualifications relevant to this Project. Please include any and all work performed for Jefferson Parish. Attach additional pages if necessary.

PROJECT NO. 1

Project Name, Location and Owner's contact information:	Nature of Firm's Responsibility:	
A/E Services for Hurricane IDA Damage to St. Charles Parish Westbank Waterworks Facilities Project No. WWKS 107 & 108 St. Charles Parish Government Department of Waterworks 301 3 rd Street Luling, LA 70070 Greg Gorden, Director (985) 783-5110	Project Performed by the JV Team of Principal Engineering as Prime and Hardy as Sub. The project included the A/E Design for the rehabilitation of numerous facilities damaged by Hurricane Ida and the design of a new metal building on the existing site. A/E work included the assessment of damage and the architectural design, structural, civil/site, electrical and mechanical engineering including modifications to bring aged existing facilities into ADA compliance. The existing utility billing and management office sustained significant damage and required complete rehabilitation including, but not limited to, new roof, decking, soffit, canopies, exterior doors, gypsum board ceiling/walls, insulation, HVAC (including ducts), millwork, base, painting, flooring, ADA restrooms and new electrical wiring.	
Completion Date (Actual or Estimated):	Estimated Cost:	
	Entire Project:	Work for which Firm was Responsible:
Design Complete – 2022 Construction – 20% Complete – 2023 Est	\$1,500,000	100%

PROJECT NO. 2

Project Name, Location and Owner's contact information:	Nature of Firm's Responsibility:	
Renovate Pathology, 2E/2N, OBVAMC Shreveport, LA Project No. 667-16-103 – Contract No. VA256-16-C-0127 Department of Veterans Affairs 510 E. Stoner Ave. Shreveport, LA 71101 Stacy Walden, P.E., Engineer, COR (318)-990-5297	Project Performed by the JV Team of Principal Engineering as Prime and Hardy as Sub. Completed the construction documents/design for the project to renovate the Pathology lab that is located on the second floor north and east wings, within the main hospital, building 1, Overton Brooks Medical Center, Shreveport, LA. The design documents captured a plan that renovated Pathology to improve efficiency in processing, handling, and transportation of specimens. The plans included, but were not limited to, total renovation in rooms 2N4, 2N5, 2N6, 2N7, 2E23, 2E24 and as necessary where 2N6 connects to 2N8. Other considerations included rooms that needed various changes due to the re-organization and process flow changes including, but not limited to, mechanical, electrical, plumbing, data, alarms, sprinklers, architectural, etc. Principal considered the proper construction phasing of work with time limitations in order for the full Pathology Operation to continue during construction and keep continuous operation throughout the entire renovation.	
Completion Date (Actual or estimated):	Estimated Cost:	
	Entire Project:	Work for which Firm was Responsible:
2020	\$2,500,000	100%

TEC Professional Services Questionnaire

PROJECT NO. 3		
Project Name, Location and Owner's contact information:	Nature of Firm's Responsibility:	
Renovate Inpatient Wards for Privatization 6W, 7W & 8W, OBVAMC, Project No. 667-18-105 – Contract No. 36C25618C0091 Department of Veterans Affairs 510 E. Stoner Ave. Shreveport, LA 71101 Stacy Walden, P.E. (318) 990-5277	Project Performed by the JV Team of Principal Engineering as Prime and Hardy as Sub. Completed the A/E design for Overton Brooks VAMC to renovate the existing Inpatient Wards on 6-West, 7-West and 8-West (approximately 31,000 GSF) for private single-occupancy patient rooms. The design included a renovation of the corridors, Nurse's Station and support areas on each floor. Patient room renovation design requirements included, reconfiguration of the medical gasses, headwall units, privacy curtains, furniture layout plan, etc. The design also incorporated new lighting and signage. The patient rooms were redesigned to be more inviting to serve veterans and their families. This design also strategically addressed Patient Centered Care initiatives by privatizing patient rooms, creating more of a non-institutional setting, improve safety, infection control and reduce the cost of maintenance on the inpatient wards.	
Completion Date (Actual or estimated):	Estimated Cost:	
	Entire Project:	Work for which Firm was Responsible:
2023	\$5,000,000	100%

PROJECT NO. 4		
Project Name, Location and Owner's contact information:	Nature of Firm's Responsibility:	
CWU Access and Enhancement Project (Welcome Center & Boat Rental Shop) St. Bernard Parish, LA St. Bernard Parish Govt. Department of Public Works Donald Bourgeois, Chief Admin 1125 East St. Bernard Hwy. Chalmette, LA 70043 (504) 236-3877	Principal was recently selected by St. Bernard Parish Government to plan and execute architectural and engineering services for Phase I of the Central Wetlands Unit (CWU) Access and Enhancement project. The project is an eco-tourism project in which residents will be attracted to recreation and educational opportunities that the area has to offer. Phase I is to design and construct an access road, boat house, welcome center, various wooden piers and lookout decks. The project is Louisiana Tourism Recovery Program (LTRP) Funded.	
Completion Date (Actual or Estimated):	Estimated Cost:	
	Entire Project:	Work for which Firm was Responsible:
July 2016	\$1,500,000	100%

TEC Professional Services Questionnaire

PROJECT NO. 5		
Project Name, Location and Owner's contact information:	Nature of Firm's Responsibility	
Cleary & Bright Playground Gym Renovation Jefferson Parish, LA Jefferson Parish Dept. of Parks & Recreation Leo Webb 6921 Saints Drive Metairie, LA 70003 lwebb@jeffparish.net	This project includes the selected interior renovation of each Playground Main Building and selected exterior renovation and improvements. The project involves renovating the interior of both gyms, replacing the roof at Bright and performing other misc. repairs and improvements. Outside of the original scope, installation of a metal ceiling was added to both main gyms as an alternate bid.	
Completion Date (Actual or estimated)	Estimated Cost:	
	Entire Project:	Work for which Firm was Responsible:
2020	\$1,150,000	100%

PROJECT NO. 6		
Project Name, Location and Owner's contact information:	Nature of Firm's Responsibility:	
Singing River Healthcare Training Center Ocean Springs, MS Singing River Health Systems Randall Cobb 2809 Denny Avenue Pascagoula, MS 39581 (228) 809-5464	Full A/E services performed by Hardy and Associates, LLC to design and construct 35,200 sf. three-story academy and training center for the Singing River Health System.	
Completion Date (Actual or estimated):	Estimated Cost:	
	Entire Project:	Work for which Firm was Responsible:
On-Going	\$12,369,000	100%

TEC Professional Services Questionnaire

PROJECT NO. 7		
Project Name, Location and Owner's contact information:	Nature of Firm's Responsibility:	
St. Bernard Parish Fire Station #10 St. Bernard Parish, LA St. Bernard Parish Government Dept. of Public Works 1125 East. St. Bernard Hwy Chalmette, LA 70443	Principal Engineering is in charge of the design, bidding, and construction administration of the new Fire Station #10 facility located between Bayou Road / Hwy 300 and LA Hwy 46 adjacent to the Hurricane Protection System. The new fire station is designed to accommodate Parish programming requirements to include fire truck bays, sleeping quarters, and emergency operations requirements.	
Completion Date (Actual or estimated):	Estimated Cost:	
	Entire Project:	Work for which Firm was Responsible:
2025 (est)	\$5,200,000	100%

PROJECT NO. 8		
Project Name, Location and Owner's contact information:	Nature of Firm's Responsibility:	
St. Bernard Police Warehouse St. Bernard Parish, LA St. Bernard Parish Sheriff's Office John Vickers 4700 Paris Road St. Bernard, LA	Principal Engineering alongside Hardy and Associates oversee the design, permitting and construction of the new 18,400 sf warehouse and office facility for the St. Bernard Parish Sheriff's Office in Chalmette, Louisiana.	
Completion Date (Actual or estimated):	Estimated Cost:	
	Entire Project:	Work for which Firm was Responsible:
2025 (est)	\$2,785,467	100%

TEC Professional Services Questionnaire

PROJECT NO. 9		
Project Name, Location and Owner's contact information:	Nature of Firm's Responsibility	
Community Center ADA Rehabilitation City of Mandeville, LA City of Mandeville Department of Public Works Clif Siverd, Director 1100 Mandeville High Blvd. Mandeville, LA 70471 (985) 624-3169	This project includes the evaluation of the City of Mandeville's Community and Senior Citizens Center for ADA compliance and the planning, design and preparation of contract documents of recommendations. The work includes the design of a new ADA compliant restroom facility, ADA entrance ramps and various other rehab improvements. Along with the ADA recommendations, the scope includes the design of a new covered vehicle entrance and accommodating driveway improvements.	
Completion Date (Actual or estimated)	Estimated Cost:	
	Entire Project:	Work for which Firm was Responsible:
2014	\$100,000	100%

PROJECT NO. 10		
Project Name, Location and Owner's contact information:	Nature of Firm's Responsibility:	
Welcome Center- Architectural & Engineering St. Bernard Parish, LA St. Bernard Parish Govt. Department of Public Works Donald Bourgeois, Chief Administrator 1125 East St. Bernard Hwy. Chalmette, LA 70043 (504) 236-3877	Principal Engineering provided A/E services for this new Welcome Center in St. Bernard Parish. Services included all architectural, electrical/mechanical, civil/site engineering, field layout, environmental, structural, etc. for a complete project from planning through construction. Project construction is currently on-hold due to funding issues. Cost: \$2.0M	
Completion Date (Actual or estimated):	Estimated Cost:	
	Entire Project:	Work for which Firm was Responsible:
Design 2019	\$200,000 (Design)	100%

TEC Professional Services Questionnaire

M. List all prior and/or on-going litigation between Firm and Jefferson Parish. Please attach additional pages if necessary.

Parties:		Status/Result of Case:
Plaintiff:	Defendant:	
1. N/A - NONE		
2.		
3.		
4.		

N. Use this space to provide any additional information or description of resources supporting Firm's qualifications for the proposed project.

COMPANY PROFILE:

PRINCIPAL INFRASTRUCTURE – A/E/C, LLC is a Joint-Venture (JV) between Principal Engineering, Inc. and Hardy and Associates/ Architect, PLLC. Principal Engineering is the majority (51%) partner of the JV. Principal and Hardy have worked together on numerous local and federal A/E projects over the past 10 years through a JV and as a prime/sub relationship. Most recently, the Principal/Hardy team completed the A/E design for the St. Bernard Parish Fire Station #10 and numerous Department of Veterans Affairs A/E Design Projects.

PRINCIPAL ENGINEERING, INC.

PRINCIPAL *Engineering, Inc.* (PRINCIPAL) is a full-service consulting Architecture, Engineering, and Construction services (A/E/C) firm specializing in the following disciplines: ***Architectural, Civil, Environmental, Structural, Electrical and Mechanical, and Construction Engineering Services.*** Founded in 2004, we successfully provide professional services to federal, state, parish, and city governmental agencies since our inception. Over **90 percent** of our work is from governmental agencies.

PRINCIPAL *Engineering, Inc.* is fully licensed and insured to perform architectural and engineering services in the State of Louisiana. The firm is registered as a corporation with the State of Louisiana, Office of the Secretary of State and is licensed as an Engineering Firm with the **Louisiana Professional Engineering and Land Surveying Board; License no. 3168.** In addition, we are currently licensed to practice professional engineering in the states of **Alabama, Arizona, Arkansas, Colorado, Connecticut, Delaware, Florida, Georgia, Illinois, Iowa, Kansas, Kentucky, Maryland, Mississippi, Missouri, Nebraska, New Jersey, New York, Nevada, New Mexico, North Carolina, Oklahoma, Ohio, Pennsylvania, South Carolina, Tennessee, Texas, Utah, Virginia, West Virginia, and Wisconsin.**

PRINCIPAL is pleased to report that we are solvent and in a solid financial condition. We have healthy cash flow, no outstanding debts, and a favorable cash reserve. In addition to our capital reserves, PRINCIPAL has a significant cash line of credit which gives us the capacity to deploy resources when and where needed to meet the needs of our clients. We have the capacity, capability, and experience to deliver successful A/E services to the federal government. PRINCIPAL's President and Vice President are former active-duty military engineering officers and current reserve forces military engineering officers that have past successful experience working on CONUS and OCONUS US Army and US Air Force DOD Facility and Civil Works Projects.

TEC Professional Services Questionnaire

PRINCIPAL is a verified Service-Disabled Veteran Owned Small Business (SDVOSB) with the Center for Veterans Enterprise (CVE) and PRINCIPAL is also a certified Disabled Veteran and Hudson Initiative Small Business and a Small and Emerging Business Enterprise with the Louisiana Department of Economic Development.

PRINCIPAL Infrastructure[®] is a federally registered service mark.

HARDY AND ASSOCIATES/ ARCHITECT, PLLC

Hardy and Associates/ Architect, PLLC (HA/A) is a Mississippi-based architectural firm. The firm's current staff includes two registered architects with 20 years of experience, a Project Manager with 14 years of experience, a Project manager with 28 years of experience, an Interior Designer with 9 years of experience, and a Business Manager with 5 years of experience. HA/A currently has a successful partnerships/working relationship with Singing River Hospital, Ocean Springs Hospital, Merit Health River Oaks, George Regional Hospital, Tallahatchie General Hospital, Merit Health Biloxi, Yalobusha General Hospital and Nursing Home, Rush Foundation Hospital, Merit Health Women's Hospital, Merit Health Central and several hospitals in Alabama as well as some smaller medical/clinical/commercial facilities. We also have a long-standing relationship with the Harrison County School District. With our down-to-earth approach to design needs and attention to the smallest details, HA/A has been successful in maintaining existing partnerships and contracting with new clients. It is our belief that integrity must be maintained for any working relationship to flourish, so we provide responsive, honest answers to questions posed and reliable solutions to concerns expressed by our clients. This approach to business has led to repeat business with all our current healthcare, Education and Commercial clients in Mississippi and Alabama.

MINIMUM REQUIREMENTS FOR SELECTION:

- 1. The persons or firms under consideration shall have at least one (1) principal who is a licensed, registered architect or a professional engineer in the State of Louisiana:**

The principal engineers are Mr. Henry DiFranco, Jr., President and Mr. Andre Monnot, Vice President. Both are registered professional engineers in the State of Louisiana.

- 2. The persons or firms under consideration shall have a *professional in charge* of the Project who is a licensed, registered architect in the State of Louisiana with a minimum of five (5) years' experience:**

Marion "Marty" Hardy, registered architect in the State of Louisiana - License #7077

- 3. The persons or firms under consideration shall have one (1) employee who is a registered professional engineer in the State of Louisiana in the applicable discipline involved.**

Principal Engineering, Inc. employs four registered professional engineers with various levels of experience in architectural projects with three of the registered senior professional engineers experienced in building design and structural engineering.

TEC Professional Services Questionnaire

EVALUATION CRITERIA:

1. Professional Training and Experience

Since 2004, Principal Engineering has performed A/E services for nearly every municipal government agency in the New Orleans Metropolitan area and all are repeat clients. As a result, Principal has a proven history of local public facility A/E design and construction success as well as established local relationships that have been built on these accomplishments. Our A/E staff has successfully completed the planning, design, and construction phase services for numerous local and federal architectural improvement projects. In addition, Principal Engineering's President, Mr. DiFranco brings unique Public Works experience to our clients; having served as a municipal engineer and Director of Public Works and Utilities for two local municipalities. This experience as an Owner's representative and consulting engineer brings valuable experience in insight to our municipal clients. The professionals at Principal stay abreast of new developments and technologies in the industry by attending annual events held by the American Society of Civil Engineers (ASCE), the Society of American Military Engineers (SAME) and the American Public Works Association (APWA). All engineers at Principal are required to maintain active registration with ASCE, SAME and APWA. Our Vice President, Mr. Monnot is an officer in the local APWA chapter.

Key Personnel Training & Experience

- **Marion Hardy, AIA, Licensed Architect**, is the **President** of Hardy & Associates/ Architect, PLLC and has over 28 years of experience in A/E design and management. He is a 1995 graduate of Mississippi State University with a B.S. in Architecture and is licensed with the LA Board #7077. Mr. Hardy is a member of the American Institute of Architects (AIA), the National Council of Architectural Registration Boards (NCARB) and the Mississippi Hospital Engineers Association.
- **Henry DiFranco, PE**, is **President** of Principal Engineering, Inc. and has over 33 years of experience in local, state and federal public works engineering and management. Mr. DiFranco served as the **Director of Public Works & Utilities** for a local Parish and held numerous positions as a Parish Public Works Engineer (Jeff Parish) and Consulting Engineer over the past **30 years**. He is also a retired **Lt Colonel in the USAF Reserve** having served as a **Civil Engineer officer** with the Air Force Civil Engineer Center and is a **veteran of Operation Iraqi Freedom and Noble Eagle**. Mr. DiFranco is the **former Chairman of the St. Tammany, Levee, Drainage and Conservation District (Governor Appointed - 2014 to 2021)**, where he has been instrumental in the planning, scope writing and implementation for the development of a *Coastal Master Plan for St. Tammany Parish*.
- **Andre Monnot, PE**, is **Vice President** of Principal Engineering, Inc. and has a diverse range of planning, engineering design and management experience in both the public sector, as a military engineer, and as a private consultant. He has demonstrated experience as a lead Structural and Civil Engineer for A/E projects and has a diverse range of planning, engineering design and management experience in both the public sector, as a military engineer, and as a private consultant. He has recently demonstrated experience performing structural and utility engineering design for numerous Department of Veterans Affairs A/E design projects, ranging from the renovation of a Pathology Lab to the complete renovation of the Emergency Room at the Biloxi VA Hospital. Most recently, Mr. Monnot served as the engineer of record for the following Jefferson Parish A/E projects, East Bank Sign Shop Restroom renovation, Cleary & Bright Playground Improvements, and the Girard Playground Concession Building. In addition, he served as the engineer of record for the St. Bernard Welcome Center and numerous City of Mandeville facility renovation projects.

2. Size of the Firm

Principal Engineering has a staff of twenty professional and technical employees, including engineers and engineering technicians with specialization in evaluation, design and construction document preparation for drainage infrastructure projects. Our team includes a staff of 4 licensed professional engineers, 2 engineer interns and 3 BS graduates in engineering technology as well as A/E CADD specialists. Furthermore, our Construction Administrator has over 27 years of experience in his field.

TEC Professional Services Questionnaire

Hardy & Associates/ Architect has a staff of 8 personnel including 2 licensed architects, 1 interior designer, 4 project managers and a clerical staff.

3. Capacity for Timely Completion

Based on a review of our current and projected workload, the JV staff has the capacity to add new projects to our current design workload. PRINCIPAL strives to carefully schedule our workload, and we would not bring on any assignment if we did not have the capacity, experience, or resources to complete the project within the client's anticipated schedule. We work closely with the client to develop a schedule that meets their needs for completion. A snapshot of some of our current Jefferson Parish workload, current phase and recent project additions include the following:

Current JPG Design/CPS Workload (% Complete):

- ◆ JPG – Destrehan Sewer Lift Station – 100% Design - 0% Construction
- ◆ JPG – Grand Isle Pump Station – 95% Design
- ◆ JPG – Woodmere Playground – 100% Design - 0% Construction (Sub to Meyer)
- ◆ JPG – Woodmere Youth Center Interior Renovations – 0% Construction
- ◆ JPG – Live Oak Blvd Water Line – 95% Design
- ◆ JPG - Bayou Rigolettes East Marsh Creation – 90% Study
- ◆ JPG - Muss Bertolino Playground – 100% Study
- ◆ JPG - Jefferson Heights Waterline Improvements – 50% Design
- ◆ JPG – Laketown Shoreline Alternatives – 95% Study
- ◆ JPG – Destrehan, Leo Kerner Waterline Improvement – 10% Design

JV's available professional and support personnel in Key Personnel section includes (but not limited to):

Principal:

- **Tom Schreiner, PE** – Bachelor of Science in Civil Engineering, over 44 years' experience in local and state, public, and civil works engineering projects.
- **Brien Croff, PE** - Bachelor of Science in Civil Engineering, skilled water and wastewater engineer.
- **Nestor Houghton, PE** – Bachelor of Science in Electrical Engineering, over 44 years of experience in the electrical industry working with local utility companies, architects, design/consulting firms, and electrical contractors.
- **Natalya Munger, PH, EI** – Master of Science in Civil Engineering, skilled Hydrologist with multiple platform H&H computer modeling experience.
- **Eric Glynn, EI** – Bachelor of Science in Mechanical Engineering, skilled on large-scale drainage models and public infrastructure design documents.
- **Emile Barre, EI, BSME** – Bachelor of Science in Mechanical Engineering, over 25 years' experience in evaluation and design of mechanical systems.
- **Michael Melendez** – Associate in engineering technology, over 20 years of experience in A/E Design
- **Logan Richard** – BS in Engineering Technology, Experience working on rehabilitation projects.

TEC Professional Services Questionnaire

Hardy:

- **Jaime Locknane, NCARB** – BS in Architecture with 21 years' experience in A/E Design; MSU Alumni
- **Dan Estes, Project Manager** – 29 years of experience in A/E Design and Construction Administration
- **Rick House, Project Manager** – BS in Architecture with 18 years of experience in design and planning.
- **Gina Hardy, NCIDQ** – Interior Designer with over 10 years of experience, USM Alumni in Interior Design
- **Matt Johnson** – A/E Project Manager with over 20 years of experience

4. Past Performance

Principal Engineering has been providing A/E services to Jefferson Parish Government since 2004. We have performed engineering services for every Department within Jefferson Parish Public Works and have completed numerous A/E projects under this type of as-needed contract. Principal currently has an active As-Needed Architectural/Engineering contract with Jefferson Parish Government.

Principal's architects and engineers all have experience working on past Public Facilities projects for Jefferson Parish and numerous other local municipal governmental bodies in the metropolitan area. In addition, we have completed Architectural projects for St. Bernard Parish, City of Mandeville, St. Charles Parish, and the Federal Government.

5. Location of the Principal Office Performing Work

Our St. Tammany Parish, LA office, located at **128 Northpark Blvd. Covington, LA** is the office where the work will be performed.

6. Adversarial Legal Proceedings

Principal Engineering, Inc. and/or Hardy & Associates/ Architect, PLLC Principal Engineering, Inc. has no past or current litigation with Jefferson Parish Government. In addition, no client has ever made a claim against Principal Engineering, Inc. or any one of our principals or employees for any error, omission, improper or incomplete A/E services; Principal has no record of any claims or litigation. Principal has never failed to complete any work awarded and has never filed any lawsuits or requested arbitration with regard to engineering contracts.

7. Prior Successful Completion of Projects of this Type and Nature

Principal Engineering has an excellent professional reputation with all of our governmental agency clients. Principal has provided services to nearly every public agency in the New Orleans metropolitan area as well as various State and Federal agencies. Every Governmental client is and has been a repeat customer. A partial list of our New Orleans regional area clients includes the following:

- ◆ City of New Orleans, Department of Public Works
- ◆ City of Kenner, Department of Public Works
- ◆ City of Covington, Department of Engineering
- ◆ City of Mandeville, Department of Public Works
- ◆ Jefferson Parish, Department of Public Works
- ◆ Jefferson Parish School Board
- ◆ St. Tammany Parish, Department of Engineering
- ◆ St. Tammany Parish, Department of Environmental Services
- ◆ Town of Abita Springs

TEC Professional Services Questionnaire

- ◆ City of Slidell, Department of Engineering
- ◆ Plaquemines Parish Government, Department of Public Works
- ◆ St. Bernard Parish Government, Department of Public Works
- ◆ Sewerage and Water Board of New Orleans
- ◆ Housing Authority of Jefferson Parish
- ◆ St. Charles Parish, Department of Public Works
- ◆ St. John the Baptist Parish Department of Utilities & Public Works
- ◆ Department of Veterans Affairs
- ◆ LA Coastal Protection and Restoration Authority

Additional References for Architectural/Engineering Projects:

St. Bernard Parish Government, Donald Bourgeois, Capital Projects Manager, (504) 278-4300, dbourgeois@sbpg.net – Projects: Welcome Center and CWU Education Facility

City of Mandeville, Clif Siverd, Interim Public Works Director, (985) 624-3169, csiverd@cityofmandeville.com – Projects: Numerous City Facility Improvements

Department of Veterans Affairs, Stacy Walden, PE, Supervising Project Engineer, (318) 990-5277, stacy.walden@va.gov – Projects: Numerous Medical Facility Improvements

Department of Veterans Affairs, Craig Crawley, Architect, Capital Asset Coordinator, (228) 523-4677, Craig.Crawley@va.gov – Projects: Numerous Medical Facility & Site Improvements

In Closing:

We will provide the highest quality of personalized, professional, and state of the art technology to our clients. PRINCIPAL INFRASTRUCTURE - A/E/C is committed to assisting our clients by offering inventive solutions to evaluate, plan, design, construct and/or restore the infrastructure under their jurisdiction and to provide professional engineering services to safeguard life, health, and property of the residents that they serve.



O. To the best of my knowledge, the foregoing is an accurate statement of facts.

Signature: Henry L. DiFranco, Jr. **Print Name:** Henry L. DiFranco, Jr

Title: President **Date:** December 19, 2024

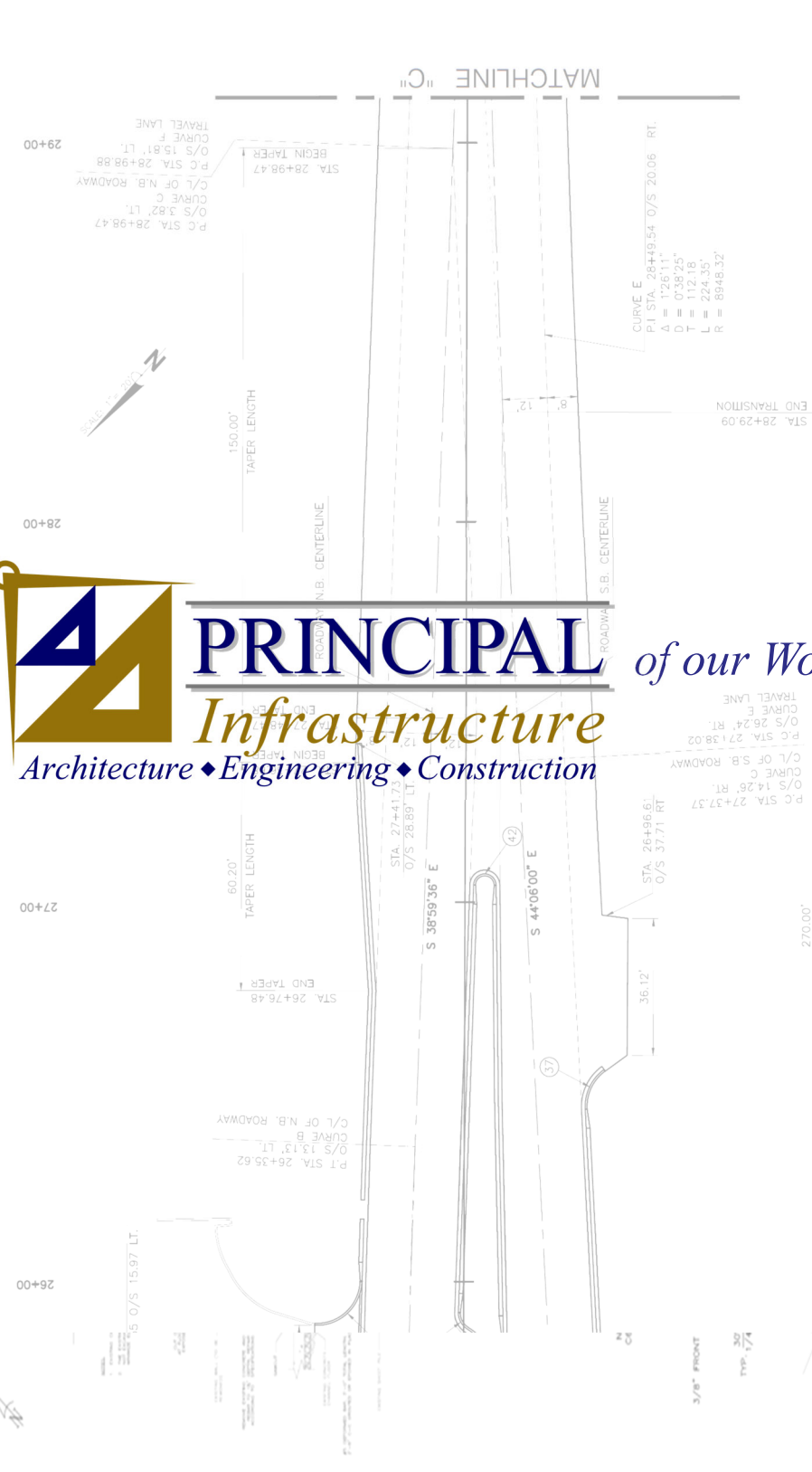
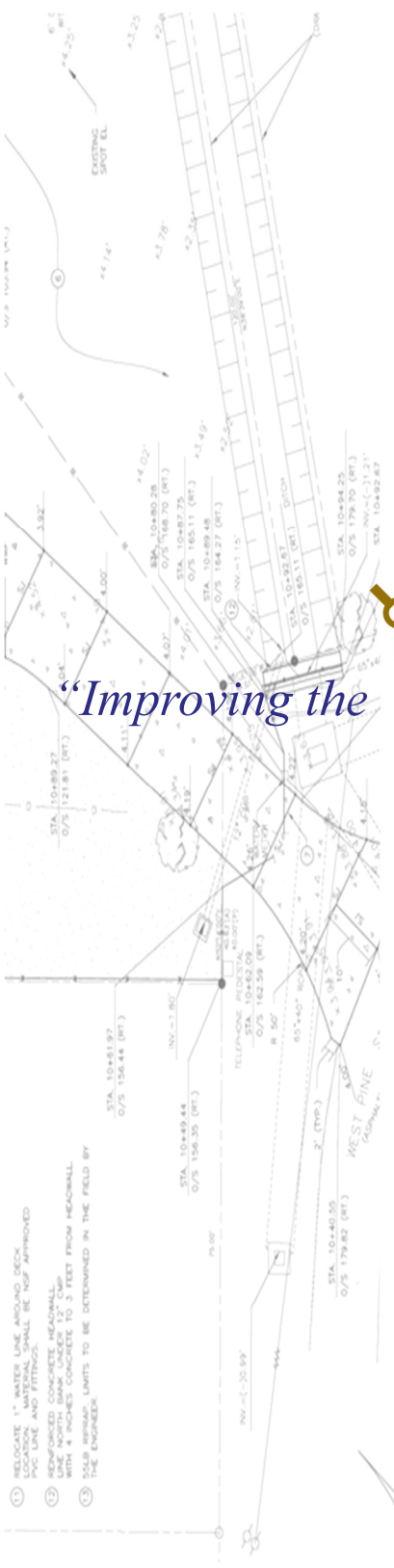

“Improving the

PRINCIPAL

of our World”

Infrastructure

Architecture ♦ Engineering ♦ Construction

1. RELOCATE 1" WATER USE AROUND DECK LOCATION. MATERIAL SHALL BE OF APPROVED PVC LINE AND FITTINGS.
2. REINFORCED CONCRETE HEADWALL WITH 4 INCHES CONCRETE TO 3 FEET FROM HEADWALL.
3. SOLID BRIDGE LIMITS TO BE DETERMINED IN THE FIELD BY THE ENGINEER.

