



## PE444T-75-8C

CRUSHER DUTY ELECTRIC MOTOR

NEMA PREMIUM EFFICIENCY

TOTALLY ENCLOSED FAN COOLED

INVERTER DUTY 10:1 CT; 20:1 VT - NEMA MG1 PART 31

Factory Certified for T2B Class I, Division II, Groups A,B,C & D and Class II, Division II, Groups F & G

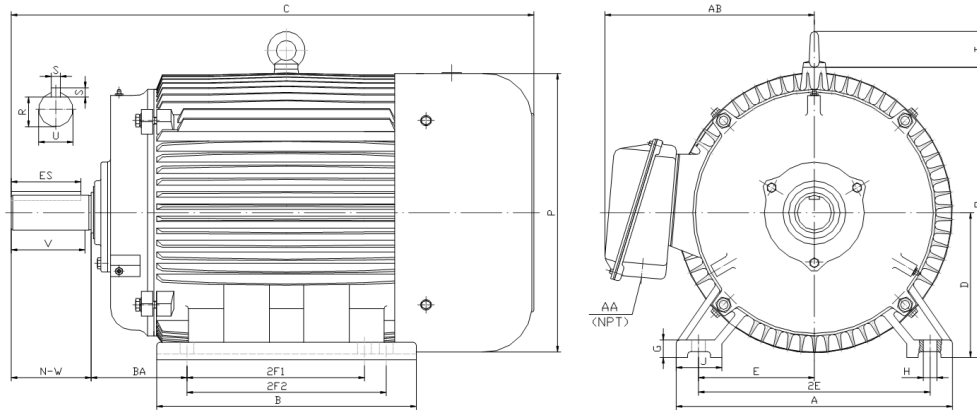

### DIMENSIONS

HP	RPM	Frame	MOUNTING														
			A	B	C	D	G	H	J	E	2E	2F1	2F2	O	P	T	BA
75	900	444T	21.7	22.9	44.3	11	1.35	0.81	3.35	9	18	14.5	16.5	22.1	21.6	3	7.5

Shaft Extension, Key Set						Conduit Box		Bearings		Mount
U	V	R	S	ES	N-W	AA	AB	DE	ODE	
3.375	8.25	2.88	0.875	6.91	8.5	3	19	NU319	6318	F1

**BEARING LUBRICATION:** The bearings come lubricated with Mobil Polyrex EM Polyurea Grease. It is recommended that you add some additional lubrication when the motor is installed.

Three options (brands) for suitable lubrication include, but are not limited to, the following:

- 1.) Mobil Polyrex EM
- 2.) Citco Polyurea MP
- 3.) Conoco Phillips Polytac EP





## PE444T-75-8C

CRUSHER DUTY ELECTRIC MOTOR

NEMA PREMIUM EFFICIENCY

TOTALLY ENCLOSED FAN COOLED

INVERTER DUTY 10:1 CT; 20:1 VT - NEMA MG1 PART 31







Factory Certified for T2B Class I, Division II, Groups A,B,C & D and Class II, Division II, Groups F & G

### PERFORMANCE DATA

HP	RPM	Frame	Voltage	Frequency (Hz)	Full Load S.F.	Insulation Class	NEMA Design	Slip (%)	NEMA Code	Enclosure Type	IP Rating	Max. Ambient
75	885	444T	208-230/460	60	1.15	F	C	1.7	G	TEFC	55	40 °C

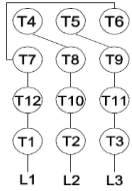
Amps (460V)		Efficiency (%)			Power Factor			Torque (ft-lb)			DE Bearing	ODE Bearing	Connection	Weight (lbs.)
FLA	LRA	100%	75%	50%	100%	75%	50%	FLT	LRT %	BDT %	NU319	6318	12 Lead 2Δ/Δ	1353
95	542	93.6	93.6	92.5	0.80	0.72	0.60	445	200	240				

### NAME PLATE

						AC INDUCTION MOTOR INVERTER DUTY 20:1 VT; 10:1 CT												CONNECTION DIAGRAMS																	
CAT NO.				PE444T-75-8C				FRAME				444T				PHASE				3				208-230V											
HZ		60		S.F.		1.15		HZ		50		S.F.		1.0		ENCL		TEFC		IP		55													
HP		75		RPM		885		HP		75		RPM		740		DUTY		CONT		DES		C													
VOLTS				208-230/460				VOLTS				190/380				AMB				40 °C				INS		F									
AMPS				210 - 190 / 95				AMPS				230/115				DE BRG				NU319															
CODE		G		P.F.		0.80		CODE		F		P.F.		0.82		ODE BRG				6318															
EFF		93.6		MIN		92.4		EFF		92.0		MIN		90.5		LUB:				Mobil Polyrex EM															
MOTOR WEIGHT				1353				LBS				CONNECTION				12 Lead 2Δ/Δ				SER NO															
Special purpose use on crushing and pulverizing equipment.																														CC082A					
Hernando, Mississippi																																			

### APPLICATIONS:

Special purpose use on crushing and pulverizing equipment. Other industrial machinery requiring extremely high starting torques and breakdown torques. Suitable for use with variable frequency drives.