

DATE: 2/01/2017

INVITATION TO BID
THIS IS NOT AN ORDER

Page: 4

BID NO.: 50-00118869

JEFFERSON PARISH

PURCHASING DEPARTMENT
P.O. BOX 9
GRETN, LA. 70054-0009
504-364-2678

VENDOR: 27118 BLANK BID COPY VENDOR

BUYER: DMEVANS

As per LSA-RS 47:301 et seq., all governmental bodies are excluded from payment of sales taxes to any Louisiana taxing body. Quotations shall be based on F.O.B. Agency warehouse or jobsite, anywhere within the Parish as designated by the Purchasing Department.

JEFFERSON PARISH reserves the right to cancel all or any part of an order if not shipped promptly. No charges will be allowed for parking or cartage unless specified in quotation. The order must not be filled at a higher price than quoted. JEFFERSON PARISH reserves the right to cancel at any time and for any reason by issuing a THIRTY (30) day written notice to the contractor.

JEFFERSON PARISH is expecting all products to be new and all work is to be done in a workman-like manner, according to standard practices. Any deviations or alterations from the specifications must be indicated and backup documentation supplied with your quotation.

DELIVERY: FOB JEFFERSON PARISH

INDICATE DELIVERY DATE ON EQUIPMENT AND SUPPLIES

3-4 Days

INDICATE STARTING TIME (IN DAYS) FOR CONSTRUCTION WORK

INDICATE COMPLETION TIME (IN DAYS) FOR CONSTRUCTION WORK

In the event that addenda are issued with this bid, bidders MUST acknowledge all addenda on the bid form. Bidder must acknowledge receipt of an addendum on the bid form as indicated. Failure to acknowledge any addendum on the bid form will result in bid rejection.

Acknowledge Receipt of Addenda: NUMBER: _____

NUMBER: _____

NUMBER: _____

NUMBER: _____

LOUISIANA CONTRACTOR'S LICENSE NO.: (if applicable) _____

*** ALL BIDDERS MUST COMPLETE SECTION BELOW ***	
FIRM NAME: <u>Crmsco</u>	
SIGNATURE: (Must be signed here)	TITLE: <u>SALES</u>
PRINT OR TYPE NAME: <u>Jeff Devaux</u>	
ADDRESS: <u>1840 LKA Rd.</u>	
CITY, STATE: <u>GRETN, LA</u>	ZIP: <u>70001</u>
TELEPHONE: <u>(504) 835-7319</u>	FAX: <u>(504) 832-0820</u>
EMAIL ADDRESS: <u>Jeff@Crmscocom.com</u>	

TOTAL PRICE OF ALL BID ITEMS: \$ 2473.44

DATE: 2/01/2017

Page: 5

INVITATION TO BID FROM JEFFERSON PARISH - continued

BID NO.: 50-00118869

SEALED BID

ITEM NUMBER	QUANTITY	U/M	DESCRIPTION OF ARTICLES	UNIT PRICE QUOTED	TOTALS
			ONE TIME PURCHASE OF VARIOUS VALVES		
1	12.00	EA	0001 TB1025T HAYWARD PVC TU BALL VALVE FKM THD 1/4"	20 ⁰⁰	240 ⁰⁰
2	12.00	EA	0002 TB1050ST HAYWARD PVC TU BALL VALVE FKM THD 1/2"	20 ⁰⁰	240 ⁰⁰
3	12.00	EA	0003 TB1075ST HAYWARD PVC TU BALL VALVE FKM THD 3/4"	24.50	294 ⁰⁰
4	12.00	EA	0004 TB1100ST HAYWARD PVC TU BALL VALVE FKM THD 1"	29 ⁰⁰	348 ⁰⁰
5	12.00	EA	0005 TC10025T HAYWARD PVC TU BALL CHECK VALVE FKM THD 1/4"	22.50	270 ⁰⁰
6	12.00	EA	0006 TC10050ST HAYWARD PVC TU BALL CHECK VALVE FKM THD 1/2"	25.37	304.44
7	12.00	EA	0007 TC10075ST HAYWARD PVC TU BALL CHECK VALVE FKM THD 3/4"	28.50	342 ⁰⁰
8	12.00	EA	0008 TC10100ST HAYWARD PVC TU BALL CHECK VALVE FKM THD 1"	36.25	435 ⁰⁰
9	1.00	EA	0009 FREIGHT	Ø	Ø
			Purpose: these valves will replace valves in the West Bank Plant and spares These are direct replacement and can't be substituted.		
			Ship To: Westbank Water Plant 4500 Westbank Expressway Marrero LA 70072		
			Attn: Darren Hernandez		

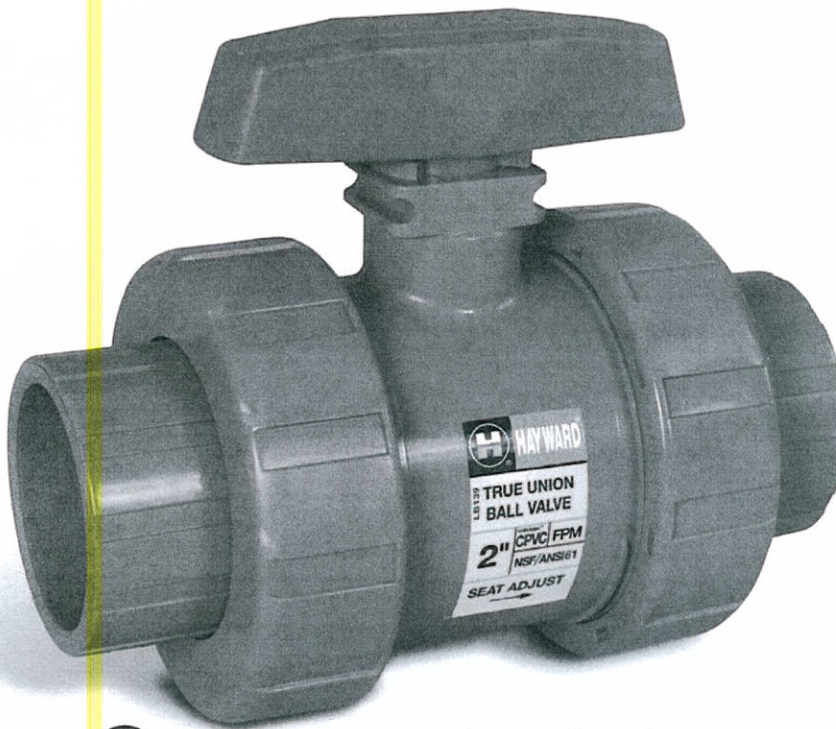
NSF

PVC and CPVC

**Now Available in
Platinum GFPP!**

TB Series True Union Ball Valves

1/4" TO 3/8" PVC AND
1/2" TO 2" PVC, CPVC AND GFPP

KEY FEATURES

- PVC, CPVC and GFPP
- Full Port Design
- Reversible PTFE Seats
- Double O-Ring Stem Seals
- Easily Actuated
- NSF/ANSI 61 Listed (PVC and CPVC)

OPTIONS

- Lockouts Available
- 2" Square Operating Nut
- Stem Extensions
- Pneumatic and Electric Actuators
- Spring Return Handle

MATERIALS

- PVC Cell Class 12454 per ASTM D1784
- CPVC Cell Class 23447 per ASTM D1784
- GFPP Cell Class 85580 per ASTM D4101
- FPM and EPDM O-Ring Seals

TECHNICAL INFORMATION

EXPLODED VIEW

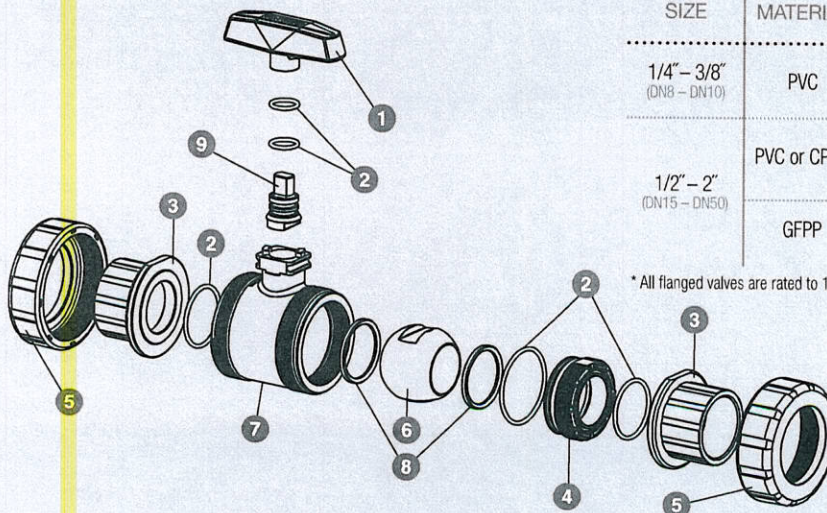

SELECTION CHART

SIZE	MATERIAL	END CONNECTION	SEALS	PRESSURE RATING
1/4" - 3/8" (DN8 - DN10)	PVC	Socket or Threaded	FPM or EPDM	250 PSI @ 70°F Non-Shock
1/2" - 2" (DN15 - DN50)	PVC or CPVC	Socket and Threaded or Flanged*		
	GFPP	Threaded or Flanged		150 PSI @ 70°F Non-Shock

* All flanged valves are rated to 150 PSI @ 70°F Non-Shock

TB Series True Union Ball Valves

1/4" TO 2" PVC, CPVC AND GFPP

TECHNICAL INFORMATION, CONTINUED

PARTS LIST

1. Handle
2. O-Ring Seals
3. End Connector
4. Seal Retainer
5. Union Nut
6. Ball
7. Body
8. PTFE Seat
9. Stem
10. Actuator Mounting Pad

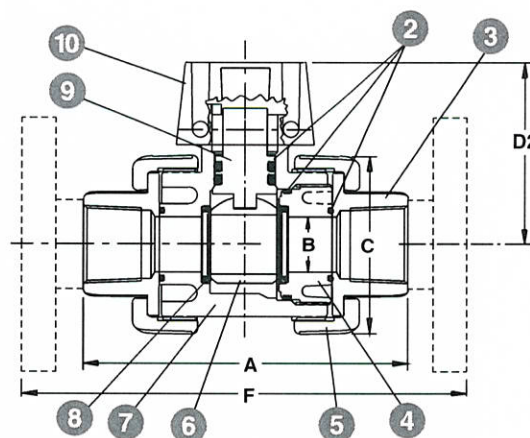
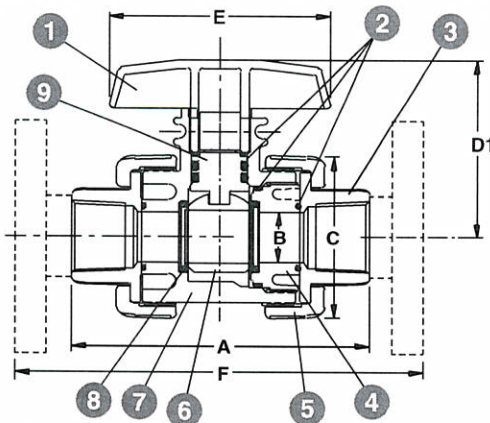

DIMENSIONS

SIZE in/DN	A in/mm	B in/mm	C in/mm	D1 in/mm	D2 in/mm	E in/mm	F in/mm	WEIGHT lbs/kg	
								SOC/THD	FLANGED
1/4/8	4.77/121	.50/13	2.25/57	2.81/71	2.63/67	3.50/89	N/A	.75/.34	N/A
3/8/10	4.77/121	.50/13	2.25/57	2.81/71	2.63/67	3.50/89	N/A	.75/.34	N/A
1/2/15*	4.77/121	.50/13	2.25/57	2.81/71	2.63/67	3.50/89	6.75/171	.75/.34	1.00/.45
3/4/20*	4.85/123	.75/19	2.63/67	3.02/77	2.81/71	3.50/89	7.13/181	.75/.34	1.00/.45
1/25*	5.44/138	.93/24	3.00/76	3.26/83	3.05/77	4.00/102	8.09/205	1.15/.52	2.15/.98
1-1/4/32*	6.30/160	1.50/38	4.00/102	3.92/100	3.48/88	5.00/127	9.19/233	2.15/.98	3.50/1.59
1-1/2/40*	6.85/174	1.50/38	4.00/102	3.92/100	3.48/88	5.00/127	9.88/251	2.15/.98	3.75/1.70
2/50*	8.00/203	1.94/49	4.75/121	4.43/113	4.00/102	5.00/127	11.4/290	3.80/1.72	6.30/2.86

Dimensions are subject to change without notice – consult factory for installation information

* Metric End Connections Available In: BSP – Straight Thread, BSP TR – Tapered Thread and Metric Socket

Cv VALUES

SIZE in/DN	Cv VALUES	SIZE in/DN	Cv VALUES	PRESSURE LOSS CALCULATION FORMULA
1/4/8	1.0	1/25	29.0	
3/8/10	2.8	1-1/4/32	75.0	$\Delta P = \left[\frac{Q}{C_v} \right]^2$
1/2/15	8.0	1-1/2/40	90.0	ΔP = Pressure Drop
3/4/20	16.0	2/50	150.0	Q = Flow in GPM
				Cv = Flow Coefficient

OPERATING TEMPERATURE/PRESSURE

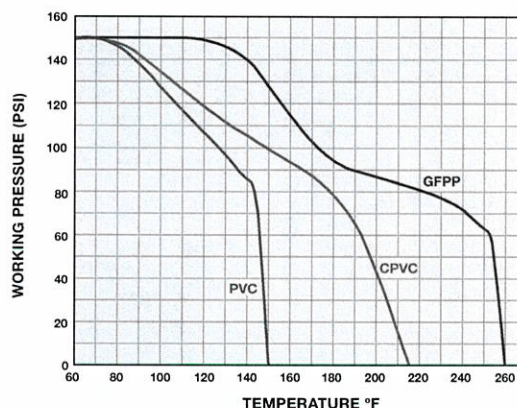

Hayward is a registered trademark
of Hayward Industries, Inc.
© 2015 Hayward Industries, Inc.

Contact Hayward Flow Control with questions: **USA:** 1-888-429-4635 • Fax: 1-888-778-8410 • One Hayward Industrial Drive • Clemmons, NC 27012 USA
Canada: 1.888.238.7665 • Fax: 1.905.829.3636 • 2880 Plymouth Drive • Oakville, ON L6H 5R4 Canada • Email: hflowcanada@haywardnet.com
Visit us at: www.haywardflowcontrol.com • E-mail: hflow@haywardnet.com



NSF

1/4" - 4"
PVC and CPVC



Ball check valve with foot
valve screen installed

TC Series True Union Ball Check Valves

1/4" TO 3/8" PVC, 1/2" TO 2" PVC, CPVC AND
PP AND 2-1/2" TO 6" PVC AND CPVC

KEY FEATURES

- PVC, CPVC and PP
- For Horizontal or Vertical Installation*
- 1/2" to 6" are Sure Block Design
- Square Cut Seat for Positive Sealing
- Seats with Minimum Back Pressure
- 1/4" and 3/8" are Trim Check Design

OPTIONS

- Foot Valve Screens

MATERIALS

- PVC Cell Class 12454 per ASTM D1784
- CPVC Cell Class 23447 per ASTM D1784
- PP per ASTM D4101
- FPM and EPDM O-Ring Seals

* For installation information, see IOM manual

TECHNICAL INFORMATION

EXPLODED VIEW

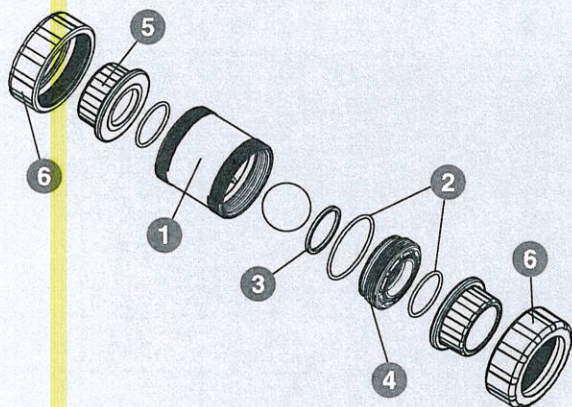

SELECTION CHART

SIZE	MATERIAL	END CONNECTION	SEALS	PRESSURE RATING
1/4" - 3/8"* (DN8 - DN10)	PVC	Socket or Threaded	FPM	150 PSI @ 70°F Non-Shock
1/2" - 2" (DN15 - DN50)	PVC or CPVC	Socket and Threaded or Flanged****	FPM or EPDM	235 PSI @ 70°F Non-Shock
	PP**	Threaded		
2-1/2" - 4" (DN65 - DN100)	PVC or CPVC	Socket, Threaded or Flanged	FPM or EPDM	150 PSI @ 70°F Non-Shock
6"*** (DN150)		Flanged		

* Trim Checks

** 2" PP is rated to 100 PSI @ 70°F Non-Shock

*** 4" valve venturied to 6"

**** All flanged valves are rated to 150 PSI @ 70°F Non-Shock

TC Series True Union Ball Check Valves

1/4" TO 3/8" PVC, 1/2" TO 2" PVC, CPVC AND PP AND 2-1/2" TO 6" PVC AND CPVC

TECHNICAL INFORMATION, CONTINUED

PARTS LIST

1. Body
2. O-Ring Seals
3. Square Cut O-Ring Seat
4. Seal Retainer
5. End Connector
6. Union Nut

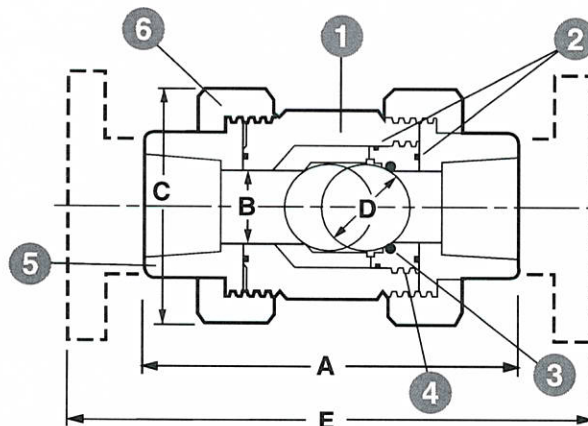

Ball check valve with foot valve screen installed

DIMENSIONS

SIZE in/DN	A in/mm	B in/mm	C in/mm	D in/mm	E in/mm	F in/mm	G in/mm	WEIGHT lbs/kg	
								SOC/THD	FLANGED
1/4/8	3.06/78	.31/8	1.38/35	.50/13	N/A	N/A	N/A	.13/.06	N/A
3/8/10	3.06/78	.31/8	1.38/35	.50/13	N/A	N/A	N/A	.13/.06	N/A
1/2/15	4.63/118	.50/13	2.25/57	.75/19	6.75/171	4.88/124	2.32/59	.75/.34	1.00/.45
3/4/20*	4.75/121	.75/19	2.63/67	1.00/25	7.13/181	5.00/127	2.60/66	.75/.34	1.38/.63
1/25*	5.25/133	1.00/25	3.00/76	1.25/32	7.75/197	5.88/149	2.88/73	1.25/.57	2.13/.97
1-1/4/32*	6.30/160	1.25/32	4.00/102	1.75/44	9.19/233	6.94/176	3.75/95	2.00/.91	3.75/1.70
1-1/2/40*	6.75/171	1.50/38	4.00/102	1.75/44	9.75/248	7.06/179	3.75/95	2.00/.91	3.75/1.70
2/50*	8.00/203	1.94/49	4.75/121	2.25/57	11.25/286	8.56/217	4.50/114	3.75/1.70	5.75/2.61
2-1/2/65*	10.68/271	2.88/73	6.56/167	3.25/83	14.38/365	11.25/286	2.50/64	10.00/4.54	14.00/6.35
3/80	10.56/268	2.88/73	6.56/167	3.25/83	14.38/365	11.25/286	2.50/64	10.00/4.54	14.00/6.35
4/100	12.94/329	4.00/102	8.56/217	4.25/108	17.00/432	14.63/372	4.25/108	17.00/7.71	25.00/11.34
6/150	N/A	4.00/102	N/A	4.25/108	19.19/487	N/A	N/A	N/A	30.20/13.70

Dimensions are subject to change without notice – consult factory for installation information

Hayward TC Ball Check Valves require a minimum of 2 PSI to seat and 1-1/2 PSI cracking pressure to open

* Metric End Connections Available In: BSP – Straight Thread, BSP TR – Tapered Thread and Metric Socket for PVC and CPVC Valves Only

Cv VALUES

SIZE in/DN	Cv VALUES	SIZE in/DN	Cv VALUES
1/4/8	1.0	1-1/2/40	45.0
3/8/10	3.0	2/50	130.0
1/2/15	4.8	2-1/2/65	170.0
3/4/20	7.7	3/80	250.0
1/25	11.0	4/100	400.0
1-1/4/32	25.0	6/150	340.0

PRESSURE LOSS CALCULATION FORMULA

$$\Delta P = \left[\frac{Q}{C_v} \right]^2$$

ΔP = Pressure Drop

Q = Flow in GPM

C_v = Flow Coefficient

OPERATING TEMPERATURE/PRESSURE

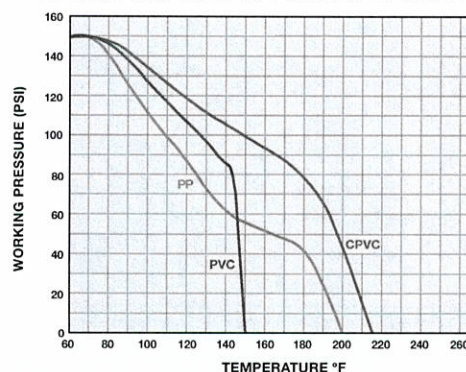

Hayward is a registered trademark
of Hayward Industries, Inc.
© 2015 Hayward Industries, Inc.

Contact Hayward Flow Control with questions: **USA:** 1-888-429-4635 • Fax: 1-888-778-8410 • One Hayward Industrial Drive • Clemmons, NC 27012 USA
Canada: 1.888.238.7665 • Fax: 1.905.829.3636 • 2880 Plymouth Drive • Oakville, ON L6H 5R4 Canada • Email: hflowcanada@haywardnet.com
Visit us at: www.haywardflowcontrol.com • E-mail: hflow@haywardnet.com