

LED EMERGENCY T8 TUBE **NEW**

Emergency T8 Series



PRODUCT DESCRIPTION:

E2's LED emergency driver products are the most efficient and convenient in the industry, consuming the least amount of energy in retrofit applications. The T8 LED tube's unique technology enables the use of an emergency battery pack built into the LED tube. This allows the tube to be powered on at 60% brightness when the electricity supply is cut off. This is one of the easiest and most convenient ways to replace a fluorescent system with an emergency ballast. The tube itself contains a 90-minute battery pack. ETL listed, DLC Standard listed and RoHS compliant.

FEATURES AND STANDARDS:

- Emergency battery backup for 90 mins or 1.5 hrs
- Test button and indicator lights for power, battery charging, motion sensor and malfunctioning in line with fire protection standards
- Internally isolated LED driver
- Built-in lithium batteries with over-charging and over-discharging protection (800x charge and discharge cycle lifespan)
- Double-Ended power bypass connectivity (default)
- Single-Ended power is an available model option
- No distortion and no yellowing light
- Light output greater than 120 lm/W
- ETL and DLC® Standard 4.4
- 50,000 Hours L70 Lifespan
- 5 year limited warranty

APPLICATION:

- Linear Replacement Lamp
- T8 Two-Foot, Four-Foot
- Internal Driver Lamp-Style Retrofit Kits (UL Type B)
- Emergency Lighting Applications including but not limited to Commercial and Industrial Buildings, Schools, Hotels, Apartments, Corridors and Stairways

TESTED DATA:

- Technical Requirements Version: 4.4
- Classification: Standard
- Light Output: 998 lm, 2319 lm
- Input Wattage: 8.2W, 18W
- Efficacy: >120 lm/W
- Power Factor: 0.9
- CCT: 4000K, 5000 K
- CRI: 80
- THD: <20 %
- Frequency: 50-60Hz
- Input Voltage: AC100-277V
- IP Rating: IP44
- Working Environment: -4°F-149°F
- Beam Angle: 220°
- Dimming Compatible: NO
- Mercury Content: No Hg
- Lens: Polycarbonate
- Base Type: Medium Bi-Pin G13
- Application: Double-Ended Bypass (Default) Singled end (Option)
- Dimensions: 2ft for 9W, 4ft for 18W
- Weight: 0.8 lbs

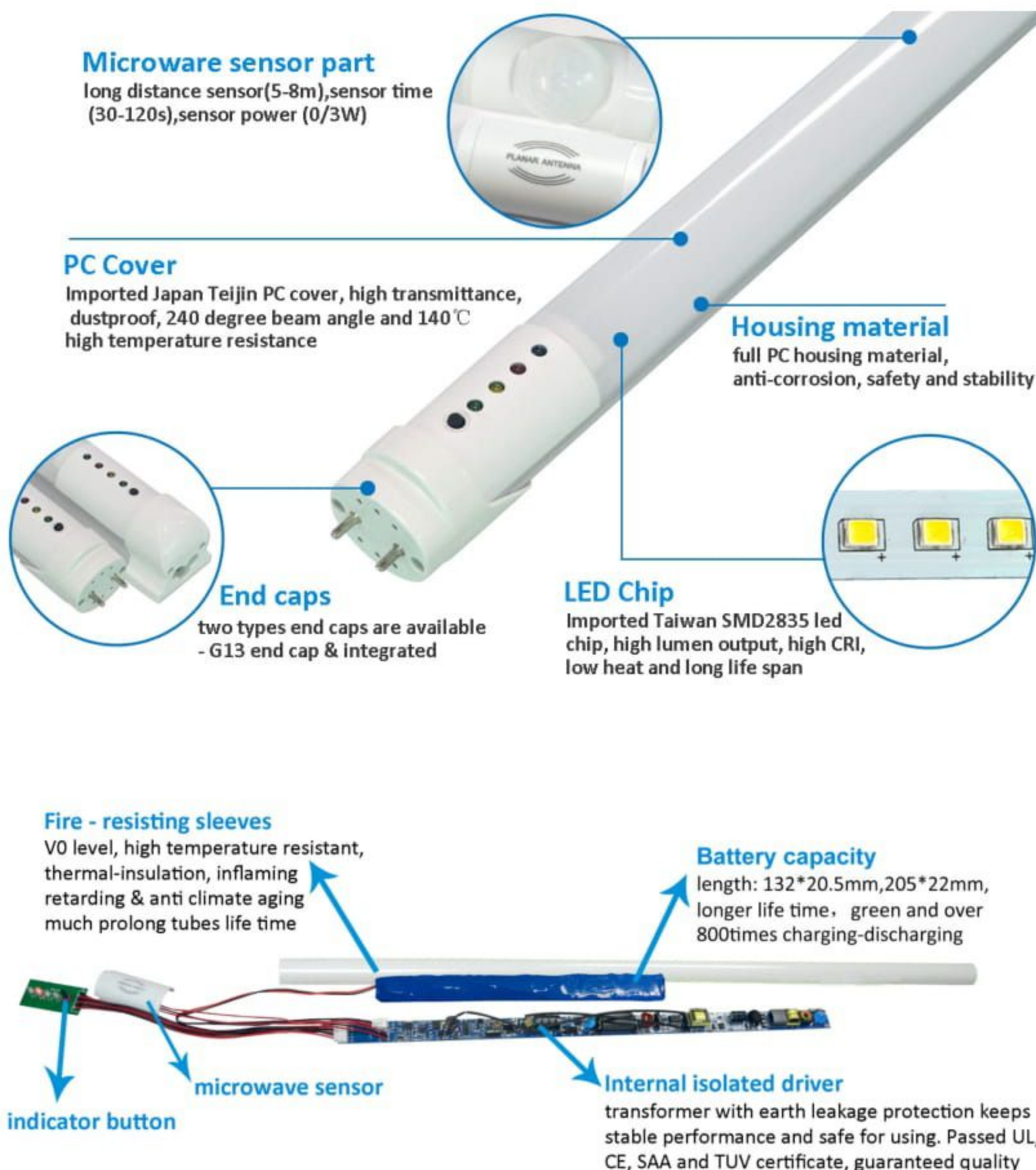

| Product Number | Wattage | Color | Certifications | Dimmable | Voltage | Lumens | Working Hours | CRI |
|--------------------|---------|--------|---------------------|----------|------------|--------|---------------|------|
| E2-T8-2ft-9W-EBBU | 9W | 4000K, | ETL & DLC® Standard | No | AC100-277V | 998 lm | 50,000hrs | 80Ra |
| E2-T8-4ft-18W-EBBU | 18W | 5000K | ETL & DLC® Standard | No | AC100-277V | 2319 m | 50,000hrs | 80Ra |

The dimming feature is only available with the integration of a microwave or PIR motion sensor.

DLC Screen Shot:

Model# E2-T8-2ft-9W-EBBU +Sensor [120V Only]

Manufacturer: E2 Lighting International inc.
Brand: E2 Lighting
Technical Requirements Version: 4.4
Date Qualified: 12/06/2018
Product ID: PLYQSW8GRAN5

Categorization

Main: Linear Replacement Lamp
General Application: T8 Two-Foot
Primary Use: Internal Driver/Line Voltage (UL Type B) Lamps
System Type: AC

Classification: standard
Is Parent Product: Yes
DLC Family Code: IIIMRV
Listing Status: Listed

| | | | | |
|--|---------------|--------------|------------------|------------------|
| Tested Data | Reported Data | Zonal Lumens | Spacing Criteria | Product Features |
| Family Data | | | | |
| Light Output: 998.79 lm Wattage: 8.21 W Efficacy (AC): 121.7 lm/W Power Factor: 0.913 CCT: 4999 K CRI: 81.9 Total Harmonic Distortion: 20.43 % | | | | |

Model# E2-T8-4ft-18W-EBBU [120V Only]

Manufacturer: E2 Lighting International inc.
Brand: E2 Lighting
Technical Requirements Version: 4.4
Date Qualified: 12/06/2018
Product ID: PLFKT672D1X9

Categorization

Main: Linear Replacement Lamp
General Application: T8 Four-Foot
Primary Use: Internal Driver/Line Voltage (UL Type B) Lamps
System Type: AC

Classification: standard
Is Parent Product: Yes
DLC Family Code: IIIMRW
Listing Status: Listed

Tested Data

Reported Data

Zonal Lumens

Spacing Criteria

Product Features

Family Data

Light Output: 2319.58 lm
Wattage: 18.15 W
Efficacy (AC): 127.8 lm/W
Power Factor: 0.987
CCT: 5002 K
CRI: 82.8
Total Harmonic Distortion: 17.01 %