



Techtop Industries

Nameplate and Performance Data

NAMEPLATE DATA		
Horsepower	60 Hz. 25	50 Hz. 25
Frame Size	324T	
Speed, RPM	1180	965
Voltage	230/460V	190/380V
# Phase	3	
Full Load Amps	63.8/31.9	74/37
Power Factor	0.81	0.855
Nominal Efficiency	93	90
3/4 Load Efficiency	92.6	-
Service Factor	1.15	1
Duty	CONT / S1	
Full Load Temp Rise °C	50	-
Enclosure	TEFC	
Ambient Temperature	40°C	
KVA Code	F	E
FL Amps. @ 208 V	70.55	-
Insulation Class	F	
NEMA Design	B	
Weight	571.1	
DE Bearing	6312C3	
NDE Bearing	6312C3	
dB No-Load	-	
Rotor Wk ² , Lb-Ft ²	7.251888	
Start Capacitor µF	-	
Start Capacitor V	-	
Run Capacitor µF	-	
Run Capacitor V	-	
Number of Leads	12	
Connection	2Δ/Δ	
Coil Resistance (Ω)	0.1935	

Motor Model:

GR3-CI-TF-324T-6-BR-D-25

Performance Load Values:

Performance values at High Voltage 60 Hz

% Load	Horsepower	Current, Amps	Input power,	Speed, RPM	Efficiency, %	PF
0	-	13.8300	0.5962	-	-	-
25	6.25	15.0800	5.31	1196.7	0.8784	0.4423
50	12.50	19.0900	10.13	1193.4	0.9205	0.6668
75	18.75	24.3100	15.08	1189.7	0.9276	0.7795
100	25.00	30.4600	20.17	1185.8	0.9246	0.8321
125	31.25	37.2800	25.41	1181.6	0.9175	0.8565

	Torque, Lb-Ft	% Full Load Torque	Speed, RPM	Current Amps.
Locked Rotor Torque	345.82	313.00	0	332.623
Pull-Up-Torque	167.94	152.00	243	-
Breakdown Torque	393.33	356.00	1044	-
Full Load	110.49	100	1185.8	30.460

Speed Torque Curve

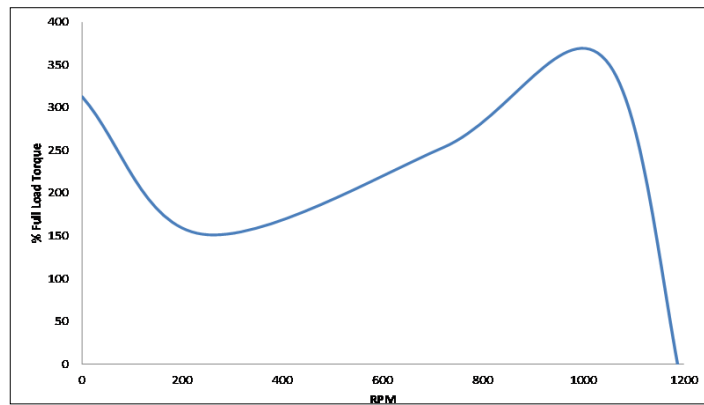

Dimensional Drawing

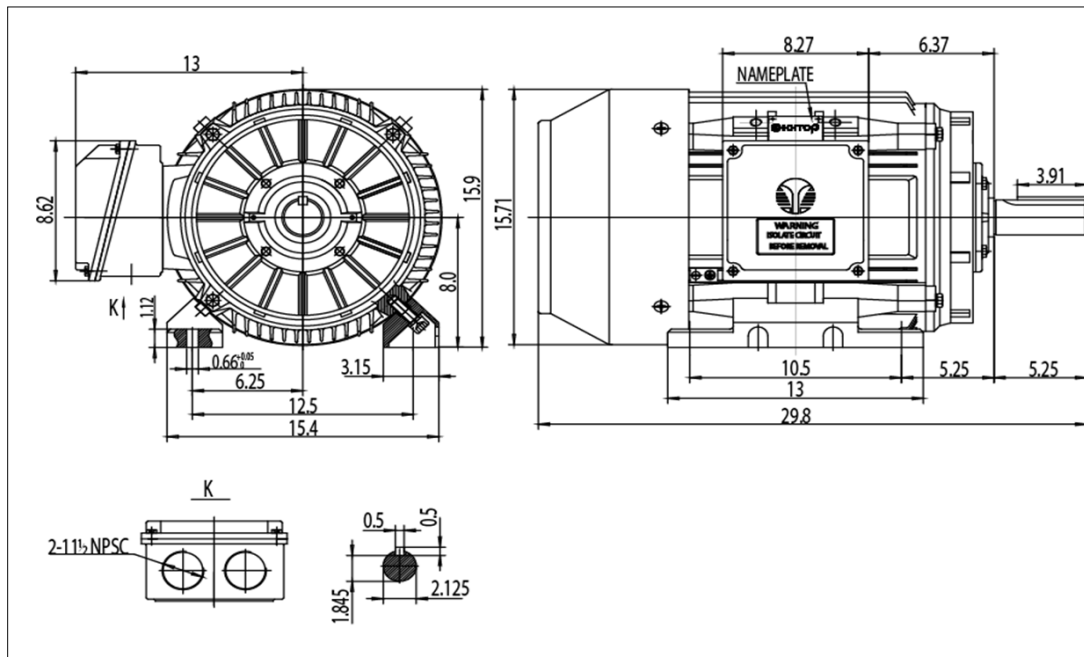

Techtop Industries
1268 Old Alpharetta Road,
Alpharetta, GA 30005
E-Mail at Info@techttopind.com