

All Public Work Projects are required to use the Louisiana Uniform Public Work Bid Form

All prices must be held firm unless an escalation provision is requested in this bid. Jefferson Parish will allow one escalation during the term of the contract, which may not exceed the U.S. Bureau of Labor Statistics National Index for all Urban Consumers, unadjusted 12 month figure. The most recently published figure issued at the time an adjustment is requested will be used. A request must be made in writing by the vendor, and the escalation will only be applied to purchases made after the request is made.

Are you requesting an escalation provision?

YES _____ NO XMAXIMUM ESCALATION PERCENTAGE REQUESTED N/A %INITIAL BID PRICES WILL REMAIN FIRM THROUGH THE DATE OF 12-31-19

For the purposes of comparison of bids when an escalation provision is requested, Jefferson Parish will apply the maximum escalation percentage quoted by the bidder to the period to which it is applied in the bid. The initial price and the escalation will be used to calculate the total bid price. It will be assumed, for comparison of prices only, that an equal amount of material or labor is purchased each month throughout the entire contract.

DELIVERY: FOB JEFFERSON PARISH

INDICATE DELIVERY DATE ON EQUIPMENT AND SUPPLIES

60 Days ARO

LOUISIANA CONTRACTOR'S LICENSE NO.: (if applicable)

N/A**THIS SECTION MUST BE COMPLETED BY BIDDER:**FIRM NAME: Comforts of Home Services IncADDRESS: 410 Rathbone Ave.CITY, STATE: Aurora, Illinois ZIP: 60506TELEPHONE: (630) 906-8002 FAX: (847) 574-7600EMAIL ADDRESS: Dan@Cohsi.com

In the event that addenda are issued with this bid, bidders MUST acknowledge all addenda on the bid form. Bidder must acknowledge receipt of an addendum on the bid form as indicated. Failure to acknowledge any addendum on the bid form will result in bid rejection.

Acknowledge Receipt of Addenda: NUMBER: #1NUMBER: #2

NUMBER: _____

NUMBER: _____

TOTAL PRICE OF ALL BID ITEMS: \$ 127,129.50AUTHORIZED SIGNATURE: [Signature]Daniel Fischer

Printed Name

TITLE: Senior Account Representative

SIGNING INDICATES YOU HAVE READ AND COMPLY WITH THE INSTRUCTIONS AND CONDITIONS.

NOTE: All bids should be returned with the BID NUMBER and BID OPENING DATE indicated on the outside of the envelope submitted to the Purchasing Department.

INVITATION TO BID FROM JEFFERSON PARISH - continued

BID NO.: 50-00125018

SEALED BID

ITEM NUMBER	QUANTITY	U/M	DESCRIPTION OF ARTICLES	UNIT PRICE QUOTED	TOTALS
1	1.00	EA	<p>ONE TIME PURCHASE OF TWO(2) RESTROOM TRAILERS</p> <p>0010 Transportable Comfort Station 8 foot 6 inch wide x 24 foot long</p> <p>wide body advantage series</p> <p>Contact: Scott Muhoberac 504-736-6999</p> <p>Needed for East Bank Maintenance</p> <p>(See word document for more information)</p>	\$63,564.75	\$63,564.75
2	1.00	EA	<p>0020 Transportable Comfort Station 8 foot 6 inch wide x 24 foot long</p> <p>wide body advantage series</p> <p>Contact: Scott Muhoberac 504-736-6999</p> <p>Needed for West Bank Recreation</p> <p>(See word document for more information)</p>	\$63,564.75	\$63,564.75

CORPORATE RESOLUTION

EXCERPT FROM MINUTES OF MEETING OF THE BOARD OF DIRECTORS OF
Comforts of Home Services
INCORPORATED.

AT THE MEETING OF DIRECTORS OF Comforts of Home Services
INCORPORATED, DULY NOTICED AND HELD ON JAN. 8, 2019,
A QUORUM BEING THERE PRESENT, ON MOTION DULY MADE AND SECONDED. IT
WAS:

RESOLVED THAT DANIEL FISCHER, BE AND IS HEREBY
APPOINTED, CONSTITUTED AND DESIGNATED AS AGENT AND ATTORNEY-IN-
FACT OF THE CORPORATION WITH FULL POWER AND AUTHORITY TO ACT ON
BEHALF OF THIS CORPORATION IN ALL NEGOTIATIONS, BIDDING, CONCERNS
AND TRANSACTIONS WITH THE PARISH OF JEFFERSON OR ANY OF ITS AGENCIES,
DEPARTMENTS, EMPLOYEES OR AGENTS, INCLUDING BUT NOT LIMITED TO, THE
EXECUTION OF ALL BIDS, PAPERS, DOCUMENTS, AFFIDAVITS, BONDS, SURETIES,
CONTRACTS AND ACTS AND TO RECEIVE ALL PURCHASE ORDERS AND NOTICES
ISSUED PURSUANT TO THE PROVISIONS OF ANY SUCH BID OR CONTRACT, THIS
CORPORATION HEREBY RATIFYING, APPROVING, CONFIRMING, AND ACCEPTING
EACH AND EVERY SUCH ACT PERFORMED BY SAID AGENT AND ATTORNEY-IN-
FACT.

I HEREBY CERTIFY THE FOREGOING TO BE
A TRUE AND CORRECT COPY OF AN
EXCERPT OF THE MINUTES OF THE ABOVE
DATED MEETING OF THE BOARD OF
DIRECTORS OF SAID CORPORATION, AND
THE SAME HAS NOT BEEN REVOKED OR
RESCINDED.



SECRETARY-TREASURER

01/08/19

DATE

Non-Public Works Bid

AFFIDAVIT

STATE OF Illinois

PARISH/COUNTY OF Kane

BEFORE ME, the undersigned authority, personally came and appeared: Daniel
Fischer, (Affiant) who after being by me duly sworn, deposed and said that
he/she is the fully authorized Representative of Comfort of Home Services Inc (Entity),
the party who submitted a bid in response to Bid Number 50-002508 to the Parish of
Jefferson.

Affiant further said:

Campaign Contribution Disclosures

(Choose A or B, if option A is indicated please include the required attachment):

Choice A _____ Attached hereto is a list of all campaign contributions, including the date and amount of each contribution, made to current or former elected officials of the Parish of Jefferson by Entity, Affiant, and/or officers, directors and owners, including employees, owning 25% or more of the Entity during the two-year period immediately preceding the date of this affidavit or the current term of the elected official, whichever is greater. Further, Entity, Affiant, and/or Entity Owners have not made any contributions to or in support of current or former members of the Jefferson Parish Council or the Jefferson Parish President through or in the name of another person or legal entity, either directly or indirectly.

Choice B X there are NO campaign contributions made which would require disclosure under Choice A of this section.

Debt Disclosures

(Choose A or B, if option A is indicated please include the required attachment):

Choice A _____ Attached hereto is a list of all debts owed by the affiant to any elected or appointed official of the Parish of Jefferson, and any and all debts owed by any elected or appointed official of the Parish to the Affiant.

Choice B X There are **NO** debts which would require disclosure under Choice A of this section.

Affiant further said:

That Affiant has employed no person, corporation, firm, association, or other organization, either directly or indirectly, to secure the public contract under which he received payment, other than persons regularly employed by the Affiant whose services in connection with the construction, alteration or demolition of the public building or project or in securing the public contract were in the regular course of their duties for Affiant; and

[The remainder of this page is intentionally left blank.]

That no part of the contract price received by Affiant was paid or will be paid to any person, corporation, firm, association, or other organization for soliciting the contract, other than the payment of their normal compensation to persons regularly employed by the Affiant whose services in connection with the construction, alteration or demolition of the public building or project were in the regular course of their duties for Affiant.

Signature of Affiant

Daniel Fischer
Printed Name of Affiant

SWORN AND SUBSCRIBED TO BEFORE ME
ON THE 9th DAY OF January, 2019.

Notary Public
Edgar Estrada-Lopez
Printed Name of Notary



Notary/Bar Roll Number

My commission expires March 8th 2021



JEFFERSON PARISH

Department of Purchasing

Michael S. Yenni
Parish President

Renny Simno
Director

January 03, 2019

ADDENDUM # 1

Bid No.: 50-00125018

Bid Opening Date: 01/10/2019

For: ONE TIME PURCHASE OF TWO (2) RESTROOM TRAILERS FOR THE JEFFERSON PARISH
DEPARTMENT OF PARKS AND RECREATION

CLARIFICATION:

Please disregard the La Dealers License number requirement. It doesn't pertain to this bid.

Sincerely,

A handwritten signature in blue ink, reading "Donna M Evans", is written over a horizontal line.

Donna M Evans, Buyer II
Jefferson Parish Purchasing Department

Bidders must acknowledge all addenda on the bid form. Bidder acknowledges receipt of this addendum on the bid form as indicated. Failure to do so will result in bid rejection.

This addendum is a part of the contract documents and modifies the original bidding documents and specifications. The contents of this addendum shall be included in the contract documents. Changes made by this addendum shall take precedence over the documents of earlier date.



JEFFERSON PARISH

Department of Purchasing

Michael S. Yenni
Parish President

Renny Simno
Director

January 15, 2019

ADDENDUM # 2

Bid Number: 50-00124814

Bid Date: January 29, 2019

For: Pre-placed emergency contract for two (2) years for the emergency supply of portable toilets immediately before, during and after a disaster event for the Jefferson Parish Department of Emergency Management, agencies and municipalities

The above stated bid number has an address change for bid responses to be *hand delivered*, due to the relocation of our office as a result of water damage. The address of Westbank Purchasing Department, Suite 4400, Jefferson Parish General Government Building, 200 Derbigny Street, Gretna, LA 70053 is closed until further notice.

This bid response can be **hand delivered or mailed** to the Eastbank Purchasing Department, Suite 404, Jefferson Parish Joseph S. Yenni Building, 1221 Elmwood Park Blvd., Jefferson, LA 70123 or to our re-located office at the Paul D. Connick, Sr. Emergency Operations & Communications Center located at 910 3rd Street, Gretna, LA 70053. At no charge, bidders may submit via Jefferson Parish's electronic procurement page by visiting www.jeffparishbids.net, to register for this free site.

The bid opening will be held at 2 pm on the assigned date above at Paul D. Connick, Sr. Emergency Operations & Communications Center located at 910 3rd Street, Gretna, LA 70053. This is a secured facility however we will have a staff member at the main gate starting at 1 pm to allow access into the building.

Please call our main phone line, 504-364-2678, if assistance is required or email the buyer assigned on the bid form.

Sincerely,

Daphne Nelson

Daphne Nelson, Buyer II
Jefferson Parish Purchasing Department



JEFFERSON PARISH

Department of Purchasing

Michael S. Yenni
Parish President

Renny Simno
Director

**Bidders must acknowledge all addenda on the bid form. Bidder acknowledges receipt of
This addendum on the bid form as indicated. Failure to do so will result in bid rejection.**

This addendum is a part of the contract documents and modifies the original bidding documents and specifications. The contents of this addendum shall be included in the contract documents. Changes made by this addendum shall take precedence over the documents of earlier date.

RESTROOM, SHOWER, COMBINATION AND SPECIALTY TRAILER SALES

CUSTOMER (BUYER)

Name: Jefferson Parish
Address: 200 Derbigny Street
General Government Building,
Suite 4400
City, State: Gretna, LA
Zip: 70053

Phone: 504-364-2691

Fax:
Email: dmevans@jeffparish.net

SHIP TO:

Name: Jefferson Parish Department of Parks and Recreation

Address: TBD
City, State: Gretna, LA 70053
Contact: Donna Evans
Phone: 504-364-2691

9 Station 29' WB Restroom Trailer with 1050 gallon waste tank

Interior Color: Basic Interior Package (White FRP) Exterior Color: White

Quantity: 2
Price Each: \$49,501.00

BASE PRICE

\$99,002.00

STANDARD ITEMS

- A/C (13,500 BTU) and Heat Strip (5,600 BTU)
- Heavy Duty Fold-up Alum. Steps & Handle
- Timed Faucets
- Oversized Structural Steel Beams
- Steel Construction (No Wood Framing)
- HD Tube Framed Doors & Hydraulic Closures
- Poly Insulation
- Smooth Aluminum Exterior Siding
- One Piece Aluminum Seamless Roof
- FRP (fiberglass wall panels)
- Scissor Jack Levelers
- Dexter (ITS) Independent Torsion Axles
- Battery Powered Trailer Runaway Protection
- Keyed alike Locks
- Premium LED Trailer Lighting
- Commercial PEX Water Lines
- E-Z Lube Hubs
- LPG on Demand water heater - shower trailers
- Electric Brakes
- 2- 5/16" Trailer Receiver
- Chip Resistant Undercoating
- Marine Grade Sub Floor
- Waste Tank Sight Gauge
- Vinyl sheet flooring

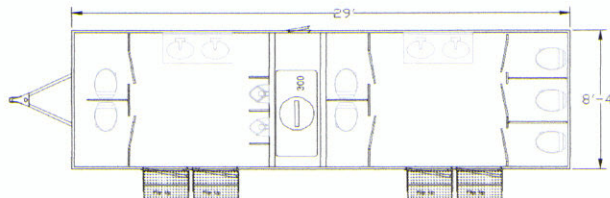

See the next page for Optional Items

Pictures are for reference only and may not reflect the final product

OPTIONAL ITEMS, DELIVERY, AND TOTAL COSTS

2	Options listed on page 2	\$15,464.00	\$	30,928.00
Sub Total:		\$	129,930.00	
Applied discount to Sub Total		Mult-Trailer	5.00%	\$ (6,496.50)
Sales Tax (when applicable)		State:	Tax Rate:	\$ -
1848	Delivery Charge per Mile (2 Trailers at 924 miles per)	\$	2.00	\$ 3,696.00

FINAL PRICE

\$127,129.50

50% or PO Due upon order	\$	63,564.75
50% Due Upon Completion	\$	63,564.75

Notes:

OPTIONAL ITEMS (some items may increase lead time)

Qty	Option	\$/ea	Total \$
	Interior upgrade to laminated two tone walls from FRP panels (per trailer foot)	\$70	\$0
	Interior upgrade to Grey Laminate walls with Barnwood accent wall from FRP panels (per trailer ft) New for 2018	\$90	\$0
	Interior upgrade to laminate walls with wainscoting from FRP panels (per trailer foot)	\$110	\$0
	Upgrade to 6 panel oak doors from high privacy metal partition doors (per door)	\$300	\$0
29	Wash down package (aluminum interior trim caulked along bottom so walls can be scrubbed) per trailer foot. (FRP Basic Interior Only)	\$35	\$1,015
	Generator mount on tongue of trailer with diamond plate encasement	\$1,000	\$0
	Custom vinyl wrap of exterior of trailer (Customer to supply graphics for wrapping) (per sq. ft.)	\$20	\$0
	Upgrade to Non Stock Aluminum (Stock Aluminum : White, Pewter, Charcoal)	\$250	\$0
	Upgrade to Non Stock Laminate (Stock Laminate : Linen, Chocolate, Wedding Cake, Feather Grey)	\$250	\$0
	Upgrade to Non Stock Partition Color (Stock Partition : Sahara, Slate)	\$250	\$0
	Remote Monitoring Application (Deep Cycle Battery Required)	\$850	\$0
	Solar Panel Charging (per solar panel)	\$700	\$0
	Deep Cycle Battery (per battery)	\$250	\$0
	12 volt Package with LED Interior Lighting (per trailer foot)	\$50	\$0
	Aluminum diamond plate fold up ramp (to be utilized with the drop box units)	\$3,300	\$0
	Lowering Trailer with fold up Ramp on Rear (Removal of Tires and Bulldog Jacks)	\$3,800	\$0
	Aluminum sectional ramp with 5' platform & railing (for wheel Chair access) Quick Easy Setup (add \$900 for CA)	\$6,600	\$0
	Lowering trailer with fold up ramp on rear (Wheelchair access) One Button Execution	\$7,800	\$0
	Lowering ADA box with fold up ramp on rear. Wheelchair access, hydraulic lowering	\$9,800	\$0
			\$0

Qty	Option	\$/EA	Total \$
29	Coin Rubber Floor (per trailer foot)	\$70	\$2,030
	6 Lug Aluminum Wheels (each)	\$110	\$0
	Increase Trailer by 1ft	\$750	\$0
3	Non-Powered Vent/Skylight (each)	\$120	\$360
	Powered Vent/Skylight (each)	\$170	\$0
3	Vent Cover, keeps rain out (each)	\$60	\$180
	Exterior Light (each)	\$185	\$0
4	Exterior Light (each) LED	\$210	\$840
1	Transformer for LED Lights	\$125	\$125
	Diamond Plate rock guard	\$400	\$0
1	Spare tire mounted	\$350	\$350
1	Utility Room w/ door	\$550	\$550
	Vacant/Occupied LED Indicators	\$125	\$0
	Water tank/pump, 105/140 gallons (Lowering/Normal)	\$780	\$0
	Water tank/pump, 225 gallons	\$890	\$0
1	Water tank/pump, 300 gallons	\$1,250	\$1,250
	Water tank & pump, 400 gallons	\$1,350	\$0
	Hot Water Heater (cabinet/utility)	\$275	\$0
	Wall heaters (each)	\$210	\$0
	Winter Package (per trailer foot)	\$50	\$0
	Arctic Package (per trailer foot)	\$100	\$0
29	Upgrade to fiberglass subfloor (per trailer foot)	\$50	\$1,450
	Outlets-GFI protected	\$120	\$0
	Replace LPG tankless with electric	\$240	\$0
	Dual 40# propane tanks mounted on tongue	\$500	\$0
			\$0

Qty	Option	\$/ea	Total \$
	Upgrade to Std Residential Toilet	\$380	\$0
	Add Toilet	\$450	\$0
	Add Urinal	\$450	\$0
	Corian Style Countertop (per Sink)	\$150	\$0
	Single sink to Single Cabinet	\$350	\$0
	Single Sink to Double Sink Solid	\$975	\$0
	Double Roll Toilet Paper Dispenser	\$22	\$0
	Stainless Steel C-Fold Paper Dispenser	\$90	\$0
	Enmotion Hands Free Paper Towel Dispenser	\$120	\$0
	Foaming or Liquid Soap Dispensers	\$40	\$0
	Hands Free Gojo Soap Dispensers	\$90	\$0
	Stainless Steel Garbage Can (each)	\$125	\$0
	Sanitary Napkin Disposal SS (each)	\$50	\$0
	Baby Changing Station	\$275	\$0
	Player	\$550	\$0
	Electric Hand Dryer	\$650	\$0
	Single Framed Mirror	\$190	\$0
	Double Framed Mirror	\$280	\$0
	Fold Down Seat (15")	\$205	\$0
	Extra sink (where available)	\$475	\$0
	Upgrade to vessel sink (per sink)	\$150	\$0
	Single sink to single cabinet (custom)	\$600	\$0
	Single sink to double sink solid (custom)	\$1,200	\$0
7	Per Stall)	\$972	\$6,804
2	Per Divider)	\$255	\$510
			\$0

Options selected are highlighted in blue.

OPTIONS PRICE
\$15,464.00
AGREEMENTS:

*Standard Terms are **50% payment to start an order**, remaining due before delivery. PO's are acceptable from most government agencies and large corporations.

*Buyer Must Agree to Comforts of Home's Terms and Conditions sheet.

***Final payment of unit will be due upon completion and before delivery unless special arrangements are made**

*Items are the sole property of Comforts of Home Services Inc until full payment is made and must be turned over if payment isn't made within 90 days of delivery.

*It is understood that no specific certifications, stamps or seals are provided with this trailer. Such items may be made available from a third party, at an additional cost.

Any requests for these must be made prior to the production of the trailer, and will affect lead time.

*It is the purchasers responsibility to research and provide us with any codes or build standards unique to you area that affect the trailer construction or use.

*Quoted lead times are estimated. Production times may vary due to circumstances beyond our control. Once the deposit is received, your order may not be cancelled or refunded.

I approve the Trailer specs and options and terms as listed above.

Signature: _____

Date: _____

Print Name: _____

Transportable Comfort Station To be built in accordance with specifications and drawing number 1813-A01 and equipped with the following:	
Women's Side	Women's Side
5 - Toilets with stainless steel partitions 2 - Lavatory in vanity with mirror 2 - Entry/exit doors No wood products used to build	Meets Meets Meets Framing of Vanity Cabinets will be 2x4 wood construction material
Men's Side	Men's Side
2 - Toilets with stainless steel partitions 2 - Porcelain Urinals 2 - Lavatory in vanity with mirror 2 - Entry/exit doors No wood products used to build	Meets Meets Meets Meets Framing of Vanity Cabinets will be 2x4 wood construction material
Additional Items	Additional Items
1 - 1000 gallon waste storage (Approximately) Air conditioning with heat	Exceeds - 1050 gallon waste storage Meets
General Specifications	General Specifications
Chassis and Frame	Chassis and Frame
Heavy duty 12 inch x 4 inch 16 pound structural steel wide flange main beams 2 inch x 2 inch x 16 gauge galvanized steel tubing floor joists 16 inch O.C. Heavy duty extruded aluminum top rail One (1) 10,000 pound tongue mounted frame jack Four (4) 7,000 pound leveling jacks, one at each corner Two (2) axles with electric brakes and emergency breakaway kit 2 -5/16 inch ball hitch, bumper pull 1 Spare tire with wheel	10" HR Channel steel frame 1 1/2" x 1" 14 guage steel tubing floor joists 16" O.C. Meets Meets Meets Meets Meets Meets
Exterior Walls, Roofing and Insulations	Exterior Walls, Roofing and Insulations
Framing will be commerical galvanized stud with composite materials on the floor walls and ceiling R-11 insulation in walls, ceiling and floor .040 thick smooth aluminum siding with baked on white enamel finish .040 thick seamless one piece aluminum roof, maintenance free, gastened to the top rail with all fastener penetrations located outside the unit to eliminate water leaks	Exceeds - Exterior framing of walls, and ceiling are structural steel tubing with composite materials on walls and ceiling. Flooring is a 1/2" thick fiberglass subfloor. Meets Meets Meets
Interior Wall, Ceiling and Flooring	Interior Wall, Ceiling and Flooring
Seamless Fiberglass Reinforced (FRP) laminated to composite material seams vinyl trimmed and sealed with a high quality silicone sealant to provide a very durable and waterproof interior Composite material sub floor Seamless, non-slip rubberized floor coved up the walls to provide a very durable waterproof floor Textured Fiberglass Reinforced (FRP) interior walls	Meets Exceeds - Marine Grade Fiberglass Meets with the exceptiton of the coved up walls. Our Wash Down Package will create the same durable waterproof floor as specified. Meets
Electrical	Electrical
Four foot, 2 tube flourescent light LED Fixtures, rated for wet locations, includes positive latches to secure the diffuser, operated by breaker Two roof mounted A/C unit with 13,500 BTU's cooling and 5,600 BTU's heating 20 amp, NEMA 3R (Weathertite) Panel Box(es), Located on the rear wall 120v/60hz/1 DOT approved running lights Wall mounted exterior LED Lights at entry/exit doors	Specification has conflicting requirement of flourescent light and LED. 4' Vapor barrier flourescent lighting, rated for wet locations will be utilized. Meets Meets - will be located in the utility room Meets
Plumbing and Interiors Facilities	Plumbing and Interiors Facilities
Parish water hookup with pressure regulator Parish sewer hooop with 3 inch slide valve and 2 inch camlock fitting with cap Steel waste tank, sandblasted and coated with a coal tar epoxy, mounted under trailer with cleanout and sight glass Low consumption flushing Thetford toilets with staniless steel partitions and doors, with transportation locks and heavy duty extruded aluminum clamp on, bolt thru partition hardware Porcelain covered steel sinks with water saving faucets in locking aluminum vanity cabinet with mirror Plumbing lines are high density cross linked polyethylene tubing with brass swaged lock fittings Wall hung porcelian urinals with stainless steel blinds and water saving flush valves 14 inch x 14 inch domed skylight roof vents two (2) in Women's Side and One (1) in the Men's Side On board fresh water, consists of pump, bladder tank, pressure switch, cross-over valves and 300 gallon tank installed in a locking enclosure on the rear platform	Meets Meets Exceeds - 3/8" thick polymer rotationally molded waste tanks with no seams to eliminate any tank failures in the future (Account for cleanout) Meets with the exception of Brand of Toilet. Our standard is the Dometic Traveler series low consumption flushing toilet Vanity cabinets will be FRP Base with aluminum trailer with lockable door, faux marble one piece molded double sink with water saving faucets and mirror (Please refer to picture on Page 1 of Quote) Exceeds - Commerical grade high pressure Pex tubing. Wall hung porcelian urinals with stainless steel blinds and water saving waterless urinals Meets Meets with the exception of being located in utility room in the center of the trailer. Please refer to layout drawing on Page 1

Doors and Steps		Doors and Steps	
<p>Heavy duty custom built doors with galvanized steel cores, aluminum exterior skins, FRP interior skins sandwiched between an aluminum extruded trim channel, weather protective neoprene bulb seal, drip shield, continuous hinge with vinyl dust cover, hydraulic closer, pull handle and dead bolt locks keyed alike</p> <p>Heavy duty fold out steps with large platforms and handrails with aluminum privacy screens on front and rear entry/exit doors</p> <p>Side entry doors to have heavy duty pull out fold down steps and folding handrail</p> <p>Exit doors and only deadbolts, no interior lock</p> <p>Exit signage on the interior of exit doors</p>		<p>Heavy duty commercial grade aluminum doors with interior and exterior skin, heavy duty interior kick plate, neoprene bulb seals, drip cap, HD 5 hinge system, hydraulic closer, pull handle and deadbolts keyed alike.</p> <p>Heavy duty aluminum fold up steps with handrails - all entry / exit doors</p> <p>Meets with the exception that all four doors are on the same side of trailer</p> <p>Meets</p> <p>Meets</p>	
Additional Items		Additional Items	
<p>A Louisiana's State Dealer License is required in accordance with LA RS 32:1254 ET SEQ. Vendor must provide a Louisiana Dealer's License Number with your bid.</p> <p>Warranty</p> <p>Manuals: (2) Parts, (2) Service Manuals, (2) Wiring Diagrams if manufacturer still provides, If no manuals, CD's will be accepted</p> <p>Safety: Must meet or exceed all federal and state safety standard</p>		<p>Per Addendum #1 - 50-00125018 This requirement doesn't pertain to this bid</p> <p>Please Refer to attached Warranty Document</p> <p>Meets</p> <p>Meets</p>	

Warranty

Comforts of Home Services Inc COHSI (warrantor), of Montgomery Illinois hereby provides a 5 year limited warranty on our trailer frame and axles and a 2 year limited warrantee on the trailer as a whole. Sealant, electrical components, hydraulics, hoses, wall coverings, trim and paint are warranted for 1 year. The warrantor guarantees the product against defects in materials and workmanship. The warranty described in this agreement is in lieu of all other warranties, expressed or implied from COHSI or its suppliers. This warrantee shall apply to the retail consumer (original purchaser), as shown on the sales agreement.

Certain individual components are warranted by their respected manufacturers' warranties and therefore are excluded from the limited warranty provided by the warrantor. These components include, but are not limited to; tires, wheels, axles, couplers, jacks, light fixtures, windows, doors, heaters, air conditioners, toilets, sinks, faucets, pumps, etc. Warranty claims must be filed with the respective component manufacturers' warranty department.

This limited warranty is void if the product:

1. Is not properly maintained and/or inspected.
2. Is neglected, abused or misused.
3. Is overloaded or made to perform beyond recommended specifications.

The limited warranty is also void if damage results from continued use after a suspected defect is or should have been discovered. The warrantor reserves the right to make the final determination as to whether any of the above exclusions may nullify a warranty claim.

The warranty shall not pay nor make provisions for:

1. Service charges; towing charges; and transportation charges, which are the responsibility of the purchaser.
2. Loss of time, inconvenience; loss of use; rental substitution equipment; loss of revenue; or other commercial or personal loss.
3. Loss or damage to any and all contents.
4. Defacing; scratches; dents; chips; and tears, on any surface, not caused by the warrantor.

Furthermore the warrantor does not warranty any modification(s) made to either the interior or exterior of the product, even if damage occurs as a result of warranty claim. The warrantor may not cover items that can be maintained or repaired using basic human skills in a short time; for example, tightening a leaky hose/pipe or other item, replacing/tightening screws, and other simple quick repair and maintenance type items.

Please refer to the products owner's manual, or authorized representative of the warrantor, for instructions on filing a warranty claim. The provisions of the limited warranty shall be interpreted and governed pursuant to the laws of the State of Illinois.