



MANNING
Architecture Interiors Planning

PROFESSIONAL ARCHITECTURAL AND ENGINEERING SERVICES ON AN AS-NEEDED BASIS FOR ARCHITECTURAL TYPE PROJECTS LOCATED THROUGHOUT THE PARISH FOR AN APPROXIMATE TWO-YEAR PERIOD

**JEFFERSON PARISH
SOQ 23-001
JANUARY 19, 2023**

Submitted By:

Manning, APC

650 Poydras Street, Ste. 1250

New Orleans, LA 70130-6101

Phone: (504) 412-2000

Fax: (504) 412-2001

Primary Contact:

Dominic A. Willard, Jr, AIA

P: 504.412.2000

daw@manning.xyz



TEC Professional Services Questionnaire

A. Project Name and Advertisement Resolution Number:

Professional Architectural and Engineering Services on an as-needed basis for architectural type projects located throughout the Parish for an approximate two-year period.

Resolution Number 140999

B. Firm Name & Address:



650 Poydras St., Ste. 1250
New Orleans, LA 70130

C. Name, title and contact information of Principal, as defined in Section 2-926 of the Jefferson Parish Code of Ordinances, who is a registered, licensed architect, professional engineer, or surveyor in the State of Louisiana:

Wm. Raymond Manning, FAIA

Founder | CEO
504-412-2000
wrm@manning.xyz

D. Name and contact information of employee who is a registered and licensed architect, professional engineer, or surveyor in the State of Louisiana in the applicable discipline. A subcontractor may be substituted here only if the advertised Project requires more than one discipline.

Dominic Willard, AIA

504-412-2000
daw@manning.xyz

E. Please provide the number of employees whose primary function corresponds with each category:

<u>4</u>	Administrative	<u> </u>	Estimators	<u> </u>	Specification Writers
<u>6</u>	Architects (Licensed)	<u> </u>	Geologists	<u> </u>	Structural Engineers
<u> </u>	Chemical Engineers	<u> </u>	Geotechnical Engineers	<u>5</u>	Graduate Architects
<u> </u>	Civil Engineers	<u>1</u>	Interior Designers	<u>6</u>	Project Managers
<u> </u>	Construction Inspectors	<u> </u>	Landscape Architects	<u> </u>	Clerical
<u> </u>	Ecologists	<u> </u>	Land Surveyor	<u> </u>	Grant/Funding Specialist
<u> </u>	Electrical Engineers	<u> </u>	Mechanical Engineers	<u> </u>	Sanitary Engineers
<u> </u>	Engineer Intern	<u> </u>	Environmental Engineers	<u> </u>	
<u> </u>	Professional Land Surveyors			<u>22</u>	TOTAL

F. Is this submittal by a JOINT-VENTURE? Please check: YES NO X

If marked "No" skip to Section I. If marked "yes" complete Sections G-H.

TEC Professional Services Questionnaire

G. If submittal is by JOINT-VENTURE, list the firms participating and outline specific areas of responsibility (including administrative, technical, and financial) for each firm. Please attach additional pages if necessary.

1.

N/A

2.

N/A

H. Has this JOINT-VENTURE previously worked together? Please check:

YES _____ NO _____

I. List all subcontractors anticipated for this Project. Please note that all subcontractors must submit a fully completed copy of this questionnaire, applicable licenses, and any other information required by the advertisement. See Jefferson Parish Code of Ordinances, Sec. 2-928(a)(3). Please attach additional pages if necessary.

Name & Address:	Specialty:	Worked with Firm Before (Yes or No):
1. Julien Engineering & Consulting, Inc. 2916 General De Gaulle Dr. #200 New Orleans, LA 70114	Structural Engineer	Yes
2. H. Davis Cole & Associates, LLC 1340 Poydras St., #1850 New Orleans, LA 70112	Civil Engineer	Yes
3. Salas O'Brien 1582 Magazine St. New Orleans, LA 70130	Mechanical, Electrical, and Plumbing Engineer	Yes

J. Please specify the total number of support personnel that may assist in the completion of this Project:

6

TEC Professional Services Questionnaire

K. List the professional in charge, key persons, specialists, and individual consultants anticipated for this Project and provide their relevant information below. If necessary, please attach additional documentation (i.e. resume) that demonstrates the employment history and experience of the Firm's key persons that may assist in the completion of this Project. Please attach additional pages if necessary.

PROFESSIONAL IN CHARGE OF PROJECT:

Name & Title:

Dominic Willard, AIA
Principal & Architect

Project Assignment:

Principal in Charge

Name of Firm with which associated:

Manning, APC

Years' experience with this Firm:

19 Years

Education: Degree(s)/Year/Specialization:

Bachelor of Architecture, Tulane University, 2003
Master of Architecture, Tulane University, 2004

Active registration: Year first registered/discipline:

Louisiana Architect - #7328 - 2010

Other experience and qualifications relevant to the proposed Project.

Dominic Willard is a licensed architect and LEED Green Associate. He is experienced in all phases of the design and construction process, from programming and design development through construction completion. Mr. Willard's thoughtful and comprehensive approach to project management have made him a natural leader on projects, including Ochsner School of Nursing and Allied Health at Delgado Community College, Tulane University Center for Intercultural Life and Academic Equity, Nora Navra Library, Dillard University Lawless Chapel and Assembly Hall Restoration, Fulton Street Pedestrian Mall, Delgado Workforce Development and Culinary Arts, and NOLA Public Schools Program Management.

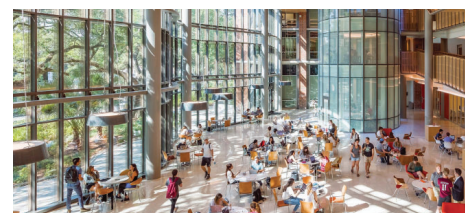

TEC Professional Services Questionnaire

KEY PERSON, SPECIALIST, OR INDIVIDUAL CONSULTANT:

Name & Title:

Tighe Kirkland, Assoc. AIA
Principal

Project Assignment:

Architectural Design

Name of Firm with which associated:

Manning, APC

Years' experience with this Firm:

13 years

Education: Degree(s)/Year/Specialization:

Bachelor of Architecture, Rhode Island School of Design, 2005
Bachelor of Fine Art, Rhode Island School of Design, 2005

Active registration: Year first registered/discipline:

Associate AIA
LEED Green Associate

Other experience and qualifications relevant to the proposed Project.

Tighe Kirkland is a LEED Green Associate and project manager on corporate, civic, hospitality, and planning projects. She has developed longstanding relationships with clients through her dedicated work and unwavering commitment to clients' goals. She is also a team builder with other partner firms and consultants. This collaborative and relational role has been important in coalescing partnerships with clients and professionals that resulted in dynamic projects like the Concessions at MSY and repeat work at the New Orleans Morial Convention Center, most recently the completion of Linear Park. Tighe's experience also includes the World Bank Group in Nigeria, Tate Etienne Prevost Interpretive Center and Senior Living, Fortune 100 office space in multiple locations, and the New Orleans East Hospital Master Plan.

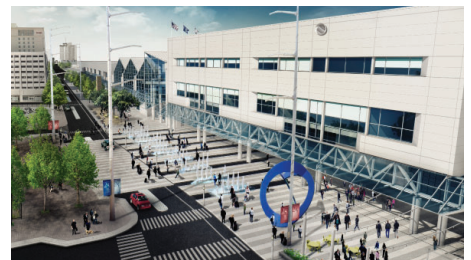

TEC Professional Services Questionnaire

KEY PERSON, SPECIALIST, OR INDIVIDUAL CONSULTANT:

Name & Title:

Ryan Bertucci, AIA

Architect

Project Assignment:

Project Manager

Name of Firm with which associated:

Manning, APC

Years' experience with this Firm:

9 Years

Education: Degree(s)/Year/Specialization:

Bachelor of Architecture, Louisiana State University, 2012

Active registration: Year first registered/discipline:

Louisiana Architect - #9112 - 2019

Other experience and qualifications relevant to the proposed Project.

Ryan Bertucci is a licensed architect and LEED Green Associate. His experience covers all phases of the design and construction process, from programming through construction administration. He has extensive experience in 2D and 3D modeling software and Building Information Modeling (BIM) with an emphasis on AutoCAD, Rhinoceros and Revit. Mr. Bertucci's professional experience has focused on commercial, civic, hospitality and transportation-oriented projects. A few of these projects include: Plank Road Area Investment Corporation/BuildBR Mixed-Use, Regional Transit Authority Downtown Transit Center Analysis, Louis Armstrong New Orleans International Airport North Terminal Commissary, New Orleans Ernest N. Morial Convention Center Linear Park, City of New Orleans Nora Navra Library, Tulane University Center for Intercultural Life and Academic Equity, and Xavier University Faculty Housing.

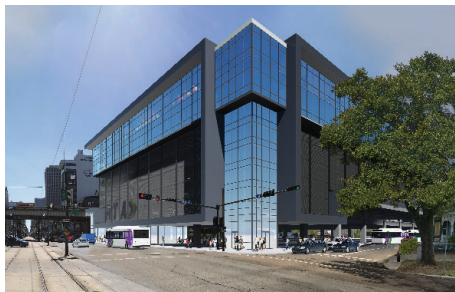

TEC Professional Services Questionnaire

KEY PERSON, SPECIALIST, OR INDIVIDUAL CONSULTANT:

Name & Title:

Carson Piontek, Assoc. AIA

Graduate Architect

Project Assignment:

Architectural Design

Name of Firm with which associated:

Manning, APC

Years' experience with this Firm:

4 Years

Education: Degree(s)/Year/Specialization:

Bachelor of Architecture, Tulane University, 2018

Active registration: Year first registered/discipline:

Associate AIA

Other experience and qualifications relevant to the proposed Project.

Carson is a Tulane graduate, where he served as the AIA's Tulane president. Currently, he is working towards acquiring his architectural license through NCARB and has contributed to Manning's Sustainability Action Plan. Carson's project experience includes Martha Turner Reilly Elementary School in Dallas, Warren Easton Charter High School historic renovation and addition, Ochsner School of Nursing and Allied Health, Tarrant County College Master Plan, Tulane Center for Intercultural Life and Academic Equity, World Bank Group in Nigeria, Parkland Hospital Outpatient Clinic, and General Informatics Corporate Master Plan.

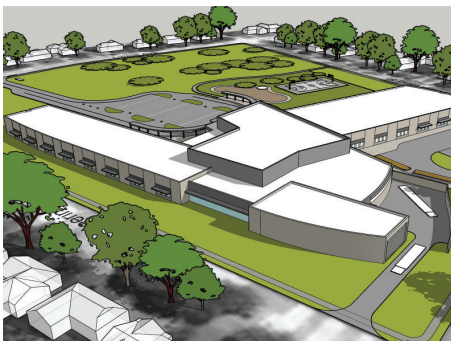

TEC Professional Services Questionnaire

KEY PERSON, SPECIALIST, OR INDIVIDUAL CONSULTANT:

Name & Title:

Charles Luquet, AIA

Sr. Architect

Project Assignment:

QA/QC | Architect

Name of Firm with which associated:

Manning, APC

Years' experience with this Firm:

5 Years

Education: Degree(s)/Year/Specialization:

Bachelor of Architecture, Tulane University, 1981

Master of Architecture, Tulane University, 2004

Active registration: Year first registered/discipline:

Louisiana Architect - #3298 - 1984

Other experience and qualifications relevant to the proposed Project.

Mr. Luquet has vast experience in providing all aspects of professional architectural services, project management, and effective quality control. His unique QC experience in the field working for a large Design-Build firm complements his knowledge of design and construction documents production, as well as review and quality control during each phase of design. As part of the document production team and as an Owner representative he has reviewed many projects and assisted outside consultant architects to improve the project documents in the areas of technical accuracy, and to improve the cost-effectiveness and constructibility of a project. His project experience includes Plank Road Mixed Use Development, World Bank Group in Nigeria, MSY Concessions, Ochsner School of Nursing and Allied Health, and Tulane University AB Freeman School of Business.



TEC Professional Services Questionnaire

L. Work by Firm or Joint-Venture members which best illustrates current qualifications relevant to this Project. Please include any and all work performed for Jefferson Parish. Please attach additional pages if necessary.

PROJECT NO. 1		
Project Name, Location and Owner's contact information:	Nature of Firm's Responsibility:	
<p>Jefferson Parish Community Park COVID Memorial and Farmers Market</p> <p>Jefferson Parish, LA</p> <p>Owner's Contact: Calvin Thompson Council Aide, Councilman Byron L. Lee, District 3 504-736-6591 cthompson@jeffparish.net</p>	<div style="display: flex; align-items: flex-start;">  <div> <p>Our Role: Planning, Architect of Record</p> <p>Manning is developing two parish-owned parcels situated on both sides of a major highway (the Westbank Expressway) into community space, including a farmer's market, splash zone, Covid memorial, picnic areas, and walking trail, as the first phase of a comprehensive development. The park incorporates a program aimed at promoting health, wellness, recreation, and social gathering. The farmers market will anchor Phase 1 with fresh food options that are currently lacking in the community. A Covid memorial acts as a place of quiet reflection where visitors may find the names of those lost in the Covid-19 pandemic. The center of the memorial is a fountain, a symbol of the river of life with its musical hush providing a serene atmosphere.</p> </div> </div>	
Completion Date (Actual or estimated):	Estimated Cost:	
	Entire Project:	Work for which Firm was Responsible:
TBD	\$6 million (E)	TBD

PROJECT NO. 2		
Project Name, Location and Owner's contact information:	Nature of Firm's Responsibility:	
<p>General Informatics Master Plan & @Highland Corporate Headquarters</p> <p>Baton Rouge, LA</p> <p>Owner's Contact: General Informatics Mohit Vij CEO 225-767-7670 mo@geninf.com</p>	<div style="display: flex; align-items: flex-start;">  <div> <p>Our Role: Master Planner, Architect of Record in JV</p> <p>Manning developed the master plan for General Informatics' pioneering development dubbed @Highland. It integrates leading-edge technology with lifestyle on an 8.5 acre campus that incorporates offices, housing, commerce, and nature. Manning also designed the 50,000 s.f. corporate headquarters within the campus that would become a hub for thought, collaboration, and community that catalyzes Louisiana's business and tech sectors.</p> </div> </div>	
Completion Date (Actual or estimated):	Estimated Cost:	
	Entire Project:	Work for which Firm was Responsible:
2018 (A)	\$11 million	\$11 million

TEC Professional Services Questionnaire

PROJECT NO. 3

Project Name, Location and Owner's contact information:	Nature of Firm's Responsibility:	
<p>Nora Navra Library New Orleans, LA</p> <p>Owner's Contact: City of New Orleans Jerry D. Harris Project Manager, Capital Project Administration 504-658-8681 jeharris@nola.gov</p>		<p>Our Role: Full architectural and interior design services.</p> <p>Manning designed the new 7,900 sf replacement of a neighborhood hub lost in Katrina. Manning led an extensive community outreach program and developed a careful stormwater management strategy. The project was recognized with an AIA New Orleans Merit Award.</p>
Completion Date (Actual or estimated):	Estimated Cost:	
	Entire Project:	Work for which Firm was Responsible:
2018 (A)	\$3 million	\$3 million

PROJECT NO. 4

Project Name, Location and Owner's contact information:	Nature of Firm's Responsibility:	
<p>Plank Road Mixed-Use Development Baton Rouge, LA</p> <p>Owner's Contact: Plank Road Area Investment Corporation Christopher J. Tyson Former CEO Build Baton Rouge 225-387-5606 ctyson@ebrra.org</p>		<p>Our Role: Architect</p> <p>Manning designed the cornerstone mixed-use development, providing affordable housing with mixed-income units targeting families and the large senior population in the community. The commercial space is slated for a YMCA Early Head Start program that will provide much needed childcare. Build Baton Rouge will also occupy space, moving its headquarters to ground-zero for the community's revitalization.</p>
Completion Date (Actual or estimated):	Estimated Cost:	
	Entire Project:	Work for which Firm was Responsible:
2023 (E)	\$7.3 million (E)	\$7.3 million (E)

TEC Professional Services Questionnaire

PROJECT NO. 5

Project Name, Location and Owner's contact information:	Nature of Firm's Responsibility:	
<p>New Orleans Ernest N. Morial Convention Center Linear Park</p> <p>New Orleans, LA</p> <p>Owner's Contact: David Mason, Director of Construction at New Orleans Ernest N. Morial Convention Center (504) 582-3000 dmason@mccno.com</p>	 <p>Convention Center's LEED Gold Operations and Maintenance certification, 200 trees line the promenade, and the landscaped rain gardens are part of the stormwater management strategy for the sixth-largest convention center in the nation.</p>	<p>Our Role: Architect of Record as a JV.</p> <p>The park design improves outdated traffic patterns and repurposes 7.5 acres of roadway into a landscaped continuous pedestrian promenade along Convention Center Boulevard for the 11-block length of the center. In addition to the vibrant user experience enhancement, the park's design helped achieve the</p>
Completion Date (Actual or estimated):	Estimated Cost:	
	Entire Project:	Work for which Firm was Responsible:
2021 (A)	\$65 million	\$65 million

PROJECT NO. 6

Project Name, Location and Owner's contact information:	Nature of Firm's Responsibility:	
<p>Ochsner Center for Nursing and Allied Health at Delgado Community College</p> <p>New Orleans, LA</p> <p>Owner's Contact: Brian Budd, Program Director at CSRS, Inc. 225-761-3602 brianbudd@csrsinc.com</p>	 <p>classrooms, advanced labs simulating real-world healthcare delivery settings, and a virtual hospital floor.</p>	<p>Our Role: Architect of Record in JV</p> <p>The Ochsner Center Center is a partnership between Ochsner and Delgado Community College to train health professionals for Louisiana's workforce. The new building will provide next-generation facilities and technology for the next generation of nurses and allied health professionals, and includes traditional lecture</p>
Completion Date (Actual or estimated):	Estimated Cost:	
	Entire Project:	Work for which Firm was Responsible:
2023 (E)	\$39 million	\$12 million

TEC Professional Services Questionnaire

PROJECT NO. 7		
Project Name, Location and Owner's contact information:	Nature of Firm's Responsibility:	
<p>Tulane University A.B. Freeman School of Business New Orleans, LA</p> <p>Owner's Contact: Randy Philipson Tulane University Vice President - Facilities, Campus Development, & Services 504-314-2170 randy@tulane.edu</p>	<div style="display: flex; align-items: center;">  <div style="margin-left: 10px;"> <p>Our Role: Architect of Record</p> <p>The integrated design merges the undergraduate and graduate business schools into a single unified structure featuring more than 80,000 square feet of new and renovated space, including 10 new classrooms, more than 30 new student breakout areas and an expansive three-story atrium fronted by a wall of undulating glass.</p> </div> </div>	
Completion Date (Actual or estimated):	Estimated Cost:	
	Entire Project:	Work for which Firm was Responsible:
2018 (A)	\$27 million	\$2.7 million

PROJECT NO. 8		
Project Name, Location and Owner's contact information:	Nature of Firm's Responsibility:	
<p>Tulane University Center for Equity & Intercultural Life New Orleans, LA</p> <p>Owner's Contact: Randy Philipson Tulane University Vice President - Facilities, Campus Development, & Services 504-314-2170 randy@tulane.edu</p>	<div style="display: flex; align-items: center;">  <div style="margin-left: 10px;"> <p>Our Role: Full architectural and interior design services.</p> <p>Tulane University commissioned Manning to design the Center for Academic Equity and Carolyn Barber Pierre Center for Intercultural Life. The center incorporates the Office of Multicultural Affairs, Religious Life, and the Office for Gender and Sexual Diversity, providing a unique opportunity to explore diversity and inclusion in an architectural context. The new center will serve under-represented and non-traditional students and will act as the hub of diverse cultural, social, and intellectual life at Tulane. "Open conversations" became a theme of Manning's design. The intent is to encourage students to gather and hold conversations.</p> </div> </div>	
Completion Date (Actual or estimated):	Estimated Cost:	
	Entire Project:	Work for which Firm was Responsible:
2021(A)	\$5.8 million	\$5.8 million

TEC Professional Services Questionnaire

PROJECT NO. 9		
Project Name, Location and Owner's contact information:	Nature of Firm's Responsibility:	
<p>Jefferson Parish Schools: Helen Cox High, Higgins High, and Collins Elementary</p> <p>Jefferson Parish, LA</p> <p>Owner's Contact: William W. Stoffle Project Manager Jefferson Parish Public School System 504-349-8595 william.stoffle@jpschools.org</p>	<div style="display: flex; align-items: flex-start;">  <div> <p>Our Role: Architect</p> <p>Manning is working with Jefferson Parish Schools on the renovation of three of its schools. At Helen Cox, Manning is focused on code conformance and delivering high-performance energy systems. Manning prepared damage assessments and is designing the repairs to Higgins High School and Collins Elementary as a result of damage from Hurricane Ida. Helen Cox is completed, and Higgins and Collins are in construction under the watchful eye of our Construction Contract Administrator, Mr. Charles Luquet. Manning planned the work for all three schools, enabling them to remain operational through construction.</p> </div> </div>	
Completion Date (Actual or estimated):	Estimated Cost:	
	Entire Project:	Work for which Firm was Responsible:
<p>Helen Cox High, 2023 (E) Higgins High, 2022 (A) Collins Elementary, 2022 (A)</p>	<p>Helen Cox High, \$4 million Higgins High, \$5.4 million Collins Elementary, \$3.8 million</p>	<p>Helen Cox High, 2023 (E) Higgins High, 2022 (A) Collins Elementary, 2022 (A)</p>

PROJECT NO. 10		
Project Name, Location and Owner's contact information:	Nature of Firm's Responsibility:	
<p>TEP Interpretive Center & Senior Living</p> <p>New Orleans, LA</p> <p>Owner's Contact: Michael Grote Alembic Community Development Director of Building Programs 504-569-0014 mgrote@alembiccommunity.com</p>	<div style="display: flex; align-items: flex-start;">   <div> <p>Our Role: Full architectural services</p> <p>Manning designed the preservation and renovation of the former McDonogh 19 school building where Leona Tate, Gail Etienne, and Tessie Prevost integrated the New Orleans public school system as first graders. The design transformed the shuttered school into a museum, community center, and includes housing for twenty-five seniors.</p> </div> </div>	
Completion Date (Actual or estimated):	Estimated Cost:	
	Entire Project:	Work for which Firm was Responsible:
<p>2021 (A)</p>	<p>\$9 million</p>	<p>\$9 million</p>

TEC Professional Services Questionnaire

M. List all prior and/or on-going litigation between Firm and Jefferson Parish. Please attach additional pages if necessary.

Parties:		Status/Result of Case:
Plaintiff:	Defendant:	
1. N/A	N/A	N/A
2. N/A	N/A	N/A
3. N/A	N/A	N/A
4. N/A	N/A	N/A

N. Use this space to provide any additional information or description of resources supporting Firm's qualifications for the proposed project.



PEOPLE

22

Employees

BUSINESS

37+

Years in Business. Organized as a corporation in 1985.

MARKETS

Aviation
Civic
Community Colleges
Corporate
Cultural
Healthcare
Higher Education
Hospitality
K-12 Education
Transit

Manning, APC

Architecture, Interior Design, Planning, Scheduling

Clients with complex urban projects rely on Manning, APC to develop a vision for what's possible, align project goals with stakeholder expectations, and navigate demanding technical issues.

Manning has a thirty-seven-year history of designing solutions with a dedication to making each client's goals our own. We are a multi-discipline firm of talented staff members, providing fully integrated architecture, interior design, and planning services with a proven track record and earning national recognition. Within the framework of these disciplines, we offer tailored services that can guide a project from the spark of an idea through occupancy. Our system clients return to Manning for multiple projects as a trusted partner for planning and design.

TEC Professional Services Questionnaire

We engage with our clients, team members, and community partners by listening. It's this collaboration that energizes our creativity. We ask in-depth questions and build relationships that lead us toward a shared vision that is clearly expressed and realized. Through our tested process that includes meticulous project management and innovative thinking, we develop responsive solutions for each project, realizing each vision.

Our passion is improving quality of life through collaboration and design. Our work brings clients' visions to fruition while adding to the vitality of communities. When approaching projects, we not only meet the programmatic needs of our clients, but also consider the broader social issues at stake through design. We believe that when all elements of the built environment are designed with a focus on efficiency, sustainability, aesthetic beauty, and a sense of place, the community enjoys a better quality of life.

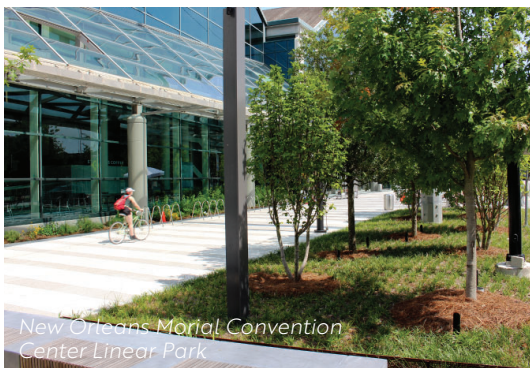

RECOGNITION

USGBC Louisiana Excellence in Sustainability Award

Top 100 Green Design Firms
– *Engineering News Record*

Design Intelligence Award
– *Almanac of Architecture & Design*

Top 250 Design Firms
– *Architectural Record*

Texas & Louisiana Top 250 Design Firms
– *Engineering News Record*

Solutions-Driven

We develop solutions that overcome obstacles, such as time constraints that require aggressive schedules, operational needs that dictate construction phasing, jurisdictional and funding considerations, and resiliency strategies to strengthen responses to disaster and change.

Collaborative Approach

Maintaining close communications over the project duration keeps us highly responsive to our clients. Along with delivering exceptional results, we've earned over 80% repeat business.

Front End Specialists

We achieve end goals such as scope, budget, and schedule because we prime projects for success at the beginning. That may involve site analysis, detailed programming, visioning, special regulatory investigations, and facility assessments.

Flexibility and Innovation

We stay focused on your goals, even when shifts occur due to funding, client personnel changes, and unforeseen conditions. We keep the goals front and center and devise new paths: scope realignments, alternative construction methodologies, phasing schemes, additional resources, and other innovations to achieve desired results.

TEC Professional Services Questionnaire

Summary of Evaluation Criteria

1. Professional training and experience in relation to the type of work required for the architectural or engineering services – 35 points

Ref. Section: K, N (Experience with On-Call Services and Governmental Clients)

Our professional staff members are licensed architects, interior designers, and planners. For this assignment, we have assembled a team with deep experience in the type of renovations, additions, and new construction that may be required. Our team members also have experience with as-needed-based contracts and working with governmental entities.

2. Size of firm considering the number of professional and support personnel required to perform the type of architectural or engineering tasks, including project evaluation, project design, drafting of technical plans, development of technical specifications and construction administration – 20 points

Ref Sections: E, N

Manning's 22 staff members and counting are more than adequate to manage a wide range of project types and sizes. We have assigned a team well-qualified to complete the projects that may arise. In addition, our proven success with similar contract types is indicated in Section N (Experience with On-Call Services and Governmental Clients). Our firm is ready to hit the ground running to assist Jefferson Parish. Once a project is awarded, we will confirm the indicated staff and ensure that they are dedicated to this project and available as needed for each phase. An important element of our work plan is our commitment to staffing continuity from design through construction.

3. Capacity for timely completion of newly assigned work, considering the factors of type of architectural or engineering task, current unfinished workload, and person or firm's available professional and support personnel – 20 points

Ref Sections: E, K, N (Approach: Schedule, Budget, and Quality)

Our resource assignment and staffing plan take into account current commitments. Our capacity for timely completion is a function of the team assigned (Sections E and K) and our proven approach to achieving schedule and budget commitments, which is discussed in Section N.

4. Past Performance by person or firm on projects of or similar comparable size, scope, and scale. Assertions of fault by a person or firm, which shall include time delays, cost over-runs, and or design inadequacies in prior work completed for the Parish – 10 points

Ref Sections: K, L, M, N

Manning's past performance is illustrated in our project sheets and resumes. Further, we have no history of litigation or claims with Jefferson Parish. In fact, Manning has had no claims or litigation with any client for over a decade. Our 80% repeat business rate and the clients that return to Manning year after year speak to our performance. Section N, Experience with On-Call Services and Governmental Clients, outlines a few examples of our repeat and on-call clients.

5. Location of the principal office. (2) Neighboring Parishes of the Greater New Orleans Metropolitan Region, which includes Orleans – 12 points

Ref Section: B

We are located in Orleans Parish.

TEC Professional Services Questionnaire

6. Adversarial legal proceedings between the Parish and the person or firm performing professional services – 15 points

Ref Section: M

Manning has no prior or current adversarial legal proceedings with Jefferson Parish, and a history of zero litigation with clients and project partners for over a decade.

7. Prior successful completion of projects of the type and nature of the architectural or engineering services, as defined, for which firm has provided verifiable references – 15 points

Ref Section: L

Our representative projects are listed in Section L with references.

Experience with On-Call Services and Governmental Clients

Manning, APC is experienced working with numerous agencies for on-call services. For example, our ability to jump in and provide services for whatever crops up to keep DFW Airport and its airlines operating efficiently resulted in a host of projects completed in 2019-2020, and our work continues at DFW. We also completed seven Dallas Independent School District (DISD) schools under a similar contract methodology, ranging from upgrading outdated facilities to current codes to more complex renovations and additions. After the successful conclusion of that as-needed contract, Manning was awarded the number one ranking out of sixty-seven selected national and local firms for DISD's next architectural pool. As a result, we are designing the new Martha Turner Reilly Elementary School for DISD.

Additionally, we are regularly at work for the Morial Convention Center, Armstrong International Airport, and the Audubon Nature Institute. These and many other clients have awarded us repeat work based on our abilities and conscientious performance.

Manning's breadth of experience with other governmental clients reinforces our knowledge and practices. 40% of our work is typically governmental—we understand the level of communication, precision, and detail required. We will bring the confidence and understanding gleaned from thirty seven years of experience to each new project.

- | | |
|--|--|
| • Jefferson Parish | • Regional Planning Commission |
| • General Services Administration | • Port of New Orleans |
| • City of New Orleans | • Audubon Nature Institute |
| • State of Louisiana Facility Planning & Control | • Ernest N. Morial Exhibition Hall Authority |
| • Regional Transit Authority of New Orleans | • New Orleans Aviation Board |
| | • Entergy Services |
| | • Orleans Parish Civil District |

Manning builds relationships with governmental clients.

Ernest N. Morial Convention Center

River District Master Plan, 2020

Linear Park, 2020

Upriver Parcel Analysis, 2019

Renovation of Lounge and Break-Out Spaces, 2019

Facility-Wide Restroom Renovation, 2019

Board Room, 2018

2012 Vision Plan

Exhibit Hall A and Ballroom Renovation, 2018

Phase IV Feasibility Study and Market Analysis, 2000

Phase III Expansion, 1998

Truck Marshalling Lots, 1995

ENMCCNO Phase II Expansion, 1994

Master Plan for Phase III Expansion, 1989

Reference:

David Mason, Director of Construction at New Orleans Ernest N. Morial Convention Center
(504) 582-3000
dmason@mccno.com

TEC Professional Services Questionnaire

- Orleans Parish School Board
- New Orleans Recovery School District
- City of Baton Rouge
- City of Shreveport
- City of Baker School District
- Iberville Parish School District
- New Orleans East Hospital Service District A
- Louisiana College and Technical College System
- U. S. Department of Labor
- U. S. Marine Forces Reserve
- Facilities
- U. S. Postal Service
- Southern University System
- MS Institutes of Higher Learning
- DFW Airport
- Dallas Independent School District
- Dallas Area Rapid Transit
- Dallas County
- Dallas Independent School District
- Trinity Metro

From our team's extensive experience, we understand the need for immediate service when emergencies occur and quick turnarounds for time-sensitive projects. The full Manning team is available on short notice and can deliver successful projects on expedited schedules. Additionally, our projects have included detailed phasing plans for clients such as DFW Airport, New Orleans Aviation Board, and the Ernest N. Morial Exhibition Hall Authority. Our work has kept these facilities operational for the duration of construction.

Because of our responsiveness, Manning has been a partner, delivering small and large projects on an on-call basis for governmental clients. Additionally, Manning has provided on-call and repeat work for private institutions, such as Tulane University, Dillard University, and Xavier University. We are currently at work for Xavier designing its new 832-bed residence hall, our most recent project in a relationship that has spanned nearly forty years and over forty projects.

Approach

Manning is ready to begin work upon NBHS's notice. Our first task will be to establish the rules of engagement which describe how all parties will interact with each other and the decision-making process that will be used throughout the project. Our Principal-In-Charge, Dominic Willard will be the point of contact and will work directly with your facility/project manager.

Another early strategy is to define the project objectives. This is achieved by conducting a series of visioning/strategic goal-setting sessions that identify the factors that will ultimately be used to measure the success of the project. In these meetings we will sort through assumed goals and dive deeper into the possibilities for the project and any constraints. We will uncover the client's known goals, delve into additional considerations, and offer conceptual solutions until a vision for the project is reached. This will be an interactive process led by Manning, facilitating participation and input from NBHS and any key stakeholders.

Audubon Nature Institute

Bear Exhibit (name? date? Any others?)

Audubon Zoo Bird House, 2022
Alliance for Sustainable Wildlife, 2019 – Phase 2 Development

Aquarium of the Americas Shark Attack Escape Room Ticketing Kiosk, 2019

Audubon Louisiana Nature Center Botany Center, 2018

Audubon Zoo Sea Lion Holding Tank Expansion, 2018

Audubon Riverview Enhancements, 2018

Louisiana Nature Center & Planetarium, 2017

Water Intrusion Report for Amazon Exhibit, 2016

Aquarium of the Americas Roof Replacement, 2014

Aquarium of the Americas & Woldenberg Riverfront Park, 1990 – Phase 1

Aquarium of the Americas & Woldenberg Riverfront Park, 1995 – Phase 2

Reference:

Kevin Chenevert
Vice President of
Construction & Exhibits
Audubon Nature Institute
Direct: (504) 212-5207
Cell: (504) 605-7545
kchenevert@auduboninstitute.org

TEC Professional Services Questionnaire

Also critical at the initial stage, we will refine the work plan for the entire project. The work plan—composed of a detailed scope description, tasks, budget, schedule, and project resources—will serve as the map for navigating the project process and sequencing each activity. Work plan data (budgets, schedules, and resources) are entered into our Ajera accounting and project management software system that is viewed by managers daily. Further, reports are presented weekly to principals.

Our assigned project manager and Principal-In-Charge will closely monitor the development of the design and construction documents throughout the phases of the project and will review them for completeness, accuracy, conformance with project requirements, and integration between disciplines. Our consultants will perform similar reviews internally, then our principals will perform an extensive coordination review between architectural and consultants' sets. Our quality control program includes reviews by our Director of Quality Control, lending his expertise in construction to the drawings early in the process as solutions are being formulated. His participation throughout the process will include constructability reviews and another layer of coordination between disciplines.

History of meeting deadlines and staying within budget

Of primary importance, our principals and project managers track project budgets, scope, and schedules. This involves a high level of coordination and management that begins at a projects' inception and is integrated into the project management structure.

The foundation of Manning's design process is our ability to lead clients through each step of the project using a progressive decision-making approach that avoids second-guessing and expensive backtracking. This approach is time-tested and flexible to meet the unique demands of each project. Throughout the process, we build consensus among stakeholders to identify a clear solution that all parties agree is the best way forward.

Our design process is structured to ensure that needed information is developed at the appropriate time, starting with the highly detailed programming phase and followed through the project process. In addition to the design process, Manning employs strategies to ensure our projects are carefully coordinated, with communication at its core.

Project Budget

The project budget is established either at project inception or during the programming phase. We reconcile the budget and scope during each consecutive design phase. For projects of a moderate to large scale, we use third-party cost estimators. This outside verification provides tight control over the design and budget and establishes a value-engineering protocol early in the design process instead of waiting until the end of construction documents. Waiting usually results in painful scope cuts, bid alternates, and time extensions as contrasted with a project that is under budget, or if slightly over, can be covered by contingency or less painful value engineering options which we will typically already have pre-identified. Communicating with the client at each step, detailing estimated costs and options, is part of our success story. Our team will also work closely with estimators to provide life-cycle analysis and the consideration of long-term operations and maintenance costs.

Keeping on track: budget and schedule

Case Study – Ochsner Center for Nursing and Allied Health at Delgado Community College, City Park Campus



The Ochsner Center for Nursing and Allied Health at Delgado Community College is the largest of three projects we're currently working on at the City Park campus that also include an athletics fieldhouse and the Culinary Arts & Workforce Training Facility. The new, state-of-the-art Nursing and Allied Health Center is five stories and roughly 120,000 SF. Its program includes classrooms, teaching labs, offices, conference and study rooms as well as a virtual hospital which features a mock OR, patient rooms and simulation labs that allows students to learn in an immersive environment. These are technology and equipment-intensive spaces.

We realized early on that we would be faced with significant budget and schedule challenges. Construction costs were skyrocketing due to the pandemic, which required a reassessment of the program. We worked as a tight team with the CMAR contractor who assisted us in developing conceptual pricing estimates starting very early so we'd have real time costs as we developed the design. We also brought together a group of stakeholders to fine tune the program during our scope to budget process. To meet the desired construction schedule and stay within budget, we suggested a fast-track delivery method featuring multiple early-release bid packages. This allowed our CMAR team to get under contract with subcontractors quickly and lock in pricing before it continued to escalate. We have been able to hit our targeted budgets for each early release package and are on track as we near completion of Construction Documents. Our team is highly experienced in all delivery methods from the standard Design-Bid-Build to Design-Assist, Design-Build as well as CMAR.

TEC Professional Services Questionnaire

Schedule, Construction Phasing, and Fast-Track

The design team will develop the schedule at project inception and will align it at every consecutive phase. Using Microsoft Project, we prepare schedules using critical path methodology and the detail needed to comprehend the complexities facing the project delivery. In Gantt chart form, all participants can see the interrelations between tasks and the impact of any changes. We understand the schedule constraints imposed by the client's internal commitments and even outside forces such as weather. Like other goals, we identify what the schedule must achieve at a detailed level so that we can guide the project to meet targeted openings.

Construction phasing may be necessary to achieve the intended schedule with minimal disruption to campus operations and activities. We are adept at working through phasing options to a consensus and developing the phasing plans, a schedule, and construction package(s) that meet this need. As an example of our attention to keeping clients operational through construction, our work at the Morial Convention Center dates back to our joint ventures that developed Phase II and Phase III while keeping previous phases open for business. As an economic generator for our city, the convention center's continuous operation is critical. More recently, we completed a modernization of the convention center's thirty-three restrooms while the more than million square feet of contiguous exhibition space remained fully functional. This required a detailed phasing plan that isolated construction activities from the public and staff over a series of phases and kept circulation and access readily available and apparent to guests. And the 2021 completion of the Ernest N. Morial Convention Center Linear Park, transformed 7.5 acres of roadway into a pedestrian promenade and landscaped park. Running the length of the convention center, the site improvements were phased to keep access flowing throughout the duration of construction. Manning, APC has developed detailed phasing plans to keep airline concourses, Fortune 500 companies, tourist venues, schools, transit hubs, and healthcare providers operating through construction.

We accomplish fast-track schedules by developing a plan of attack at the beginning of the project that will inform the work plan. A series of intense programming sessions and design charrettes allows us to develop the program and a conceptual design quickly. We then focus on developing critical-path aspects of the project and nail them down, which allows consultants to initiate their work sooner in the process and avoids unnecessary and time-consuming design revisions. Waste is the enemy in fast-track projects. We utilize Lean in Design principles outlined by the Lean Construction Institute to help us avoid waste in our design process. Timely client feedback and decision making are also critical in that process.



Convention Center Linear Park

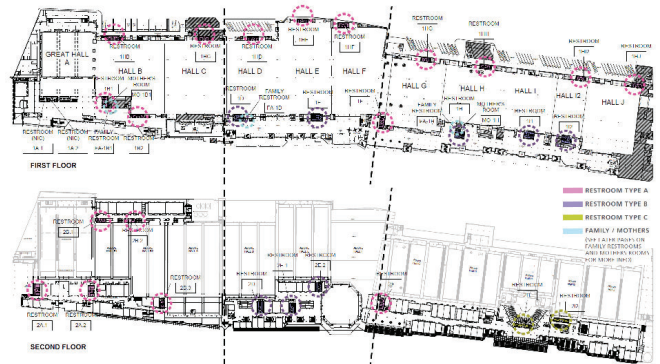

Convention Center Restroom Renovations

TEC Professional Services Questionnaire

We accomplish fast-track schedules by developing a plan of attack at the beginning of the project that will inform the work plan. A series of intense programming sessions and design charrettes allows us to develop the program and a conceptual design quickly. We then focus on developing critical-path aspects of the project and nail them down, which allows consultants to initiate their work sooner in the process and avoids unnecessary and time-consuming design revisions. Waste is the enemy in fast-track projects. We utilize Lean in Design principles outlined by the Lean Construction Institute to help us avoid waste in our design process. Timely client feedback and decision making are also critical in that process.

We have produced numerous projects on an accelerated or fast-track basis, many phased to keep facilities operational. Some examples include multiple renovation projects for the Morial Convention Center, concessions and terminal renovation projects at DFW, Smoothie King Arena Renovations, and numerous educational projects for K-12 and higher education.

Scope

Scope is important because it affects both budget and schedule. Scope creep happens when spaces or amenities are added or enlarged. During a complex and schedule-bound project with many users and team members, it can easily happen. We are versed in dealing with requested changes to the scope by documenting them, assessing the value of the change where feasible, and communicating the requests prior to implementation for the agreement or disagreement of decision makers. Even in the absence of changes to the scope, we perform an alignment of the scope and budget at each phase to best ensure the final design is within budget.

QA/QC Procedures

Manning's Standard of Quality Assurance and Quality Control (QA and QC) is targeted to meet the client's goals for the project and our own standards for consistency and completeness. To do this, we use a combination of templates as tools. These templates are each focused upon specific aspects of quality in the architectural practice and in project delivery:

- American Institute of Architects D200 Project Checklist
- Red-Yellow-Green Review
- RediCheck
- Manning Document Standards

We have developed a checklist format for each phase of the project: pre-contract, predesign and programming, schematic design, design development, construction documents, bidding, construction administration and close-out. Project documents are reviewed at each phase and at multiple points during the construction documents phase. Our dedicated Quality Control Manager, Mr. Charles Luquet, uses his vast experience in architectural design, construction, and owner representation to provide confidence to the project team and the owner.

Components of our QA/QC program include effective management and assessment.

Assessment

In order to assess our own work, we will utilize a system of critical review at appropriate points in the design process for each project.

TEC Professional Services Questionnaire

- At the 30% schematic design level, the team will evaluate the design against the design criteria and architectural program document for the project.
- At the 60% design development level, we will assess a comprehensive outline specification to identify any problems with the roof assembly, wall assembly, and other features of the building envelope. A review of the basic mechanical, electrical, and plumbing system design; space conflicts; interferences; and code and zoning review will also occur at this time.
- The final review at the 95% level will examine all the building components and systems specified for constructability of the details as shown, durability of the building envelope and finishes, level of coordination between disciplines within the documents, service of support systems, and the clarity and completeness of the information contained within the construction documents. With the detail contained in this stage of design, we employ Clash Detection software to best coordinate various and specific design features and eliminate what would otherwise be time consuming and expensive Change Orders during construction.
- Through the bidding process, Manning provides technical options within state bid law to the owner and the owner's contracting representative. These options are also offered considering the authorities having jurisdiction while addressing the owner's needs and goals that we have attended to from the Program Phase and refined throughout the design process.
- During Construction Administration, our quality assurance and quality control protocol relies on:
 - Continuing to maintain close project management controls through consistent staffing and project management software reporting.
 - Assigning the construction administration who continue their involvement in the project from design phases, so the project history, considerations, and solutions carry through from design to implementation.
 - Relying on Manning, standard process and checklist and utilizing industry standard AIA forms and procedures that we customize for the specific project.

Our Quality Control Manager, along with other continuously involved staff, will undertake the QC and CA tasks with the intention of facilitating the Owner's interests. Manning has the insight and experience necessary to anticipate construction challenges and eliminate many that would otherwise bog down construction progress and add unnecessary expense.

Our QC Manager will implement Manning's CA procedures with customized aspects focused on critical results for the owner and project. Our CA staff follows those procedures while the QC Manager continues to provide oversight and decision making. Some tasks that are routinely tracked by the QC Manager include:

1. Receive, review and comment on documents required from the successful bidder including bonds, schedule of values, construction schedule, etc. From experience, we significantly further the anticipatory process through this review;
2. Attend pre-construction meeting and confirm that the agenda suits the project needs;
3. Establish the QC program specific for the project including preparatory meetings - prior to start of each new aspect of work, start-up meetings at the onset of work, conclusion meetings prior to a

TEC Professional Services Questionnaire

- subcontractor / trade leaving the site;
4. Negotiate changes for time and sum;
 5. Review maintenance of logs, including those for
 - a. Submittals
 - b. Request for Information (RFI)
 - c. Request for Change (RFC)
 - d. Proposed Change Order (PCO)
 - e. Change Order (CO)
 6. Conduct meetings at the site with design consultants to focus their observations and assist in most expedient information and directives to the contractor;
 7. Spot evaluate the work and field observation reports;
 8. Review record drawings with POM and Construction Contract Administrator for progress and completeness
 9. Assist with review of close-out documents



O. To the best of my knowledge, the forgoing is an accurate statement of facts.

Signature:

A handwritten signature in blue ink, appearing to read 'Wm. Raymond Manning', is written over a horizontal line.

Print Name: Wm. Raymond Manning, FAIA

Title: CEO | Founder

Date: January 19, 2023

Dominic Willard, AIA

LEED Green Associate

Principal

daw@manning.xyz



Since joining Manning in 2003, Dominic has served as project architect, senior associate, and now principal on many hospitality, education and transportation projects. Dominic is experienced in all phases of the design and construction process, from programming and design development through construction administration. Dominic possesses a comprehensive background in the art of building construction, having worked in the field since 1994.

Dominic's thoughtful and comprehensive approach to project management have made him a natural leader on projects. His expertise and oversight have been critical in the successful completion of projects that have required fast-track schedules, innovative solutions, attention to detail, a hands-on approach, and responsiveness.

PROJECT EXPERIENCE:

Housing Authority of New Orleans

Scattered Sites, 2017
Iberville Revitalization Plan, Phases I, II, & III, 11 city blocks, on-going
Guste Community Center, 2016
St. Thomas Elderly Housing Revitalization, 2006

Calcasieu Parish School Board

Hurricane Laura Assessment & Recovery

NOLA Public Schools

Project Management for various projects, on-going
Facilities Assessment, 2020

Louisiana's Community and Technical Colleges

Delgado Community College School of Nursing & Allied Health, on-going
Delgado Community College City Park Campus New Construction & Renovations, on-going

Tulane University

Center for Academic Equity/Intercultural Life, 2021
A.B. Freeman School of Business Addition & Renovations, 2017
Student Health Center Renovation, 2015
Sharp Quad Site Improvements, 2011
Glazer Garden, 2009

Louis Armstrong New Orleans International Airport

Exterior Repairs for Hurricane Repairs, 2007
Long-Term Infrastructure Development Plan, 2013

Dallas-Fort Worth International Airport

HKS RAC Canopy, 2013

EDUCATION:

Master of Architecture
Tulane University, 2004

Bachelor of Architecture
Tulane University, 2003

Universidad Francisco
Marroquin
Guatemala City

PROFESSIONAL REGISTRATIONS:

Registered Architect:
Louisiana

National Council of
Architectural Registration
Boards (NCARB)

AFFILIATIONS:

American Institute of
Architects (AIA)

AIA New Orleans (AIANO),
Executive Board Member

AIA Louisiana (AIALA), Chapter
Delegate

United States Green Building
Council - Louisiana Chapter

Leadership in Energy and
Environmental Design (LEED)
Green Associate

COMMUNITY AND CIVIC:

Orleans Parish Democratic
Executive Committee, Publicly
Elected Member

Lycee Francais De La
Nouvelle Orleans Charter
School, Facilities Task Force
Committee Member



Tighe Kirkland, Assoc. AIA

LEED Green Associate

Principal

tbk@manning.xyz



Tighe Kirkland has been with Manning for over ten years and is a project manager on Corporate, Civic, Hospitality, and Planning projects. She has developed longstanding relationships with clients through her dedicated work and unwavering commitment to clients' goals. She is also a team builder with other partner firms and consultants. This collaborative and relational role has been important in coalescing partnerships with clients and professionals that resulted in dynamic projects like the Concessions at MSY and repeat work at the New Orleans Morial Convention Center.

Tighe's big-picture awareness supports project teams and also drives her interest in the planning arena. She's contributed to Manning's planning efforts at the New Orleans Armstrong International Airport (MSY), New Orleans Ernest N. Morial Convention Center, and the firm's planning efforts supporting wellness in New Orleans East.

PROJECT EXPERIENCE:

New Orleans Ernest N. Morial Convention Center

Linear Park Master Plan & Design, on-going
Restroom Renovations, on-going
I-Cove Renovations, on-going

Alembic Community Development / Leona Tate Foundation

McDonogh 19 Senior Housing Renovation, on-going

Algiers Development District

Mixed Use Planning & Development, 2016

New Orleans East

Master Planning & Development, 2016

New Orleans Regional Planning Commission

Baton Rouge to New Orleans Rail, on-going

New Orleans Downtown Development District

Facade Restoration Campaign, 2011

Louis Armstrong International Airport North Terminal

Delaware North Concessions, 2019
Long Term Development Program, 2018
Hudson Group Concessions, 2017

Shreveport Regional Airport

TSA Security Checkpoint Consolidation, 2019
Restroom Renovation, 2018

Caesars Entertainment

Canal Street Hotel Vision, 2018

EDUCATION:

Bachelor of Architecture, 2005
Rhode Island School of Design

Bachelor of Fine Art, 2005
Rhode Island School of Design

AFFILIATIONS:

American Institute of
Architects (AIA)

Urban Land Institute (ULI)

Leadership in Energy and
Environmental Design (LEED)



Ryan Bertucci, AIA

LEED Green Associate

Senior Associate

rmb@manning.xyz



Ryan Bertucci joined Manning in 2014 as an intern architect. Ryan has been amassing experience in the architectural and construction industry since 2011; before joining the Manning team, Ryan worked as an intern architect in Baton Rouge. His experience has covered all phases of the design and construction process, from programming to construction administration. Ryan has extensive experience in 2D and 3D modeling software as well as Building Information Modeling (BIM) with an emphasis on AutoCAD, Rhinoceros, and Revit.

Ryan's professional experience has focused on commercial, civic, hospitality, and transportation oriented projects.

PROJECT EXPERIENCE:

LCTCS

- Delgado Culinary, on-going
- Delgado Nursing and Allied Health, on-going
- Baton Rouge Community College Nursing School, on-going

LTFC Alembic, LLC

- TEP Center, 2021

The McDonnell Group, LLC

- Warren Easton High School 9th Grade Annex, On-going

Plank Road Area Investment Corporation/Build Baton Rouge

- Plank Road Mixed Use Development, on-going

Regional Transit Authority

- Downtown Transit Center Analysis, on-going
- Executive Office Suite Renovations, 2018
- Canal Street Ferry Terminal, 2018

City of Baton Rouge Parish of East Baton Rouge

- TramlinkBR (Phase I), 2016

Louis Armstrong New Orleans International Airport

- North Terminal Commissary, 2019
- North Terminal Design, 2014

Ernest N. Morial Convention Center

- Linear Park Master Plan & Design, on-going

City of New Orleans

- New Orleans Public Library Branch Signage & Illumination, 2019
- Nora Navra Library, 2018

Tulane University

- Richardson Hall Renovations, 2021
- Goldring Woldenberg Complex – A.B. Freeman School of Business, 2017
- Student Health Center Renovation, 2015

EDUCATION:

Bachelor of Architecture
Louisiana State University, 2012

PROFESSIONAL REGISTRATIONS:

Louisiana

AFFILIATIONS:

Associate of American
Institute of Architects (AIA)

Leadership in Energy and
Environmental Design LEED
Green Associate

United States Green Building
Council - Louisiana Chapter

National Council Architectural
Registrations Board (NCARB)
Certified



Carson Piontek, Assoc. AIA

Graduate Architect

cmp@manning.xyz



Carson is a recent Tulane graduate, where he honed his conceptualization, visualization, and production skills on projects ranging from small offices to large-scale master planning exercises. While at Tulane, Carson served as the AIAS Tulane president, coordinated meetings, firm tours, and other events both locally and regionally. Currently, he is working towards acquiring his architectural license through NCARB.

While shadowing an architect in high school, he was fortunate to attend an OAC meeting and was inspired by the spirit of collaboration as the different aspects of the project came together. This motivated him to pursue architecture and to bring this ethos of teamwork to his professional career.

PROJECT EXPERIENCE:

Warren Easton Charter High School Foundation

Warren Easton 9th Grade Academy, on-going

Dallas Independent School District

Martha Turner Reilly Elementary School, on-going

Louisiana Community and Technical College System

Delgado Community College School of Nursing & Allied Health, on-going

Delgado Community College Athletic Field House

Baton Rouge Community College Nursing School, on-going

Tarrant County College District

Community College Master Plan, on-going

Tulane University

Center for Academic Equity/Intercultural Life, on-going

Ernest N. Morial Convention Center

Linear Park Master Plan & Design, 2021

Louis Armstrong International Airport North Terminal

Delaware North Concessions, Board Room, Military Lounge, Admin

Dallas Fort Worth International Airport

Sprinkler, on-going

World Bank Group

World Bank Nigeria, on-going

Parkland Hospital Outpatient Clinic

First and Fourth Floor Tenant Build-Out, 2020

General Informatics

Corporate Master Plan

EDUCATION:

Bachelor of Architecture
Tulane University, 2018

AFFILIATIONS:

American Institute of
Architects (AIA)



W. Craig King

Senior Associate

wck@manning.xyz



Mr. King joined Manning in 2009 after working as a design manager at PB2 Architecture and Engineering in Dallas, Texas. He is an experienced Project Manager in a range of fields including transportation and education.

PROJECT EXPERIENCE:

American Airlines at DFW

Terminal C High Gates Interior Build-out 2020, on-going
Yandry Center Renovation, 2020

Dallas/Fort Worth International Airport

Terminal C Renovations, on-going
Customer Experience/Innovation Office Suite Renovation, on-going
ITS Relocation to Terminal B - Terminal B, Design
Terminal Renewal and Improvement Program
Terminals A, B, C, 2010 - 2018
Terminal E, Design/Construction Support
Terminal E, Programming/SD
Terminals A, B, E Amenities

Trinity Metro

Signage and re-branding, 2019

Dallas Area Rapid Transit (DART)

Orange Line Light Rail Expansion, 2009
Green Line Light Rail Expansion, 2003 - 2008

VIA Metropolitan Transit

Brooks City Base Transit Center, 2016
Zarzamora Bus Corridor, 2016

Bi-State Metrolink

Central West End Station Extension, 2016
Cortex Station, 2016

Dallas Independent School District

CityLab High School, 2020
Martha Reilly Elementary School, on-going

EDUCATION:

Master of Architecture, 2009
The University of Texas at Arlington

Bachelor of Science,
Architecture, 1988
The University of Texas at Arlington

TEC Professional Services Questionnaire

A. Project Name and Advertisement Resolution Number:

SOQ 23-001 RES NO. 140999

PROFESSIONAL ARCHITECTURAL AND ENGINEERING SERVICES ON AN AS-NEEDED BASIS FOR ARCH. TYPE PROJECTS LOCATED THROUGHOUT THE PARISH FOR AN APPROXIMATE TWO-YEAR PERIOD

B. Firm Name & Address:

**Julien Engineering and Consulting
2916 General Degaulle Drive
Suite 200
New Orleans, LA 70114**

C. Name, title and contact information of Principal, as defined in Section 2-926 of the Jefferson Parish Code of Ordinances, who is a registered, licensed architect, professional engineer, or surveyor in the State of Louisiana:

**Name: Kerwin E. Julien, Sr., P.E., MSCE
Title: President
E-mail: kerwin@julien-engineering.com
Phone: 504.366.3454**

D. Name and contact information of employee who is a registered and licensed architect, professional engineer, or surveyor in the State of Louisiana in the applicable discipline. A subcontractor may be substituted here only if the advertised Project requires more than one discipline.

**Name: Kerwin E. Julien, Sr., P.E., MSCE
E-mail: kerwin@julien-engineering.com
Phone: 504.366.3454**

E. Please provide the number of employees whose primary function corresponds with each category:

<u>2</u> Administrative	___ Estimators	___ Specification Writers
___ Architects (Licensed)	___ Geologists	<u>2</u> Structural Engineers
___ Chemical Engineers	___ Geotechnical Engineers	___ Graduate Engineers
<u>2</u> Civil Engineers	___ Interior Designers	___ Project Managers
<u>2</u> Construction Inspectors	___ Landscape Architects	___ Clerical
___ Ecologists	___ Land Surveyor	___ Grant/Funding Specialist
___ Electrical Engineers	___ Mechanical Engineers	___ Sanitary Engineers
<u>3</u> Engineer Intern	___ Environmental Engineers	
___ Professional Land Surveyors		<u>11</u> TOTAL

F. Is this submittal by a JOINT-VENTURE? Please check: YES ☐ NO ☒

If marked "No" skip to Section I. If marked "yes" complete Sections G-H.

TEC Professional Services Questionnaire

G. If submittal is by JOINT-VENTURE, list the firms participating and outline specific areas of responsibility (including administrative, technical, and financial) for each firm. Please attach additional pages if necessary.

1.

2.

H. Has this JOINT-VENTURE previously worked together? Please check:

YES ☐ NO ☐

I. List all subcontractors anticipated for this Project. Please note that all subcontractors must submit a fully completed copy of this questionnaire, applicable licenses, and any other information required by the advertisement. See Jefferson Parish Code of Ordinances, Sec. 2-928(a)(3). Please attach additional pages if necessary.

Name & Address:	Specialty:	Worked with Firm Before (Yes or No):
1. N/A	N/A	N/A
2.		
3.		

J. Please specify the total number of support personnel that may assist in the completion of this Project:

8

TEC Professional Services Questionnaire

K. List the professional in charge, key persons, specialists, and individual consultants anticipated for this Project and provide their relevant information below. If necessary, please attach additional documentation (i.e. resume) that demonstrates the employment history and experience of the Firm's key persons that may assist in the completion of this Project. Please attach additional pages if necessary.

PROFESSIONAL IN CHARGE OF PROJECT:

Name & Title:

Kerwin E. Julien, Sr., P.E., MSCE / President

Project Assignment:

Principal-In-Charge

Name of Firm with which associated:

Julien Engineering and Consulting

Years' experience with this Firm:

28

Education: Degree(s)/Year/Specialization:

M.S. / 1992 / Civil Engineering

B.S. / 1987 / Civil Engineering

B.A. / 1987 / Physics

Active registration: Year first registered/discipline:

1992 / Civil Engineering

Other experience and qualifications relevant to the proposed Project:

Mr. Julien is the President and Owner of Julien Engineering and Consulting, Inc. He has extensive experience working on many civil and structural engineering design and management projects mainly in Louisiana, Maryland, D.C., and Virginia. He has served the engineering needs of a diverse group of governmental agencies, industrial plants, commercial establishments, private residents, and other individuals and corporations. Mr. Julien is a working principal and a registered professional engineer with active licenses in many states. With a strong career and respectful educational background, Mr. Julien is always ready and able to put his qualifications to just about any challenge that may arise.

TEC Professional Services Questionnaire

KEY PERSON, SPECIALIST, OR INDIVIDUAL CONSULTANT:
Name & Title:
Brian Anderson, P.E. / Project Engineer
Project Assignment:
Project Manager
Name of Firm with which associated:
Julien Engineering and Consulting
Years' experience with this Firm:
22
Education: Degree(s)/Year/Specialization:
B.S. / 1998 / Civil Engineering
Active registration: Year first registered/discipline:
2005 / Civil Engineering
Other experience and qualifications relevant to the proposed Project:
Mr. Anderson has extensive experience working on various civil/ structural projects including building structures, roadways, sanitary sewerage, stormwater drainage, and a myriad of other new and rehabilitation projects. He has developed engineering experience in design and inspection of structural and civil works, project management, analysis of existing conditions, and problem solving. He is proficient in several computer software programs that enable him to effectively manage his work. For public and private clients, Mr. Anderson has developed plans and specifications and probable cost estimates and also managed tens of millions of dollars of construction work.

TEC Professional Services Questionnaire

KEY PERSON, SPECIALIST, OR INDIVIDUAL CONSULTANT:
Name & Title:
James Green, P.E. / Project Engineer
Project Assignment:
Project Manager
Name of Firm with which associated:
Julien Engineering and Consulting
Years' experience with this Firm:
14
Education: Degree(s)/Year/Specialization:
B.S. / 2004 / Civil Engineering B.A. / 2004 / Physics
Active registration: Year first registered/discipline:
2011 / Civil Engineering
Other experience and qualifications relevant to the proposed Project:
Mr. Green has experience in various areas of engineering, construction, and architecture. Mr. Green has provided civil and structural engineering design, construction management and structural inspection for several private and public works projects for many public agencies. He has been involved in extensive project management of civil infrastructure construction in the surrounding New Orleans area. Mr. Green also has experience with wastewater system design and site plan development. He also oversaw the design and construction of several school projects that included civil and structural engineering.

TEC Professional Services Questionnaire

KEY PERSON, SPECIALIST, OR INDIVIDUAL CONSULTANT:
Name & Title: Arthur Malbroue, III, P.E. / Project Engineer
Project Assignment: Project Engineer
Name of Firm with which associated: Julien Engineering and Consulting
Years' experience with this Firm: 11
Education: Degree(s)/Year/Specialization: B.S. / 2012 / Civil Engineering
Active registration: Year first registered/discipline: 2017 / Civil Engineering
Other experience and qualifications relevant to the proposed Project: Mr. Malbroue has worked on various civil and structural projects including public and private building structures, roadway design, storm drainage, sanitary sewerage, and a variety of other new and rehabilitation projects. Mr. Malbroue develops plans, performs quality assurance tasks, inspections, and other construction administration tasks. He has the ability and can manage large or small projects with limited assistance or oversight from a licensed engineer. Mr. Malbroue's knowledge of computer software programs such as AutoCAD, Revit, and Microsoft Office Adobe allows him to work efficiently and effectively.

TEC Professional Services Questionnaire

KEY PERSON, SPECIALIST, OR INDIVIDUAL CONSULTANT:
Name & Title:
Kerwin E. Julien, Jr., E.I. / Project Engineer
Project Assignment:
Project Engineer
Name of Firm with which associated:
Julien Engineering and Consulting
Years' experience with this Firm:
13
Education: Degree(s)/Year/Specialization:
B.S. / 2010 / Civil Engineering
Active registration: Year first registered/discipline:
2017 / Civil Engineering
Other experience and qualifications relevant to the proposed Project:
Mr. Julien has worked on various civil and structural projects which include new building and building renovations. He has superior skills in AutoCAD, Revit, Tekla Structural and TEDDS. He has managed and monitored efforts of construction contractors and performed pre- and post-construction inspections as well as addressing unforeseen field conditions as they arise. Mr. Julien has experience with designing, managing, and executing small and large project with limited supervision from a licensed engineer. His experience includes site drainage, sanitary sewerage, water supply, foundations, framing, and general site development.

TEC Professional Services Questionnaire

L. Work by Firm or Joint-Venture members which best illustrates current qualifications relevant to this Project. Please include any and all work performed for Jefferson Parish. Please attach additional pages if necessary.

PROJECT NO. 1

Project Name, Location and Owner's contact information:	Nature of Firm's Responsibility:	
Name: Louis Armstrong New Orleans International Airport Long Term Development Location: Kenner, LA Owner: New Orleans Aviation Board Kevin Spruell - 504.303.7636	<p>This project involved construction of a new airport terminal and concourses along with partial demolition of the existing terminal and concourses. Specifically, the project involved demolishing the existing terminal building, constructing new buildings, site paving, and infrastructure. Site improvements include a new terminal and concourses (superstructure not design by Julien), multi-story parking garage, central utility plant, aircraft bluewater disposal station, taxi restroom, and other miscellaneous structures, all designed by Julien. Julien was exclusively responsible for the foundation for the main terminal. The most challenging aspect of the project was the difficulty in designing infrastructure with a highly compressed project schedule. Julien Engineering performed structural engineering design and developed plans for the terminal and concourse foundations, framing and foundations for the parking garage, aircraft bluewater station, central utility plant, taxi restroom facilities, as well as several FAA towers and structures, and ancillary structures along with partial demolition of the existing terminal and concourses. Julien Engineering's scope of work also included associated construction administration and inspection throughout the project.</p>	
Completion Date (Actual or estimated):	Estimated Cost:	
	Entire Project:	Work for which Firm was Responsible:
NOV. 2019	\$1.3B	\$150M

PROJECT NO. 2

Project Name, Location and Owner's contact information:	Nature of Firm's Responsibility:	
Name: Louis Armstrong New Orleans International Airport Long Term Parking Garage Location: Kenner, LA Owner: New South Parking (developer) c/o William Porter - 615.957.7727	<p>This project involved construction of new 2,750 vehicle 7-story parking garage, 3,900 square feet one-story administration building, and walkway canopy connecting the main building to the east garage. The most challenging aspect of the project was the difficult in designing infrastructure with a highly compressed schedule. JULIEN performed structural engineering design and developed plans for the framing and foundation for the parking garage, administration building, walkway canopy, and civil utility's foundation support (civil site and utilities not designed by Julien). JULIEN's scope of work also included associated construction administration and inspection. JULIEN also performed overall Project Management directly for the Owner/ Developer as the Owner's Representative during construction to manage coordination of consultants and contractor.</p>	
Completion Date (Actual or estimated):	Estimated Cost:	
	Entire Project:	Work for which Firm was Responsible:
NOV. 2019	\$63M	\$40M

TEC Professional Services Questionnaire

PROJECT NO. 3		
Project Name, Location and Owner's contact information:	Nature of Firm's Responsibility	
Name: SUNO Arts, Humanities, and Social Sciences Building Location: New Orleans, LA Owner: Southern University at New Orleans Marilyn Manuel - 504.286.5440	This project involved design and construction of a 3 story - 71,000 square feet Arts, Humanities and Social Science Building on the Lake Front campus of Southern University in New Orleans, LA. The building contains science laboratories, classrooms, a business center, offices, a museum and a 900-seat auditorium. The building's framing consists of steel and concrete beams, steel and concrete columns with steel reinforced concrete slab on deck floor and roof. JULIEN provided structural engineering design, plans and specifications as well as construction administration.	
Completion Date (Actual or estimated)	Estimated Cost:	
	Entire Project:	Work for which Firm was Responsible:
AUG. 2018	\$30M	\$8M

PROJECT NO. 4		
Project Name, Location and Owner's contact information:	Nature of Firm's Responsibility:	
Name: Superdome Capital Improvements Location: New Orleans, LA Owner: State of Louisiana c/o Trahan Architects Brad McWhirter - 504.533.9033	This project is a multi-phase, multi-year renovation project to the Mercedes-Benz Superdome in New Orleans, Louisiana that will improve guest experience with modernized amenities, while maintaining the building's architectural characteristics. Some of the upgrades include expanded concourses, new entry gates, escalators, and food commissary area to name a few. Julien provided assistance with structural design, analysis, development of plans and specifications, as well as construction administration.	
Completion Date (Actual or estimated):	Estimated Cost:	
	Entire Project:	Work for which Firm was Responsible:
2025	\$450M	\$100M

TEC Professional Services Questionnaire

PROJECT NO. 5		
Project Name, Location and Owner's contact information:	Nature of Firm's Responsibility:	
Name: Greenwood Park and Baton Rouge Zoo Location: Baton Rouge, LA Owner: Recreation Park Commission for the Parish of East Baton Rouge (BREC) c/o Torre Design Consortium Ace Torre - 504.899.2932	This project involves redeveloping nearly 660 acres at Greenwood Community Park, which is the largest park in Baton Rouge and also includes the Baton Rouge Zoo. Julien is the structural engineer of record for this project. Julien's responsibilities within the park included overseeing structural design for park amenities, such as, a golf course, a waterfront building, an outdoor concert venue, a bayou promenade, and many other features to serve park visitors. For the zoo, Julien was responsible for the structural design of the main entry building, and many zoo exhibits, including the African Aviary exhibit, the Elk/Bison exhibit, the Condor and Eagle exhibit, giraffe nighthouse, and several other animal exhibits. Julien provided the structural engineering design of plans and specifications, and will provide construction administration once construction begins.	
Completion Date (Actual or estimated):	Estimated Cost:	
	Entire Project:	Work for which Firm was Responsible:
JUN. 2023	\$40M (Phase 1)	\$30M (Phase 1)

PROJECT NO. 6		
Project Name, Location and Owner's contact information:	Nature of Firm's Responsibility:	
Name: Fourth District Police Station Location: New Orleans, LA Owner: City of New Orleans Vincent Smith - viasmith@nola.gov	This project involves constructing a new 18,000 SF police station on an undeveloped site. The building will be a multi-story steel framed structure with associated site paving and utilities. Julien Engineering is the civil/structural engineer of record for design and is also providing assistance with construction administration. as well as construction administration.	
Completion Date (Actual or estimated):	Estimated Cost:	
	Entire Project:	Work for which Firm was Responsible:
JUN. 2022	\$4.5M	\$2.5M

TEC Professional Services Questionnaire

PROJECT NO. 7		
Project Name, Location and Owner's contact information:	Nature of Firm's Responsibility:	
Name: Leo Kerner Elementary School Renovations Location: Lafitte, LA Owner: Jefferson Parish Schools c/o Mathes Brierre Architects Pete Priola - 504.586.9303	This project involves miscellaneous renovations of a 68,000 square foot multi-level school building. Our firm's responsibility for this project was to design a new mechanical platform and slab foundation to support the new proposed mechanical units, as well as a new slab for the new proposed transformer. Julien Engineering is providing the structural design, structural plans & specifications and construction administration services.	
Completion Date (Actual or estimated):	Estimated Cost:	
	Entire Project:	Work for which Firm was Responsible:
JUN. 2023	\$2M	\$750K

PROJECT NO. 8		
Project Name, Location and Owner's contact information:	Nature of Firm's Responsibility:	
Name: Charity Hospital Redevelopment Location: New Orleans, LA Owner: 1532 Tulane Partners Joseph St. Martin - jsm@1532tulane.com	This renovation project involves the redevelopment of the one-million square foot former Charity Hospital Building, which was built in 1938. The refurbished building will serve as a mixed-use facility that will have offices, retail and public space, as well as residential units. Julien Engineering is providing civil and structural engineering design, plans & specifications, and construction administration services. For civil, Julien's role was to provide design for the modified parking lot, water, sewer, and drainage utilities, stormwater management, pavement surfaces, and other miscellaneous site elements. Structural work included various site demolition, and modification to existing framework and slab areas, as well as installation of new framing where necessary.	
Completion Date (Actual or estimated):	Estimated Cost:	
	Entire Project:	Work for which Firm was Responsible:
2025	\$300M	\$25M

TEC Professional Services Questionnaire

PROJECT NO. 9		
Project Name, Location and Owner's contact information: Name: Jefferson Parish Public Schools - Modular Buildings Location: Multiple locations in Jefferson Parish, LA Owner: Jefferson Parish Schools c/o Mathes Brierre Architects Pete Priola - 504.586.9303	Nature of Firm's Responsibility: This project involves designing foundations for new modular buildings and associated canopies, stairs, and ramps at Gretna Park Elementary, Marie Riviere Elementary, Alice Birney Elementary, and Geraldine Boudreaux Elementary. Julien Engineering is providing the structural design, structural plans & specifications, and construction administration services.	
Completion Date (Actual or estimated): <div style="text-align: center; padding-top: 20px;">OCT. 2023</div>	Estimated Cost:	
	Entire Project: <div style="text-align: center; padding-top: 20px;">\$1.0M</div>	Work for which Firm was Responsible: <div style="text-align: center; padding-top: 20px;">\$200K</div>

PROJECT NO. 10		
Project Name, Location and Owner's contact information: Name: Delgado City Park - Nursing & Allied Health Building Location: New Orleans, LA Owner: Delgado Community College c/o Manning Architects Dominic Willard - 504.412.2000	Nature of Firm's Responsibility: This project involves construction of a new 80,000 square foot, multi-level facility and associated amenities located at Delgado's City Park campus. The new building will provide next-generation facilities and technology for future nurses and allied health professionals, including traditional lecture classrooms, advanced labs simulating real-world healthcare delivery settings, and a virtual hospital floor. JULIEN provided civil and structural engineering, developed plans and specifications, as well as construction administration. Responsible design elements included foundations, framing, paving, stormwater drainage, sanitary sewerage, water supply, and general sitework.	
Completion Date (Actual or estimated): <div style="text-align: center; padding-top: 20px;">2023</div>	Estimated Cost:	
	Entire Project: <div style="text-align: center; padding-top: 20px;">\$40M</div>	Work for which Firm was Responsible: <div style="text-align: center; padding-top: 20px;">\$8M</div>

TEC Professional Services Questionnaire

M. List all prior and/or on-going litigation between Firm and Jefferson Parish. Please attach additional pages if necessary.

Parties:		Status/Result of Case:
Plaintiff:	Defendant:	
1. N/A	N/A	N/A
2.		
3.		
4.		

N. Use this space to provide any additional information or description of resources supporting Firm's qualifications for the proposed project.

Established in 1995, Julien Engineering and Consulting, Inc (JEC) is a professional engineering firm specializing in civil & structural engineering and construction administration & inspection. We assist clients in an expedient manner and provide accurate cost effective solutions for projects requiring civil and structural engineering. Our project interests are maintained in buildings, transportation features, roadways, storm sewer, drainage, sewerage, water supply, structures, site development, foundations, and other areas related to infrastructure development and improvement. JEC is a minority-owned, small business firm which is DBE certified by State of Louisiana, LADOTD, City of Orleans, Orleans Parish School Board, Louis Armstrong New Orleans International Airport, the Sewerage & Water Board of New Orleans, Orleans Levee District, and the Small Business Administration (SBA - HUB Zone) and is CCR registered. We have the supporting facilities including advanced technology, and supplementary equipment required to complete any engineering task in a timely manner. Registered engineers supervise all engineering work. JEC provides design, analysis, construction administration, resident inspection, and development of plans, specifications, reports, and assessments.

The professional staff at JEC has direct experience on civil/structural projects involving work on *public buildings and infrastructure*. As demonstrated through our vast experience with past clients, we have the professional qualifications, education and experience required to perform the necessary work above the expected level. JEC professionals have managed projects from conception to successful completion providing leadership to dynamic teams of owners, contractors, public agencies, private institutions, and the public.

O. To the best of my knowledge, the foregoing is an accurate statement of facts.

Signature:  Print Name: Kerwin E. Julien, Sr.
 Title: President Date: 01/18/2023

TEC Professional Services Questionnaire

A. Project Name and Advertisement Resolution Number:

Professional Architectural and Engineering Services on an as-needed basis for architectural type projects located throughout the Parish for an approximate two-year period.
Resolution Number 140999

B. Firm Name & Address:

H. Davis Cole & Associates, LLC
1340 Poydras Street, Suite 1850
New Orleans, LA 70112

C. Name, title and contact information of Principal, as defined in Section 2-926 of the Jefferson Parish Code of Ordinances, who is a registered, licensed architect, professional engineer, or surveyor in the State of Louisiana:

H. Davis Cole, P.E.

Managing Member/ Principal Engineer
Phone: (504) 836-2020
Fax: (504) 836-2010
Email: hddcole@hdaviscole.com

D. Name and contact information of employee who is a registered and licensed architect, professional engineer, or surveyor in the State of Louisiana in the applicable discipline. A subcontractor may be substituted here only if the advertised Project requires more than one discipline.

H. Davis Cole, P.E.

Managing Member / Principal Engineer
Phone: (504) 836-2020
Fax: (504) 836-2010
Email: hddcole@hdaviscole.com

E. Please provide the number of employees whose primary function corresponds with each category:

<u>2</u> Administrative	<u> </u> Estimators	<u> </u> Specification Writers
<u> </u> Architects (Licensed)	<u> </u> Geologists	<u> </u> Structural Engineers
<u> </u> Chemical Engineers	<u> </u> Geotechnical Engineers	<u> </u> Graduate Architects
<u>3</u> Civil Engineers	<u> </u> Interior Designers	<u>1*</u> Project Managers
<u>1</u> Construction Inspectors	<u> </u> Landscape Architects	<u> </u> Clerical
<u> </u> Ecologists	<u> </u> Land Surveyor	<u> </u> Grant/Funding Specialist
<u> </u> Electrical Engineers	<u> </u> Mechanical Engineers	<u> </u> Sanitary Engineers
<u> </u> Engineer Intern	<u> </u> Environmental Engineers	
<u> </u> Professional Land Surveyors		<u>7</u> TOTAL

F. Is this submittal by a JOINT-VENTURE? Please check: YES NO **X**

If marked "No" skip to Section I. If marked "yes" complete Sections G-H.

TEC Professional Services Questionnaire

G. If submittal is by JOINT-VENTURE, list the firms participating and outline specific areas of responsibility (including administrative, technical, and financial) for each firm. Please attach additional pages if necessary.

1.
N/A

2.
N/A

H. Has this JOINT-VENTURE previously worked together? Please check:
YES _____ NO _____

I. List all subcontractors anticipated for this Project. Please note that all subcontractors must submit a fully completed copy of this questionnaire, applicable licenses, and any other information required by the advertisement. See Jefferson Parish Code of Ordinances, Sec. 2-928(a)(3). Please attach additional pages if necessary.

Name & Address:	Specialty:	Worked with Firm Before (Yes or No):
1. N/A	N/A	NA
2.		
3.		

J. Please specify the total number of support personnel that may assist in the completion of this Project:

7

TEC Professional Services Questionnaire

K. List the professional in charge, key persons, specialists, and individual consultants anticipated for this Project and provide their relevant information below. If necessary, please attach additional documentation (i.e. resume) that demonstrates the employment history and experience of the Firm's key persons that may assist in the completion of this Project. Please attach additional pages if necessary.

PROFESSIONAL IN CHARGE OF PROJECT:

Name & Title:

H. Davis Cole, P.E.

Managing Member/ Principal Engineer

Project Assignment:

Principal Engineer

Name of Firm with which associated:

H. Davis Cole & Associates, LLC

Years' experience with this Firm:

17 Years (2006)

Education: Degree(s)/Year/Specialization:

BSCE, 1998, Civil & Environmental Engineering, Louisiana State University

Active registration: Year first registered/discipline:

2002, Civil Engineer, Louisiana, No. 30219

2017, LSUCCC Third Party Provider, U02383

Other experience and qualifications relevant to the proposed Project.

Mr. Cole founded H. Davis Cole & Associates, LLC in 2006 after serving several years with international, national, and local engineering firms. Mr. Cole has over two decades of experience working with various types of program management and civil engineering projects including wastewater, drainage, potable water, structural, and transportation improvement projects. Mr. Cole has served the Southeast Louisiana community for the past decade through his role as a Technical Advisor on many infrastructure improvement projects as well as the grant and program management of recovery programs following disasters. Mr. Cole's career has focused on providing civil and environmental engineering design solutions to municipal clients across the Gulf Coast. Mr. Cole also serves on the Louisiana Naval War Memorial Commission.

TEC Professional Services Questionnaire

KEY PERSON, SPECIALIST, OR INDIVIDUAL CONSULTANT:
Name & Title:
Rachel Merkl, EI Civil Engineer Intern
Project Assignment:
Civil Designer
Name of Firm with which associated:
H. Davis Cole & Associates, LLC
Years' experience with this Firm:
5 (2018)
Education: Degree(s)/Year/Specialization:
B.S., 2017, Civil & Environmental Engineering, University of New Orleans
Active registration: Year first registered/discipline:
Traffic Control Supervisor & Technician Certification, ATSSA, 2019
Other experience and qualifications relevant to the proposed Project.
<p>Ms. Merkl is a degreed civil engineer currently enrolled in a master's program in Architecture. She joined HDCA as a member of the Engineering Design team and assists with the creation of design documents for infrastructure projects. Ms. Merkl is skilled in AutoCAD, ArcGIS, RISA, HEC-GeoHMS, HEC-GeoRAS, EPANET, SketchUp and HEC-RAS, as well as the Adobe Creative Suite of programs.</p> <p>EXPERIENCE WITH JEFFERSON PARISH</p> <p>Improvements to "Rheem" Building, Department of Drainage, Jefferson Parish, LA. HDCA prepared plans and specifications for modifications to the Drainage Department's Yard Facility on the East Bank of the Parish to provide for a dormitory and staging area for staff during emergency operations. Ms. Merkl assisted with the design of plans for the project and has provided periodic field services throughout construction. Construction was completed and the facility is currently in-use. (ongoing)</p> <p>Improvements to the Ehret & Broas Lift Station (L-13-6), Jefferson Parish, LA. HDCA is providing design, permitting, bid phase, and construction phase services related to the restoration of functionality at the existing lift station on the west bank of Jefferson Parish. The existing station is to be demolished and replaced with a new, relocated station. The new station includes a wet well, valve pit, control panel, and emergency pump out, along with submersible pumps and Variable Frequency Drives (VFDs). Ms. Merkl is assisting with the preparation of construction drawings for the project. (ongoing)</p>

TEC Professional Services Questionnaire

KEY PERSON, SPECIALIST, OR INDIVIDUAL CONSULTANT:
Name & Title:
John Baucum Director of Construction Services
Project Assignment:
Resident Project Representative / Construction Contract Management
Name of Firm with which associated:
H. Davis Cole & Associates, LLC
Years' experience with this Firm:
12 (2011)
Education: Degree(s)/Year/Specialization:
Coursework, Pearl River Community College ASCE Construction Engineering Certificate Program (CERCE17)
Active registration: Year first registered/discipline:
Traffic Control Supervisor & Technician Certification, ATSSA, 2018
Other experience and qualifications relevant to the proposed Project.
<p>Mr. Baucum is an experienced water & sewer operator, with advanced knowledge of many aspects of public works construction. Mr. Baucum serves as a Construction Manager for HDCA, responsible for Construction Phase Services and Resident Inspection in support of design activities. Mr. Baucum's breadth of knowledge is evident in both his communications in the field and astute reporting of observations.</p> <p>EXPERIENCE WITH JEFFERSON PARISH</p> <p>Improvements to "Rheem" Building, Department of Drainage, Jefferson Parish, LA. HDCA prepared plans and specifications for modifications to the Drainage Department's Yard Facility on the East Bank. Improvements included the addition of a dormitory and staging area for staff during emergency operations. Mr. Baucum also provided Resident Inspection Services periodically throughout construction of the project. Construction has been completed and the facility is now in-use. (ongoing)</p> <p>Brown Avenue Canal Improvements, Jefferson Parish, LA. HDCA designed improvements to the area surrounding Brown Avenue on the West Bank of Jefferson Parish. Improvements included the enclosure of the Brown Avenue Canal utilizing approximately 1,125 linear feet of 96" reinforced concrete pipe arch as well as cold-planing segments of the existing Brown Avenue and overlaying with new asphalt. Upon completion of the construction of the first phase of the project, Jefferson parish increased the scope of the project to include the remaining section of Brown Avenue for improvements. Design of Phase II of the project was recently bid and is awaiting the start of construction. Mr. Baucum is assisting with construction management of the project. (ongoing)</p>

TEC Professional Services Questionnaire

KEY PERSON, SPECIALIST, OR INDIVIDUAL CONSULTANT:
Name & Title:
Angie Triche Administrative/Project Controls
Project Assignment:
Administrative Services
Name of Firm with which associated:
H. Davis Cole & Associates, LLC
Years' experience with this Firm:
15 Years (2008)
Education: Degree(s)/Year/Specialization:
B.S., 2013, Management, University of Phoenix
Active registration: Year first registered/discipline:
Not Applicable
Other experience and qualifications relevant to the proposed Project.
<p>Ms. Triche serves as a Project Control Specialist at HDCA, responsible for financial and document controls for various projects. Ms. Triche has been responsible for the accounting management of task orders for The SBSA Group, HDCA's Joint Venture company. Additionally, Ms. Triche has skillfully managed the financial reporting aspect of the firm's involvement in the program management of the FEMA-funded hurricane recovery of St. Bernard Parish since the program's inception.</p> <p>Hurricane Recovery Administrative & Program Management, St. Bernard Parish, LA. Ms. Triche is serving as document control coordinator for the management of FEMA – funded recovery projects in St. Bernard Parish, Louisiana. Ms. Triche's duties include the logging and tracking of incoming documents, distribution of documents to the appropriate Program Manager or Parish Personnel, preparation and maintenance of Project Worksheet Files to ensure that all are ready for closeout, and invoice tracking. Ms. Triche's challenging role includes the tracking and maintenance of documents for over 550 individual projects. (ongoing)</p> <p>SBSA Task Orders 3, 7, 8, 9, 11, 13, 50, 64, 87, 92, 97. Ms. Triche oversaw billing and invoicing for these task orders for the U.S. Army Corps of Engineers (USACE). These "Staff Extension" Task Orders required detailed invoicing and accounting procedures, and Ms. Triche was responsible for overseeing and coordinating all invoicing activities for multiple staff extension personnel in accordance with USACE standards. (2015)</p>

TEC Professional Services Questionnaire

KEY PERSON, SPECIALIST, OR INDIVIDUAL CONSULTANT:

Name & Title:**Jason Guy**

Construction Project Manager (Contractor)

Project Assignment:

Construction Phase Services

Name of Firm with which associated:**H. Davis Cole & Associates, LLC****Years' experience with this Firm:**

Contractor (Since 2015)

Education: Degree(s)/Year/Specialization:

B.S., 1995, Civil Engineering, Louisiana State University

Active registration: Year first registered/discipline:

Not Applicable

Other experience and qualifications relevant to the proposed Project.

Mr. Guy has a Bachelor of Science degree in Civil Engineering and over two decades of experience providing construction management, program management, estimating, quality control, surveying and design service for governmental and municipal infrastructure projects. He specializes in the construction administration of general municipal and private projects and has participated in the design of a wide variety of projects. Mr. Guy has been instrumental in the successful construction management of federally funded projects including the recovery efforts following Hurricanes Katrina & Rita in St. Bernard Parish, Louisiana.

CONSTRUCTION PROGRAM MANAGEMENT

Roadway Rehabilitation Program, St. Bernard Parish Government, LA. As a Construction Manager for the Roadway Rehabilitation Program, Mr. Guy has assisted in identifying and justification of additional eligible storm damage throughout both the design phase and construction phase for FEMA assessment. Mr. Guy has facilitated the resolution of construction-related field issues with third-party architects and engineers, contractors, and St. Bernard Parish Government. Mr. Guy works to ensure construction schedules are followed and maintained. Mr. Guy has also served as an Owner's Representative to address and resolve resident complaints related to the construction activities. (Ongoing)

TEC Professional Services Questionnaire

L. Work by Firm or Joint-Venture members which best illustrates current qualifications relevant to this Project. Please include any and all work performed for Jefferson Parish. Please attach additional pages if necessary.

PROJECT NO. 1

Project Name, Location and Owner's contact information:	Nature of Firm's Responsibility:	
Rheem Building Improvements Jefferson Parish, LA Jefferson Parish Department of Drainage Mitchell T. Theriot, P.E. Director of Drainage 504-736-6753	HDCA provided engineering services for a rehabilitation of an existing building owned by the Jefferson Parish Drainage Department. The remodel included the build-outs of a dormitory and storage space from the existing building. The dormitory is a 2,800 sq ft free-standing structure consisting of sleeping and kitchen space for department employees who may need to shelter at the building to support the department during an emergency. The storage area is a build-out of an existing space to better serve the department as a protected area to store equipment and tools. The project was successfully bid, constructed, and the facility is currently in-use.	
Completion Date (Actual or estimated):	Estimated Cost:	
	Entire Project:	Work for which Firm was Responsible:
2020	\$522,000.00	\$43,000.00 (fee)

PROJECT NO. 2

Project Name, Location and Owner's contact information:	Nature of Firm's Responsibility:	
Program Management for Critical Facilities Hardening Catahoula Parish, LA Catahoula Parish Police Jury Rodney Sones Police Jury President 318-744-5435	HDCA served as Program Manager for the HMGP-funded storm hardening of four facilities in Catahoula Parish, Louisiana. The hazard mitigation project included installation of storm shutter systems and tornado safe rooms at the Parish Courthouse, Parish Maintenance Unit, and Parish Health Unit. Program Management Services included assisting in the procurement and management of architectural/engineering services, review of plans & specifications, management of pay requests, and overall grant management, including the preparation of reports & documentation required by State and Federal agencies.	
Completion Date (Actual or estimated):	Estimated Cost:	
	Entire Project:	Work for which Firm was Responsible:
2015	\$1,300,000.00	\$50,000.00 (fee)

TEC Professional Services Questionnaire

L. Work by Firm or Joint-Venture members which best illustrates current qualifications relevant to this Project. Please include any and all work performed for Jefferson Parish. Please attach additional pages if necessary.

PROJECT NO. 3

Project Name, Location and Owner's contact information:	Nature of Firm's Responsibility:	
Improvements to the Baton Rouge North Plant Baton Rouge City/Parish, LA CDMSmith (Prime Firm) David Peters, P.E. Project Manager 225-663-3034	HDCA served on the CDMSmith Team selected by the East Baton Rouge City-Parish Engineering Selection Committee to design improvements at the North Wastewater Treatment Plant. Generally, the scope of the project included a new preliminary treatment facility, rehabilitation of the existing primary settling tanks, modifications to the primary effluent pump station, rehabilitation of the existing trickling filters, dewatering building and sludge thickener system modifications, and associated yard piping, site, and electrical & controls improvements. HDCA was responsible for design of the HVAC and plumbing systems at the plant, as well as odor control piping.	
Completion Date (Actual or estimated):	Estimated Cost:	
	Entire Project:	Work for which Firm was Responsible:
2017	\$45,000,000.00	\$45,000,000.00

PROJECT NO. 4

Project Name, Location and Owner's contact information:	Nature of Firm's Responsibility:	
Delacroix Island Pier: Fishing Complex & Assembly Complex St. Bernard Parish, LA St. Bernard Parish Department of Public Works Matt Falati, P.E. Director of Public Works 504-278-4314	HDCA provided professional engineering services for the Pavilion and Dockside Improvements to the Delacroix Assembly Facility. The project included the preliminary and final design of the bulkhead & waterfront fishing pavilion, a mobile boat hoist system, travel crane platform, as well as overall site improvements including an access road. This project was designed on an accelerated schedule to ensure construction could be completed in time for St. Bernard Parish's "Blessing of the Fleet" to be held at the Pavilion. All phases of the project have been constructed and are currently in use. The pavilion is open to the public for boat blessings, private functions, and local seafood promotions.	
Completion Date (Actual or estimated):	Estimated Cost:	
	Entire Project:	Work for which Firm was Responsible:
2017	\$180,000.00	\$50,000.00 (fee)

TEC Professional Services Questionnaire

L. Work by Firm or Joint-Venture members which best illustrates current qualifications relevant to this Project. Please include any and all work performed for Jefferson Parish. Please attach additional pages if necessary.

PROJECT NO. 5

Project Name, Location and Owner's contact information:	Nature of Firm's Responsibility:	
Hurricane Shutters for Popich Building Plaquemines Parish, LA Plaquemines Parish Government Engineering & Public Works Ken Dugas, P.E. Chief Engineer 504-297-5343	HDCA prepared plans & specifications and provided construction phase services for this hazard mitigation project which involved the installation of removable storm panels at the Plaquemines Parish Government Building. Services included development of plans & specifications, development of renderings of the installed panels, and construction administration. The project was funded through FEMA Hazard Mitigation Grant Funding. Construction was completed for \$335,000 which included an increase over the original grant amount, negotiated by HDCA.	
Completion Date (Actual or estimated):	Estimated Cost:	
	Entire Project:	Work for which Firm was Responsible:
2010	\$335,000.00	\$24,000.00 (fee)

PROJECT NO. 6

Project Name, Location and Owner's contact information:	Nature of Firm's Responsibility:	
FEMA-Funded Hurricane Recovery and Restoration Projects - Program Management Services: Civic Center Renovation St. Bernard Parish, LA St. Bernard Parish Department of Public Works Matt Falati, P.E. Director of Public Works 504-278-4314	The St. Bernard Civic Center is located at the intersection of West Judge Perez and Jean Lafitte, adjacent to the Parish Government complex. The Civic Center is comprised of two separated components, a full-service auditorium and ballroom. An accelerated, fast-tracked construction schedule was used to achieve the desired construction time frame of approximately 200 days and the renovation cost managed to meet the budgetary constraints. Prior to the Civic Center renovation project, the services of several other contractors were secured to perform required environmental, selective demolition, and miscellaneous work items. The services of these contractors were secured through purchase orders, letter bids, and/or construction contracts.	
Completion Date (Actual or estimated):	Estimated Cost:	
	Entire Project:	Work for which Firm was Responsible:
2010	\$7,000,000.00	\$7,000,000.00

TEC Professional Services Questionnaire

L. Work by Firm or Joint-Venture members which best illustrates current qualifications relevant to this Project. Please include any and all work performed for Jefferson Parish. Please attach additional pages if necessary.

PROJECT NO. 7

Project Name, Location and Owner's contact information:	Nature of Firm's Responsibility:	
Goodyear Tire Store Site Design Covington, LA Embree Asset Group, Inc. Jeff Ferrell Design Manager 512-819-4754	H. Davis Cole & Associates provided civil and site design for Embree Development Group's proposed 6,500 square foot Goodyear Tire Store in Covington, Louisiana. HDCA provided site design, including site layout, grading, drainage, retaining wall and pavement design. HDCA also provided administrative support for the schematic and final design of the project.	
Completion Date (Actual or estimated):	Estimated Cost:	
	Entire Project:	Work for which Firm was Responsible:
2015	\$1,200,000.00	\$25,000.00 (fee)

PROJECT NO. 8

Project Name, Location and Owner's contact information:	Nature of Firm's Responsibility:	
Improvements to the Terrace Avenue WWTP Slidell, LA City of Slidell Department of Engineering Blaine Clancy, P.E. City Engineer 985-646-4270	HDCA is providing engineering design services to implement mechanical, structural, and process improvements at the City's existing Terrace Avenue WWTP. HDCA had previously provided the City of Slidell with a structural and mechanical assessment of the various existing facilities at the Terrace Avenue Treatment Plant. The plant has an average daily flow of approximately 4.0 MGD and a peak hydraulic capacity of 15 MGD. HDCA worked closely with the Owner to assess various plant facilities including the headworks, grit removal system, primary clarifiers, secondary clarifiers, chlorination facility, spray water system, return activated sludge pump station, waste activated pump station, and in-house station. Proposed improvements at the plant were all structural and mechanical or civil in nature, including the renovation of buildings, platforms, stairwells and improvements to roofing configurations at multiple plant facilities. HDCA also prepared construction cost opinions and prepared an application for funding for future improvements through the EPA/LDEQ Clean Water State Revolving Loan Fund which was accepted for funding by LDEQ and EPA. The project was successfully bid and is currently under construction with HDCA providing daily resident project representation services and construction administration for the duration of the project.	
Completion Date (Actual or estimated):	Estimated Cost:	
	Entire Project:	Work for which Firm was Responsible:
2023 (E)	\$8,542,000.00	\$997,000.00 (fee)

TEC Professional Services Questionnaire

L. Work by Firm or Joint-Venture members which best illustrates current qualifications relevant to this Project. Please include any and all work performed for Jefferson Parish. Please attach additional pages if necessary.

PROJECT NO. 9

Project Name, Location and Owner's contact information:	Nature of Firm's Responsibility:	
Baton Rouge Adolescent Psychiatric Hospital Baton Rouge, LA MB Design Consultants Jatinder Goel Project Manager 225-612-3938	HDCA is currently providing civil engineering and permitting services for the development of a new 23,000 sq ft psychiatric hospital in Baton Rouge, LA. HDCA's services include the preparation of a Drainage Impact Study consisting of a detailed hydrologic and hydraulic analysis of the property as necessary for compliance with the Baton Rouge Unified Development Code. HDCA is also developing detailed construction plans for the on-site improvements, including the geometric layout; grading and drainage layout; paving details; and overall utility layout. HDCA is also providing permitting services as well as the Stormwater Pollution Prevention Plan (SWPPP) for the project.	
Completion Date (Actual or estimated):	Estimated Cost:	
	Entire Project:	Work for which Firm was Responsible:
2024 (E)	TBD	\$17,000.00 (fee)

PROJECT NO. 10

Project Name, Location and Owner's contact information:	Nature of Firm's Responsibility:	
West Point Development - Veterans Housing New Orleans, LA MB Design Consultants Jatinder Goel Project Manager 225-612-3938	HDCA is currently providing site design services for the development of a new housing development to benefit veterans of the United States Military in New Orleans. The development, which is situated on nearly 8 acres, will consist of 9 buildings with 30 apartment units each, as well as a 5,000 sq ft administration building and 288 parking spots. HDCA is preparing the formal drainage calculations and Stormwater Management Plan required to be submitted to the City of New Orleans as required for compliance with the City of New Orleans Stormwater Management Ordinance. Additional services include the development of civil and site construction documents which will consist of a site plan, grading and drainage plan, paving plan, sewer plan, water service plan, electrical plan, and associated detail drawings necessary for permitting and construction. Due to the large size of the development, HDCA will be responsible for the design of on-site stormwater retention facilities, as required. HDCA will also prepare a SWPP, Notice of Intent (NOI), and all additional permits required for coverage under the LDEQ LAR100000 permit.	
Completion Date (Actual or estimated):	Estimated Cost:	
	Entire Project:	Work for which Firm was Responsible:
2025 (E)	TBD	\$55,000.00 (fee)

TEC Professional Services Questionnaire

M. List all prior and/or on-going litigation between Firm and Jefferson Parish. Please attach additional pages if necessary.

Parties:		Status/Result of Case:
Plaintiff:	Defendant:	
1. HDCA has never been involved in litigation with Jefferson Parish.		
2.		
3.		
4.		

N. Use this space to provide any additional information or description of resources supporting Firm's qualifications for the proposed project.

FIRM HISTORY

HDCA was founded in 2006 and has rapidly grown to be a leader in providing exceptional client services to meet the public works engineering and environmental needs of municipal, governmental, and private sector clients through performance, quality, and teamwork. Our highly qualified team of motivated professionals provides a variety of services that include design, engineering and analyses, field investigations, construction management, construction inspection, computer modeling, environmental documentation, permitting, and regulatory support. For three years in a row (2016, 2017, 2018), HDCA was included in the 'LSU 100' which recognizes the fastest growing LSU-alumni-owned businesses in the world. Each year the award distinguishes one hundred successful entrepreneurs hailing from Louisiana State University who best embody the institution's values, character and leadership. HDCA was honored to be included in the list of accomplished local professionals. The company is licensed in the State of Louisiana, with professional engineers registered in other states as well. HDCA offices are located in New Orleans, Louisiana. HDCA is certified under the Small Entrepreneurship Program as a Hudson Initiative Certified Firm by the Louisiana Department of Economic Development.

HDCA's staff members have an average of over 20 years of experience in Civil and Environmental Engineering, all of which is in the design and construction oversight of major infrastructure.

Summary of Evaluation Criteria

1. Professional training and experience in relation to the type of work required for the architectural or engineering services – 35 points

HDCA has worked with almost every facet of the public sector and the private industry, serving individual clients with the utmost professionalism. The personnel at HDCA possess a wide range of experience in terms of both project type and magnitude. This is evidenced in the résumés of our key personnel provided within this Questionnaire.

HDCA possesses significant in-house capabilities, including Computer Aided Design and Drafting (CADD) capabilities using AutoCAD, MicroStation and structural and hydraulic modeling software. HDCA also possesses significant sewer and water modeling capabilities through Bentley SewerGEMS and expertise with EPANET.

TEC Professional Services Questionnaire

HDCA is committed to maintaining the latest technology available to our profession to improve our ability to stay connected and accessible to our clients. We have all become experts at this skillset over the course of the last year and we are committed to continuing to improve and evolve our technology. This commitment extends into the production aspects of our business by using technology to improve our work efficiency and accuracy. This commitment to technology also results in significant savings to our clients in both the schedule and budget.

To supplement our in-house staff capabilities and expertise, we maintain an extensive professional network and have maintained strong personal and professional relationships with large and small specialty firms that provide supporting services such as wetlands specialists, FEMA specialists, grant managers, electrical engineering, structural engineering, geotechnical engineering, environmental engineering, land surveying, and materials testing / inspections / construction quality control services, on whom we rely as needed to assist us in special design considerations that are outside our area of expertise. These relationships allow us to provide comprehensive, turn-key, engineering services to our clients. As required, we employ capable, experienced sub-consultants on an as needed basis for specialized tasks.

2. Size of firm considering the number of professional and support personnel required to perform the type of architectural or engineering tasks, including project evaluation, project design, drafting of technical plans, development of technical specifications and construction administration – 20 points

HDCA is certified under the Small Entrepreneurship Program as a Hudson Initiative Certified Firm by the Louisiana Department of Economic Development. HDCA has sufficient engineering personnel to support Jefferson Parish for the duration of any assigned project. Our personnel members are highly motivated, hard working, and professional. Our personnel pride themselves on delivering the highest level of professional services with a personalized level of detail and attention that may be missing from larger firms. We are invested in improving the community in which we live and work. HDCA is a full-service civil engineering firm, capable of providing design, drafting, project management, the development of construction documents, and the provision of construction administrative services all in-house.

Minimum Requirements for Selection:

- 1. The persons or firms under consideration shall have at least one (1) principal who is a licensed, registered, professional engineer in the State of Louisiana (Section C. of TEC Professional Services Questionnaire);**

This requirement is met by Mr. H. Davis Cole, P.E., the principal engineer of HDCA.

- 2. The persons or firms under consideration shall have a professional in charge of the Project who is a licensed, registered, professional architect in the State of Louisiana with a minimum of five (5) years' experience.**

N/A

- 3. The persons or firms under consideration shall have one (1) employee who is a licensed, registered, professional engineer, surveyor or landscape architect in the State of Louisiana in each of the applicable disciplines involved. A subcontractor may meet this requirement since the advertised Project involves more than one discipline (Section D. of TEC Professional Services Questionnaire).**

This requirement is met by both of HDCA's professional civil engineers: Mr. H. Davis Cole, P.E. and Mr. Mike D'Angelo, P.E, PLS. both of whom are licensed professional engineers in the State of Louisiana.

TEC Professional Services Questionnaire

3. Capacity for timely completion of newly assigned work, considering the factors of type of architectural or engineering task, current unfinished workload, and person or firm's available professional and support personnel – 20 points

Based on the firm's current and expected project workload and schedule, HDCA is capable of allocating the necessary resources and manpower required to support Jefferson Parish for the duration of any assigned architectural or engineering project. The contract and project management philosophy of HDCA is to maintain a strong working relationship with the client to protect your interests and accomplish project goals in a cost effective, responsive, and responsible manner. These interests and goals are to produce and deliver the highest quality projects that are welcomed by all stakeholders, and are technically and environmentally sound, affordable and completed within the project schedule.

HDCA personnel are adept at managing multiple projects in varying phases of design and construction at any given time. This is accomplished through clear communication of goals and expectations with our clients at every phase.

4. Past Performance by person or firm on projects of or similar comparable size, scope, and scale. Assertions of fault by a person or firm, which shall include time delays, cost over-runs, and or design inadequacies in prior work completed for the Parish – 10 points

HDCA is proud of our relationship with Jefferson Parish, having served Jefferson Parish on a variety of infrastructure improvement projects over the course of the firm's existence. Individual personnel members have provided engineering services to the Parish prior to joining HDCA and we're dedicated to continuing to serve the Jefferson Parish community. HDCA's long-standing relationships with governmental agencies and clients is the key to our business' success. Please feel free to contact our major governmental and private clients, which include those listed below, regarding our past performance on engineering design and project management related projects.

- Donald Bourgeois, Director of Capital Projects, 504-278-1593, St. Bernard Parish Government, Louisiana
- Michael J. Enlow, Project Manager, 225- 450-1326, Ascension Parish Government, Louisiana
- Blaine Clancy, P.E., City Engineer, 985-646-4270, City of Slidell, Louisiana

Additional references are available upon request.

5. Location of the principal office. (2) Neighboring Parishes of the Greater New Orleans Metropolitan Region, which includes Orleans – 12 points

HDCA has two offices located in Southeast Louisiana in Baton Rouge and New Orleans. Work will be completed in our corporate headquarters which is located in New Orleans at 1340 Poydras St., a very convenient location for quick access to Jefferson Parish. This proximity will allow our project managers and design team to be on-site at any Jefferson Parish assigned project quickly. We are also readily available to attend and assist with any meetings regarding the project, regardless of whether meetings are held at the project site or at a Jefferson Parish Government location.

We're a local firm and our roots are firmly planted in the area. Our staff members will be dedicated to providing the highest level of professional services to ensure the integrity of any Jefferson Parish assigned project.

TEC Professional Services Questionnaire

6. Adversarial legal proceedings between the Parish and the person or firm performing professional services – 15 points

HDCA has never been involved in litigation with Jefferson Parish.

7. Prior successful completion of projects of the type and nature of the architectural or engineering services, as defined, for which firm has provided verifiable references – 15 points

HDCA staff members have a history of superior performance on contracts with government, state, and local agencies as well as within private industry. The firm has been routinely recognized by our governmental clients as extremely responsive and competent in the services that we have provided. Our personnel have a consistent track record of providing quality projects to clients within both schedule and budget. This is evidenced by our staff's long standing relationships and repeat business with clients including the City of Slidell, St. Bernard Parish and Jefferson Parish.

The project which best demonstrates the firm's capabilities in regards to Architectural/ Engineering projects is the recent completion of the Improvements to the "Rheem" Building for the Jefferson Parish Drainage Department. HDCA provided design services for the build-out of the existing building to function as a dormitory space for use during emergencies, as well as safe storage of equipment. The HDCA team worked closely with the Drainage Department to ensure the overall design of the project met the specific needs of the department and we were careful to ensure the resulting space adhered to all applicable building and fire codes. HDCA personnel also provided daily resident project representation over the course of construction of the project, which was completed in late 2020.

We feel confident that our past successes depicted within this TEC Questionnaire have prepared our personnel to successfully complete any assigned architecture-type project that may be assigned by Jefferson Parish.

O. To the best of my knowledge, the forgoing is an accurate statement of facts.

Signature:

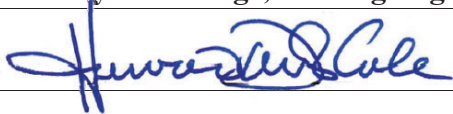

Print Name: H. Davis Cole, P.E.

Title: Managing Member

Date: January 19, 2023

Technical Evaluation Committee (TEC) Questionnaire

Instructions

- The Technical Evaluation Committee (TEC) Questionnaire shall be used for professional services related to architecture, engineering, or survey projects.
- **The TEC Questionnaire should be completely filled out. Complete and attach ALL sections. Insert “N/A” or “None” if a section does not apply or if there is no information to provide.**
- Questionnaire must be signed by an authorized representative of the Firm. Failure to sign the questionnaire shall result in disqualification of proposer pursuant to J.P. Code of Ordinances Sec. 2-928.
- All subcontractors must be listed in the appropriate section of the Questionnaire. Each subcontractor must provide a complete copy of the TEC Questionnaire, applicable licenses, and any other information required by the advertisement. Failure to provide the subcontractors' complete questionnaire(s), applicable licenses, and any other information required by the advertisement shall result in disqualification of proposer pursuant to J.P. Code of Ordinances Sec. 2-928.
- If additional pages are needed, attach them to the questionnaire and include all applicable information that is required by the questionnaire.

TEC Professional Services Questionnaire

A. Project Name and Advertisement Resolution Number:

SOQ 23-001 Professional Architectural and Engineering Services on an as-needed basis

B. Firm Name & Address:

Salas O'Brien - New Orleans
541 Julia St.
Suite 200
New Orleans, LA 70130

C. Name, title and contact information of Principal, as defined in Section 2-926 of the Jefferson Parish Code of Ordinances, who is a registered, licensed architect, professional engineer, or surveyor in the State of Louisiana:

D. Name and contact information of employee who is a registered and licensed architect, professional engineer, or surveyor in the State of Louisiana in the applicable discipline. A subcontractor may be substituted here only if the advertised Project requires more than one discipline.

David Bonaventure, PE, CEM, Principal
E | david.bonaventure@salasobrien.com
P | 225.372.6961

E. Please provide the number of employees whose primary function corresponds with each category:

<u>3</u> Administrative	<u> </u> Estimators	<u> </u> Specification Writers
<u> </u> Architects (Licensed)	<u> </u> Geologists	<u> </u> Structural Engineers
<u> </u> Chemical Engineers	<u> </u> Geotechnical Engineers	<u> </u> Graduate Engineers
<u> </u> Civil Engineers	<u> </u> Interior Designers	<u>4</u> Project Managers
<u>1</u> Construction Inspectors	<u> </u> Landscape Architects	<u> </u> Clerical
<u> </u> Ecologists	<u> </u> Land Surveyor	<u> </u> Grant/Funding Specialist
<u>4</u> Electrical Engineers	<u>5</u> Mechanical Engineers	<u> </u> Sanitary Engineers
<u> </u> Engineer Intern	<u> </u> Environmental Engineers	
<u> </u> Professional Land Surveyors	<u>15</u> Designer/Tech/CADD	<u>32</u> TOTAL

F. Is this submittal by a JOINT-VENTURE? Please check: YES ☐ NO ☒

If marked "No" skip to Section I. If marked "yes" complete Sections G-H.

TEC Professional Services Questionnaire

G. If submittal is by JOINT-VENTURE, list the firms participating and outline specific areas of responsibility (including administrative, technical, and financial) for each firm. Please attach additional pages if necessary.

1.

2.

H. Has this JOINT-VENTURE previously worked together? Please check:

YES ☐ NO ☐

I. List all subcontractors anticipated for this Project. Please note that all subcontractors must submit a fully completed copy of this questionnaire, applicable licenses, and any other information required by the advertisement. See Jefferson Parish Code of Ordinances, Sec. 2-928(a)(3). Please attach additional pages if necessary.

Name & Address:	Specialty:	Worked with Firm Before (Yes or No):
1. Salas O'Brien 541 Julia St. Suite 200 New Orleans, LA 70130	Mechanical, Electrical and Plumbing Engineering Design	Yes
2.		
3.		

J. Please specify the total number of support personnel that may assist in the completion of this Project:

TEC Professional Services Questionnaire

K. List the professional in charge, key persons, specialists, and individual consultants anticipated for this Project and provide their relevant information below. If necessary, please attach additional documentation (i.e. resume) that demonstrates the employment history and experience of the Firm's key persons that may assist in the completion of this Project. Please attach additional pages if necessary.

PROFESSIONAL IN CHARGE OF PROJECT:

Name & Title:

Project Assignment:

Name of Firm with which associated:

Years' experience with this Firm:

Education: Degree(s)/Year/Specialization:

Active registration: Year first registered/discipline:

Other experience and qualifications relevant to the proposed Project:

TEC Professional Services Questionnaire

KEY PERSON, SPECIALIST, OR INDIVIDUAL CONSULTANT:
Name & Title:
David Bonaventure, PE, CEM, Principal
Project Assignment:
Principal in Charge SOQ 23-001 Professional Architectural and Engineering Services on an as-needed basis
Name of Firm with which associated:
Salas O'Brien
Years' experience with this Firm:
22 Years
Education: Degree(s)/Year/Specialization:
Louisiana State University, Bachelor of Science, 1999, Mechanical Engineering University of Houston, Masters of Business Administration, 2003
Active registration: Year first registered/discipline:
Professional Engineer LA #0031064 / 2004
Other experience and qualifications relevant to the proposed Project:
Mr. Bonaventure joined Salas O'Brien in January 2000 as an Assistant Project Manager and Lead Mechanical Designer. He currently serves as the Principal In Charge of the New Orleans and Baton Rouge offices. Mr. Bonaventure is responsible for all projects at this location in addition to the mechanical design and specifications of projects for our production team. Mr. Bonaventure is a professional mechanical engineer with experience in management, design, and specifications of both large and small projects. David is ardent about his project's aesthetics and energy use. Because the visual aspects are so important to him, his projects are able to advance the clients' designs. Therefore, several his projects have gone on to win many architectural awards. He also went through the grueling task of becoming a Certified Energy Manager to further assist our clients in making the best energy decisions possible.

TEC Professional Services Questionnaire

KEY PERSON, SPECIALIST, OR INDIVIDUAL CONSULTANT:
Name & Title:
Tom Ward, PE, Senior Vice President
Project Assignment:
Project Manager SOQ 23-001 Professional Architectural and Engineering Services on an as-needed basis
Name of Firm with which associated:
Salas O'Brien
Years' experience with this Firm:
7 Years
Education: Degree(s)/Year/Specialization:
Master of Science, Applied Physics, University of New Orleans; 2012 Bachelor of Science, Applied Physics, Roanoke College; 2007
Active registration: Year first registered/discipline:
Virginia, North Carolina, Maryland
Other experience and qualifications relevant to the proposed Project:
Mr. Ward began his career working on the mechanical design build side for the second largest mechanical contractor on the gulf coast. Additionally, he worked on a diverse group of projects from high rise, schools, office as well as medical. He then decided to expand into the Consulting field with the goal of proactively solving the exact issues that he had witnessed happening in construction.

TEC Professional Services Questionnaire

KEY PERSON, SPECIALIST, OR INDIVIDUAL CONSULTANT:
Name & Title:
Jacob Truax, PE Project Manager / Electrical Engineer
Project Assignment:
Electrical Engineer SOQ 23-001 Professional Architectural and Engineering Services on an as-needed basis
Name of Firm with which associated:
Salas O'Brien
Years' experience with this Firm:
13 Years
Education: Degree(s)/Year/Specialization:
Bachelor of Science, Electrical Engineering, Louisiana State University
Active registration: Year first registered/discipline:
Electrical Engineer: LA PE.0040358 / 2015
Other experience and qualifications relevant to the proposed Project:
Mr. Truax joined Salas O'Brien in September 2008 as an intern electrical engineer until he became a graduate electrical engineer in 2010. He then spent a little less than a year working as an electrical engineer for the Department of Energy in the Oak Ridge National Lab in Tennessee before eventually moving back to Baton Rouge and working for an industrial Engineering firm in the oil and gas industry. In July 2013, Mr. Truax returned to Salas O'Brien as an electrical engineer and project manager. He has designed, managed, and checked a variety of projects from commercial, retail, government facilities, industrial plant expansions as well as major retail developments and apartments/residential developments.

TEC Professional Services Questionnaire

KEY PERSON, SPECIALIST, OR INDIVIDUAL CONSULTANT:
Name & Title:
Project Assignment:
Name of Firm with which associated:
Years' experience with this Firm:
Education: Degree(s)/Year/Specialization:
Active registration: Year first registered/discipline:
Other experience and qualifications relevant to the proposed Project:

TEC Professional Services Questionnaire

L. Work by Firm or Joint-Venture members which best illustrates current qualifications relevant to this Project. Please include any and all work performed for Jefferson Parish. Please attach additional pages if necessary.

PROJECT NO. 1

Project Name, Location and Owner's contact information:	Nature of Firm's Responsibility:	
<p>Redmellon Canal Street Development New Orleans, LA</p> <p>Trapolin Peer Architects Ashley King 504.523.2772 aking@trapolinpeer.com</p>	<p>Salas O'Brien is providing MEP consulting engineering for the renovation of existing buildings into short term rental hotel. The project is located at 1000-1015 Canal Street and 934 Canal Street in New Orleans, LA. Two sets of buildings will be renovated that combine 81,973sf. These will consist of office spaces being converted into hotel type programs.</p> <p>The electrical systems will consist of the lighting system, electrical distribution system and location of all electrical devices. The electronic safety and security systems consists of performance specification to install a fire detection and alarm system. The access control system including device locations, cabling and specifying equipment.</p>	
Completion Date (Actual or estimated):	Estimated Cost:	
	Entire Project:	Work for which Firm was Responsible:
2021	Fee: \$150,000	Mechanical, Electrical and Plumbing Design

PROJECT NO. 2

Project Name, Location and Owner's contact information:	Nature of Firm's Responsibility:	
<p>Audubon Zoo Capital one Pavilion New Orleans, LA</p> <p>Eskew Dumez Ripple Architects Mike Johnson 504.561.5686 mjohnson@eskewdumezripple.com</p>	<p>The Capital One Field and Stage (or Audubon Zoo Pavilion) is located at Audubon Zoo in New Orleans adjacent to the Audubon Tea Room. Salas O'Brien worked as a subconsultant for Eskew Dumez Ripple Architects and the Audubon Nature Institute on electrical conceptual plans for improvements to the pavilion and surrounding area.</p>	
Completion Date (Actual or estimated):	Estimated Cost:	
	Entire Project:	Work for which Firm was Responsible:
2021	\$318,933.61	Electrical Engineering

TEC Professional Services Questionnaire

PROJECT NO. 3		
Project Name, Location and Owner's contact information:	Nature of Firm's Responsibility	
GSA Wisdom Hall New Orleans, LA Gensler Jacqueline Johnson 214.273.1500 jacqueline_johnson@gensler.com	Salas O'Brien is currently working on the GSA Wisdom Hall Building in New Orleans. The project includes establishing the potential sources for water intrusion and developing a forensic engineering plan to address them; providing professional consulting services for the preparation of a Feasibility Study (FS) for a prospective capital improvement project located at the John Minor Wisdom US Court of Appeals Building; and completing engineering design services for renovations of rooms 102, 106, 116, and 131 on the 1st Floor. This project will accomplish the build out of space needed to support the expansion of private offices for the 5th Circuit's Automation Department and Circuit Library, the construction of a training room, VCT conference room, and renovations to the Circuit Library's staff restrooms.	
Completion Date (Actual or estimated)	Estimated Cost:	
	Entire Project:	Work for which Firm was Responsible:
Ongoing	\$1,3000,000	Mechanical, Electrical and Plumbing Engineering Design

PROJECT NO. 4		
Project Name, Location and Owner's contact information:	Nature of Firm's Responsibility:	
Jefferson Parish Gretna Park Upgrades Marrero, LA Manning Architects Tighe Kirkland 504.412.2000 tbk@manning.xyz	Salas O'Brien provided Structural, Mechanical, Electrical and Plumbing Consulting Engineering Services for Covid Memorial Park: Immediately north of the Westbank Expressway including the Covid Memorial, the walking trail, parking stalls, and picnic shelters The Amphitheater is excluded in this phase of the project. Farmers Market: Farmer's Market immediately south of the WBE including the stage, canopies, benches, washing station, and parking area. Kids Splash Zone immediately just south of the Johnny Jacobs Pool including the flow-thru splash zone facility and picnic shelters.	
Completion Date (Actual or estimated):	Estimated Cost:	
	Entire Project:	Work for which Firm was Responsible:
Ongoing	Fee: \$65,000	Structural, Mechanical, Electrical and Plumbing Consulting Engineering Services

TEC Professional Services Questionnaire

PROJECT NO. 5		
Project Name, Location and Owner's contact information:	Nature of Firm's Responsibility:	
<p>Jefferson Parish Computer Lab Dorothy Watson Metairie, LA</p> <p>Manning Architects Travis Martin 504.412.2000 t1m@manning.xyz</p>	<p>Salas O'Brien provided Structural, Mechanical, Electrical and Plumbing Consulting Engineering Services for A new computer lab designed and constructed in the interior of the existing building.</p>	
Completion Date (Actual or estimated):	Estimated Cost:	
	Entire Project:	Work for which Firm was Responsible:
2023	Fee: \$3,000	Structural, Mechanical, Electrical and Plumbing Consulting Engineering Services

PROJECT NO. 6		
Project Name, Location and Owner's contact information:	Nature of Firm's Responsibility:	
<p>IV Waste Knox Rd Jefferson, LA</p> <p>Zach Smith Consulting Zach Smith 504.383.3748 zach@zachsmithconsulting.com</p>	<p>Salas O'Brien provided Electrical and Plumbing for a recycle truck unload and material sort site. Also performed site lighting and oil water separators on the storm drainage</p>	
Completion Date (Actual or estimated):	Estimated Cost:	
	Entire Project:	Work for which Firm was Responsible:
2022	Fee: \$6,000	Electrical and Plumbing Consulting Engineering Services

TEC Professional Services Questionnaire

PROJECT NO. 7		
Project Name, Location and Owner's contact information:	Nature of Firm's Responsibility:	
Jefferson Parish Public School System Helen Cox High School HVAC Renovation Harvey, LA Manning Architects Dominic Willard 504.412.2000 daw@manning.xyz	Salas O'Brien provided Mechanical, Electrical and Plumbing Consulting Engineering Services for the HVAC renovation at an Helen Cox High School.	
Completion Date (Actual or estimated):	Estimated Cost:	
	Entire Project:	Work for which Firm was Responsible:
2022	\$3,913,000	Mechanical, Electrical and Plumbing Consulting Engineering Services

PROJECT NO. 8		
Project Name, Location and Owner's contact information:	Nature of Firm's Responsibility:	
The Beach at UNO New Orleans, LA Eskew Dumez Ripple Architects Jose Alvarez 504.561.5686 jalvarez@eskewdumezripple.com	Salas O'Brien provided Mechanical, Electrical and Plumbing Consulting Engineering two buildings will have selected areas renovated over the course of three phases. It is anticipated that the area of renovation is approximately 52,000 - square-feet. There will also be site improvements. Phase 1: This Phase to include Landscaping, Signage/Wayfinding, Outdoor Space. Phase 2: This phase to include finish, lighting, and restroom upgrades to common spaces at the ATC and ITC#1 Buildings. Phase 3: This phase to include a master plan program and vision for approximately 38,000 sf of coworking and conference center at the CERM building.	
Completion Date (Actual or estimated):	Estimated Cost:	
	Entire Project:	Work for which Firm was Responsible:
Ongoing	\$93,150	Mechanical, Electrical and Plumbing Consulting Engineering Services

TEC Professional Services Questionnaire

PROJECT NO. 9		
Project Name, Location and Owner's contact information:	Nature of Firm's Responsibility:	
Completion Date (Actual or estimated):	Estimated Cost:	
	Entire Project:	Work for which Firm was Responsible:

PROJECT NO. 10		
Project Name, Location and Owner's contact information:	Nature of Firm's Responsibility:	
Completion Date (Actual or estimated):	Estimated Cost:	
	Entire Project:	Work for which Firm was Responsible:

TEC Professional Services Questionnaire

M. List all prior and/or on-going litigation between Firm and Jefferson Parish. Please attach additional pages if necessary.

Parties:		Status/Result of Case:
Plaintiff:	Defendant:	
1. N/A		
2.		
3.		
4.		

N. Use this space to provide any additional information or description of resources supporting Firm's qualifications for the proposed project.

Jefferson Parish
State of Louisiana

O. To the best of my knowledge, the foregoing is an accurate statement of facts.

Signature:  Print Name: David Bonaventure
Title: Principal Date: 01/17/2023

State of Louisiana
Board of Architectural Examiners

The firm whose name appears on this certificate is in compliance with the provisions of the Louisiana State Board of Architectural Examiners' Licensing Law and Rules and Regulations and is duly registered and entitled to practice architecture in the State of Louisiana.

CERTIFICATE OF AUTHORITY NO. AC0251

EXPIRES June 30, 2023

Manning, APC

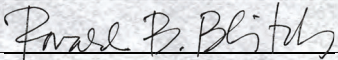
President

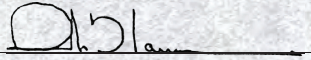
Secretary

Executive Director



May 16, 2022
Date

\$75.00
Fee Paid

(ALL CERTIFICATES BECOME DELINQUENT AFTER EXPIRATION DATE)

State of Louisiana
Board of Architectural Examiners



Registration No. AC0251

Expires June 30, 2023

Manning, APC

The above named is duly registered and entitled to practice Architecture in the state of Louisiana until the indicated expiration date.

Executive Director