

DATE: 1/17/2017

INVITATION TO BID
THIS IS NOT AN ORDER

Page: 4

BID NO.: 50-00118712

JEFFERSON PARISH

PURCHASING DEPARTMENT
P.O. BOX 9
GRETN, LA. 70054-0009
504-364-2678

VENDOR:

Basic Supply LLC

BUYER:

SFOLSE

As per LSA-RS 47:301 et seq., all governmental bodies are excluded from payment of sales taxes to any Louisiana taxing body. Quotations shall be based on F.O.B. Agency warehouse or jobsite, anywhere within the Parish as designated by the Purchasing Department.

JEFFERSON PARISH reserves the right to cancel all or any part of an order if not shipped promptly. No charges will be allowed for parking or cartage unless specified in quotation. The order must not be filled at a higher price than quoted. JEFFERSON PARISH reserves the right to cancel at any time and for any reason by issuing a THIRTY (30) day written notice to the contractor.

JEFFERSON PARISH is expecting all products to be new and all work is to be done in a workman-like manner, according to standard practices. Any deviations or alterations from the specifications must be indicated and backup documentation supplied with your quotation.

DELIVERY: FOB JEFFERSON PARISH

INDICATE DELIVERY DATE ON EQUIPMENT AND SUPPLIES _____

INDICATE STARTING TIME (IN DAYS) FOR CONSTRUCTION WORK _____

INDICATE COMPLETION TIME (IN DAYS) FOR CONSTRUCTION WORK _____

In the event that addenda are issued with this bid, bidders MUST acknowledge all addenda on the bid form. Bidder must acknowledge receipt of an addendum on the bid form as indicated. Failure to acknowledge any addendum on the bid form will result in bid rejection.

Acknowledge Receipt of Addenda: NUMBER: _____

NUMBER: _____

NUMBER: _____

NUMBER: _____

LOUISIANA CONTRACTOR'S LICENSE NO.: (if applicable) _____

*** ALL BIDDERS MUST COMPLETE SECTION BELOW ***

FIRM NAME: Basic Supply LLC	
SIGNATURE: (Must be signed here) John Atkinson	TITLE: Manager
PRINT OR TYPE NAME: John Atkinson	
ADDRESS: 2108 Cameron Street	
CITY, STATE: Lafayette LA	ZIP: 70596
TELEPHONE: 337 232-1733	FAX: 337 232-2045
EMAIL ADDRESS: charlotte@basicsupply.com	

TOTAL PRICE OF ALL BID ITEMS: \$ 14914.70 or 18138.70

depending on cross matches
on absolute breakers

INVITATION TO BID FROM JEFFERSON PARISH - continued

BID NO.: 50-00118712

SEALED BID

ITEM NUMBER	QUANTITY	U/M	DESCRIPTION OF ARTICLES	UNIT PRICE QUOTED	TOTALS
			ELECTRICAL SUPPLIES NEEDED FOR THE JEFFERSON PARISH EB SEWERAGE DEPARTMENT	①	
1	18.00	EA	0001 - Element heater, Cutler Hammer no. H2013B-3 (0833570)	23.4	421.20
2	18.00	EA	0002 - Heater element, Westinghouse No. FH-49 (0835490)	② 20.26	364.68
3	1.00	EA	0003 - Breaker, circuit, 30 amperes, 600 volt, 3 pole, with lugs, new in factory box, Square D no FA3603015M, Series 2 (0841010)	③ A-709 B-873 or 873.00	709.00 873.00
4	3.00	EA	0004 - Breaker, circuit, 20 amperes, 480 volt, 2 pole, Westinghouse No. EHD-2020 (0841570)	④ 64.00	192.00
5	6.00	EA	0005 - Breaker, circuit, 100 amperes, 600 VAC, 3 poles, with lugs, new in factory box, Westinghouse no. FB-3100 (0841800)	⑤ 2 options FB-3100-900 5,400 FD-3100-390 2,340 6	5,400.00 2,340.00
6	3.00	EA	0006 - Kit, contact, auxiliary, Allen Bradley no. 595-B (0850910)	34.00	102.00
7	10.00	EA	0007 - Fuse, fast acting, 5 amperes, 125/250 VAC, glass-tube, Fusetron no. AGC-5 (0855110)	.47	4.70
8	20.00	EA	0008 - Fuse, dual element, time delay, 60 amperes, 600 VAC, class RK5, Fusetron no. FRS-R-60 (0855580)	6.25	125.00
9	20.00	EA	0009 - Fuse, dual element, time delay, 100 amperes, 600 VAC, class RK5, Fusetron no. FRS-R-100	9.79	195.80

INVITATION TO BID FROM JEFFERSON PARISH - continued

BID NO.: 50-00118712

SEALED BID

ITEM NUMBER	QUANTITY	U/M	DESCRIPTION OF ARTICLES	UNIT PRICE QUOTED	TOTALS
10	24.00	EA	(0855630) 0010 - Charger, battery, Power Sonic part no. PSC12800A	¹⁰ 42.10	1010.40
11	16.00	EA	(0863250) 0011 - Connector, mechanical, uni-tap, AL9CU rated for no. 10 AWG - 250 KCMIL,	¹¹ 53.65	858.00
12	12.00	EA	Burndy no. B1BD250-4 (086991R) 0012 - Connector, mechanical, uni-tap, AL9CU rated for no. 4 AWG - 600 MCM,	¹² 84.00	1008.00
13	800.00	EA	Burndy no. B1BD600-4 (086995K) 0013 - Splice, butt, sta-kon, 16-14 wire range, insulated,	¹³ .44	220.00
14	200.00	EA	Thomas & Betts no. 2RB14X (0870260) 0014 - Connector, male, sta-con, 16-14 wire range, insulated,	¹⁴ .62	124.00
15	3.00	EA	T & B no. 14RB250T (0870390) 0015 - Switch, pressure, Allen Bradley no. 836-C4A	¹⁵ 129.00	381.00
16	50.00	EA	(0871060) 0016 - Plate, hand-off-auto, Square D no. 9001KN260	¹⁶ 1.72	86.00
17	2.00	EA	(0871320) 0017 - Switch, pressure, adjustable range 5-80 PSI,	¹⁷ 82.75	165.5
18	2.00	EA	Barksdale model no. D1H-A80 (0872630) 0018 - Switch, pressure, 20-40 range, Square D Brand no. 9013-GSG-2C	¹⁸ 49.25	98.50
19	12.00	EA	(0873250) 0019 - Seal, conduit knock out, 1-1/4 in, Weatherproof,	¹⁹ 16.50	198.00

INVITATION TO BID FROM JEFFERSON PARISH - continued

BID NO.: 50-00118712

SEALED BID

ITEM NUMBER	QUANTITY	U/M	DESCRIPTION OF ARTICLES	UNIT PRICE QUOTED	TOTALS
20	18.00	EA	Hoffman Brand no. AS125 (0874280) 0020 - Seal, conduit knock out, 1-1/2 in, Weatherproof,	20 19.00	342.00
21	12.00	EA	Hoffman no. AS150 (0874290) 0021 - Fitting, conduit, 1 inch, type T, FM7 Grayloy-iron body with	21 24.75	297.00
22	12.00	EA	wedge-lok clip cover and gasket, Appleton no. T37 (0876280) Killark T37	22 12.75	153.00
23	16.00	EA	0022 - Connector, sealtite, straight, 1-1/4 inch, Appleton no. ST-125 (087719E)	23 22.61	361.76
24	8.00	EA	0023 - Connector, sealtite, straight, 1-1/2 inch, Appleton no. ST-150 (087719F)	24 8.40	67.20
25	12.00	EA	0024 - Union, 1/2 inch, aluminum, explosion proof, Appleton no. UNF50NR-A (0878740) Killark UNF-1	25 11.28	138.96
26	100.00	EA	0025 - Elbow, sweep 90 degree, 3 in, schedule 40 pvc conduit (0879840) Canlex PVE11-903	26 6.85	685.00
27	500.00	LF	0026 - Lug, terminal, 2/0-14 range, AL/CU IlSCO catalog no. TA (0880470) PennUnion PNL-250	27 .15	75.00
28	400.00	LF	0027 - Wire, electrical, no. 16 solid THHN, black insulation, 500 ft spool, copper (0882680) Cerro THHN 16	28 10.47	4188.00
			0028 - Wire, electrical, 1/0 stranded 4-conductor sow-a/so, type W, 2000 volt, ul listed, black neoprene jacket, copper (0883020) Priority 30C1/0-4C		

PART NUMBER	SIZE	"R"	"O"	"H"	"S" MIN	"B" MIN	"L"
5133823	½"	4"	4"	4"	1 ½"	N/A	6 ¼"
5133824	¾"	4 ½"	4 ½"	4 ½"	1 ½"	N/A	7 ⅛"
5133825	1"	5 ¾"	5 ¾"	5 ¾"	1 ⅞"	N/A	9"
5133826	1 ¼"	7 ¼"	7 ¼"	7 ¼"	2"	N/A	11 ⅜"
5133827	1 ½"	8 ¼"	8 ¼"	8 ¼"	2"	N/A	13"
5133828	2"	9 ½"	9 ½"	9 ½"	2"	N/A	15"
5133829	2 ½"	10 ½"	10 ½"	10 ½"	3"	N/A	16 ½"
5133830	3"	13"	13"	13"	3 ⅛"	N/A	20 ⅜"
5133831	3 ½"	15"	15"	15"	3 ¼"	N/A	23 ½"
5133832	4"	16"	16"	16"	3 ⅜"	N/A	25 ⅛"
5133835	5"	24"	24"	24"	3 ⅝"	N/A	37 ⅝"
5133834	6"	30"	30"	30"	3 ¾"	N/A	47 ⅛"

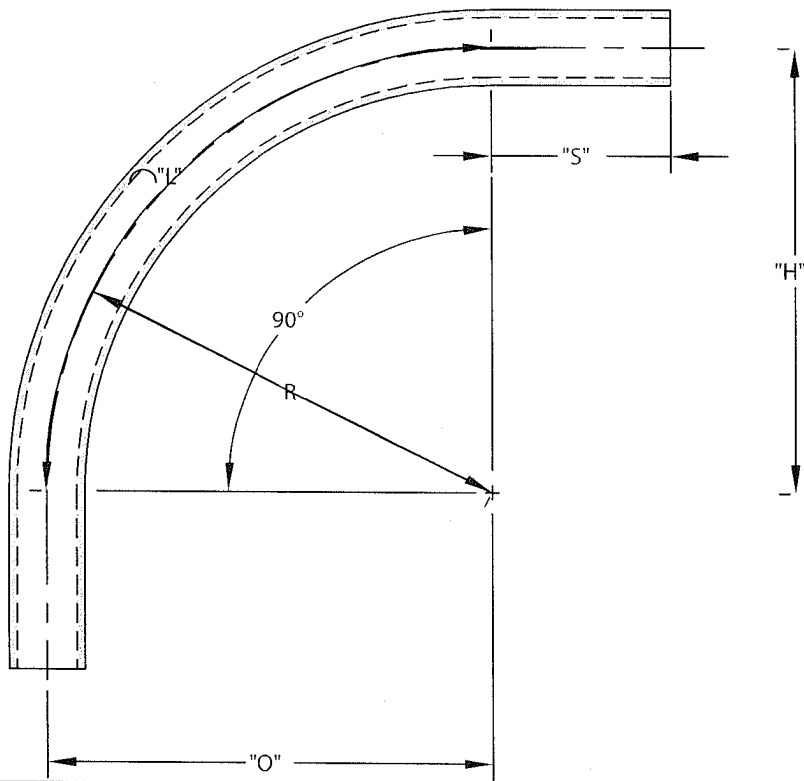

ETL LISTED
 CONFORMS TO UL651
 ETL CONTROL #3107144
 CONFORMS TO NEMA TC3
 SEE NEC ARTICLE 352 FOR USE
 MATERIAL IS RIGID PVC
 BEND TOLERANCE IS $\pm 2^\circ$



CANTEX
 INC.
 Fort Worth, TEXAS

90° Elbows Plain End
 Schedule 40 Standard Radius Elbc

Drawn By: CD Branch

Date: 10/15/07



UNIONS - ATEX/IEC Ex CERTIFIED

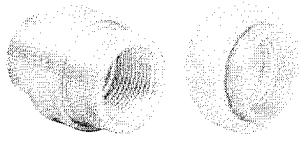

GUF-2

GUF-8



GUM-2



GUML-2



UNF2



UNY4

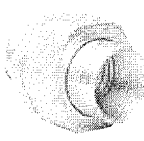

UNY2

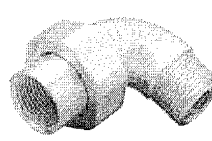

GUML-2M

Female to Female

Male to Female

90° Elbow Union

Global Listings

ATEX / IEC Ex Certified

File nos. IT509ATEX16417U

IECEx IT509.0024U

Ex d IIC

Ex d IIC



Listed File No. E 10514



Certified File No. LR11716

See previous page for UL and CSA suitabilities



FEATURES-SPECIFICATIONS

Applications

- GUF/GUM or UNF/UNY unions are used to connect two pieces of conduit or attach conduit to junction boxes, fittings, or devices
- Permits removal of equipment without turning or removal of conduit

Features

- Threaded for rigid conduit or IMC
- Tapered threads (NPT)
- Strong and durable construction

Material/Finish

Copper-brass Aluminum
(less than 4/10 of 1%)

- Natural Finish
- 1/2" - 2" screw machine
- 2-1/2" - 4" cast

Iron - 1-1/4" - 4"

Steel - 1/2", 3/4", 1"

- Zinc electro-plate

Third-Party Standards

UL Standards 886 and 1203

CSA Standard C22.2 No. 30

For NON-ATEX and IEC Ex certified Unions,
see previous page.

FEMALE TO FEMALE - QUAD LISTED							
CAT. NO.	HUB SIZE	DIMENSIONS		CAT. NO.	HUB SIZE	DIMENSIONS	
KILLARK ALUM.		A DIAMETER	B LENGTH	STEEL/IRON		A DIAMETER	B LENGTH
GUF-1-EX	1/2"	1-7/16"(37)	1-7/8"(48)	UNF1-EX	1/2"	1-1/2"(37)	1-55/64"(47)
GUF-2-EX	3/4"	1-5/8"(41)	1-15/16"(49)	UNF2-EX	3/4"	1-3/4"(45)	1-59/64"(49)
GUF-3-EX	1"	2"(51)	2-29/64"(62)	UNF3-EX	1"	2"(51)	2-7/16"(62)
GUF-4-EX	1-1/4"	2-3/8"(60)	2-1/2"(63)	UNF4-EX	1-1/4"	2-27/32"(72)	2-1/4"(57)
GUF-5-EX	1-1/2"	2-5/8"(67)	2-1/2"(63)	UNF5-EX	1-1/2"	3-3/32"(79)	2-7/16"(62)
GUF-6-EX	2"	3-1/4"(82)	2-5/8"(67)	UNF6-EX	2"	3-3/4"(95)	2-5/8"(67)
GUF-7-EX	2-1/2"	4-1/2"(114)	3"(76)	UNF7-EX	2-1/2"	4-1/2"(114)	3"(76)
GUF-8-EX	3"	5-3/8"(136)	3-1/16"(78)	UNF8-EX	3"	5-3/8"(136)	3-1/16"(78)
GUF-9-EX	3-1/2"	6-1/4"(159)	3-9/16"(90)	UNF9-EX	3-1/2"	6-1/4"(159)	3-9/16"(90)
GUF-0-EX	4"	6-1/4"(159)	3-9/16"(90)	UNF0-EX	4"	6-1/4"(159)	3-9/16"(90)
MALE TO FEMALE - QUAD LISTED							
GUM-1-EX	1/2"	1-7/16"(37)	2-1/2"(64)	UNY1-EX	1/2"	1-1/2"(37)	2-9/16"(65)
GUM-2-EX	3/4"	1-5/8"(41)	2-9/16"(65)	UNY2-EX	3/4"	1-3/4"(45)	2-5/8"(67)
GUM-3-EX	1"	2"(51)	3-3/64"(77)	UNY3-EX	1"	2-1/32"(52)	3-5/64"(78)
GUM-4-EX	1-1/4"	2-3/8"(60)	3-1/4"(83)	UNY4-EX	1-1/4"	2-15/16"(75)	3-1/4"(83)
GUM-5-EX	1-1/2"	2-5/8"(67)	3-1/4"(83)	UNY5-EX	1-1/2"	3-3/16"(81)	3-1/2"(89)
GUM-6-EX	2"	3-1/4"(82)	3-5/8"(92)	UNY6-EX	2"	3-3/4"(95)	4"(102)
GUM-7-EX	2-1/2"	4-1/2"(114)	4-15/16"(125)	UNY7-EX	2-1/2"	4-1/2"(114)	4-15/16"(125)
GUM-8-EX	3"	5-3/8"(136)	5-7/32"(133)	UNY8-EX	3"	5-3/8"(133)	5-7/32"(133)
GUM-9-EX	3-1/2"	6-1/4"(159)	5-13/16"(148)	UNY9-EX	3-1/2"	6-1/4"(159)	5-13/16"(148)
GUM-0-EX	4"	6-1/4"(159)	5-13/16"(148)	UNY0-EX	4"	6-1/4"(159)	5-13/16"(148)

90° ANGLE UNION - QUAD LISTED									
CAT. NO.	HUB SIZE	DIMENSIONS			CAT. NO.	HUB SIZE	DIMENSIONS		
KILLARK ALUM.		A DIA.	B LENGTH	C	STEEL/ IRON		A DIA.	B LENGTH	C
GUML-1-EX	1/2"	2-1/2" (64)	1-7/16" (37)	1-3/4" (44)	GUML-1M-EX	1/2"	2-1/4" (32)	1-1/2" (38)	1-5/8" (42)
GUML-2-EX	3/4"	2" (51)	1-5/8" (42)	1-5/8" (42)	GUML-2M-EX	3/4"	2-1/4" (32)	1-3/4" (44)	2" (51)

① UL & CSA suitable for Class I, Groups A, B, C, D.

Dimensions

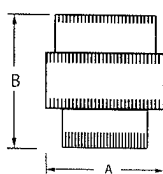

GUF

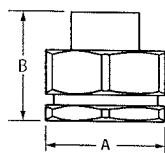

UNF

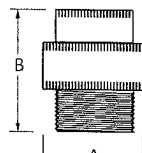

GUM

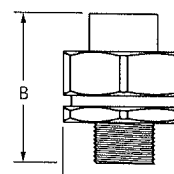

UNY

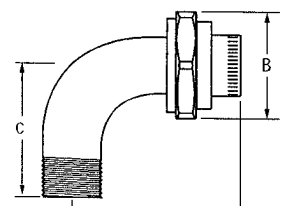

GUML

Circuit Sized THHN/THWN

Vynlon® PVC/Nylon

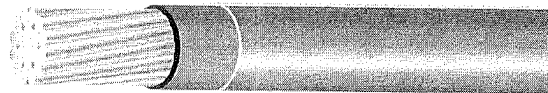

Solid wires:
90°C Dry or Wet

Stranded wires:
90°C Dry, 75°C Wet

600 volts

**Gasoline and oil
resistant**

APPLICATIONS

600-volt building wire for use in commercial and industrial applications as specified in the NEC®, including machine-tool and appliance wiring. Marked VW-I. Wires with solid conductors are rated THWN-2.

CONDUCTORS

Solid conductors: Uncoated copper per ASTM-B3.

Stranded conductors: Uncoated copper per ASTM-B3, ASTM-B787

INSULATION

Color-coded, heat-and moisture-resistant PVC (polyvinyl chloride)

JACKET

Nylon (polyamide), clear

INDUSTRY STANDARDS*

UL 83: File No. E15119

UL 1063 (MTW): File No. E85964

AWM: File No. E11829

Canada Standard C22.2 No. 75 and CSA Bulletin No. 1451

ASTM Standards: B3, B8, B787

WC70/ICEA S-95-658

Federal Specification A-A-59544

NFPA-70: National Electrical Code®

Cerro Wire LLC self certifies that these products, in stranded constructions, satisfy the product safety requirements identified by the European Low Voltage Directive 2006/95/EC.

SURFACE PRINT

Stranded: CERRO VINYLON-A 14 AWG (2.08mm²) (UL) THHN or THWN or MTW or AWM GR2 VW-I 600V - C(UL) TWN75 or T90 NYLON

Solid: CERRO VINYLON-A 14 AWG (2.08mm²) (UL) THHN or THWN-2 or AWM GR2 VW-I 600V - C(UL) TWN75 or T90 NYLON



MADE IN THE USA

©2012, Cerro Wire LLC
All Rights Reserved

*It is the sole responsibility of the end user to determine suitability of this product for its intended end use and application.

cerrowire

Electrical Distribution Division: 800.523.3869 | FAX 877.877.9563
www.cerrowire.com

A Marmon Group/
Berkshire Hathaway Company

Circuit Sized THHN/THWN

Vinylon® PVC/Nylon

Product Code	Conductors		Covering		Approx. O.D. Inches	Allowable Ampacities*			Approx. Net. Wt. Lbs./M Ft.
	AWG Size	No. of Strands	PVC Ins. Mils.	Nylon Jkt. Mils.		60°C **	75°C ***	90°C ****	
112-14xxx	14	Solid	15	4	0.104	15	15	15	15
112-16xxx	12	Solid	15	4	0.120	20	20	20	23
112-18xxx	10	Solid	20	4	0.151	30	30	30	37
112-34xxx	14	19	15	4	0.110	15	15	15	16
112-36xxx	12	19	15	4	0.130	20	20	20	24
112-38xxx	10	19	20	4	0.165	30	30	30	39

* Per Table 310.15 (B) (16) NEC®

** For termination to equipment for circuits rated 100 amperes or less or marked for size 14 through 1 AWG conductors. Also for MTW used in wet locations or exposed to oil or coolant.

*** For termination to equipment for circuits rated over 100 amperes or marked for conductors larger than 1 AWG and for THWN in wet locations.

Also for THWN-2 exposed to oil or coolant and MTW in dry locations.

**** For THHN used in dry locations and THWN-2 used in wet or dry locations. For ampacity derating purposes.

Colors available (Product Code 7th and 8th Digits)

AWG Size	Black 01	White 02	Red 03	Blue 04	Green 05	Orange 06	Yellow 07	Brown 08	Purple 09	Grey 10	Pink 11
14 Solid	X	X	X	X	X	X	X	X	X	X	X
12 Solid	X	X	X	X	X	X	X	X	X	X	X
10 Solid	X	X	X	X	X	X	X	X	X	X	X
14 Strand	X	X	X	X	X	X	X	X	X	X	X
12 Strand	X	X	X	X	X	X	X	X	X	X	X
10 Strand	X	X	X	X	X	X	X	X	X	X	X

Packages Available (Product Code 9th Digit)

Package Code	J	M
Size	500' (SPOOL)	2,500' (REEL)
14, 12 Solid & Strand	X	X
10 Solid & Strand	X	X

cerrowire

Electrical Distribution Division: 800.523.3869 | FAX 877.877.9563
www.cerrowire.com

REV-12/2013

A Marmon Group/
Berkshire Hathaway Company



CONNECTING YOUR TOMORROW.™

HOME : SALES LOCATIONS : PRODUCTS : CUSTOMER SERVICE : COMPANY : CONTACT US

Now In: [Penn-Union Products](#) → [Mechanical Lugs & Splices](#) → [Bronze Penn-Lugs](#) → [PNL - 1 Conductor](#) → PNL-250 - Bronze Penn-Lug

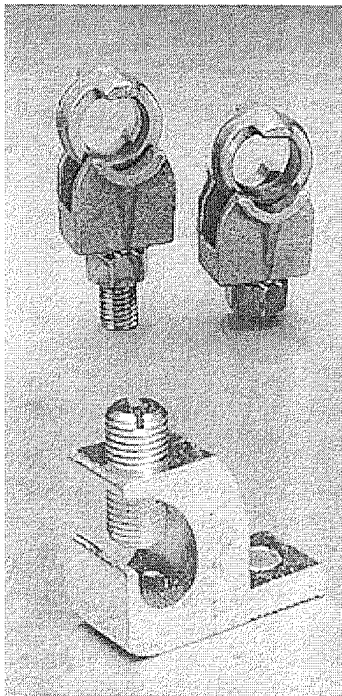

PRODUCT QUICK SEARCH:

[Part Number Search:](#)

[Manufacturer Search:](#)

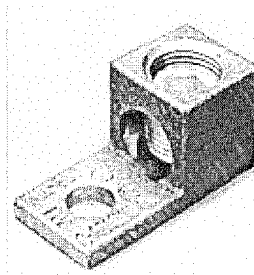

PNL-250 - Bronze Penn-Lug

1-Hole Tongue

For copper wire

The Economy Lug with Quality Improvements

Screw tightens directly on the conductor forcing the conductor into intimate contact with the body for maximum conductivity

Flat bottom allows mounting either on tongue only or with full contact surface

Inspection hole for proper cable insertion

Lug can be furnished electro-tinned or silver plated.

For tin plating add "-TN" to catalog number. For silver plating add "-SV" to catalog number

Product Drawing:

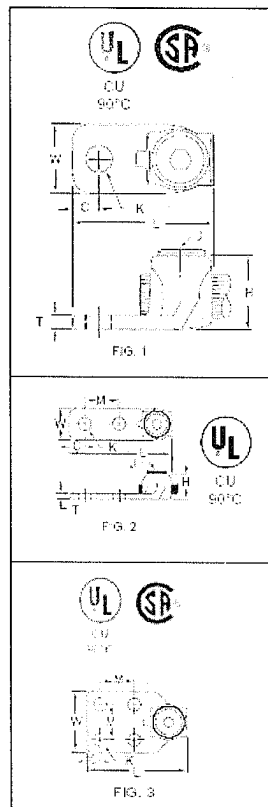

Click to expand.

Conductor Type	Conductor Range	Wire Diameter (in.)
Copper	6 Sol. - 250 MCM	.162 - .575

No. of Holes in Pad:	1
No. of Conductors:	1

Additional Details

Wrench Size:	5/16
UL Listing:	CU 90°C
CSA Listing:	Yes

Approximate Dimensions

Fig. No.:	1
C (in.):	7/16
H (in.):	1 3/64
J (in.):	5/8-18
K (in.):	25/64
L (in.):	1 31/32
T (in.):	1/8
W (in.):	15/16

© 2017 Penn-Union Corp. • 171 Chesapeake Avenue • Piquette, OH 44681
Region: 214-414-1235 • Fax: 214-414-1414 • info@pennunion.com

Designed & Developed by O-Web Technologies, Ltd.

9013GSG2J20

pump or compressor switch 9013GS - adjustable diff.
- 20-40 psi

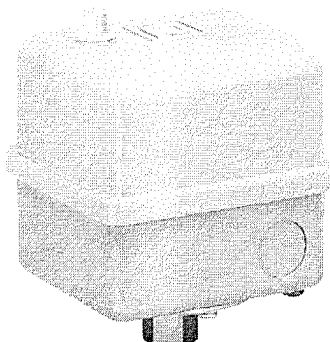

Main

Range of product	Square D Pumptrol
Pressure sensor name	9013GS
Pressure sensor size	80 psi (5...60 psi)
Value of setting	20...40 psi
Electrical circuit type	Power circuit
Product specific application	Control electrically driven water pumps and air compressors
Quantity per set	1
Type of packing	Individual

Complementary

Pressure sensor type	Electromechanical pressure switch
Controlled fluid	Air (-22...257 °F) Fresh water (-22...257 °F)
Adjustable range on rising pressure	20...80 psi
Approximate adjustable differential	15...30 psi
Destruction pressure	300 psi
Pressure actuator	Diaphragm
Pressure switch type of operation	Regulation between 2 thresholds
Scale type	Adjustable differential
Setting	Internal
Local display	Without
Contacts type and composition	2 NC, snap action, DPST-DB, Form YY
Cable entry number	3 knock-outs for 1/2" conduit UL 508
Electrical connection	Screw-clamp terminals, clamping capacity: 10 AWG Screw-clamp terminals, clamping capacity: 5.261 mm ²
Fluid connection type	0.25 inch NPSF internal conforming to UL 508
Short circuit protection	20 A by cartridge fuse, type gG
Materials in contact with fluid	Zinc plated steel or equivalent flange Nitrile (Buna-N) or equivalent rubber diaphragm
Material	Polypropylene cover Noryl thermoplastic resin or equivalent cover
Operating position	Any position
Motor power kW	1.5 kW (2 hp) at 115 V AC, 1 phase 2.2 kW (3 hp) at 115 V AC, 3 phases 2.2 kW (3 hp) at 230 V AC, 1 phase 0.75 kW (1 hp) at 115 V DC 0.75 kW (1 hp) at 230 V DC 3.75 kW (5 hp) at 230 V AC, 3 phases 3.7 kW (5 hp) at 460 V AC, 1 phase 3.7 kW (5 hp) at 460 V AC, 3 phases 3.7 kW (5 hp) at 575 V AC, 1 phase 3.7 kW (5 hp) at 575 V AC, 3 phases
Electrical durability	100000 cycles at 10 cyc/mn
Mechanical durability	300000 cycles
Terminal block type	4 terminals
Operating rate	10 cyc/mn
[Ui] rated insulation voltage	575 V conforming to UL 508
Product weight	2.25 lb(US)
Repeat accuracy	+/- 3 %

The information provided in this documentation contains general descriptions and/or technical characteristics of the performance of the products contained herein. This documentation is not intended as a substitute for and is not to be used for determining suitability or reliability of these products for specific user applications. It is the duty of any such user or integrator to perform the appropriate and complete risk analysis, evaluation and testing of the products with respect to the relevant specific application or use thereof. Neither Schneider Electric Industries SAS nor any of its affiliates or subsidiaries shall be responsible or liable for misuse of the information contained herein.

Terminals description ISO n°1	L1-T1 L2-T2
CAD overall width	3.44 in
CAD overall height	5.4 in
CAD overall depth	3.88 in
Factory modification	-

Environment

Standards	CE UL 508 NSF ANSI 372
Ambient air temperature for operation	-33...257 °F
Ambient air temperature for storage	-33...257 °F
Protective treatment	None
NEMA degree of protection	NEMA 1 conforming to UL 50
IP degree of protection	IP20 conforming to IEC 60529
Product certifications	UL listed file E12158 CSA file LR25490

Offer Sustainability

Sustainable offer status	Green Premium product
RoHS	Compliant - since 1150 - Schneider Electric declaration of conformity
REACH	Reference not containing SVHC above the threshold
Product environmental profile	Available
Product end of life instructions	Available