

DATE: 1/24/2020

INVITATION TO BID
THIS IS NOT AN ORDER

Page: 4

BID NO.: 50-00129425

JEFFERSON PARISH

PURCHASING DEPARTMENT
P.O. BOX 9
GRETN, LA. 70054-0009
504-364-2678

VENDOR: **Rocky Mountain Recreation LLC**

BUYER: DABRAHAM

As per LSA-RS 47:301 et seq., all governmental bodies are excluded from payment of sales taxes to any Louisiana taxing body. Quotations shall be based on F.O.B. Agency warehouse or jobsite, anywhere within the Parish as designated by the Purchasing Department.

JEFFERSON PARISH reserves the right to cancel all or any part of an order if not shipped promptly. No charges will be allowed for parking or cartage unless specified in quotation. The order must not be filled at a higher price than quoted. JEFFERSON PARISH reserves the right to cancel at any time and for any reason by issuing a THIRTY (30) day written notice to the contractor.

JEFFERSON PARISH is expecting all products to be new and all work to be done in workman-like manner, according to standard practices. Any deviations or alteration from the specifications must be indicated on the bid form for each item and upon request, product data for same must be submitted by the time specified by the Purchasing Department.

DELIVERY: FOB JEFFERSON PARISH

INDICATE DELIVERY DATE ON EQUIPMENT AND SUPPLIES

7 - 10 Days

INDICATE STARTING TIME (IN DAYS) FOR CONSTRUCTION WORK

N/A

INDICATE COMPLETION TIME (IN DAYS) FOR CONSTRUCTION WORK

N/A

In the event that addenda are issued with this bid, bidders MUST acknowledge all addenda on the bid form. Bidder must acknowledge receipt of an addendum on the bid form as indicated. Failure to acknowledge any addendum on the bid form will result in bid rejection.

Acknowledge Receipt of Addenda: NUMBER: **N/A**
NUMBER: **N/A**
NUMBER: **N/A**
NUMBER: **N/A**

LOUISIANA CONTRACTOR'S LICENSE NO.: (if applicable) **N/A**

***** ALL BIDDERS MUST COMPLETE SECTION BELOW *****

FIRM NAME:
Rocky Mountain Recreation LLC

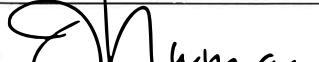
SIGNATURE:  TITLE: **President**
(Must be signed here)

PRINT OR TYPE NAME:
Janeil Norman

ADDRESS:
PO Box 68

CITY, STATE: **Albion ID** ZIP: **83311**

TELEPHONE: **(208) 670-5079** FAX: **() N/A**

EMAIL ADDRESS:
rockymountainrecreationllc@gmail.com

TOTAL PRICE OF ALL BID ITEMS: \$ **4,382.44**

INVITATION TO BID FROM JEFFERSON PARISH - continued

BID NO.: 50-00129425

SEALED BID

ITEM NUMBER	QUANTITY	U/M	DESCRIPTION OF ARTICLES	UNIT PRICE QUOTED	TOTALS
1	8.00	EA	A purchase of (8) 7 x 7 "L" pitchers screens for the Department of Recreation		
			0001 7x7 TUFF "L" SCREEN W/192 PLY NET PAD KIT AND WHEEL KIT WITH HEAVY DUTY NET COLORS: BLACK, BLUE OR GREEN	\$485.93	\$3,887.44
2	1.00	EA	0002 FREIGHT		
			Ship to: Jefferson Parish Recreation 6921 Saints Dr. Metairie, LA 70003	\$495.00	\$495.00
Bidding Jugs Sports S6000 Protector 7' L Shaped Screen W/Padding & Wheels (See Attached)					



PROTECTOR™ SERIES

L-SHAPED SCREEN ASSEMBLY INSTRUCTIONS

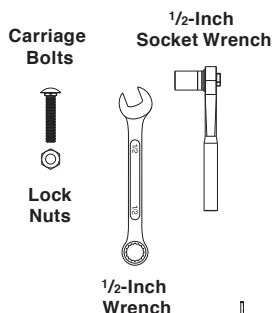

INVENTORY

- (30) Carriage Bolts
- (30) Lock Nuts
- (1) 1/2-Inch Wrench
- (1) 1/2-Inch Socket Wrench
- (4) Legs
- (10) Frame Parts
- (15) Padded Sections
- (1) L-Shaped Netting

FRAME ASSEMBLY

Start by attaching 4 legs (B) to frame parts A and E using carriage bolts and lock nuts. (Lock Nuts should be on underside of legs).
Note: all remaining carriage bolts should enter frame tubing from the outside, with lock nut on the inside.

Next, connect leg assembly A together with parts D and C. Also connect leg assembly E with parts G, H and F. Finger tight nuts and bolts.

Join both sides together. Finger tight nuts and bolts.

Finally, join parts I, J and K together and attach to already assembled base. Finger tight nuts and bolts.

SECURELY tighten all Bolts using socket wrench.

Note: inside nut on part G must be tightened with 1/2-inch wrench.



PADDING

Using PADDING illustration, attach all padded sections to locations shown. Note: pad seams should all be on inside edge of frame.

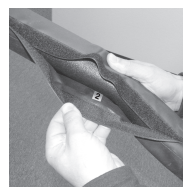

Padding reference numbers are located on the inside of the padding vinyl cover.

NETTING

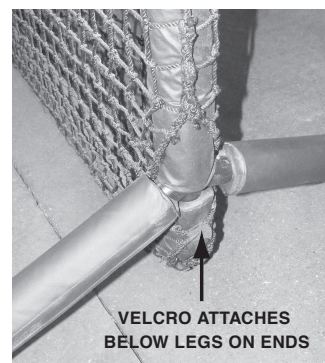

Stretch netting out, on the ground, in the same shape as the frame. Stand at the center of the frame and begin feeding the net onto the frame, like a pillowcase, alternating sides as you go. After the netting has been slipped over the frame, secure the netting around the bottom frame using the attached velcro strips.

Note: the side velcro strips attach below the legs (see photo above).

Note: new netting must be pulled and stretched to fit frame correctly—this is easier with two people.

JUGS Sports guarantees JUGS Protector™ Series netting and frame for (2) years unless damaged by snow, ice or other acts of God.

If you have any questions regarding this screen, contact JUGS Sports. USA and Canada, call toll free: 1-800-547-6843. International orders, call collect: 0-503-692-1635. Our fax number is 503-691-1100. Or, visit our website at jugssports.com



Transport Wheel Kit Installation Instructions



Note: This kit is for use with JUGS Protector Series Screens **ONLY**.

1. Assemble wheels to wheel bracket (figure 1.)

- Slide axel through wheel bracket.
- Slip wheels onto axel and insert retaining pins through the two holes at each end of the axel to secure wheels.

2. Join main screen bracket to wheel bracket assembly (figure 1.)

- Place washers between the top of the wheel bracket and the two lower arms of the main screen bracket.
- Place a washer on the $\frac{1}{2}$ " bolt and thread through both brackets to assemble the wheel bracket to the main screen bracket.
- Place washer and lock nut on opposite side of $\frac{1}{2}$ " bolt and tighten securely but just enough to allow rotation of the wheel bracket.

Figure 1.

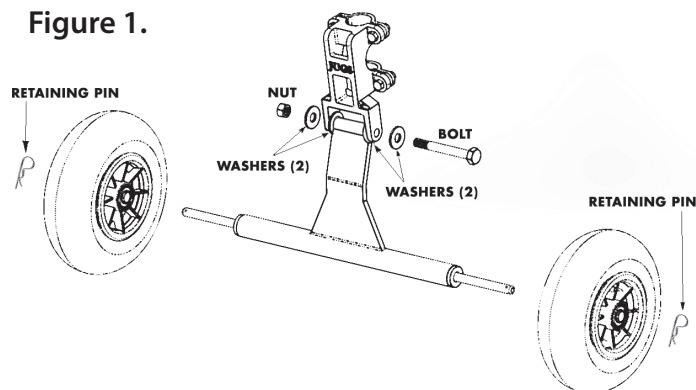

3. Join main screen bracket to screen (figure 2.)

- Unfasten net at the bottom of the screen and undo vertical padding directly above the legs.

- Attach main bracket onto bare frame so that bolts will be located above and below the legs.
- Install top and bottom u-clamps on the inside of the screen as shown.
- Slip bolts through washer, then main screen bracket and through u-clamps.
- Thread lock nuts and washers onto bolts and tighten all bolts evenly for best results.

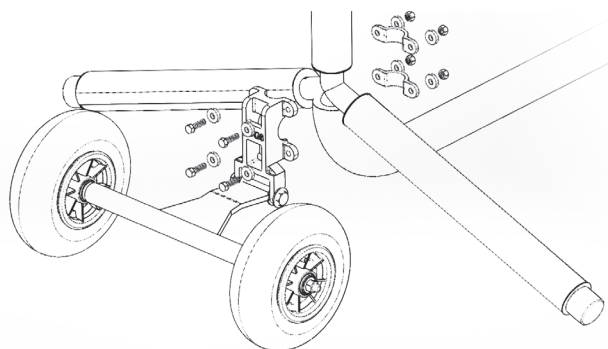
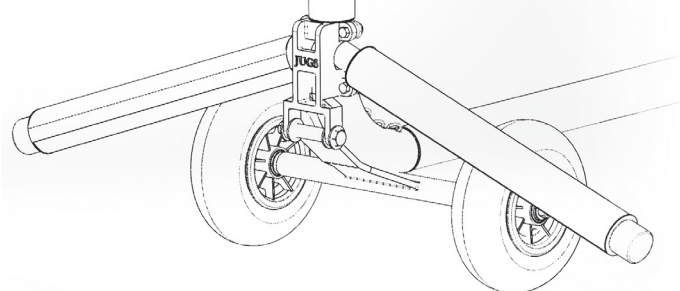

Figure 2.



4. Engage/Disengage transport wheel kit (figure 3.)

- To engage wheel kit, simply lift screen directly above the wheel kit and kick the wheels under the screen.
- For ease of transportation, lift screen from other side to move.

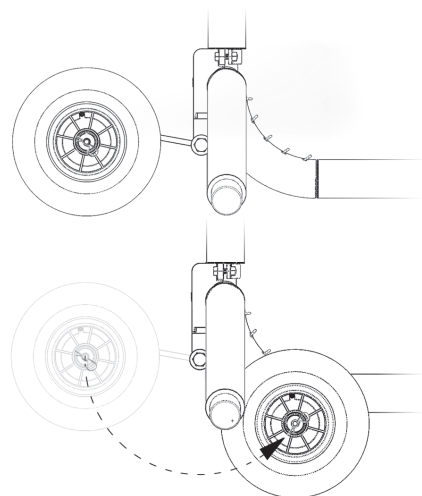

Figure 3.

**For more information please call: 1-800-547-6843
or visit us online at jugssports.com**

- **NEW:** JUGS Protector Series L-Shaped Screen now comes standard with the Protector Series Wheel Kit. Moving your screen has never been easier.
- 7'H x 7'W with a 3' x 3' cutout
- Black, pearl-foam, vinyl-covered .5-inch-thick padding.
- Black, double-thick 691-90 ply, poly-E netting.
- Screens are easily assembled—no welding or lacing.
- All joints are double-bolted for maximum strength and superior longevity.
- 1.5-inch-diameter, 2mm-thick, 1020 cold-rolled steel frame tubing.
- 2-Year Guarantee on netting and frame: No one guarantees their screens longer.
- Hitting-Facility Tough design.

