



PE324T-25-6-AI

GENERAL PURPOSE ELECTRIC MOTOR

NEMA PREMIUM EFFICIENCY

TOTALLY ENCLOSED FAN COOLED

INVERTER DUTY 10:1 CT; 20:1 VT - NEMA MG1 PART 31

Factory Certified for T2B Class I, Division II, Groups A,B,C & D and Class II, Division II, Groups F & G

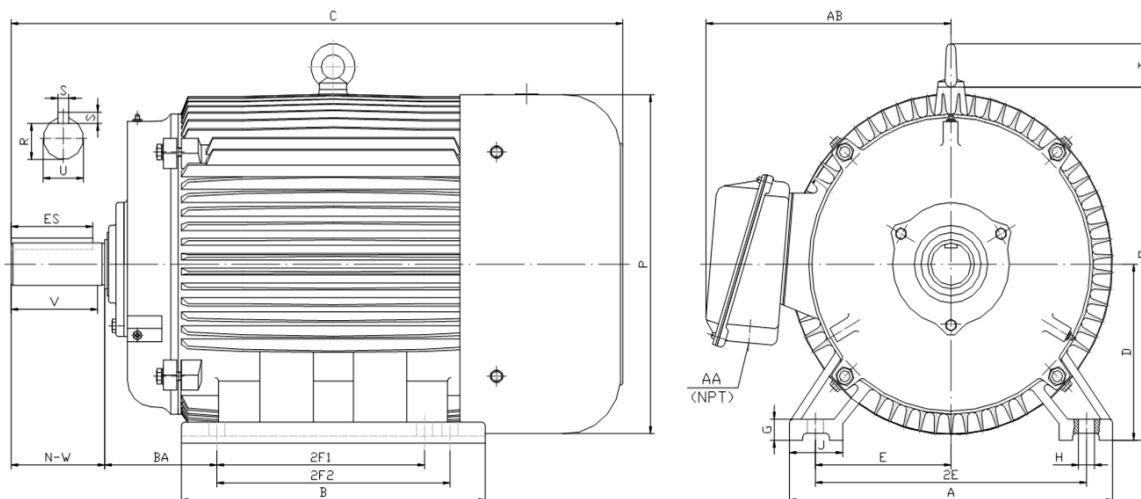

DIMENSIONS

HP	RPM	Frame	MOUNTING														
			A	B	C	D	G	H	J	E	2E	2F1	2F2	O	P	T	BA
25	1200	324T	16.00	14.60	31.80	8.00	1.10	0.66	2.75	6.25	12.50	10.50	12.00	17.06	17.50	2.44	5.25

Shaft Extension, Key Set						Conduit Box		Bearings		Mount
U	V	R	S	ES	N-W	AA	AB	DE	ODE	
2.125	5.00	1.845	0.50	3.91	5.25	1.50	14.80	6312	6312	0.00

BEARING LUBRICATION: The bearings come lubricated with Mobile Polyrex EM Polyurea Grease. It is recommended that you add some additional lubrication when the motor is installed.

Three options (brands) for suitable lubrication include, but are not limited to, the following:

- 1.) Mobile Polyrex EM
- 2.) Citco Polyurea MP
- 3.) Conoco Phillips Polytac EP





PE324T-25-6-AI

GENERAL PURPOSE ELECTRIC MOTOR

NEMA PREMIUM EFFICIENCY

TOTALLY ENCLOSED FAN COOLED

INVERTER DUTY 10:1 CT; 20:1 VT - NEMA MG1 PART 31







Factory Certified for T2B Class I, Division II, Groups A,B,C & D and Class II, Division II, Groups F & G

PERFORMANCE DATA

HP	RPM	Frame	Voltage	Frequency (Hz)	Full Load S.F.	Insulation Class	NEMA Design	Slip (%)	NEMA Code	Enclosure Type	IP Rating	Max. Ambient
25	1175	324T	208-230/460	60	1.15	F	B	2.1	G	TEFC	55	40° C

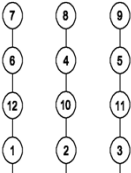
Amps (460V)			Efficiency (%)				Power Factor			Torque (ft-lb)			DE Bearing	ODE Bearing	Connection	Weight (lbs.)
FLA	LRA		100%	75%	50%	Min.	100%	75%	50%	FLT	LRT %	BDT %				
29.5	0		93.0	93.0	92.4	91.7	0.860	0.840	0.750	111.0	200	250	6312	6312	12 Lead 2Δ/Δ	585

NAME PLATE

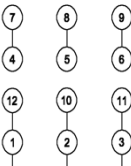
<div><div></div><div>North American Electric, Inc.</div></div> <div><div></div></div>										CONNECTION DIAGRAMS			
INVERTER DUTY 20:1 VT; 10:1 CT													
CAT NO: PE324T-25-6-AI				FRAME 324T			PHASE 3			<div>208 - 230V</div> 			
HZ 60		S.F. 1.15		HZ 50		S.F. 1.0		ENCL TEFC				IP 55	
HP 25		RPM 1175		HP 25		RPM 980		DUTY CONT				DES B	
VOLTS 208-230/460				VOLTS 190/380			AMB 40° C		INS F				
FLA 65.2 - 59 / 29.5				FLA 71/35.5			DE BEARING 6312						
CODE G		P.F. 0.86		CODE E		P.F. 0.86		ODE BEARING 6312					
EFF 93.0		MIN 91.7		EFF 92.4		MIN 89.5		LUB: Mobile Polyrex EM					
MOTOR WEIGHT 585 LBS				CONNECTION 12 Lead 2Δ/Δ			SER NO						
<div>General purpose use on industrial machinery installed in damp, dusty or dirty environments.</div> <div><div></div><div></div><div></div><div>CC113B</div></div> <div>Hernando, Mississippi</div>										<div>460V</div> 			

APPLICATIONS:

General purpose use on pumps, fans, blowers, compressors, conveyors, material handling and other industrial machinery installed in damp, dusty or dirty environments.