

DATE: 3/14/2019
BID NO.: 50-00125770

INVITATION TO BID
THIS IS NOT AN ORDER

Page: 4

JEFFERSON PARISH
PURCHASING DEPARTMENT
P.O. BOX 9
GRETN, LA. 70054-0009
504-364-2678

VENDOR: ACE Garage Door

BUYER: DABRAHAM

As per LSA-RS 47:301 et seq., all governmental bodies are excluded from payment of sales taxes to any Louisiana taxing body. Quotations shall be based on F.O.B. Agency warehouse or jobsite, anywhere within the Parish as designated by the Purchasing Department.

JEFFERSON PARISH reserves the right to cancel all or any part of an order if not shipped promptly. No charges will be allowed for parking or cartage unless specified in quotation. The order must not be filled at a higher price than quoted. JEFFERSON PARISH reserves the right to cancel at any time and for any reason by issuing a THIRTY (30) day written notice to the contractor.

JEFFERSON PARISH is expecting all products to be new and all work to be done in workman-like manner, according to standard practices. Any deviations or alteration from the specifications must be indicated on the bid form for each item and upon request, product data for same must be submitted by the time specified by the Purchasing Department.

DELIVERY: FOB JEFFERSON PARISH

INDICATE DELIVERY DATE ON EQUIPMENT AND SUPPLIES

3-5 weeks

INDICATE STARTING TIME (IN DAYS) FOR CONSTRUCTION WORK

2 days

INDICATE COMPLETION TIME (IN DAYS) FOR CONSTRUCTION WORK

1 day

In the event that addenda are issued with this bid, bidders MUST acknowledge all addenda on the bid form. Bidder must acknowledge receipt of an addendum on the bid form as indicated. Failure to acknowledge any addendum on the bid form will result in bid rejection.

Acknowledge Receipt of Addenda: NUMBER: 50-00125770 yes I Acknowledge
NUMBER: _____
NUMBER: _____
NUMBER: _____

LOUISIANA CONTRACTOR'S LICENSE NO.: (if applicable) N/A

***** ALL BIDDERS MUST COMPLETE SECTION BELOW *****

FIRM NAME:

ACE Garage Door

SIGNATURE:

(Must be signed here)

Donal M. Miller

TITLE:

owner

PRINT OR TYPE NAME:

Donal M. Miller

ADDRESS:

257 W Oakland

CITY, STATE:

ST Rose LA

ZIP:

70087

TELEPHONE:

() 504-231-2132

FAX:

504 466-9622

EMAIL ADDRESS:

TOTAL PRICE OF ALL BID ITEMS: \$ 4213.00

DATE: 3/15/2019

INVITATION TO BID FROM JEFFERSON PARISH - continued

Page: 5

BID NO.: 50-00125770

SEALED BID

ITEM NUMBER	QUANTITY	U/M	DESCRIPTION OF ARTICLES	UNIT PRICE QUOTED	TOTALS
1	1.00	JOB	<p>Remove, install and replace roll-up door at Bridge City Playground Gym</p> <p>0010 Remove, haul away and replace 10 x 10 roll up door and include a 1/2 HP, 120V SGL motor</p> <p>Bridge City Playground Gym 219 Marrero Ave. Bridge City, LA 70094</p> <p>See specs for details **</p> <p>For site visits contact:</p> <p>Steve Williams at 504-349-5000 ext.7224 SCWilliams@jeffparish.net or Chad Tomassie at 504-349-50006 CThomassie@jeffparish.net</p>	4213. ⁰⁰	4213. ⁰⁰

Revised Page 5 - Please replace the original with this revised page when submitting your bid ***

NOTE: Wall construction detail shown is for illustrative purposes only, does not imply compliance with building requirements, and must meet architectural specifications to properly support product. Products designed with wind load requirements must be properly fastened to structural members as specified in order to avoid catastrophic failure. Wall construction and closure installation shall be in accordance with the local authority having jurisdiction requirements.

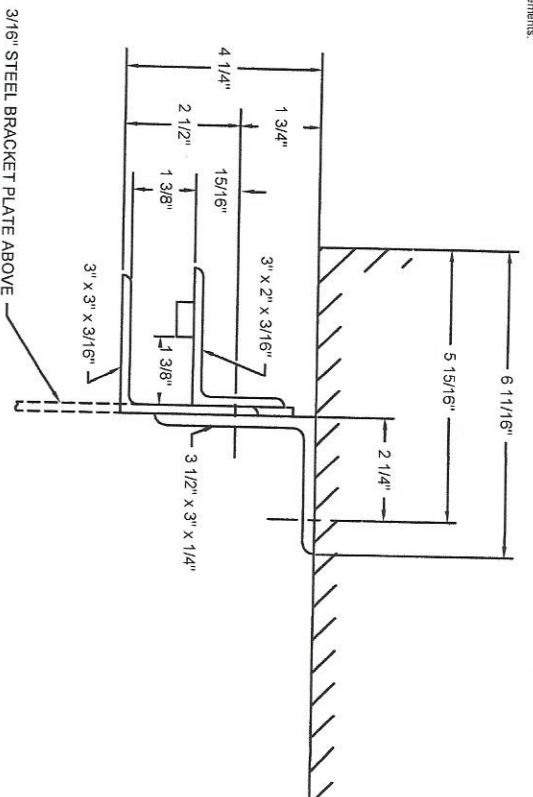
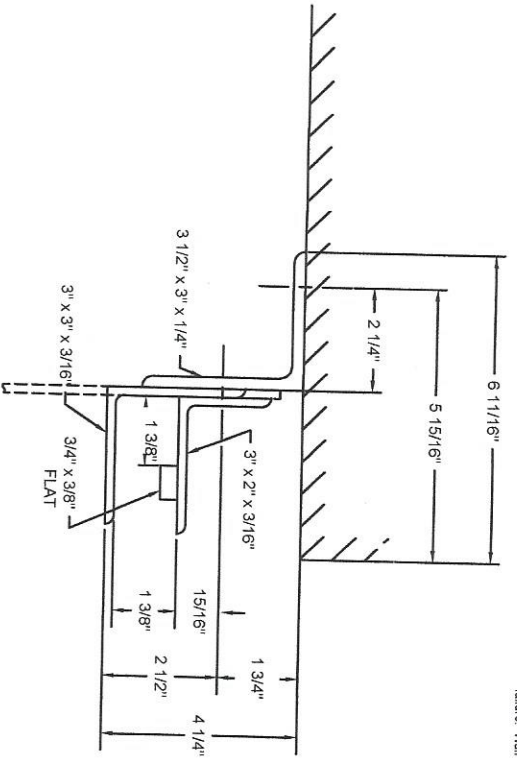

GA0658 - 4 1/4"

WALL FASTENERS:

- AT 8" ON CENTER
- Ø3/4" x 5-1/2" HILTI KWIK BOLT 3,
- MIN. 1500 PSI GROUT FILLED CMU REQD
- MIN. EMBEDMENT DEPTH - 4-3/8"
- MIN. DISTANCE FROM VERTICAL JOINT - 1 3/8"

ASSEMBLY FASTENERS:

- AT 12" ON CENTER
- Ø3/8-16 x 1 1/2" HEX HEAD CAP SCREW, GR. 8
- HEX HEAD NUT, GR. 8
- HARDENED FLAT WASHERS

GA0658 - 4 1/4"

WALL FASTENERS:

- AT 8" ON CENTER
- Ø3/4" x 5-1/2" HILTI KWIK BOLT 3,
- MIN. 1500 PSI GROUT FILLED CMU REQD
- MIN. EMBEDMENT DEPTH - 4-3/8"
- MIN. DISTANCE FROM VERTICAL JOINT - 1 3/8"

ASSEMBLY FASTENERS:

- AT 12" ON CENTER
- Ø3/8-16 x 1 1/2" HEX HEAD CAP SCREW, GR. 8
- HEX HEAD NUT, GR. 8
- HARDENED FLAT WASHERS

BOTTOM BAR / SLAT DETAIL

CP0020 SLAT

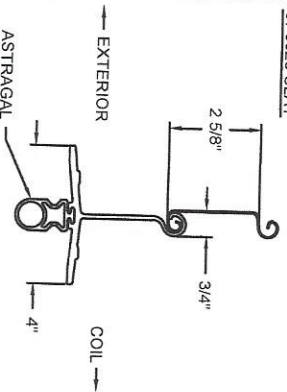

PLAN OF OPENING

MK: 001

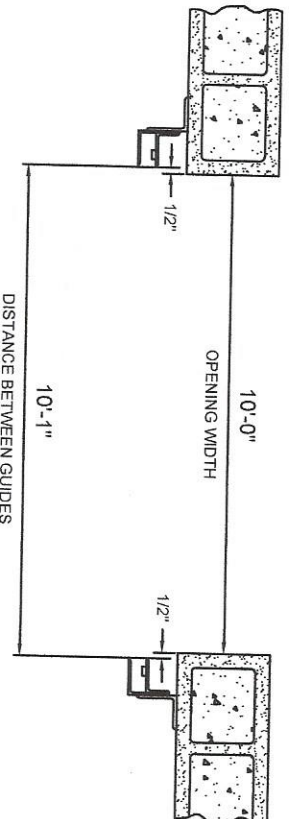

INSTALLERS NOTE:

MAINTAINING FACTORY SET GUIDE GAPS IS CRITICAL TO THE PROPER OPERATION OF THE DOOR AND ITS ABILITY TO WITHSTAND THE DESIGNED WINDLOAD!

ENDLOCK DETAIL

CP1151 CAST IRON ENDLOCK / WINDLOCK ON ALTERNATING SLATS WITH 2 x 1/4" RIVETS



09-18-2018 PRODUCT CODE: MFI 5F 22GP

GSD10_425

03/14/19 KA20

DATE BY

#

REVISION

COOKSON

Preferred door solutions.

JOB

SERVICE DOOR GUIDE ASSEMBLY

4-1/4" PACKOFF

JEFFERSON PARISH BRIDGE CITY

MODEL #:

ESD10

JOB #:

E 01317564 001 B

*

AGENT:

A.C.E. GARAGE DOOR CO LLC

CONTRACTOR:

ARCHITECT:

MOTOR SPECIFICATIONS:

1 - Pair of photo eyes, NEMA 1.
1 - Three button push button station, 'OPEN-CLOSE-STOP' in NEMA 1 enclosure, surface mounted.
using color coding of the wires to facilitate troubleshooting.

ELECTRICAL EQUIPMENT LIST:

CURRENT CHARACTERISTICS:
120 V 1 PH 60 HZ
Electrical current must be verified in writing before job is released for manufacture: current verified and found correct. Operator bracket bracing required, unless operator is wall mounted.
Signed: _____

BOTTOM BAR LOCKING:

QUANTITY & MARK:

(1) 001

MATERIAL & FINISH:

Curtain - Galvanized steel with Galvalux™ coating system.
Finish color: Gray
Bottom Bar - Aluminum, mill finish
Guides - Structural steel, Gray polyester powder coating
Hood - Galvanized steel with Galvalux™ coating system.
Finish color: Gray
Plain Steel - Powder coated Gray

Door to withstand designed windload of ± 30 P.S.F.

"SUPPORT TO RUN TO TOP OF COIL"

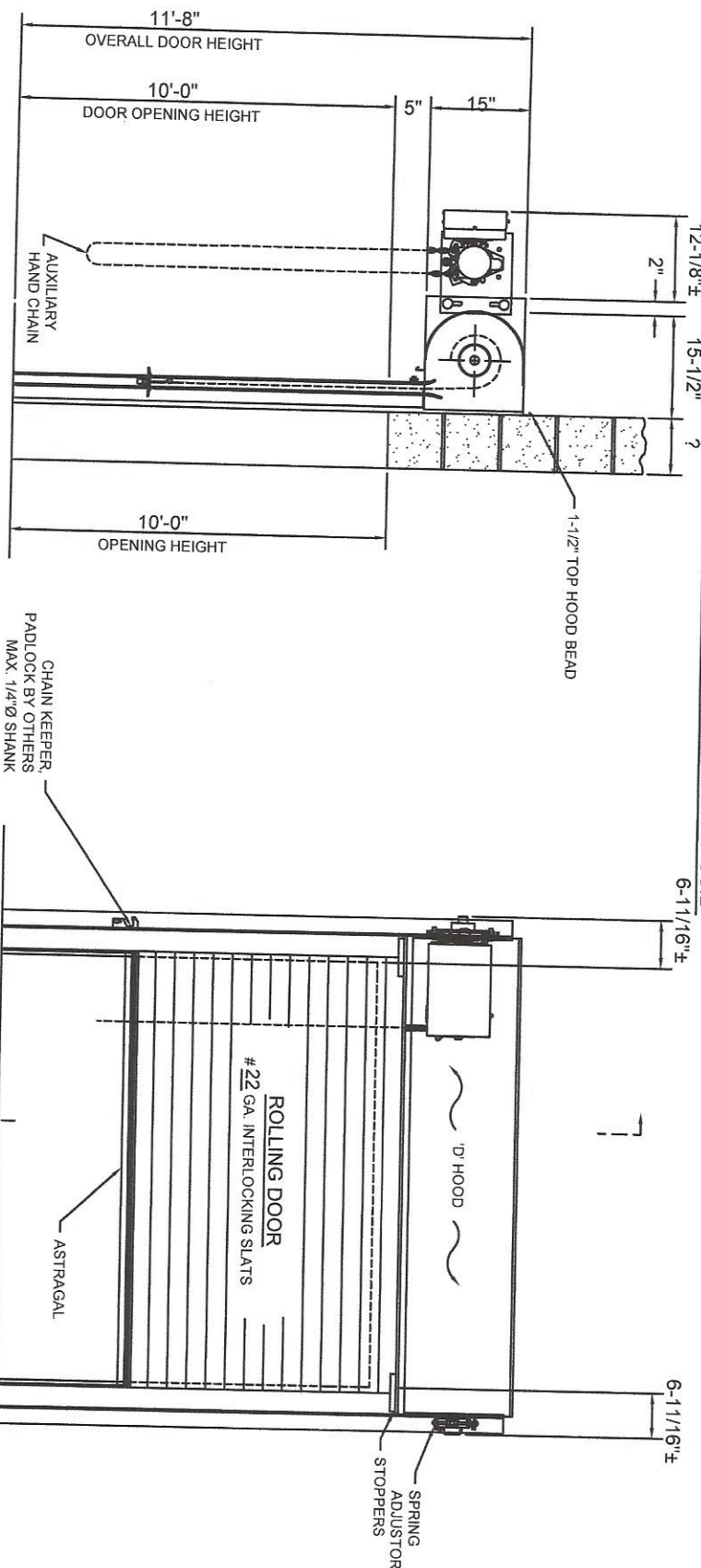

01-21-2019 PRODUCT CODE: MFI 5F 22GP

ELEVATION (COIL SIDE) AND SECTION VIEW
See drawing # E 01317564 001 B for guide detail.

MODEL #: ESD10 JOB #: E 01317564 001 A

#	REVISION	DATE	BY
1	ORIGINAL DRAWING	03/14/19	K A 20

COOKSON Preferred door solutions.

MGH MOTOR OPERATED ROLLING DOOR
JEFFERSON PARISH BRIDGE CITY

AGENT: A.C.E. GARAGE DOOR CO LLC
CONTRACTOR:
ARCHITECT:

**PARISH OF ST. CHARLES
STATE OF LOUISIANA**

St. Charles Parish,

69602

**A.C.E. GARAGE DOOR LLC
DONALD G MICHLER
257 W. OAKLAND ST.
SAINT ROSE, LA 70087**

2019

Is hereby licensed to conduct the business of, **REPAIR & INSTALLATION SERVICE**
at, 257 W. OAKLAND ST.,
SAINT ROSE, LA 70087, Louisiana, during the year ending December 31, 2019

**HAHNVILLE, LOUSIANA
PARISH OF ST. CHARLES**

Date Issued: 1/8/2019

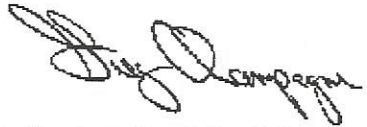
Tax Collector, Parish of St. Charles

RECEIPT

DATE

1/8/2019

NO

69602

ACCOUNT NO: 6095

BUSINESS NAME: A.C.E. GARAGE DOOR LLC

AMOUNT PAID: \$900.00 2019 OCCUPATIONAL LICENSE

BY: