

DATE: 1/10/2018

BID NO.: 50-00121923

INVITATION TO BID  
THIS IS NOT AN ORDER

Page: 4

**JEFFERSON PARISH**

PURCHASING DEPARTMENT  
P.O. BOX 9  
GRETN, LA. 70054-0009  
504-364-2678

VENDOR:

BUYER: SFOLSE

As per LSA-RS 47:301 et seq., all governmental bodies are excluded from payment of sales taxes to any Louisiana taxing body. Quotations shall be based on F.O.B. Agency warehouse or jobsite, anywhere within the Parish as designated by the Purchasing Department.

JEFFERSON PARISH reserves the right to cancel all or any part of an order if not shipped promptly. No charges will be allowed for parking or cartage unless specified in quotation. The order must not be filled at a higher price than quoted. JEFFERSON PARISH reserves the right to cancel at any time and for any reason by issuing a THIRTY (30) day written notice to the contractor.

JEFFERSON PARISH is expecting all products to be new and all work to be done in workman-like manner, according to standard practices. Any deviations or alteration from the specifications must be indicated on the bid form for each item and upon request, product data for same must be submitted by the time specified by the Purchasing Department.

**DELIVERY: FOB JEFFERSON PARISH**

INDICATE DELIVERY DATE ON EQUIPMENT AND SUPPLIES \_\_\_\_\_

INDICATE STARTING TIME (IN DAYS) FOR CONSTRUCTION WORK \_\_\_\_\_

INDICATE COMPLETION TIME (IN DAYS) FOR CONSTRUCTION WORK \_\_\_\_\_

In the event that addenda are issued with this bid, bidders MUST acknowledge all addenda on the bid form. Bidder must acknowledge receipt of an addendum on the bid form as indicated. Failure to acknowledge any addendum on the bid form will result in bid rejection.

Acknowledge Receipt of Addenda: NUMBER: \_\_\_\_\_  
NUMBER: \_\_\_\_\_  
NUMBER: \_\_\_\_\_  
NUMBER: \_\_\_\_\_

**Gas And Supply**

**Jimmy Gibbs**

**Phone 504-392-2400**

**Fax 504-392-1500**

**jimmy.gibbs@gasandsupply.com**

LOUISIANA CONTRACTOR'S LICENSE NO.: (if applicable) \_\_\_\_\_

**\*\*\* ALL BIDDERS MUST COMPLETE SECTION BELOW \*\*\***

FIRM NAME:	
I.W.S. GAS AND SUPPLY	
SIGNATURE:	TITLE:
(Must be signed here)	SALES
PRINT OR TYPE NAME:	
Jimmy Gibbs	
ADDRESS:	
111 BURAS DR.	
CITY STATE:	ZIP:
BELLE CHASSE, LA.	70037
TELEPHONE:	FAX:
504 392-2400	504 392-1500
EMAIL ADDRESS:	
Jimmy.Gibbs@GasAndSupply.com	

TOTAL PRICE OF ALL BID ITEMS: \$ 1780.22

## INVITATION TO BID FROM JEFFERSON PARISH - continued

BID NO.: 50-00121923

SEALED BID

ITEM NUMBER	QUANTITY	U/M	DESCRIPTION OF ARTICLES	UNIT PRICE QUOTED	TOTALS
			SUPPLIES FOR THE JEFFERSON PARISH WB PUBLIC WORKS ADMINISTRATION DEPARTMENT		
1	3.00	EA	0010 - PUNCH, DRIFT, 1/4 IN X 11 IN LONG, ARMSTRONG #70-197-1/4 <i>PROTO 596 1/2 S2</i> SK# 00-0305980	<i>8.64</i>	<i>25.92</i>
2	300.00	EA	0020 - CLIP, WIRE ROPE, 3/8" HOT DIPPED GALVANIZED, DROP FORGED, MEETS SPEC. FF- <i>CAMPBELL 6990634</i> C-450, TYPE 1, CLASS 1, CROSBY #G-450 WEISNER#WC38DF, MSC #07846249 SK# 00-0271340	<i>2.79</i>	<i>837.00</i>
3	50.00	EA	0030 - WHEEL, ABRASIVE, 14 IN X 1/8 IN X 1 IN ARBOR, REINFORCED FOR DUCTILE IRON, <i>NORTON 66252837843</i> HANDHELD ONLY, NOT FOR USE ON WALK BEHIND, NORTON #06611 SK# 00-0488530	<i>4.93</i>	<i>246.50</i>
4	120.00	EA	0040 - PADLOCK, COMMERCIAL, NUMBER 3KA, (KEYED ALIKE) TO #A300, MASTER BRAND NO SUBSTITUTION (SEWERAGE DEPT) SK# 00-058008W	<i>5.59</i>	<i>670.80</i>

Gas And Supply  
Jimmy Gibbs  
Phone 504-392-2400  
Fax 504-392-1500  
jimmy.gibbs@gasandsupply.com



## 7 PIECE DRIFT PUNCH SET

Product #: J96AS2

Contents	Description	Tip Width (in) (A)	Shank Width (in) (B)	Overall Length (in) (L)
J961/4S2	Punch, Drift 3/32"	3/32	1/4	10
J965/16S2	Punch, Drift 1/8"	1/8	5/16	10
J963/8S2	Punch, Drift 3/16"	3/16	3/8	10
J967/16S2	Punch, Drift 7/32"	7/32	7/16	10
J961/2S2	Punch, Drift 1/4"	1/4	1/2	10
J965/8S2	Punch, Drift 5/16"	5/16	5/8	10
J963/4S2	Punch, Drift 3/8"	3/8	3/4	10
J25TR29C	Tool Roll, 7 Pockets			

Weight (lbs): 3.46



## 5 PIECE DRIFT PUNCH SET

Product #: J96BS2

Contents	Description	Tip Width (in) (A)	Shank Width (in) (B)	Overall Length (in) (L)
J965/16S2	Punch, Drift 1/8"	1/8	5/16	10
J963/8S2	Punch, Drift 3/16"	3/16	3/8	10
J961/2S2	Punch, Drift 1/4"	1/4	1/2	10
J965/8S2	Punch, Drift 5/16"	5/16	5/8	10
J967/16S2	Punch, Drift 7/32"	7/32	7/16	10
J25TR30C	Tool Roll, 5 Pockets			

Weight (lbs): 2.30

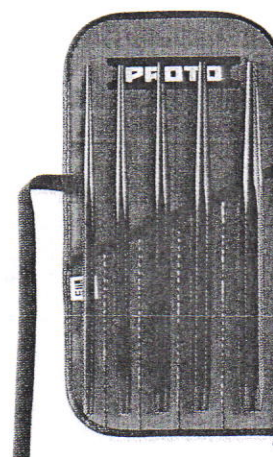

## DRIFT PUNCHES

- Application: to align holes in two or more pieces of metal through which a bolt or screw is to be inserted.
- Application: for installing and removing pins and shafts.
- One-piece design for strength and durability.
- Reverse taper to help prevent binding.

Product #	Tip Width (in) (A)	Shank Width (in) (B)	Overall Length (in) (L)	Weight (lbs)
J961/4S2	3/32	1/4	10	0.12
J965/16S2	1/8	5/16	10	0.19
J963/8S2	3/16	3/8	10	0.28
J967/16S2	7/32	7/16	10	0.37
J961/2S2	1/4	1/2	10	0.49
J965/8S2	5/16	5/8	10	0.70
J963/4S2	3/8	3/4	10	1.02

ASME B107.48



Gas And Supply  
Jimmy Gibbs  
Phone 504-392-2400  
Fax 504-392-1500

jimmy.gibbs@gasandsupply.com



# Campbell® Forged Wire Rope Clips, 1000-G

- Base is Drop-Forged Carbon Steel
- Hot Galvanized to ASTM A-153 to Resist Rust and Corrosion
- U-Bolts Are Dyed Blue for Identification Purposes and Use Heavy Duty Hex Nuts (UNC-2A)
- Designed to Meet Federal Specifications, FF-C-450, Type 1, Class 1
- Designed to Meet or Exceed All Requirements of ASME B30.26 Including: Identification, Ductility, Design Factor and Temperature
- Permanently Marked with Size and Manufacturer
- Sizes 1/4" and Above Marked with USA and Date Code
- Sizes 1/8" Through 1-1/4" Are Supplied Bagged and Unassembled
- Forged and Assembled in Cortland, NY
- Note: See Application and Warning Information

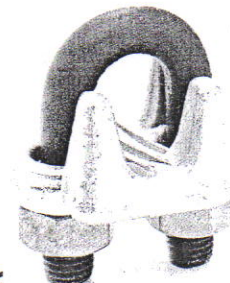
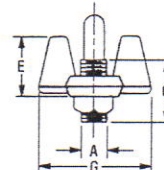
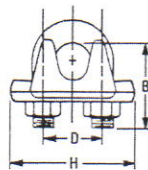

For Rope Diameter	Cat. No.	UPC No.	Minimum No. of Clips Required	Clips Per Box	A Dim.	B Dim.	C Dim.	D Dim.	E Dim.	F Dim.	G Dim.	Weight Each (lbs.)
1/8 in	6990234	020418099908	2	100	7/32 in	3/4 in	7/16 in	9/16 in	7/16 in	29/32 in	1-1/16 in	0.08 lb
3/16 in	6990334	020418099915	2	100	1/4 in	15/16 in	9/16 in	5/8 in	1/2 in	15/16 in	1-1/8 in	0.10 lb
1/4 in	6990434	020418099922	2	100	5/16 in	1-1/32 in	5/8 in	23/32 in	21/32 in	1-1/8 in	1-7/16 in	0.18 lb
5/16 in	6990534	020418099939	2	100	3/8 in	1-5/16 in	13/16 in	7/8 in	3/4 in	1-5/16 in	1-11/16 in	0.32 lb
3/8 in	6990634	020418099946	2	75	7/16 in	1-1/2 in	15/16 in	1 in	29/32 in	1-9/16 in	1-15/16 in	0.48 lb
7/16 in	6990734	020418099953	2	50	1/2 in	2 in	1-1/8 in	1-1/8 in	1 in	1-11/16 in	2-1/4 in	0.72 lb
1/2 in	6990834	020418099960	3	50	1/2 in	2 in	1-1/8 in	1-1/8 in	1-1/16 in	1-13/16 in	2-1/4 in	0.76 lb
9/16 in	6990934	020418099977	3	50	9/16 in	2-3/8 in	1-3/8 in	1-1/4 in	1-9/32 in	1-15/16 in	2-7/16 in	0.96 lb
5/8 in	6991034	020418099984	3	25	9/16 in	2-3/8 in	1-1/2 in	1-1/4 in	1-9/32 in	2-1/16 in	2-7/16 in	1.05 lb
3/4 in	6991234	020418099991	4	25	5/8 in	2-3/4 in	1-1/2 in	1-1/2 in	1-1/2 in	2-5/16 in	2-13/16 in	1.60 lb
7/8 in	6991434	020418100000	4	25	3/4 in	3-1/8 in	1-7/8 in	1-3/4 in	1-17/32 in	2-1/2 in	3-1/4 in	2.40 lb
1 in	6991634	020418100017	5	25	3/4 in	3-1/2 in	2-1/32 in	1-7/8 in	1-3/4 in	2-3/4 in	3-3/8 in	2.70 lb
1-1/8 in	6991834	020418100024	6	10	3/4 in	3-7/8 in	2-1/8 in	2-1/32 in	1-29/32 in	3 in	3-5/8 in	3.40 lb
1-1/4 in	6992034	020418100031	7	10	7/8 in	4-1/4 in	2-3/8 in	2-1/4 in	2-7/32 in	3-1/4 in	4 in	4.60 lb
1-1/2 in	6992434	020418100048	8	10	7/8 in	4-15/16 in	2-1/4 in	2-9/16 in	2-9/16 in	3-1/2 in	4-3/8 in	6.00 lb
1-3/4 in	6992835	020418100055	8	1	1-1/8 in	5-13/16 in	2-3/4 in	3-1/16 in	2-3/4 in	3-3/4 in	5-5/16 in	9.00 lb
2 in	6993235	020418100062	8	1	1-1/4 in	6-1/2 in	3 in	3-3/8 in	3-1/8 in	4-1/4 in	5-7/8 in	13.00 lb

Gas And Supply

Jimmy Gibbs

Phone 504-392-2400

Fax 504-392-1500

jimmy.gibbs@gasandsupply.com



## CROSS REFERENCE GUIDE

SPECIALITY

### NORTON

Abmast  
Brilliant  
Bullard Blaze  
& Road Warrior  
Camel  
Flexovit  
Husqvarna  
Pearl  
Pferd  
Sait  
Tyrolit  
Virginia Abrasives  
Walter

### GOOD

Gemini Metal	Gemini Metal Decking	Gemini Ductile	Gemini Concrete	Gemini Asphalt
A 24 R, Kompetitor Metal	A 24 T	AC 24 R, Kompetitor Ductile Iron	C 24 R, Kompetitor Concrete	C 16 T, Kompetitor Asphalt
Metal/Stainless	—	—	Concrete/Masonry	—
A24R, ZA24Q, The Competitor	TA24R	AC24R	C24R, The Competitor	CC20R
A24-R	A24-T	AC24-R	C24-R	C16-U
A24/30SB	A24TB	AC24SB	C30UB	C16UB
Blue XHS, Blue QMS- CM, Blue EHS	Grey QMS-CM	Green QMS-CM, Green EHS	Red XHS, Red QHS-CM, Red EHS	Black QMS-AS
SRT, Premium A36S, Silver Line A30R	—	AC30S	Premium C36S, Silver Line C24R	—
A 24 R SG	A 24 Q SG-RAIL	AC 24 Q SG	C 24 R SG	—
A24R, A30S, XFC	Brute	Ductile	C24R	Big M.A.C, XFC
A30P, A30BF	—	AC24, AC30BF	1C24, C30BF	—
Metal	—	Ductile	Concrete	Asphalt
A-24	—	—	—	—

### Gas And Supply Jimmy Gibbs

Phone 504-392-2400

Fax 504-392-1500

[jimmy.gibbs@gasandsupply.com](mailto:jimmy.gibbs@gasandsupply.com)



**GOOD**  
Norton  
**GEMINI METAL HD**

Type 01/41  
Aluminum Oxide  
3 Layers



**GOOD**  
Norton  
**GEMINI METAL**

Type 01/41  
Aluminum Oxide  
2 Layers



**GOOD**  
Norton  
**GEMINI METAL  
DECKING**

Type 01/41  
Aluminum Oxide  
2 Layers



**GOOD**  
Norton  
**GEMINI RESCUE**

Type 01/41  
Aluminum Oxide  
2 Layers

### Type 01/41 Cut-off – for Gas & Electric-Powered Saws

12 x 1/8 x 1" / 20mm	6,300	10	66252836708	66252837838		
14 x 1/8 x 1" / 20mm	5,400	10	66252835386	66252837841		
14 x 5/32 x 1" / 20mm	5,400	10			66252832521	66243578262
16 x 1/8 x 1" / 20mm	4,800	10		66252830886		
16 x 1/8 x 1"	4,800	10				

See additional Rail Cut wheels on the next page for larger-volume jobs.



**GOOD**  
Norton  
**GEMINI DUCTILE HD**



Type 01/41  
Silicon Carbide /  
Aluminum Oxide Blend  
3 Layers



**GOOD**  
Norton  
**GEMINI DUCTILE**



Type 01/41  
Silicon Carbide /  
Aluminum Oxide Blend  
2 Layers



**GOOD**  
Norton  
**GEMINI CONCRETE HD**



Type 01/41  
Silicon Carbide  
3 Layers



**GOOD**  
Norton  
**GEMINI CONCRETE**



Type 01/41  
Silicon Carbide  
2 Layers

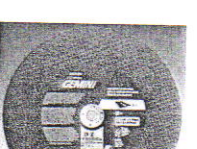

**GOOD**  
Norton  
**GEMINI ASPHALT**



Type 01/41  
Silicon Carbide  
2 Layers

### Type 01/41 Cut-off – for Gas & Electric-Powered Saws

12 x 1/8 x 1" / 20mm	6,300	10		66252837840	66252837839	70184670243
14 x 1/8 x 1" / 20mm	5,400	10	66252835388	66252837843	66252837842	70184672877
16 x 1/8 x 1" / 20mm	4,800	10			70184623029	