



West Bank Regional Library

Request for Qualifications

SOQ#25-015

8 MAY 2025



TEC Professional Services Questionnaire

A. Project Name and Advertisement Resolution Number:

West Bank Regional Library | RFQ Number: 25-015

B. Firm Name & Address:

EskewDumezRipple
400 Lafayette Street, Suite 300
New Orleans, LA 70130

C. Name, title and contact information of Principal, as defined in Section 2-926 of the Jefferson Parish Code of Ordinances, who is a registered, licensed architect, professional engineer, or surveyor in the State of Louisiana:

Christian Rodriguez, AIA, LEED Green Associate
Principal
crodriguez@eskewdumezripple.com
504.276.5421

D. Name and contact information of employee who is a registered and licensed architect, professional engineer, or surveyor in the State of Louisiana in the applicable discipline. A subcontractor may be substituted here only if the advertised Project requires more than one discipline.

Mark Hash, AIA
Senior Associate | Project Manager
mhash@eskewdumezripple.com
504.561.8686

E. Please provide the number of employees whose primary function corresponds with each category:

<u>10</u> Administrative	<u> </u> Estimators	<u> </u> Specification Writers
<u>26</u> Architects (Licensed)	<u> </u> Geologists	<u> </u> Structural Engineers
<u> </u> Chemical Engineers	<u> </u> Geotechnical Engineers	<u> </u> Graduate Engineers
<u> </u> Civil Engineers	<u>4</u> Interior Designers	<u> </u> Project Managers
<u> </u> Construction Inspectors	<u> </u> Landscape Architects	<u> </u> Clerical
<u> </u> Ecologists	<u> </u> Land Surveyor	<u> </u> Grant/Funding Specialist
<u> </u> Electrical Engineers	<u> </u> Mechanical Engineers	<u> </u> Sanitary Engineers
<u> </u> Engineer Intern	<u> </u> Environmental Engineers	<u>16</u> Designers
<u> </u> Professional Land Surveyors		<u>56</u> TOTAL

F. Is this submittal by a JOINT-VENTURE? Please check: YES ☐ NO ☒

If marked “No” skip to Section I. If marked “yes” complete Sections G-H.

TEC Professional Services Questionnaire

G. If submittal is by JOINT-VENTURE, list the firms participating and outline specific areas of responsibility (including administrative, technical, and financial) for each firm. Please attach additional pages if necessary.

1.

2.

H. Has this JOINT-VENTURE previously worked together? Please check:

YES ☐ NO ☐

I. List all subcontractors anticipated for this Project. Please note that all subcontractors must submit a fully completed copy of this questionnaire, applicable licenses, and any other information required by the advertisement. See Jefferson Parish Code of Ordinances, Sec. 2-928(a)(3). Please attach additional pages if necessary.

Name & Address:	Specialty:	Worked with Firm Before (Yes or No):
1. Marais Consultants 2018 Jena Street New Orleans, LA 70115 504.350.2644	Civil Engineering & Water Management <i>*Woman-Owned Small Business (WOSB); Women's Business Enterprise (WBE); Louisiana Small Entrepreneurship (Hudson Initiative); Disadvantaged Business Enterprise (DBE)</i>	Yes
2. Salas O'Brien 541 Julia Street #200, New Orleans, LA 70130 504.930.4080	Mechanical, Electrical, and Plumbing Engineering (MEP)	Yes
3. Batture LLC 5110 Freret Street New Orleans, LA 70115 504.533.8644	Structural Engineering + Landscape Architecture <i>*Certified as a Disadvantaged Business Enterprise (DBE) through the Louisiana Unified Certification Program and as a Small Entrepreneurship under the Louisiana Economic Development Hudson Initiative (No. 12964).</i>	Yes

J. Please specify the total number of support personnel that may assist in the completion of this Project:

TEC Professional Services Questionnaire

K. List the professional in charge, key persons, specialists, and individual consultants anticipated for this Project and provide their relevant information below. If necessary, please attach additional documentation (i.e. resume) that demonstrates the employment history and experience of the Firm's key persons that may assist in the completion of this Project. Please attach additional pages if necessary.

PROFESSIONAL IN CHARGE OF PROJECT:

Name & Title:

Christian Rodriguez, AIA, LEED Green Associate
Principal

Project Assignment:

Professional-in-Charge | Project Director

Name of Firm with which associated:

EskewDumezRipple

Years' experience with this Firm:

15 years with EskewDumezRipple
15 years in the industry

Education: Degree(s)/Year/Specialization:

Master of Architecture, Tulane University, 2010

Active registration: Year first registered/discipline:

Registered Architect in State of Louisiana
License #7896 | First Registered on 08/02/2013

Other experience and qualifications relevant to the proposed Project:
Professional Bio

Christian is a Principal and Architect with significant experience leading complex institutional and campus projects across Louisiana and beyond. His thoughtful, interdisciplinary approach integrates buildings and landscapes into cohesive, unified environments—an approach especially evident in his key role on the major renovation of Tulane University's main campus library. The project showcased his ability to reimagine learning environments while addressing technical, programmatic, and historic considerations. Grounded in a holistic design strategy and a commitment to sustainable, community-focused solutions, Christian brings a depth of insight to every phase of a project. Most recently, he served as project manager for the Home Building at Thaden School in Bentonville, Arkansas—a 30-acre master plan and high school campus designed around experiential learning and a strong sustainability agenda.

Professional Affiliations

American Institute of Architects
National Council of Architectural
Registration Boards

Other Registrations

Louisiana No. 7896; Alabama No.
8953; Connecticut No. ARI.0015434;
LEED Green Associate

TEC Professional Services Questionnaire

KEY PERSON, SPECIALIST, OR INDIVIDUAL CONSULTANT:	
Name & Title:	
Mark Hash, AIA Sr. Associate Sr. Project Manager	
Project Assignment:	
Project Manager	
Name of Firm with which associated:	
EskewDumezRipple	
Years' experience with this Firm:	
10 years with EskewDumezRipple 20 years in the industry	
Education: Degree(s)/Year/Specialization:	
Master of Architecture, Yale University, 2005 Bachelor of Architecture, Louisiana State University, 2002	
Active registration: Year first registered/discipline:	
Registered Architect in State of Louisiana License #9575 Registered on 07/19/2021	
Other experience and qualifications relevant to the proposed Project:	
Professional Bio <p>Mark Hash brings a deep and varied background to his role as Senior Project Manager, with particular expertise in public, institutional, and cultural design. Since joining EskewDumezRipple in 2014, he has led projects that span from major civic facilities to highly specialized cultural institutions, often guiding complex efforts through early concept development, stakeholder engagement, and design execution.</p> <p>Mark is currently leading design efforts for the LSU Library, working closely with university stakeholders to reimagine the library as a future-facing hub for research, collaboration, and student life. His approach combines a strong understanding of institutional needs with an ability to navigate large-scale planning and detailed technical execution. His previous work includes serving as both Project Manager and Project Architect for the LSU Burden Botanical Garden and Visitor's Center, a contemplative gateway to a major cultural and ecological campus, and as Project Architect for the transformation of the Audubon Aquarium and Insectarium, where he helped unify two major public attractions into one seamless and immersive experience. Mark's portfolio also includes a range of public-facing projects such as the Lockport Community Recreation Center, Miller Park, and the Louisiana Music and Heritage Experience Museum.</p>	Professional Affiliations American Institute of Architects (AIA) Registrations & Certifications Registered Architect, License #9575

TEC Professional Services Questionnaire

KEY PERSON, SPECIALIST, OR INDIVIDUAL CONSULTANT:	
Name & Title: Mike Johnson, AIA, LEED Green Associate Associate Project Architect	
Project Assignment: Project Architect	
Name of Firm with which associated: EskewDumezRipple	
Years' experience with this Firm: 8 years with EskewDumezRipple 13 years in the industry	
Education: Degree(s)/Year/Specialization: Master of Architecture, Harvard University, 2016 Bachelor of Architecture, Louisiana State University, 2012	
Active registration: Year first registered/discipline: Registered Architect in State of Louisiana License #9076 Registered on 02/18/2019	
Other experience and qualifications relevant to the proposed Project:	
Professional Bio <p>Mike Johnson is a skilled designer and Project Architect whose work blends technical precision with a strong command of visualization and storytelling. His expertise in design communication has made him a key contributor to several of the firm's most impactful institutional and cultural projects. Mike is currently serving as Project Architect on the LSU Library, working to reimagine the facility as a vibrant center for research, collaboration, and student life. His project experience also includes the Home Building at Thaden School, the Small Family Collaboration Hub at Tulane University, and the Olney Theatre Center for the Arts—each reflecting his ability to deliver thoughtful, mission-driven design.</p> <p>Before joining EskewDumezRipple, Mike gained experience at firms in New Orleans and Boston, and honed his construction knowledge through summers working with a master carpenter and general contractor. He is also active in nonprofit design work, currently volunteering as lead designer with Samanhaus on an orphanage in Jacmel, Haiti. His recognitions include the Heffernan International Travel Grant (2015), the ARCC King Medal (2012), and the Best Design-Build Award at the Washington-Alexandria Architecture Center (2011), with work featured in GSD Platform 8, Sucker Punch Daily, and Super//Architects.</p>	Professional Affiliations American Institute of Architects (AIA) LEED Green Associate Registrations & Certifications Registered Architect, License #9076

TEC Professional Services Questionnaire

KEY PERSON, SPECIALIST, OR INDIVIDUAL CONSULTANT:	
Name & Title: <div style="padding-left: 20px;">Steve Dumez, FAIA Principal Director of Design</div>	
Project Assignment: <div style="padding-left: 20px;">Library Programming & Design Expert and Design Advisor</div>	
Name of Firm with which associated: <div style="padding-left: 20px;">EskewDumezRipple</div>	
Years' experience with this Firm: <div style="padding-left: 20px;">31 years with EskewDumezRipple 44 years in the industry</div>	
Education: Degree(s)/Year/Specialization: <div style="padding-left: 20px;">Master of Architecture, Yale University, 1989 Bachelor of Architecture, Louisiana State University, 1982</div>	
Active registration: Year first registered/discipline: <div style="padding-left: 20px;">Registered Architect in State of Louisiana License #3650 Registered on 11/01/1985</div>	
Other experience and qualifications relevant to the proposed Project:	
<p>Professional Bio</p> <p>As Director of Design at EskewDumezRipple, Steve leads the firm's creative vision with a focus on architecture that enhances community, context, and civic life. With over 30 years of professional practice, he is nationally recognized for designing innovative, high-performing buildings that elevate both user experience and environmental responsibility. A Library Programming & Design Expert, Steve brings deep expertise in creating public institutions that foster learning, access, and connection. His design leadership is central to the LSU Library transformation, where he is helping reimagine the building as a 21st-century hub for knowledge, collaboration, and student life. His broader portfolio reflects a consistent commitment to civic architecture—projects that are as functional as they are inspirational.</p> <p>Steve's work has earned more than 200 design awards, including 16 national AIA honors and the prestigious AIA Architecture Firm Award in 2014. A respected voice in the profession, he has chaired national juries including the AIA Institute Honor Awards, COTE Top Ten, and GSA Design Excellence, and frequently lectures on the social and environmental responsibilities of design. Through both his work and advocacy, Steve reinforces the belief that great architecture serves the public good.</p>	<p>Professional Affiliations</p> <p>American Institute of Architects (AIA) College of Fellows</p> <p>Registrations & Certifications</p> <p>Registered Architect, License #3650 NCARB</p>

TEC Professional Services Questionnaire**KEY PERSON, SPECIALIST, OR INDIVIDUAL CONSULTANT:****Name & Title:**

Z Smith, PhD., FAIA, LEED Fellow, WELL AP, Fitwel & Living Building Ambassador
Principal | Director of Sustainability & Building Performance

**Project Assignment:**

Sustainability Expert

Name of Firm with which associated:

EskewDumezRipple

Years' experience with this Firm:

15 years with EskewDumezRipple
23 years in the industry

Education: Degree(s)/Year/Specialization:

Master of Architecture, University of California, Berkeley, 2002
Doctorate in Electrical Engineering and Computer Science, Princeton University, 1987
Bachelor in Physics, MIT, 1983

Active registration: Year first registered/discipline:

Registered Architect in State of Louisiana
License #7045 | Registered on 04/06/2009

Other experience and qualifications relevant to the proposed Project:**Professional Bio**

Z offers a scientist's perspective to the field of architecture, and his work exists at the intersection of design and technical expertise. He brings training and experience in physics, engineering, and architecture, and is named as inventor on 10 patents and author on over 50 peer-reviewed scientific publications.

As the studio's Director of Sustainability & Building Performance, he integrates his broad range of skills in service of lowering the environmental footprint of each of our buildings and reducing energy costs for owners, while simultaneously leading teams in delivering projects of considerable complexity. His leadership has shaped projects such as the Tulane University Howard-Tilton Memorial Library renovation, the Rosa F. Keller Library & Community Center, and student-focused learning environments like the University of Southern Mississippi Student Resource Center and the Tulane River and Coastal Center.

His paper, "Sustainable Mid-Century Modern," investigates deep energy renovations that preserve the best qualities of buildings from this period, while providing improved comfort at reduced energy consumptions.

Professional Affiliations

American Institute of Architects, College of Fellows; U.S. Green Building Council, LEED Fellow USGBC Louisiana, Former Chair

Registrations & Certifications

Louisiana #7045; California #C 30280; Tennessee #106565; Michigan #1301067325; Connecticut #ARI.0013945; New York #042959-01; LEED Accredited Professional; Building Design + Construction Living Building Ambassador; WELL Accredited Professional; Fitwel Ambassador

TEC Professional Services Questionnaire

KEY PERSON, SPECIALIST, OR INDIVIDUAL CONSULTANT:	
Name & Title: Jill Traylor, NCIDQ, IIDA, LEED Green Associate, WELL AP Principal Director of Interior Design	
Project Assignment: Director of Interior Design & Principal Interior Designer	
Name of Firm with which associated: EskewDumezRipple	
Years' experience with this Firm: 10 years with EskewDumezRipple 26 years in the industry	
Education: Degree(s)/Year/Specialization: Bachelor of Interior Design, Louisiana State University, 1998	
Active registration: Year first registered/discipline: Registered Interior Designer in State of Louisiana License #1461 First Registered on 05/06/2016	
Other experience and qualifications relevant to the proposed Project:	
Professional Bio Jill is a Principal and the Director of Interior Design, with over 25 years of experience in commercial interior design. Over the course of her tenure at the firm, she has played a key role in enhancing EskewDumezRipple's national reputation for interior architecture. Her expertise spans education, workplace, mixed-use, and restaurant design, with a strong focus on creating functional, engaging environments that support learning, collaboration, and community. Jill has been an integral leader in the success of numerous projects, including The Shop at the Contemporary Arts Center in New Orleans and The Shop SLC—coworking environments that balance professional functionality with a warm, welcoming atmosphere. She also led interior design for the Small Family Collaboration Hub at Tulane University, the Baptist Community Ministries Headquarters, and Tech Square 3 at Georgia Tech—each reflecting her ability to shape interiors that respond to institutional missions and user needs. Her portfolio further includes projects such as the Center of Developing Entrepreneurs in Charlottesville, Bottlenworks in New Orleans, NEXUS at The Beach at UNO, LUMCON Blue Works, and the Second Harvest Food Bank. From early programming and space planning to finish and furniture selection, Jill's thoughtful, client-centered approach ensures each space reflects the values and identity of its users. Whether designing educational facilities, coworking hubs, or mission-driven workplaces, her work consistently enhances the user experience and supports long-term impact.	Professional Affiliations International Interior Design Association (IIDA) Registrations & Certifications Registered Interior Designer; NCIDQ License #017636 LEED Green Associate

TEC Professional Services Questionnaire

L. Work by Firm or Joint-Venture members which best illustrates current qualifications relevant to this Project. Please include any and all work performed for Jefferson Parish. Please attach additional pages if necessary.

PROJECT NO. 1

Project Name, Location and Owner's contact information:	Nature of Firm's Responsibility:	
Louisiana State University Library <i>Baton Rouge, LA</i> Owner Contact Danny Mahaffey, LSU - Facilities & Property Oversight (225) 578-2264 dmahaf1@lsu.edu	Set at the nexus of the historic quad and the emerging South Campus Academic Core, the new LSU Library will serve as a vibrant academic and social anchor—uniting diverse users through inclusive, flexible, and future-ready spaces. In alignment with university design guidelines, the library will promote sustainable design, support academic and social activity, and foster pedestrian-friendly connections that bridge expansive campus zones. Designed to empower student success and interdisciplinary collaboration, the library will provide next-generation learning environments, technology-rich resources, and informal gathering areas that encourage interaction, recreation, and intellectual growth. As a key link between LSU's academic legacy and its forward-looking vision, the new library will enrich the full academic journey and contribute to the broader vitality of campus life.	
Completion Date (Actual or estimated):	Estimated Cost:	
	Entire Project:	Work for which Firm was Responsible:
Estimated 2028	\$120M	\$120M

PROJECT NO. 2

Project Name, Location and Owner's contact information:	Nature of Firm's Responsibility:	
Rosa F. Keller Library & Community Center <i>New Orleans, LA</i> Owner Contact Sharon Kohl Branch Director skohl@neworleanspubliclibrary.org	This 10,000 SF FEMA-funded project restores a historic 1917 home and adds a modern library wing to serve as a resilient civic anchor for the Broadmoor neighborhood after Hurricane Katrina. A glazed link connects the two buildings, allowing them to function independently or as one. The library is organized around a central courtyard, with reading areas, book stacks, and a children's room arranged beneath a spiraling glue-laminated wood roof. Rainwater is collected and treated on site via a visible rain garden. The restored historic house includes a community café, meeting rooms, and technology lab—supporting the library's role as both an educational resource and community hub. The project is LEED certified and reflects a broader commitment to sustainability, equity, and neighborhood revitalization.	
Completion Date (Actual or estimated):	Estimated Cost:	
	Entire Project:	Work for which Firm was Responsible:
2012	\$5.8M	\$5.8M

TEC Professional Services Questionnaire

PROJECT NO. 3		
Project Name, Location and Owner's contact information:	Nature of Firm's Responsibility	
Howard Tilton Memorial Library at Tulane University <i>New Orleans, LA</i> Owner Contact Shawn Lege VP Design & Construction Tulane University 504.865.5443 slege@tulane.edu	Tulane University's Howard-Tilton Memorial Library underwent a significant expansion to support its evolving academic mission. Two new upper floors were added to replace spaces lost in the basement due to Hurricane Katrina, restoring critical program areas and enhancing user experience. The addition consolidates collections and services from both the library and the neighboring Joseph M. Jones Memorial Building, while also improving building infrastructure with new mechanical and electrical systems on the sixth floor. Rising above the oak canopy, the design respects both the campus setting and nearby residential neighborhoods, with thoughtful integration of circulation, vertical access, and environmental controls to ensure long-term functionality and resilience.	
Completion Date (Actual or estimated)	Estimated Cost:	
	Entire Project:	Work for which Firm was Responsible:
2012	\$26.6M	\$26.6M

PROJECT NO. 4		
Project Name, Location and Owner's contact information:	Nature of Firm's Responsibility:	
Library Planning & Programming Study at Louisiana State University <i>Baton Rouge, LA</i> Owner Contact Danny Mahaffey, LSU - Facilities & Property Oversight (225) 578-2264 dmahaf1@lsu.edu	This comprehensive planning/programming study outlines a transformative vision for a new Library at LSU—one that redefines the campus library as an academic, social, & support hub. The study recommends a 298,000 SF facility with over 3,500 study seats, integrated student services, flexible learning environments, and next-generation technology like an Automated Storage and Retrieval System (ASRS). The phased approach ensures LSU can align long-term goals with immediate needs, positioning the Library as a critical connector between historic and emerging campus cores and as a driver of academic success and innovation.	
Completion Date (Actual or estimated):	Estimated Cost:	
	Entire Project:	Work for which Firm was Responsible:
2022	N/A	N/A

TEC Professional Services Questionnaire

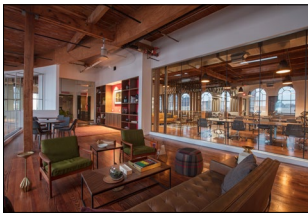
PROJECT NO. 5		
Project Name, Location and Owner's contact information:	Nature of Firm's Responsibility:	
<p>The Shop at the Contemporary Arts Center (CAC) New Orleans, LA</p> <p>Owner Contact Chris Papamichael Principal Domain Companies (212) 991-0001 cpapamichael@thedomaincos.com</p>	<p>The Shop at the CAC is a 37,000 SF coworking space designed to support New Orleans' creative and entrepreneurial community. Located within the historic Contemporary Arts Center, the project blends modern design with exposed structural elements to create a vibrant, collaborative environment. A central commons anchors the space, offering shared amenities like a full kitchen, coffee station, and flexible seating to encourage informal interaction and community building. Connected by a sculptural stair, the two-level workspace includes private offices, open desks, and lounges—supporting a wide range of work styles and business needs. With its central location and cultural adjacency, The Shop has become a hub for innovation and connection in the city's downtown core.</p> 	
Completion Date (Actual or estimated):	Estimated Cost:	
	Entire Project:	Work for which Firm was Responsible:
2017	\$9.2M	\$9.2M

PROJECT NO. 6		
Project Name, Location and Owner's contact information:	Nature of Firm's Responsibility:	
<p>Small Family Collaboration Hub at Tulane University New Orleans, LA</p> <p>Owner Contact Alicia Crowell Tulane - Capital Projects and Real Estate Group (504) 247-1285 acrowell@tulane.edu</p>	<p>The Small Family Collaboration Hub anchors the ground floor of Tulane's River and Lake Residence Halls as a dynamic, 14,000 SF gathering space open to the entire campus community. Designed to support student wellness, creativity, and connection, the hub offers flexible zones for academic collaboration, advising events, and informal recreation. Work booths, lounge seating, and quiet study areas coexist with social features like foosball, shuffleboard, and a 100-inch TV. Drawing inspiration from New Orleans' "Neutral Ground," the space blends the energy of campus life with the comfort of a student living room—encouraging spontaneous interaction, shared learning, and a sense of belonging.</p> 	
Completion Date (Actual or estimated):	Estimated Cost:	
	Entire Project:	Work for which Firm was Responsible:
2023	\$3.79M	\$3.79M

TEC Professional Services Questionnaire

PROJECT NO. 7		
Project Name, Location and Owner's contact information:	Nature of Firm's Responsibility:	
Home Building at Thaden School <i>Bentonville, AR</i> Owner Contact Clayton Marsh Former Head of School Thaden School (479) 268-5321 claytonkmarsh@gmail.com	<p>The Home Building at Thaden School serves as the social and academic heart of campus, embodying the school's "learning by doing" philosophy. In addition to housing the dining hall, the 34,000-square-foot facility includes a teaching kitchen, student bookstore, library, and flexible study and lounge spaces—creating a central hub for both structured and informal learning. The teaching kitchen and open culinary workspace allow students to engage directly with food preparation, reinforcing hands-on education. The library opens to the broader campus, maintaining visual connections even in quiet study. Designed with regional materials and a welcoming, residential feel, the Home Building fosters a strong sense of community while supporting diverse modes of learning.</p> 	
Completion Date (Actual or estimated):	Estimated Cost:	
	Entire Project:	Work for which Firm was Responsible:
2023	\$11.2M	\$11.2M

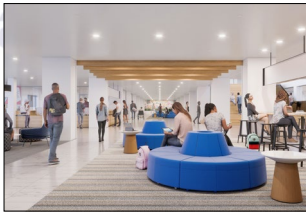
PROJECT NO. 8		
Project Name, Location and Owner's contact information:	Nature of Firm's Responsibility:	
Olin and Uris Library Study at Cornell University <i>Ithaca, NY</i> Owner Contact Margaret Carney Senior Director of the Office of the University Architect Cornell University (607) 255-5322	<p>A transformative feasibility study reimagines Cornell's Olin and Uris Libraries as more connected, inclusive, and adaptable spaces—aligned with the evolving needs of the academic community. The study explores how these iconic libraries can better support research, learning, and student life through greater accessibility, flexibility, and connection—both between the buildings and across campus. Conceptual design strategies propose improved circulation, enhanced entries, and new academic hubs. A phased implementation plan with cost estimates across 11 capital projects provides a clear roadmap for revitalizing these essential campus resources.</p> 	
Completion Date (Actual or estimated):	Estimated Cost:	
	Entire Project:	Work for which Firm was Responsible:
2019	N/A	N/A

TEC Professional Services Questionnaire

PROJECT NO. 9		
Project Name, Location and Owner's contact information:	Nature of Firm's Responsibility:	
N/A		
Completion Date (Actual or estimated):	Estimated Cost:	
	Entire Project:	Work for which Firm was Responsible:

PROJECT NO. 10		
Project Name, Location and Owner's contact information:	Nature of Firm's Responsibility:	
N/A		
Completion Date (Actual or estimated):	Estimated Cost:	
	Entire Project:	Work for which Firm was Responsible:

TEC Professional Services Questionnaire

M. List all prior and/or on-going litigation between Firm and Jefferson Parish. Please attach additional pages if necessary.

Parties:		Status/Result of Case:
Plaintiff:	Defendant:	
1. N/A		
2.		
3.		
4.		

N. Use this space to provide any additional information or description of resources supporting Firm's qualifications for the proposed project.

Information for **Section N** can be found on the following attached pages.

O. To the best of my knowledge, the foregoing is an accurate statement of facts.

Signature:  **Print Name:** Christian Rodriguez, AIA, LEED Green Associate
Title: Principal | Project Director **Date:** 05 May 2025

Section N



Section N Table of Contents

Subsection 1 Experience (Firm & Individual)

- A. Executive Summary
- B. Firm Background, Management Style, & Design Philosophy
- C. Education Experience
- D. Staffing Plan
- E. Management Plan

Subsection 2 Past Performance

- A. Projects with Similar Scope
- B. Errors & Omissions
- C. Professional References

Subsection 3 Current Workload

Subsection 4 Firm Size Relative to Magnitude of Work

Subsection 5 Responsiveness to Scope of Work

Subsection 6 Other

Subsection 1: Experience (Firm & Individual)

A. Executive Summary

As community libraries continue to evolve to meet expanding expectations, we believe our role as design partners is more vital than ever—helping you focus investments where they will matter most and delivering a project that reflects the values and needs of your community.

No longer just repositories for books and quiet study, today's regional libraries are vibrant civic resources—places of connection, learning, and opportunity.

EskewDumezRipple is proud to lead a collaborative team with deep experience in public-sector library, education, and community-centered design. Our portfolio spans new and renovated library facilities, higher education study centers, and cultural institutions across Louisiana and beyond. We've worked closely with local governments, institutions, and neighborhoods to deliver architecture that is forward-thinking, fiscally responsible, and designed for long-term value. As one of the largest and most enduring architecture firms in the state—founded in 1989 in New Orleans—we bring an unparalleled understanding of Louisiana's climate, construction landscape, and regulatory context.

For this project, our team is led by Christian Rodriguez, Project Director and Professional-in-Charge, who will provide strategic oversight and serve as Jefferson Parish's primary point of contact. He is joined by Mark Hash, Project Manager, whose leadership on projects like the ongoing LSU Library demonstrates his ability to manage large-scale public work with precision and care. Mike Johnson, serving as Project Architect, brings a strong technical background and design sensitivity to guide the development of a durable, functional building. Jill Traylor, Director of Interior Design, will lead the creation of inclusive, user-friendly interiors informed by her work on collaborative hubs like The Shop at the CAC and Tulane's Small Family Collaboration Hub.

Our design approach will be guided by Steve Dumez, Director of Design and our firm's nationally recognized Library Programming & Design Expert. Steve's leadership has shaped some of the firm's most celebrated civic projects, ensuring that every space serves the people who use it. Z Smith, our Director of Sustainability and Building Performance, will ensure that environmental performance and long-term resilience are woven into every design decision.

To deliver on all technical requirements, we've partnered with trusted Louisiana-based engineers: **Batture LLC** (structural and landscape), **Marais Consultants** (civil), and **Salas O'Brien** (MEP), all of whom have long-standing relationships with our firm and bring a depth of experience working on institutional facilities across the region.

We understand the essential role that the Jefferson Parish Library system plays in enriching the lives of its residents. Our collaborative process, community engagement experience, and track record of high-performing civic projects position us to support the Parish in creating a new West Bank Regional Library that is welcoming, adaptable, and deeply rooted in place.

We appreciate your consideration and welcome the opportunity to partner on this important initiative.

Let's create something remarkable together.

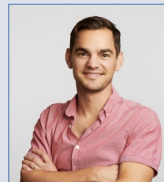

Christian Rodriguez
AIA, LEED Green Associate
Project Director & Project Manager
Principal
crodriguez@eskewdumezripple.com

B. Firm Background, Management Style, & Design Philosophy

Eskew Dumez Ripple⁺

Firm Background

EskewDumezRipple is a nationally honored architecture, interiors and urban planning firm recognized for producing innovative projects grounded by a strong understanding of context, culture, and environment. With offices in New Orleans, LA, and Washington, DC, the firm builds across the country and around the world, with the goal of integrating beauty and performance.

Design Philosophy

From its inception, the firm has been driven by four enduring core values: Design Excellence, Environmental Responsibility, Community Outreach, and Client Commitment. Every aspect of the practice has been structured to support these ideals. The resulting body of work – ranging from intimate interiors to large urban planning projects with numerous stakeholders – reflects an aspiration to build community, regardless of project scale, budget, scope or complexity.

Management Style

The practice's commitment to culture and civility places public participation at the center. The firm works to integrate many voices alongside the constraints of climate, place, and budget to deliver projects that provide the greatest positive impact for the owner, for the user, for the community, and for the planet.

1989 YEAR FOUNDED

56 NUMBER OF EMPLOYEES

33 UNIVERSITY PROGRAMS REPRESENTED

30% LEED ACCREDITED TECHNICAL STAFF

55% LICENSED PROFESSIONAL STAFF



2014

AIA ARCHITECTURE FIRM AWARD

Sustainability

We believe that design excellence combines beauty, function, economy, and environmental performance. Our goal is to create places that work and inspire. We start from an awareness of site and climate, pay attention to energy and water use, and consider the consequences of materials choices on the health of occupants, the community, and the environment. Some call this approach 'sustainable design.' We believe it is just good design. This philosophy can be summarized quite simply: *If it doesn't work, it is not beautiful, and, if it's not beautiful, it doesn't work.* Our approach inextricably links beauty with performance to connect people to place and create projects of lasting cultural and social value.

Award-Winning Design to Meet Your Budget

We frequently work with clients who are working within the constraints of a set budget and are often similarly celebrated by these clients as "architects who can do more with less." Architecture doesn't have to be costly to be impactful. Our portfolio showcases a range of projects dedicated to high design work on relatively modest budgets, where we worked with clients as "good stewards" focusing dollars where they will have the highest and best use for your mission.

C. Relevant Experience

Library Projects

LSU Library

Tulane University Howard Tilton Memorial Library
Renovation & Addition

Rosa F. Keller Library and Community Center

Olin & Uris Library Study at Cornell University

Community & Public Space Projects

U.S. Courthouse in Greenville, Mississippi

Shaw Center for the Arts

LSU Burden Welcome Center

Louisiana Capitol Park Museum

Acadiana Center for the Arts

Chattanooga Outdoor Center

Ernest N. Morial Convention Great Hall

Linear Park at Convention Center Boulevard

+ more

Higher Education Projects

Small Family Collaboration Hub at Tulane University's River and
Lake Residence Halls

Loyola University Danna Center & Dining Facility

LSU Our Lady of the Lake Interdisciplinary Science Building

LSU Health's Center for Advanced Learning and Simulation

Tech Square 3 at Georgia Tech

Tulane University School of Social Work

University of South Alabama College of Medicine

Rice University Sustainability Master Plan

+ more

K-12 Education Projects

Home Building at Thaden School

New Commons at Trinity School

New Orleans Center for Creative Arts (NOCCA) Master Plan: The
100 Year Vision + Student Performance/Studio Center

Transfiguration of the Lord Classroom Building & Gymnasium/
Student Commons

McDonogh 42 Elementary School Renovation

L.B. Landry High School

Mount Carmel Academy Motherhouse Interior Renovation

Lycée Français de la Nouvelle-Orléans

+ more



LSU Burden Welcome Center at the Botanical Gardens,
Baton Rouge, LA



Small Family Collaboration Hub at Tulane University's River and
Lake Residence Halls, New Orleans, LA



Loyola University Danna Center & Dining Facility,
New Orleans, LA



Lycée Français de la Nouvelle-Orléans,
New Orleans, LA

D. Staffing Plan

Core Design Team

Programming, Architecture,
& Interior Design

EskewDumezRipple

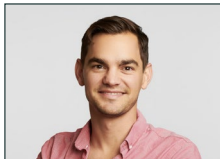

Christian Rodriguez
Project Director
& Professional-in-
Charge



Mark Hash
Project Manager



Mike Johnson
Project Architect



Steve Dumez
Library Programming
& Design Expert



Jill Traylor
Interior Design Expert



Z Smith
Sustainability Expert

Structural Engineering &
Landscape Architecture

Batture LLC

Civil Engineering &
Stormwater Management

Marais Consultants

Mechanical, Electrical, and
Plumbing (MEP) Engineering

Salas O'Brien

Our Team: For this library project, we’ve assembled a multidisciplinary team purpose-built to meet its unique goals—combining extensive experience in public libraries, renovations, new construction, and integrated design. This collaborative structure ensures every aspect of the project is considered from the outset.

Christian Rodriguez, Project Director and Professional-in-Charge, brings over 15 years of experience leading complex, community-focused projects. He will oversee the design team and serve as Jefferson Parish’s primary point of contact. Mark Hash, Project Manager, provides strategic leadership and organizational precision, drawing from his experience on efforts such as the LSU Library. Mike Johnson, Project Architect, will guide the technical development of the project, balancing design excellence with constructability and budget-conscious solutions. Steve Dumez, Library Programming & Design Expert, brings over three decades of nationally recognized work in civic and institutional architecture. His leadership will shape a compelling, high-performing design that reflects community needs.

Jill Traylor, Interior Design Expert, will lead the development of purposeful, wellness-centered interior environments, building on her work with library-adjacent projects like the Small Family Collaboration Hub at Tulane and The Shop at the CAC. Z Smith, Sustainability Expert, will integrate performance-driven strategies that reduce long-term operating costs and environmental impact, aligning with Jefferson Parish’s future-ready goals.

We’ve partnered with a trusted team of consultants to ensure technical excellence:

- Marais Consultants will lead civil engineering and stormwater management,
- Salas O’Brien will deliver MEP design, leveraging experience from the LSU Library, and
- Batture will oversee structural engineering and landscape architecture.

Together, this team brings the depth, expertise, and alignment needed to realize Jefferson Parish’s vision for a forward-thinking public library.



Christian Rodriguez

Principal | Project Director

AIA, LEED Green Associate

Christian is a Principal and Architect with significant experience leading complex institutional and campus projects across Louisiana and beyond. His thoughtful, interdisciplinary approach integrates buildings and landscapes into cohesive, unified environments—an approach especially evident in his key role on the major renovation of Tulane University’s main campus library. The project showcased his ability to reimagine learning environments while addressing technical, programmatic, and historic considerations.

Grounded in a holistic design strategy and a commitment to sustainable, community-focused solutions, Christian brings a depth of insight to every phase of a project. Most recently, he served as project manager for the Home Building at Thaden School in Bentonville, Arkansas—a 30-acre master plan and high school campus designed around experiential learning and a strong sustainability agenda.

Education

Master of Architecture, Tulane University, 2010

Professional Affiliations

American Institute of Architects
National Council of Architectural
Registration Boards

Certification/Registration

Louisiana No. 7896
Alabama No. 8953
Connecticut No. ARI.0015434
LEED Green Associate

+ Favorite Book

Rising Tide
by John Barry

Selected Projects

Home Building at Thaden School, Bentonville, AR
Howard Tilton Memorial Library, Tulane University, New Orleans, LA
U.S. Federal Courthouse, Greenville, MS
College of Medicine, University of South Alabama, Mobile, AL
New Orleans Military and Maritime Academy, New Orleans, LA
Linear Park at MCCNO, New Orleans, LA
Miller Park, Chattanooga, TN
Olney Theatre Center for the Arts, Olney, MD
SBP St. Peter’s Residential, New Orleans, LA
Crescent Park, New Orleans, LA
Louisiana Superdome Champions Square, New Orleans, LA
St. Pius Chapel, New Orleans, LA
Second Harvest Food Bank, New Orleans, LA
Lakefront Redevelopment, New Orleans, LA
New Orleans Museum of Art Repairs, New Orleans, LA
Woldenberg Park Site Improvements, New Orleans, LA

Home Building at Thaden School, Bentonville, AR



Howard Tilton Memorial Library, Tulane University, New Orleans, LA



U.S. Federal Courthouse, Greenville, MS





Mark Hash

Sr. Associate | Project Manager

AIA

Mark Hash brings a deep and varied background to his role as Senior Project Manager, with particular expertise in public, institutional, and cultural design. Since joining EskewDumezRipple in 2014, he has led projects that span from major civic facilities to highly specialized cultural institutions, often guiding complex efforts through early concept development, stakeholder engagement, and design execution.

Education

Master of Architecture, Yale University, 2005

Bachelor of Architecture, Louisiana State University, 2002

Professional Affiliations

American Institute of Architects

Certification/Registration

Registered Architect, License #9575

+ Favorite Book

As Little Design as Possible
by Dieter Rams

Mark is currently leading design efforts for the LSU Library, working closely with university stakeholders to reimagine the library as a future-facing hub for research, collaboration, and student life. His approach combines a strong understanding of institutional needs with an ability to navigate large-scale planning and detailed technical execution. His previous work includes serving as both Project Manager and Project Architect for the LSU Burden Botanical Garden and Visitor's Center, a contemplative gateway to a major cultural and ecological campus, and as Project Architect for the transformation of the Audubon Aquarium and Insectarium, where he helped unify two major public attractions into one seamless and immersive experience. Mark's portfolio also includes a range of public-facing projects such as the Lockport Community Recreation Center, Miller Park, and the Louisiana Music and Heritage Experience Museum.

Selected Projects

LSU Library, Baton Rouge, LA

LSU Burden Welcome Center, Baton Rouge, LA

Louisiana Workers' Compensation Corporation Headquarters, Baton Rouge, LA

Louisiana Association of Business and Innovation, Baton Rouge, LA

LUMCON Blue Works, Houma, LA

Audubon Aquarium and Insectarium, New Orleans, LA

Miller Park, Chattanooga, TN

Louisiana Music and Heritage Experience Museum, New Orleans, LA

LSU College of Art & Design Master Plan, Baton Rouge, LA

Tech Square 3 at Georgia Tech, Atlanta, GA

LSU Library, Baton Rouge, LA



LSU Burden Welcome Center, Baton Rouge, LA



Louisiana Workers' Compensation Corporation Headquarters, Baton Rouge, LA

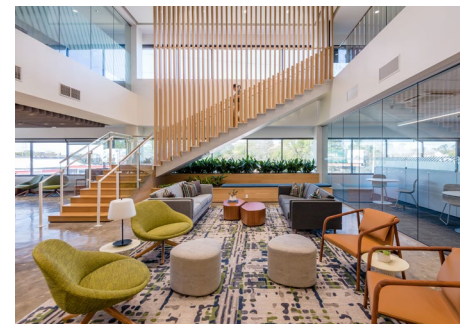



Mike Johnson

Associate | Project Architect

AIA, LEED Green Associate

Mike Johnson is a skilled designer and Project Architect whose work blends technical precision with a strong command of visualization and storytelling. His expertise in design communication has made him a key contributor to several of the firm's most impactful institutional and cultural projects. Mike is currently serving as Project Architect on the LSU Library, working to reimagine the facility as a vibrant center for research, collaboration, and student life. His project experience also includes the Home Building at Thaden School, the Small Family Collaboration Hub at Tulane University, and the Olney Theatre Center for the Arts—each reflecting his ability to deliver thoughtful, mission-driven design.

Before joining EskewDumezRipple, Mike gained experience at firms in New Orleans and Boston, and honed his construction knowledge through summers working with a master carpenter and general contractor. He is also active in nonprofit design work, currently volunteering as lead designer with Samanhaus on an orphanage in Jacmel, Haiti. His recognitions include the Heffernan International Travel Grant (2015), the ARCC King Medal (2012), and the Best Design-Build Award at the Washington-Alexandria Architecture Center (2011), with work featured in GSD Platform 8, Sucker Punch Daily, and Super//Architects.

Education

Master of Architecture,
Harvard University, 2016

Bachelor of Architecture,
Louisiana State University, 2012

Professional Affiliations

American Institute of Architects (AIA)
LEED Green Associate

Certification/Registration

Registered Architect, License #9076

+ Favorite Book

An Anthropologist on Mars
by Oliver Sacks

Selected Projects

LSU Library, Baton Rouge, LA
Home Building at Thaden School, Bentonville, AR
Small Family Collaboration Hub at Tulane University, LA
Tech Square 3 at Georgia Tech, Atlanta, GA
U.S. Courthouse, Greenville, MS
Uptown Residence Hall, New Orleans, LA
University of South Alabama College of Medicine, Mobile, AL
Gulf Coast Bank Elmwood, Metairie, LA
Louisiana Music and Heritage Experience Museum, New Orleans, LA
LUMCON Blue Works, Houma, LA
Olney Theatre Center for the Arts, Olney, MD

LSU Library, Baton Rouge, LA



Home Building at Thaden School, Bentonville, AR



Small Family Collaboration Hub at Tulane University, LA

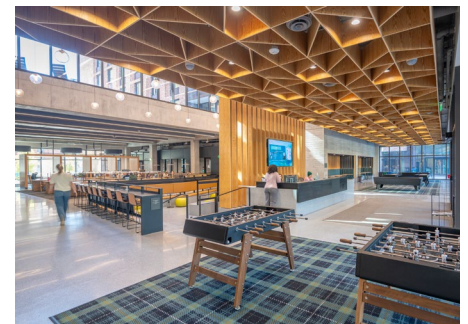



Steve Dumez

Director of Design | Library Programing & Design Expert

FAIA

As Director of Design at EskewDumezRipple, Steve leads the firm's creative vision with a focus on architecture that enhances community, context, and civic life. With over 30 years of professional practice, he is nationally recognized for designing innovative, high-performing buildings that elevate both user experience and environmental responsibility. A Library Programming & Design Expert, Steve brings deep expertise in creating public institutions that foster learning, access, and connection. His design leadership is central to the LSU Library transformation, where he is helping reimagine the building as a 21st-century hub for knowledge, collaboration, and student life. His broader portfolio reflects a consistent commitment to civic architecture—projects that are as functional as they are inspirational.

Steve's work has earned more than 200 design awards, including 16 national AIA honors and the prestigious AIA Architecture Firm Award in 2014. A respected voice in the profession, he has chaired national juries including the AIA Institute Honor Awards, COTE Top Ten, and GSA Design Excellence, and frequently lectures on the social and environmental responsibilities of design. Through both his work and advocacy, Steve reinforces the belief that great architecture serves the public good.

Education

Master of Architecture, Yale University, 1989

Bachelor of Architecture, Louisiana State University, 1982

Professional Affiliations

American Institute of Architects (AIA)
College of Fellows

Certification/Registration

Registered Architect, License #3650
NCARB

+ Favorite Book

All the King's Men
by Robert Penn Warren

Selected Projects

Rosa F. Keller Library and Community Center, New Orleans, LA
LSU Library, Baton Rouge, LA
Tulane University Howard Tilton Memorial Library, New Orleans, LA
Home Building at Thaden School, Bentonville, AR
Small Family Collaboration Hub at Tulane University, New Orleans, LA
LSU Burden Welcome Center, Baton Rouge, LA
New Student Commons at Trinity School, New Orleans, LA
New Orleans Bioinnovation Center, New Orleans, LA
U.S. Courthouse, Greenville, MS
LSU Our Lady of the Lake Interdisciplinary Science Building, Baton Rouge, LA

LSU Library, Baton Rouge, LA



Tulane University Howard Tilton Memorial Library, New Orleans, LA



Rosa F. Keller Library and Community Center, New Orleans, LA





Jill Traylor

Principal | Director of Interior Design & Principal Interior Designer

NCIDQ, IIDA, LEED Green Associate, WELL AP

Jill is a Principal and the Director of Interior Design, with over 25 years of experience in commercial interior design. Over the course of her tenure at the firm, she has played a key role in enhancing EskewDumezRipple's national reputation for interior architecture. Her expertise spans education, workplace, mixed-use, and restaurant design, with a strong focus on creating functional, engaging environments that support learning, collaboration, and community.

Education

Bachelor of Interior Design, Louisiana State University, 1998

Professional Affiliations

International Interior Design Association (IIDA)

Certification/Registration

Registered Interior Designer; NCIDQ License #017636; Louisiana Licensed Interior Designer #1461; LEED Green Associate; WELL AP

+ Favorite Book

The Day the Crayons Quit
by Drew Daywalt

Jill has been an integral leader in the success of numerous projects, including The Shop at the Contemporary Arts Center in New Orleans and The Shop SLC—coworking environments that balance professional functionality with a warm, welcoming atmosphere. She also led interior design for the Small Family Collaboration Hub at Tulane University, the Baptist Community Ministries Headquarters, and Tech Square 3 at Georgia Tech—each reflecting her ability to shape interiors that respond to institutional missions and user needs. Her portfolio further includes projects such as the Center of Developing Entrepreneurs in Charlottesville, Bottleworks in New Orleans, NEXUS at The Beach at UNO, LUMCON Blue Works, and the Second Harvest Food Bank. From early programming and space planning to finish and furniture selection, Jill's thoughtful, client-centered approach ensures each space reflects the values and identity of its users. Whether designing educational facilities, coworking hubs, or mission-driven workplaces, her work consistently enhances the user experience and supports long-term impact.

Selected Projects

The Shop CAC, New Orleans, LA
Small Family Collaboration Hub at Tulane University, New Orleans, LA
The Shop SLC, Salt Lake City, UT
Tech Square 3 at Georgia Tech, Atlanta, GA
Baptist Community Ministries Headquarters, New Orleans, LA
LUCMON Blue Works, Houma, LA
Bottleworks Coworking, New Orleans, LA
NEXUS at the Beach at UNO Research/Technology Park, New Orleans, LA
Center of Developing Entrepreneurs, Charlottesville, VA

The Shop CAC, New Orleans, LA

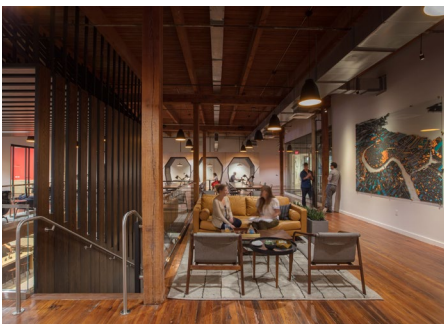

Small Family Collaboration Hub at Tulane University, New Orleans, LA



The Shop SLC, Salt Lake City, UT

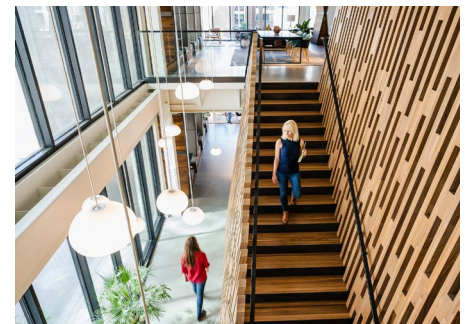



Z Smith

Director of Sustainability & Performance | Sustainability Expert

PhD., LEED Fellow, WELL AP, Fitwel & Living Building Ambassador

Z offers a scientist's perspective to the field of architecture, and his work exists at the intersection of design and technical expertise. He brings training and experience in physics, engineering, and architecture, and is named as inventor on 10 patents and author on over 50 peer-reviewed scientific publications.

As the studio's Director of Sustainability & Building Performance, he integrates his broad range of skills in service of lowering the environmental footprint of each of our buildings and reducing energy costs for owners, while simultaneously leading teams in delivering projects of considerable complexity. His leadership has shaped projects such as the Tulane University Howard-Tilton Memorial Library renovation, the Rosa F. Keller Library & Community Center, and student-focused learning environments like the University of Southern Mississippi Student Resource Center and the Tulane River and Coastal Center.

His paper, "Sustainable Mid-Century Modern," investigates deep energy renovations that preserve the best qualities of buildings from this period, while providing improved comfort at reduced energy consumptions.

Education

Master of Architecture, University of California, Berkeley, 2002;
Doctorate in Electrical Engineering and Computer Science, Princeton University, 1987; Bachelor in Physics, MIT, 1983

Professional Affiliations

American Institute of Architects,
College of Fellows; USGBC, LEED
Fellow USGBC Louisiana, Former Chair

Certification/Registration

Louisiana #7045; LEED Accredited
Professional: Building Design
+ Construction Living Building
Ambassador; WELL Accredited
Professional; Fitwel Ambassador

+ Favorite Book

Braiding Sweetgrass
by Robin Wall Kemmerer

Selected Projects

Rosa F. Keller Library and Community Center, New Orleans, LA
Home Building at Thaden School and Master Plan, Bentonville, AR
Small Family Collaboration Hub at Tulane University, New Orleans, LA
Cornell Olin and Uris Library Master Plan and Feasibility Study, Ithaca, NY
LSU Comprehensive and Strategic Master Plan, Baton Rouge, LA
LSU Interdisciplinary Science Building, Baton Rouge, LA
NOCCA Master Plan, New Orleans, LA
Tulane School of Science and Engineering Study, New Orleans, LA
Emory University Pathways Program Feasibility Study, Atlanta, GA
Tech Square 3 at Georgia Tech, Atlanta, GA
New Orleans BioInnovation Center, New Orleans, LA
U.S. Courthouse, Greenville, MS
Yale Univ. Botanical Garden & Greenhouse Carbon Neutrality Plan, New Haven, CT
Center of Developing Entrepreneurs, Charlottesville, VA

Home Building at Thaden School and Master Plan,
Bentonville, AR



Rosa F. Keller Library and Community Center, New
Orleans, LA

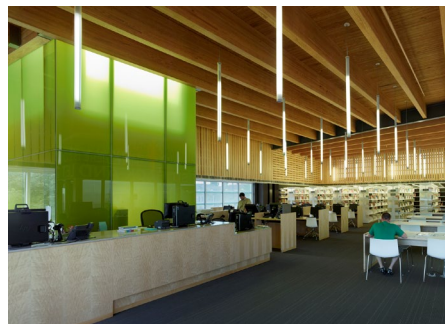

Cornell Olin and Uris Library Master Plan and
Feasibility Study, Ithaca, NY

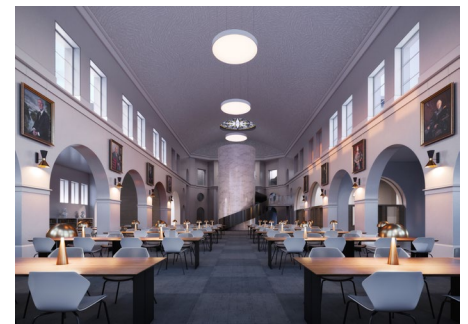

E. Management Plan

Key Personnel and Responsibilities

EskewDumezRipple brings together a focused team of experts and collaborators to deliver a high-performing, community-centered library tailored to Jefferson Parish's unique needs. Our leadership structure and project management approach are designed to ensure seamless coordination, responsive communication, and effective delivery.

Christian Rodriguez, Project Director and Professional-in-Charge, will provide strategic oversight and maintain alignment across all design disciplines, consultants, and stakeholders—including Jefferson Parish leadership. Mark Hash, Project Manager, will direct day-to-day operations, manage consultant coordination, and ensure the project remains on schedule and within budget. Mike Johnson, Project Architect, will lead the technical and architectural execution of the design, ensuring the library's goals for function, performance, and durability are met. Jill Traylor, Interior Design Director, will guide the creation of inviting and functional interior environments for the existing library and new additions that serve both patrons and library staff. Steve Dumez, Library Programming & Design Expert and Director of Design at EskewDumezRipple, will lend vision and expertise to create a library that is both architecturally significant and highly usable.

Mark Hash and Mike Johnson working with a 3D model of the LSU Library, currently in design.



Christian Rodriguez, Professional-in-Charge and Project Director for this library project, working with the Civic/Cultural design team.



Jill Traylor, Interior Design Expert and Director of Interior Design, leading a design charrette in studio.

Z Smith, Director of Sustainability and Building Performance, will advise on strategies that reduce long-term operational costs and environmental impact—ensuring the building is efficient, future-ready, and resilient.

To support the project's technical needs, we have assembled a trusted team of engineering partners:

- Batture LLC (structural and landscape),
- Marais Consultants (civil), and
- Salas O'Brien (MEP).

These collaborators bring deep experience working with our firm and are well-versed in delivering high-performing facilities across Louisiana.

E. Management Plan (*cont.*)

Monitoring and Controlling Budget and Schedule

Our approach begins with establishing a clear, achievable project schedule that identifies all critical delivery dates, decision points, and review milestones. We prioritize early alignment on these benchmarks to ensure the project progresses smoothly, efficiently, and on time.

In parallel, we implement a proactive cost management strategy. EskewDumezRipple conducts internal cost estimates at each project milestone, led by our **Construction Manager and Director of Preconstruction, Andy Redmon**. His expertise ensures cost control and scheduling expertise to maintain design intent while adhering to the project's budget.

This dual-layered approach to managing cost and schedule allows us to identify discrepancies early, propose value engineering (VE) solutions, and keep the design on track within budgetary constraints. Our deep local experience and up-to-date cost database provide real-time feedback on the financial impact of design decisions, helping us make informed choices and eliminate impractical options early.

Director of Preconstruction Services Andy Redmon (right) working with PM Cynthia Dubberley in studio.



TOP: Sustainability Coordinator Aida Ayuk leading a drone workshop for EskewDumezRipple staff. BOTTOM: Designer Roshell Grant Wesley; leading VR tours at a fundraising event.



Technology

Our design process integrates cutting-edge technology at every stage to ensure precision, efficiency, and collaboration. We use advanced software for 3D modeling, rendering, and virtual reality to visualize and refine design concepts with clients and stakeholders, enabling real-time feedback and adjustments to align the design with project goals.

Our in-house team, including certified drone pilots, employs aerial imagery for site analysis and design validation, providing valuable insights into the project's physical context. Building Information Modeling (BIM) improves design coordination, while tools like Bluebeam and Revu streamline document management and communication, ensuring efficient teamwork.

To facilitate seamless communication, we rely on collaboration platforms like Miro, Microsoft Teams, Adobe Creative Suite, and our cloud-based server, Egnyte. These technologies improve project delivery, streamline workflows, and enhance collaboration, ensuring the Library is realized efficiently and effectively in the built environment.

E. Management Plan (*cont.*)



TOP: An early workshop led by Z Smith for Thaden School that convened a broad spectrum of school and community stakeholders; BOTTOM: Principal Jack Sawyer working with Trinity School students on ideas for their new Commons.

Integrated & Sustainable Design

Sustainability is woven into our design process, extending beyond environmental concerns to encompass social, economic, and equitable dimensions. This ensures our interventions are resilient, adaptive, and serve as beacons of responsible architecture. Each project begins with a thorough site & climate analysis, focusing on energy and water use, occupant health, and community wellbeing. We assess material choices, daylighting strategies, and carbon emissions to ensure positive contributions to ecosystems and urban landscapes, among other interventions and practices.

Resilience is central to our sustainability approach, especially in New Orleans, where we've pioneered innovative stormwater solutions. Before it became a city mandate, we specified permeable pavement in parking lots, allowing 90% of stormwater to be managed onsite at the New Orleans BioInnovation Center. Our decisions often transition from "novel" to "policy."

Engaging Voices, Building Consensus

Our familiarity working with the oversight committees mentioned above ensures projects progress smoothly through regulatory review. We simultaneously manage a project schedule that balances design milestones with timely owner review: driving the project forward together. Design is a process we do with you, not for you.

We're skilled at drawing from a variety of stakeholders a vision of where you're going, bringing an understanding of how institutions move through time. Conversations aimed at energizing an existing campus—how you change it, adapt it, make it vital—are structured to draw out a vision that goes beyond this project in isolation. We're committed to convening the necessary stakeholders and facilitating a process that builds consensus. We strive to empower our leaders on the client side to be clear and concise with individual stakeholders to ensure that presence and consensus are present—maintaining momentum. Projects can veer off track when critical voices aren't in the room during critical decisions.

Our firm has a strong track record of delivering complex, challenging projects that have been driven by aggressive, non-negotiable schedules. By establishing a clear schedule at the beginning of the project, all critical delivery dates, decision points and review schedules are set. All parties on the design team, as well as all project stakeholders, know what will be required to make the project happen.



New Orleans BioInnovation Center, New Orleans, LA

A. Projects with Similar Scope



Louisiana State University Library

Baton Rouge, Louisiana

Set at the heart of campus, the new LSU Library will serve as a vibrant academic and social anchor—connecting students, faculty, and disciplines across a dynamic, future-ready environment.

Set at the nexus of the historic Quad and the emerging South Campus Academic Core, the new LSU Library will serve as a vibrant academic and social anchor—uniting diverse users through inclusive, flexible, and future-ready spaces. In alignment with university design guidelines, the library promotes sustainable design, supports academic and social activity, and fosters pedestrian-friendly connections that bridge expansive campus zones.

Designed to empower student success and interdisciplinary collaboration, the library will offer next-generation learning environments, technology-rich resources, and informal gathering areas that encourage interaction, recreation, and intellectual growth. As a key link between LSU's academic legacy and forward-looking vision, the new library enriches the full academic journey while contributing to the vitality of campus life.

PROJECT SIZE
298,300 SF

YEAR COMPLETED
Estimated completion
by 2028

CONSTRUCTION COST
\$120M

TEAM MEMBERS
Steve Dumez, is serving as
Principal-in-Charge.

Mark Hash, is serving as
Project Manager, overseeing
daily coordination.

Mike Johnson, is serving as
Project Architect.





Rosa F. Keller Library & Community Center

New Orleans, LA

In the heart of Broadmoor, the Rosa F. Keller Library and Community Center is a dual-purpose facility that honors history while championing resilience—combining a restored 1917 home with a new library wing to serve the community’s educational and social needs.

This 10,000 SF FEMA-funded project blends preservation and innovation, transforming a historic residence into a vibrant community center and adding a new, light-filled library wing. A glazed lobby connects the two structures, linking old and new while allowing each to function independently or as a unified whole. At the heart of the library is a landscaped courtyard that anchors the reading rooms, book stacks, and children's area—fostering quiet retreat and natural daylight throughout the space.

The project is LEED-certified, integrating high-efficiency systems and stormwater management strategies that capture nearly all runoff on-site. With its sustainable design and thoughtful programming, the Rosa F. Keller Library and Community Center stands as a symbol of Broadmoor’s recovery and a model for community-centered resilience in New Orleans.

PROJECT SIZE
10,000 SF

YEAR COMPLETED
2012

CONSTRUCTION COST
\$5.08M

TEAM MEMBERS
Steve Dumez, served as the Design Architect.





Howard Tilton Memorial Library at Tulane University

New Orleans, Louisiana

The Howard Tilton Memorial Library expansion transforms the building by elevating critical functions and optimizing space, creating a resilient, modern facility while preserving continuous access to its collections.

The Howard-Tilton Memorial Library at Tulane University's main campus was flooded during Hurricane Katrina in 2005. Following a feasibility study by the University and FEMA, a vertical expansion was identified as the most appropriate hazard mitigation solution for relocating mechanical equipment and stacks previously stored in the flooded basement. The building's structural capacity, designed to accommodate up to four additional floors, made this approach feasible.

The project involved adding two floors to the existing four-story concrete structure built in 1969. The design team collaborated with the University and library staff to optimize program space within the constraints of the replacement square footage while taking advantage of rare views offered by the new floors. The phased renovation ensured continuous library operations and access to collections during the two-year construction period. The project also included new mechanical and electrical systems serving the entire 240,000 SF facility.

PROJECT SIZE
196,000 SF

YEAR COMPLETED
2015

CONSTRUCTION COST
\$24M

TEAM MEMBERS
Christian Rodriguez, served as the Project Architect.
Steve Dumez, served as the Director of Design.
Z Smith, served on the Project Team.



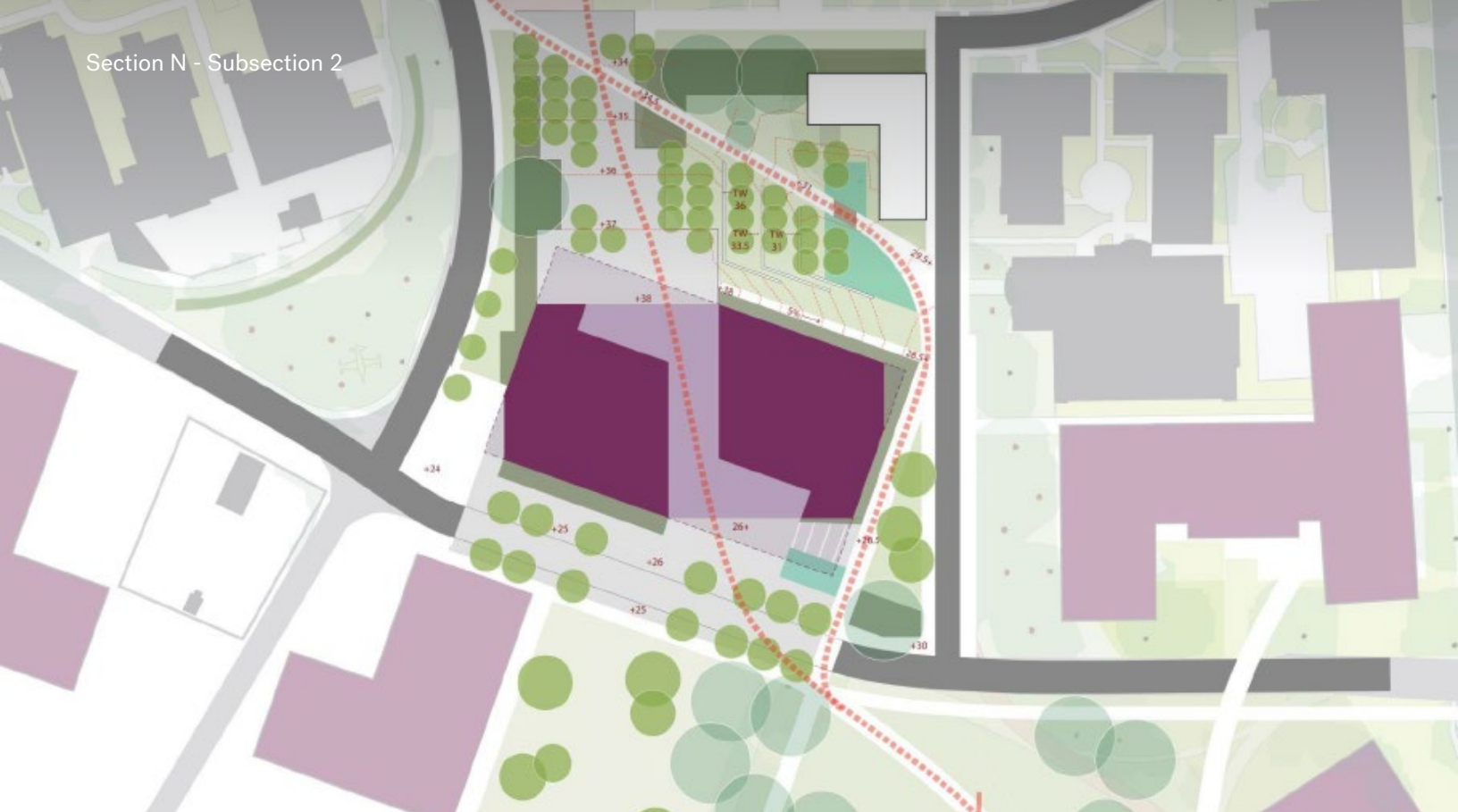

Library Planning & Programming Study at Louisiana State University

Baton Rouge, Louisiana

This comprehensive planning and programming study lays the groundwork for LSU’s future Library—establishing the vision, scale, and strategy for a transformative academic hub.

Through deep engagement with students, faculty, and university leadership, the study identifies evolving campus needs and opportunities to centralize key academic services under one roof. At its core, the proposed Learning Commons is designed to foster collaboration, inclusion, and innovation—serving as both a welcoming space for individual study and a dynamic environment for shared learning.

The study recommended a 298,000 GSF facility anchored by more than 3,500 study seats, integrated partner suites for advising and student success, adaptable learning spaces, and next-generation infrastructure such as an Automated Storage and Retrieval System (ASRS) to manage collections. With a phased development strategy—beginning with a 198,000 GSF first phase—the plan balances long-term goals with near-term implementation. Positioned between the historic campus core and the emerging South Campus Academic Core, the future Library Learning Commons is envisioned as a new academic heart for LSU and a driver of institutional excellence.

PROJECT SIZE
298,000 SF

YEAR COMPLETED
2022

CONSTRUCTION COST
N/A

TEAM MEMBERS
Steve Dumez, served as the Principal-in-Charge.
Z Smith, served on the Project Team.

Program Need, Phase One, and Delta

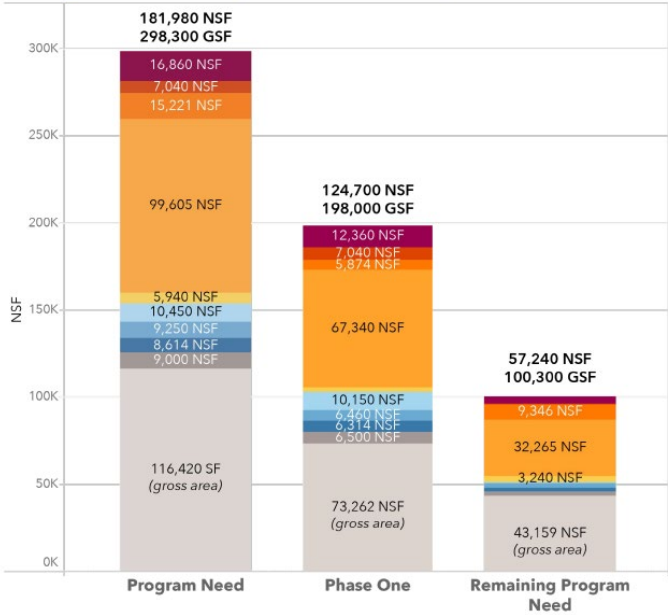

Program Needs

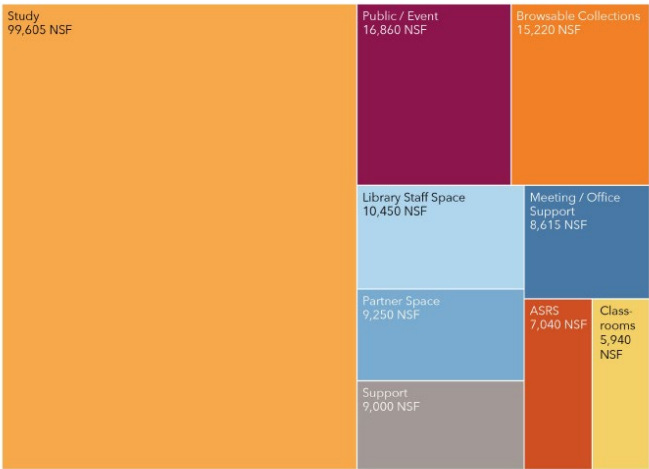

Conceptual Partner Space Organization Model

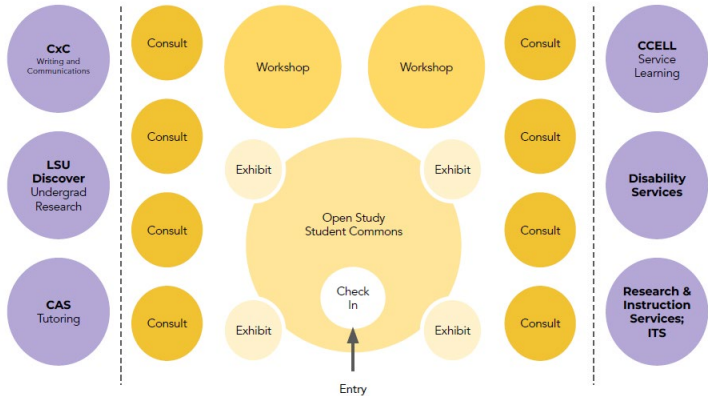

Library Learning Commons Student Study Seats By Seat Type

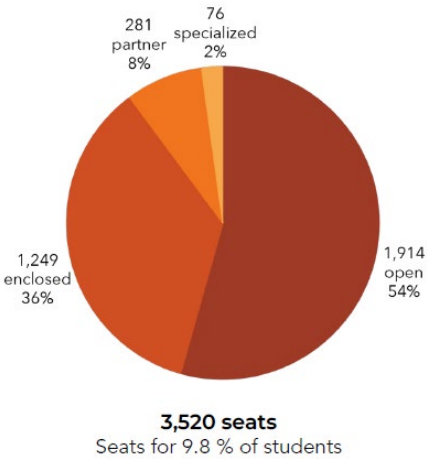

Library Staff Workspace Needs

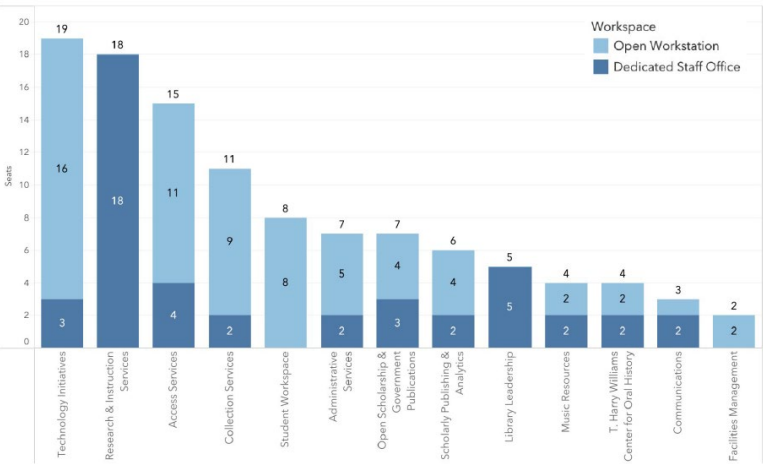

Library Learning Commons Student Seats Including Classrooms and Event Seats

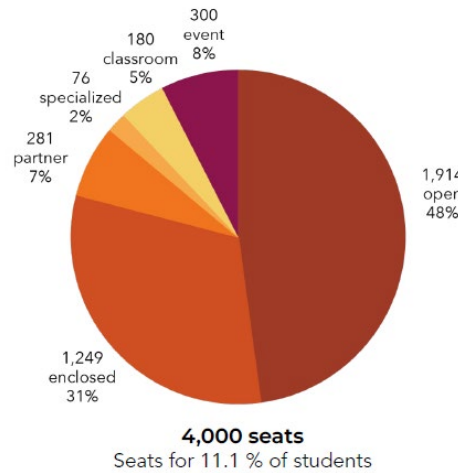



The Shop at the Contemporary Arts Center

New Orleans, Louisiana

The Shop is a comprehensive coworking development at the Contemporary Arts Center (CAC). Targeting technology, arts, and cultural-based businesses, The Shop serves as a hub of entrepreneurship in the developing downtown innovation corridor.

The project occupies the third and fourth floors of the CAC—connecting the two floors with an open architectural staircase—and features an extensive amenity and commons area, varied meeting and office space, and a roof deck. This renovation preserves the classic Warehouse District architecture of the existing building while incorporating modern elements. The light-filled space features high ceilings with exposed beams, large windows, a contemporary art collection, and a flowing, open floor plan.

The heart of The Shop is the commons area designed to facilitate conversation and connection. It boasts a full kitchen, seating options, coffee station, snacks available for purchase, and communal and recreational space. All of The Shop's amenities offer small businesses, entrepreneurs, and arts-based professionals the resources they need to grow.

PROJECT SIZE
37,448 SF

YEAR COMPLETED
2017

CONSTRUCTION COST
\$8.9M

TEAM MEMBERS
Jill Traylor, served as Principal Interior Designer.

Steve Dumez, served as Principal-in-Charge.

Section N - Subsection 2

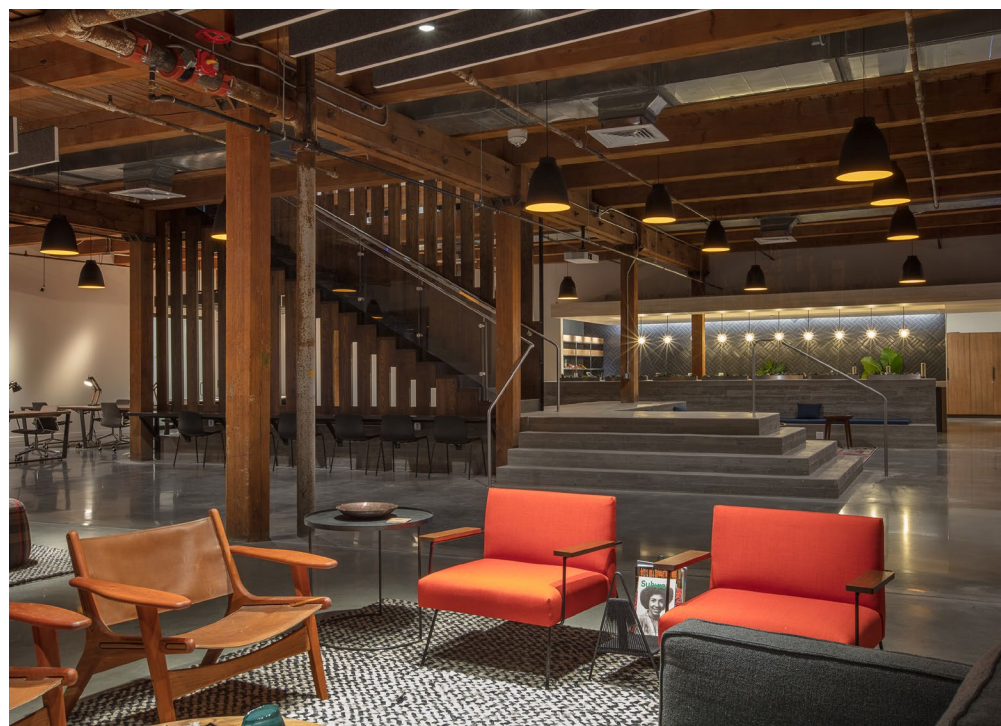



Small Family Collaboration Hub at Tulane University

New Orleans, Louisiana

A welcoming academic commons at Tulane University, the Small Family Collaboration Hub fosters student connection and collaboration through flexible interiors, natural light, and a warm, residential design language.

Located within an existing academic building on Tulane's campus, the Small Family Collaboration Hub transforms a once-underutilized space into a vibrant learning environment centered on student engagement. The renovation introduces a mix of open study areas, enclosed meeting rooms, and soft seating zones to support both group work and quiet reflection.

Designed to feel comfortable and inviting, the interiors feature natural materials, warm lighting, and informal furnishings that promote relaxation and community. Large windows bring daylight deep into the space, while careful acoustic planning ensures a variety of working environments. As a key campus destination, the Hub serves as a model for student-focused design—one that blends function, flexibility, and a strong sense of belonging.

PROJECT SIZE
14,000 SF

YEAR COMPLETED
2023

CONSTRUCTION COST
\$3.79M

TEAM MEMBERS
Jill Traylor, served as Principal Interior Designer.
Steve Dumez, served as Principal-in-Charge.
Z Smith, served as Director of Sustainability.
Mike Johnson, served on Project Team.

Section N - Subsection 2





Home Building at Thaden School

Bentonville, AR

A flexible, light-filled learning hub, the Home Building at Thaden School brings students together across disciplines, acting as both an academic commons and a central gathering place on campus.

As a cornerstone of Thaden School’s “learning by doing” curriculum, the Home Building is more than a classroom—it is a dynamic academic environment designed to support research, project-based work, and collaborative exploration. While originally conceived to support the school’s “Meals” strand, the building now serves a much broader purpose across the full curriculum. With its seminar-style classrooms, informal learning zones, and flexible gathering spaces, it provides a setting where students can investigate complex ideas, develop critical thinking skills, and engage in interdisciplinary learning.

Located along the public-facing edge of campus, the Home Building welcomes interaction and connection, acting as both a campus gateway and a social-academic commons. Its open porches and generous windows blur the boundary between indoor and outdoor learning, while daylit interiors and shared seating areas offer a variety of settings for reading, discussion, and reflection. Like a modern interpretation of a library, the Home Building encourages knowledge exchange, peer collaboration, and self-directed discovery—supporting the intellectual and personal growth of Thaden students.

PROJECT SIZE
34,686 SF

YEAR COMPLETED
2019

CONSTRUCTION COST
\$9.7M

TEAM MEMBERS
Christian Rodriguez, served as Project Architect.

Steve Dumez, served as Principal-in-Charge.

Z Smith, served as Director of Sustainability & Building Performance.

Mike Johnson, served on the Project Team.

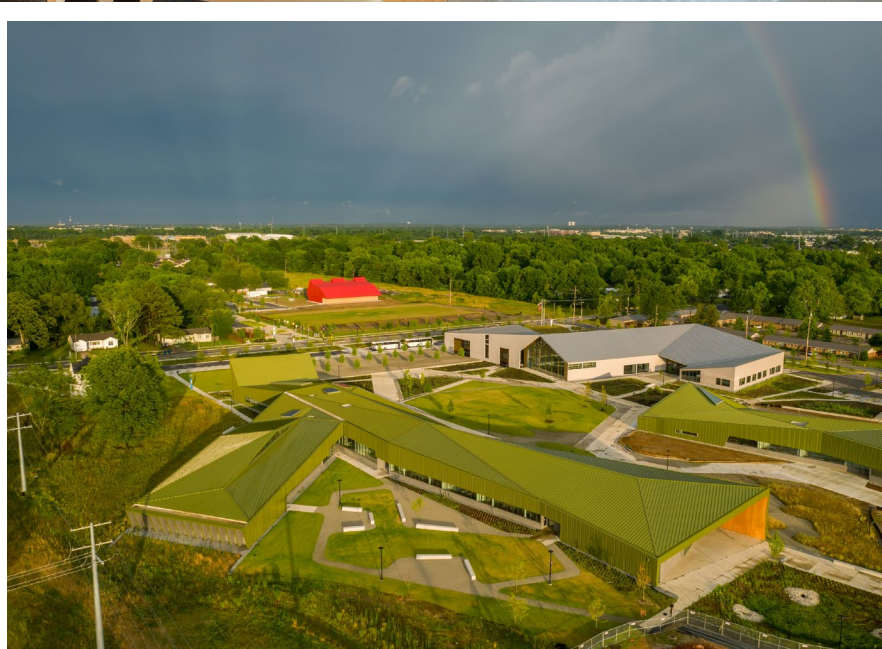



Olin and Uris Library Study at Cornell University

Ithaca, NY

A transformative feasibility study reimagines Cornell's Olin and Uris Libraries as more connected, inclusive, and adaptable spaces—aligned with the evolving needs of the academic community.

Cornell University, in partnership with brightspot and EskewDumezRipple, conducted a comprehensive feasibility and programming study to re-envision the future of Olin and Uris Libraries. Through extensive community engagement—including interviews, visioning sessions, and feedback forums—the team explored how these iconic buildings could evolve to better support research, learning, and student life. The study emphasizes accessibility, adaptability, and connectivity, both between the two libraries and with the broader campus. It outlines spatial strategies to expand user space by 43%, consolidate staff functions, integrate services, and support flexible partnerships. Conceptual design interventions propose enhanced entries, improved circulation, and new hubs for collaboration and scholarship. The final report includes a phased implementation plan and cost estimates across 11 capital projects, offering a clear roadmap for revitalizing these central resources in alignment with Cornell University Library's strategic goals.

PROJECT SIZE
670,000 SF

YEAR COMPLETED
2019

CONSTRUCTION COST
N/A

TEAM MEMBERS
Z Smith served as Principal-in-Charge.

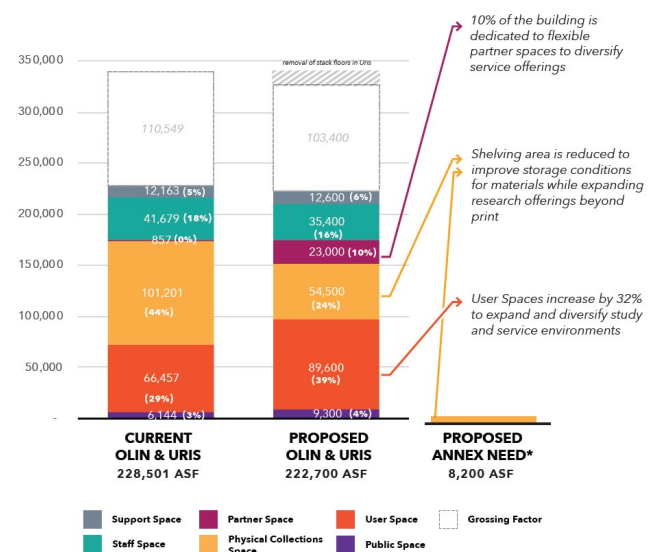
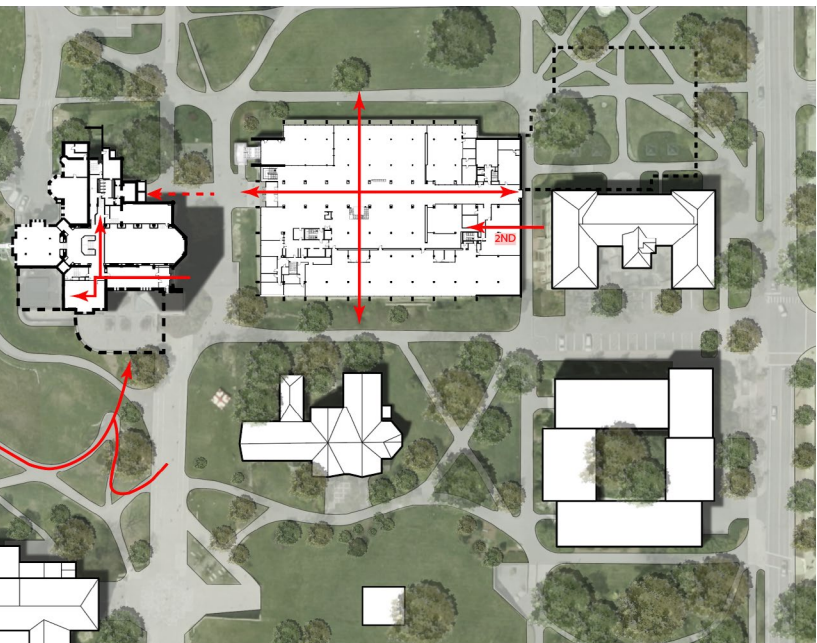

*The space need calculation for the Annex assumes a relocation of 1,291,000 volumes at 18.5 volumes per ASF. This is an estimate, further study of the space needs for the Annex is beyond the scope of this project.

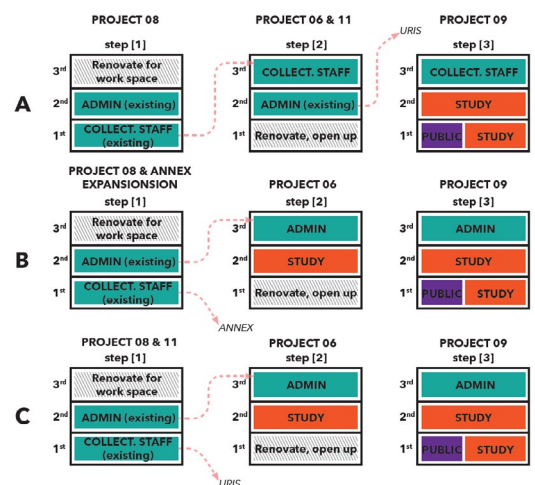

B. Errors & Omissions

Our team is committed to maintaining a high standard of design and responsibility throughout all phases of a project. In terms of design errors, we implement a thorough review process that includes multiple checks at key stages, ensuring accuracy and minimizing the likelihood of mistakes. We pride ourselves on this system, and our philosophy of design excellence is evident in each step of the design journey, both within the studio setting and in the documents we produce.

If an error occurs, we promptly address it through corrective measures, working collaboratively with the client, consultants, and stakeholders to minimize the impact on the project's budget or schedule.

For design omissions, we ensure that all project requirements are thoroughly understood and communicated from the outset. We proactively engage with stakeholders to confirm all details are included in the design, reducing the risk of omissions and working toward a level of understanding that mitigates risks like this. If an omission is identified, we work swiftly to rectify it, always keeping the project's overall goals and budget in mind. Our commitment to transparency, communication, and accountability allows us to resolve any issues quickly and maintain a high level of trust with our clients.

C. Professional References



Reference 1: LSU Library

Danny Mahaffey
Asst. VP and University Architect,
Facility and Property Oversight at LSU
dmahaf1@lsu.edu
225.578.2264



Reference 2: Home Building at Thaden School

Dr. Clayton Marsh
Former Founding Head of School at Thaden School
claytonkmarsh@gmail.com
479.268.5321



Reference 3: Rosa F. Keller Library and Community Center

Sharon Kohl
Branch Director at Rosa F. Keller Library and Community Center
skohl@neworleanspubliclibrary.org



Reference 4: The Shop at the Contemporary Arts Center

Chris Papamichael
Principal at Domain Companies
cpapamichael@thedomaincos.com
504.301.0014



Reference 5: Howard Tilton Memorial Library at Tulane University

Andy Corrigan
Vice Dean of Libraries at Tulane University
andyc@tulane.edu
504.865.5131

Subsection 3: Current Workload

EskewDumezRipple is well-equipped to undertake and successfully complete the work required for the project while maintaining the high standards of quality and professionalism that have defined our firm. With extensive experience in managing a diverse range of projects, our team is accustomed to balancing multiple high-priority initiatives simultaneously. We employ a collaborative, efficient approach to project management, ensuring that resources are allocated effectively across all current and future commitments. Our proven ability to deliver complex projects on time and within budget underscores our capacity to successfully handle additional work without compromising on quality.

In addition to our project management strengths, our firm's in-house team is supported by an extensive network of trusted consultants and partners. This allows us to scale resources as needed to meet project demands, ensuring that each phase of the project is completed seamlessly and without delay. We are committed to maintaining clear communication with clients and stakeholders, providing regular updates on progress and proactively addressing any challenges. This strategic approach guarantees that the work required for the new library will be executed efficiently, with the necessary expertise and attention to detail, while maintaining a focus on the firm's other ongoing projects.

Subsection 4: Firm Size Relative to Magnitude of Work

EskewDumezRipple has a team of 56 highly skilled professionals, ensuring that we have the staffing capacity to successfully complete the West Bank Regional Library project in a timely and professional manner.

Our team is organized into specialized design studios, each focused on specific project types, allowing us to efficiently allocate resources based on project needs. With a broad range of expertise and experience and a well-known reputation to manage projects well, we are well-equipped to handle complex projects while maintaining the quality and attention to detail we are known for.

Additionally, our organizational structure and robust internal processes allow for the seamless coordination of resources across multiple projects. We can scale efforts up or down as needed, ensuring that the Library project receives the necessary attention without compromising our commitment to other ongoing projects. Our access to state-of-the-art technology, collaborative tools, and trusted external partners further strengthens our ability to meet deadlines and deliver high-quality results across all aspects of the project.

Subsection 5: Responsiveness to Scope of Work

EskewDumezRipple's proposal for the West Bank Regional Library project is designed to ensure that all tasks outlined in the work scope are completed efficiently and effectively within a realistic schedule. Our approach integrates thorough planning and a clear project timeline that aligns with critical milestones and decision points, ensuring that we remain on track throughout the design and construction phases. We have strategically allocated the right team members to oversee key aspects of the project, from programming to design development to preconstruction and construction management, ensuring expertise is applied to every phase.

To achieve the objectives of the scope, we have carefully assessed the project's requirements and have proposed a realistic schedule that accounts for potential challenges while maintaining momentum. Our established processes for monitoring and controlling both budget and schedule, coupled with our use of advanced technology and collaboration tools, will allow us to make real-time adjustments as needed. This ensures that any unforeseen issues are addressed promptly without compromising the project's overall goals or timeline. By leveraging our extensive experience and coordinated team efforts, we are confident in our ability to meet all objectives within the proposed time frame.

Subsection 6: Other

Our Commitment to Inclusive Partnerships

Our team is committed to fostering diversity, equity, and inclusion through meaningful partnerships with women- and minority-owned businesses. For this project, we are proud to collaborate with two highly qualified firms who meet these qualifications, **Batture LLC** and **Marais Consultants**, whose expertise and certifications align with our shared values and contribute to the project's success.

By partnering with these exceptional firms, we demonstrate our dedication to promoting opportunities for historically underrepresented groups in the professional services industry.



Batture LLC, serving as both Structural Engineer and Landscape Architect, is certified as a Disadvantaged Business Enterprise (DBE) through the Louisiana Unified Certification Program and as a Small Entrepreneurship under the Louisiana Economic Development Hudson Initiative (No. 12964).



Marais Consultants, a Civil Engineering and Water Management firm, brings additional strength to our team as a certified Woman-Owned Small Business (WOSB) and a Women's Business Enterprise (WBE). Marais is also recognized as a Small Entrepreneurship under the Hudson Initiative and a DBE in Louisiana.



Subsection 6: Other

TEC Questionnaires for Consultants

All completed TEC Questionnaires are included on the following pages.

TEC Professional Services Questionnaire**A. Project Name and Advertisement Resolution Number:**

Jefferson Parish New West Bank Regional Library, RFQ Number: 25-015

B. Firm Name & Address:

Salas O'Brien LLC
 541 Julia St.
 Suite 200
 New Orleans, LA 70130

**C. Name, title and contact information of Principal, as defined in Section 2-926 of the Jefferson Parish Code of Ordinances, who is a registered, licensed architect, professional engineer, or surveyor in the State of Louisiana:**

David Bonaventure, PE, CEM
 Managing Principal
 E | david.bonaventure@salasobrien.com
 P | 225.372.6961

D. Name and contact information of employee who is a registered and licensed architect, professional engineer, or surveyor in the State of Louisiana in the applicable discipline. A subcontractor may be substituted here only if the advertised Project requires more than one discipline.

David Bonaventure, PE, CEM, Principal
 E | david.bonaventure@salasobrien.com
 P | 225.372.6961

E. Please provide the number of employees whose primary function corresponds with each category:

<u>2</u> Administrative	<u> </u> Estimators	<u>1</u> Specification Writers
<u> </u> Architects (Licensed)	<u> </u> Geologists	<u> </u> Structural Engineers
<u> </u> Chemical Engineers	<u> </u> Geotechnical Engineers	<u>1</u> Graduate Engineers
<u> </u> Civil Engineers	<u> </u> Interior Designers	<u>1</u> Project Managers
<u> </u> Construction Inspectors	<u> </u> Landscape Architects	<u> </u> Clerical
<u> </u> Ecologists	<u> </u> Land Surveyor	<u> </u> Grant/Funding Specialist
<u>4</u> Electrical Engineers	<u>7</u> Mechanical Engineers	<u> </u> Sanitary Engineers
<u>5</u> Engineer Intern	<u> </u> Environmental Engineers	<u>25</u> Other
<u> </u> Professional Land Surveyors		<u>46</u> TOTAL

F. Is this submittal by a JOINT-VENTURE? Please check: YES ☐ NO ☒**If marked "No" skip to Section I. If marked "yes" complete Sections G-H.**

TEC Professional Services Questionnaire

G. If submittal is by JOINT-VENTURE, list the firms participating and outline specific areas of responsibility (including administrative, technical, and financial) for each firm. Please attach additional pages if necessary.

1.

2.

H. Has this JOINT-VENTURE previously worked together? Please check:
 YES ☐ NO ☐

I. List all subcontractors anticipated for this Project. Please note that all subcontractors must submit a fully completed copy of this questionnaire, applicable licenses, and any other information required by the advertisement. See Jefferson Parish Code of Ordinances, Sec. 2-928(a)(3). Please attach additional pages if necessary.

Name & Address:	Specialty:	Worked with Firm Before (Yes or No):
1. Salas O'Brien LLC 541 Julia St. Suite 200 New Orleans, LA 70130	Mechanical, Electrical, Plumbing, and Technology Design	Yes
2.		
3.		

J. Please specify the total number of support personnel that may assist in the completion of this Project:

TEC Professional Services Questionnaire

K. List the professional in charge, key persons, specialists, and individual consultants anticipated for this Project and provide their relevant information below. If necessary, please attach additional documentation (i.e. resume) that demonstrates the employment history and experience of the Firm's key persons that may assist in the completion of this Project. Please attach additional pages if necessary.

PROFESSIONAL IN CHARGE OF PROJECT:

Name & Title:

David Bonaventure, PE, CEM
Managing Principal - Director of Baton Rouge and New Orleans Offices

Project Assignment:

Principal in Charge

Name of Firm with which associated:

Salas O'Brien, LLC

Years' experience with this Firm:

25 Years

Education: Degree(s)/Year/Specialization:

Master of Business Administration, University of Houston (2003); Bachelor of Science, Mechanical Engineering, Louisiana State University (1999)

Active registration: Year first registered/discipline:

PE, LA #: 0031064
First Issued: 2004

Other experience and qualifications relevant to the proposed Project:



David joined Salas O'Brien in 2000 and is a Managing Principal of the southern region offices, leading a team of over 45 engineering and technical staff in Louisiana. He is a professional mechanical engineer with experience in management, design, and specifications of both large and small projects. As a Certified Energy Manager (CEM) for over a decade, David is dedicated to advancing energy-efficient practices.

TEC Professional Services Questionnaire**KEY PERSON, SPECIALIST, OR INDIVIDUAL CONSULTANT:****Name & Title:**

Joe Starring, PE
Project Manager

Project Assignment:

Project Manager - Mechanical Engineering

Name of Firm with which associated:

Salas O'Brien, LLC

Years' experience with this Firm:

2 Years

Education: Degree(s)/Year/Specialization:

Bachelor of Science, Mechanical Engineering, Louisiana State University (2014)

Active registration: Year first registered/discipline:

PE, LA #: 43014
First Issued: 2018

Other experience and qualifications relevant to the proposed Project:

Joe Starring has recently joined Salas O'Brien as an experienced mechanical engineer with over 11 years in designing mechanical and plumbing systems. He has completed several large-scale projects in hospitality and education. Joe manages a multi-discipline team, ensuring clear communication between clients and the design team. With a commitment to high standards, he excels in solving complex engineering problems and delivering quality results.

TEC Professional Services Questionnaire**KEY PERSON, SPECIALIST, OR INDIVIDUAL CONSULTANT:****Name & Title:**

Jacob Truax, PE
Senior Vice President, Project Manager

Project Assignment:

Project Manager
Electrical - Professional Engineer

Name of Firm with which associated:

Salas O'Brien, LLC

Years' experience with this Firm:

16 Years

Education: Degree(s)/Year/Specialization:

Bachelor of Science, Electrical Engineering, Louisiana State University
(2010)

Active registration: Year first registered/discipline:

PE, LA #0040358
First Issued : 2015

Other experience and qualifications relevant to the proposed Project:

Jacob joined Salas O'Brien in 2008 as an intern electrical engineer until he became a graduate electrical engineer in 2010. He then spent a little less than a year working as an electrical engineer for the Department of Energy in the Oak Ridge National Lab in Tennessee before eventually moving back to Baton Rouge and working for an industrial Engineering firm in the oil and gas industry. In July 2013, he returned to Salas O'Brien as an electrical engineer and project manager. He has designed, managed, and checked a variety of projects from commercial, retail, government facilities, industrial plant expansions as well as major retail developments and apartments/residential developments.

TEC Professional Services Questionnaire

KEY PERSON, SPECIALIST, OR INDIVIDUAL CONSULTANT:	
Name & Title:	
Diego Solorio, RCDD, CTS Associate Vice President, Director of Technology	
Project Assignment:	
Technology Design	
Name of Firm with which associated:	
Salas O'Brien, LLC	
Years' experience with this Firm:	
31 Years	
Education: Degree(s)/Year/Specialization:	
Certifications: BICSI Registered Communications Distribution Designer, AVIXA Certified Technology Specialist, NICET Certified Engineering Technologist Fire Alarm Level II, ASIS Physical Security Professional	
Active registration: Year first registered/discipline:	
Other experience and qualifications relevant to the proposed Project:	
	Diego has over 31 years of experience as a technology project manager. He provides successful solutions in the communications, electronic safety, and security field. His roles include project manager for projects large and small, coordinating with subcontractors, monitored on-site progress and performance, provided expertise of divisions 27 & 28 in meetings with owners, and general contractors. His experience ranges from K-12, higher education, multifamily, healthcare, government, commercial, and aviation projects.

TEC Professional Services Questionnaire

L. Work by Firm or Joint-Venture members which best illustrates current qualifications relevant to this Project. Please include any and all work performed for Jefferson Parish. Please attach additional pages if necessary.

PROJECT NO. 1

Project Name, Location and Owner's contact information:	Nature of Firm's Responsibility:	
LSU Library Site Strategic Capitol Plan <i>Baton Rouge, LA</i> (Worked for Architect) Forte and Tablada, Inc. Boyd Holmes bholmes@forteandtablada.com	Salas O'Brien provided the mechanical, electrical and plumbing services for the demolition of (5) existing buildings, relocation of all utilities under the future site of the library and the extension of major chilled water infrastructure.	
Completion Date (Actual or estimated):	Estimated Cost: Fee: \$244,400	
	Entire Project:	Work for which Firm was Responsible:
2024	\$11,360,000.00	Mechanical, Electrical, and Plumbing Engineering Services

PROJECT NO. 2

Project Name, Location and Owner's contact information:	Nature of Firm's Responsibility:	
Tioga Library Addition <i>Ball, LA</i> (Worked for Architect) Alliance Design Group Adam Grunzinger adamg@adgllc.net	Salas O'Brien provided mechanical, electrical and plumbing design for the 3200 sf addition to the Tioga Library in Rapides Parish. Also included was a lighting replacement to the existing building.	
Completion Date (Actual or estimated):	Estimated Cost: Fee: \$10,000	
	Entire Project:	Work for which Firm was Responsible:
2017	N/A	Mechanical, Electrical and Plumbing Engineering services

TEC Professional Services Questionnaire

PROJECT NO. 3		
Project Name, Location and Owner's contact information:	Nature of Firm's Responsibility	
Libuse Library <i>Pineville, LA</i> (Worked for Architect) Alliance Design Group Adam Grunzinger adamg@adgllc.net	Salas O'Brien provided mechanical, electrical and plumbing design for the new 6500 sf Libuse Library for Rapides Parish.	
Completion Date (Actual or estimated)	Estimated Cost: Fee: \$15,000	
	Entire Project:	Work for which Firm was Responsible:
06/2018	N/A	Mechanical, Electrical and Plumbing Engineering services

PROJECT NO. 4		
Project Name, Location and Owner's contact information:	Nature of Firm's Responsibility:	
Cameron Parish - Johnson Bayou Library <i>Cameron, LA</i> (Worked for Architect) Porche May Architects Derek Porche 404.980.0020	Salas O'Brien provided mechanical, electrical and plumbing consulting engineering for hurricane repairs.	
Completion Date (Actual or estimated):	Estimated Cost: Fee: \$4,500	
	Entire Project:	Work for which Firm was Responsible:
02/2022	N/A	Mechanical, Electrical and Plumbing Engineering services

TEC Professional Services Questionnaire**A. Project Name and Advertisement Resolution Number:**

Provide Professional Architectural and Engineering Services to Design and Construct the New West Bank Regional Library
 SOQ Number: 25-015

B. Firm Name & Address:

Marais Consultants LLC
 2018 Jena Street
 New Orleans, LA 70115

C. Name, title and contact information of Principal, as defined in Section 2-926 of the Jefferson Parish Code of Ordinances, who is a registered, licensed architect, professional engineer, or surveyor in the State of Louisiana:

Jennifer Snape, PE
 Owner and Lead Designer
 Phone: 504.350.2644
 Email: jenny@maraisconsultants.com

D. Name and contact information of employee who is a registered and licensed architect, professional engineer, or surveyor in the State of Louisiana in the applicable discipline. A subcontractor may be substituted here only if the advertised Project requires more than one discipline.

Jennifer Snape, PE
 Owner and Lead Designer
 Phone: 504.350.2644
 Email: jenny@maraisconsultants.com

E. Please provide the number of employees whose primary function corresponds with each category:

<u>1</u> Administrative	<u> </u> Estimators	<u> </u> Specification Writers
<u> </u> Architects (Licensed)	<u> </u> Geologists	<u>1</u> Structural Engineers
<u> </u> Chemical Engineers	<u> </u> Geotechnical Engineers	<u>2</u> Graduate Engineers
<u>2</u> Civil Engineers	<u> </u> Interior Designers	<u> </u> Project Managers
<u> </u> Construction Inspectors	<u> </u> Landscape Architects	<u> </u> Clerical
<u> </u> Ecologists	<u> </u> Land Surveyor	<u> </u> Grant/Funding Specialist
<u> </u> Electrical Engineers	<u> </u> Mechanical Engineers	<u> </u> Sanitary Engineers
<u>3</u> Engineer Intern	<u> </u> Environmental Engineers	
<u> </u> Professional Land Surveyors		<u>9</u> TOTAL

F. Is this submittal by a JOINT-VENTURE? Please check: YES ☐ NO ☒

If marked "No" skip to Section I. If marked "yes" complete Sections G-H.

TEC Professional Services Questionnaire

G. If submittal is by JOINT-VENTURE, list the firms participating and outline specific areas of responsibility (including administrative, technical, and financial) for each firm. Please attach additional pages if necessary.

1.

N/A

2.

N/A

H. Has this JOINT-VENTURE previously worked together? Please check:

YES ☐ NO ☐

I. List all subcontractors anticipated for this Project. Please note that all subcontractors must submit a fully completed copy of this questionnaire, applicable licenses, and any other information required by the advertisement. See Jefferson Parish Code of Ordinances, Sec. 2-928(a)(3). Please attach additional pages if necessary.

Name & Address:	Specialty:	Worked with Firm Before (Yes or No):
1. N/A	N/A	N/A
2.		
3.		

J. Please specify the total number of support personnel that may assist in the completion of this Project:

9 _____

TEC Professional Services Questionnaire

K. List the professional in charge, key persons, specialists, and individual consultants anticipated for this Project and provide their relevant information below. If necessary, please attach additional documentation (i.e. resume) that demonstrates the employment history and experience of the Firm's key persons that may assist in the completion of this Project. Please attach additional pages if necessary.

PROFESSIONAL IN CHARGE OF PROJECT:**Name & Title:**

Jennifer Snape, PE
Owner and Lead Designer

Project Assignment:

Lead Engineer

Name of Firm with which associated:

Marais Consultants LLC

Years' experience with this Firm:

2.5 years

Education: Degree(s)/Year/Specialization:

Master's Certificate /2012/ Coastal Engineering
B.S./2004/Civil Engineering

Active registration: Year first registered/discipline:

2010/LA Civil Engineering PE # 35470
Also in CA, AL, FL, MS, MT, HI, CO
ASCE Sustainable Infrastructure Certificate

Other experience and qualifications relevant to the proposed Project:

Jennifer Snape, PE is owner and lead designer at Marais Consultants LLC and has 22 years of experience in the engineering field. She has a wide range of project experience including structural design for both residential and commercial structures for renovations and new construction; civil site design for sites ranging from less than an acre to over 1000 acres; hydrologic and hydraulic modeling; stormwater management plans for urban, rural, and coastal systems; environmental consulting and due diligence studies; sewer design; grading and drainage design; coastal erosion protection systems design; and permitting through federal, state, and local agencies. She has successfully managed and delivered projects for private and public clients, including the City of New Orleans, Sewerage & Water Board of New Orleans, Plaquemines Parish, St. Bernard Parish, St. Tammany Parish, and others. At Marais, she oversees, manages, and designs all engineering projects.

TEC Professional Services Questionnaire

KEY PERSON, SPECIALIST, OR INDIVIDUAL CONSULTANT:
Name & Title:
Trevor Paitz, PE Professional Engineer
Project Assignment:
Professional Engineer
Name of Firm with which associated:
Marais Consultants, LLC
Years' experience with this Firm:
1 year
Education: Degree(s)/Year/Specialization:
BS/ 2020/ Civil Engineering BS/ 2012/ Construction Management
Active registration: Year first registered/discipline:
2023/LA Civil Engineering PE #0048389
Other experience and qualifications relevant to the proposed Project:
Trevor Paitz, PE is a Structural Engineer at Marais Consultants, LLC. Mr. Paitz started his career in Construction Management working as a civil and structural field engineer and project engineer. To further his engineering knowledge, Trevor completed a Bachelor's degree in Civil and Environmental Engineering at the University of New Orleans. After graduation, Trevor worked as a Civil/Structural Engineer for 6 years with other local firms before joining Marais Consultants. In addition to his extensive experience in construction administration and management, Trevor has designed marine and commercial structures for renovations and new construction. At Marais, Trevor performs structural inspections and assessments for residential and commercial buildings including wind analysis for framing and foundations. He utilizes his project management skills for cost estimating and value engineering to ensure budget compliance and avoid unforeseen overages.

TEC Professional Services Questionnaire

KEY PERSON, SPECIALIST, OR INDIVIDUAL CONSULTANT:
Name & Title:
Jake Yemma, PE Professional Engineer
Project Assignment:
Professional Engineer
Name of Firm with which associated:
Marais Consultants LLC
Years' experience with this Firm:
1 year
Education: Degree(s)/Year/Specialization:
BS/ 2016/ Civil Engineering BS/ 2010/ Music Science and Technology
Active registration: Year first registered/discipline:
2023/LA Civil Engineering PE #0048432
Other experience and qualifications relevant to the proposed Project:
Jake Yemma, PE is a Civil Engineer at Marais Consultants, LLC with more than 10 years of experience. While in school, he interned for the Louisiana DOTD where he honed his skills in data collection and Arc GIS. He spent several years in New York working on private and public roadway and infrastructure projects and returned to New Orleans to work for the Louisiana DOTD as an EIT. Mr. Yemma has extensive experience with permitting, cost estimating, project management, roadway design, grading and drainage, traffic analysis and reporting, construction staging, inspection, and MPT, stormwater management, surveying, cost. He is also proficient in construction administration, including submittal and shop drawing reviews for residential and commercial projects.

TEC Professional Services Questionnaire

KEY PERSON, SPECIALIST, OR INDIVIDUAL CONSULTANT:
Name & Title:
Phil Aucoin, EI Project Designer
Project Assignment:
Structural Designer
Name of Firm with which associated:
Marais Consultants LLC
Years' experience with this Firm:
2 years
Education: Degree(s)/Year/Specialization:
BS/ 2015/ Civil Engineering
Active registration: Year first registered/discipline:
2016 / LA Civil Engineering EI #32861
Other experience and qualifications relevant to the proposed Project:
<p>Philip Aucoin, EI is a civil and structural designer at Marais specializing in residential and small to medium commercial projects. After graduating with a B.S. in Civil Engineering from LSU, he began working as a field engineer for a roadway and utility construction company. He has 9 years of experience in civil site design (including sewer and wastewater), roadway/parking lot design, and structural design for various projects throughout the Southeastern United States. Mr. Aucoin has worked directly with design engineers and inspectors on a variety of public and private projects. Some of these projects spanned across many years and cost \$10+ million to complete. At Marais, Mr. Aucoin assists with the preparation of civil and structural engineering drawings; prepares and modifies calculations and reports; conducts data research and field investigations; and coordinates with public and government agencies.</p>

TEC Professional Services Questionnaire

KEY PERSON, SPECIALIST, OR INDIVIDUAL CONSULTANT:
Name & Title:
Anne Gutierrez, EI Project Designer
Project Assignment:
Structural Designer
Name of Firm with which associated:
Marais Consultants LLC
Years' experience with this Firm:
1 year
Education: Degree(s)/Year/Specialization:
BS/ 2020/ Civil Engineering
Active registration: Year first registered/discipline:
2023/ FL Civil Engineering EI # 1100026549 2023/ Certificate of Training - Suspended Scaffold Competent Person 2023/ Remote (Drone) Pilot - Small Unmanned Aircraft Systems (UAS) #4926504
Other experience and qualifications relevant to the proposed Project:
<p>Anne Gutierrez, EI recently joined Marais as a Project Designer. Ms. Gutierrez completed her bachelor's degree in Civil Engineering at the University of Louisiana in Lafayette in 2020. Anne has extensive experience with structural design, forensic investigations and assessments, restoration and historic renovation, residential design, and construction administration. Following graduation, Anne worked with a small local structural engineering firm in Santa Rosa, Florida where she conducted residential inspections for hurricane damages homes and oversaw construction for home renovations. Anne continued gaining experience with a nationwide firm in Tampa where she performed structural design for small to medium residential and commercial buildings. She also applied her design skills to restorations of a large apartment complex and a hotel roof/envelope. At Marais, Anne is performing structural design for small to medium residential and commercial sites throughout southern Louisiana and is continuing to add to her impressive skill set as she works toward her Professional Engineer certification.</p>



TEC Professional Services Questionnaire

KEY PERSON, SPECIALIST, OR INDIVIDUAL CONSULTANT:
Name & Title:
Cleo Pappas, EI Project Designer
Project Assignment:
Structural Designer
Name of Firm with which associated:
Marais Consultants LLC
Years' experience with this Firm:
2 years
Education: Degree(s)/Year/Specialization:
BS/ 2021/ Civil Engineering Master's Certificate/ 2024/ Coastal Engineering
Active registration: Year first registered/discipline:
2021 / LA Civil Engineering EI #34841
Other experience and qualifications relevant to the proposed Project:
Cleo Pappas, EI is a Civil and Structural Designer at Marais Consultants LLC. In 2020, she worked as a student intern at a local engineering firm, and after graduating with a B.S. in Civil Engineering from LSU, she began working as an Engineer Intern full-time. While interning/working, she has gained experience and assisted in the design of stormwater management systems and civil design projects as well as hydrologic and hydraulic modeling in SWMM and HEC-RAS. She also assisted in the design of residential and commercial structures. Cleo has increased her experience in structural and civil calculations and is adept in the AutoCAD, ArcGIS, and RISA.

TEC Professional Services Questionnaire

KEY PERSON, SPECIALIST, OR INDIVIDUAL CONSULTANT:
Name & Title:
Alexander Vu Project Designer
Project Assignment:
Project Designer
Name of Firm with which associated:
Marais Consultants LLC
Years' experience with this Firm:
2 years
Education: Degree(s)/Year/Specialization:
BS/ 2021 / Civil Engineering
Active registration: Year first registered/discipline:
2021/ Procore Certified Project Manager 2021/ USACE Construction Quality Mgmt/ SE9-04-19-00231
Other experience and qualifications relevant to the proposed Project:
Alexander Vu is a civil and structural designer and project manager at Marais. He specializes in project management and estimating; site supervision; scheduling; quality control; project financials and budgets; value engineering; civil design; and structural design. He is experienced with ProCore, BIM360, Submittal Exchange, and AutoCAD/Civil 3D. Mr. Vu is a member of the American Concrete Institute (ACI), American Society of Civil Engineers (ASCE), and the Society of American Military Engineers (SAME). Alexander is a Procore Certified: Project Manager and is certified through the USACE: Construction Quality Management for Contractors (SE9-04-19-00231)

TEC Professional Services Questionnaire

L. Work by Firm or Joint-Venture members which best illustrates current qualifications relevant to this Project. Please include any and all work performed for Jefferson Parish. Please attach additional pages if necessary.

PROJECT NO. 1

Project Name, Location and Owner's contact information:	Nature of Firm's Responsibility:	
1450 L&A Road Office and Warehouse Renovations Metairie, LA Jefferson Parish Prime - RGND - A Palmisano Company Erin Comeaux 504.620.8022 ecomeaux@rngd.com	This project consists of renovating an existing approximately 70,000 SF office and warehouse facility located on an approximately 100,952 SF site into a new office and training facility for RNGD Headquarters. The site is located on L and A Road between McDermott Road and Hauser Road in Metairie. Office area to include approximately 30,000 SF of workspace to house +150 employees. Training center to include state of the art conference space, showroom, amenities, and training area. The project will be a collaborative process with RNGD Builders LLC in the lead though each team member will be accountable for direct communication with other team members to ensure both the design and construction schedules are met. Marais is providing civil engineering services for this project including a demolition plan, site plan, and utility plan.	
Completion Date (Actual or estimated):	Estimated Cost:	
	Entire Project:	Work for which Firm was Responsible:
Estimated 2024	\$25 mil	\$38,000

PROJECT NO. 2

Project Name, Location and Owner's contact information:	Nature of Firm's Responsibility:	
Adaptive Reuse for Co-working Office 519 Huey P. Long Ave. Gretna, LA Jefferson Parish Prime - Studio BKA Ben Allen, AIA 504.486.3272 ben@studiobka.com	This project consists of the adaptive reuse of an historic school building into a co-working space. The structure is 3 stories (approximately 18,650 sf) with brick masonry exterior walls and wood framing. The renovation will include minor modifications and repairs on the interior of the structure to support the new use. Our structural scope on this project includes: <ul style="list-style-type: none"> • Study of existing conditions including analysis of existing framing • Site visit to analyze historic masonry for repair • Design for removal of walls and repairs of masonry and wood structure • Assisting with design Documents for Public Bidding • Construction Administration 	
Completion Date (Actual or estimated):	Estimated Cost:	
	Entire Project:	Work for which Firm was Responsible:
Estimated 2025	N/A	\$13,000

TEC Professional Services Questionnaire

PROJECT NO. 3		
Project Name, Location and Owner's contact information:	Nature of Firm's Responsibility	
Harriet Tubman School Addition New Orleans, LA Prime - Mathes Brierre Architects Angela Morton 504.586.9303 amorton@mathesbrierre.com	Marais is providing structural design, civil design, and stormwater management solutions for a new building at the Harriet Tubman campus in New Orleans. The building, which will be modular and constructed offsite, is planned for an existing 96x160 parking lot. It will feature a site-fabricated truss roof, permanent site foundations, and a site-built entry deck/ramp. In addition to the building, the project includes the development of a new parking lot, a baseball diamond, and a soccer field on a large, vacant parcel nearby. We will produce SWMP drawings for permitting and develop a Stormwater Pollution Prevention Plan to meet stormwater management regulations. The civil design scope includes site grading and utility planning, while the structural design focuses on the foundation of the pre-fabricated building.	
Completion Date (Actual or estimated)	Estimated Cost:	
	Entire Project:	Work for which Firm was Responsible:
Estimated 2025	N/A	\$57,500

PROJECT NO. 4		
Project Name, Location and Owner's contact information:	Nature of Firm's Responsibility:	
Ninth Ward Stadium New Orleans, LA Orleans Parish School Board Prime - Williams Architects Andrew Stephens 504.566.0888 astephens@williamsarchitects.com	This new construction school sports facility will include an artificial turf football field, an 8-lane track with field events included, a grandstand seating 3,000 - 5,000 spectators plus a pressbox and scoreboard, restrooms, concessions and ticketing, parking and site amenities. Marais's scope of work consists of civil and structural design for the complete construction of the stadium facility. Site Improvements include stadium lighting, access drives and parking, entry plaza and ticket booth, and perimeter fencing. The design focuses on incorporating green infrastructure and a storm water retention system in the site design through pervious concrete, stormwater detention/native planting areas, pervious pavers, and stormwater bioswales. The site's infrastructure will include electric vehicle charging stations, bicycle parking, dark sky compliant LED lighting, water-efficient plumbing, and recycled field turf.	
Completion Date (Actual or estimated):	Estimated Cost:	
	Entire Project:	Work for which Firm was Responsible:
Estimated 2025	N/A	\$97,000

TEC Professional Services Questionnaire

PROJECT NO. 5		
Project Name, Location and Owner's contact information:	Nature of Firm's Responsibility:	
St. George's Episcopal Hall Porteous Hall and Library Renovation 923 Napoleon Ave. New Orleans, LA 70115 Prime - Studio West Jason Richards 504.380.9880 jason@studiowest.design	Marais is providing structural engineering for renovations to Porteous Hall, a historic building housing offices, a library, and classrooms for St. George's Episcopal School in New Orleans. Originally constructed in 1875 as McDonogh No. 6 Public School, this building was designed by William A. Freret and built by James Cox. As the first black public school built in New Orleans during Reconstruction, it holds significant educational and historical importance.	
Completion Date (Actual or estimated):	Estimated Cost:	
	Entire Project:	Work for which Firm was Responsible:
Estimated 2025	N/A	\$3,000

PROJECT NO. 6		
Project Name, Location and Owner's contact information:	Nature of Firm's Responsibility:	
SUNO Cafeteria and Office Design New Orleans, LA Office of Facility Planning and Control Prime - Bell Butler Design & Architecture Lindsay Butler, AIA 504.754.1118 lindsay@bell-butler.com	Marais is providing civil and structural design for this project involving construction of a new one-story cafeteria at the Southern University of New Orleans campus. The existing cafeteria will be demolished to make way for the new building, which will include a dining room, kitchen, storage rooms, walk-in cooler and freezer, staff offices, restrooms, mechanical rooms, electrical rooms, corridors, and other necessary spaces. The project also includes modifications to site features, parking, pavement, and sidewalks. Coordination with external vendors for kitchen equipment is essential to ensure seamless integration of utilities and mechanical connections. The scope of the proposal covers design services up to the construction documents phase, excluding bidding or construction administration. Drainage design will comply with the campus stormwater master plan.	
Completion Date (Actual or estimated):	Estimated Cost:	
	Entire Project:	Work for which Firm was Responsible:
Estimated 2025	N/A	\$37,000

TEC Professional Services Questionnaire

PROJECT NO. 7		
Project Name, Location and Owner's contact information:	Nature of Firm's Responsibility:	
Lincoln Beach Redevelopment Master Plan New Orleans, LA City of New Orleans Prime - Sasaki Joshua Brooks, PE 720.776.4675 jbrooks@sasaki.com	Lincoln Beach is an approximately 15-acre property located on the shore of Lake Pontchartrain bordered on the southeast by a railroad track, flood protection levee, and a large roadway. It was established along the shores of the Lake in 1939 as a recreational area for the city's African American population and managed by the City of New Orleans until its closing in 1964. Since then, the structures and facilities at Lincoln Beach have gradually deteriorated over time due to lack of maintenance and a barrage of hurricane impacts, causing unsafe conditions at the site. The master planning process will facilitate additional public input and engage residents in formulating and implementing a plan that truly belongs to the community. It will include improved amenities for ongoing use of the site as well as shoreline improvements, beach nourishment, and new structures. Marais is providing civil and structural design and assistance with permitting.	
Completion Date (Actual or estimated):	Estimated Cost:	
	Entire Project:	Work for which Firm was Responsible:
Estimated 2025	N/A	\$132,000

PROJECT NO. 8		
Project Name, Location and Owner's contact information:	Nature of Firm's Responsibility:	
Trinity School Nursery Renovations and Additions New Orleans, LA Prime - MZ Architecture Jill Maumus 504.434.0319 jill@designwithmz.com	This project includes a renovation at Trinity school in New Orleans in order to accommodate the programming needs of the Trinity Nursery and associated offices. The two-story building was built in 1860. As originated in the planning effort completed as the Trinity Campus Master Plan, the building renovation and addition will house the future Trinity Nursery program. The 1730 gross square foot building has been used as Trinity's business office and needs extensive interior upgrades and has considerable deferred maintenance. The master plan proposes a first-floor addition of roughly 650 square feet to accommodate the new Nursery program.	
Completion Date (Actual or estimated):	Estimated Cost:	
	Entire Project:	Work for which Firm was Responsible:
Actual 2024	N/A	\$14,000

TEC Professional Services Questionnaire

PROJECT NO. 9		
Project Name, Location and Owner's contact information:	Nature of Firm's Responsibility:	
Campus-Wide Drainage Study Kenner, LA Jefferson Parish Prime - Burns & McDonnell Jeff Doudrick 816.286.6900 jadoudrick@burnsmcd.com	The overarching goal of this effort will be to provide the project area with a comprehensive hydraulic model documenting the subcatchments, collection systems, and conduits serving the site as they currently exist, while also assessing drainage impacts in terms of discharge and stage variation in the connecting canal outfalls due to current and selected future infrastructure improvements. As part of this effort, Marais is performing detailed stormwater modeling using PCSWMM, a software tool that allows for advanced hydrological and hydraulic analysis of stormwater systems. The PCSWMM model helps us accurately simulate stormwater flow and assess the performance of existing infrastructure under current conditions, while also incorporating the potential impacts of future improvements.	
Completion Date (Actual or estimated):	Estimated Cost:	
	Entire Project:	Work for which Firm was Responsible:
Estimated 2025	N/A	\$45,000

PROJECT NO. 10		
Project Name, Location and Owner's contact information:	Nature of Firm's Responsibility:	
Coushatta Education Building Historic Renovations Coushatta Reservation Elton, LA Nelson Worldwide Rebecca Muchow 612.638.6324 rmuchow@nelsonww.com	The current Coshatta educational building is the oldest facility on the Reservation, and in extreme state of disrepair that makes renovations infeasible. A number of educational and social programs critical to support the community that have traditionally been provided are no longer being offered on-site due to the condition of the existing building. A new facility with greatly expanded programming is planned to provide large community gathering space, cultural education space, and multi-generational educational facilities. Early learning, educational assistance, kids tutoring, college research area, K-12 support programming, and Elder services will be supported by the new facility. Marais is providing civil and structural engineering services for this project to include structural (wind) analysis, framing and foundation drawings, civil site design, and construction phase services.	
Completion Date (Actual or estimated):	Estimated Cost:	
	Entire Project:	Work for which Firm was Responsible:
Estimated 2025	N/A	\$40,000

TEC Professional Services Questionnaire

M. List all prior and/or on-going litigation between Firm and Jefferson Parish. Please attach additional pages if necessary.

Parties:		Status/Result of Case:
Plaintiff:	Defendant:	
1. N/A		
2. N/A		
3. N/A		
4. N/A		

N. Use this space to provide any additional information or description of resources supporting Firm's qualifications for the proposed project.

Civil engineering is one of the core services upon which Marais was founded. We provide a broad spectrum of drainage design services ranging from small private properties and residences to commercial and municipal projects. With a highly diversified skill set, our designs incorporate and complement the existing site features, working to enhance the project's value to its environment. As a result of our work on projects throughout the region, we have established strong working relationships with local municipalities allowing us to streamline the permitting process. We believe that quality and consistency have shaped our successful history of obtaining timely approvals for our developments. In addition, we understand and account for the variability in soil conditions in southern Louisiana by balancing the specific earthwork components encountered on each project with the project goals.

O. To the best of my knowledge, the foregoing is an accurate statement of facts.

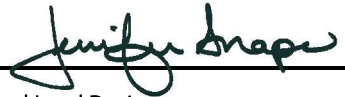
Signature:  Print Name: Jennifer Snape
 Title: Owner and Lead Designer Date: 5/1/25

TEC Professional Services Questionnaire**A. Project Name and Advertisement Resolution Number:**

SOQ No. 25-015: Provide Professional Architectural and Engineering Services to Design and Construct the New West Bank Regional Library

B. Firm Name & Address:

Batture, LLC
5110 Freret Street
New Orleans, LA 70115

C. Name, title and contact information of Principal, as defined in Section 2-926 of the Jefferson Parish Code of Ordinances, who is a registered, licensed architect, professional engineer, or surveyor in the State of Louisiana:

Mary Schambeau Johnson
Principal Engineer, Batture LLC
Professional Engineer
msjohnson@batture-eng.com
504.533.8644

D. Name and contact information of employee who is a registered and licensed architect, professional engineer, or surveyor in the State of Louisiana in the applicable discipline. A subcontractor may be substituted here only if the advertised Project requires more than one discipline.

Mary Schambeau Johnson
Principal Engineer, Batture LLC
Professional Engineer
msjohnson@batture-eng.com
504.533.8644

E. Please provide the number of employees whose primary function corresponds with each category:

<u>1</u> Administrative	<u> </u> Estimators	<u> </u> Specification Writers
<u> </u> Architects (Licensed)	<u> </u> Geologists	<u>3</u> Structural Engineers
<u> </u> Chemical Engineers	<u> </u> Geotechnical Engineers	<u> </u> Graduate Engineers
<u>1</u> Civil Engineers	<u> </u> Interior Designers	<u> </u> Project Managers
<u> </u> Construction Inspectors	<u>1</u> Landscape Architects	<u> </u> Clerical
<u> </u> Ecologists	<u>3</u> Land Surveyor	<u> </u> Grant/Funding Specialist
<u> </u> Electrical Engineers	<u> </u> Mechanical Engineers	<u> </u> Sanitary Engineers
<u>3</u> Engineer Intern	<u> </u> Environmental Engineers	
<u>1</u> Professional Land Surveyors		<u>13</u> TOTAL

F. Is this submittal by a JOINT-VENTURE? Please check: YES ☐ NO ☒

If marked "No" skip to Section I. If marked "yes" complete Sections G-H.

TEC Professional Services Questionnaire

G. If submittal is by JOINT-VENTURE, list the firms participating and outline specific areas of responsibility (including administrative, technical, and financial) for each firm. Please attach additional pages if necessary.

1.
N/A

2.
N/A

H. Has this JOINT-VENTURE previously worked together? Please check:
YES ☐ NO ☐

I. List all subcontractors anticipated for this Project. Please note that all subcontractors must submit a fully completed copy of this questionnaire, applicable licenses, and any other information required by the advertisement. See Jefferson Parish Code of Ordinances, Sec. 2-928(a)(3). Please attach additional pages if necessary.

Name & Address:	Specialty:	Worked with Firm Before (Yes or No):
1. N/A		
2. N/A		
3. N/A		

J. Please specify the total number of support personnel that may assist in the completion of this Project:

5 _____

TEC Professional Services Questionnaire

K. List the professional in charge, key persons, specialists, and individual consultants anticipated for this Project and provide their relevant information below. If necessary, please attach additional documentation (i.e. resume) that demonstrates the employment history and experience of the Firm's key persons that may assist in the completion of this Project. Please attach additional pages if necessary.

PROFESSIONAL IN CHARGE OF PROJECT:**Name & Title:**

Mary Schambeau Johnson, MS, PE
Principal Engineer

Project Assignment:

Professional In Charge

Name of Firm with which associated:

Batture, LLC

Years' experience with this Firm:

7 Years

Education: Degree(s)/Year/Specialization:

M.S. / 2012 / Civil Engineering
B.S. / 2010 / Civil Engineering

Active registration: Year first registered/discipline:

2016 / Civil Engineering / 40458

Other experience and qualifications relevant to the proposed Project:

Schambeau Johnson, MS, PE is a Professional Engineer at Batture specializing in structural engineering. Ms. Johnson holds Bachelor's and Master's degrees in Civil Engineering from Auburn University where she graduated Summa Cum Laude. With over a decade of experience in the field, Mary has established herself as a seasoned structural engineer with a diverse portfolio spanning commercial construction, multifamily developments, historic renovations, and foundation design.

Mary has built her career in New Orleans and is dedicated to its vibrant culture and has contributed significantly to its development by serving as the Engineer of Record for notable ventures such as Carrollton Courthouse Assisted Living Facility, Ronald McDonald House Children's Hospital, and multiple historic renovations on Canal Street and in the French Quarter. Notably, she has also led the structural design for municipal recreational structures, including Mirabeau Water Gardens and Gretna City Park. Her design skills encompass the comprehensive design of gravity and lateral load systems, foundations, and meticulous detailing, all executed with precision using REVIT. Moreover, her adeptness in construction administration, from submittal and shop drawing review to field inspections and structural redesign coordination, underscores her holistic approach to project management. In addition to her technical expertise, Ms. Johnson also serves as a principal of the firm, overseeing all of the firm's design projects and personnel.

TEC Professional Services Questionnaire

KEY PERSON, SPECIALIST, OR INDIVIDUAL CONSULTANT:
Name & Title:
Robert Mora, PE, PLS, ENV-SP Principal Engineer
Project Assignment:
QA/QC
Name of Firm with which associated:
Batture, LLC
Years' experience with this Firm:
10 Years
Education: Degree(s)/Year/Specialization:
B.S. / 2003 / Civil Engineering
Active registration: Year first registered/discipline:
2009 / Civil Engineering / 35109 2010 / Professional Land Surveyor / 5042
Other experience and qualifications relevant to the proposed Project:
Robert (Bob) Mora, PE, PLS is founder and managing partner of Batture, LLC and has over 20 years experience in land surveying and civil engineering throughout the New Orleans Metro Area. Mr. Mora has experience providing civil design services on projects for private developers and municipalities. He has successfully managed and completed projects for entities such as the Sewerage and Water Board of New Orleans, City of New Orleans Department of Public Works, Regional Planning Commission, St. Bernard Parish, Orleans Levee Board, and Army Corps of Engineers. From 2008 – 2011, he worked on the Army Corps of Engineers Hurricane Protection Program as a sub consultant. After managing the construction of over 100 million dollars of flood protection, Mr. Mora was recognized with a Certificate of Appreciation for Exceptional Achievement as a Project Engineer on the Hurricane & Storm Damage Risk Reduction System Mission. Managing this construction work greatly increased his ability to prepare contract plans and specifications.

TEC Professional Services Questionnaire

KEY PERSON, SPECIALIST, OR INDIVIDUAL CONSULTANT:
Name & Title:
Hermann Alb, MS, PE Senior Engineer
Project Assignment:
Structural Engineer
Name of Firm with which associated:
Batture, LLC
Years' experience with this Firm:
5 Years
Education: Degree(s)/Year/Specialization:
M.S. / 2004 / Civil Engineering B.S. / 2006 / Civil Engineering
Active registration: Year first registered/discipline:
2013 / Civil Engineering / 38032
Other experience and qualifications relevant to the proposed Project:
<p>Hermann Alb, MS, PE leverages 18+ years of structural engineering experience as a Professional Engineer at Batture. With a Bachelor's and Master's in Civil Engineering from Tulane University, he blends academic proficiency with practical skills honed during his time as a Research Assistant at Tulane. Hermann excels in the design of foundations, high-wind resistant systems, structural support modifications for existing structures, a wide range of structural systems supporting gravity and lateral loads, construction oversight, BIM coordination, QA/QC processes, and project management for commercial, industrial, residential, and historical renovation projects. He is also proficient in several software platforms such as Revit, AutoCAD, RISA, Enercalc, Excel, iLevel Forte, and Profis Engineering.</p> <p>In addition to Hermann's technical expertise, he is the current Vice-President of One Heart NOLA, a non-profit providing support to teens and young adults who are about to age out or have aged out of the foster care system with the mission to provide necessary resources for the most vulnerable in our city.</p>

TEC Professional Services Questionnaire

KEY PERSON, SPECIALIST, OR INDIVIDUAL CONSULTANT:
Name & Title:
Arielle Authement, PE Project Engineer
Project Assignment:
Structural Engineer
Name of Firm with which associated:
Batture, LLC
Years' experience with this Firm:
6 Years
Education: Degree(s)/Year/Specialization:
B.S. / 2017 / Civil Engineering
Active registration: Year first registered/discipline:
2024 / Civil Engineering / 49109
Other experience and qualifications relevant to the proposed Project:
<p>Arielle Authement, PE is a civil engineer at Batture with experience in both design and construction administration. Since earning her B.S. in Civil Engineering from UNO in 2017, she has worked on a range of projects, from historic renovations to new commercial buildings. She specializes in steel, cold-formed, concrete, masonry, and timber design and is skilled in structural analysis, construction detailing, and producing design documents in REVIT.</p> <p>Additionally, Arielle is the Past-President of the New Orleans Professional Chapter of Engineers Without Borders and actively collaborates with local non-profits. She's passionate about using her expertise to support underserved communities, both locally and globally.</p>

TEC Professional Services Questionnaire

KEY PERSON, SPECIALIST, OR INDIVIDUAL CONSULTANT:
Name & Title:
Lauren Williams, PLA, ASLA, GIP Professional Landscape Architect
Project Assignment:
Landscape Architect
Name of Firm with which associated:
Batture, LLC
Years' experience with this Firm:
2 years
Education: Degree(s)/Year/Specialization:
B.L.A. / 2016 / Design Studies(major), Landscape Architecture(minor) M.L.A. / 2018 / Landscape Architecture
Active registration: Year first registered/discipline:
2022 / Louisiana PLA (Landscape Architect) / W-266 2022 / Louisiana Arborist / 184497 2021 / Green Infrastructure Professional
Other experience and qualifications relevant to the proposed Project:
Lauren Williams, PLA is a passionate licensed landscape architect, licensed arborist, and green infrastructure professional, specializing in stormwater management in an urban environment. She is dedicated to creating functional and aesthetically pleasing outdoor spaces that harmonize with the natural environment while meeting the needs of diverse communities. In addition to her technical and design skills, Lauren has expertise in community engagement, organizing public events and collaborating closely with stakeholders to ensure that projects reflect the unique needs and aspirations of the communities they serve. Throughout her experience as a project manager, Lauren has led multidisciplinary teams to deliver projects spanning a wide range of types and scales, from small residential green infrastructure designs to urban parks and reforestation initiatives, as well as large-scale commercial developments and higher education campuses. She has played a key role in award winning projects in green infrastructure in both Louisiana and North Carolina.

TEC Professional Services Questionnaire

L. Work by Firm or Joint-Venture members which best illustrates current qualifications relevant to this Project. Please include any and all work performed for Jefferson Parish. Please attach additional pages if necessary.

PROJECT NO. 1

Project Name, Location and Owner's contact information:	Nature of Firm's Responsibility:	
St. John the Baptiste Reserve Library Reserve, Louisiana Client: Ewing Cole Joan Gradus jgradus@ewingcole.com	The project focuses on relocating the Leroy D. William Memorial Library to River Road and adjacent to the Mississippi River. The proposed site is heavily wooded with old growth trees and currently has several house structures that are of a typical vernacular style – wood siding and trim, wide porches and high ceilings. The concept proposal relocates and restores one of these existing structures for use as a community history activity hub. The project site is bordered on the east by the St. John Theatre, which together with the library, and existing house will create a civic hub in the heart of Reserve. Shared use parking with pathways and garden spaces will link the Theatre and library site. Batture's participation in this project involves civil engineering, stormwater management plan and construction administration services.	
Completion Date (Actual or estimated):	Estimated Cost:	
	Entire Project:	Work for which Firm was Responsible:
July 2024	\$14,527,178	\$48,946

PROJECT NO. 2

Project Name, Location and Owner's contact information:	Nature of Firm's Responsibility:	
Mercy Hall Dormitories - Loyola University New Orleans, Louisiana Client: Eskew+Dumez+Ripple Cynthia Dubberley cdubberley@eskewdumezripple.com Owner: Loyola University New Orleans Hoc Ngo hngo@loyno.edu	A new 7 story dormitory is being constructed at the corner of Freret St. and Calhoun St. for Loyola University. The over 200,000 SF building will house nearly 600 residents and includes communal spaces. A central courtyard will simultaneously provide semi-private communal exterior space and be part of the of the stormwater retention system. Batture is designing the interior courtyard and perimeter site design. The project will feature a courtyard with permeable paving, gardens, and user seating. A series of rain gardens separated by concrete weirs will manage the stormwater from the roof. The superstructure structural system features a post-tensioned concrete slab supported by concrete columns on an augercast pile foundation with over 300 piles extending 80 ft deep. The first-floor slab is a two-way concrete slab, supported by 40-foot-deep Class 5 timber piles. The lateral system consists of concrete shear wall cores for both stairwells and for the elevator core. Steel framing was provided to accommodate a large rooftop solar array and typical site gates. Batture is providing structural, civil, surveying and landscape architecture services.	
Completion Date (Actual or estimated):	Estimated Cost:	
	Entire Project:	Work for which Firm was Responsible:
Fall 2025	\$79,888,522	\$555,300

TEC Professional Services Questionnaire

PROJECT NO. 3		
Project Name, Location and Owner's contact information:	Nature of Firm's Responsibility	
<p>The Beach at UNO - Pedestrian Connectivity & Lakeshore Crossing</p> <p>New Orleans, Louisiana</p> <p>Client: Eskew+Dumez+Ripple Jose Alvarez jalvarez@eskewdumezripple.com</p> <p>Owner: Corporate Realty Michele B. Johnston mjohnston@corp-realty.com</p>	<p>Batture is on the design team that was tasked with improvements to The Beach at UNO, a research and technology park located on the University of New Orleans campus. Improvements includes creating better pedestrian connectivity through new pedestrian paths, plantings, and a raised outdoor deck area for communal gatherings. A new pedestrian crossing at Lakeshore Drive was also designed and Batture handled the permitting with DPW. New awnings were also designed by the structural team and attached to existing buildings for entrance revitalizations along with a new monumental stair in an adjacent additional service project to revitalize the Sandbox, a research office building.</p>	
Completion Date (Actual or estimated)	Estimated Cost:	
	Entire Project:	Work for which Firm was Responsible:
November 2024	\$2,500,000	\$60,083

PROJECT NO. 4		
Project Name, Location and Owner's contact information:	Nature of Firm's Responsibility:	
<p>St. Augustine High School Gym Renovation – Watson Jones Health and Wellness Center</p> <p>New Orleans, Louisiana</p> <p>Client: Trapolin Peer Raymond Armant rarmant@trapolinpeer.com</p>	<p>This project is the improvement and repair of the existing gymnasium at St. Augustine High School that was damaged by fire in 2021. The fire damaged several steel roof trusses and Batture designed the replacement details of the damaged ends and repair plan for spalled concrete columns and beams closest to the fire origin. For the expansion of the athletic complex, scope includes installation of a new elevator, new 3rd floor additions on either side of the gymnasium mass and extensions of a monumental stair to the new 3rd floor additions. Batture provided structural and civil design services.</p>	
Completion Date (Actual or estimated):	Estimated Cost:	
	Entire Project:	Work for which Firm was Responsible:
Ongoing	\$10,000,000	\$43,810

TEC Professional Services Questionnaire

PROJECT NO. 5		
Project Name, Location and Owner's contact information:	Nature of Firm's Responsibility:	
Gretna City Park, Gretna, Louisiana Client: Waggonner & Ball Andy Sternad andy@wbae.com Owner: City of Gretna Amanda Pelligrin, AICP Email: apellegrin@gretnala.com	The Gretna City Park project is a \$5.6 million renovation, transforming 80 acres of green space into a park that is now capable of holding an additional 6.5 million gallons of stormwater. With hundreds of new trees and expanded detention ponds, the park uses nature-based solutions for water management and ecosystem restoration. Funded as part of Louisiana's LA SAFE program, the project is one of ten across the state. The renovations aim to reduce flooding and offer recreational opportunities to residents, including 1.5 miles of trails, a 1,500 square foot pavilion, a kayak launch, fishing piers, a bog garden, and wildflower meadow.	
Completion Date (Actual or estimated):	Estimated Cost:	
	Entire Project:	Work for which Firm was Responsible:
May 2023	\$3,485,000	\$166,080

PROJECT NO. 6		
Project Name, Location and Owner's contact information:	Nature of Firm's Responsibility:	
Carrollton Courthouse Assisted Living and Memory Care Facility, New Orleans, Louisiana Client: Waggonner & Ball David Curtis davidc@wbae.com Owner: Felicity Property Company Patrick Schindler (504) 586-8305	This project is located on approximately 76,000 square feet of land on Carrollton Avenue between Hampson and Maple Streets. The development consists of the complete renovation of the two-story, historically significant Carrollton Courthouse building (approximately 16,000 square feet, masonry construction with timber joists and brick corbel foundation) as well as the construction of two new 3-story wings (totaling approximately 88,000 square feet) to accommodate project-programming needs for 100 Senior Living units (65 Assisted Living, 35 Memory Care), on-site amenities, common areas, and parking. Batture provided structural engineering design. This project won a 2023 Best Project Award from Engineer News Record for the TX-Louisiana region.	
Completion Date (Actual or estimated):	Estimated Cost:	
	Entire Project:	Work for which Firm was Responsible:
February 2023	\$29,350,000	\$134,200

TEC Professional Services Questionnaire

PROJECT NO. 7		
Project Name, Location and Owner's contact information:	Nature of Firm's Responsibility:	
NAVFAC Visitor Community Center Planting Plan Belle Chasse, Louisiana Client: Royal Engineers & Consultants, LLC Imbrie Packard ipackard@royalengineering.net	A design for a new road and vehicular circulation is planned for the Visitor Control Center at the Navy Facility in Belle Chasse. Part of this new design is the inclusion of a statue, gardens, parking lot, and stormwater management. Batture was brought on to provide landscape architectural services and design new bioretention facilities.	
Completion Date (Actual or estimated):	Estimated Cost:	
	Entire Project:	Work for which Firm was Responsible:
December 2024	Unknown	\$13,155

PROJECT NO. 8		
Project Name, Location and Owner's contact information:	Nature of Firm's Responsibility:	
Beach at UNO - Louisiana Future Energy Center New Orleans, Louisiana Client: Eskew+Dumez+Ripple Jose Alvarez jAlvarez@eskewdumezripple.com	The Louisiana Future Energy Center, funded by a \$10 million award from Biden's Build Back Better Regional Challenge, will house private offices, co-working spaces and event spaces after a renovation to an existing concrete framed building at the Beach. In addition to the interior build-out, new solar carport structures will be installed. Batture provided the structural design including the foundation for the new carport structures and details for new mechanical openings. Batture also provided the required site utility design coordination for the new carports located in the existing parking lot.	
Completion Date (Actual or estimated):	Estimated Cost:	
	Entire Project:	Work for which Firm was Responsible:
Ongoing	10,000,000	\$15,000

TEC Professional Services Questionnaire

PROJECT NO. 9		
Project Name, Location and Owner's contact information:	Nature of Firm's Responsibility:	
<p>Ronald McDonald House Children's Hospital</p> <p>New Orleans, Louisiana</p> <p>Client: Eskew+Dumez+Ripple Jenifer Navard jnavard@eskewdumezripple.com</p>	<p>This project was the renovation of two buildings of the old U.S. Marine Hospital on Children's Hospitals campus to provide housing to long-term patient families during treatment at Children's Hospital. This project was a part of the ongoing master plan to renovate the U.S. Marine Hospital buildings. Batture provided the structural design services for the renovation of the historic structures which included in addition to the design of a new 2-story cold-formed framed addition along with a glass and steel connecting structure that serves as the new main entrance. Batture also provided landscape architecture services and a stormwater management plan.</p>	
Completion Date (Actual or estimated):	Estimated Cost:	
	Entire Project:	Work for which Firm was Responsible:
December 2022	\$6,300,000	\$35,700

PROJECT NO. 10		
Project Name, Location and Owner's contact information:	Nature of Firm's Responsibility:	
<p>Bucktown BRIC</p> <p>Jefferson Parish, Louisiana</p> <p>Client: Digital Engineering & Imaging, Inc. Andrew Woodroof awoodroof@deii.net</p> <p>Owner: Jefferson Parish Michelle Gonzales mgonzales@jeffparish.net</p>	<p>The Bucktown BRIC program aims to ensure the longevity and sustainability of this coastal community by finding solutions to stormwater management within the confines of Orpheum Ave, Cherokee Ave, West Esplanade Ave, and Lake Pontchartrain. Batture was a subcontractor to Digital Engineering, providing landscape architecture, survey services, as well as community engagement coordination. Two community engagement events were held to gain important community feedback from residents about potential plans for the space to provide stormwater management for the most vulnerable areas. The engagements events included activities that allowed residents to voice their concerns about flooding, as well as an opportunity for the contractors to present preliminary designs. Event materials were prepared in both Spanish and English to provide greater accessibility to Hispanic residents in the neighborhoods.</p>	
Completion Date (Actual or estimated):	Estimated Cost:	
	Entire Project:	Work for which Firm was Responsible:
December 2023	\$262,813	\$61,311

TEC Professional Services Questionnaire

M. List all prior and/or on-going litigation between Firm and Jefferson Parish. Please attach additional pages if necessary.

Parties:		Status/Result of Case:
Plaintiff:	Defendant:	
1. N/A		
2. N/A		
3. N/A		
4. N/A		

N. Use this space to provide any additional information or description of resources supporting Firm's qualifications for the proposed project.

Established in 2014, Batture LLC is a Louisiana-licensed landscape architecture, civil engineering, and land surveying firm specializing in site development, stormwater management design, green infrastructure, hydraulic/ hydrodynamic modeling, structural design, and construction management. Based in New Orleans, our company is a certified Small Entrepreneurship (Hudson Initiative) dedicated to Louisiana's progress and protection. Our diverse team includes 4 Professional Engineers, 1 Professional Landscape Architect, and 1 Licensed Land Surveyor with over 70 years of collective experience. Licensed in Louisiana, Mississippi, Alabama, and Florida, we prioritize open communication with clients and deliver services that enhance communities and the environment, integrating low impact design principles into our projects. Leveraging our relationships with permitting authorities, we navigate project challenges efficiently. Additionally, our multi-disciplinary approach allows seamless coordination across professions. We are deeply committed to projects that enhance Louisiana's community resilience while preserving its cultural heritage, and we take pride in projects that combine our design services with our dedication to this commitment. In fact, much of our work focuses on urban infrastructure development, from historic renovations to large-scale green infrastructure projects. We strive to embody a mission that makes the world a better place directly through our services. In fact, Batture LLC is the only civil engineering company to be accepted into the business program at Propeller, the New Orleans non-profit that works with socially minded companies. It's not just our pro bono work that got us there, but our vision to help transform civil engineering. We believe civil engineering firms will be most successful long-term when they work profitably and collaboratively with the community to discover our greatest opportunities for impact.

O. To the best of my knowledge, the foregoing is an accurate statement of facts.

Signature: Mary Schambeau Johnson Print Name: Mary Schambeau Johnson
 Title: Principal Engineer Date: 05/02/2025

Eskew Dumez Ripple⁺

Let's build something
remarkable together.

NEW ORLEANS

400 Lafayette St., Ste. 300
New Orleans, LA 70130
504.561.8686

WASHINGTON, DC

1701 Rhode Island Ave NW
Washington, DC 20036
202.967.3150

SALT LAKE CITY

350 East 400 South, Ste. 245
Salt Lake City, UT 84111
504.276.5439

ESKEWDUMEZRIPPLE.COM