



GRACE HEBERT CURTIS



ARCHITECTS

## TEC Professional Services Questionnaire

**A. Project Name and Advertisement Resolution Number:**

**Jefferson Parish Miscellaneous Architecture and Engineering Services on an As-Needed basis**  
SOQ 24-036

**B. Firm Name & Address:**

**Grace Hebert Curtis Architects, LLC**

601 Poydras Street, Suite 2310  
New Orleans, LA 70130



**C. Name, title and contact information of Principal, as defined in Section 2-926 of the Jefferson Parish Code of Ordinances, who is a registered, licensed architect, professional engineer, or surveyor in the State of Louisiana:**

Alex Deshotels, AIA, NCARB  
Partner, Registered Architect in LA #8323  
P: 225.338.5569  
E: adeshotels@ghc-arch.com

**D. Name and contact information of employee who is a registered and licensed architect, professional engineer, or surveyor in the State of Louisiana in the applicable discipline. A subcontractor may be substituted here only if the advertised Project requires more than one discipline.**

Andrea Bowman, AIA, NCARB, LEED AP BD+C, WELL AP  
Senior Associate, New Orleans Office Leader, Registered Architect in LA #7769  
P: 504.522.2050  
E: abowman@ghc-arch.com

**E. Please provide the number of employees whose primary function corresponds with each category:**

<u>60</u> Administrative	<input type="checkbox"/> Estimators	<input type="checkbox"/> Specification Writers
<u>149</u> Architects (Licensed)	<input type="checkbox"/> Geologists	<input type="checkbox"/> Structural Engineers
<input type="checkbox"/> Chemical Engineers	<input type="checkbox"/> Geotechnical Engineers	<input type="checkbox"/> Graduate Engineers
<input type="checkbox"/> Civil Engineers	<u>24</u> Interior Designers	<input type="checkbox"/> Project Managers
<input type="checkbox"/> Construction Inspectors	<input type="checkbox"/> Landscape Architects	<input type="checkbox"/> Clerical
<input type="checkbox"/> Ecologists	<input type="checkbox"/> Land Surveyor	<input type="checkbox"/> Grant/Funding Specialist
<input type="checkbox"/> Electrical Engineers	<u>2</u> Mechanical Engineers	<input type="checkbox"/> Sanitary Engineers
<u>125</u> <del>Engineer-Intern</del> Design Intern	<input type="checkbox"/> Environmental Engineers	
<input type="checkbox"/> Professional Land Surveyors		<u>360</u> <b>TOTAL</b>

**F. Is this submittal by a JOINT-VENTURE? Please check: YES ☐ NO ☒**

**If marked "No" skip to Section I. If marked "yes" complete Sections G-H.**

## TEC Professional Services Questionnaire

**G. If submittal is by JOINT-VENTURE, list the firms participating and outline specific areas of responsibility (including administrative, technical, and financial) for each firm. Please attach additional pages if necessary.**

1. N/A

2. N/A

**H. Has this JOINT-VENTURE previously worked together? Please check:**

YES ☐ NO ☐ N/A

**I. List all subcontractors anticipated for this Project. Please note that all subcontractors must submit a fully completed copy of this questionnaire, applicable licenses, and any other information required by the advertisement. See Jefferson Parish Code of Ordinances, Sec. 2-928(a)(3). Please attach additional pages if necessary. [Consultant questionnaires begin on page 28](#)**

Name & Address:	Specialty:	Worked with Firm Before (Yes or No):
1. <b>Huseman &amp; Associates, LLC</b> 3501 N Causeway Blvd #710 Metairie, LA 70002	<b>Electrical Engineering</b>	Yes
2. <b>Infinity Engineering Consultants, LLC</b> 4001 Division Street Metairie, LA 70002	<b>Civil / Site Engineering</b>	Yes
3. <b>Grace Hebert Curtis Architects</b> 601 Poydras Street, Ste. 2310 New Orleans, LA 70130	<b>Mechanical Engineering</b>	Yes

**J. Please specify the total number of support personnel that may assist in the completion of this Project:**

19

## TEC Professional Services Questionnaire

**K. List the professional in charge, key persons, specialists, and individual consultants anticipated for this Project and provide their relevant information below. If necessary, please attach additional documentation (i.e. resume) that demonstrates the employment history and experience of the Firm's key persons that may assist in the completion of this Project. Please attach additional pages if necessary. [See additional resumes and professional licenses beginning on page 26.](#)**

### **PROFESSIONAL IN CHARGE OF PROJECT:**

**Name & Title:**

**Alex Deshotels, AIA, NCARB**  
Partner, Architect

**Project Assignment:**

**Principal-In-Charge**

**Name of Firm with which associated:**

Grace Hebert Curtis Architects, LLC

**Years' experience with this Firm:**

15

**Education: Degree(s)/Year/Specialization:**

Bachelor of Arts, Architecture, University of Louisiana at Lafayette, 2006

**Active registration: Year first registered/discipline:**

Licensed Architect in LA #8323, 2015

**Other experience and qualifications relevant to the proposed Project:**

- Hahnville Branch Library; Hahnville, LA
- Ochsner at Clearview Center; Metairie, LA
- Calcasieu Parish Office of Juvenile Justice Services; Lake Charles, LA
- West Feliciana Parish Hospital; St. Francisville, LA
- Terrebonne Parish Juvenile Justice Complex; Gray, LA
- Evangeline Parish Sheriff's Detention Center; Ville Platte, LA
- Trinity Medical; Ferriday, LA





## TEC Professional Services Questionnaire

<b>KEY PERSON, SPECIALIST, OR INDIVIDUAL CONSULTANT:</b>	
<b>Name &amp; Title:</b> <b>Andrea Bowman, AIA, NCARB, LEED AP BD+C, WELL AP</b> Senior Associate, New Orleans Office Leader	
<b>Project Assignment:</b> Project Manager, <b>Main Point of Contact</b>	
<b>Name of Firm with which associated:</b> Grace Hebert Curtis Architects, LLC	
<b>Years' experience with this Firm:</b> 7	
<b>Education: Degree(s)/Year/Specialization:</b> Master, Architecture, Tulane University, 2007 Master, Historic Preservation, Tulane University, 2007	
<b>Active registration: Year first registered/discipline:</b> Licensed Architect in LA #7769, 2013	
<b>Other experience and qualifications relevant to the proposed Project:</b> <ul style="list-style-type: none"> <li>▪ Bernhard Office Renovation; Metairie, LA</li> <li>▪ Orleans Parish Sheriff's Office Medical Services Building; New Orleans, LA</li> <li>▪ Hynes UNO Charter School; New Orleans, LA</li> <li>▪ Ochsner Fitness Center Renovation; Harahan, LA</li> <li>▪ Ochsner Marrero Urgent Care; Marrero, LA</li> <li>▪ Tulane Reilly Center Natatorium; New Orleans, LA</li> <li>▪ Madison Parish Hospital; Tallulah, LA</li> </ul>	



## TEC Professional Services Questionnaire

<b>KEY PERSON, SPECIALIST, OR INDIVIDUAL CONSULTANT:</b>	
<b>Name &amp; Title:</b> <b>Greg Eckert, AIA, NCARB</b> Architect	
<b>Project Assignment:</b> Project Architect	
<b>Name of Firm with which associated:</b> Grace Hebert Curtis Architects, LLC	
<b>Years' experience with this Firm:</b> 2	
<b>Education: Degree(s)/Year/Specialization:</b> Bachelor, Architecture, Louisiana State University, 2003	
<b>Active registration: Year first registered/discipline:</b> Licensed Architect in LA #8239, 2015	
<b>Other experience and qualifications relevant to the proposed Project:</b> <ul style="list-style-type: none"><li>▪ New K-8 School for Jefferson Parish; Metairie, LA</li><li>▪ Orleans Parish Sheriff's Office Medical Services Building; New Orleans, LA</li><li>▪ Hahnville High School Triple A - Alumni Center; Luling, LA</li><li>▪ Lafayette Sheriff's Office Shooting Range; Lafayette, LA</li><li>▪ JS Clark Leadership Academy; Opelousas, LA</li><li>▪ Bayou Bend Health System Surgery Expansion; Franklin, LA</li></ul>	

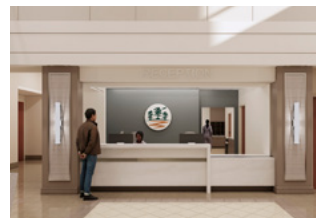

## TEC Professional Services Questionnaire

<b>KEY PERSON, SPECIALIST, OR INDIVIDUAL CONSULTANT:</b>	
<b>Name &amp; Title:</b> <b>Greg Jefferson, Assoc. AIA</b> Senior Designer	
<b>Project Assignment:</b> Project Designer	
<b>Name of Firm with which associated:</b> Grace Hebert Curtis Architects, LLC	
<b>Years' experience with this Firm:</b> 5	
<b>Education: Degree(s)/Year/Specialization:</b> Master, Architecture, University of Louisiana at Lafayette, 2010	
<b>Active registration: Year first registered/discipline:</b> N/A	
<b>Other experience and qualifications relevant to the proposed Project:</b> <ul style="list-style-type: none"> <li>▪ New K-8 School for Jefferson Parish; Metairie, LA</li> <li>▪ Dr. John Ochsner Discovery Health Sciences Academy; Jefferson, LA</li> <li>▪ Laitram Assembly West Expansion and Renovation; Harahan, LA</li> <li>▪ Hynes UNO Charter School; New Orleans, LA</li> <li>▪ McNeese Urgent Care and Student Health Clinic; Lake Charles, LA</li> <li>▪ Tulane University Swim Team Locker Room; New Orleans, LA</li> </ul>	



## TEC Professional Services Questionnaire

<b>KEY PERSON, SPECIALIST, OR INDIVIDUAL CONSULTANT:</b>	
<b>Name &amp; Title:</b> <b>Noah Verret, Assoc. AIA</b> Designer	
<b>Project Assignment:</b> Project Designer	
<b>Name of Firm with which associated:</b> Grace Hebert Curtis Architects, LLC	
<b>Years' experience with this Firm:</b> 3	
<b>Education: Degree(s)/Year/Specialization:</b> B.S., Architecture, University of Louisiana at Lafayette, 2021 Master, Architecture, University of Louisiana at Lafayette, 2022	
<b>Active registration: Year first registered/discipline:</b> N/A	
<b>Other experience and qualifications relevant to the proposed Project:</b> <ul style="list-style-type: none"> <li>▪ New K-8 School for Jefferson Parish; Metairie, LA</li> <li>▪ Beauregard Parish Sheriffs Office Ragley Substation; Ragley, LA</li> <li>▪ St. Helena Parish Hospital; Greensburg, LA</li> <li>▪ McNeese State University - Baseball Fieldhouse; Lake Charles, LA</li> <li>▪ LSU Alex Box Stadium Field Level Seating; Baton Rouge, LA</li> <li>▪ Tulane Tidewater Clinical Trials Space Expansion; New Orleans, LA</li> </ul>	





## TEC Professional Services Questionnaire

**L. Work by Firm or Joint-Venture members which best illustrates current qualifications relevant to this Project. Please include any and all work performed for Jefferson Parish. Please attach additional pages if necessary. [Additional project information on pages 16 - 25](#)**

PROJECT NO. 1		
Project Name, Location and Owner's contact information:	Nature of Firm's Responsibility:	
<b>Ascension Parish Courthouse</b> Gonzales, LA  Judge Jason Verdigets P: 225.621.8514 E: jverdigets@23rddjdc.org	The state-of-the-art Ascension Parish Courthouse is designed to accommodate the current and future requirements of the Ascension Parish Court and the 23rd Judicial District Court. Through in-depth pre-design meetings, GHC learned that security was a primary driver. Hence, the design includes subtle, yet effective, separation between the public, detained individuals, and judicial and law enforcement staff. While broad expanses of glass are used along the exterior to draw natural light into the building, glass used strategically throughout the interior gives staff added security.	
Completion Date (Actual or estimated):	Estimated Cost:	
	Entire Project:	Work for which Firm was Responsible:
Actual: 10/2021	\$29,454,917	Full Architecture & Interior Design services

PROJECT NO. 2		
Project Name, Location and Owner's contact information:	Nature of Firm's Responsibility:	
<b>Central Community School Board Office</b> Central, LA  Jason Fountain, Superintendent P: 225.262.1919 E: jfountain@centralcss.org	Serving as the administrative hub for the Central Community School System, the School Board Office is a modern and efficient workspace for over 30 administrative employees. The complex features sleek design elements and spacious offices, along with dedicated conference spaces for school board meetings. Additionally, the project includes extensive improvements to Central High School's adjacent football stadium including newly paved parking, a landscaped promenade, an inviting stadium entry, and a convenient concession stand.	
Completion Date (Actual or estimated):	Estimated Cost:	
	Entire Project:	Work for which Firm was Responsible:
Actual: 09/2023	\$7,714,092	Full Architecture & Interior Design services

## TEC Professional Services Questionnaire

PROJECT NO. 3		
Project Name, Location and Owner's contact information:	Nature of Firm's Responsibility	
<b>East Baton Rouge Council Chambers Renovations</b> Baton Rouge, LA  Sean Johnson, Chief Architect P: 225.603.3477 E: smjohnson@brla.gov	East Baton Rouge Metropolitan Council Chambers located in City Hall underwent a major renovation to provide the public with greater opportunity to observe deliberations and participate in the Council's proceedings. The new space provides more public seating, new voting equipment, and a state-of-the-art audio-visual system. The renovation brings the 1970s era space into the 21st century rich with technology while creating a sense of stateliness and reverence using timeless materials.	
Completion Date (Actual or estimated)	Estimated Cost:	
	Entire Project:	Work for which Firm was Responsible:
Actual: 10/2016	\$1,143,540	Full Architecture & Interior Design services

PROJECT NO. 4		
Project Name, Location and Owner's contact information:	Nature of Firm's Responsibility:	
<b>Ascension Parish 911 Center &amp; Substation</b> Gonzales, LA  Bobby Webre, Sheriff P: 225.715.4557 E: bwebre@ascensionsheriff.com	Ascension Parish 911 Center & Substation improves the Sheriff's services for the fast growing community. With the objective to better serve the growing community, the Ascension Parish Sheriff's Office worked with GHC to develop a new Sheriff's Substation. The project also includes a separate facility for a state-of-the-art 911 Communication Center, planned to the most current specialized design criteria, and outfitted with a high-performance raised access flooring system providing flexibility for changing needs with minimal operational disruption.	
Completion Date (Actual or estimated):	Estimated Cost:	
	Entire Project:	Work for which Firm was Responsible:
Actual: 08/2017	\$5,641,000	Full Architecture & Interior Design services

## TEC Professional Services Questionnaire

<b>PROJECT NO. 5</b>		
<b>Project Name, Location and Owner's contact information:</b>	<b>Nature of Firm's Responsibility:</b>	
<b>Gert Town Natatorium</b> New Orleans, LA  Vincent A. Smith, Director P: 504.658.8670 E: viasmith@nola.gov	Gert Town Natatorium has six lanes, seating for spectators, as well as a zero-depth ramped accessible entry, to allow people at various levels of ability to be able to use the pool. The design team treated the natatorium into two parts. The high-ceilinged natatorium itself was built to stand up to the high temperatures, humidity, and associated corrosion inherent in indoor pools. The adjacent entry lobby was free of these considerations allowing for more standard construction and intricate detailing to welcome the community.	
<b>Completion Date (Actual or estimated):</b>	<b>Estimated Cost:</b>	
	<b>Entire Project:</b>	<b>Work for which Firm was Responsible:</b>
Actual: 10/2018	\$ 6,734,000	Full Architecture & Interior Design services

<b>PROJECT NO. 6</b>		
<b>Project Name, Location and Owner's contact information:</b>	<b>Nature of Firm's Responsibility:</b>	
<b>Zachary Police Department and Training Center</b> Zachary, LA  David McDavid, Chief of Police P: 225.654.9393 E: dmcdavid@zacharypd.org	The Zachary Police Department is designed to have an inviting, civic presence while providing a safe, durable, secure environment. The new headquarters addresses security, department workflows, and technical design requirements while providing a welcoming lobby, flexible training, and educational spaces for employees. The design features focused materiality and transparency to provide an open and inviting atmosphere, while the placement of glazing at high locations provide daylight to internal spaces during the day and illuminating the building at night.	
<b>Completion Date (Actual or estimated):</b>	<b>Estimated Cost:</b>	
	<b>Entire Project:</b>	<b>Work for which Firm was Responsible:</b>
Actual: 09/2024	\$8,490,000	Full Architecture & Interior Design services

## TEC Professional Services Questionnaire

<b>PROJECT NO. 7</b>		
<b>Project Name, Location and Owner's contact information:</b>	<b>Nature of Firm's Responsibility:</b>	
<b>Hahnville Branch Library</b> Hahnville, LA  Leann Benedict, Director P: 385.764.1744 E: leann.benedict@myscpl.org	The Hahnville Branch Library, part of the St. Charles Parish Public Library system, will feature dedicated spaces for children, teens, and adults, as well as the Parish's Louisiana Room, which will focus on state and local history, including genealogy. Its proximity to the Clerk of Court and Parish Archives will provide patrons with enhanced resources for researching and exploring local history. This new, modern facility will not only improve access to historical materials but also offer a variety of indoor and outdoor spaces designed for both small and large group meetings and events.	
Completion Date (Actual or estimated):	<b>Estimated Cost:</b>	
	<b>Entire Project:</b>	<b>Work for which Firm was Responsible:</b>
Estimated: 10/2026	\$7,000,000	Full Architecture & Interior Design services

<b>PROJECT NO. 8</b>		
<b>Project Name, Location and Owner's contact information:</b>	<b>Nature of Firm's Responsibility:</b>	
<b>Ochsner at Clearview Center</b> Metairie, LA  James Britsch, System VP P: 504.842.7378 E: jbritsch@ochsner.org	Ochsner at Clearview Center is an innovative "super clinic" that offers numerous health and wellness services under one expansive roof. The three-level facility (a former Sears department store) comprises of primary and specialty care clinics as well as an outpatient surgical unit with eight operating rooms, a drive-thru pharmacy, endoscopy suites, a health and wellness spa, and a 10-bed micro-hospital. GHC showcases its industry expertise by seamlessly integrating multiple specialties while adhering to a compressed design and construction schedule.	
Completion Date (Actual or estimated):	<b>Estimated Cost:</b>	
	<b>Entire Project:</b>	<b>Work for which Firm was Responsible:</b>
Actual: 02/2023	\$71,358,249	Full Architecture & Interior Design services



## TEC Professional Services Questionnaire

<b>PROJECT NO. 9</b>		
<b>Project Name, Location and Owner's contact information:</b>	<b>Nature of Firm's Responsibility:</b>	
<b>Bernhard Office Renovation</b> Metairie, LA  Philip Catanzaro, President P: 504.833.8291 E: philipc@bernhard.com	The project expertly transformed an existing structure, which had seen a wide variety of former tenants, into a strategically branded corporate office space. The primary impetus for the project was to consolidate the majority of Bernhard's workforce into one location to promote collaboration. Relocating to the space also gave the firm an opportunity to modernize with a more open office environment. Dynamic open workspaces allow employees the freedom to move and share ideas.	
<b>Completion Date (Actual or estimated):</b>	<b>Estimated Cost:</b>	
	<b>Entire Project:</b>	<b>Work for which Firm was Responsible:</b>
Actual: 04/2020	\$3,900,000	Full Architecture & Interior Design services

<b>PROJECT NO. 10</b>		
<b>Project Name, Location and Owner's contact information:</b>	<b>Nature of Firm's Responsibility:</b>	
<b>New K-8 School for Jefferson Parish</b> Washington, LA  Patrick Jenkins, COO P: 504.349.7692 E: patrick.jenkins@jpschools.org	The new school for Jefferson Parish is designed to educate up to 1,000 pre-K through 8th-grade students. The school is built around a "pod" concept, utilizing a spoke-and-wheel design where clusters of four or more classrooms are connected by a common area with its own entrance. This common area will feature a science lab and flexible desks and chairs, allowing for small-group instruction. Additionally, the "pod" design incorporates a safety component to enhance security in the event of an emergency.	
<b>Completion Date (Actual or estimated):</b>	<b>Estimated Cost:</b>	
	<b>Entire Project:</b>	<b>Work for which Firm was Responsible:</b>
Estimated: 06/2026	\$44,033,700	Full Architecture & Interior Design services

## TEC Professional Services Questionnaire

**M. List all prior and/or on-going litigation between Firm and Jefferson Parish. Please attach additional pages if necessary.**

Parties:		Status/Result of Case:
Plaintiff:	Defendant:	
1. N/A	N/A	N/A
2.		
3.		
4.		

**N. Use this space to provide any additional information or description of resources supporting Firm's qualifications for the proposed project. [Additional firm information to follow.](#)**

Grace Hebert Curtis Architects has extensive experience assisting municipalities in the planning and design of their facilities. We understand these types of projects are important because they provide a cornerstone for the community's sustained success. We are critical thinkers and creative problem solvers. We have experience working hand-in-hand with municipalities to make the most out of their allotted project budget. Our 50+ year municipal portfolio encompasses various project types including:

- [Police Stations](#)
- [Fire Stations](#)
- [Emergency Operations Centers](#)
- [911 Communication Centers](#)
- [Recreational Facilities](#)
- [Courthouses](#)
- [Council Chambers](#)
- [Community Theaters & Performing Arts](#)
- [Administration Buildings](#)
- [Warehouses](#)

We immerse ourselves in each client's culture to better understand their objectives, so on any given project we really are all on the same team. We listen, set goals, and arrive at the best solutions by working together.

**O. To the best of my knowledge, the foregoing is an accurate statement of facts.**

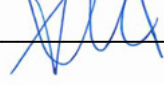
Signature:  Print Name: Alex Deshotels  
 Title: Partner, Architect Date: 12/19/2024



**Grace Hebert Curtis Architects** is dedicated to designing civic facilities that address the unique needs of municipalities and the communities they serve. We specialize in creating civic facilities that enrich lives, promote engagement, and serve as cornerstones for community growth. Whether its new construction or renovations, we design with purpose, ensuring every project contributes to strengthening the community.

## WE ARE LEADERS IN MUNICIPALITY DESIGN

Our firm has been engaged in the design of municipalities for 50+ years. Since 1970, GHC has designed over 200 different municipality projects, ranging in scale from minor renovations to completely new facilities. Given our expertise in municipality design, we understand the importance these projects play for public safety. We understand that there are unique aspects to every client and every project. We tap into our depth of expertise to balance those distinct characteristics with project parameters.

With more than 400 dedicated professionals, GHC, along with our talented team of consultants, has the capacity and resources to meet your project needs and provide excellent service. With many of our projects wrapping up construction documents, our production team is ready to work! We are available to commence services as the projects demand and/or immediately after selection. Our entire team commits the time and resources necessary to achieve the project goals and exceed your expectations.

## WHAT WE BRING TO THE TEAM

Our proven track record highlights our ability to create spaces that promote connection, engagement, and growth while improving quality of life. From community centers, schools, and libraries to administrative buildings and public safety spaces, we deliver functional and impactful designs tailored to each project's purpose.

Our approach emphasizes flexibility and adaptability, ensuring that the facilities we design can evolve with the changing needs of the community. By collaborating closely with Jefferson Parish stakeholders, we will develop thoughtful layouts and efficient operations that prioritize accessibility, sustainability, and long-term value. We look forward to partnering with Jefferson Parish to deliver state-of-the-art facilities that enhance the community and serve its residents for years to come.

**57**

Years in  
Business

**200+**

Municipal  
Projects

**COMMUNITY**

Centered  
Spaces



## Project Experience



## Ascension Parish Courthouse

Gonzales, LA | 103,017 SF

The spacious, state-of-the-art Ascension Parish Courthouse is designed to accommodate the current and future requirements of the Ascension Parish Court and the 23rd Judicial District Court. The new structure also houses a Fines Collection station operated by the Sheriff's Department and the Gonzales Police Department.

Through in-depth pre-design meetings, GHC learned that security was a primary driver. Hence, the design includes subtle, yet effective, separation between the public, detained individuals, and judicial and law enforcement staff. While broad expanses of glass are used along the exterior to draw natural light into the building, glass used strategically throughout the interior gives staff added security.





## Central City Hall

Central, LA | 14,000 SF

Central City Hall is a new facility for the City of Central. This building's prominent main entry opens into the spacious lobby adorned with wooden and neutral accents, creating an inviting atmosphere for citizens. The facility's large council room is designed for hearings and other civic matters, along with offices dedicated to all city services.



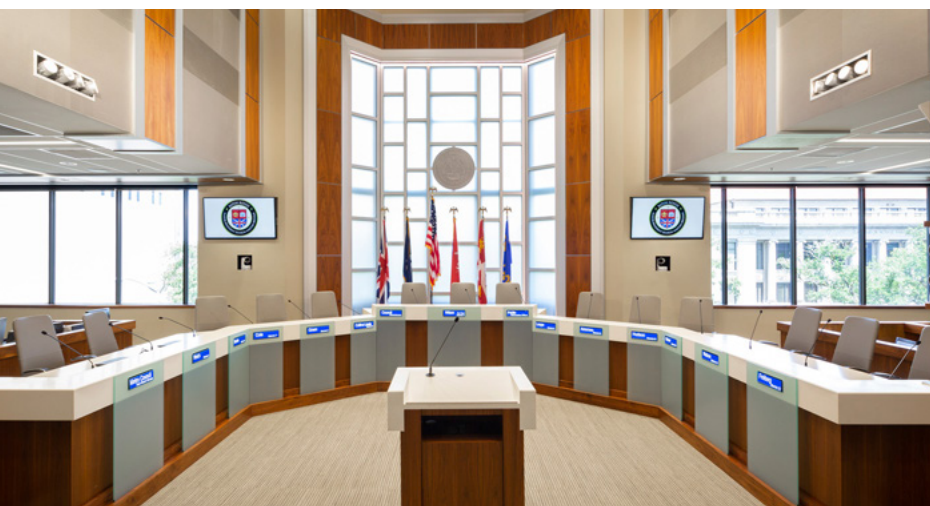

BEFORE

## East Baton Rouge Council Chambers Renovations

Baton Rouge, LA | 4,050 SF

East Baton Rouge Metropolitan Council Chambers located in City Hall underwent a major renovation to provide the public with greater opportunity to observe deliberations and participate in the Council's proceedings. The new space provides more public seating, new voting equipment, and a state-of-the-art audio-visual system. The renovation brings the 1970s era space into the 21st century rich with technology while creating a sense of stateliness and reverence using timeless materials.





## Ascension Parish 911 Center & Substation

Gonzales, LA | 17,026 SF

Funded through state grant money, the Ascension Parish 911 Center & Substation improves the Sheriff's services for the fast growing community. With the objective to better serve the growing community, the Ascension Parish Sheriff's Office worked with GHC to develop a new Sheriff's Substation, featuring a public lobby space with ancillary consultation room, office space with a squad briefing room and adjacent computer station lab for uniformed officers, a booking facility with evidence processing and storage, departmental offices for the Narcotics and Go-team divisions, as well as civil case processing and administrative support offices. The project also includes a separate facility for a state-of-the-art 911 Communication Center, planned to the most current specialized design criteria, and outfitted with a high-performance raised access flooring system providing flexibility for changing needs with minimal operational disruption.





## Gert Town Natatorium

New Orleans, LA | 13,268 SF

In order to meet the varying needs of the community, the pool has six lanes, seating for spectators, as well as a zero-depth ramped accessible entry, to allow people at various levels of ability to be able to use the pool. The lobby has a tall glass lantern, to serve as a beacon, bringing people on from across the neighborhood and across the city to the door. The design team treated the natatorium into two parts. The high-ceilinged natatorium itself was built to stand up to the high temperatures, humidity, and associated corrosion inherent in indoor pools. The adjacent entry lobby was free of these considerations allowing for more standard construction and intricate detailing to welcome the community.



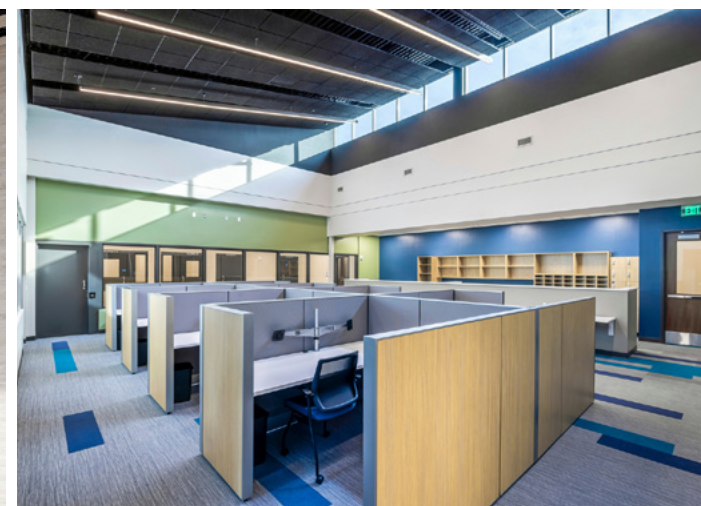
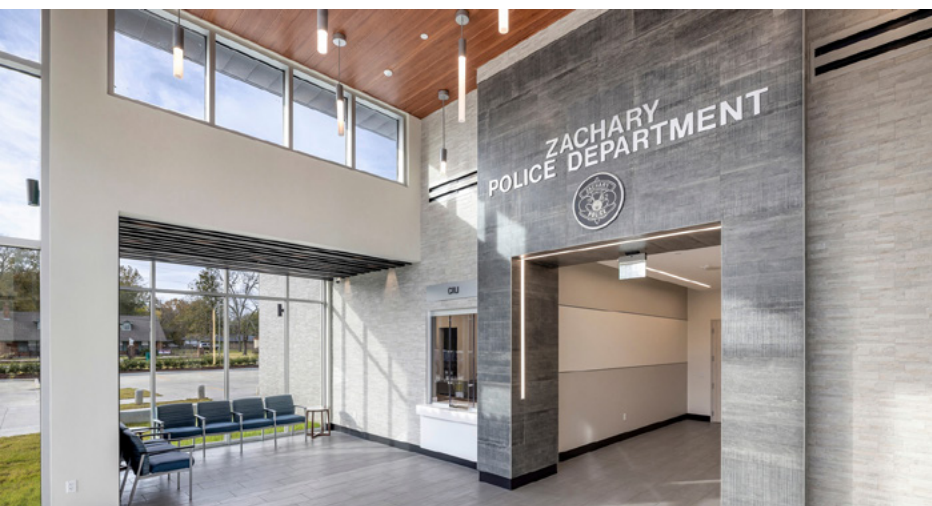

## Zachary Police Department and Training Center

Zachary, LA | 21,300 SF

The new Zachary Police Department was designed to have an inviting, civic presence while providing a safe, durable, secure environment. The new headquarters addresses security, department workflows, and technical design requirements while providing a welcoming lobby, flexible training, and educational spaces for employees. The design features focused materiality and transparency to provide an open and inviting atmosphere, while the placement of glazing at high locations provide daylight to internal spaces during the day and illuminating the building at night. The building provides a visual screen to the secure functions that happen within its walls. Its street frontage is comprised of soft and hard landscaping that provides building security and forms a public plaza leading entry.





## Hahnville Branch Library

Hahnville, LA | 15,047 SF

The Hahnville Branch Library, part of the St. Charles Parish Public Library system, will be located adjacent to the Mississippi River with convenient levee access for the community. Spanning 15,047 square feet, the library will feature dedicated spaces for children, teens, and adults, as well as the Parish's Louisiana Room, which will focus on state and local history, including genealogy. Its proximity to the Clerk of Court and Parish Archives will provide patrons with enhanced resources for researching and exploring local history. This new, modern facility will not only improve access to historical materials but also offer a variety of indoor and outdoor spaces designed for both small and large group meetings and events, serving as a vibrant community center for the surrounding area.





## Ochsner at Clearview Center

Metairie, LA | 202,000 SF

Ochsner at Clearview Center is an innovative “super clinic” that offers numerous health and wellness services under one expansive roof. The three-level facility (a former Sears department store) comprises of primary and specialty care clinics as well as an outpatient surgical unit with eight operating rooms, a drive-thru pharmacy, endoscopy suites, a health and wellness spa, and a 10-bed micro-hospital. GHC showcases its industry expertise by seamlessly integrating multiple specialties while adhering to a compressed design and construction schedule. The design team develops a high-end aesthetic with a finish palette that blends naturally inspired materials with Ochsner's signature color and branding elements. Honoring the facility's wellness mission, staff and guests enjoy natural light and an open, airy environment.





## Bernhard Office Renovation

Metairie, LA | 36,000 SF

The project expertly transformed an existing structure, which had seen a wide variety of former tenants, into a strategically branded corporate office space. The primary impetus for the project was to consolidate the majority of Bernhard's workforce into one location to promote collaboration. Relocating to the 36,000-square-foot space also gave the firm an opportunity to modernize with a more open office environment. Staff focused spaces create the central hub for teaming and collaborative sessions while providing opportunities for individual and small group meetings. Dynamic open workspaces allow employees the freedom to move and share ideas. A new mezzanine maximizing unused vertical space allowed for separation of departments that require a quiet environment.





## New K-8 School for Jefferson Parish

Metairie, LA | 127,000 SF

The new Jefferson Parish school is thoughtfully designed to accommodate up to 1,000 students from pre-K through 8th grade. Featuring a modern “pod” concept, the layout utilizes a spoke-and-wheel design, where clusters of four or more classrooms are connected to a shared common area with its own dedicated entrance. These common areas are equipped with a science lab and flexible furniture, fostering dynamic learning opportunities like small-group instruction. Additionally, the innovative “pod” design prioritizes safety, incorporating enhanced security measures to ensure student protection in emergencies.

# Continuation of Team Resumes

## TEC Professional Services Questionnaire

KEY PERSON, SPECIALIST, OR INDIVIDUAL CONSULTANT:	
<b>Name &amp; Title:</b> <b>Lauren Thompson</b> Designer	
<b>Project Assignment:</b> Designer - Interiors	
<b>Name of Firm with which associated:</b> Grace Hebert Curtis Architects, LLC	
<b>Years' experience with this Firm:</b> 2	
<b>Education: Degree(s)/Year/Specialization:</b> Bachelor, Interior Design, Louisiana State University, 2023	
<b>Active registration: Year first registered/discipline:</b> N/A	
<b>Other experience and qualifications relevant to the proposed Project:</b> <ul style="list-style-type: none"> <li>Central City Hall; Central, LA</li> <li>Hahnville High School Triple A - Alumni Center; Luling, LA</li> <li>Breast Center of Excellence; Baton Rouge, LA</li> <li>Richland Parish Hospital; Delhi, LA</li> <li>St. Helena Parish Hospital; Greensburg, LA</li> <li>Tulane Tidewater Clinical Trials Space Expansion; New Orleans, LA</li> </ul>	

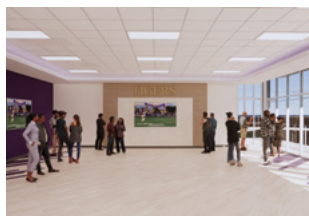



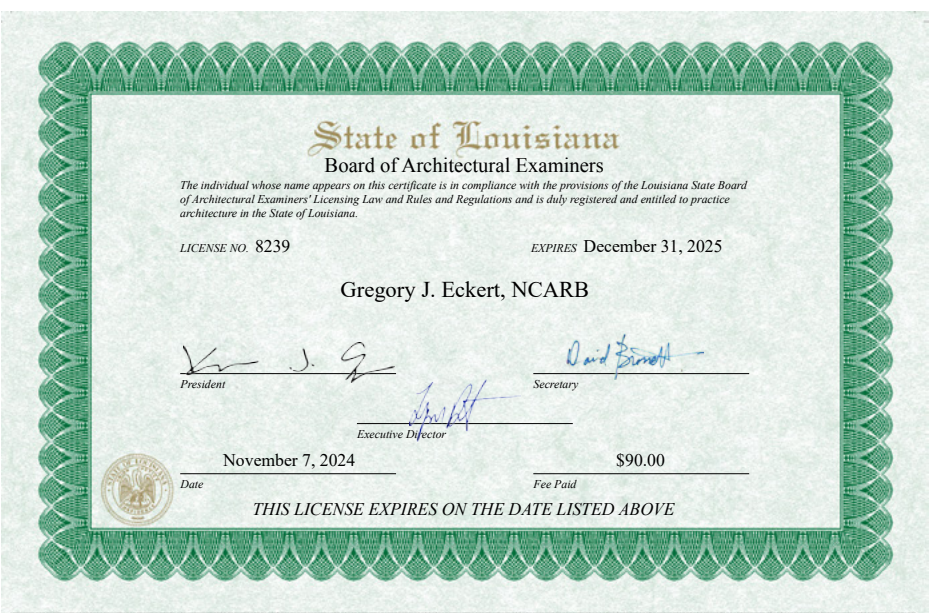

# Huseman & Associates TEC Professional Services Questionnaire

## TEC Professional Services Questionnaire

### A. Project Name and Advertisement Resolution Number:

Miscellaneous Architectural & Engineering Services on an As-Needed basis  
SOQ 24-036

### B. Firm Name & Address:

Huseman & Associates, LLC  
3501 N. Causeway Blvd.  
Suite 710  
Metairie, LA 70002

### C. Name, title and contact information of Principal, as defined in Section 2-926 of the Jefferson Parish Code of Ordinances, who is a registered, licensed architect, professional engineer, or surveyor in the State of Louisiana:

Jason Chauvin, P.E.  
Principal / Vice-President

### D. Name and contact information of employee who is a registered and licensed architect, professional engineer, or surveyor in the State of Louisiana in the applicable discipline. A subcontractor may be substituted here only if the advertised Project requires more than one discipline.

Jason Chauvin, P.E.  
Principal / Vice-President

### E. Please provide the number of employees whose primary function corresponds with each category:

<u>2</u> Administrative	___ Estimators	___ Specification Writers
___ Architects (Licensed)	___ Geologists	___ Structural Engineers
___ Chemical Engineers	___ Geotechnical Engineers	___ Graduate Engineers
___ Civil Engineers	___ Interior Designers	<u>1</u> Project Managers
___ Construction Inspectors	___ Landscape Architects	___ Clerical
___ Ecologists	___ Land Surveyor	___ Grant/Funding Specialist
<u>3</u> Electrical Engineers	<u>4</u> Mechanical Engineers	___ Sanitary Engineers
<u>1</u> Engineer Intern	___ Environmental Engineers	
___ Professional Land Surveyors		<u>11</u> TOTAL

### F. Is this submittal by a JOINT-VENTURE? Please check: YES ☐ NO ☒

If marked "No" skip to Section I. If marked "yes" complete Sections G-H.



### TEC Professional Services Questionnaire

**G. If submittal is by JOINT-VENTURE, list the firms participating and outline specific areas of responsibility (including administrative, technical, and financial) for each firm. Please attach additional pages if necessary.**

1. N/A

2. N/A

**H. Has this JOINT-VENTURE previously worked together? Please check:**

YES ☐ NO ☐ N/A

**I. List all subcontractors anticipated for this Project. Please note that all subcontractors must submit a fully completed copy of this questionnaire, applicable licenses, and any other information required by the advertisement. See Jefferson Parish Code of Ordinances, Sec. 2-928(a)(3). Please attach additional pages if necessary.**

Name & Address:	Specialty:	Worked with Firm Before (Yes or No):
1. N/A	N/A	N/A
2. N/A	N/A	N/A
3. N/A	N/A	N/A

**J. Please specify the total number of support personnel that may assist in the completion of this Project:**

\_\_\_\_\_

### TEC Professional Services Questionnaire

**K. List the professional in charge, key persons, specialists, and individual consultants anticipated for this Project and provide their relevant information below. If necessary, please attach additional documentation (i.e. resume) that demonstrates the employment history and experience of the Firm's key persons that may assist in the completion of this Project. Please attach additional pages if necessary.**

#### **PROFESSIONAL IN CHARGE OF PROJECT:**

**Name & Title:**

Jason Chauvin, P.E.  
Vice-President  
Director of Electrical Engineering

**Project Assignment:**

Director of Electrical Engineering

**Name of Firm with which associated:**

Huseman & Associates, LLC

**Years' experience with this Firm:**

18

**Education: Degree(s)/Year/Specialization:**

Bachelor of Science in Electrical Engineering (with honors)  
Tulane University, 2002

**Active registration: Year first registered/discipline:**

Louisiana-PE #32838-2006  
TX-PE #147337-2023 / MS-PE #33584-2023 / AL-PE #52169-2023

**Other experience and qualifications relevant to the proposed Project:**

As the head of the electrical engineering department for Huseman & Associates, Mr. Chauvin has extensive expertise in the design and implementation of power systems, load analyses, one-line diagrams, electrical schematics, fire alarm systems, and circuit breaker coordination. He has extensive experience in the design and construction of a variety of electrical design and construction projects. He specializes in the creation and implementation of designs that eliminate facility interruption, is constructible, and easy to understand and maintain. Mr. Chauvin has extensive experience in performance and sustainability and was part of one of New Orleans' first NetZero buildings.

### TEC Professional Services Questionnaire

<b>KEY PERSON, SPECIALIST, OR INDIVIDUAL CONSULTANT:</b>
<b>Name &amp; Title:</b>
Pedro Gomez, P.E., LEED AP BD+C Supervising Senior Mechanical Engineer/Project Manager
<b>Project Assignment:</b>
Supervising Senior Mechanical Engineer
<b>Name of Firm with which associated:</b>
Huseman & Associates, LLC
<b>Years' experience with this Firm:</b>
15 years
<b>Education: Degree(s)/Year/Specialization:</b>
Bachelor of Science in Mechanical Engineering Tulane University, 1994
<b>Active registration: Year first registered/discipline:</b>
Louisiana-PE #36027-2011 Texas-PE #101616-2008 \ Mississippi-PE #31786-2021
<b>Other experience and qualifications relevant to the proposed Project:</b>
As a mechanical engineer for Huseman & Associates, Mr. Gomez has expertise in mechanical design engineering and project management. He has extensive construction industry experience in commercial and industrial facilities including office buildings, educational building, research laboratory facilities, as well as water and wastewater treatment facilities.

### TEC Professional Services Questionnaire

<b>KEY PERSON, SPECIALIST, OR INDIVIDUAL CONSULTANT:</b>
<b>Name &amp; Title:</b>
Jamey Logrande President and Director of Mechanical Group
<b>Project Assignment:</b>
Principal, Senior Designer, Project Manager
<b>Name of Firm with which associated:</b>
Huseman & Associates, LLC
<b>Years' experience with this Firm:</b>
19 years
<b>Education: Degree(s)/Year/Specialization:</b>
Studies in Mechanical Engineering, University of New Orleans
<b>Active registration: Year first registered/discipline:</b>
<b>Other experience and qualifications relevant to the proposed Project:</b>
As President and Director of the Mechanical Group, Mr. Logrande has been extensively involved in the conceptual design and oversees the design of mechanical systems for all mechanical projects for Huseman & Associates. With over 29 years of experience in project management, design and construction administration of commercial, institutional, municipal, and light industrial facilities, Mr. Logrande performs all project management for the mechanical systems for all projects.

### TEC Professional Services Questionnaire

<b>KEY PERSON, SPECIALIST, OR INDIVIDUAL CONSULTANT:</b>
<b>Name &amp; Title:</b>
Thomas Burger, P.E. Mechanical Engineer
<b>Project Assignment:</b>
Mechanical Engineering
<b>Name of Firm with which associated:</b>
Huseman & Associates, LLC
<b>Years' experience with this Firm:</b>
2 years
<b>Education: Degree(s)/Year/Specialization:</b>
Bachelor of Science in Mechanical Engineering University of Wyoming, 2018
<b>Active registration: Year first registered/discipline:</b>
Louisiana – PE #48892
<b>Other experience and qualifications relevant to the proposed Project:</b>
Mr. Burger has experience in commercial, industrial, and institutional applications, with a focus on coordination, detail, and collaboration with engineers, clients, and contractors in balancing client needs with constructability. His expertise has expertise in mechanical design engineering and project management, performing field investigations, and establishing and maintaining project and internal design standards. His experience ranges from hi-rise tenant building renovations, schools, hospitals, hotels, shopping malls, apartment complexes, prisons, courthouses and central plants.

**TEC Professional Services Questionnaire**

<b>KEY PERSON, SPECIALIST, OR INDIVIDUAL CONSULTANT:</b>
<b>Name &amp; Title:</b>
N/A
<b>Project Assignment:</b>
N/A
<b>Name of Firm with which associated:</b>
N/A
<b>Years' experience with this Firm:</b>
N/A
<b>Education: Degree(s)/Year/Specialization:</b>
N/A
<b>Active registration: Year first registered/discipline:</b>
N/A
<b>Other experience and qualifications relevant to the proposed Project:</b>
N/A

## TEC Professional Services Questionnaire

**L. Work by Firm or Joint-Venture members which best illustrates current qualifications relevant to this Project. Please include any and all work performed for Jefferson Parish. Please attach additional pages if necessary.**

### **PROJECT NO. 1**

<b>Project Name, Location and Owner's contact information:</b>	<b>Nature of Firm's Responsibility:</b>	
Washington Elementary - UNO   Kenner, LA	A new 126,300 SF K-8 school is currently being built. H&A designed the MEPFP and special systems for the project and are currently providing construction administration.	
<b>Completion Date (Actual or estimated):</b>	<b>Estimated Cost:</b>	
	<b>Entire Project:</b>	<b>Work for which Firm was Responsible:</b>
JUL 2026	\$47.7 million	\$17.6 million

### **PROJECT NO. 2**

<b>Project Name, Location and Owner's contact information:</b>	<b>Nature of Firm's Responsibility:</b>	
Charity Hospital Redevelopment Tulane University New Orleans, LA	Renovate the LaSalle wing of Charity Hospital consisting of approximately 330,431 sf. The renovation is comprised of new educational and research spaces. 87,000 sf of offices and laboratories, 89,000 sf learning commons, and 155,000 sf of office space. The bottom 3 floors will include a large-scale auditorium, national museum of public health, and commercial teaching kitchen. The landlord providing an empty core and shell and providing a separately metered chilled water connection, metered service steam capacity, and metered electrical capacity. The design team is to design all MEP distribution from landlord points of connect to the renovated areas end devices/equipment. The design will meet LEED Silver certification requirements.	
<b>Completion Date (Actual or estimated):</b>	<b>Estimated Cost:</b>	
	<b>Entire Project:</b>	<b>Work for which Firm was Responsible:</b>
2028	\$120 million	\$40 million

### TEC Professional Services Questionnaire

<b>PROJECT NO. 3</b>		
Project Name, Location and Owner's contact information:	Nature of Firm's Responsibility	
Teche Action Clinic Gramercy, LA	Teche Action is currently in design for a new 10,000 sq. ft. facility in Gramercy to expand its primary, preventative, mental health, dental and pharmacy services. The clinic will house exams rooms, offices, lobby/waiting area, dental exam rooms, in-house pharmacy, behavioral health department, administrative services, adult and pediatric medical services, women's health department, WIC and nutritional departments, diagnostic lab services and a patient assistance center.	
Completion Date (Actual or estimated)	Estimated Cost:	
	Entire Project:	Work for which Firm was Responsible:
DEC 2025	\$4 million	\$1 million

<b>PROJECT NO. 4</b>		
Project Name, Location and Owner's contact information:	Nature of Firm's Responsibility:	
St. James Parish Hospital Lutcher, LA	H&A designed construction documents addressing damages to HVAC rooftop equipment caused by hurricane Ida per FEMA P/W for both the hospital and medical plaza buildings' roofs.	
Completion Date (Actual or estimated):	Estimated Cost:	
	Entire Project:	Work for which Firm was Responsible:
JAN 2026	\$3.7 million	\$3.7 million



### **TEC Professional Services Questionnaire**

<b>PROJECT NO. 5</b>		
<b>Project Name, Location and Owner's contact information:</b>	<b>Nature of Firm's Responsibility:</b>	
Ochsner Health Center Baton Rouge, LA	Huseman & Associates provided MEP design services for the 50% DD set in a Bridging Documents contract under Grace Hebert Curtis Architects. H&A then continued as the MEP engineers with the selected subcontractors. The project included two buildings and had multiple features including medical office building, surgical center, imaging, two chemo mixing laboratories and pharmacies. The facility also serves as a micro hospital. The design process was advantageous for the owner's compressed schedule and aided in attaining pricing and scheduling plans prior to a full bidding process for construction.	
<b>Completion Date (Actual or estimated):</b>	<b>Estimated Cost:</b>	
	<b>Entire Project:</b>	<b>Work for which Firm was Responsible:</b>
2019	\$100 million	\$35 million

<b>PROJECT NO. 6</b>		
<b>Project Name, Location and Owner's contact information:</b>	<b>Nature of Firm's Responsibility:</b>	
Jefferson Parish Forensic Laboratory Harvey, LA	Huseman & Associates provided MEP design services for the Jefferson Parish Sheriff's Department Forensic Crime Lab. The building is a 45,000 sf, four-story building with two full floors of forensic laboratory space. The building houses the department's crime scene division, DNA lab, forensic lab, photo lab, and latent print technicians.	
<b>Completion Date (Actual or estimated):</b>	<b>Estimated Cost:</b>	
	<b>Entire Project:</b>	<b>Work for which Firm was Responsible:</b>
2010	\$16 million	\$5.4 million

## TEC Professional Services Questionnaire

<b>PROJECT NO. 7</b>		
<b>Project Name, Location and Owner's contact information:</b>	<b>Nature of Firm's Responsibility:</b>	
St. Charles Parish Courthouse 2 <sup>nd</sup> Floor Renovation Hahnville, LA	22,000 sf renovation of the entire 2nd floor, including three courtrooms and associated judge chambers, jury rooms, offices, and the build-out of the Sheriff's Office space. The entire MEP system serving the 2nd floor was replaced, including two new chilled water air handling units and new hydronic VAVs.	
<b>Completion Date (Actual or estimated):</b>	<b>Estimated Cost:</b>	
	<b>Entire Project:</b>	<b>Work for which Firm was Responsible:</b>
2024	\$6.5 million	

<b>PROJECT NO. 8</b>		
<b>Project Name, Location and Owner's contact information:</b>	<b>Nature of Firm's Responsibility:</b>	
Tulane University National Primate Research Center – New Office Building Covington, LA	New 10,300 sf office building for laboratory research staff. The building includes 2 departmental suites with private and open offices, multi-purpose spaces, break rooms, and support areas. The building design meets IECC 2021.	
<b>Completion Date (Actual or estimated):</b>	<b>Estimated Cost:</b>	
	<b>Entire Project:</b>	<b>Work for which Firm was Responsible:</b>
2025	\$3.5 million	\$1.2 million

## TEC Professional Services Questionnaire

<b>PROJECT NO. 9</b>		
<b>Project Name, Location and Owner's contact information:</b>	<b>Nature of Firm's Responsibility:</b>	
New Orleans Fire Department Headquarters New Orleans, LA	Complete renovation of the existing two story, 20,075 sf building on City Park Ave. The project includes an executive suite for the NOFD superintendent and their support staff. It has a large open office for the administration staff and another for the inspection staff. It includes a critical operations conference room. There is also a fireman sleeping quarters that includes a dayroom, fitness area, locker room, and fully operational commercial kitchen.	
<b>Completion Date (Actual or estimated):</b>	<b>Estimated Cost:</b>	
	<b>Entire Project:</b>	<b>Work for which Firm was Responsible:</b>
2025	\$8.3 million	\$2.9 million

<b>PROJECT NO. 10</b>		
<b>Project Name, Location and Owner's contact information:</b>	<b>Nature of Firm's Responsibility:</b>	
N/A	N/A	
<b>Completion Date (Actual or estimated):</b>	<b>Estimated Cost:</b>	
	<b>Entire Project:</b>	<b>Work for which Firm was Responsible:</b>
N/A	N/A	N/A

## TEC Professional Services Questionnaire

<b>M. List all prior and/or on-going litigation between Firm and Jefferson Parish. Please attach additional pages if necessary.</b>		
Parties:		Status/Result of Case:
Plaintiff:	Defendant:	
1.  N/A	N/A	N/A
2.  N/A	N/A	N/A
3.  N/A	N/A	N/A
4.  N/A	N/A	N/A
<b>N. Use this space to provide any additional information or description of resources supporting Firm's qualifications for the proposed project.</b>		
<div style="text-align: center;">N/A</div>		
<b>O. To the best of my knowledge, the foregoing is an accurate statement of facts.</b>		
<b>Signature:</b>		<b>Print Name:</b> Jason Chauvin, PE
Vice-President		12/13/2024
<b>Title:</b> _____		<b>Date:</b> _____

	<b>LOUISIANA PROFESSIONAL ENGINEERING &amp; LAND SURVEYING BOARD (LPELS)</b>	
	9643 Brookline Avenue, Suite 121 Baton Rouge, LA 70809 Phone (225) 925-6291 www.lapels.com	
<b>Mr. Jason Michael Chauvin</b>		
License/Certificate Type - Number	Expiration Date	
<b>PE.0032838</b>	<b>03/31/2025</b>	
<b>Status: Active</b>		

Please be advised that your license must be in "Active" status in order for you to (a) provide or offer to provide engineering or land surveying services in Louisiana or (b) use the words "engineer", "engineering", "land surveyor", "land surveying" or any modification or derivative thereof in your name or in connection with your business or activities in Louisiana. Licensees whose licenses are in "Retired", "Inactive", or "Expired" status are prohibited from engaging in the activities described above in items (a) and (b).

LA R. S. 37:689 requires firms practicing or offering to practice engineering or land surveying in the state of Louisiana to be licensed by the Board prior to offering such services.

# Infinity Engineering TEC Professional Services Questionnaire

## TEC Professional Services Questionnaire

### A. Project Name and Advertisement Resolution Number:

**Miscellaneous Architecture and Engineering Services on an As-Needed Basis  
Resolution No. 145324**

### B. Firm Name & Address where Project work will be performed:

**Infinity Engineering Consultants, LLC**  
4001 Division St.  
Metairie, LA 70002

### C. Name, title and contact information of Principal, as defined in Section 2-926 of the Jefferson Parish Code of Ordinances, who is a registered, licensed architect, professional engineer, or surveyor in the State of Louisiana:

**Raoul V. Chauvin, III, P.E.**  
Principal  
504-304-0548  
rchauvin@infinityec.com

### D. Name and contact information of employee who is a registered and licensed architect, professional engineer, or surveyor in the State of Louisiana in the applicable discipline. A subcontractor may be substituted here only if the advertised Project requires more than one discipline.

**William J. Thomassie, P.E.**  
Principal  
Civil/Structural Engineering Advisor  
504-304-0548  
wthomassie@infinityec.com

### E. Please provide the number of employees whose primary function corresponds with each category:

<u>4</u> Administrative	<u>      </u> Estimators	<u>      </u> Specification Writers
<u>      </u> Architects (Licensed)	<u>      </u> Geologists	<u>3</u> Structural Engineers
<u>      </u> Chemical Engineers	<u>      </u> Geotechnical Engineers	<u>3</u> Graduate Engineers
<u>3</u> Civil Engineers	<u>      </u> Interior Designers	<u>      </u> Project Managers
<u>4</u> Construction Inspectors	<u>      </u> Landscape Architects	<u>1</u> Clerical
<u>      </u> Ecologists	<u>      </u> Land Surveyor	<u>      </u> Grant/Funding Specialist
<u>2</u> Electrical Engineers	<u>3</u> Mechanical Engineers	<u>      </u> Sanitary Engineers
<u>4</u> Engineer Intern	<u>      </u> Environmental Engineers	<u>9</u> Drafting/Design
<u>      </u> Professional Land Surveyors		<u>36</u> TOTAL

### F. Is this submittal by a JOINT-VENTURE? Please check: YES ☐ NO ☒

If marked "No" skip to Section I. If marked "yes" complete Sections G-H.

## TEC Professional Services Questionnaire

<b>G. If submittal is by JOINT-VENTURE, list the firms participating and outline specific areas of responsibility (including administrative, technical and financial) for each firm. Please attach additional pages if necessary.</b>		
1.		
2.		
<b>H. Has this JOINT-VENTURE previously worked together? Please check:</b> YES <input type="checkbox"/> NO <input type="checkbox"/>		
<b>I. List all subcontractors anticipated for this Project. Please note that <u>all subcontractors must submit a fully completed copy of this questionnaire</u>, applicable licenses, and any other information required by the advertisement. See Jefferson Parish Code of Ordinances, Sec. 2-928(a)(3). Please attach additional pages if necessary.</b>		
<b>Name &amp; Address:</b>	<b>Specialty:</b>	<b>Worked with Firm Before (Yes or No):</b>
1.  Please See Prime's Form		
2.		
3.		
4.		
5.		
6.		
<b>J. Please specify the total number of support personnel that may assist in the completion of this Project:</b>  <b>16</b> It is possible for upwards of sixteen Infinity personnel to be qualified to work on projects involving civil/structural elements.		



## TEC Professional Services Questionnaire

<b>K. List the professional in charge, key persons, specialists, and individual consultants anticipated for this Project and provide their relevant information below. If necessary, please attach additional documentation (i.e. resume) that demonstrates the employment history and experience of the Firm's key persons that may assist in the completion of this Project. Please attach additional pages if necessary.</b>	
<b>PROFESSIONAL IN CHARGE OF PROJECT:</b>	
<b>Name &amp; Title:</b>	<b>William J. Thomassie, P.E.</b> Principal
<b>Project Assignment:</b>	Principal-in-Charge; Civil/Structural Engineering Advisor
<b>Name of Firm with which Associated:</b>	<b>Infinity Engineering Consultants, LLC.</b>
<b>Years' experience with this Firm:</b>	20
<b>Education: Degree(s)/Year/Specialization:</b>	Bachelor of Science / 1992 / Civil/Structural Engineering
<b>Active registration: Year first registered/discipline:</b>	Professional Engineer – Civil Engineering LA / 1997 / Civil
<b>Other experience and qualifications relevant to the proposed Project:</b>	
<u><b>Delgado Community College Student Pavilion – New Orleans, LA</b></u> Supervised the complete structural design of the 1,164 sq ft new shelter. Structural designs included a timber pile foundation, welded hollow tubing sub-structure, and glulam timber super-structure/roof. The shelter will be accessed via a concrete walkway path leading to steps and a handicap ramp.	
<u><b>Mahalia Jackson Theater of Performing Arts – New Orleans, LA</b></u> Lead Civil/Structural Engineer for the emergency repair of the Mahalia Jackson Theater of Performing Arts in Orleans Parish. Engineered designs and incorporated components to mitigate future weather-related damage to equipment. Provided detailed structural design for new stage lift systems.	
<u><b>Regional Transit Authority Canal Street Ferry Terminal Replacement – New Orleans, LA</b></u> Principal for the engineering design of the demolition and redevelopment of the Canal Street Ferry Terminal on the Mississippi River in New Orleans for the RTA. The project includes the construction of a new terminal building, reconfiguration of streetcar tracks, realignment of underground utilities, construction of a new wharf structure, and refurbishment and reconfiguration of a captive barge platform.	
<u><b>Jefferson Parish East Bank Maintenance Facility – Jefferson Parish, LA</b></u> Lead structural engineer for the new East Bank Maintenance Facility foundation and building. This two-story building was designed to serve as an emergency shelter for critical Parish personnel during hurricane season.	
<u><b>O'Brien Fire Station New Facility Design – Plaquemines Parish, LA</b></u> Engineering manager for the O'Brien Fire Station, a new facility in Port Sulphur designed to replace a fire station destroyed during Hurricane Katrina. Infinity was responsible for the design of all structural, electrical, and mechanical systems associated with the fire house, including elevated platforms to protect the electrical systems from flood.	
<u><b>Lake Hermitage Fire Station Complete Replacement Design – Lake Hermitage, LA</b></u> Engineering Manager for the Lake Hermitage Fire Station, a new facility designed to replace a fire house destroyed by Hurricane Katrina. The fire station was located in a FEMA FIRM V-Zone, outside of hurricane protection levees, requiring intensive structural design. The final structure was a combination of concrete framework and structural steel clad with concrete masonry units.	

## TEC Professional Services Questionnaire

<b>KEY PERSON, SPECIALIST, OR INDIVIDUAL CONSULTANT:</b>
<b>Name &amp; Title:</b>
<b>Rachel Kenney, P.E.</b> Chief Engineer
<b>Project Assignment:</b>
Chief Engineer & Facility Structural Engineer
<b>Name of Firm with which Associated:</b>
<b>Infinity Engineering Consultants, LLC.</b>
<b>Years' experience with this Firm:</b>
14
<b>Education: Degree(s)/Year/Specialization:</b>
Bachelor of Science / 2001 / Civil Engineering
<b>Active registration: Year first registered/discipline:</b>
Professional Engineer – Civil Engineering LA / 2013 / Civil
<b>Other experience and qualifications relevant to the proposed Project:</b>
<p><b><u>Percy Griffin Community Center Structural Design– Davant, LA</u></b> Managed a project team for the Structural, Mechanical, and Electrical design of the 14,000 sq ft community center. Responsible for project management, structural design, and construction administration. The building was designed to withstand Category 4 hurricane force winds and included a main floor elevation above the Base Flood Elevation (14'-2").</p> <p><b><u>St. Bernard School Board Maintenance Building – Chalmette, LA</u></b> Project Engineer responsible for the structural engineering design for the new 100,000 sq ft. maintenance facility and storage warehouse. The project included the design of steel framing, masonry structures, and a pile supported concrete foundation and had FEMA allocated funds. The design considered loading from hurricane force winds and loads from equipment and vehicles. The building is used to repair the school boards' cars and buses.</p> <p><b><u>RTA Canal Street Ferry Terminal – New Orleans, Louisiana</u></b> Managed a multidisciplinary team of designers working with the Owner's Contractor to determine the most cost-effective design that would satisfy project and grant requirements. The project included: a steel pile supported wharf with concrete beams and hollow core concrete panels; a timber pile supported, steel framed terminal building; two steel framed stair/elevator towers connected by a prefabricated steel truss bridge spanning (2) railroad tracks; and half grand union with catenary system.</p> <p><b><u>Plaquemines Parish Government Lake Hermitage Firehouse – Lake Hermitage, LA</u></b> Project Manager responsible for managing a project team for the Structural, Mechanical, and Electrical design of the new 3,200 sq ft firehouse. Responsible for project management, structural design, and construction administration for pile supported building, which has a first-floor elevation above the Base Flood Elevation (17'-2") and is designed to withstand Category 4 hurricane force winds. Foundation design included review of geotechnical reports.</p> <p><b><u>Sewerage &amp; Water Board Wastewater Treatment Administration Building Design – New Orleans, LA</u></b> Managed a project team for the mechanical, electrical, and structural design of the 5,000 sq ft administration building. Responsible for project management, structural design, and construction administration.</p> <p><b><u>St. Claude Avenue Sheriff's Substation – Arabi, LA</u></b> Project Structural Engineer for the design of a new 3-story criminal sheriff's administration building, incorporating high security aspects as required by the St. Bernard Parish Sheriff's Department. The building consists of steel-reinforced concrete with the bottom of the second floor above the BFE.</p>

## TEC Professional Services Questionnaire

<b>KEY PERSON, SPECIALIST, OR INDIVIDUAL CONSULTANT:</b>	
<b>Name &amp; Title:</b>	
<b>Ricardo Contreras, P.E.</b> Civil/Structural Engineering Manager	
<b>Project Assignment:</b>	
Site Civil Engineer	
<b>Name of Firm with which Associated:</b>	
<b>Infinity Engineering Consultants, LLC.</b>	
<b>Years' experience with this Firm:</b>	
7	
<b>Education: Degree(s)/Year/Specialization:</b>	
Bachelor of Science / 1994 / Civil Engineering	
<b>Active registration: Year first registered/discipline:</b>	
Professional Engineer – Civil Engineering LA / 1999 / Civil      FL / 2006 / Civil	
<b>Other experience and qualifications relevant to the proposed Project:</b>	
<p><b><u>Belle Chasse Primary Pre-K – 1 - Plaquemines Parish School Board – Belle Chasse, LA</u></b> Designed 9.03-acre site for new primary school, including clearing, grading, concrete surface parking lots, domestic and fire water distribution systems, gas lines, sewer system, and a new sewer treatment.</p> <p><b><u>Lafayette Academy Elementary School Renovations – New Orleans, LA</u></b> Provided structural analysis and design for renovations to an existing 100-year-old concrete structure. Modifications included the demolition of existing stairs, slabs, foundations, and beams for construction of a new 3 stop elevator, including the shaft and pit structures. Additional modifications to the existing building included the addition of two separate HVAC equipment frames, one over the main roof and the other over the cafeteria, and design of two chiller structural support frames.</p> <p><b><u>St. Augustine High School Building Renovations – New Orleans, LA</u></b> Technical lead responsible for plan preparation for the underside of the first floor of the original school building. Also reviewed and developed structural options at different locations for the support of the A/C units.</p> <p><b><u>Ben Franklin Elementary School Renovations – New Orleans, LA</u></b> Oversaw Infinity's engineering services for structural modifications and repairs to the existing exterior structural brick walls of the school, wooden floors, ceiling, and roof framing, and the addition of a new elevator. Designs included:</p> <ul style="list-style-type: none"> <li>• Repair/replacement of the existing brick at select designated locations</li> <li>• Repair details for damaged floor and ceiling joists</li> <li>• Performing a detailed non-destructive survey of the existing roof framing system and provided repair details</li> <li>• Specifications on drawings for the addition of an elevator system, which included modifications to the existing building foundation and floor framing</li> </ul> <p><b><u>Dillard University Campus Improvements – New Orleans, LA</u></b> Responsible for the improvements and upgrades to multiple systems throughout the Dillard University campus. The project ranged from civil road work to electrical lighting and low voltage communications systems. The designs included the removal of an existing guard shack to realign the entrance and intersecting roads to provide access control via a new guard shack. The roadway realignment also included widened the existing roadway, drainage modifications, roadway curbs, sidewalks, and building landing.</p> <p><b><u>RTA Napoleon Facility Rehabilitation – New Orleans, LA</u></b> Responsible for the structural inspection of the 100-year-old, 11,000 square foot historic building. Additionally, the roof system was inspected to determine its integrity. Designs were created to rehabilitate and modernize the building, with selective demolition plans.</p>	

## TEC Professional Services Questionnaire

<b>KEY PERSON, SPECIALIST, OR INDIVIDUAL CONSULTANT:</b>
<b>Name &amp; Title:</b>
<b>Cindy Gallo, P.E.</b> Project Deliver Manager / Structural Engineer
<b>Project Assignment:</b>
Infinity Project Manager & Structural Engineer
<b>Name of Firm with which Associated:</b>
<b>Infinity Engineering Consultants, LLC.</b>
<b>Years' experience with this Firm:</b>
10
<b>Education: Degree(s)/Year/Specialization:</b>
Bachelor of Science / 2014 / Civil & Environmental Engineering
<b>Active registration: Year first registered/discipline:</b>
Professional Engineer – Mechanical Engineering LA / 2019 / Civil
<b>Other experience and qualifications relevant to the proposed Project:</b>
<p><u><b>Regional Transit Authority Napoleon Building Renovations – New Orleans, LA</b></u>  Project Engineer on the structural team responsible for analyzing the existing roof structures of two buildings using a model created in RAM Elements. This project consisted of structural, electrical, and mechanical engineering designs for the build out of the RTA Boardroom Facility within the existing Napoleon Avenue building.</p> <p><u><b>West Feliciana Parish Riverfront Development – St. Francisville, LA</b></u>  Project manager responsible for organizing the preparation and delivery of a front-end design study to identify potential development options for a Mississippi riverfront property. Coordinated with the owner, West Feliciana Parish representatives, and the Mississippi riverboat companies to gather input for the project site. Prepared conceptual designs and cost estimates for a docking facility for up to three riverboat cruise ships, as well as a welcome center pavilion. Additionally, the project consisted of civil and structural design for a passenger terminal, visitor parking, bus access, fishing services, walking trails, pavilions, and an amphitheater.</p> <p><u><b>Regional Transit Authority Canal Street Ferry Terminal CMAR – New Orleans, LA</b></u>  Project Engineer part the structural team responsible for the preparation of a construction drawing and specification package related to the installation of a new terminal building. Coordinated with the project lead, the Owner, and the architect to ensure the client's needs were addressed.</p> <p><u><b>New Orleans Union Passenger Terminal Improvements – New Orleans, LA</b></u>  Project Manager responsible for providing Program Management services to the New Orleans Building Corporation (NOBC) associated with infrastructure improvements at the New Orleans Union Passenger Terminal (NOUPT). Served as project liaison between NOBC and all stakeholders including funding sources, representatives of the City of New Orleans, and tenants of the facility. Prepared a Request for Qualifications for Architectural and Engineering and Design Services for the project, which is anticipated to be a Construction Management at Risk project.</p> <p><u><b>Plaquemines Parish Government Emergency Generators – Belle Chasse, LA</b></u>  Project Engineer on a team responsible for the preparation of a construction drawing and specification package related to the installation of a new generator and ancillary equipment at the Plaquemines Parish Finance Building. Assisted with the design of a new concrete foundation for the generator.</p> <p><u><b>Federal City Water Tower Evaluation – Algiers, LA</b></u>  Project Engineer on the team that was responsible for analyzing the existing NAVY water tower on the Federal City property in Algiers, La using a model created in RAM Elements. Assisted in the development of an engineering assessment discussing the findings of the analysis.</p>

## TEC Professional Services Questionnaire

**L. Work by Firm or Joint-Venture members which best illustrates current qualifications relevant to this Project. Please include any and all work performed for Jefferson Parish. Please attach additional pages if necessary.**

<b>PROJECT NO. 1</b>		
<b>Project Name, Location and Owner's contact information:</b>	<b>Nature of Firm's Responsibility:</b>	
<p><b>RTA Canal Street Ferry Terminal CMAR Design</b></p> <p>New Orleans, LA</p> <p>New Orleans Regional Transit Authority Darrell LaFrance 504-827-8393</p>	<p>Previously utilized for vehicles, the Canal Street Ferry has since been repurposed to focus solely on pedestrian traffic. The RTA selected Infinity to be the prime consultant to design the reconfiguration of the ferry, with the demolition of the previous terminal building and the construction of new terminal, including a pedestrian bridge.</p>  <p>The new terminal designs included a new dock structure to infill the space between the two neighboring wharf structures. Additionally, the project called for the installation of new landscape features, irrigation systems, and wayfinding signage. Infinity provided engineering designs and construction drawings for the new terminal including:</p> <ul style="list-style-type: none"> <li>• Demolition plans and modification of neighboring wharfs</li> <li>• Design of new wharf structure</li> <li>• New ferry terminal building structural designs</li> <li>• Ferry terminal building mechanical/electrical/plumbing designs</li> <li>• Subsurface utility relocation designs</li> </ul>	
<b>Completion Date (Actual or estimated):</b>	<b>Estimated Cost:</b>	
	<b>Entire Project:</b>	<b>Work for which Firm was Responsible:</b>
Completed: February 2024	\$32,500,000	\$32,500,000

<b>PROJECT NO. 2</b>		
<b>Project Name, Location and Owner's contact information:</b>	<b>Nature of Firm's Responsibility:</b>	
<p><b>Louisiana State University Science Zone Infrastructure Improvements</b></p> <p>Baton Rouge, LA</p> <p>Louisiana Office of Facility Planning &amp; Control Jim Pugh 225-219-1129</p>	<p>Infinity was the prime consultant providing schematic designs for strategic utility improvements to the Science Zone of Louisiana State University's Baton Rouge campus. The infrastructure improvements were implemented to support the construction of the new Interdisciplinary Science Building (ISB). Upon completion of the schematic designs, Infinity Engineering became a sub consultant to Tiger Energy Partners, the Program Managers of the project, to provide full engineering design for the infrastructure improvements and roadway rehabilitation.</p> <p>Infinity's designs expanded the chilled water capacity and natural gas serving the new building as well as future construction within the Science Zone. To provide this additional utilities capacity, the complete roadway replacement of approximately three campus blocks was required. The project's electrical scope included conversion from 4.16kV power distribution to 13.8kV to serve the new ISB. With this change, sectionalizers were replaced and new feeders were installed by directional drilling. Telecommunications scope was also in development to remove and relocate existing services.</p> 	
<b>Completion Date (Actual or estimated):</b>	<b>Estimated Cost:</b>	
	<b>Entire Project:</b>	<b>Work for which Firm was Responsible:</b>
Completed: December 2024	\$10,600,000	\$10,600,000



## TEC Professional Services Questionnaire

PROJECT NO. 3		
Project Name, Location and Owner's contact information:	Nature of Firm's Responsibility:	
<p style="text-align: center;"><b>Harbor of Refuge Design &amp; Construction</b> Jesuit Bend, LA</p> <p>Plaquemines Parish Government John Helmers 504-934-6297</p>	<p>Infinity served as the prime consultant to provide engineering and design services associated with the development of a harbor of refuge for commercial fishing vessels in Empire, LA. The project area consists of approximately 16 acres of land and surface water located off Hwy 23 south of the Empire Mississippi River Locks.</p> <p>The goal of the project was to develop a facility to serve as a harbor of refuge for upwards of 50 vessels during harsh weather conditions. Additionally, Plaquemines Parish sought to create opportunities to support the growth of the local fishing economy, as well as create public recreational facilities to teach about the importance of coastal protection and restoration to the State of Louisiana. The project included the following civil, structural, mechanical, and electrical design elements:</p> <ul style="list-style-type: none"> <li>New Harbor Master Building MEP &amp; Structural Design</li> <li>20,000 SF Open Air Pavilion</li> <li>Storage for 50+ fishing vessels</li> <li>On-Site Wastewater Treatment</li> </ul>	
<p>Completion Date (Actual or estimated):</p> <p>Completed: September 2024</p>	Estimated Cost:	
	Entire Project:	Work for which Firm was Responsible:
	\$4,100,000	\$4,100,000



PROJECT NO. 4		
Project Name, Location and Owner's contact information:	Nature of Firm's Responsibility:	
<p style="text-align: center;"><b>Port of New Orleans Elmwood Warehouse Renovation</b> New Orleans, LA</p> <p>Port of New Orleans Christine Nguyen 504-528-3416</p>	<p>Infinity served as the prime consultant for the design of the warehouse renovation which included civil/structural, mechanical, and electrical engineering. Infinity provided a 3D scan of the interior of the warehouse. Construction administration services included coordinating with the selected contractor, performing submittal review, reviewing and responding to RFIs, reviewing and preparing recommendations. Infinity was responsible for the following design tasks:</p> <ol style="list-style-type: none"> <li>Civil Design: Civil design components consisted of updating the roof system (10,000 sf), pavement design to accommodate the turning radius of vehicles classified as WB-67, and repairing concrete.</li> <li>Structural Design: Structural design components consisted of walls that are 16.5' in height, exterior wall demolition to provide overhead doors (20'X12') and personnel doors (2). Additionally replaced the exterior wall where the old overhead door was located.</li> <li>Mechanical Design: Engineering of the new duct configuration, HVAC design, and consisted of calculating ventilation and heat load. Performing a code review on the warehouse unit, relocating the existing sprinkler system.</li> </ol>	
<p>Completion Date (Actual or estimated):</p> <p>Completed: October 2021</p>	Estimated Cost:	
	Entire Project:	Work for which Firm was Responsible:
	\$1,500,000	\$1,500,000



## TEC Professional Services Questionnaire

PROJECT NO. 5		
Project Name, Location and Owner's contact information:	Nature of Firm's Responsibility:	
<p style="text-align: center;"><b>Braithwaite Auditorium Design</b> Braithwaite, LA</p> <p>Plaquemines Parish Government Byron Williams 504-297-5560</p>	<p>Infinity engineering and hazard mitigation design services for the new 7,800 sq ft auditorium. This FEMA-funded project replaced the previous Braithwaite Auditorium. Infinity's services included all structural, electrical, mechanical, fire protection and plumbing components, as well as construction administration, for the new auditorium. The new building features a 6,500 sq. ft. open auditorium and stage area, catering kitchen/concession space, and restrooms. The finished floor is elevated 21 feet above the Advisory Base Flood Elevation (ABFE).</p> <p>For the mechanical HVAC design, an elevator lobby is located on the ground level with a ductless split air conditioning system. The second level is conditioned via two independent mechanical systems. The auditorium and stage are conditioned via a rooftop air conditioning unit with an energy recovery ventilator providing fresh air. The kitchen/concessions area and restroom are conditioned via a split-system air conditioning system. The building is protected with a wet pipe sprinkler system.</p>	
<p>Completion Date (Actual or estimated):</p>	Estimated Cost:	
	Entire Project:	Work for which Firm was Responsible:
Completed: 2012	\$2,800,000	\$1,200,000



PROJECT NO. 6		
Project Name, Location and Owner's contact information:	Nature of Firm's Responsibility:	
<p style="text-align: center;"><b>St. Claude Avenue Sheriff Substation</b> Arabi, LA</p> <p>St. Bernard Parish Government Matthew Falati, P.E. 504-278-4300</p>	<p>This FEMA-funded project included the design of a 3-story criminal sheriff's administration building for St. Bernard Parish. Infinity designed all civil, structural, mechanical, and electrical components. The structural and electrical designs incorporated high security aspects. The building consists of steel-reinforced concrete with the bottom of the second floor above the BFE.</p> <p>The building's foundation consists of timber piles with concrete pile caps. The pile caps support reinforced concrete columns that extend up to integral concrete ledger beams. The ledger beams support precast hollow core panels that form the first level's floor. The concrete ledger beams support steel columns and additional framing for the second and third floors. Steel framing and bar joists support concrete filled metal pan flooring and a metal pan built up roof. This structure was designed to meet the International Building Code, exceeding the LA Uniform Construction Code.</p>	
<p>Completion Date (Actual or estimated):</p>	Estimated Cost:	
	Entire Project:	Work for which Firm was Responsible:
Completed: 2014	\$2,100,000	\$985,000





## TEC Professional Services Questionnaire

<b>PROJECT NO. 7</b>		
Project Name, Location and Owner's contact information:	Nature of Firm's Responsibility:	
<p style="text-align: center;"><b>East Bank Wastewater Treatment Plant Administration Building</b> New Orleans, LA</p> <p>Sewerage &amp; Water Board of New Orleans Reid Dennis, P.E. 504-865-0459</p>	<p>The East Bank Wastewater Treatment Plant Administration Building project consisted of the complete demolition and replacement design for the New Orleans Sewerage &amp; Water Board. The original single-story 4,000 sq ft building was destroyed by storm water and wind. This project was FEMA funded and included assessment of damages, writing project worksheets with construction cost estimates for submittal to FEMA, preparing plans and specifications for a brand-new elevated building. Infinity Engineering's scope included:</p> <ul style="list-style-type: none"> <li>Coordination with NO S&amp;WB and FEMA personnel for strategic planning of replacement/repair operations</li> <li>Facilities and equipment demolition planning and design coordination</li> <li>Providing structural design for an elevated concrete slab building foundation</li> <li>Design of all mechanical and plumbing systems</li> <li>Design of all electrical power and lighting, fire protection systems</li> </ul> <p>This project won an award by the American Concrete Institute Louisiana Chapter Best Concrete Projects Banquet. This award is given for innovative, economical, and environmentally conscious use of concrete, and recognizes Infinity as a leader in the field of concrete design and construction.</p>	
<p style="text-align: center;">Completion Date (Actual or estimated):</p> <p style="text-align: center;">Completed: 2013</p>	<b>Estimated Cost:</b>	
	<b>Entire Project:</b>	<b>Work for which Firm was Responsible:</b>
	\$2,500,000	\$2,500,000



<b>PROJECT NO. 8</b>		
Project Name, Location and Owner's contact information:	Nature of Firm's Responsibility:	
<p style="text-align: center;"><b>Dillard University Campus Roadway &amp; Security Improvements</b> New Orleans, LA</p> <p>Dillard University Jimmie Gooden 504-816-4375</p>	<p>Infinity provided civil, structural, mechanical, and electrical engineering designs for the improvements and upgrades to multiple systems throughout the Dillard University campus. The projects ranged from civil roadway widening to campus electrical lighting improvements.</p> <p>The roadway realignment widened the existing roadway and included drainage modifications, as well as reconfigured roadway curbs and sidewalks. The designs included the removal of an existing guard shack and foundation to realign the entrance and intersecting roads to provide access control via a new guard station. Campus site security designs included the installation of a campus wide security intelligence system campus, point to point communication via a new fiber optic loop around campus to tie into new access control, card access to walking gates with new camera surveillance, and cameras at guard booths including a license plate reader camera at each booth. Miscellaneous campus improvements included parking lot pavement repairs, as well as the addition of directional signage, bike parking, sidewalks, and bench seating.</p>	
<p style="text-align: center;">Completion Date (Actual or estimated):</p> <p style="text-align: center;">Completed: November 2020</p>	<b>Estimated Cost:</b>	
	<b>Entire Project:</b>	<b>Work for which Firm was Responsible:</b>
	\$1,000,000	\$1,000,000



## TEC Professional Services Questionnaire

<b>PROJECT NO. 9</b>		
<b>Project Name, Location and Owner's contact information:</b>	<b>Nature of Firm's Responsibility:</b>	
<p><b>Lake Hermitage Firehouse</b> Port Sulphur, LA</p> <p>Plaquemines Parish Government Bill Serpas 504-274-2471</p>	<p>Infinity provided design of all structural, mechanical, plumbing, and electrical components, including construction administration for the design and construction of a new 3,200 sq.ft. fire station. Mechanical design included services for two split system air conditioning systems to serve the community room, kitchen, and offices. Plumbing design services included plumbing for the toilet rooms and kitchen.</p> <p>The firehouse has a first-floor elevation above the Base Flood Elevation and is supported by composite piles (timber and concrete with steel shell) with concrete pile caps. Concrete columns extend to integral ledger beams, which support the precast concrete hollow core panel floor. The ledger beams also support steel columns and roof framing. The exterior walls of the main floor are reinforced CMU. The structure was designed to meet the International Building Code, exceeding the LA Uniform Construction Code.</p>	
	<b>Estimated Cost:</b>	
<b>Completion Date (Actual or estimated):</b>	<b>Entire Project:</b>	<b>Work for which Firm was Responsible:</b>
Completed: 2009	\$1,700,000	\$550,000



<b>PROJECT NO. 10</b>		
<b>Project Name, Location and Owner's contact information:</b>	<b>Nature of Firm's Responsibility:</b>	
<p><b>RTA Napoleon Facility</b> Structural Analysis and Building Weatherization New Orleans, LA</p> <p>Brittny Barnes, LEED AP BD+C Landmark Consulting, LLC 504-524-8880</p>	<p>The Regional Transit Authority's Napoleon Facility, which is included on the National Register of Historic Places, is slated for renovation. Infinity inspected the mechanical, structural, plumbing fire protection and electrical systems of the 16,000 sq ft building. After inspection, Infinity proposed underpinning of the foundation, repair of the walls and roof framing, as well as mechanical and electrical upgrades and repairs to the building.</p> <p>The structure's partially failed foundation caused one wall to lean, fracturing adjacent walls and floors. Also, the roof framing was in need of partial replacement and repair. Infinity worked with an architect to tailor renovations around preservation of the historic features of the building. Demolition plans included the selective demolition of interior walls and portions of steel truss roof support framing to create larger interior spaces and to facilitate replacement of portions of corroded roof framing. They also included demolition of existing mechanical, electrical, and fire suppression systems for replacement.</p>	
	<b>Estimated Cost:</b>	
<b>Completion Date (Actual or estimated):</b>	<b>Entire Project:</b>	<b>Work for which Firm was Responsible:</b>
Completed: May 2024	\$3,000,000	\$3,000,000



## TEC Professional Services Questionnaire

**M. List all prior and/or on-going litigation between Firm and Jefferson Parish. Please attach additional pages if necessary.**

Parties:		Status/Result of Case:
Plaintiff:	Defendant:	
1. Not Applicable	Not Applicable	Not Applicable
2.		
3.		
4.		

**N. Use this space to provide any additional information or description of resources supporting Firm's qualifications for the proposed project.**

### Firm Overview

Infinity Engineering Consultants, LLC is a dynamic, multi-discipline engineering consulting firm with specific expertise in providing designs for municipal, industrial, and marine projects. Infinity's in-house capabilities blend together the disciplines of mechanical, electrical, civil, and structural engineering to create a world-class organization capable of ushering a project from the earliest conceptual stages all the way to commissioning. With a portfolio ranging from facilities to stormwater hazard mitigation projects, Infinity has the experience and vision to handle any engineering design challenge assigned to the firm.

Founded in 2004 with offices in Metairie and Baton Rouge, Louisiana, Infinity's total full-time staff includes eleven (11) professional engineers, four (4) engineering interns, three (3) engineering graduates, nine (9) AutoCAD designers, four (4) resident inspectors, as well as supportive administrative personnel. Infinity is licensed by the Louisiana Professional Engineering and Land Surveying Board (LAPELS) and is in good standing with the Louisiana Secretary of State.

At Infinity, we passionately believe that great engineering design is people-centric. When approaching each project, Infinity seeks to understand how our engineering designs will impact the persons, places, and environments within our communities. Whether a *public* or *commercial* endeavor, Infinity is determined to improve the vitality of every community through creating forward-thinking designs that exceed the needs of everyday life.

Infinity Engineering Consultants, LLC. is a registered DBE firm with the Louisiana Unified Certification Program for Disadvantaged Business Enterprises, the City of New Orleans, and the Regional Transit Authority of New Orleans. Additionally, Infinity Engineering is certified by the Louisiana Department of Economic Development as a Small and Emerging Business Enterprise (SEBD).

### Infinity's Engineering Capabilities

Infinity offers a wide range of **Civil Engineering services**, including all forms of earthwork, roadway, and drainage designs. We recognize that great civil design is the foundation for a successful project. Infinity is committed to providing civil solutions that will do more than just work; our goal is to provide designs that work effectively and efficiently. Civil Engineering project types include:

- Site Planning, Earthwork, & Foundations
- Drainage Systems and Roadway Design
- Traffic Marking Layout & Design
- Highway Infrastructure Evaluation
- Asphalt and Concrete Paving Systems
- Water and Wastewater Facilities

Infinity's team is comprised of proficient registered Professional Engineers capable in providing comprehensive **Structural Engineering services**, including the rehabilitation of old and design of new structures. Our team holds extensive experience in most modern building materials; steel, concrete, timber, and composites, to name a few. Structural Engineering capabilities include:

- Steel and Concrete Frames
- Building Foundations & Structures
- Marine Dock Structures
- Bridges
- Trestles & Causeways
- Bulkheads



## **TEC Professional Services Questionnaire**

Infinity offers a diverse array of **Mechanical Engineering** services across industrial, commercial, and municipal applications. Among the types of mechanical engineering projects within our team's capabilities are:

- Process Equipment Sizing
- Drainage & Sewer Lift Stations
- Piping & Instrument Drawings
- Process Piping Design
- HVAC & Plumbing Systems
- Product Loading/Offloading Facilities

### **Construction Management and Inspection Services**

Infinity can provide Construction Management and Inspection Services for projects involving civil, structural, electrical, or mechanical disciplines. An experienced construction manager, who oversees all phases of construction, would be available from contract award through commissioning. Having an experienced QA/QC inspector who is familiar with the nature of the work, and the support of a qualified engineering staff, is critical to the success of the job. Our inspectors will coordinate between the contractor and the client, understand budget, deadlines, and will be there to resolve deviations in the field, as they occur. Infinity's resident inspectors have been on the job site for projects ranging from complete street reconstruction, waterline replacement, pumping station repairs, and new dock construction.

**Construction Permitting** often involves every level of government, including local, state, and federal concerns. Permits will often control the critical path of your project. This is why it is important to have an experienced consultant who understands how to pursue and ultimately obtain permitting approval for your project – as timely as possible. Infinity's engineers have experience securing permits from a wide variety of agencies. Whether it is approval from the State Fire Marshall, the EPA, Minerals Management Service, or the U.S. Army Corps of Engineers, Infinity understands the process and can assist you every step of the way.

### **Advanced Measurements**

To provide the most accurate site readings, Infinity has invested in advanced measurement technologies and a proficient team capable of collecting and interpreting difficult-to-obtain field data. Often, a project may require a visual inspection of a site that is either difficult or unsafe to access. Infinity's advanced measurement capabilities include drone technologies, allowing for safe and cost-effective visual documentation. Infinity's advanced measurements capabilities include:

- Aerial Drone
- Underwater Drone
- Laser Scanning
- Aerial LiDAR

### **Project Experience**

Infinity has prepared engineering designs for facilities ranging from a few thousand dollars to several million dollars completely with in-house staff. Below is a listing of additional representative projects that demonstrate the firm's breadth and depth of experience when providing engineering solutions for municipal facilities.

- Mahalia Jackson Theater of the Performing Arts Renovation
- Florida Desire Community Center MEP & Commercial Kitchen Design & Construction Administration
- Percy Griffin Community Center Design & Construction
- Ursuline Academy Drainage Improvements FEMA Repairs
- Edna LaFrance Administration Building – MEP & Kitchen Design
- Frederick Douglass High School HVAC Replacement
- Jefferson Parish Gymnasium/Disaster Shelter Generator Manual Transfer Switches
- The Pre-School Learning Center, Inc. Commercial Kitchen MEP Design
- Tom Benson Elementary School HVAC Replacement
- JB Martin Elementary School Elevator Addition
- St. Charles Parish School Satellite Career Center MEP Design
- Schaumburg Elementary Chillers Replacement
- Ellis Marsalis School Boiler Replacement

With the formation of Infinity Engineering just over one year before the events of Hurricane Katrina, the firm's growth can be attributed to providing design work for FEMA-funded projects. Throughout the rebuilding efforts, the Infinity team

## **TEC Professional Services Questionnaire**

gained invaluable experience working within the parameters of federally funded and federal grant projects. The Infinity team is well versed in the documentation necessary to meet funding requirements. Infinity understands any of the assigned drainage projects could utilize Community Development Block Grant or other federal funding. Infinity is committed to performing the design engineering to the specifications of the CDBG funding to ensure the funding requirements are met. The following projects represent some of the federally funded projects Infinity has performed:

### **Infinity CDBG-Funded Projects**

- Wedmore Neighborhood Drainage Improvements
- Martin Luther King Resource Center
- Bannerwood Neighborhood Drainage Improvements
- South Galvez Street Lighting Improvements
- Empire Harbor of Refuge Design & Construction
- Washington Parish Emergency Center & Communications Tower

Infinity's growth, resilience, and repeat business in the municipal and industrial sectors is proof of our reputation. We take great pride in that and expect to continue to build the same trust with Jefferson Parish. The engineering pool for routine architectural services is an important endeavor for Jefferson Parish. Its success will afford comfort and convenience for present and future users, as the Jefferson Parish community continues to grow and thrive. Improved sanitation leads to a healthier and more vibrant community.

Infinity Engineering recognizes the importance of this program and has assembled the most qualified team to handle all aspects of the projects. Thank you for taking the time to learn more about Infinity Engineering Consultants, LLC. We look forward to working with you to grow and enhance our communities together.

Infinity Engineering Consultants, LLC.  
rchauvin@infinityec.com  
(504) 304-0548

**O. To the best of my knowledge, the foregoing is an accurate statement of facts.**

**Signature:**  **Print Name:** Raoul V. Chauvin, III, P.E.  
**Title:** Principal **Date:** December 16, 2024

# Infinity Engineering Licenses



**LOUISIANA PROFESSIONAL  
ENGINEERING & LAND SURVEYING BOARD  
(LAPELS)**

9643 Brookline Avenue, Suite 121  
Baton Rouge, LA 70809  
Phone (225) 925-6291  
www.lapels.com

**Mr. William John Thomassie**

License/Certificate Type - Number	Expiration Date
<b>PE.0027421</b>	<b>09/30/2025</b>
Status: <b>Active</b>	



**LOUISIANA PROFESSIONAL  
ENGINEERING & LAND SURVEYING BOARD  
(LAPELS)**

9643 Brookline Avenue, Suite 121  
Baton Rouge, LA 70809  
Phone (225) 925-6291  
www.lapels.com

**Ms. Rachel Ann Kenney**

License/Certificate Type - Number	Expiration Date
<b>PE.0037666</b>	<b>09/30/2025</b>
Status: <b>Active</b>	



**LOUISIANA PROFESSIONAL  
ENGINEERING & LAND SURVEYING BOARD  
(LAPELS)**

9643 Brookline Avenue, Suite 121  
Baton Rouge, LA 70809  
Phone (225) 925-6291  
www.lapels.com

**Mr. Ricardo Antonio Contreras**

License/Certificate Type - Number	Expiration Date
<b>PE.0028533</b>	<b>09/30/2025</b>
Status: <b>Active</b>	



**LOUISIANA PROFESSIONAL  
ENGINEERING & LAND SURVEYING BOARD  
(LAPELS)**

9643 Brookline Avenue, Suite 121  
Baton Rouge, LA 70809  
Phone (225) 925-6291  
www.lapels.com

**Ms. Cindy Michelle Gallo**

License/Certificate Type - Number	Expiration Date
<b>PE.0043357</b>	<b>09/30/2025</b>
Status: <b>Active</b>	

The Louisiana Professional Engineering and Land Surveying Board has the following information on file:

Name:	Public Address:
Infinity Engineering Consultants, LLC	Mr. William Thomassie 4001 Division Street Metairie, Louisiana 70002

## License/Certificate Information w/ Supervision

License	Status	First Issuance Date	Expiration Date	Supervisor(s)
EF.0003109	Active	03/09/2004	09/30/2026	Mr. William John Thomassie # PE.0027421 ; Mr. Raoul Vincent Chauvin III # PE.0028272



**TEC Professional Services Questionnaire**

**A. Project Name and Advertisement Resolution Number:**

**Jefferson Parish Miscellaneous Architecture and Engineering Services on an As-Needed basis**  
SOQ 24-036

**B. Firm Name & Address:**

**Grace Hebert Curtis Architects, LLC**  
601 Poydras Street, Suite 2310  
New Orleans, LA 70130



**C. Name, title and contact information of Principal, as defined in Section 2-926 of the Jefferson Parish Code of Ordinances, who is a registered, licensed architect, professional engineer, or surveyor in the State of Louisiana:**

Alex Deshotels, AIA, NCARB  
Partner, Registered Architect in LA #8323  
P: 225.338.5569  
E: adeshotels@ghc-arch.com

**D. Name and contact information of employee who is a registered and licensed architect, professional engineer, or surveyor in the State of Louisiana in the applicable discipline. A subcontractor may be substituted here only if the advertised Project requires more than one discipline.**

Michael Leitzinger  
Senior Associate, Registered Mechanical Engineer in LA #0034903  
P: 225.338.5569  
E: mleitzinger@ghc-arch.com

**E. Please provide the number of employees whose primary function corresponds with each category:**

<u>60</u> Administrative	<u>    </u> Estimators	<u>    </u> Specification Writers
<u>149</u> Architects (Licensed)	<u>    </u> Geologists	<u>    </u> Structural Engineers
<u>    </u> Chemical Engineers	<u>    </u> Geotechnical Engineers	<u>    </u> Graduate Engineers
<u>    </u> Civil Engineers	<u>24</u> Interior Designers	<u>    </u> Project Managers
<u>    </u> Construction Inspectors	<u>    </u> Landscape Architects	<u>    </u> Clerical
<u>    </u> Ecologists	<u>    </u> Land Surveyor	<u>    </u> Grant/Funding Specialist
<u>    </u> Electrical Engineers	<u>2</u> Mechanical Engineers	<u>    </u> Sanitary Engineers
<u>125</u> Engineer Intern	<u>    </u> Environmental Engineers	
<u>    </u> Professional Land Surveyors		<u>360</u> TOTAL

**F. Is this submittal by a JOINT-VENTURE? Please check: YES ☐ NO ☒**

**If marked "No" skip to Section I. If marked "yes" complete Sections G-H.**

## TEC Professional Services Questionnaire

**G. If submittal is by JOINT-VENTURE, list the firms participating and outline specific areas of responsibility (including administrative, technical, and financial) for each firm. Please attach additional pages if necessary.**

1. N/A

2. N/A

**H. Has this JOINT-VENTURE previously worked together? Please check:**

YES ☐ NO ☐ N/A

**I. List all subcontractors anticipated for this Project. Please note that all subcontractors must submit a fully completed copy of this questionnaire, applicable licenses, and any other information required by the advertisement. See Jefferson Parish Code of Ordinances, Sec. 2-928(a)(3). Please attach additional pages if necessary.**

Name & Address:	Specialty:	Worked with Firm Before (Yes or No):
1.		
2.		
3.		

**J. Please specify the total number of support personnel that may assist in the completion of this Project:**

3

## TEC Professional Services Questionnaire

<b>KEY PERSON, SPECIALIST, OR INDIVIDUAL CONSULTANT:</b>	
<b>Name &amp; Title:</b>	
<b>Michael Leitzinger, PE</b> Senior Associate, Mechanical Engineer	
<b>Project Assignment:</b>	
Mechanical Engineer	
<b>Name of Firm with which associated:</b>	
Grace Hebert Curtis Architects, LLC	
<b>Years' experience with this Firm:</b>	
1	
<b>Education: Degree(s)/Year/Specialization:</b>	
Bachelor, Science in Mechanical Engineering, University of Alabama	
<b>Active registration: Year first registered/discipline:</b>	
Licensed PE in VA #PE.0034903, 2001	
<b>Other experience and qualifications relevant to the proposed Project:</b>	
<ul style="list-style-type: none"><li>▪ Hahnville High School Triple A Alumni Center; Boutte, LA</li><li>▪ Ascension Parish Sheriff's Office District 3 Substation; Prairieville, LA</li><li>▪ South Baton Rouge Presbyterian Church Additions and Renovations; Baton Rouge, LA</li><li>▪ Central High School Baseball Facilities Phase I; Baton Rouge, LA</li><li>▪ Plaquemine Lockhouse; Plaquemine, LA</li><li>▪ Ascension Parish Training Center Expansion; Gonzales, LA</li><li>▪ Public Safety Complex Welding Shop Addition; Scott, LA</li><li>▪ Grace Hebert Curtis Architects Office; Pensacola, FL</li></ul>	



## TEC Professional Services Questionnaire

<b>KEY PERSON, SPECIALIST, OR INDIVIDUAL CONSULTANT:</b>	
<b>Name &amp; Title:</b> <b>Daniel Hebert</b> Senior Mechanical Designer	
<b>Project Assignment:</b> Mechanical Designer	
<b>Name of Firm with which associated:</b> Grace Hebert Curtis Architects, LLC	
<b>Years' experience with this Firm:</b> 1	
<b>Education: Degree(s)/Year/Specialization:</b> Bachelor, Mechanical Engineering, University of Louisiana at Lafayette, 2015	
<b>Active registration: Year first registered/discipline:</b> N/A	
<b>Other experience and qualifications relevant to the proposed Project:</b> <ul style="list-style-type: none"> <li>▪ LCIW Replacement of Flood Damaged Facility; St. Gabriel, LA*</li> <li>▪ Great Hearts Charter School; Baton Rouge, LA*</li> <li>▪ Madison Parish Hospital; Tallulah, LA*</li> <li>▪ Farm Bureau; Baton Rouge, LA*</li> <li>▪ Ascension Parish Courthouse; Gonzales, LA*</li> <li>▪ Evangeline Parish Sheriff's Detention Center; Ville Platte, LA*</li> <li>▪ Spencer Calahan Office; Baton Rouge, LA*</li> <li>▪ Central High School Renovation and Additions; Baton Rouge, LA*</li> </ul> <div style="text-align: right; margin-top: 10px;">           *Work on GHC-designed projects while with previous employment         </div>	

## TEC Professional Services Questionnaire

**L. Work by Firm or Joint-Venture members which best illustrates current qualifications relevant to this Project. Please include any and all work performed for Jefferson Parish. Please attach additional pages if necessary.**

<b>PROJECT NO. 1</b>		
<b>Project Name, Location and Owner's contact information:</b>	<b>Nature of Firm's Responsibility:</b>	
<b>Grace Hebert Curtis Office Pensacola</b> Pensacola, FL  Larry Adams, Jr., Partner, Hospitality Practice Leader P: 850.434.5444 E: ladams@ghc-arch.com	The renovations to Grace Hebert Curtis Architects' Pensacola office involved transforming the existing first and second-floor spaces into a modern office environment. The project included the complete removal and replacement of walls, ceilings, flooring, HVAC ductwork, diffusers, controls, and electrical systems, while reusing the existing HVAC air conditioning units.	
Completion Date (Actual or estimated):	Estimated Cost:	
	Entire Project:	Work for which Firm was Responsible:
Actual: 07/2024	\$985,963	Mechanical Engineering

<b>PROJECT NO. 2</b>		
<b>Project Name, Location and Owner's contact information:</b>	<b>Nature of Firm's Responsibility:</b>	
<b>Hahnville High School Triple A Alumni Center</b> Boutte, LA  John P. Rome, Assistant Superintendent of Operations P: 985.785.6289	Construction of a two-story multipurpose facility to be used as an alumni center. The building has store front glass, a standing seam metal roof, warming kitchen, and 2 banquet areas on each floor. Enclosed spaces are to serve as meeting/entertaining/hosting rooms. The first-floor rooms can be divided with a movable wall. There are upper and lower outdoor viewing areas facing the football field.	
Completion Date (Actual or estimated):	Estimated Cost:	
	Entire Project:	Work for which Firm was Responsible:
Actual: 08/2025	\$2,000,000	Mechanical Engineering

## TEC Professional Services Questionnaire

<b>PROJECT NO. 3</b>		
<b>Project Name, Location and Owner's contact information:</b>	<b>Nature of Firm's Responsibility</b>	
<b>Ascension Parish Sheriff's Office District 3 Substation</b> Prairieville, LA  Cody Melancon, Lieutenant Colonel P: 225.621.8300	The Ascension Parish Sheriff's Office District 3 Headquarters is a new facility that will house offices, a squad room, breakroom, evidence storage, restrooms, and support spaces. Exterior finishes include but are not limited to ACM panels, modular block veneer, and aluminum storefront and curtainwall systems. Interior finishes include but are not limited to acoustic ceiling tiles, wood-look ceiling, LVT, carpet, porcelain tile, sealed concrete, painted gypsum board walls, and millwork. Plumbing, HVAC, lighting, power, and telecommunications systems will be provided to accommodate the building design.	
<b>Completion Date (Actual or estimated)</b>	<b>Estimated Cost:</b>	
	<b>Entire Project:</b>	<b>Work for which Firm was Responsible:</b>
Actual: 06/2025	\$4,637,000	Mechanical Engineering

<b>PROJECT NO. 4</b>		
<b>Project Name, Location and Owner's contact information:</b>	<b>Nature of Firm's Responsibility:</b>	
<b>South Baton Rouge Presbyterian Additions and Renovations</b> Baton Rouge, LA  Connie Droze, Office Administrator P: 225.768.9999 E: office@sbrpc.org	The South Baton Rouge Presbyterian Additions and Renovations project encompasses the construction of a new 3,416-square-foot office building designed to house pastor offices and support spaces, as well as a new classroom building to accommodate Sunday School and Vacation Bible School programs. The project also includes significant updates to the existing sanctuary, converting the former office area into a versatile multipurpose space and reconfiguring the nursery to better serve the congregation's needs.	
<b>Completion Date (Actual or estimated):</b>	<b>Estimated Cost:</b>	
	<b>Entire Project:</b>	<b>Work for which Firm was Responsible:</b>
Actual: Undetermined	\$3,100,000	Mechanical Engineering



## TEC Professional Services Questionnaire

<b>PROJECT NO. 5</b>		
<b>Project Name, Location and Owner's contact information:</b>	<b>Nature of Firm's Responsibility:</b>	
<b>BASIS Texas Charter Schools</b> Leander, TX  Barb DeLisa, Sr., Director of Planning & Building Development P: 480.751.8967 E: barb.delisa@basised.com	The BASIS Texas Charter School in Leander features a three-story classroom building, a gymnasium, landscaped areas, and parking lots. The project scope encompasses all associated civil, structural, mechanical, and electrical systems to support the new facilities.	
Completion Date (Actual or estimated):	<b>Estimated Cost:</b>	
	<b>Entire Project:</b>	<b>Work for which Firm was Responsible:</b>
Actual: 08/2026	\$32,000,000	Mechanical Engineering

<b>PROJECT NO. 6</b>		
<b>Project Name, Location and Owner's contact information:</b>	<b>Nature of Firm's Responsibility:</b>	
<b>Central High School Baseball Facilities Phase I</b> Baton Rouge, LA  Jason Fountain, Superintendent P: 225.262.1919 E: jfountain@centralcss.org	Phase 1 of the Central High School Baseball Facilities project involves the design and construction of a single-story building featuring batting cages, with optional additions including locker rooms, restrooms, and offices.	
Completion Date (Actual or estimated):	<b>Estimated Cost:</b>	
	<b>Entire Project:</b>	<b>Work for which Firm was Responsible:</b>
Actual: 07/2025	\$2,500,000	Mechanical Engineering

## TEC Professional Services Questionnaire

<b>PROJECT NO. 7</b>		
<b>Project Name, Location and Owner's contact information:</b>	<b>Nature of Firm's Responsibility:</b>	
<b>Plaquemine Lockhouse</b> Plaquemine, LA  Mike Carringone, FOL President P: 225.235.9022 E: <a href="mailto:contact@friendsofthelock.org">contact@friendsofthelock.org</a>	The Plaquemine Lockhouse project involves repairs and renovations to transform a historic two-story brick lockhouse, listed on the National Register of Historic Places, into a museum. The scope of work includes restoring the exterior and interior brick walls, repairing the roof, and refurbishing the historic wood windows, doors, and flooring. Upgrades also include a new mechanical system, new electrical system, installation of new flooring, an ADA-compliant ramp, and the addition of a modern restroom to enhance accessibility and functionality.	
<b>Completion Date (Actual or estimated):</b>	<b>Estimated Cost:</b>	
	<b>Entire Project:</b>	<b>Work for which Firm was Responsible:</b>
Estimated: 12/2024	\$500,000	Mechanical Engineering

<b>PROJECT NO. 8</b>		
<b>Project Name, Location and Owner's contact information:</b>	<b>Nature of Firm's Responsibility:</b>	
<b>Anne Frank Inspire Academy Expansion</b> San Antonio, TX  Justin Johnson, Superintendent P: 210.638.5012 E: <a href="mailto:jjohnston@braination.net">jjohnston@braination.net</a>	The Anne Frank Inspire Academy expansion involves the ground-up construction of a new classroom building. The project includes comprehensive work across all related civil, structural, mechanical, and electrical systems to support the new facility.	
<b>Completion Date (Actual or estimated):</b>	<b>Estimated Cost:</b>	
	<b>Entire Project:</b>	<b>Work for which Firm was Responsible:</b>
Actual: 07/2026	\$3,600,000	Mechanical Engineering

## TEC Professional Services Questionnaire

<b>PROJECT NO. 9</b>		
<b>Project Name, Location and Owner's contact information:</b>	<b>Nature of Firm's Responsibility:</b>	
<b>Ascension Parish Training Center Expansion</b> Gonzales, LA  Jef Wiley, Sheriff P: 225.621.8320	The Ascension Parish Training Center Expansion will provide fully finished and conditioned spaces for training facilities, locker rooms, storage, and showers. The project also includes renovations to the existing assembly area and upgrades to the commercial kitchen, enhancing functionality and modernizing the facility.	
<b>Completion Date (Actual or estimated):</b>	<b>Estimated Cost:</b>	
	<b>Entire Project:</b>	<b>Work for which Firm was Responsible:</b>
Actual: 12/2025	\$6,500,000	Mechanical Engineering

<b>PROJECT NO. 10</b>		
<b>Project Name, Location and Owner's contact information:</b>	<b>Nature of Firm's Responsibility:</b>	
<b>Public Safety Complex Welding Shop Addition</b> Scott, LA  Keith Sibille, Chief Financial Officer P: 337.236.5611 E: keith.sibille@lafayettesheriff.com	The Public Safety Complex Welding Shop Addition is a new extension to the existing Lafayette Parish Sheriff's Office Public Safety Complex. Designed as a pre-engineered metal building on a slab-on-grade foundation, the addition will include an outdoor welding workshop, an electrical closet, and a storage room. The exterior features standing seam metal roofing and a painted structural finish. The project also includes associated mechanical, electrical, and plumbing (MEP) work to support the new facility.	
<b>Completion Date (Actual or estimated):</b>	<b>Estimated Cost:</b>	
	<b>Entire Project:</b>	<b>Work for which Firm was Responsible:</b>
Estimated: 06/2025	\$300,000	Mechanical Engineering



## TEC Professional Services Questionnaire

**M. List all prior and/or on-going litigation between Firm and Jefferson Parish. Please attach additional pages if necessary.**

Parties:		Status/Result of Case:
Plaintiff:	Defendant:	
1. N/A	N/A	N/A
2.		
3.		
4.		

**N. Use this space to provide any additional information or description of resources supporting Firm's qualifications for the proposed project.**

At Grace Hebert Curtis Architects, our mechanical engineers play an indispensable role within our firm, offering expertise in designing, analyzing, and implementing various systems to a building's functionality. We work hand in hand with architects and interior designers, combining their creative know-how with our mechanical experience to ensure all designs not only provide comfort and efficiency, but also visual appeal. Our responsibility for the development of environmental and plumbing systems allows us to ensure comfort within the constructed spaces. This balance between operational functionality and architectural aesthetics is crucial to our approach.

Collaborating closely with architects and interior designers brings a practical perspective to the table, ensuring that the architectural vision seamlessly aligns with the technical necessities. This collaboration results in buildings that are not just visually striking but also functionally exceptional.

**O. To the best of my knowledge, the foregoing is an accurate statement of facts.**

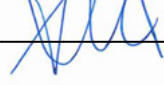
Signature:  \_\_\_\_\_ Print Name: \_\_\_\_\_ Alex Deshotels  
 Title: \_\_\_\_\_ Partner, Architect \_\_\_\_\_ Date: \_\_\_\_\_ 12/19/2024

# GHC Mechanical Engineer License

---

	<b>LOUISIANA PROFESSIONAL ENGINEERING &amp; LAND SURVEYING BOARD (LAPELS)</b> 9643 Brookline Avenue, Suite 121 Baton Rouge, LA 70809 Phone (225) 925-6291 <a href="http://www.lapels.com">www.lapels.com</a>
<b>Mr. Michael Philip Leitzinger</b>	
License/Certificate Type - Number	
<b>PE.0034903</b>	
<b>Status: Active</b>	Exp Date: <b>03/31/2026</b>



[GHC-ARCH.com](http://GHC-ARCH.com)